



pdw Daybot USB Tail Light Instruction Manual

[Home](#) » [PDW](#) » **pdw Daybot USB Tail Light Instruction Manual** 

Contents

- [1 pdw Daybot USB Tail Light](#)
- [2 Charging](#)
- [3 Battery Care Noter](#)
- [4 Stayputnik™ Mount](#)
- [5 Operation](#)
- [6 Warranty](#)
- [7 Documents / Resources](#)
- [8 Related Posts](#)



pdw Daybot USB Tail Light



Charging

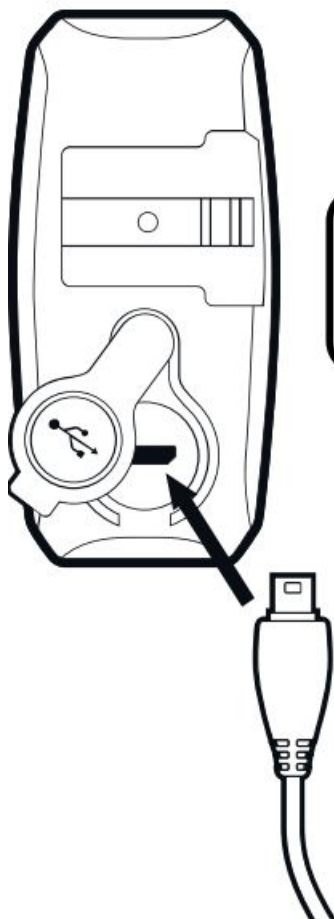

Charging indicator on front of light:

- ☀ Blue flash = charging
- Solid Blue = fully charged

Tail light will charge from empty to full in 2.5 hours.

Battery Care Noter

- Leaving the light plugged into a power source or charging before the light is fully depleted will not harm the battery.
- Charge the battery at least once every 2 months to maintain battery health.

Stayputnik™ Mount

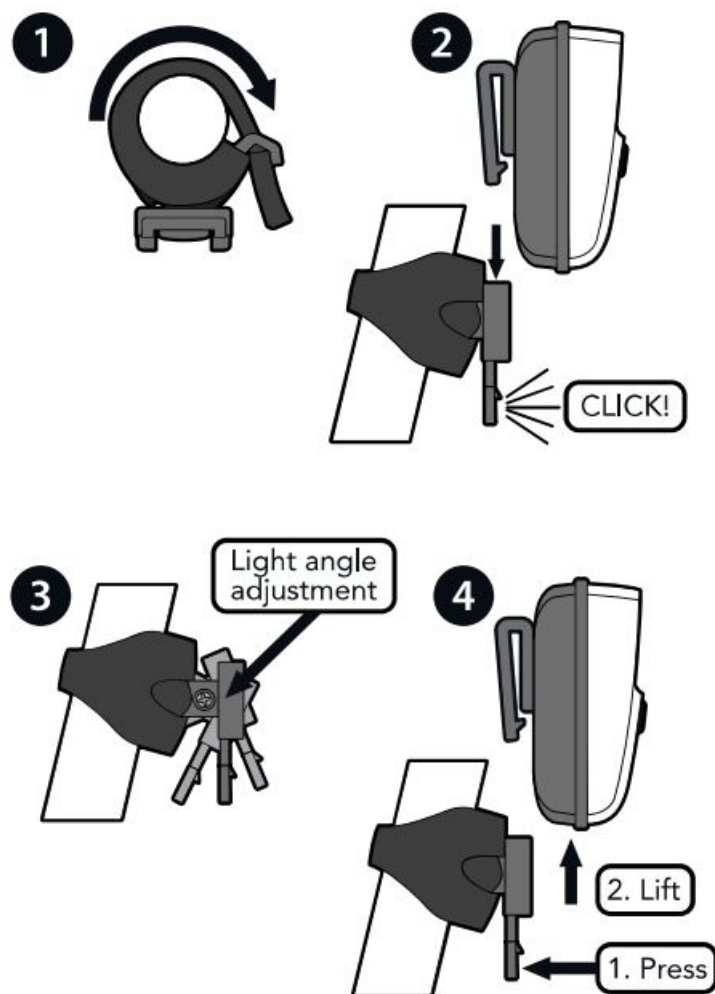

Operation

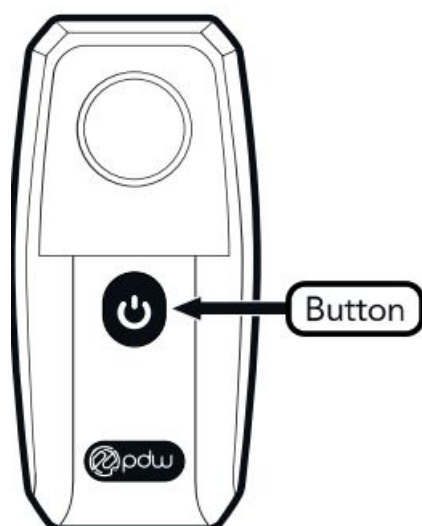

- Press and hold button for 1 second for on/of. Tap button to change between functions.
- When battery is low, light automatically switches to a slow flash reserve mode.

Warranty

Lifetime warranty covering manufacturing defects except as follows: 2 years on electrical components and one

year on batteries.
Spare parts available at: www.ridepdw.com/goods/spare-parts

Documents / Resources

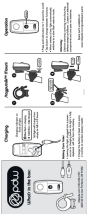
	<p>pdw Daybot USB Tail Light [pdf] Instruction Manual Daybot USB Tail Light, Daybot, USB Tail Light, Tail Light</p>
---	---