



PDQ KMS BLE Only Deadbolt Instruction Manual

[Home](#) » [PDQ](#) » PDQ KMS BLE Only Deadbolt Instruction Manual 

PDQ KMS BLE Only Deadbolt Instruction Manual



Contents

- [1 INSTALL LATCH](#)
- [2 INSTALL CYLINDER ASSEMBLY](#)
- [3 NSTALL GASKET & INSIDE MOUNTING PLATE](#)
- [4 INSTALL INSIDE TRIM AND BATTERIES](#)
- [5 Documents / Resources](#)
 - [5.1 References](#)
- [6 Related Posts](#)

INSTALL LATCH

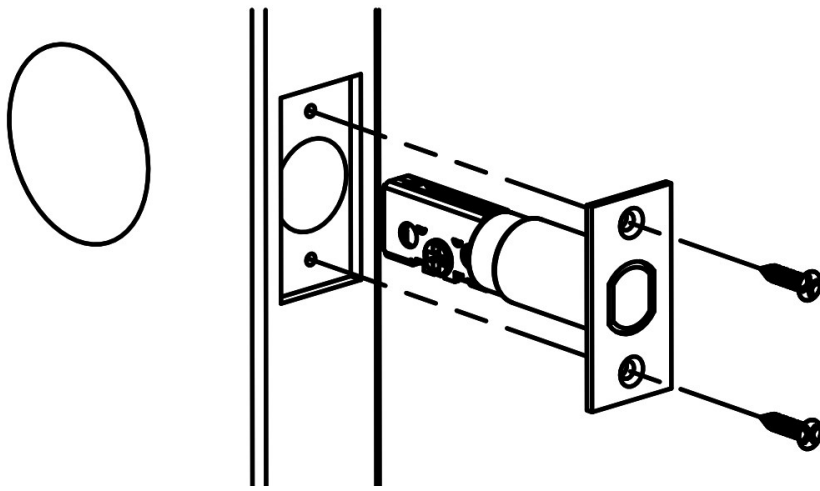

- Install latch with cross slot for tailpiece toward bottom.
- Secure with (2) combo screws

INSTALL CYLINDER ASSEMBLY

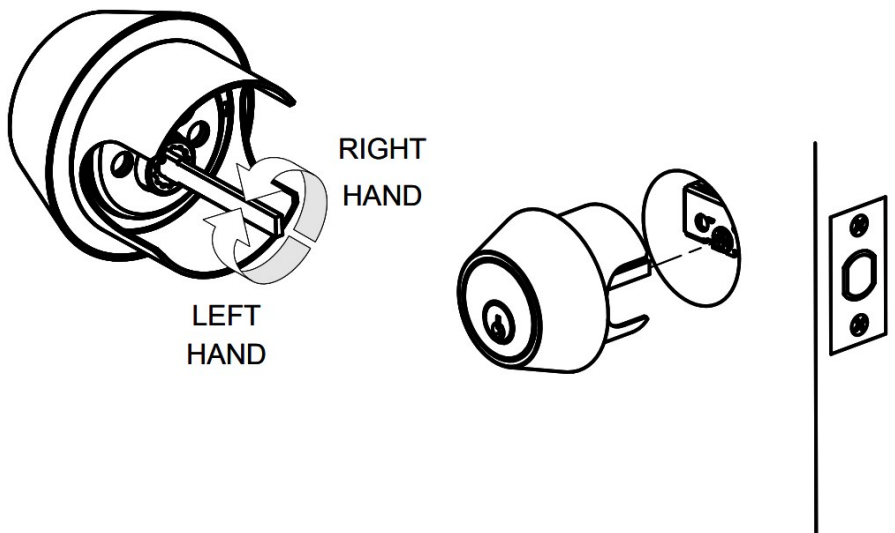

- Install cylinder assembly from outside of door.
- If extended, retract deadbolt

Left Hand Door – Rotate tailpiece clockwise until it stops in the vertical orientation.

Right Hand Door – Rotate tailpiece counter-clockwise until it stops in the vertical orientation.

INSTALL GASKET & INSIDE MOUNTING PLATE

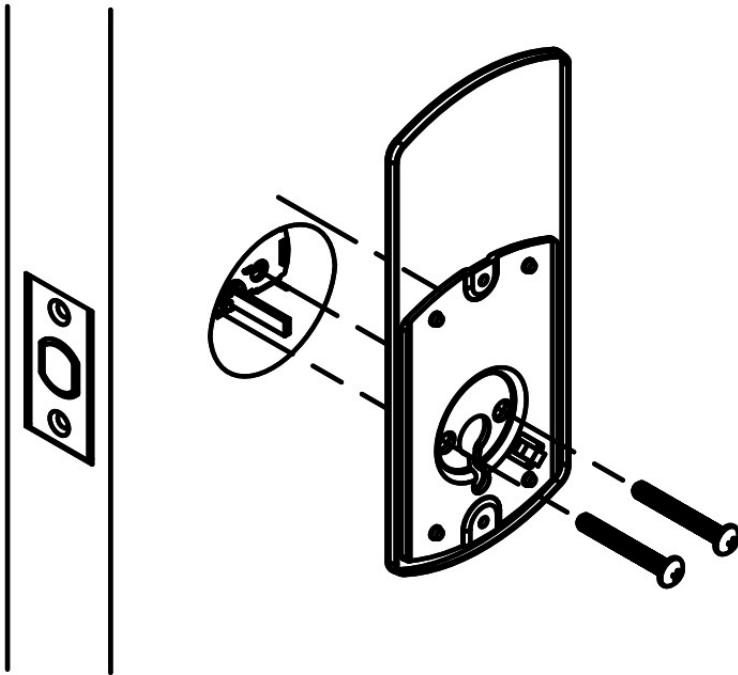

- Install rubber gasket and inside mounting plate
- Secure with (2) pan head screws.

INSTALL INSIDE TRIM AND BATTERIES

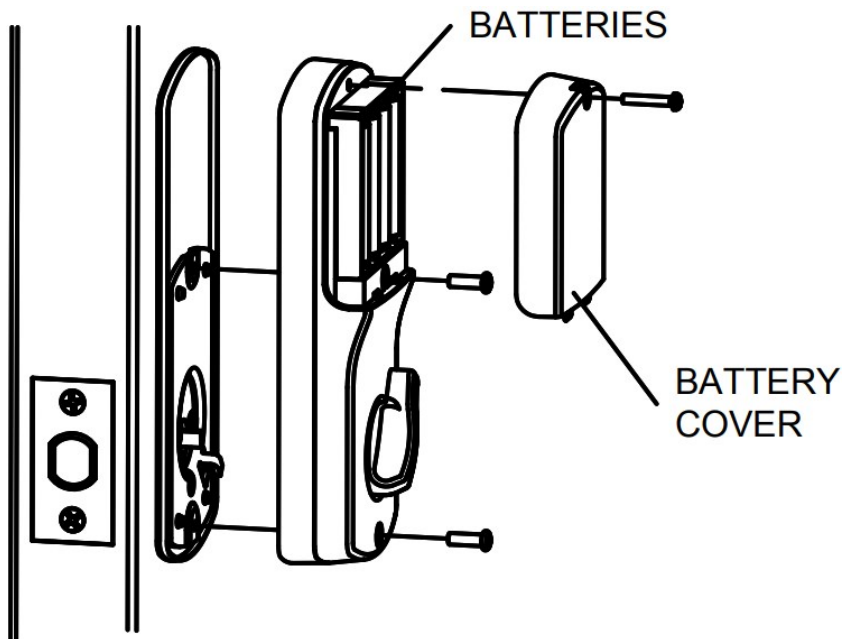

- Align thumb turn with tailpiece
- Secure escutcheon with (2) short pan head screws.
- Install batteries and battery cover with pan head screw.

Documents / Resources

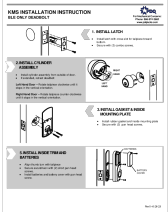

[PDQ KMS BLE Only Deadbolt](#) [pdf] Instruction Manual
KMS BLE Only Deadbolt, KMS Deadbolt, BLE Only Deadbolt, Deadbolt

References

- [🌟 Home Page | PDQ](#)

Manuals+,