



## PDQ 6400 Series Exit Devices Instruction Manual

[Home](#) » [PDQ](#) » PDQ 6400 Series Exit Devices Instruction Manual 

### PDQ 6400 Series Exit Devices Instruction Manual



#### Contents

- [1 ADJUST FOR DOOR THICKNESS](#)
- [2 HAND TRIM – 6W/6N Only](#)
- [3 INSTALL TRIM](#)
- [4 REMOVE BACKPLATE](#)
- [5 DETERMINE FUNCTION](#)
- [6 INSTALL NEW FUNCTION](#)
- [7 Documents / Resources](#)
  - [7.1 References](#)
- [8 Related Posts](#)

**ADJUST FOR DOOR THICKNESS**

- Pin can be moved for 1 3/4", 2" or 2 1/4"
- Remove clip, move pin to desired location, reinstall clip

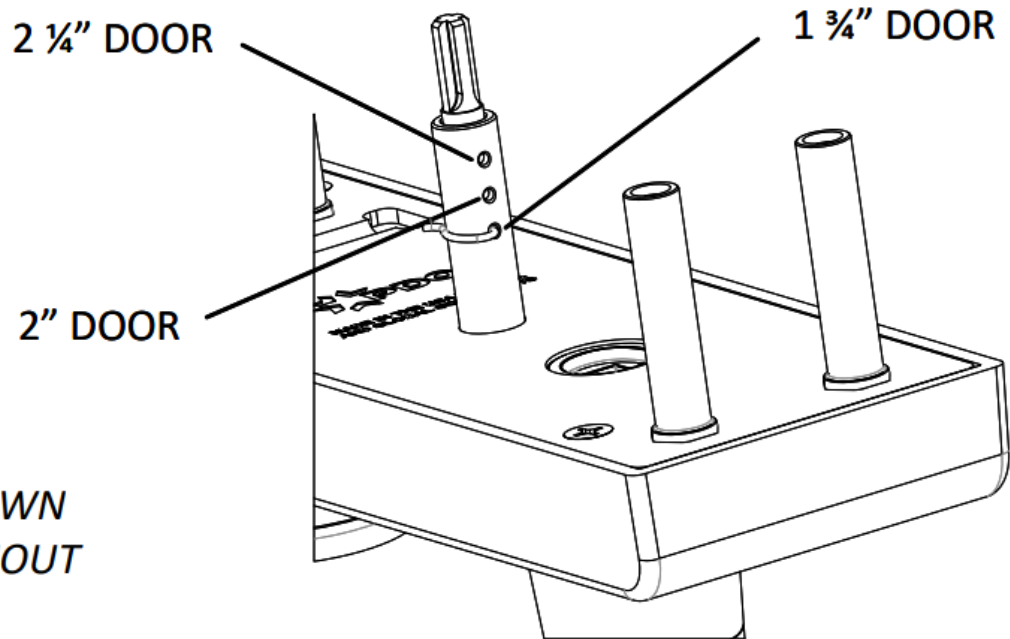

### HAND TRIM – 6W/6N Only

- Adjust lever for proper handing

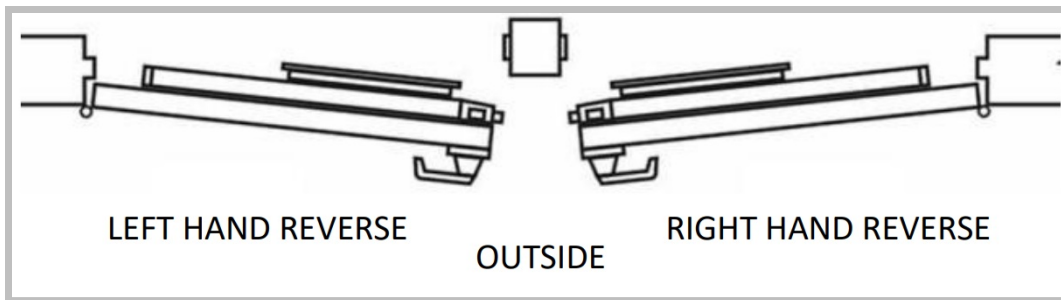

- Install lever drive spindle

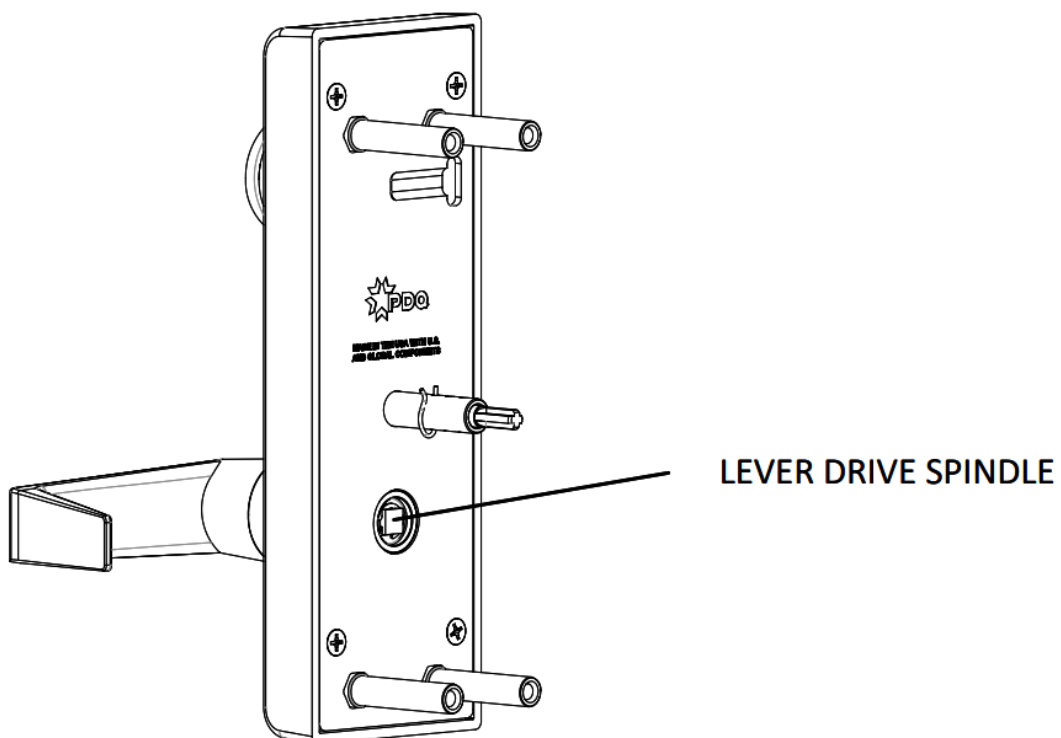

## INSTALL TRIM

- Secure trim and exit device to door
- Trim will always thru bolt to exit device
  - Verify operation of both the trim and the exit device
- 6T only – Secure handle with mounting screw and finish washer

**6N/6W**

**6T**

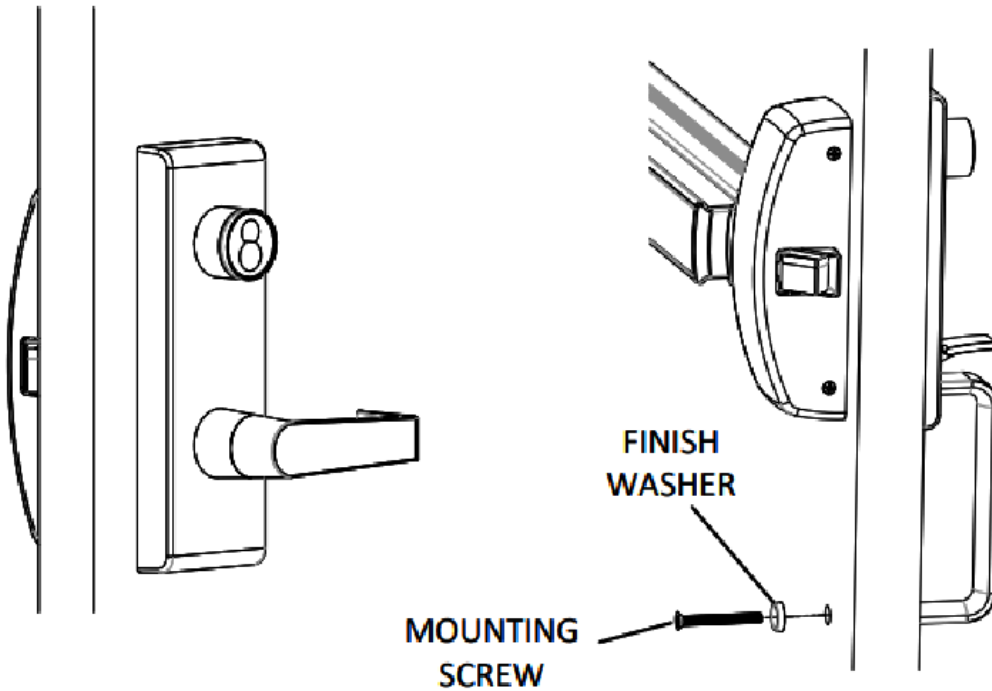

## REMOVE BACKPLATE

- Remove retaining clip
- Remove (4) screws
- Remove Backplate

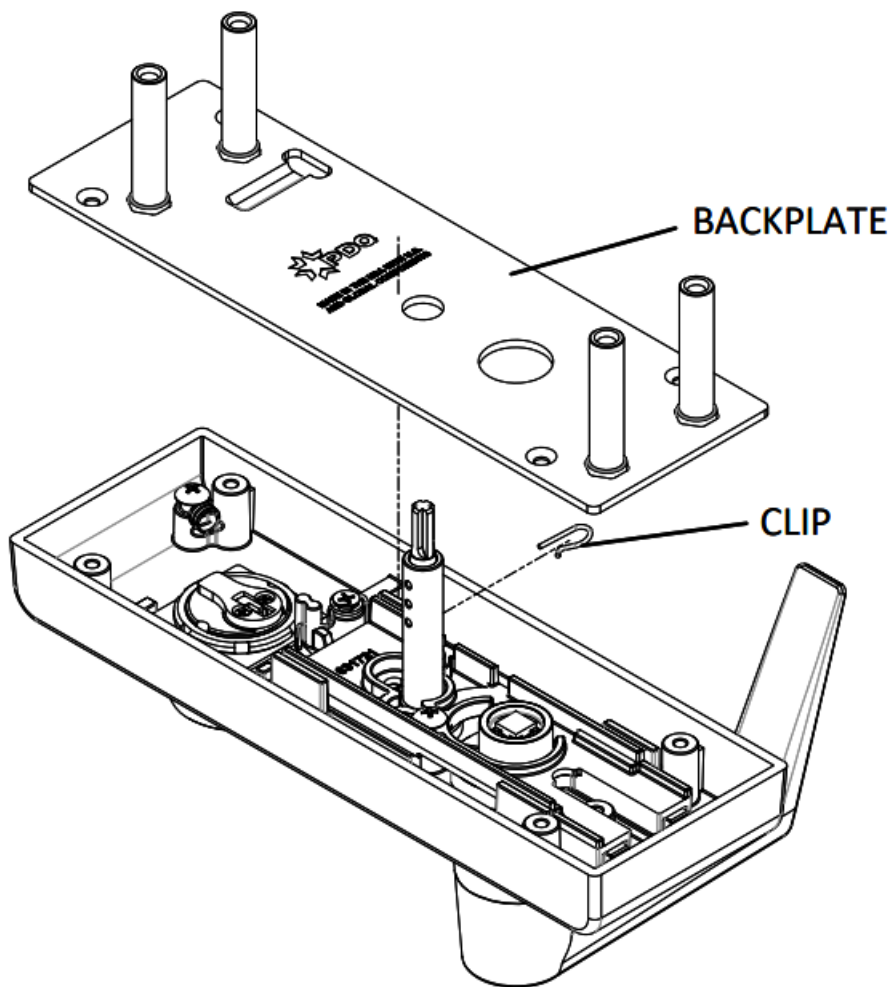

## DETERMINE FUNCTION

- Standard 6W includes conversion kit within escutcheon
- 6N/6T conversion kit can be ordered separately

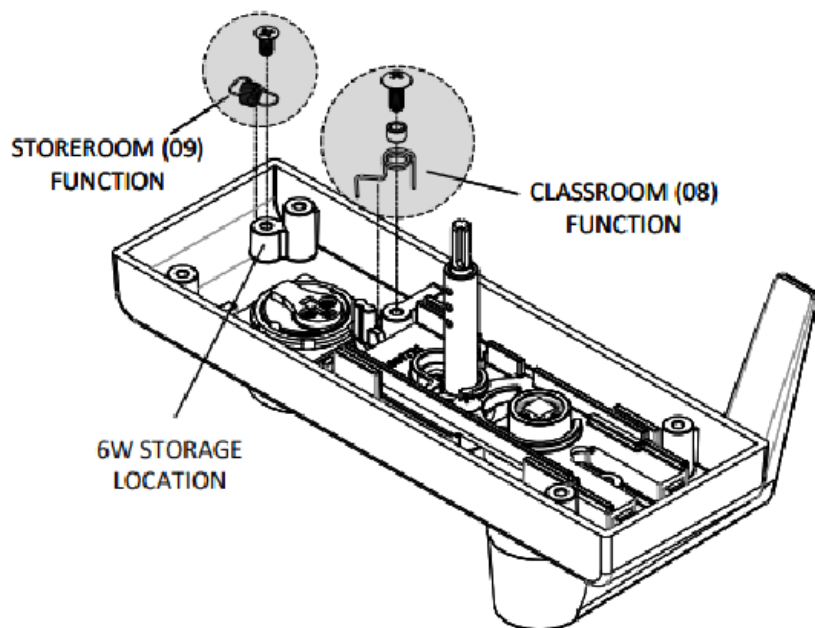

## INSTALL NEW FUNCTION

- Install desired function

- **08 Function:** Spring engages beneath boss on locking mechanism. Spring spacer must be installed on inside of spring before tightening screw

## 08 FUNCTION

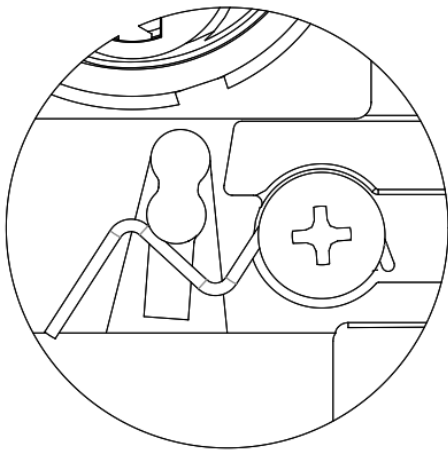

- **09 Function:** Extension spring to go around boss on locking mechanism

## 09 FUNCTION

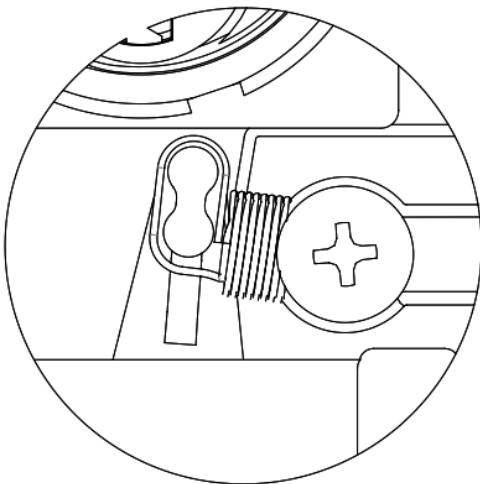

- For 6W Only: Install unneeded function into storage location
- Reinstall backplate and retaining clip

## Documents / Resources

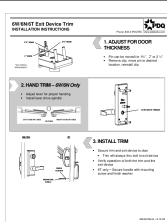

[PDQ 6400 Series Exit Devices](#) [pdf] Instruction Manual  
6400 Series, 6300 Series, Exit Devices, 6400 Series Exit Devices

## References

-  [pdqlocks.com](https://pdqlocks.com)

Manuals+.