

PDQ
6300 Exit Device
Equipped With
Delayed Egress



PDQ 6300 Exit Device Equipped With Delayed Egress Instructions

[Home](#) » [PDQ](#) » PDQ 6300 Exit Device Equipped With Delayed Egress Instructions 

Contents

- [1 PDQ 6300 Exit Device Equipped With Delayed Egress](#)
- [2 Product Information](#)
- [3 Product Usage Instructions](#)
- [4 OVERVIEW](#)
- [5 Box Contents](#)
- [6 DEFINITIONS](#)
- [7 INTERFACE](#)
- [8 WIRING EXAMPLE](#)
- [9 TROUBLESHOOTING](#)
- [10 ELECTRICAL SPECIFICATIONS](#)
- [11 CERTIFICATIONS](#)
- [12 FAQ](#)
- [13 Documents / Resources](#)
 - [13.1 References](#)

PDQ

PDQ 6300 Exit Device Equipped With Delayed Egress



Product Information

Specifications

- **Product:** Delayed Egress Exit Device for 6300/6400 Exits with DE Option
- **Manufacturer:** PDQ Locks
- **Power Supply:** Minimum 1 Amp at 24VDC (+/-10%) with fire alarm link required
- **Inhibit Contact:** Normally Open
- **Door Position Switch (DPS):** Normally Closed
- **Relay Contacts:** SPDT
- **Nuisance Delay Configurable:** Immediate, 1 second
- **Release Delay Configurable:** 15 seconds, 30 seconds
- **Rearm Delay Configurable:** Immediate, 1 second, 5 seconds, 15 seconds

Product Usage Instructions

- **Power Supply Wiring**

Connect the power supply to cut power to the DE device on activation of the fire alarm. Refer to the example wiring diagram in the manual for instructions on wiring using the PS220 power supply. Ensure a UL 294-rated power supply is used.

- **Inhibit Contact Usage**

Connect the Inhibit contact for free egress/ingress without alarming the device. Wire it to an access control system to allow entry/exit without alarm.

- **Door Position Switch (DPS)**

The DPS senses door opening. Ensure it is normally closed to arm the device. Bypass DPS by closing the circuit if not used.

- **Relay Contacts**

Optional SPDT relay contacts can be used to signal the security system when the device is armed.

- **Nuisance Delay and Release Delay**

Configure the Nuisance Delay and Release Delay timings according to your requirements. Nuisance Delay prevents accidental activations, while Release Delay controls the time before egress is allowed.

- **Rearm Delay**

Set the Rearm Delay time to control how long the device waits to re-arm after activation with the Key Switch or Inhibit Input.

OVERVIEW

- **Armed:** When armed, this device activates an internal blocking mechanism to prevent exiting the door from the inside until the proper release sequence has been completed.
- **Release Delay:** When an attempt is made to open the door from the inside, the device sounds an alarm and initiates a countdown.
- **Free Exit:** Upon completion of the Release Delay countdown, the device will release the push bar and allow free exit from the door until it is reset. An alarm will continue to sound until the device is reset.
- **Fire Contacts:** The power supply for this device must be connected to a fire alarm to cut power to the device, allowing immediate egress in the event of an emergency.

IMPORTANT

Local regulations and building codes may dictate specific requirements for the installation and usage of these devices.

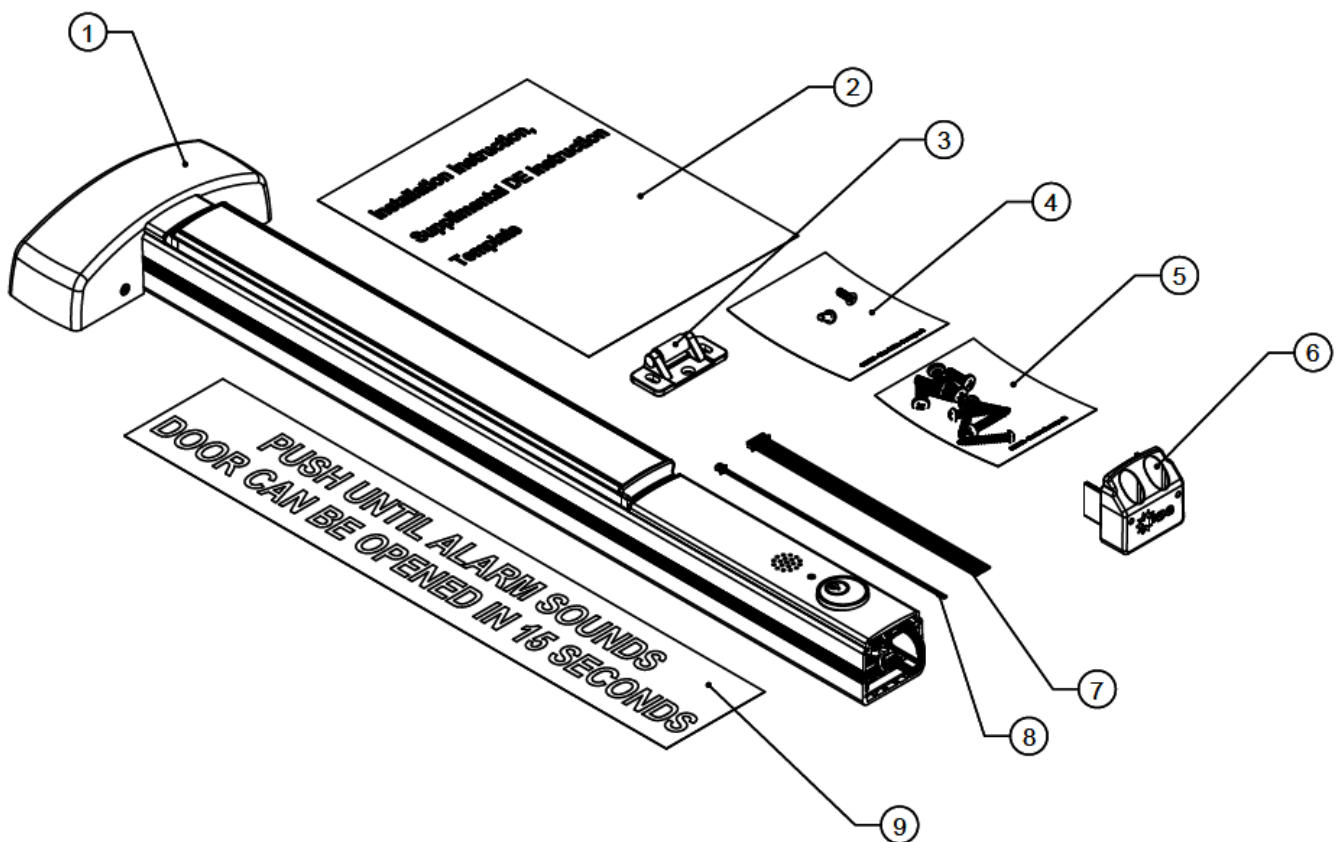

Box Contents

1. Exit device equipped with Delayed Egress
2. Installation Instruction, Delayed Egress Instruction, Door Template
3. Strike
4. Strike Screwpack
5. Device Screwpack
6. End Cap
7. 8 pin wiring harness with leads
8. 2 pin wiring harness with leads
9. Warning signage for door

DEFINITIONS

- **Fire Alarm – Power Supply**

Usage: Required by Code

Power supply must be wired to cut power to the DE device on activation of fire alarm. The example wiring diagram in this manual shows how device should be wired if using our PS220 power supply. A UL 294 rated power supply providing a minimum of 1 Amp at 24VDC (+/-10%) with fire alarm link is required.

- **Inhibit Contact**

Usage: Optional

Type: Normally Open

Contact closure allows free egress/ingress without sounding the alarm. After Inhibit completes, the system resets automatically when contact position conditions are satisfied (door position switch and optional latch monitor switch). Inhibit is usually wired to an access control system to allow entry from the outside or exit from the inside without alarming the device. When not used for Inhibit, this input can be used to reset a device in alarm.

- **Door Position Switch (DPS)**

Usage: Preferred

Type: Normally Closed

The Door Position Switch input senses door opening. If the door has been opened without using the Inhibit feature, the internal alarm will sound. The DPS contact must be closed to arm the device including after inhibit has been used. If not used, bypass DPS by closing circuit.

- **Relay Contacts**

Usage: Optional

Type: SPDT

Opens or closes contact upon system arming. Can be used to signal security system when device is armed. Relay contacts will change state when device alarms and during Inhibit.

- **Nuisance Delay**

Configurable: Immediate, 1 second

The Nuisance Delay starts from the first moment the push bar is pressed. If set to Immediate, the device will immediately begin the Release Delay. If set to 1 second, the device will sound a beep when pressed. If the device is released before 1 second it will return to the previous, armed state. If held for longer than 1 second the device will proceed to the Release Delay. This is useful in public areas where the device may be accidentally activated.

- **Release Delay**

Configurable: 15 seconds, 30 seconds

When the Release Delay is initiated, the push bar will remain locked and a warning beep will sound for the configured number of seconds (less any time already occupied by the Nuisance Delay). Once started, the Release Delay sequence cannot be stopped and the device will allow egress after the configured time has passed.

- **Rearm Delay**

Configurable: Immediate, 1 second, 5 seconds, 15 seconds

The time the device waits to arm following arming with the Key Switch or Inhibit Input. The device will arm when door closes (and DPS is satisfied) and the rearm delay has completed. Rearm delay can also be set to 15 seconds to allow door to close after Inhibit when DPS is not used.

INTERFACE

Key Switch

- The Key Switch Arms or Disarms the device.
- Turning the Key Switch counter-clockwise arms the device (following the Rearm Delay)
- Turning the Key Switch clockwise Disarms the device immediately

Status Indicator LED

- Armed – Solid Red LED
- Disarmed / Alarmed – Red LED is off
- Inhibit Active – Red LED is off

Internal Alarm

- Nuisance Delay Active – Short continuous beep
- Release Delay Initiated – Long continuous beep
- Alarming – Pulsing Beep

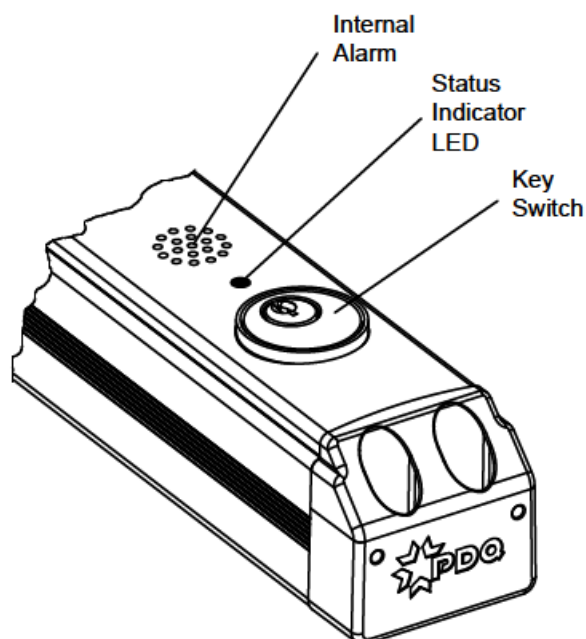

CONFIGURATION



CONFIGURATION

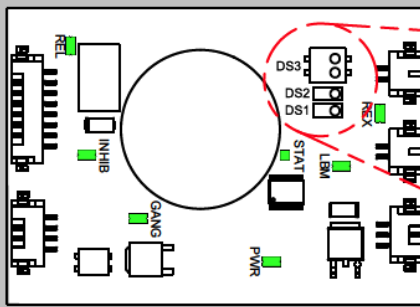

Factory Setting

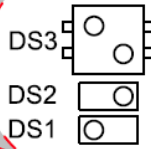

DS3 – Rearm Delay

- Immediate
- 1 Second
- 5 Seconds
- 15 Seconds

DS2 – Release Delay

- 15 Second Delay
- 30 Second Delay

DS1 - Nuisance Delay

- 1 Second Delay
- Immediate

WIRING EXAMPLE

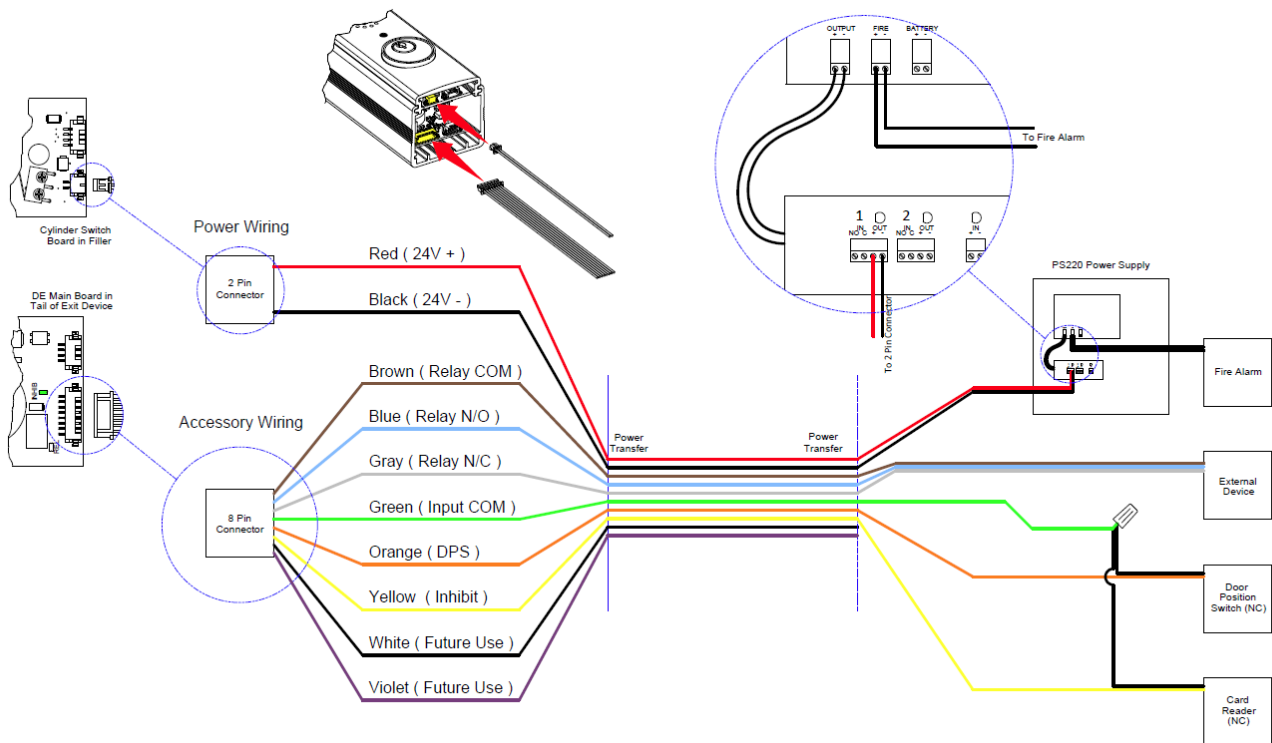

TROUBLESHOOTING

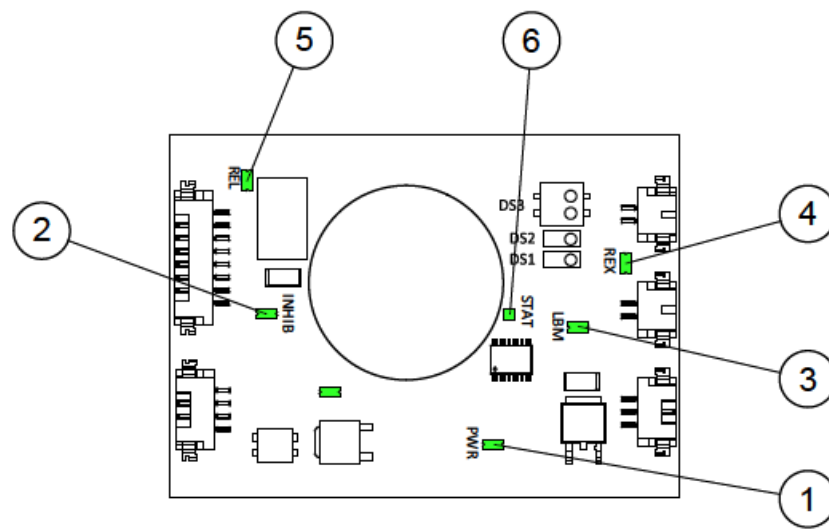

IMPORTANT

For device to arm, the following must be true: PWR, REX, LBM, STAT must be lit INHIB must not be lit

Description	Status	Troubleshooting
1 PWR	On = Power Present Off = No Power Present	Check power to key switch board Ensure key switch is in ON position Ensure fire alarm link is closed at the power supply Check all connections
2 INHIB	On = Inhibit Engaged Off = Inhibit not Engaged	Ensure circuit is a Normally Open and is in the open state Check all connections
3 LBM/DPS	On = Loop Closed Off = Loop Open	Ensure sure latch is extended Ensure Door Position Switch is Normally Closed and in closed state Check all connections
4 REX	On = Loop Closed Off = Loop Open	Make sure push pad is not depressed Check all connections
5 RELAY	On = Armed State Off = Not Armed	Check all connections
6 STAT	On = Armed Off = Not Armed	Power needs to be present, and all inputs need to be in their normal state (INHIB/REX/DPS/LBM) Check all connections

ELECTRICAL SPECIFICATIONS

Power Supply Requirements:

- UL 294 rated
- 1 Amp at 24VDC +/-10%
- Fire alarm link to cut power to DE device when active

Description	Color	Function	Specification	Wire Type and Distance
2 Pin Harness	Red	24VDC +	1 AMP Inrush, 250 mA holding	18 gauge up to 300'
	Black	24VDC -		
8 Pin Harness	Brown	Relay Common	Security Relay Output Common	22 gauge up to 98.5' for signal contacts 18 gauge up to 98.5' for power contacts Relay rated 1Amp @ 24VDC
	Blue	Relay NO	Security Relay Output Normally Open	
	Gray	Relay NC	Security Relay Output Normally Closed	
	Green	Input Common	Input Common Ground	22 gauge up to 500'
	Orange	Door Position Switch	Input DPS Normally Closed	
	Yellow	Inhibit	Input Inhibit Normally Open	
	White / Violet	Future Use		

CERTIFICATIONS

- Listed for UL305 “Panic”
- Listed for UL10C “Fire Exit Hardware” (for devices ordered with fire rating only)
- Listed for UL294 “Controlled Egress Equipment and Systems or Delayed Egress Equipment and Systems”, Access Control Endurance Level I
- Certified to ANSI/BHMA A156.3 Grade 1
- Meets International Building Code (IBC) for Delayed Egress and Controlled Egress Systems.
- Meets requirements of the BAA as a COTS product manufactured in the United States

FAQ

Q: Are there any specific requirements for the power supply?

A: Yes, a UL 294-rated power supply providing a minimum of 1 Amp at 24VDC (+/-10%) with fire alarm link is required.

Q: How does the Inhibit Contact work?

A: The Inhibit Contact allows free egress/ingress without sounding the alarm. It can be wired to an access control system for controlled entry/exit.

Q: Can the Nuisance Delay be customized?

A: Yes, the Nuisance Delay can be configured as Immediate or set to a 1-second delay.

Documents / Resources

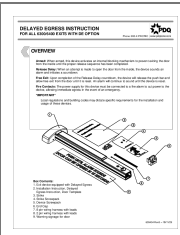
	<p>PDQ 6300 Exit Device Equipped With Delayed Egress [pdf] Instructions 6300, 6400, 6300 Exit Device Equipped With Delayed Egress, 6300, Exit Device Equipped With Delayed Egress, Equipped With Delayed Egress, With Delayed Egress, Delayed Egress, Egress</p>
---	---

References

- [User Manual](#)

This website is an independent publication and is neither affiliated with nor endorsed by any of the trademark owners. The "Bluetooth®" word mark and logos are registered trademarks owned by Bluetooth SIG, Inc. The "Wi-Fi®" word mark and logos are registered trademarks owned by the Wi-Fi Alliance. Any use of these marks on this website does not imply any affiliation with or endorsement.