



## PDQ Locks 6400 Rail Filler Exit Device Instruction Manual

[Home](#) » [PDQ Locks](#) » PDQ Locks 6400 Rail Filler Exit Device Instruction Manual 

### Contents

- 1 [PDQ Locks 6400 Rail Filler Exit Device](#)
- 2 [6300/6400 RAIL FILLER INSTALLATION ALL DEVICES](#)
- 3 [Documents / Resources](#)
  - 3.1 [References](#)
- 4 [Related Posts](#)



**PDQ Locks 6400 Rail Filler Exit Device**



## 6300/6400 RAIL FILLER INSTALLATION ALL DEVICES

### 1. INSERT FILLER CAP /RETAINER

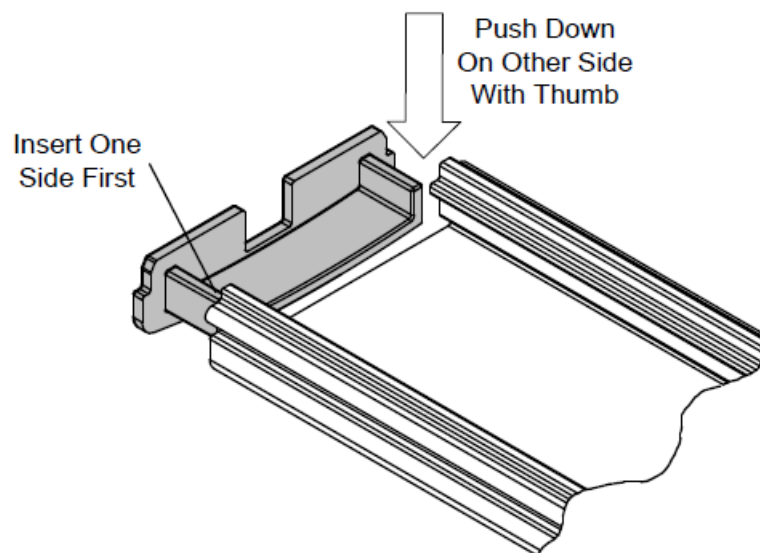

- Insert one corner of Filler Cap into extrusion
- Filler cap is curved/spring-loaded and will not insert without pushing down on other side.
- Once both leading corners are engaged, push or tap cap into extrusion.

### 2. START FILLER

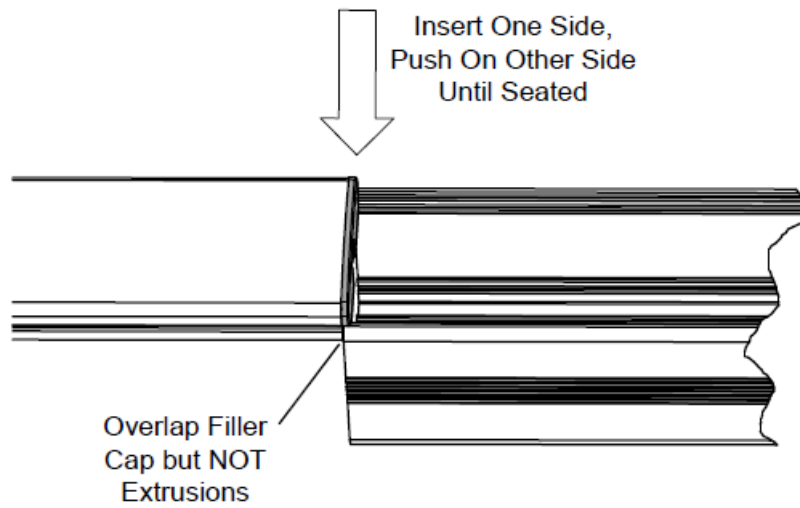

- Overlap plastic Filler Cap onto main rail extrusion being careful not to overlap extrusions.
- Put one side of filler down into extrusion.
- Push or tap other side to snap into place so filler will fit and slide into place.

### 3. SLIDE FILLER INTO PLACE

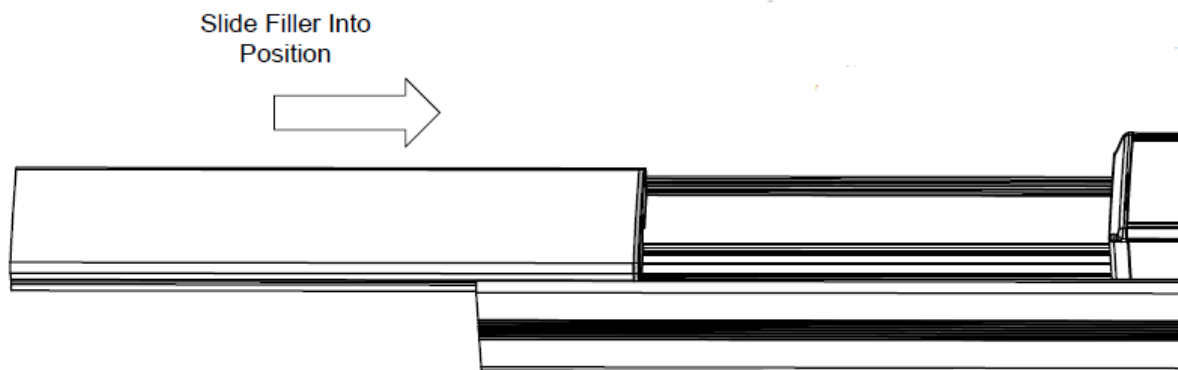

- Slide filler and filler cap into place –proper position is flush with end of main rail.

## Documents / Resources

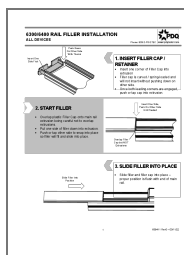

[PDQ Locks 6400 Rail Filler Exit Device](#) [pdf] Instruction Manual  
6400, Rail Filler, Exit Device, Rail Filler Exit Device, 6400 Rail Filler, 6400 Rail Filler Exit Device , 6300

## References

- [pdqlocks.com](https://pdqlocks.com)