



PCE-DFG N Instruments Force Gauge User Manual

[Home](#) » [PCE](#) » PCE-DFG N Instruments Force Gauge User Manual 

Contents

- [1 PCE-DFG N Instruments Force Gauge](#)
- [2 Safety notes](#)
- [3 Specifications](#)
 - [3.1 Technical specifications](#)
 - [3.2 Delivery contents](#)
 - [3.3 Optional accessories](#)
- [4 System description](#)
 - [4.1 Device](#)
 - [4.2 Interfaces](#)
 - [4.3 Display](#)
 - [4.4 Function keys](#)
- [5 Getting started](#)
 - [5.1 Power supply](#)
 - [5.2 Settings](#)
- [6 Operation](#)
 - [6.1 Measurement](#)
- [7 Maintenance](#)
 - [7.1 Storage](#)
- [8 Appendix: load cell \(1 ... 100 kN\)](#)
- [9 Warranty](#)
- [10 Disposal](#)
- [11 Disposal](#)
- [12 PCE Instruments contact information](#)
- [13 Documents / Resources](#)
 - [13.1 References](#)
- [14 Related Posts](#)



PCE-DFG N Instruments Force Gauge



Safety notes

Please read this manual carefully and completely before you use the device for the first time. The device may only be used by qualified personnel and repaired by PCE Instruments personnel. Damage or injuries caused by non-observance of the manual are excluded from our liability and not covered by our warranty.

- The device must only be used as described in this instruction manual. If used otherwise, this can cause dangerous situations for the user and damage to the meter.
- The instrument may only be used if the environmental conditions (temperature, relative humidity, ...) are within the ranges stated in the technical specifications. Do not expose the device to extreme temperatures, direct sunlight, extreme humidity or moisture.
- The case should only be opened by qualified PCE Instruments personnel.
- Never use the instrument when your hands are wet.
- You must not make any technical changes to the device.
- The appliance should only be cleaned with a damp cloth. Use only pH-neutral cleaner, no abrasives or solvents.
- The device must only be used with accessories from PCE Instruments or equivalent.

- Before each use, inspect the case for visible damage. If any damage is visible, do not use the device.
- Do not use the instrument in explosive atmospheres.
- **ATTENTION:** For impact tests, the maximum measurable value of the force gauge should be twice as high as the applied impact load.
- When doing impact tests, wear a mask and protective gloves to avoid injuries.
- Do not use the test stand when it is bent or damaged. Dropping can cause injuries.
- This device only measures tensile and compressive forces. The test head must not be bent or twisted.
- Overloading, excessive impact loads or applied forces other than tensile and compressive forces can cause damage to the sensor.
- Do not press the keys with pointed objects.
- Keep the force gauge away from water, oil and other liquids.
- Store the meter in a cool, dry place without any occurrence of vibration.
- Wire the ports as described in this manual. Non-observance of the instructions can cause circuit failure or problems with your computer.
- Make sure that the mains adaptor is securely connected to the power outlet as otherwise short circuits and thus electric shocks and fire can occur.
- When the battery is fully charged, remove the mains adaptor immediately to avoid overheating, fire or accidents.
- Non-observance of the safety notes can cause damage to the device and injuries to the user.



We do not assume liability for printing errors or any other mistakes in this manual.

We expressly point to our general guarantee terms which can be found in our general terms of business.

If you have any questions please contact PCE Instruments. The contact details can be found at the end of this manual.

Safety symbols

Safety-related instructions the non-observance of which can cause damage to the device or personal injury carry a safety symbol.

Symbol	Designation / description
	General warning sign Non-observance can cause damage to the device and injuries to the user.
	Warning: electrical voltage Non-observance can cause electric shock.

Specifications

Technical specifications

Force gauge with internal dynamometric cell

Specification	Value / version				
Model	PCE-DFG N 5	PCE-DFG N 10	PCE-DFG N 20	PCE-DFG N 200	PCE-DFG N 500
Range	0 ... 5 N	0 ... 10 N	0 ... 20 N	0...200 N	0...500 N
Resolution	0.001 N	0.002 N	0.005 N	0.01 N	0.05 N
Accuracy					
Dimensions	200 x 97 x 42 mm				
Weight	approx. 540g				

Force gauge with external dynamometric cell

Specific ation	Value / version			
Model	PCE-DFG N 1K	PCE-DFG N 2,5K	PCE-DFG N 5K	PCE-DFG N 10K
Range	1,000 N / 100 kg	2,500 N / 250 kg	5,000 N / 500 kg	10,000 N / 1 t
Resoluti on	0.5 N	1 N	1 N	0.001 kN / 1 N
Accurac y	0,1 % F.S.			
Units	N, kg, lb, KPa			
Model	PCE-DFG N 20K	PCE-DFG N 50K		PCE-DFG N 100K
Range	20,000 N / 2t	50,000 N / 5 t		100,000 N / 10 t
Resoluti on	0.002 kN / 2 N	0.005 kN / 5 N		0.01 kN / 10 N
Accurac y	0,2 % F.S.			
Units	kN, t, klb, MPa			

Further versions on request

Specification	Value
Cell protection class	IP 67
Device dimensions	162 x 82 x 41 mm
Device weight	325 g
Display	2.8" TFT graphical display
Alarm modes	within, beyond, fracture, off
Sampling rate	6 ... 1600 Hz device 6...800 Hz software
Memory	100 measurements
Power supply	Ni-Hi rechargeable battery 6 V, 1600 mAh Battery life 10 hours
Mains adaptor	12 VDC 1 A;
Outputs	Communication via USB Output port 12 V, 50 mA
Operating conditions	-10 ... +50 °C; 5 ... 95 % RH, non-condensing
Protection class	IP 54

General specifications

Delivery contents

- Version with internal cell:
- 1 x force gauge PCE-DFG N
- 5 x test head adaptors (pointed head adaptor, notched head adaptor, chisel head adaptor, flat head adaptor, hook adaptor)
- 1 x extension rod incl. adaptor
- 1 x USB cable
- 1 x mains adaptor
- 1 x software
- 1 x user manual

Version with external cell:

- 1 x force gauge PCE-DFG N
- 1 x dynamometric cell
- 2 x eyebolt (only up to 10 kN load cell) 1 x case for the meter
- 1 x case for the dynamometric cell
- 1 x USB cable
- 1 x mains adaptor

- 1 x software
- 1 x user manual

Optional accessories

- PCE-C-S-1000N-C3 load cell 1,000 N / 100 kg / M10
- PCE-C-S-2500N-C3 load cell 2,500 N / 250 kg / M12
- PCE-C-S-5000N-C3 load cell 5,000 N / 500 kg / M12
- PCE-C-S-10000N-C3 load cell 10,000 N / 1 t / M12
- PCE-C-S-20KN-C3 load cell 20.000 N / 2 t / M20
- PCE-C-S-50KN-C3 load cell 50.000 N / 5 t / M20
- PCE-C-S-100KN-C3 load cell 100.000 N / 10 t / M30
- PCE-C-A-1000N-EB eyebolt M10 1,000 N (set: 2 pieces)
- PCE-C-A-2500N-EB eyebolt M12 2,500 N (set: 2 pieces)
- PCE-C-A-5000N-EB eyebolt M12 5,000 N (set: 2 pieces)
- PCE-C-A-10000N-EB eyebolt M12 10,000 N (set: 2 pieces)
- PCE-C-A-60KN-EB eyebolt M20 / 60.000 N / 6 t (set: 2 pieces)
- PCE-C-A-120KN-EB eyebolt M30 / 120.000 N / 12 t (set: 2 pieces)
- PCE-C-A-1000N-RE eyebolt with joint head M10 1,000 N (set: 2 pieces)
- PCE-C-A-10000N-RE eyebolt with joint head M12 10,000 N (set: 2 pieces)
- PCE-C-A-1000N-HB clip bolt M10 1,000 N (set: 2 pieces)
- PCE-C-A-2500N-HB clip bolt M12 2,500 N (set: 2 pieces)
- PCE-C-A-5000N-HB clip bolt M12 5,000 N (set: 2 pieces)
- PCE-C-A-10000N-HB clip bolt M12 10,000 N (set: 2 pieces)
- CAL-PCE-DFG N calibration certificate

Further accessories on request

System description

Device

Version with internal dynamometric cell



1. Measuring shaft
2. Display
3. Keypad
4. Extension rod
5. Chisel head adaptor
6. Pointed head adaptor
7. Hook adaptor
8. Notched head adaptor
9. Flat head adaptor
10. Adaptor for extension rod

Interfaces



1. Input / output interface
2. USB interface
3. Power connection

Circuit diagram of output port

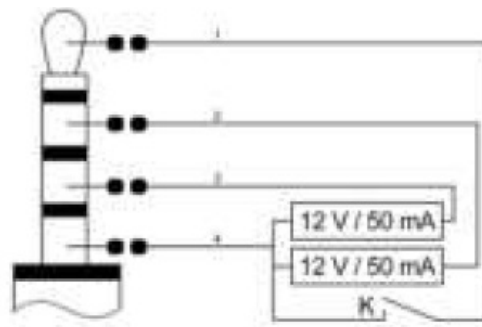

1. Switch of external input / output
2. Output lower limit
3. Output upper limit
4. GND





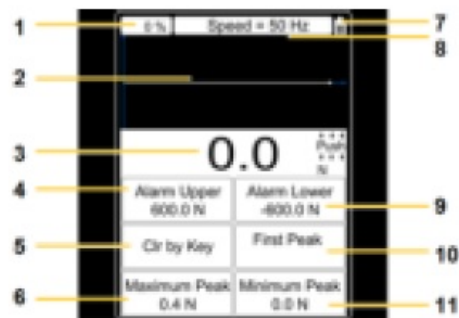



Display

In measurement mode



1. memory usage
2. measurement curve
3. force value
4. upper alarm value
5. clear by key
6. maximum peak
7. battery level indicator
8. sampling rate
9. lower alarm value
10. first peak
11. minimum peak

Function keys

Key	Designation	Function				
		Single measurement mode	Capture mode	Online measurement mode	Memory and query mode	Menu mode
	On / Off	Switch off	–	Switch off	–	–
	Back	–	Close capture mode	–	Exit	Exit / close parameter settings
	Zero	Zero setting	–	Zero setting	–	–
	Up	–	–	–	Up	Up
	Down	Activate memory and query mode	–	–	Switch to upper window	Down
	OK	Open parameter settings	Stop capturing	–	Show report and reading	Confirm parameter setting
	Left	Start curve capturing	–	Start curve capturing	Move flashing number left by one digit	
	Right	Delete peak value	–	Delete peak value	Move flashing number right by one digit	

Getting started

Power supply

The PCE-DFG N is equipped with a rechargeable 1600 mAh 6 V Ni-Hi battery that should only be charged by means of the mains adaptor which is included in the standard delivery.

Charging can take 8 to 10 hours and should only be started when the battery is completely flat. Excessively frequent or long-time charging shortens the battery life.

When the battery is fully charged, it will last up to 10 hours of continuous use. The device can also be used during charging. The battery can be charged approx. 500 times.

Settings

When you are in measurement mode, press the OK key to enter the settings screen which is divided into 2 pages:

Page 1



Page 2



In order to change settings, select the menu item with the arrow keys and confirm with the OK key. The values can then be changed by means of the arrow keys. Then press “OK” to confirm the settings or the Back key to discard.

Function	Description page 1
<i>Display Unit</i>	The display unit can be set to: „N“, „kg“, „lb“ or „KPa“
<i>Force Area</i>	The force area can be set to a value between 999.99cm ² and 0.01cm ² and is included in the calculation if the display unit selected is „kPa“ (important for the accuracy).
<i>Zero Tracking</i>	<p>For zero tracking, you can set:</p> <p>„Off“, „0.1 N“, „0.2 N“, „0.3 N“, „0.4 N“, „0.5 N“</p> <p>Values below the value set are automatically excluded before the zero point stabilises. After stabilisation of the reading, the sampling rate will be 1 x per second. Deviations from the measured value which are</p> <p>below the set value are automatically excluded in order to keep the displayed values.</p>

<i>Sampling Speed</i>	<p>You can set how many measurements are taken per second. A value between 6 and 1600 Hz can be set here.</p> <p>Note: The higher the sampling rate, the lower the accuracy will be. Higher sampling rates are suitable for dynamic measurements whereas lower sampling rates are more suitable for static and slow measurements.</p>
<i>Calibrate Grav</i>	Enter the gravity at the place of calibration.
<i>Alarm Upper</i>	The upper alarm can be set to +/- 9999.9.
<i>Alarm Mode</i>	You can choose "Within" (within alarm limit), "Beyond" (outside alarm limit), "Fracture" (overload alarm) or "Off".

	<p>If you select "Within" or "Beyond", the display will show information on the alarm.</p> <p>If you select "Fracture", Alarm Upper LV and Alarm Lower LV will automatically be set to "Fracture Alarm" and „Fracture Stop of Peak“. Set these two parameters. When the force reaches the fracture alarm value or when the sample breaks, the display will show some information on the alarm.</p>
<i>Peak V. Hold</i>	You can select „On“ or “Off“. If “Off” is selected, the peak value will not be indicated in the display.
<i>Factory Set A</i>	Only relevant for customer service.
<i>Factory Set B</i>	Only relevant for customer service.

<i>Factory Set C</i>	Only relevant for customer service.
<i>Calibrate</i>	<p>Press OK to start the calibration. The calibration result will have a considerable influence on the accuracy of measurement. There are two possibilities to calibrate the meter:</p> <ol style="list-style-type: none"> 1. Entering saved data: The user enters the saved calibration data. The calibration is done without any other devices or weights. 2. Standard calibration: The force gauge is calibrated by means of the calibration stand or calibration weight.
<i>User Gravity</i>	<p>Here, you can set the gravity at the place of use. The value can be between 9.700 and 9.900 N/kg. This parameter is used for the gravity correction. The following formula must be used for this:</p> $\text{Displayed value} = \text{reading} + \text{reading} \times (\text{gravitation place of calibration} - \text{gravitation place of use})$
<i>Alarm Lower</i>	The lower alarm can be set to +/- 9999.9.
<i>External Input</i>	<p>You can select "On" or "Off". If "On" is selected, the external switch can be switched on and the force gauge enters curve capture mode.</p> <p>Note: The capturing duration depends on the sampling rate. Capturing duration in seconds = number of recorded data / sampling rate</p>
<i>Peak Hold Time</i>	<p>You can select "Clr by Key" or certain periods between 1 and 60 seconds. If "Clr by Key" is selected, the peak value will not be changed until the "Arrow Right key or the "Zero Set" button is applied. If a period between 1 and 60 seconds is selected, the peak value will automatically be measured again after the set time has passed. The peak value can also be re-measured by applying the "Arrow Right key or the "Zero Set" button.</p>

Function	Description page 2
<i>Capture Length</i>	<p>You can set a value between 1 and 1280 seconds. This value represents the duration of curve capturing in capture mode which depends on the sampling rate:</p> <p>Sampling rate 6 Hz: 1 ~ 1280 seconds</p> <p>Sampling rate 12 Hz: 1 ~ 640 seconds</p> <p>Sampling rate 25 Hz: 1 ~ 320 seconds</p> <p>Sampling rate 50 Hz: 1 ~ 160 seconds</p> <p>Sampling rate 100 Hz: 1 ~ 80 seconds</p> <p>Sampling rate 200 Hz: 1 ~ 40 seconds</p> <p>Sampling rate 400 Hz: 1 ~ 20 seconds</p> <p>Sampling rate 800 Hz: 1 ~ 10 seconds</p> <p>Sampling rate 1600 Hz: 1 ~ 5 seconds</p>
<i>F/P Boundary</i>	<p>You can set a value between 1 and 99999. This setting is used during peak value measurement to determine the first peak value. When you press the Arrow Right key, a new peak value measurement will start. Meanwhile, the values peak-to-peak (Vmax), valley-to-peak (Vmin) and new peak (Vnew) are updated continuously. For example, if 10 is set as the criterion, Vmax or Vmin will be counted as the first peak value when the absolute value of (Vmax – Vnew) or (Vmin – Vnew) is above 10.</p>

<p><i>Serial Por</i></p>	<p>This port is used to control the real-time data transfer. The following parameters can be set:</p> <p>Prohibit: The real-time data transfer of the serial interface is prohibited.</p> <p>Key/Order: A single output will take place when you press the Up key or when an output command is received. When the force gauge is connected to a computer, the programmes on the computer will automatically disable the output function.</p> <p>Change: A single output will take place when the measuring data change.</p> <p>Stabilize: A single output will take place when the reading stabilises. Consecutive: The measuring data are transferred without interruption.</p>
<p>Auto Power Off</p>	<p>This function reduces the energy consumption. The force gauge will automatically power off when it has not been used for a certain period of time.</p>
<p><i>Max Charge V</i></p>	<p>This window shows the maximum voltage of the battery.</p>
<p><i>Clear Storage</i></p>	<p>Here, you can delete saved measurement reports and curves.</p> <p>Important information:</p> <p>When the memory is full, all data will automatically be deleted to enable new data to be saved.</p>
<p><i>Factory Test</i></p>	<p>Only relevant for customer service.</p>

S/N	This window shows the serial number of the device which cannot be changed.
<i>Capture Trigger</i>	Here, you can set a value between -99999 and +99999. The range of values depends on the set unit. This parameter stipulates the

	condition that triggers the capturing when the force gauge is in curve capture mode. When the maximum number of data has been recorded or capturing was discontinued early, a capture report is created and saved. The curve is deleted when you leave capture mode.
Baud Rate	<p>The baud rate for the serial interface can be set to a value between 4800 and 230400 bps.</p> <p>This setting will only be effective after restarting the force gauge.</p> <p>Note: To make sure that all data are retrieved when the device is connected to a computer, the baud rate should be set as follows:</p> <p>12 Hz: ≥ 9600 bps 25 Hz: ≥ 14400 bps</p> <p>50 Hz: ≥ 19200 bps</p> <p>100 Hz: ≥ 28800 bps</p> <p>200 Hz: ≥ 38400 bps</p> <p>400 Hz: ≥ 57600 bps</p> <p>800 Hz: ≥ 115200 bps</p> <p>1600 Hz: ≥ 230400 bps</p> <p>Due to the limited speed of serial interfaces, some data get lost when transferred to a PC if the sampling rate is higher than 800 Hz. The readings will, however, not get lost in the device.</p>
<i>Display Angle</i>	Here, you can set the display angle. You can select 0 or 180 °.
<i>Auto Backlight</i>	This function also reduces the energy consumption. The brightness of the display backlight will automatically be turned off when the meter has not been used for a certain period of time.

<i>Now Voltage</i>	This window shows the current battery level.
<i>Reset</i>	You can reset the device to factory default settings, e. g. if you have made an incorrect setting or if other problems with the settings occurred.
<i>Language</i>	In this window, you can change the output language. English or German can be selected.
<i>Connection</i>	In this window, you can see the circuit diagram of the input port (see chapter 3.2).

Operation

Measurement

Edition with internal sensor:

After making the settings, you can start a measurement. To do so, you first need to attach the suitable adaptor. If required, you can also use the extension rod. Do not apply too much force when attaching the adaptor and / or the extension rod to avoid damage to the sensor.

Edition with external sensor:

Connect the sensor to the force gauge. Then attach the suitable adaptor to the sensor without applying too much force as this can damage the sensor.

Switch on the device by pressing the On / Off key. You are now in the measurement window. Start by checking the battery level in the upper right corner. If the battery level is low, charge the device using the mains adaptor that comes with the device. For charging, it does not matter if the device is switched on or off. It is possible to make measurements during charging. When the device is fully charged, a notification will appear on the display. You should then disconnect the device from the power supply immediately.

You can now set the parameters. Press “OK” when you are in measurement mode to enter the settings window. Set the unit, the force area, zero tracking, the sampling speed, fracture alarm, the upper and lower limit alarm, the Peak Hold function, the capture trigger as well as the capture length (duration). Press the Back key to return to measurement mode.

To start your measurement, attach the device to a suitable test stand. Press the Zero key and the Arrow Right key. You can now take a direct measurement or capture a curve. If you make a direct measurement, the force will be measured in real time, as well as the peak values and further parameters. These will not be saved. The previously measured values will be lost when a new measurement is taken. If you want to capture a curve, enter capture mode by pressing the “Arrow Left” key when you are in measurement mode. The measurement will start automatically as soon as the trigger condition is met. The measurement ends if you press “OK” or when the set capture duration has been reached. The measurement will return peak values, measurement curves and further parameters.

These will be saved. Only one curve with the associated values can be saved. You can retrieve the saved data by pressing the “Query” button. The curve will be deleted when the force gauge is restarted or when a new measurement is taken. A maximum of 100 reports can be saved if no curve is saved. These can also be retrieved by pressing the “Query” button.

Press the Back key to get back to the measurement window. To switch off the device, press the On/Off key. Remove the sensor if you have a device with an external sensor and clean the force gauge. It is recommended to store the device in its original carrying case.

Maintenance

Storage

Please charge the battery before storing the meter for a longer period of time and store the device as well as, if applicable, the external sensors and the accessories in the packaging / carrying case the PCE-DFG N comes with to protect the technical components.

Appendix: load cell (1 ... 100 kN)

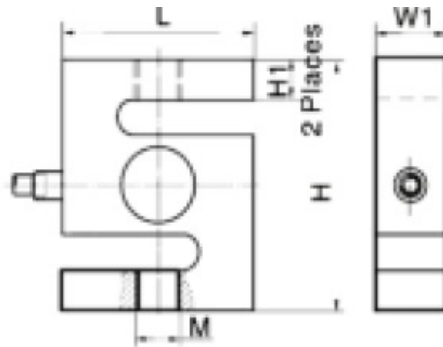

	L [mm]	H [mm]	W1[mm]	H1 [mm]	M [mm]
1 kN	50,8	76,2	20,8	15,3	M10 x 1,5
2,5 ... 5 kN	20,8	76,2	20,8	13,6	M12 x 1,75
10 kN	50,8	76,2	27,2	12,1	M12 x 1,75
20 ... 50 kN	76,2	101,6	27,2	20	M20 x 1,5
100 kN	112,78	177,8	42,93	—	M30 x 2

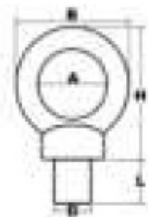

	A [mm]	B [mm]	H [mm]	L [mm]	D [mm]	Max	Weight
1 kN	24	45	45	20	M10	0,25 t	110 g
2,5 kN	29	53	53	22	M12	0,4 t	175 g
5 kN	35	62	63	22	M12	0,7 t	260 g
10 kN	39	71	73	22	M12	1 t	395 g
20 kN ... 50kN	40	72	71	30	M20	6 t	450 g
100 kN	60	108	109	45	M30	12 t	1700 g

Warranty

You can read our warranty terms in our General Business Terms which you can find here: <https://www.pce-instruments.com/english/terms>.

Disposal

For the disposal of batteries in the EU, the 2006/66/EC directive of the European Parliament applies. Due to the contained pollutants, batteries must not be disposed of as household waste. They must be given to collection points designed for that purpose.

In order to comply with the EU directive 2012/19/EU we take our devices back. We either re-use them or give them to a recycling company which disposes of the devices in line with law.

For countries outside the EU, batteries and devices should be disposed of in accordance with your local waste regulations.

If you have any questions, please contact PCE Instruments.

Disposal

For the disposal of batteries in the EU, the 2006/66/EC directive of the European Parliament applies. Due to the contained pollutants, batteries must not be disposed of as household waste. They must be given to collection points designed for that purpose.

In order to comply with the EU directive 2012/19/EU we take our devices back. We either re-use them or give them to a recycling company which disposes of the devices in line with law.

For countries outside the EU, batteries and devices should be disposed of in accordance with your local waste regulations.

If you have any questions, please contact PCE Instruments.

PCE Instruments contact information

Germany

PCE Deutschland GmbH

Im Langel 4

D-59872 Meschede

Deutschland

Tel.: +49 (0) 2903 976 99 0

Fax: +49 (0) 2903 976 99 29

info@pce-instruments.com

www.pce-instruments.com/deutsch

United Kingdom

PCE Instruments UK Ltd

Unit 11 Southpoint Business Park Ensign Way, Southampton Hampshire

United Kingdom, SO31 4RF

Tel: +44 (0) 2380 98703 0

Fax: +44 (0) 2380 98703 9

info@pce-instruments.co.uk

www.pce-instruments.com/english

The Netherlands

PCE Brookhuis B.V. Institutenweg 15

7521 PH Enschede

Nederland

Telefoon: +31 (0)53 737 01 92 info@pcebenelux.nl

www.pce-instruments.com/dutch

France

PCE Instruments France EURL 23, rue de Strasbourg

67250 Soultz-Sous-Forêts
France
Téléphone: +33 (0) 972 3537 17
Numéro de fax: +33 (0) 972 3537 18
info@pce-france.fr
www.pce-instruments.com/french

Italy

PCE Italia s.r.l.
Via Pesciatina 878 / B-Interno 6 55010 Loc. Gragnano
Capannori (Lucca)
Italia
Telefono: +39 0583 975 114
Fax: +39 0583 974 824
info@pce-italia.it
www.pce-instruments.com/italiano

Hong Kong

PCE Instruments HK Ltd.
Unit J, 21/F., COS Centre
56 Tsun Yip Street
Kwun Tong
Kowloon, Hong Kong
Tel: +852-301-84912
jiyi@pce-instruments.com
www.pce-instruments.cn

Spain

PCE Ibérica S.L.
Calle Mayor, 53
02500 Tobarra (Albacete)
España
Tel. : +34 967 543 548
Fax: +34 967 543 542
info@pce-iberica.es
www.pce-instruments.com/espanol

Turkey

PCE Teknik Cihazları Ltd.Şti. Halkalı Merkez Mah.
Pehlivan Sok. No.6/C
34303 Küçükçekmece – İstanbul Türkiye
Tel: 0212 471 11 47
Faks: 0212 705 53 93
info@pce-cihazlari.com.tr
www.pce-instruments.com/turkish

United States of America

PCE Americas Inc.
1201 Jupiter Park Drive, Suite 8 Jupiter / Palm Beach
33458 FL

USA

Tel: +1 (561) 320-9162
Fax: +1 (561) 320-9176
info@pce-americas.com

User manuals in various languages

(français, italiano, español, português, nederlands, türk, polski, русский,)

can be downloaded here: www.pce-instruments.com

Specifications are subject to change without notice.

© PCE Instruments

Documents / Resources

	<p>PCE PCE-DFG N Instruments Force Gauge [pdf] User Manual PCE-DFG N, Instruments Force Gauge, Force Gauge, Instruments Gauge, Gauge, PCE-DFG N Force Gauge</p>
---	--

References

- [France.fr : Actualités, destinations et infos du tourisme en France](#)
- [iberica.es](#)
- [Make an offer on the domain instruments.co.uk - Domains.co.uk](#)
- [Computer Instruments | Home](#)
- [Discover Italy: Official Tourism Website - Italia.it](#)
- [PCEİ¼âCE—äº¬İ¼%ç\\$'æŠæœ%é™â...¬â](#)
- [Industrial Measurement Products and Solutions | PCE Instruments](#)
- [PCE Deutschland GmbH Prüfgeräte vom Hersteller | PCE Instruments](#)
- [PCE Brookhuis B.V. | PCE Instruments](#)
- [PCE Americas Inc. : Test Instruments | PCE Instruments](#)
- [PCE Iberica S.L. Instrumentación | PCE Instruments](#)
- [PCE Instruments France | PCE Instruments](#)
- [PCE Italia s.r.l. / Strumenti di Misura | PCE Instruments](#)
- [PCE Teknik Cihazlar Paz. Tic. Ltd.Şti. | PCE Instruments](#)
- [PCE Deutschland GmbH Prüfgeräte vom Hersteller | PCE Instruments](#)
- [PCE Americas Inc. : Test Instruments | PCE Instruments](#)