

Paxton INS-20006-ZA Access Control Unit Instructions

[Home](#) » [Paxton](#) » Paxton INS-20006-ZA Access Control Unit Instructions 

Contents

- [1 Paxton INS-20006-ZA Access Control Unit](#)
- [2 Instructions](#)
- [3 Overview](#)
- [4 Battery Instruction](#)
- [5 Specifications](#)
- [6 Contact Us](#)
- [7 Product Compliance and limitations](#)
- [8 Documents / Resources](#)
 - [8.1 References](#)
- [9 Related Posts](#)



Paxton INS-20006-ZA Access Control Unit

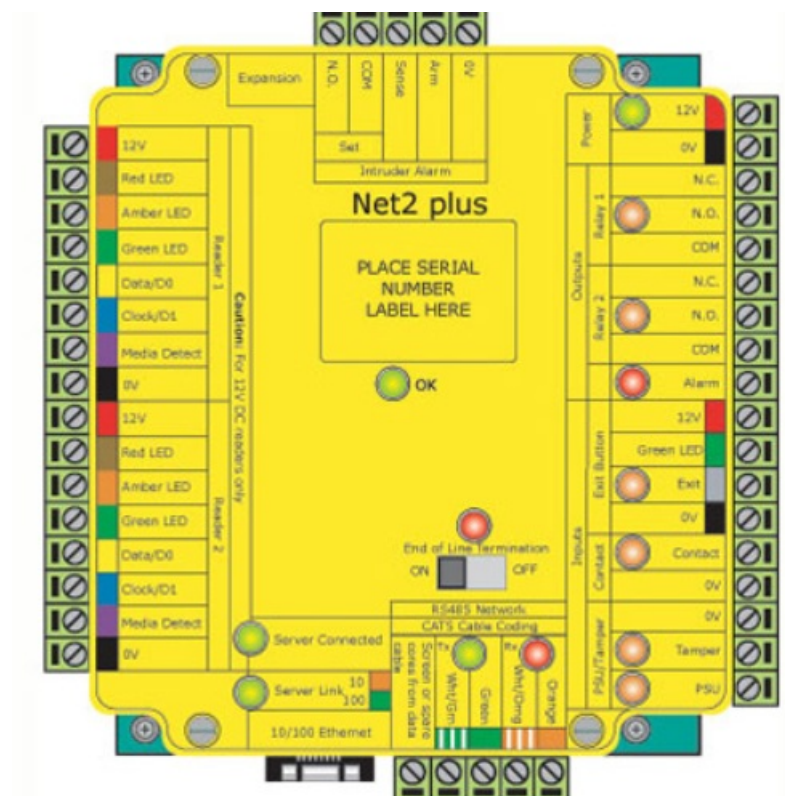

Instructions

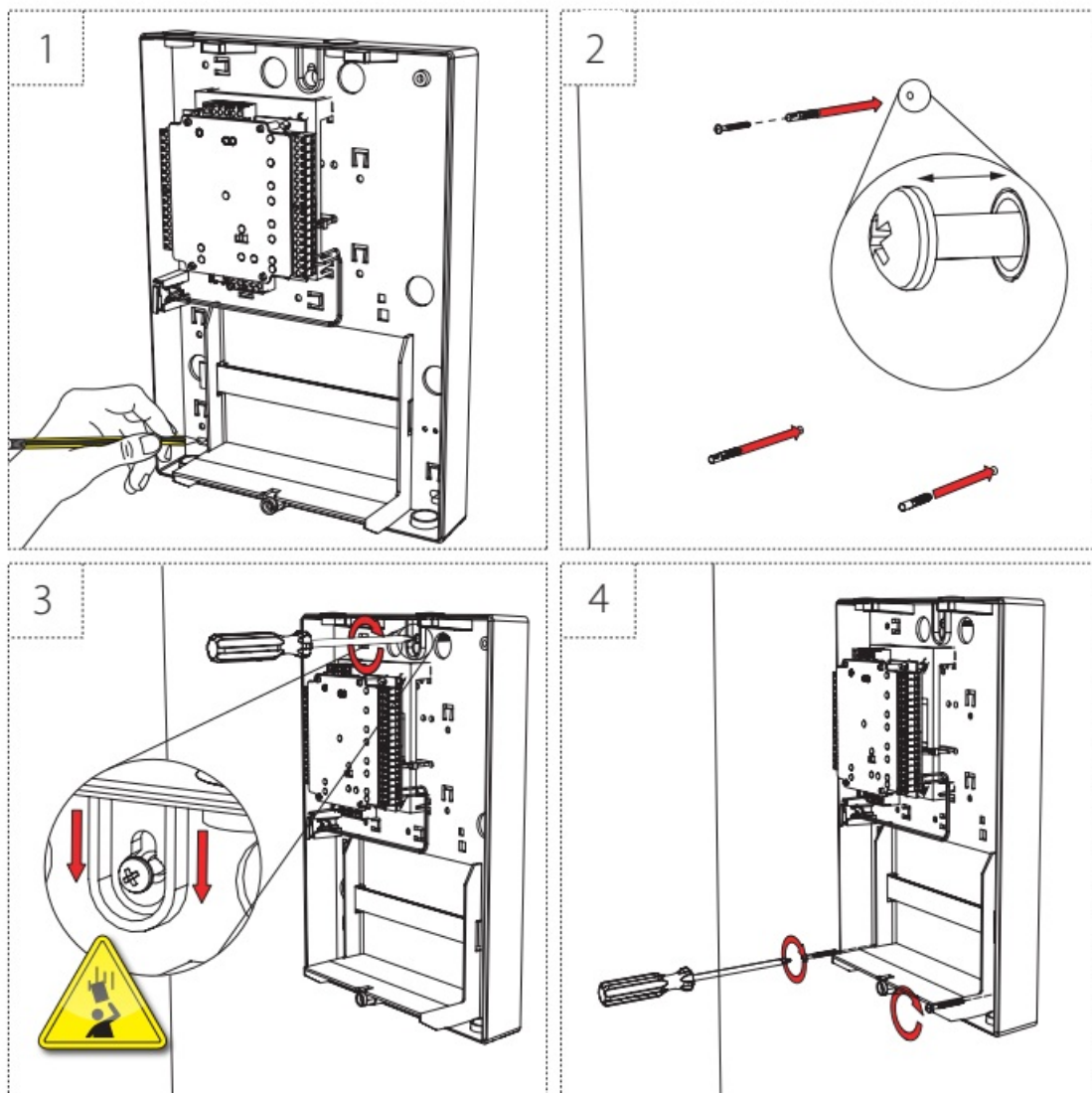

Overview

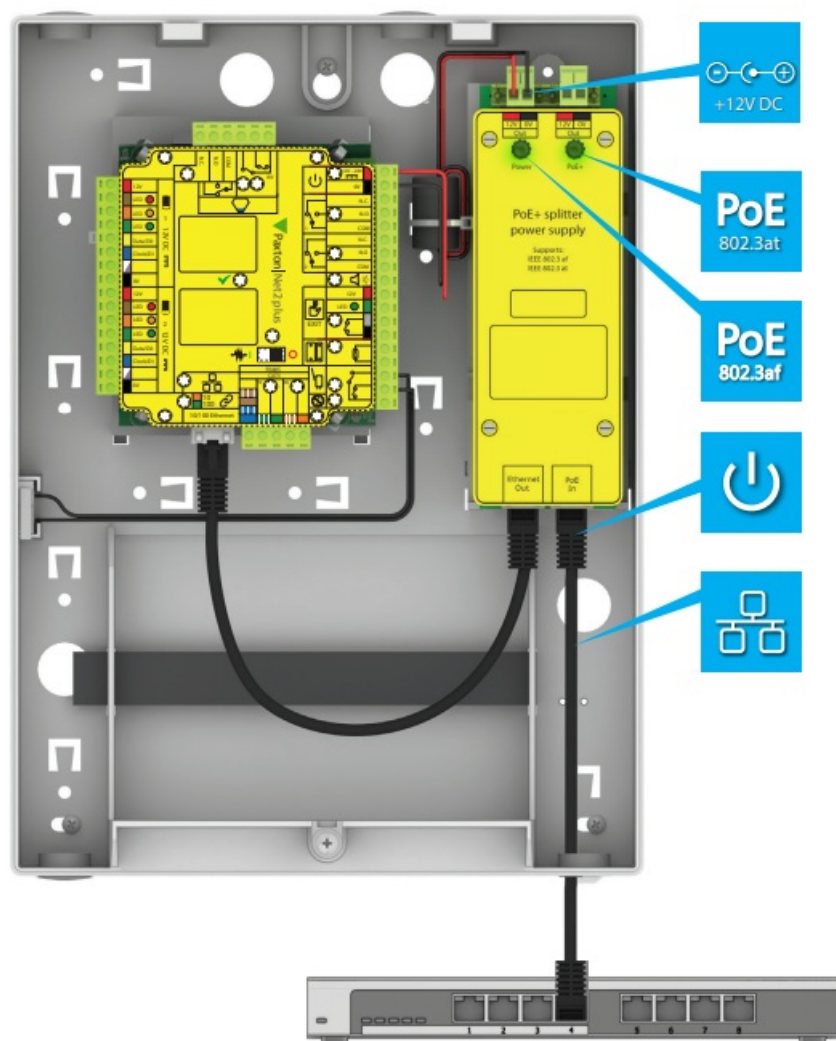

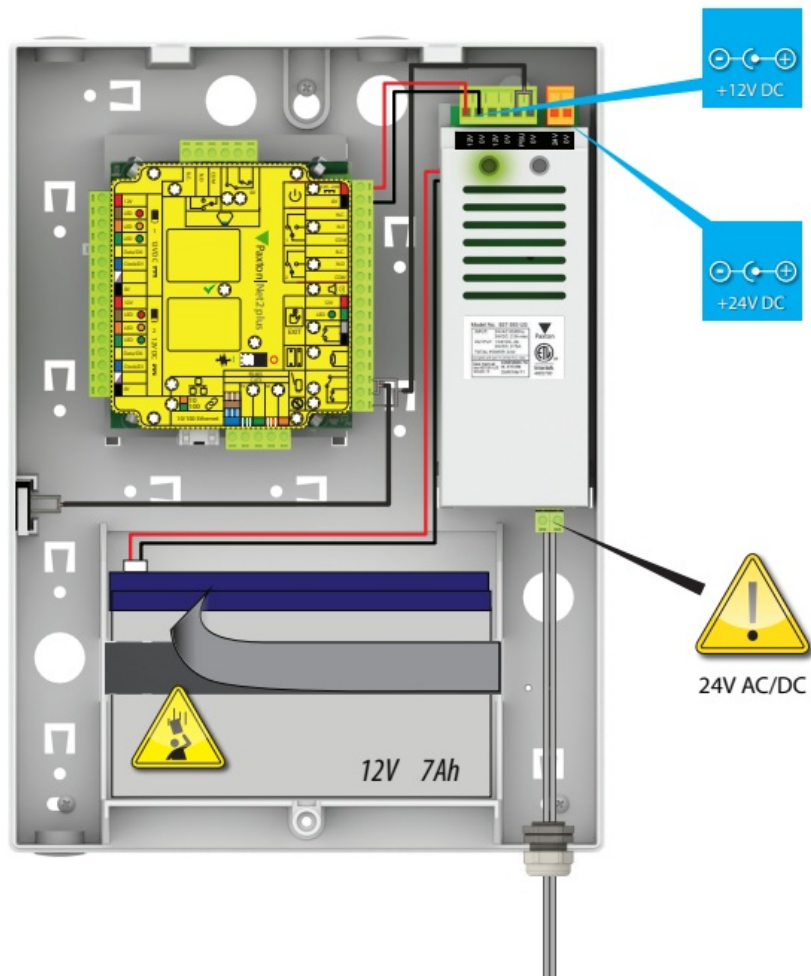
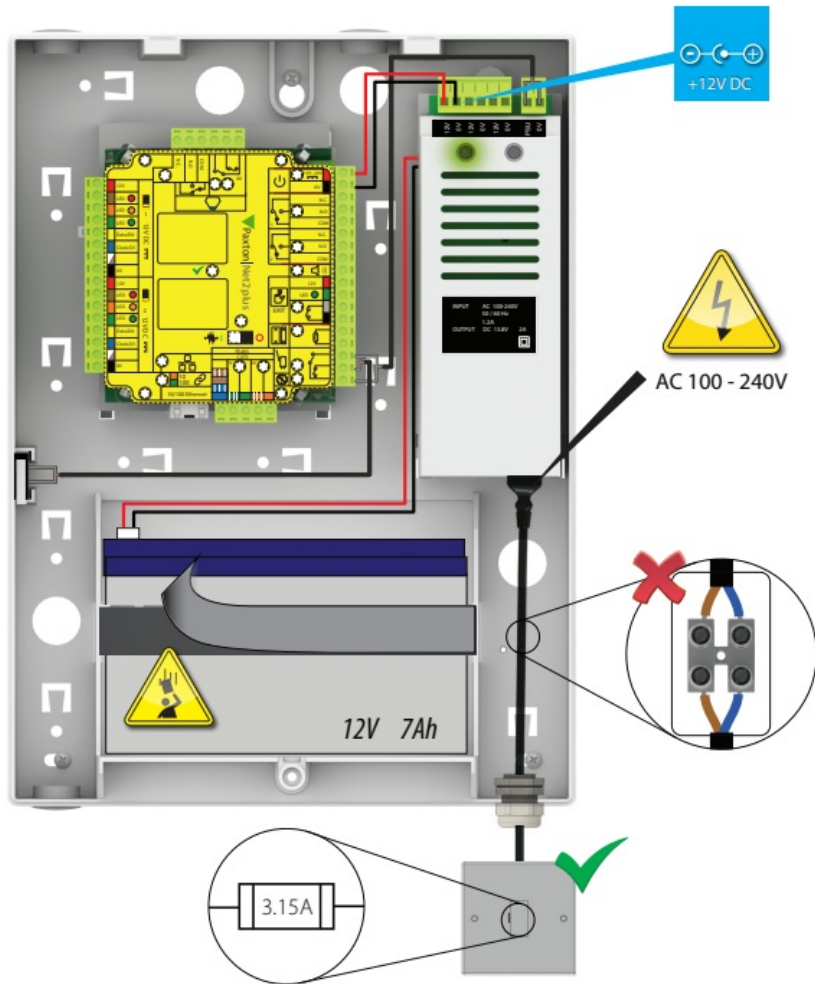



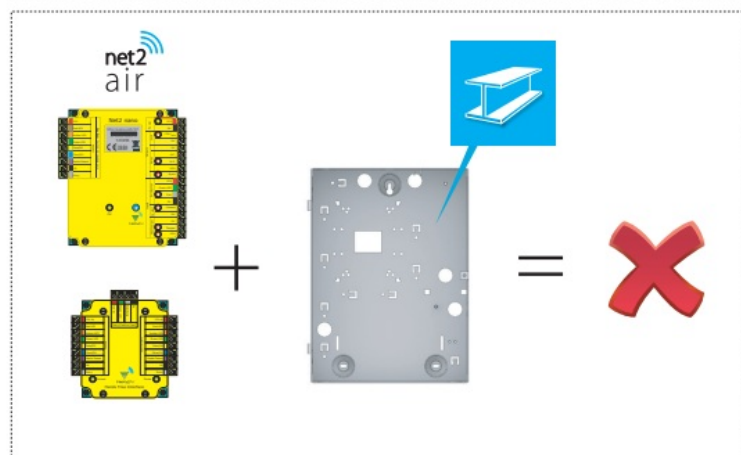
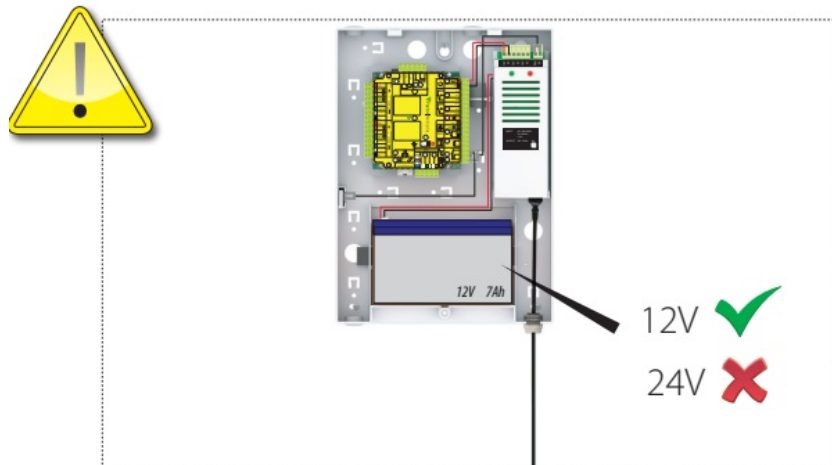
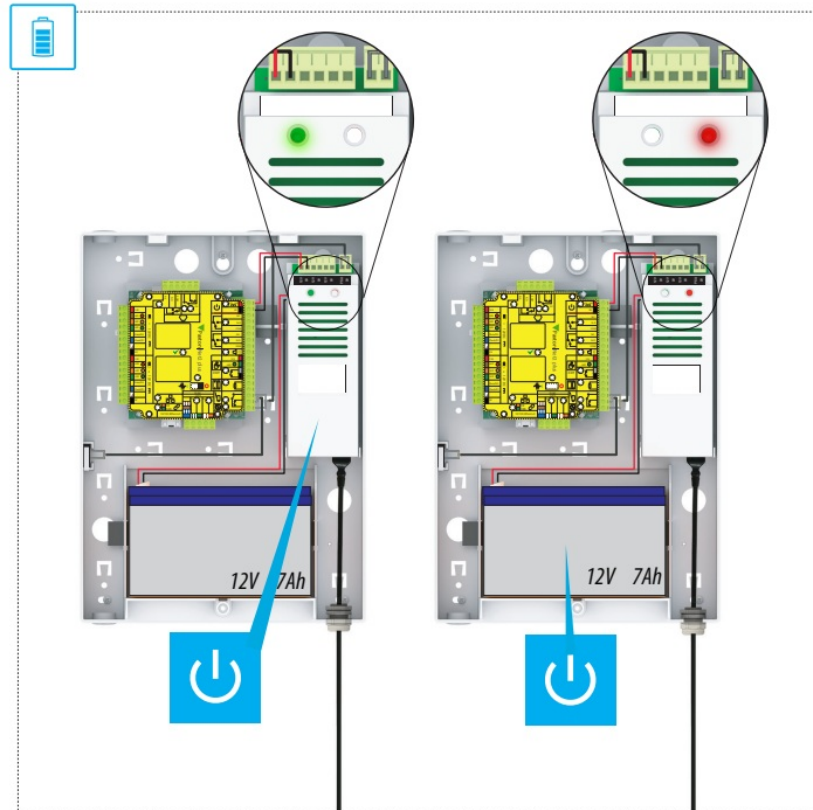



Battery Instruction



Specifications

| |  |  |  |  |  |  |
|---------|---|---|---|---|---|---|
| 682-493 | N/A | N/A | N/A | N/A | 0°C - +55°C 32°F - +131°F | × |
| 682-528 | N/A | N/A | N/A | N/A | 0°C - +55°C 32°F - +131°F | × |
| 682-531 | 100V - 240V AC | 50/60HZ | N/A | N/A | ↑ | × |
| 682-813 | 100V - 240V AC | 50/60Hz | N/A | N/A | ↑ | × |
| 682-910 | 24V AC | 50/60HZ | N/A | N/A | 0°C - +49°C 32°F - +120°F | × |
| 682-284 | N/A | N/A | ≤0.8A / ≤10.36W | ≤1.5A / ≤20.4W | ↓ | × |
| 682-721 | N/A | N/A | ≤0.8A / ≥10.36W | ≤1.5A / ≤20.4W | ↓ | × |

Contact Us

+44 (0)1273 811011

[paxton.support](mailto:usapaxton.support@paxton.co.uk)

support@paxton.co.uk

877.438.7298

[usapaxton.support](mailto:usapaxton.support@paxton-access.com)

supportUS@paxton-access.com

The declaration of conformity is available on request. Contact details are provided at: <http://paxton.info/596>

These products are not suitable for retail sale. All warranties are invalid if these products are not installed by a competent person.

The product is compliant with the following directives:

- The Low Voltage (LVD) Directive
- The Electro-Magnetic Compatibility (EMC) Directive
- The Restriction of Hazardous Substances (RoHS) Directive

The following warnings and instructions **MUST** be adhered to. Read the instructions before installing and powering the equipment. Keep the instructions in a safe place for future reference.

INSTALLATION – Only qualified and trained personnel, familiar with this type of product and who fully understand these instructions should install, connect or test this equipment. There are no user serviceable parts within the PSU unit.

- The equipment is intended for indoor use only in dry locations. This is a Class A product. In a domestic environment this product may cause radio interference in which case the user may be required to take adequate measures.
- The installation must meet National Wiring Regulations and IEC62368-1 standards
- **Disconnect Devices:** A readily accessible disconnect device shall be incorporated in the building wiring to include an appropriately rated circuit breaker to disconnect both poles with at least a 3.0 mm contact gap. After switch off, all internal capacitors will discharge to safe levels within 60 seconds under normal conditions. Under

fault conditions, charge may be held for much longer and suitable precautions should be taken before handling the unit.

- **Protection device:** The fusing characteristics of the protection device to be used are T3.15AH250V

SAFETY WARNING

RISK OF EXPLOSION IF BATTERY IS REPLACED BY AN INCORRECT TYPE.

DISPOSE OF USED BATTERIES ACCORDING TO THE INSTRUCTIONS.

WHEN USED WITH A PAXTON ENTRY PANEL, IN ORDER TO RETAIN UL293 CERTIFICATION THE READER CABLE SHOULD NOT BE EXTENDED BEYOND 30M.

Product Compliance and limitations

This device complies with Industry Canada licence-exempt RSS standard(s). Operation is subject to the following two conditions:

1. this device may not cause interference, and
2. this device must accept any interference, including interference that may cause undesired operation of the device.

Wiring methods shall be in accordance with the National Electrical Code (ANSI/NFPA70), local codes, and the authorities having jurisdiction.

FCC Compliance

This device complies with Part 15 of the FCC Rules. Operation is subject to the following two conditions:

1. this device may not cause harmful interference, and
2. this device must accept any interference received, including interference that may cause undesired operation.

Changes or modifications not expressly approved by the party responsible for compliance could void the user's authority to operate the equipment.

Class B digital devices.

This equipment has been tested and found to comply with the limits for a Class B digital device, pursuant to Part 15 of the FCC Rules. These limits are designed to provide reasonable protection against harmful interference in a residential installation. This equipment generates, uses and can radiate radio frequency energy and, if not installed and used in accordance with the instructions, may cause harmful interference to radio communications. However, there is no guarantee that interference will not occur in a particular installation. If this equipment does cause harmful interference to radio or television reception, which can be determined by turning the equipment off and on, the user is encouraged to try to correct the interference by one or more of the following measures:

- Reorient or relocate the receiving antenna.
- Increase the separation between the equipment and receiver.
- Connect the equipment into an outlet on a circuit different from that to which the receiver is connected.
- Consult the dealer or an experienced radio/TV technician for help

Class A digital devices.

This equipment has been tested and found to comply with the limits for a Class A digital device, pursuant to part 15 of the FCC Rules. These limits are designed to provide reasonable protection against harmful interference when the equipment is operated in a commercial environment. This equipment generates, uses, and can radiate radio energy and, if not installed and used in accordance with the instruction manual, may cause harmful interference to radio communications. Operation of this equipment in a residential area is likely to cause harmful

interference in which case the user will be required to correct the interference at his own expense.
Wiring methods shall be in accordance with the National Electrical Code (ANSI/NFPA70), local codes, and the authorities having jurisdiction.
For CAN/ULC-S319 installations, terminals, leads and wiring methods must comply with CSA, C22.1, Canadian electrical code, Part 1, safety standards for electrical installations.
The use of any add-on, expansion, memory or other module manufactured or supplied by the manufacturer's representative will invalidate the CAN/ULC-S319 certification.
This device complies with Industry Canada licence-exempt RSS standard(s). Operation is subject to the following two conditions:

1. this device may not cause interference, and
2. this device must accept any interference, including interference that may cause undesired operation of the device

Documents / Resources

| | |
|---|---|
|  | <p>Paxton INS-20006-ZA Access Control Unit [pdf] Instructions INS-20006-ZA, Access Control Unit, INS-20006-ZA Access Control Unit</p> |
|---|---|

References

- [Heavy Lifting LLC](#)
- [GmbH.de](#)
- [Contact Us | Paxton Access Control](#)