



Paulmann 95668 Component For High Voltage Track System Instruction Manual

[Home](#) » [Paulmann](#) » Paulmann 95668 Component For High Voltage Track System Instruction Manual 

Contents

- [1 Paulmann 95668 Component For High Voltage Track System](#)
- [2 Product Usage Instructions](#)
- [3 Safety Instructions](#)
- [4 Factory reset](#)
- [5 Touchlink pairing](#)
- [6 Documents / Resources](#)
 - [6.1 References](#)
- [7 Related Posts](#)



Paulmann 95668 Component For High Voltage Track System



Product Specifications:

- Model Numbers: 956.67, 956.68, 956.69 (+MA 326)
- Power Supply: PSU 08/24
- Dimensions:
 - A: 7mm
 - B: 14mm
- Input Power: M2a3x0. V1~00W

Product Usage Instructions

Safety Instructions:

Before using the product, ensure to read and understand the safety instructions included in the manual.

Factory Reset:

To perform a factory reset, follow one of the methods below:

- Reset with App:
 - Access the app and navigate to the reset option to restore factory settings.
- Reset with Remote:
 - Press and hold the reset button on the remote for 5 seconds to initiate a factory reset.

Flash On Connection Mode:

The Flash On Connection Mode allows the device to flash for 3 minutes upon establishing a connection.

Frequently Asked Questions (FAQ):

Q: How do I delete the product from the app?



A: To delete the product from the app, follow these steps:

- Access the app and locate the product in your device list.
- Choose the option to delete or remove the product from the app interface.

Q: What is the purpose of the Flash On Connection Mode?

A: The Flash On Connection Mode provides a visual indication by flashing the device for 3 minutes when a connection is established.

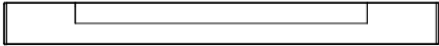
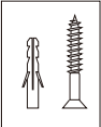
Safety Instructions

<p>Nº: 956.67 956.68 956.69 (+MA 326) PSU 08/24</p> <p>CE UK CA</p>	  <p>1x</p>	 <p>Incl.</p>	
--	---	---	---

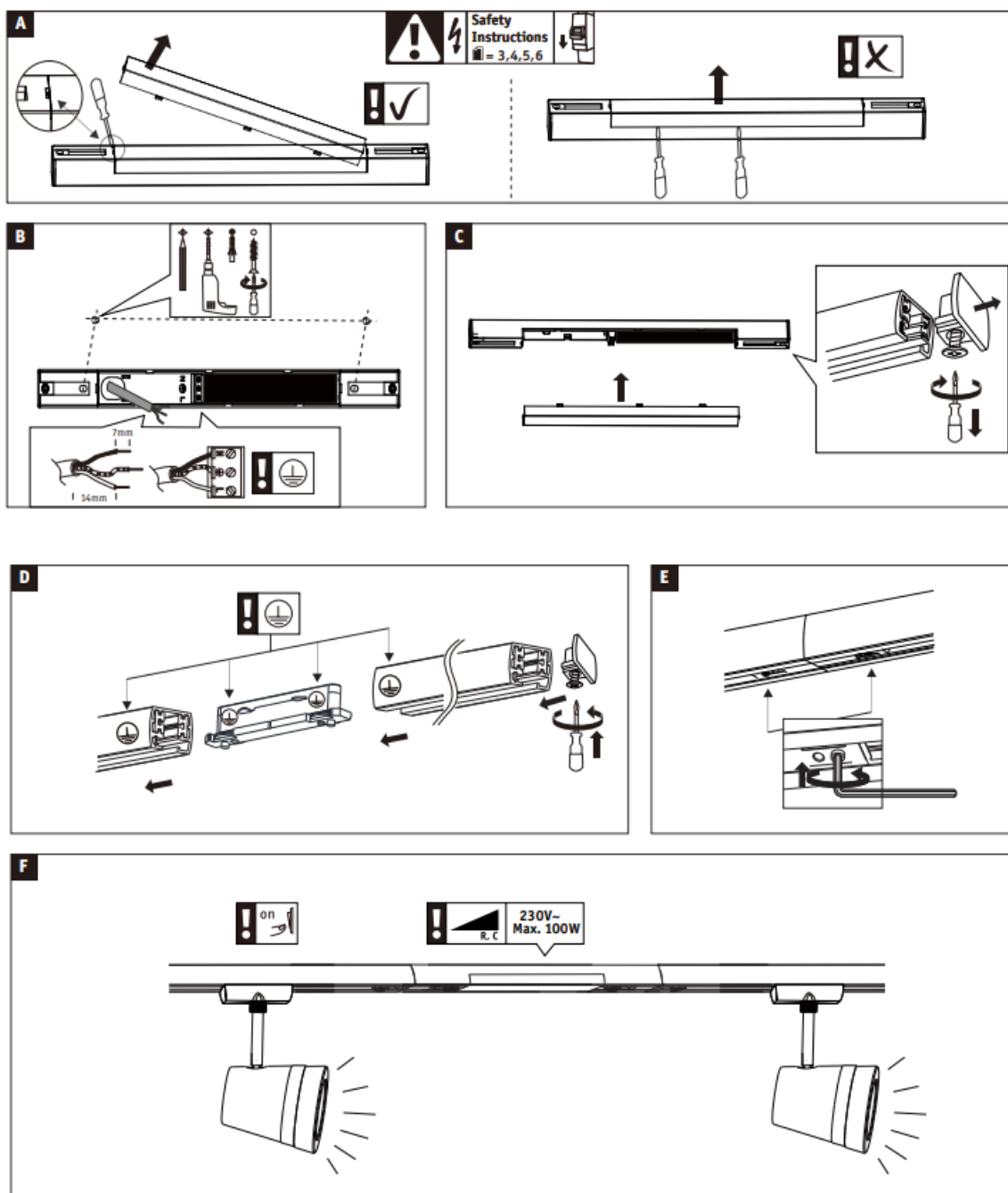

Factory reset

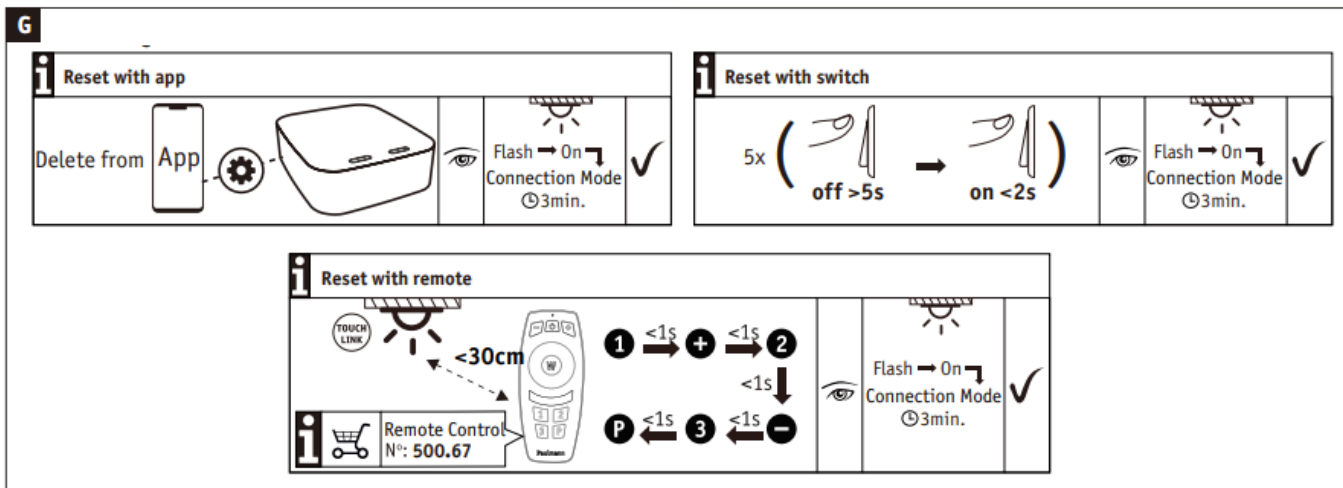

Add to gateway

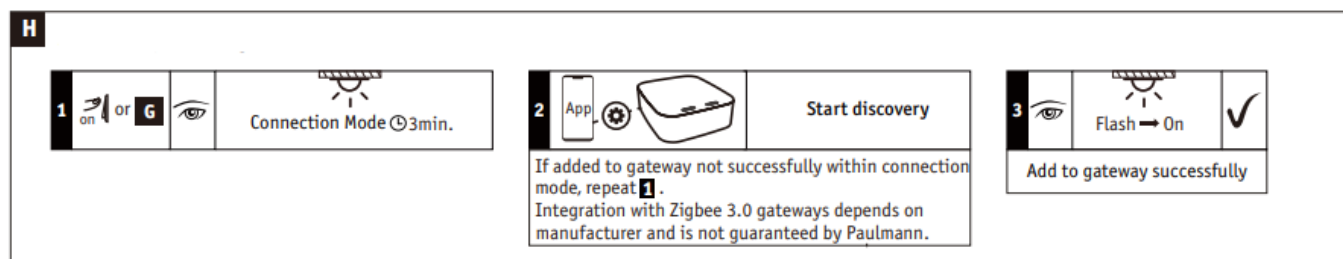

Touchlink pairing

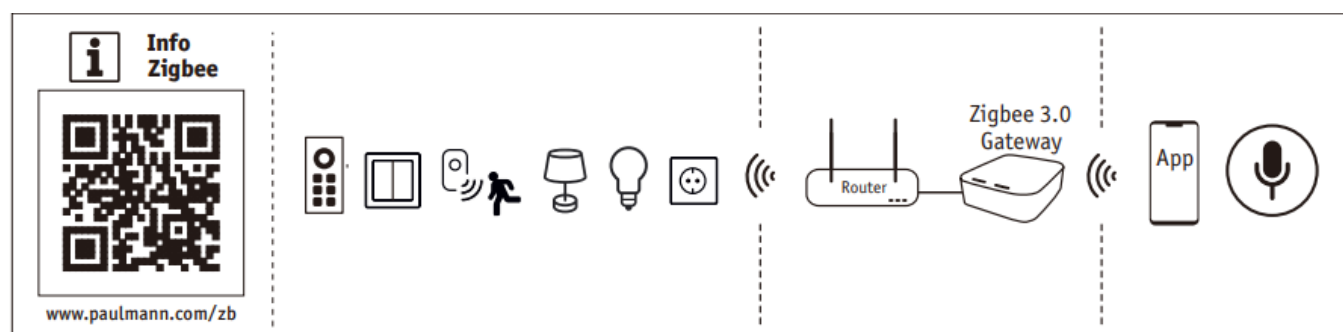
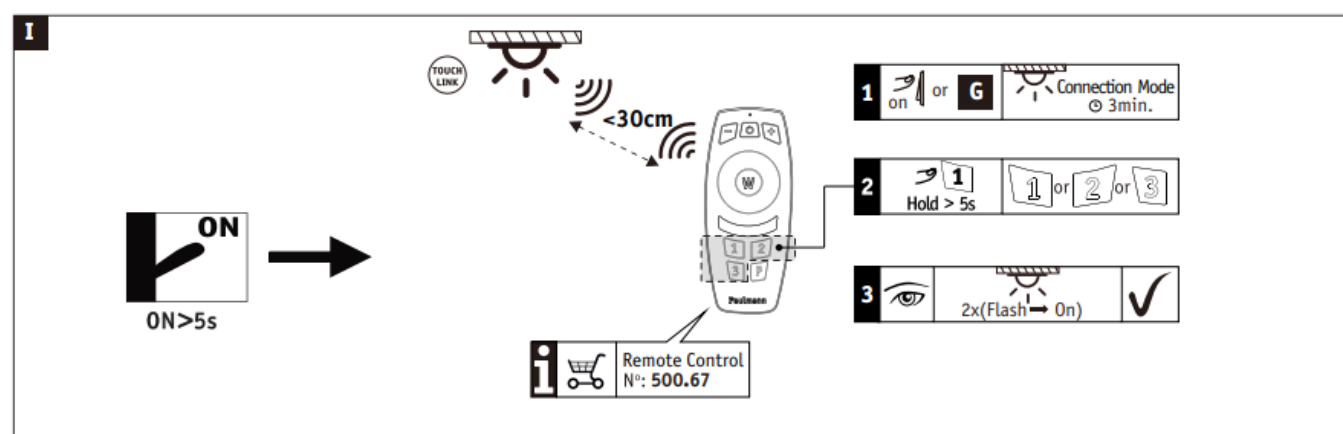

www.paulmann.com/zb

The full text of the EU declaration of conformity is available at the following internet address:
www.paulmann.com/ce Radio frequency [2,4 GHz – 2,4835 GHz]R adiated energy[1 0 mW]

Paulmann Licht GmbH Quezinger Feld 2 31832 Springe
Germany www.paulmann.com

Documents / Resources

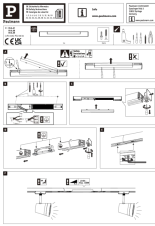
	<p>Paulmann 95668 Component For High Voltage Track System [pdf] Instruction Manual 95668, 95668 Component For High Voltage Track System, Component For High Voltage Track System, High Voltage Track System, Track System, System</p>
---	---

References

- [P Paulmann – Lamps & Luminaires from the Manufacturer](#)
- [P Zigbee lighting control: What is it?](#)
- [User Manual](#)

Manuals+, Privacy Policy

This website is an independent publication and is neither affiliated with nor endorsed by any of the trademark owners. The "Bluetooth®" word mark and logos are registered trademarks owned by Bluetooth SIG, Inc. The "Wi-Fi®" word mark and logos are registered trademarks owned by the Wi-Fi Alliance. Any use of these marks on this website does not imply any affiliation with or endorsement.