

PATIOJOY HW63889 Folding Rattan Side Table



# PATIOJOY HW63889 Folding Rattan Side Table Instruction Manual

[Home](#) » [Patiojoy](#) » PATIOJOY HW63889 Folding Rattan Side Table Instruction Manual 

## Contents

- [1 PATIOJOY HW63889 Folding Rattan Side Table](#)
- [2 Product Usage Instructions](#)
- [3 Before You Start](#)
- [4 Return / Damage Claim Instructions](#)
- [5 FAQ](#)
- [6 Documents / Resources](#)
  - [6.1 References](#)



**PATIOJOY HW63889 Folding Rattan Side Table**



### Product Specifications

- **Product Name:** Folding Rattan Side Table
- **Model Number:** HW63889
- **Language:** English (EN) and French (FR)

### Product Usage Instructions

**Assembly:**

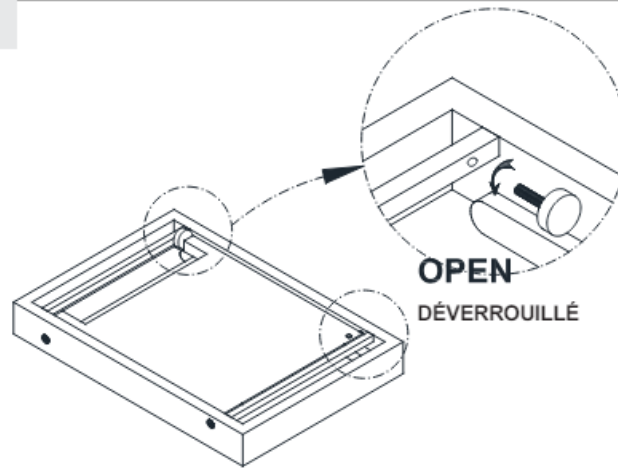
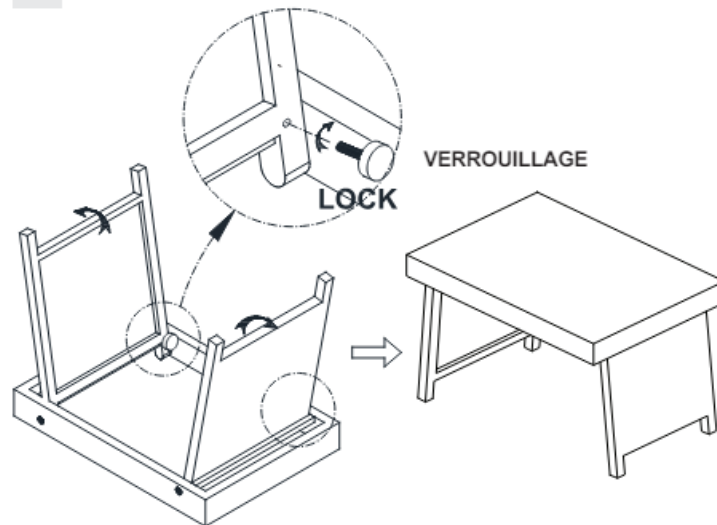
**1****2**

1. Unbox all parts and check for any damage.
2. Follow the assembly instructions provided in the manual.
3. Ensure all parts are securely connected before use.

**Usage:**

- Place the folding rattan side table on a flat and stable surface.
- Use it as a side table for holding drinks, books, or other items.
- Avoid placing excessively heavy items on the table to prevent damage.

**Maintenance:**

- Regularly clean the table with a damp cloth to remove dust and dirt.
- Avoid prolonged exposure to direct sunlight or rain to maintain the rattan's quality.
- If used outdoors, consider storing the table indoors during harsh weather conditions.

**Before You Start**

- Please read all instructions carefully.
- Retain instructions for future reference.

- Separate and count all parts and hardware.
- Read through each step carefully and follow the proper order.
- We recommend that, where possible, all items are assembled near to the area in which they will be placed in use, to avoid moving the product unnecessarily once assembled.
- Always place the product on a flat, steady and stable surface.
- Keep all small parts and packaging materials for this product away from babies and children as they potentially pose a serious choking hazard.

## Notice

- 50% tighten before fixing all screws, Allen wrench is recommended instead of an electric drill.
- Place the item on a flat ground to adjust and make sure it remains stable.
- Tighten up all screws with tools gradually.
- If the screws are not aligned with holes during assembly, please loosen all the other screws to 50% and continue the assembly process.
- If the item is not stable, please loosen all the screws, adjust it on flat ground and tighten up all screws again.

**Note:** If one or some screws are fully tightened during assembly, the others may not be aligned with the holes. In addition, all the holes are designed to be relatively larger to provide more space for the adjustment of the screws.

## Return / Damage Claim Instructions

- **DO NOT discard the box / original packaging.**

In case a return is required, the item must be returned in the original box. Without this your return will not be accepted.

- **Take a photo of the box markings.**

A photo of the markings (text) on the side of the box is required in case a part is needed for replacement. This helps our staff identify your product number to ensure you receive the correct parts.

- **Take a photo of the damaged part (if applicable).**

A photo of the damage is always required to file a claim and get your replacement or refund processed quickly. Please make sure you have the box even if it is damaged.

- **Send us an email with the images requested.**

Email us directly from a marketplace where your item was purchased with the attached images and a description of your claim.

## FAQ

**Q: Can the rattan side table be used outdoors?**

A: Yes, the rattan side table can be used outdoors, but it is recommended to protect it from harsh weather conditions.

**Q: How do I fold the side table for storage?**

A: To fold the side table, carefully follow the folding instructions provided in the manual to avoid any damage.

**Q: What is the weight capacity of the side table?**

A: The weight capacity of the side table is specified in the product manual. Please refer to it for accurate

information.

## Documents / Resources

|   |  |
|---|--|
|  The image shows a white folding rattan side table with a square top and four legs. It is positioned next to a large, stylized letter 'H' and a large, stylized letter 'Q'. Below the table, the text 'Folding Rattan Side Table' and 'Table à pliage en rotin' is visible, along with the model number 'HW63889'. | <p><a href="#">PATIOJOY HW63889 Folding Rattan Side Table</a> [pdf] Instruction Manual<br/>HW63889, HW63889 Folding Rattan Side Table, Folding Rattan Side Table, Rattan Side Table, Side Table, Table</p> |
|---|--|

## References

- [User Manual](#)

### Manuals+, Privacy Policy

This website is an independent publication and is neither affiliated with nor endorsed by any of the trademark owners. The "Bluetooth®" word mark and logos are registered trademarks owned by Bluetooth SIG, Inc. The "Wi-Fi®" word mark and logos are registered trademarks owned by the Wi-Fi Alliance. Any use of these marks on this website does not imply any affiliation with or endorsement.