



PARKSIDE PMFS 200 C3 3-In-1 Multi-Function Sander Instruction Manual

[Home](#) » [PARKSIDE](#) » PARKSIDE PMFS 200 C3 3-In-1 Multi-Function Sander Instruction Manual 

Contents

- [1 PARKSIDE PMFS 200 C3 3-In-1 Multi-Function Sander](#)
- [2 Introduction](#)
- [3 Features](#)
- [4 Package contents](#)
- [5 Technical specifications](#)
- [6 General power tool safety warnings](#)
- [7 Before use](#)
- [8 Maintenance and cleaning](#)
- [9 Kompernass Handels GmbH warranty](#)
- [10 Service](#)
- [11 Documents / Resources](#)
 - [11.1 References](#)
- [12 Related Posts](#)



PARKSIDE PMFS 200 C3 3-In-1 Multi-Function Sander



Before reading, unfold the page containing the illustrations and familiarise yourself with all functions of the device.

3-IN-1 MULTI-FUNCTION SANDER PMFS 200 C3

Introduction

Congratulations on the purchase of your new appliance. You have chosen a high-quality product. The operating instructions are part of this product. They contain important information about safety, usage and disposal. Before using the product, please familiarise yourself with all of the operating and safety instructions. Use the product only as described and for the range of applications specified. Please also pass these operating instructions on to any future owner.

Intended use

Depending on the sandpaper being used, this appliance is suitable for the dry sanding of wood, plastic, metal, filler and also painted surfaces. The appliance is particularly suitable for corners, edges and hard-to-reach areas. Any other usage of or modification to the appliance is deemed to be improper and carries a significant risk of accidents. The manufacturer accepts no responsibility for damage(s) resulting from improper usage. This appliance is not intended for commercial use.

Features

1. ON/OFF switch
2. Adapter fitting
3. Reducer for external extraction appliances
4. Mains cable
5. Dust bag
6. Dust box
7. Release button for dust box
8. Clamping levers
9. Orbital sander plate
10. Clamping rails

11. Delta sander plate
12. Screws (4x)
13. Random orbital sander plate
14. Speed selector
15. Rubber pin (4x)
16. Hex key

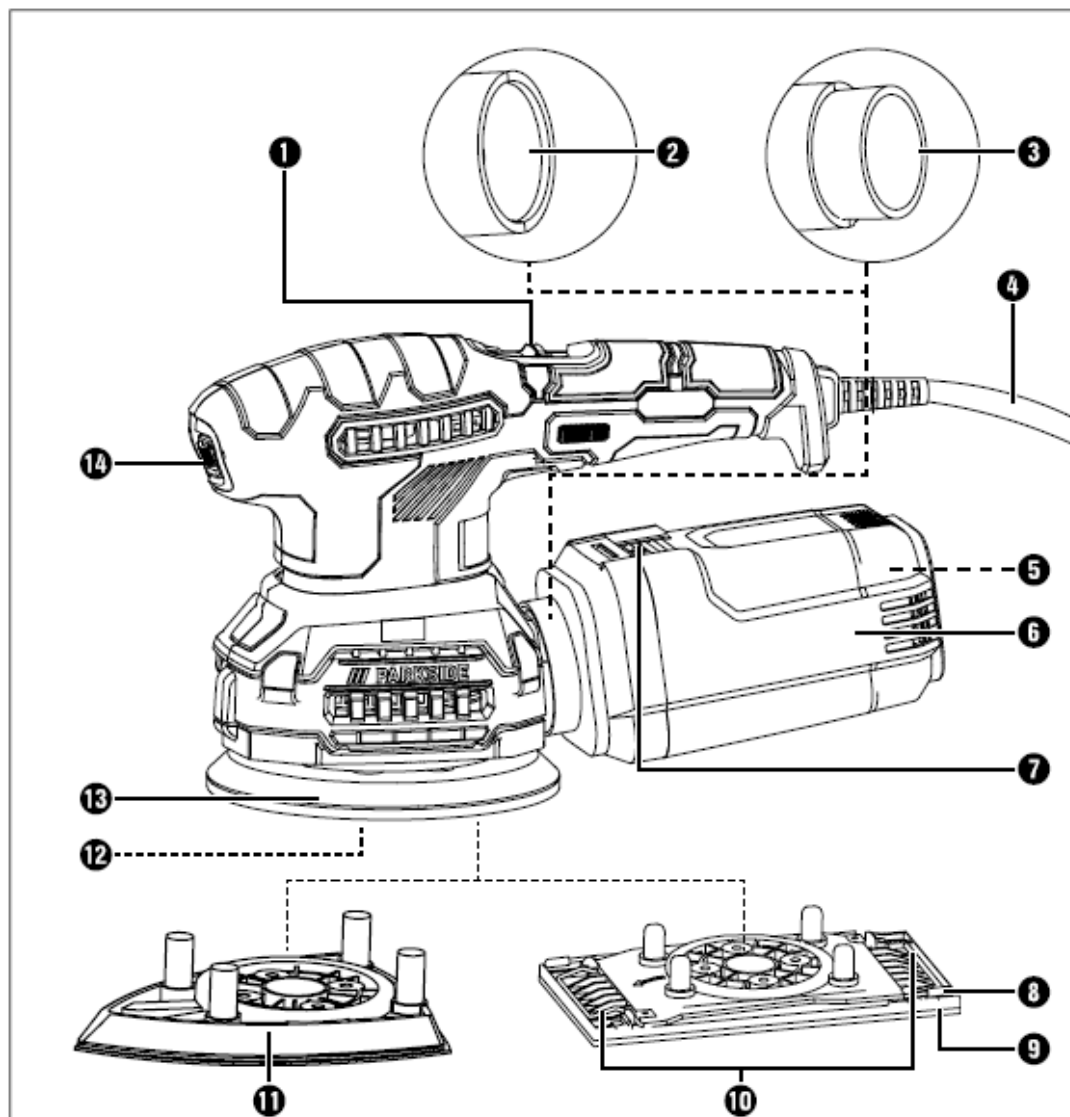

Package contents

- 1 3-in-1 multi-function sander
- 1 Random orbital sander plate with Velcro fastener
- 1 Orbital sander plate with Velcro fastener
- 1 Delta sander plate with Velcro fastener
- 2 Random orbital sanding sheets (grain size 80/240)
- 2 Orbital sanding sheets (grain size 80/240)
- 2 Delta sanding sheets (grain size 80/240)
- 1 Dust box
- 1 Reducer for external extraction appliances
- 4 Rubber pins (pre-installed)
- 4 Screws (pre-installed)

- 1 Hex key
- 1 Set of operating instructions

Technical specifications

- Rated power consumption 200 W
- Nominal voltage 230 V ~, 50 Hz
- Rated idle speed n₀ 7000–12000 rpm
- Rated oscillation speed 14000–24000 rpm
- Protection class II / (double insulation)

Noise and vibration data

Noise measurement value determined in accordance with EN 62841. The A-rated noise level of the power tool is typically as follows:

- Sound pressure level LPA = 74.3 dB (A)
- Sound power level LWA = 85.3 dB (A)
- Uncertainty K = 3 dB

Wear ear muffs!

Rated acceleration, typically

- Hand/arm vibration a_h = 5.428 m/s²
- Uncertainty K = 1.5 m/s²

NOTE

- The vibration emission values and the noise emission values given in these instructions have been measured in accordance with a standardised test procedure and can be used for comparison of the power tool with another tool.
- The specified total vibration values and the noise emission values can also be used to make a provisional load estimate.

WARNING!

- Depending on the manner in which the power tool is being used, and in particular the kind of workpiece being worked, the vibration and noise emission values can deviate from the values given in these instructions during actual use of the power tool.
- Try to keep the vibration loads as low as possible. Measures to reduce the vibration load are, e.g. wearing gloves and limiting the working time. Wherein all states of operation must be included (e.g. times when the power tool is switched off and times where the power tool is switched on but running without load).

General power tool safety warnings

WARNING!

Read all safety warnings, instructions, illustrations and specifications provided with this power tool. Failure to follow all instructions listed below may result in electric shock, fire and/or serious injury.

Save all warnings and instructions for future reference.

The term “power tool” in the warnings refers to your mains-operated (corded) power tool or battery-operated (cordless) power tool.

1. Work area safety

- a) Keep work area clean and well lit. Cluttered or dark areas invite accidents.
- b) Do not operate power tools in explosive atmospheres, such as in the presence of flammable liquids, gases or dust. Power tools create sparks which may ignite the dust or fumes.
- c) Keep children and bystanders away while operating a power tool. Distractions can cause you to lose control.

2. Electrical safety

- a) Power tool plugs must match the outlet. Never modify the plug in any way.
Do not use any adapter plugs with earthed (grounded) power tools. Unmodified plugs and matching outlets will reduce risk of electric shock.
- b) Avoid body contact with earthed or grounded surfaces, such as pipes, radiators, ranges and refrigerators. There is an increased risk of electric shock if your body is earthed or grounded.
- c) Do not expose power tools to rain or wet conditions. Water entering a power tool will increase the risk of electric shock.
- d) Do not abuse the cord. Never use the cord for carrying, pulling or unplugging the power tool. Keep cord away from heat, oil, sharp edges or moving parts. Damaged or entangled cords increase the risk of electric shock.
- e) When working outdoors with an electrical power tool, always use extension cords that are also suitable for use outdoors. Use of a cord suitable for outdoor use reduces the risk of electric shock.
- f) If operating a power tool in a damp location is unavoidable, use a residual current device (RCD) protected supply. Use of an RCD reduces the risk of electric shock.

3. Personal safety

- a) Stay alert, watch what you are doing and use common sense when operating a power tool. Do not use a power tool while you are tired or under the influence of drugs, alcohol or medication. A moment of inattention while operating a power tool may result in serious personal injury.
- b) Use personal protective equipment. Always wear eye protection. Protective equipment such as a dust mask, non-skid safety shoes, hard hat or hearing protection used for appropriate conditions will reduce personal injuries.
- c) Prevent unintentional starting. Ensure the switch is in the off-position before connecting to power source and/or battery pack, picking up or carrying the tool. Carrying power tools with your finger on the switch or energising power tools that have the switch on invites accidents.
- d) Remove any adjusting key or wrench before turning the power tool on. A wrench or a key left attached to a rotating part of the power tool may result in personal injury.
- e) Do not overreach. Keep proper footing and balance at all times. This enables better control of the power tool in unexpected situations.
- f) Dress properly. Do not wear loose clothing or jewellery. Keep your hair and clothing away from moving parts. Loose clothes, jewellery or long hair can be caught in moving parts.
- g) If devices are provided for the connection of dust extraction and collection facilities, ensure these are connected and properly used. Use of dust collection can reduce dust-related hazards.

h) Do not allow yourself to get lulled into a false sense of security and do not ignore the safety rules for power tools, even if you are familiar with the power tool after repeated use. A careless action can cause severe injury within a fraction of a second.

4. Power tool use and care

- a) Do not force the power tool. Use the correct power tool for your application. The correct power tool will do the job better and safer at the rate for which it was designed.
- b) Do not use the power tool if the switch does not turn it on and off. Any power tool that cannot be controlled with the switch is dangerous and must be repaired.
- c) Disconnect the plug from the power source and/or remove the battery pack, if detach-able, from the power tool before making any adjustments, changing accessories, or storing power tools. Such preventive safety measures reduce the risk of starting the power tool acci-dentally.
- d) Store idle power tools out of the reach of children, and do not allow persons unfamiliar with the power tool or these instructions to operate the power tool. Power tools are dangerous in the hands of untrained users.
- e) Maintain power tools and accessories. Check for misalignment or binding of moving parts, breakage of parts and any other condition that may affect the power tool's operation. If damaged, have the power tool repaired before use. Many accidents are caused by poorly maintained power tools.
- f) K eep cutting tools sharp and clean. Properly maintained cutting tools with sharp cutting edges are less likely to bind and are easier to control.
- g) Use the power tool, accessories and tool bits, etc., in accordance with these instructions, taking into account the working conditions and the work to be performed. Use of the power tool for operations different from those intended could result in a hazardous situation.
- h) Keep handles and grasping surfaces dry, clean and free from oil and grease. Slippery handles and grasping surfaces do not allow for safe handling and control of the tool in unex-pected situations.

5. Service

- a) Have your power tool serviced by a qualified repair person using only identical replace-ment parts. This will ensure that the safety of the power tool is maintained.
- b) Always arrange for the replacement of the plug or the power cord to be carried out by the manufacturer of the appliance or by his approved customer services. This will ensure that the safety of the power tool is maintained.

Appliance-specific safety instructions

- Secure the workpiece. A workpiece securely held by a clamping device or vice is much safer than one held in your hand.
- Do not rest your hands next to or in front of the appliance and the area being worked as there is a risk of injury if you slip.
- In the event of danger, remove the mains plug from the socket immediately.
- Always route the power cable towards the rear, away from the appliance.
- **RISK OF FIRE DUE TO FLYING SPARKS!** If you sand metal, sparks will be produced. There-fore, make sure that nobody is at risk and that no combustible materials are located in the immediate vicinity of where you are working.
- Hold the power tool by the insulated gripping surfaces, as the grinding surface could hit its own cable. Damage

to a live wire may make exposed metal parts of the power tool live and could give the operator an electric shock.

WARNING! TOXIC VAPOURS!

Working with the tool can produce harmful/toxic dusts that represent a health hazard for the person operating the appliance and for any other people in the area.

WARNING! RISKS DUE TO DUST!

When working for extended periods of time on wood and, in particular, materials that produce dust which is hazardous to health, connect the appliance to an appropriate external dust extraction appliance. Wear safety goggles and a protective dust mask!

- Ensure sufficient ventilation when working on plastics, paints, lacquers, etc.
- Do not soak the materials or the area to be processed with liquids containing solvents.
- Never work on moistened materials or damp surfaces.
- Avoid sanding lead paint or other harmful materials.
- Materials containing asbestos must not be processed. Asbestos is a known carcinogen.
- Avoid contact with the sanding sheet while the appliance is running!
- Do not use the appliance without a sanding sheet fitted.
- Never use the appliance for other purposes and only use original parts/accessories. Using attachments or accessory tools other than those recommended in the operating instructions can lead to a risk of injury.
- Always allow the appliance to come to a complete standstill before putting it down.
- The appliance must always be kept clean, dry and free from oil or grease.

Before use

Fitting/changing the sander plate

WARNING!

Always remove the plug from the mains power socket before carrying out any work on the appliance.

- Use the appropriate sander plate the corresponding application.
- Remove the pre-fitted sander plate.

NOTE

The orbital sander plate can only be fitted to the appliance in one direction. Please pay attention to the arrow marks on the orbital sander plate . These must point forwards. With the delta sander plate the tip points forwards.

The rubber pins have a groove on the side. The groove must be aligned with the tabs in the mounting holes on the respective sander plate . This allows you to insert the rubber pins into the sander plate .

- Now fit the required sander plate. Ensure that the mounting plate B is aligned with the sander plate. The threaded holes of the mounting plate B must be aligned with the corresponding holes on the respective sander

plate. Align the rubber pins A (only on sander plates and) with the holes in the appliance (see fig. 1).

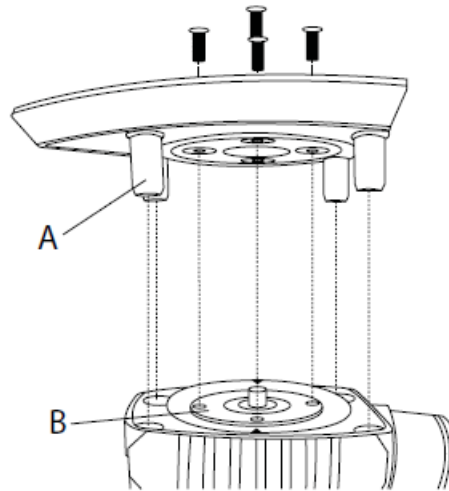

Figure 1

- Re-tighten the four screws using the hex key .
- Check that the sander plate is fitted securely.

Selecting a sanding sheet

Removal and surface

The material removal rate and surface quality are determined by the grain strength of the sanding sheet.

- Please note that you need to use appropriate sanding sheets with different grains for working different materials.

Fitting the sanding sheet

WARNING!

Always remove the plug from the mains power socket before carrying out any work on the appliance.

NOTE

Before fitting a new sanding sheet, remove any dust and dirt from the sander plate .

Attaching sanding sheets using Velcro

- You can attach the sanding sheet to the sander plate using Velcro.
- Ensure that the extraction holes on the sanding sheet match up with those on the sander plate.

Removing sanding sheets fitted using Velcro

- Simply pull the sanding sheet off the sander plate (see fig. A on the fold-out page).

Attaching sanding sheets without using Velcro (see fig. B on the fold-out page, not supplied)

- Open the two clamping levers .
- Push the sanding sheet under the open clamping rail at one end and clamp it firmly in place with the clamping lever.
- Follow the same procedure at the other end

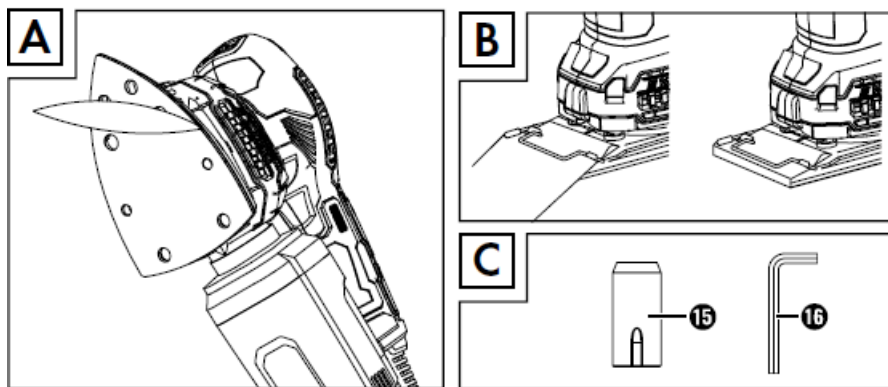

Dust extraction

WARNING! RISK OF FIRE!

When working with power tools that have a dust collection box or can be connected to a vacuum cleaner via the vacuum cleaner adapter, there is a risk of fire! In unfavourable conditions, e.g. when sparks are flying while sanding metal or metal residues in wood, wood dust in the dust sack (or in the vacuum cleaner dust bag) can spontaneously ignite. This is a particular risk if the wood dust is mixed with paint residues or other chemicals and the workpiece has become hot after being worked for a long time. Therefore, do not allow the workpiece to overheat and always empty the dust box or the dust bag of the vacuum cleaner before taking a break from work.

Wear a dust mask!

NOTE

Perforated sanding sheets are required for dust extraction.

Dust box

Connecting

Slide the dust box onto the appliance. Make sure that the symbol on the dust box is aligned with the ► symbol on the appliance. Turn the dust box to the symbol to lock it (see detailed illustration fig. D on the fold-out page).

Removal

Turn the symbol on the dust box to the symbol on the appliance (see detailed illustration fig. D on the fold-out page). Pull the dust box off the appliance.

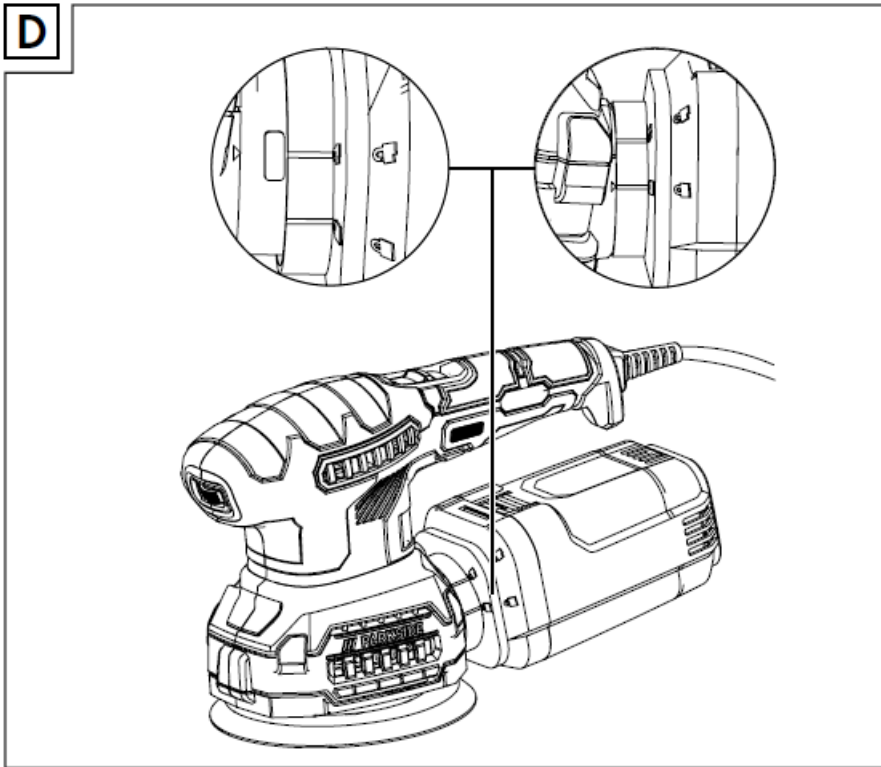

NOTE

To achieve optimum dust extraction, the dust box should be emptied regularly.

To do this, remove the dust box off the appliance as described above. To do this, open the dust box by pressing on the release button and pulling off the rear part. Now remove the dust bag. Clean the dust bag thoroughly by tapping it out.

Reducer Connecting

- Push the reducer into the adapter fitting.
- Push the hose of a suitable vacuum cleaning appliance (e.g. a workshop vacuum cleaner) onto the reducer.

Removal

- Pull the hose of the vacuum cleaner off the reducer.
- Remove the reducer.

Use

CAUTION!

Ensure that the appliance is switched off before connecting it to the mains.

NOTE

Always switch the multi-sander on before applying it to the material, then move it over the workpiece.

Switching on and off

Switching the appliance on

- ◆ Move the ON/OFF switch to the “I” position.

Switching the appliance off

- ◆ Move the ON/OFF switch to the “0” position.

Setting the oscillating speed

You can set the desired oscillating speed using the speed selector as required. The required speed depends on the material being processed and can be determined through practical tests.

Working procedures

- Switch the appliance on before applying it to the workpiece.
- Apply minimal pressure when working.
- Work at a constant speed.
- Change the sanding sheets regularly.
- Never use the same sanding sheet for sanding different materials (e.g. wood followed by metal). Optimum sanding results can only be achieved by using clean sanding sheets.
- Clean the sanding sheet every once in a while using a vacuum cleaner.
- Sand hard-to-reach places with the front or side edge of the sanding sheet on the sander plate.
- Guide the sander over the workpiece in parallel and use overlapping sanding motions.
- After completing the task, lift the appliance from the workpiece and then switch it off.

Maintenance and cleaning

WARNING!

Always remove the plug from the mains power socket before carrying out any work on the appliance.

The multi-sander is maintenance-free.

- Always clean the appliance directly after completion of work.
- Use a dry cloth to clean the housing.
- Remove any sanding dust stuck to the appliance with a brush.
- Never use sharp objects, petrol, solvents or cleaning agents which can damage plastic. Do not allow any liquids to get into the interior of the appliance.
- Always keep the ventilation openings free of obstructions.

Kompernass Handels GmbH warranty

Dear Customer,

This appliance has a 3-year warranty valid from the date of purchase. If this product has any faults, you, the buyer, have certain statutory rights. Your statutory rights are not restricted in any way by the warranty described below.

Warranty conditions

- The warranty period starts on the date of purchase. Please keep your receipt in a safe place. This will be required as proof of purchase.

- If any material or manufacturing fault occurs within three years of the date of purchase of the product, we will either repair or replace the product for you or refund the purchase price (at our discretion). This warranty service requires that you present the defective appliance and the proof of purchase (receipt) within the three-year warranty period, along with a brief written description of the fault and of when it occurred.
- If the defect is covered by the warranty, your product will either be repaired or replaced by us. The repair or replacement of a product does not signify the beginning of a new warranty period.

Warranty period and statutory claims for defects

The warranty period is not prolonged by repairs effected under the warranty. This also applies to replaced and repaired components. Any damage and defects present at the time of purchase must be reported immediately after unpacking. Repairs carried out after expiry of the warranty period shall be subject to a fee.

Scope of the warranty

This appliance has been manufactured in accordance with strict quality guidelines and inspected meticulously prior to delivery.

The warranty covers material faults or production faults. The warranty does not extend to product parts subject to normal wear and tear or to fragile parts which could be considered as consumable parts such as switches or parts made of glass.

The warranty does not apply if the product has been damaged, improperly used or improperly maintained. The directions in the operating instructions for the product regarding proper use of the product are to be strictly followed. Uses and actions that are discouraged in the operating instructions or which are warned against must be avoided.

This product is intended solely for private use and not for commercial purposes. The warranty shall be deemed void in cases of misuse or improper handling, use of force and modifications / repairs which have not been carried out by one of our authorised Service centres.

The warranty period does not apply to

- Normal reduction of the battery capacity over time
- Commercial use of the product
- Damage to or alteration of the product by the customer
- Non-compliance with safety and maintenance instructions, operating errors
- Damage caused by natural hazards

Warranty claim procedure

To ensure quick processing of your case, please observe the following instructions:

- Please have the till receipt and the item number (e.g. IAN 12345) available as proof of purchase.
- You will find the item number on the type plate on the product, an engraving on the product, on the front page of the operating instructions (below left) or on the sticker on the rear or bottom of the product.
- If functional or other defects occur, please contact the service department listed either by telephone or by e-mail.
- You can return a defective product to us free of charge to the service address that will be provided to you. Ensure that you enclose the proof of purchase (till receipt) and information about what the defect is and when it occurred.

WARNING!

- Have the appliances repaired by the Service Centre or a qualified electrician and only using genuine replacement parts. This will ensure that the safety of the appliance is maintained.
- Always ensure that the power plug or the mains cable is replaced only by the manufacturer of the appliance or by an approved customer service provider. This will ensure that the safety of the appliance is maintained.

Service

Service Great Britain

Tel.: 0800 404 7657

E-Mail: kompernass@lidl.co.uk

Service Malta

Tel.: 80062230

E-Mail: kompernass@lidl.com.mt

Importer

Please note that the following address is not the service address. Please use the service address provided in the operating instructions.

KOMPERNASS HANDELS GMBH BURGSTRASSE 21

44867 BOCHUM

GERMANY

www.kompernass.com

Disposal

The packaging is made from environmentally friendly material and can be disposed of at your local recycling plant.

Do not dispose of power tools in your normal domestic waste!

In accordance with European Directive 2012/19/EU on Waste Electrical and Electronic Equipment and its integration into national law, used power tools must be disposed of separately and recycled in an environmentally friendly manner.

Your local community or municipal authorities can provide information on how to dispose of the appliance.

Translation of the original Conformity Declaration

We, KOMPERNASS HANDELS GMBH, document officer: Mr Semi Uguzlu, BURGSTR. 21, 44867 BOCHUM, GERMANY, hereby declare that this product complies with the following standards, normative documents and EC directives:

Machinery Directive

(2006/42/EC)

EMC (Electromagnetic Compatibility)

(2014/30/EU)

RoHS Directive

(2011/65/EU)*

Applied harmonised standards

EN 62841-1:2015

EN 62841-2-4:2014

EN 55014-1:2017

EN 55014-2:2015

EN 61000-3-2:2004

EN IEC 61000-3-2:2019

EN 61000-3-3:2013

EN 61000-3-3:2013/A1:2019

EN IEC 63000:2018

Type/appliance designation: 3-in-1 multi-function sander PMFS 200 C3

Year of manufacture: 05–2021

Serial number: IAN 367467_2101

Bochum, 26/04/2021

Documents / Resources

	<p>PARKSIDE PMFS 200 C3 3-In-1 Multi-Function Sander [pdf] Instruction Manual PMFS 200 C3, 3-In-1 Multi-Function Sander</p>
---	---

References

-  [Kompernaß - Online shop for accessories and spare parts](#)

[Manuals+](#).