

**/// PARKSIDE®**  
**HG04830D**  
**For**  
**Checking**  
**Drills**



## PARKSIDE HG04830D For Checking Drills User Guide

[Home](#) » [PARKSIDE](#) » PARKSIDE HG04830D For Checking Drills User Guide 

### Contents

- [1 PARKSIDE HG04830D For Checking Drills](#)
- [2 Product Information](#)
- [3 Product Usage Instructions](#)
- [4 Before use](#)
- [5 HOW TO USE](#)
- [6 Warranty](#)
- [7 Documents / Resources](#)
  - [7.1 References](#)

**/// PARKSIDE®**

### PARKSIDE HG04830D For Checking Drills



### Product Information

## Specifications:

- **Product Name:** Flaring Tool Kit
- **Material:** Hardened Steel
- **Includes:** Pressure Pieces, Flaring Tool, Tubing Clamp

## Product Usage Instructions

### Preparation:

Before flaring the end, ensure the fitting is positioned correctly on the tubing.

### Flaring Process:

1. Secure the flaring tool base in a vice for stability.
2. Insert the tube into the appropriate opening of the flaring tool.
3. Place the correctly sized pressure piece beside the tube's end.
4. Tighten the wing nuts firmly while keeping the tool halves parallel.
5. Coat the pressure piece with lubricant and insert it into the tube.
6. Position the flaring tool on the tubing clamp with the cone point centered on the pressure piece.
7. Turn the screw clockwise until the pressure piece bottoms out of the tubing clamp.

### Final Steps:

Loosen the screw, remove the pressure piece, and observe the tube end for a properly flared appearance.

### FAQ:

#### • **Q: Can the flaring tool be used without a vice?**

A: Yes, while using a vice is recommended for stability, you can use the flaring tool without one if necessary. Ensure to follow all steps carefully for proper flaring.

## Before use

It is recommended to anneal one end of the hard tube before flaring.

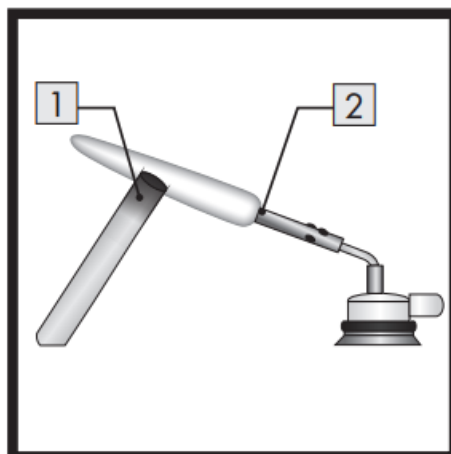

1. Tube
2. Gas torch

### Single flare

Follow steps A to D and K to O.

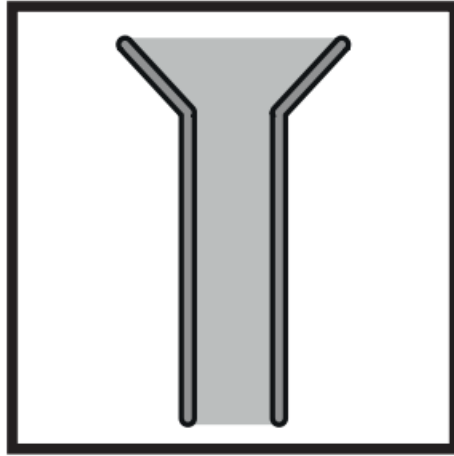

### Double flare

Use the included pressure pieces and follow all steps (A to O).

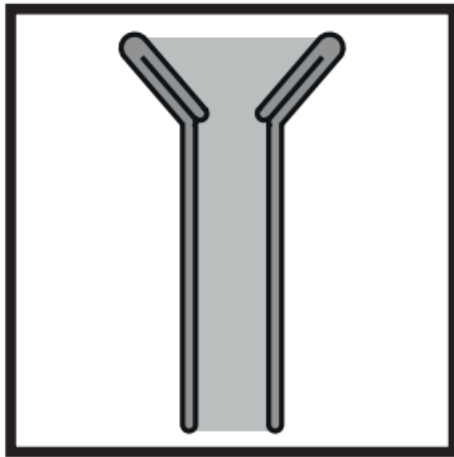

## HOW TO USE

- Before flaring the end: Make sure the fitting is on the line and facing the right direction.

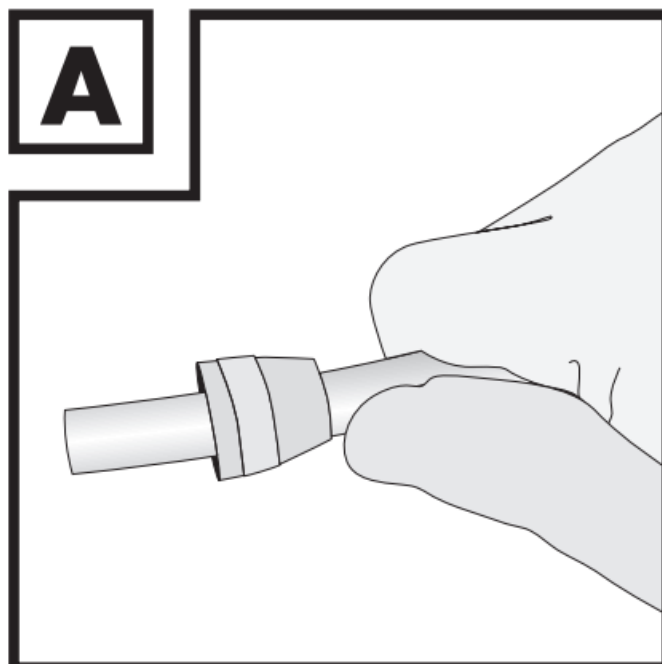

- The flaring tool base is easiest to manage when secured in a vice. The flaring tool can be used without a vice if necessary. Loosen the wing nuts. Insert the tube in the appropriate opening.

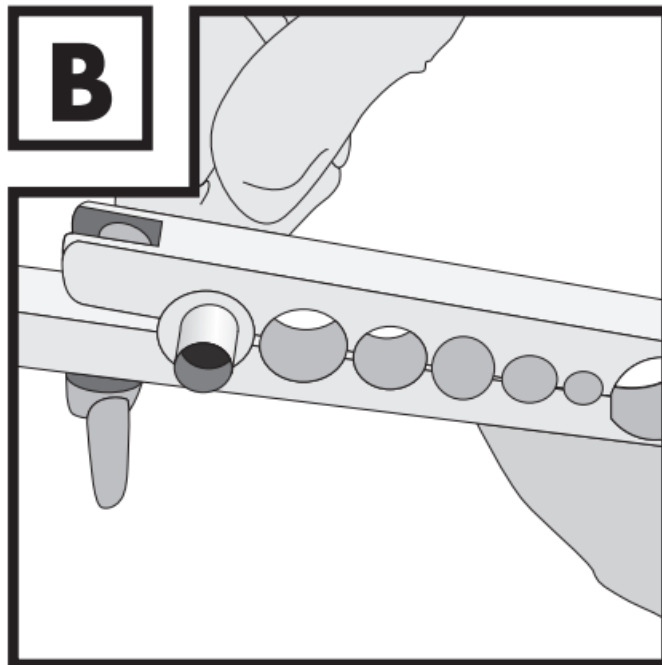

- Place the correct-sized pressure piece upside down beside the protruding end of the tube. Let the end of the tubing protrude from the tube to match the thickness of the large part of the pressure piece.

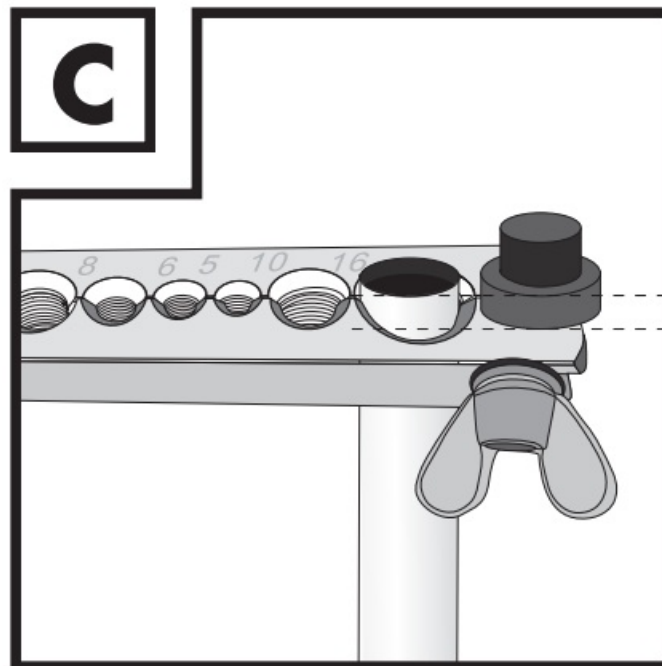

- Tighten the wing nuts tightly. Keep the halves of the tool parallel to each other as you tighten. Tighten the wing nuts with a suitable tool.

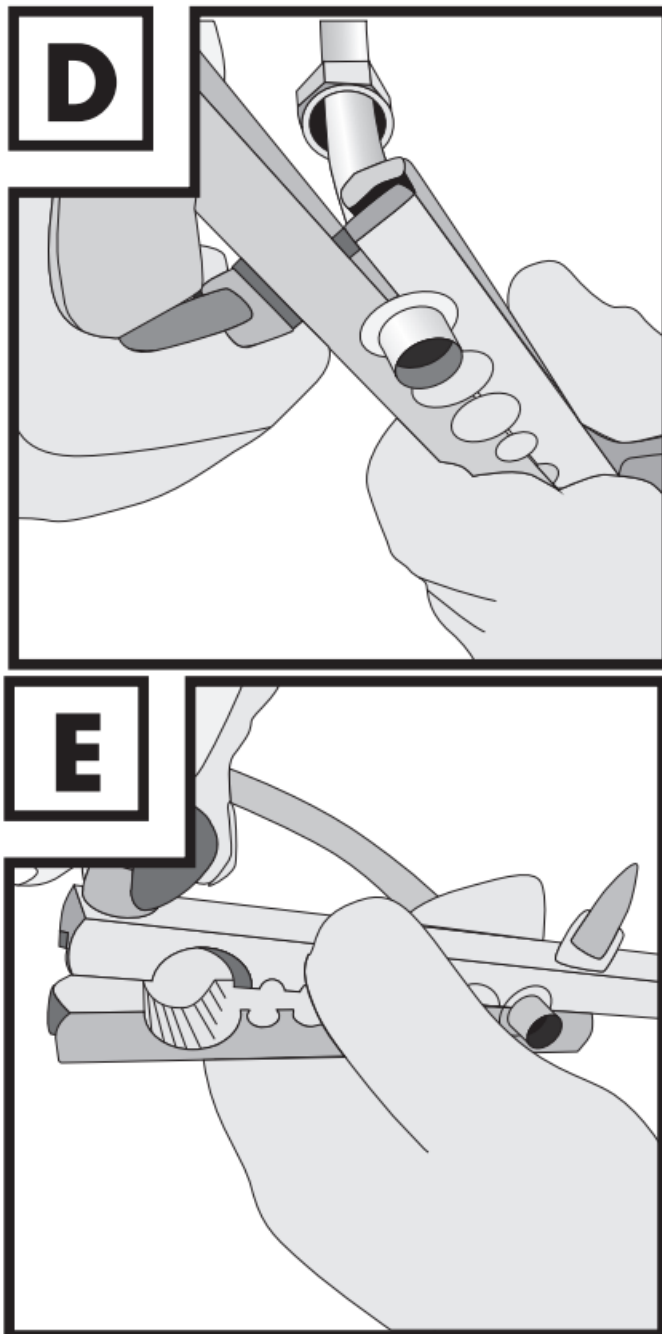

- Turn the pressure piece over. Coat the pressure piece with a small amount of lubricant. Insert the pressure piece into the tube.

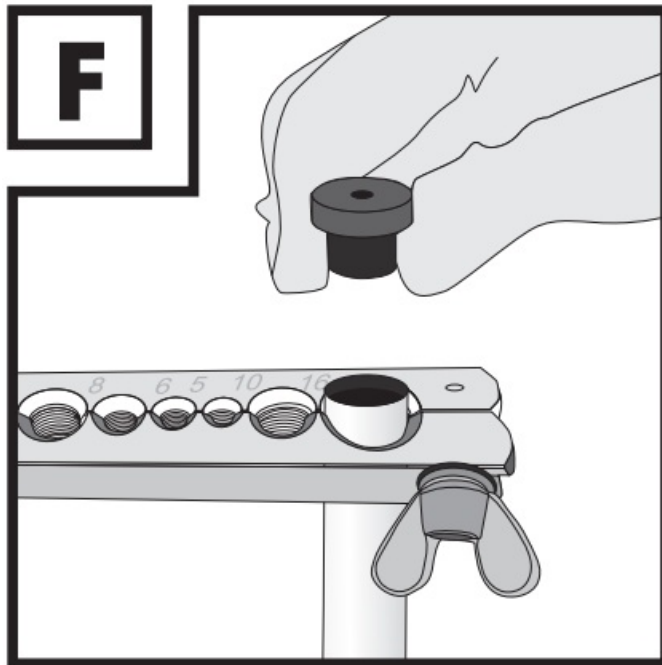

- Place the flaring tool on the tubing clamp.

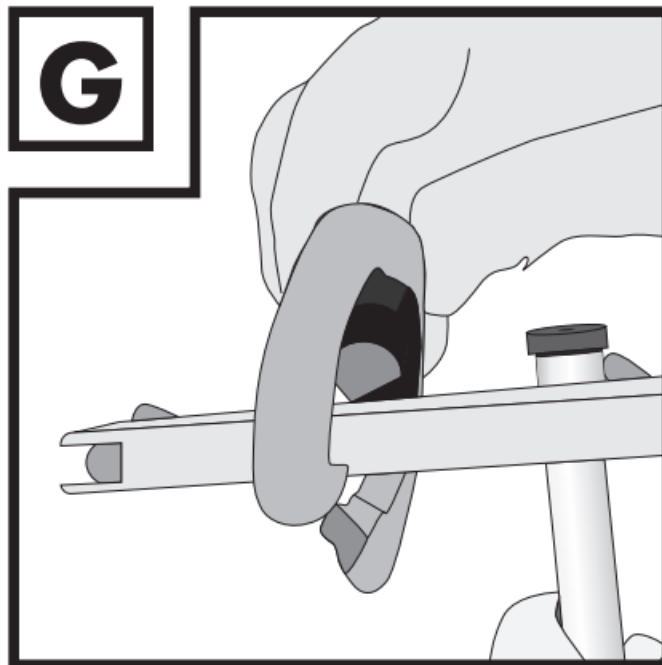

- The cone point must be centered on the pressure piece. The flaring tool must be locked on the tubing clamp.

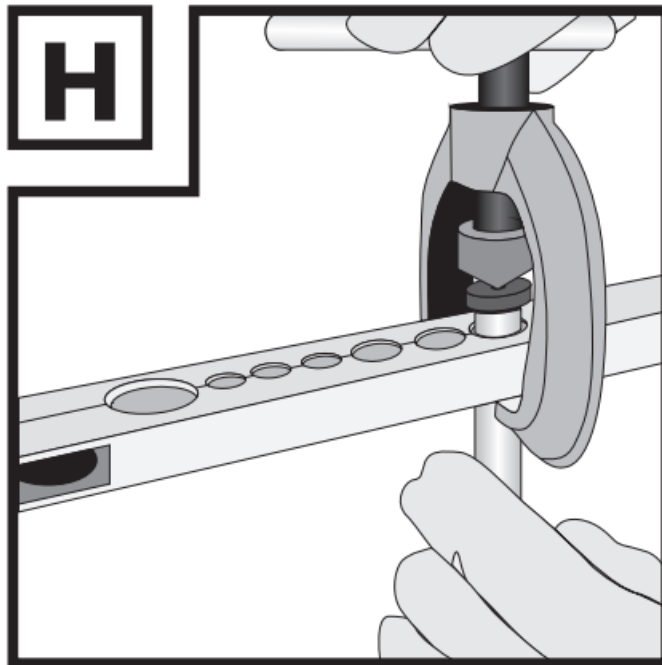

- Turn the screw clockwise until the pressure piece bottoms out of the tubing clamp. Final tightening is easier if you clamp the tool in a vice. Observe the tube does not drop down during use.

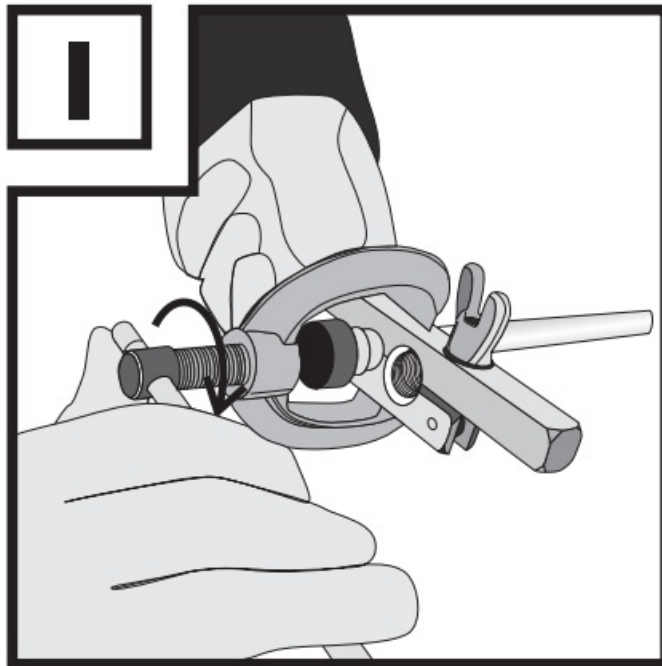

- Loosen the screw and remove the pressure piece. The tube end should have a bubble look at this point.

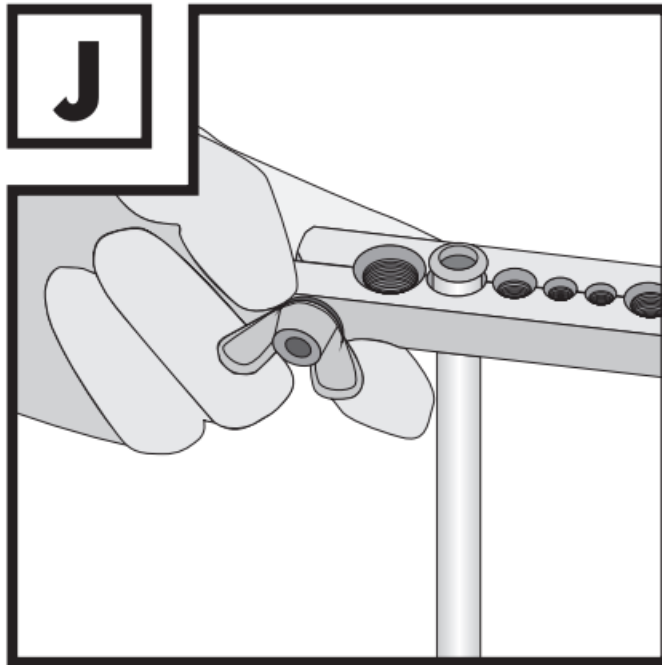

- Position the flaring tool with the cone point entering the tubing end and centered.

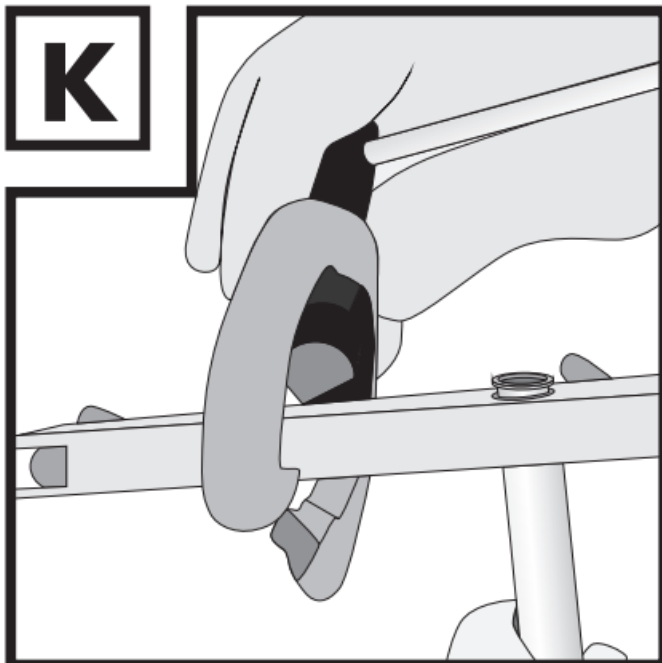

- Make sure the cone point is centered on the tube and the flaring tool is locked on the tubing clamp.

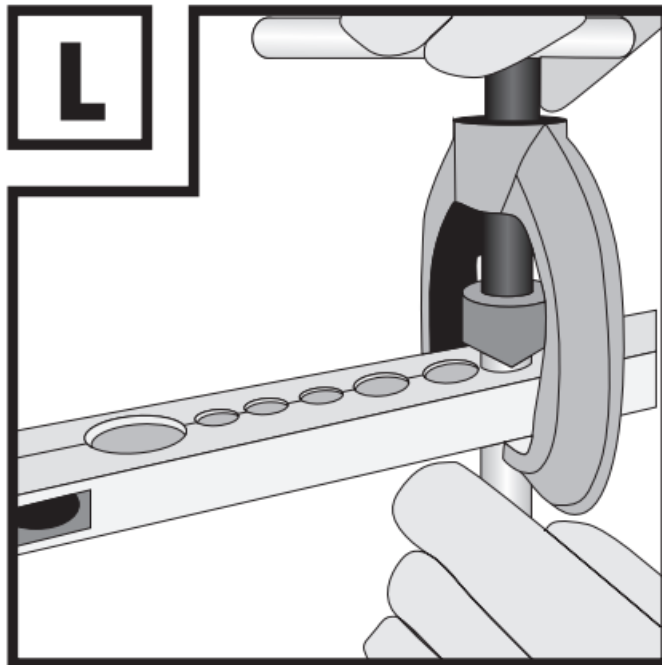

- Turn the screw clockwise and tighten until the cone is bottomed out completely.

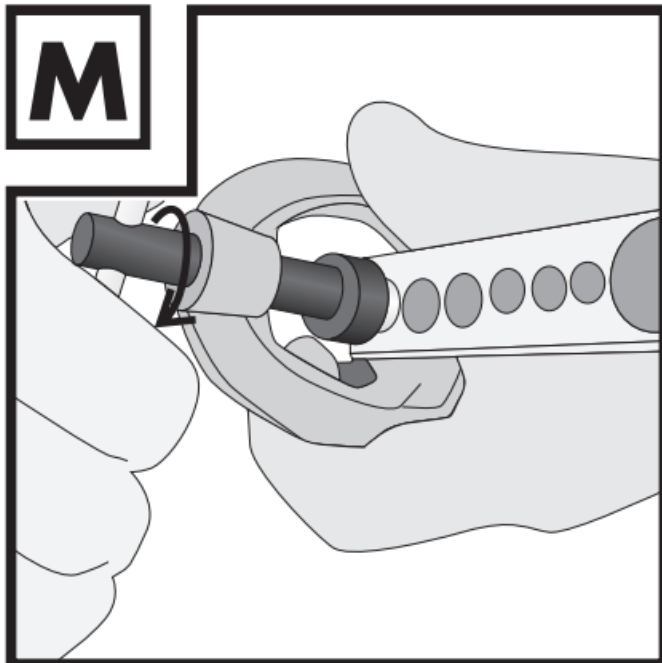

- Remove the flaring tool. Inspect the tubing end. The flare should be even all around with no cracks or gaps. Remove the tubing from the clamp.

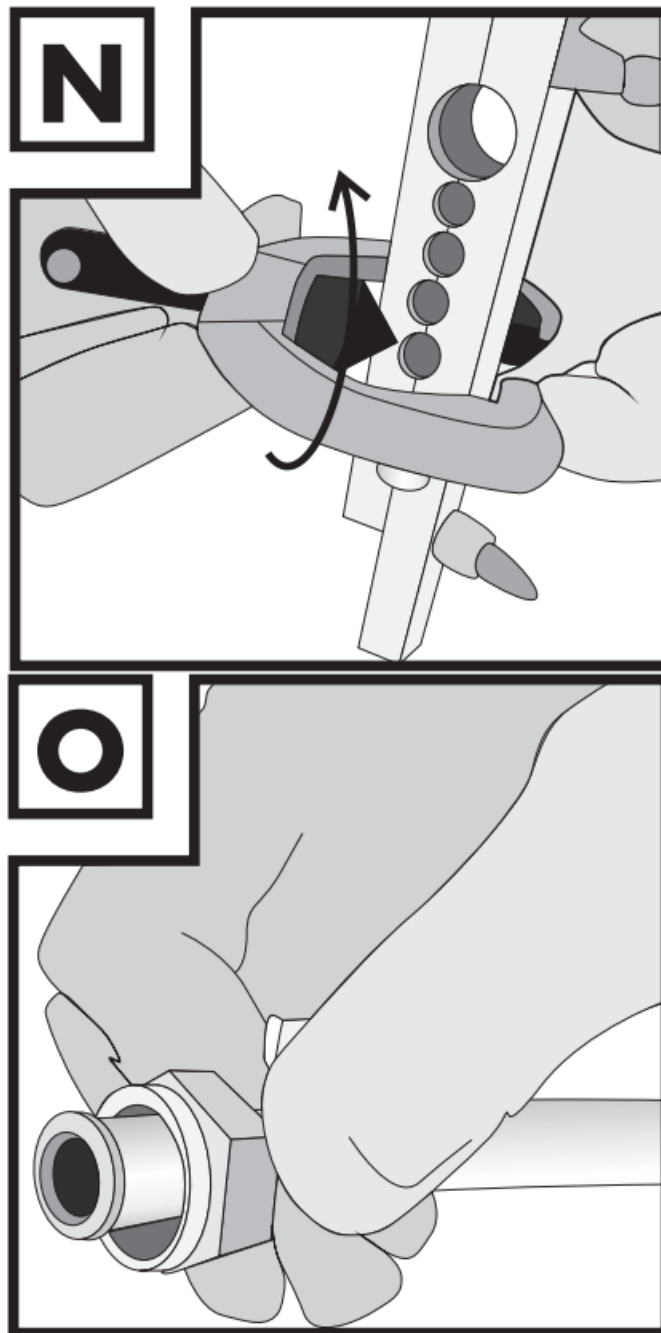

## Warranty

The product has been manufactured to strict quality guidelines and meticulously examined before delivery. In the event of material or manufacturing defects you have legal rights against the retailer of this product. Your legal rights are not limited in any way by our warranty detailed below.

The warranty for this product is 3 years from the date of purchase. The warranty period begins on the date of purchase. Keep the original sales receipt in a safe location as this document is required as proof of purchase. Any damage or defects already present at the time of purchase must be reported without delay after unpacking the product.

Should the product show any fault in materials or manufacture within 3 years from the date of purchase, we will repair or replace it – at our choice – free of charge to you. The warranty period is not extended as a result of a claim being granted. This also applies to replaced and repaired parts. This warranty becomes void if the product has been damaged, or used or maintained improperly.

The warranty covers material or manufacturing defects. This warranty does not cover product parts subject to normal wear and tear, thus considered consumables (e.g. batteries, rechargeable batteries, tubes, cartridges), nor

damage to fragile parts, e.g. switches or glass parts.

### Warranty claim procedure

To ensure quick processing of your claim, observe the following instructions: Make sure to have the original sales receipt and the item number (IAN 450945\_2310) available as proof of purchase.

You can find the item number on the rating plate, an engraving on the product, on the front page of the instruction manual (bottom left), or as a sticker on the rear or bottom of the product. If functional or other defects occur, contact the service department listed below either by telephone or by e-mail.

Once the product has been recorded as defective you can return it free of charge to the service address that will be provided to you. Ensure to enclose the proof of purchase (sales receipt) and a short, written description outlining the details of the defect and when it occurred.

### Service

- **Service Great Britain**

**Tel.:** 0800 0569216

**E-Mail:** [owim@lidl.co.uk](mailto:owim@lidl.co.uk)

- **Service Ireland**

**Tel.:** 1800 200736

- **Service Northern Ireland**

**Tel.:** 0800 0927852

**E-Mail:** [owim@lidl.ie](mailto:owim@lidl.ie)

IAN 450945\_2310  
OWIM GmbH  
& Co. KG  
Stiftsbergstraße 1  
74167 Neckarsulm  
GERMANY  
Model No.: HG04830D  
Version: 05/2024



**PDF ONLINE**

[www.lidl-service.com](http://www.lidl-service.com)

**Documents / Resources**



[PARKSIDE HG04830D For Checking Drills](#) [pdf] User Guide  
HG04830D For Checking Drills, HG04830D, For Checking Drills, Checking Drills, Drills

References

- [User Manual](#)

[Manuals+](#), [Privacy Policy](#)

This website is an independent publication and is neither affiliated with nor endorsed by any of the trademark owners. The "Bluetooth®" word mark and logos are registered trademarks owned by Bluetooth SIG, Inc. The "Wi-Fi®" word mark and logos are registered trademarks owned by the Wi-Fi Alliance. Any use of these marks on this website does not imply any affiliation with or endorsement.