



## Palintest Lumiso Expert Benchtop Kit User Guide

[Home](#) » [Palintest](#) » Palintest Lumiso Expert Benchtop Kit User Guide 

# Palintest

Water Analysis Technologies

**Lumiso Expert  
Quick Start Guide**



## Contents

- [1 Registration and technical support](#)
- [2 Getting started](#)
- [3 Achieving accurate results](#)
- [4 Documents / Resources](#)
  - [4.1 References](#)
- [5 Related Posts](#)

## Registration and technical support

Thank you for choosing a Palintest Lumiso Expert Photometer. Please register your instrument now at [www.palintest.com/products/lumiso-expert](http://www.palintest.com/products/lumiso-expert) or scan the QR Code.



There, you will also find invaluable support for your new instrument, including:

- User Manual
- Supporting documents for all test methods
- Firmware updates
- Palintest Connect cloud based data storage and management

## Getting started

Onscreen instructions are available for all test methods.

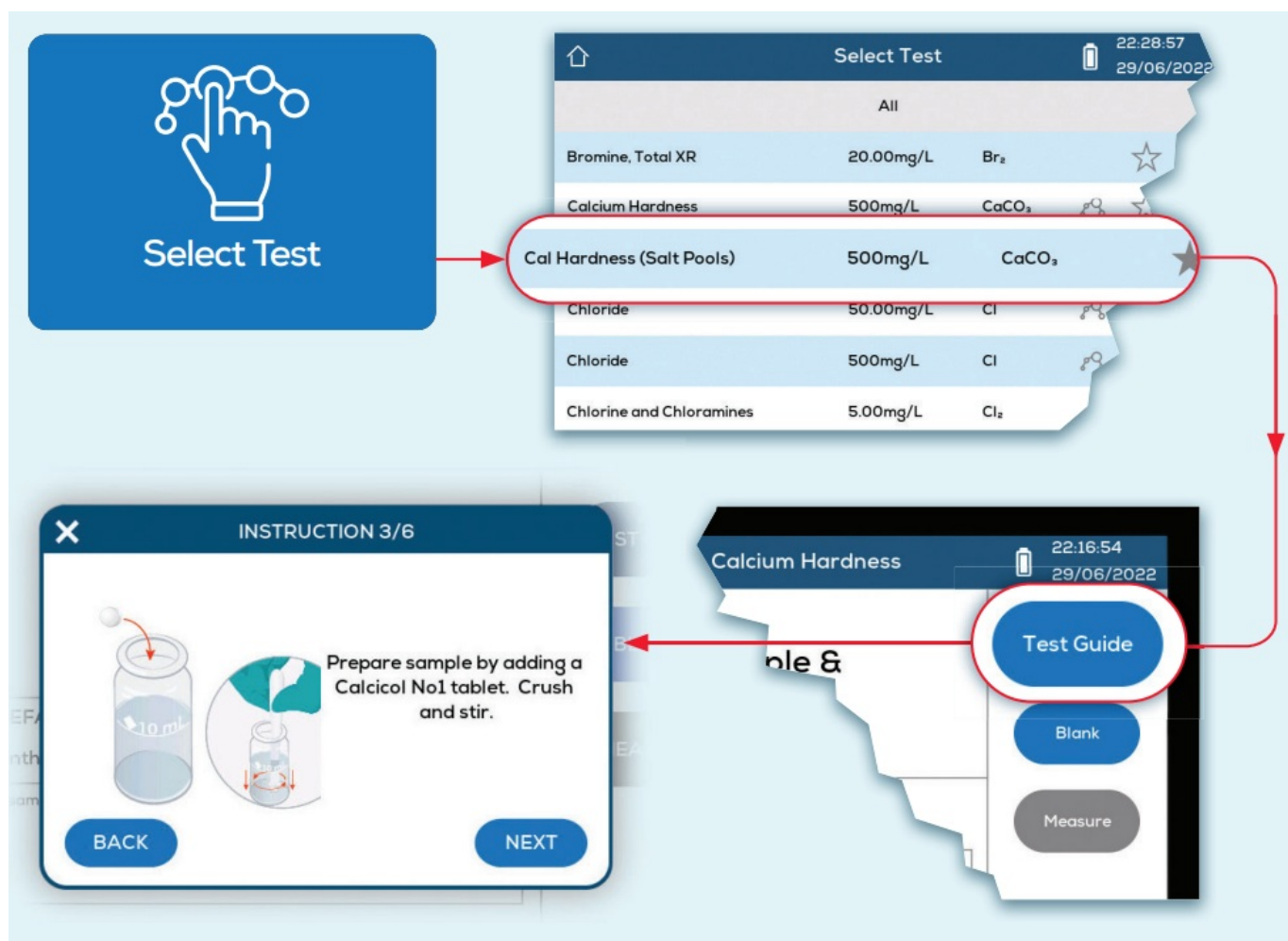

## Achieving accurate results

### Blanking

- Blanking is critical and sets the zero level for each test.
- Usually, the blank is a sample without any reagents added.
- The onscreen instructions show blanking as the first few steps, however, the “blank” can be prepared in a separate tube and blanking carried out just prior to the measurement step.

### Best practice when testing

Rinse equipment thoroughly with deionised water or the water being tested.



Measure volumes accurately as shown (or use a pipettor or syringe).

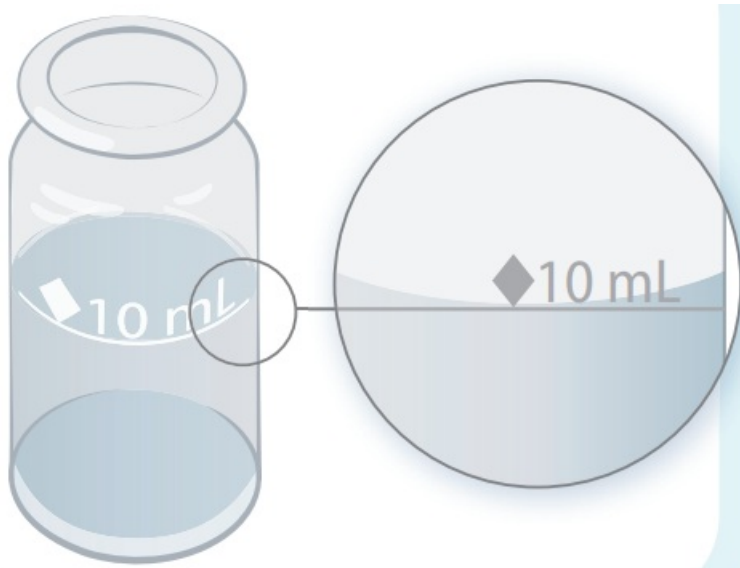

Use the correct Palintest reagents and observe all safety information supplied with them.



Check for bubbles and remove as shown.

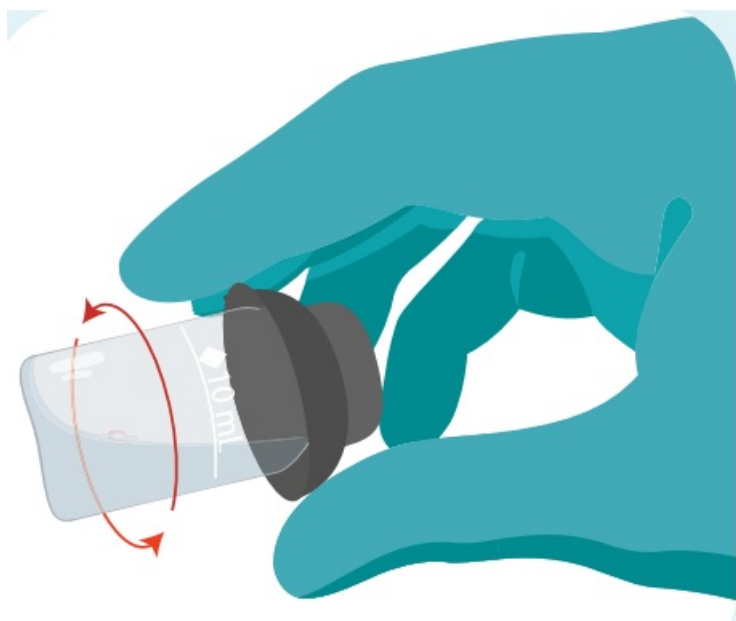

Align tubes as shown. Always use the tube cap as it excludes light from the optics.

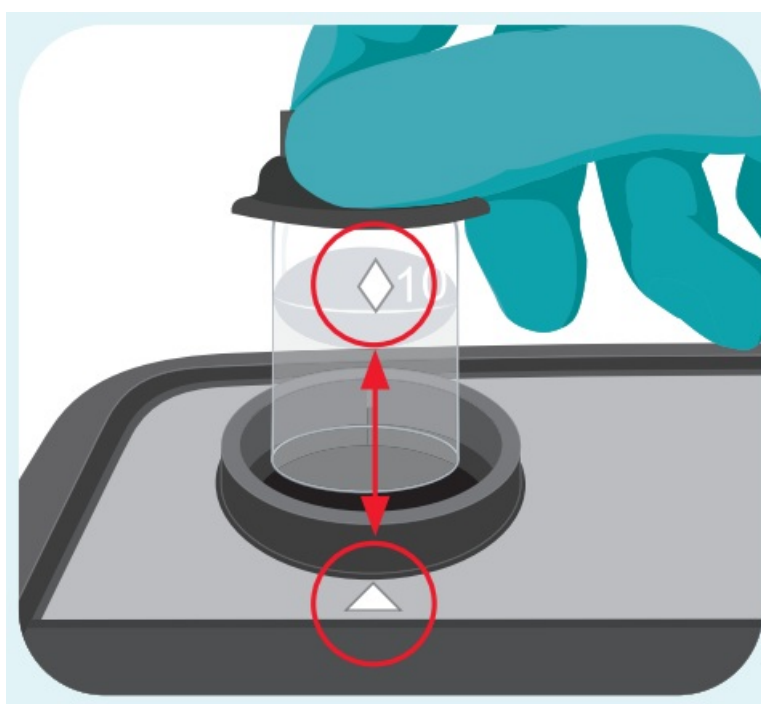

Keep instrument clean. Dry all tubes before placing in the optical cell.

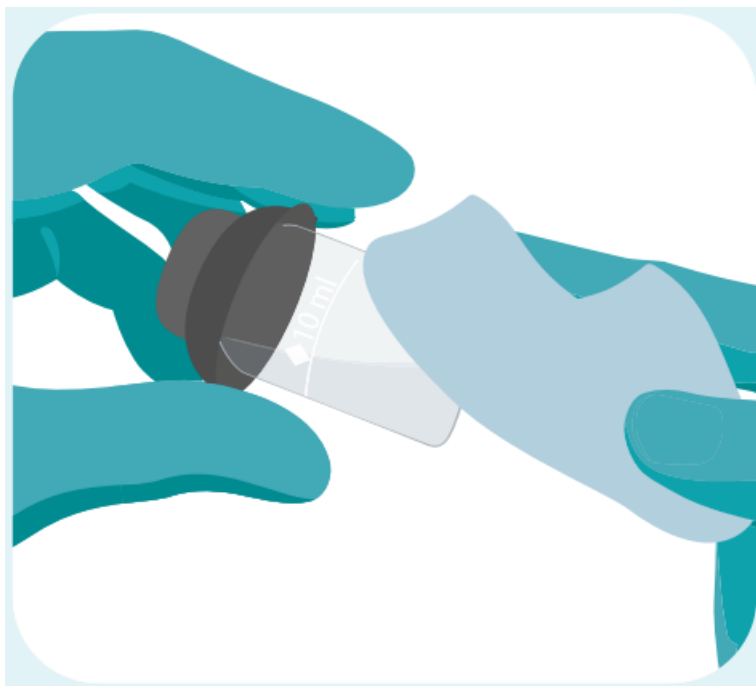

### Verify instrument calibration

Check Standards are available for your Lumiso Expert. Use these regularly to confirm that the instrument is within calibration.



[www.palintest.com](http://www.palintest.com)

**Palintest**  
Water Analysis Technologies

A Halma company

©Palintest Limited 2022. All rights reserved.

Registered office: Palintest House, Kingsway, Team Valley,  
Tyne & Wear, England NE11 0NS.

## Documents / Resources

 The image shows the cover of a Palintest Lumiso Expert Quick Start Guide. It features the Palintest logo at the top, followed by 'Lumiso Expert' and 'Quick Start Guide'. Below this, there are three lines of text in different languages: 'Guide de démarrage rapide', 'Guia de inicio rápido', and '快速入门指南'. At the bottom, there is a photograph of the Lumiso Expert Benchtop Kit, which is a small, dark-colored device with a screen and buttons.	<p><a href="#">Palintest Lumiso Expert Benchtop Kit</a> [pdf] User Guide Lumiso Expert Benchtop Kit, Expert Benchtop Kit, Benchtop Kit</p>
--	--

## References

- [P Palintest – Water Analysis Technologies](#)
- [P Palintest – Water Analysis Technologies](#)
- [P Water Analysis Products, Water Safety Testing Products - Palintest](#)
- [P Lumiso Expert - Palintest](#)