



---

[Home](#) » [PAKBRITE](#) » **PAKBRITE PakLite Mini High Output Taillight User Manual** 

**Contents** [ [hide](#) ]

- [1 PAKBRITE PakLite Mini High Output Taillight](#)
- [2 Specifications](#)
- [3 Installation](#)
- [4 Overview](#)
- [5 Key Features](#)
- [6 FAQs](#)
- [7 Documents / Resources](#)
  - [7.1 References](#)



## **PAKBRITE PakLite Mini High Output Taillight**



## Specifications

- **Weight:** 1.85 ounces or 54 grams
- **Dimensions:** H: 50mm x W: 50 mm x L: 36 mm
- **Light Modes:** 8 modes, including flash and steady on
- **Max Output:** 220 lumens
- **Run-Time:** Max steady on – 6 hrs, Max flash – 58 hrs
- **Smart Brake Sense:** Yes, on selected Flash modes
- **Battery Level Calculator:** Yes
- **Low Battery Indicator:** Yes
- **Low Power Mode:** Yes, below 15% battery power
- **Certifications:** IP67 waterproof & dustproof
- **Charging Method:** USB-C
- **Seat Post Compatibility:** Cylindrical 25-33mm, Aero, D-shaped
- **Battery Type:** 1000mAh Lithium-Ion

## Installation

- Install Rubber Insert

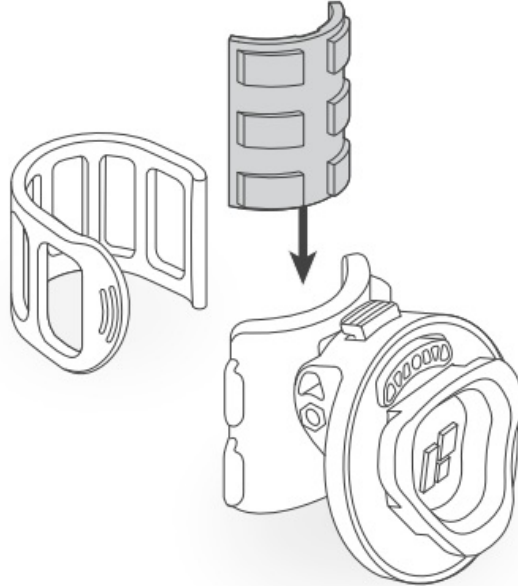
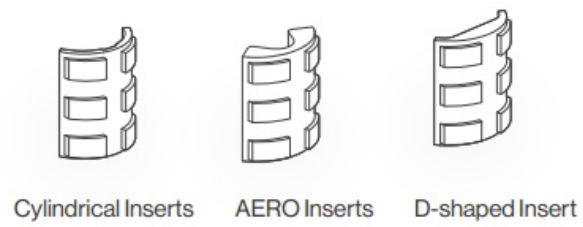

- Install Mount

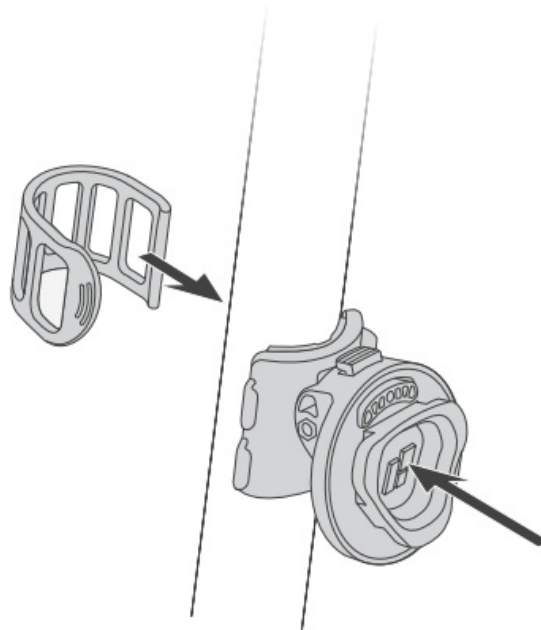

Top View

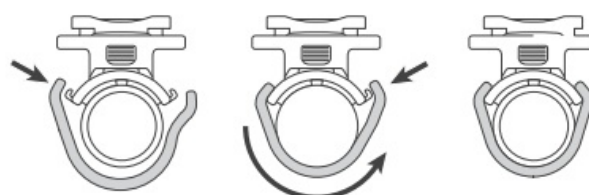

- Adjust Mount Angle

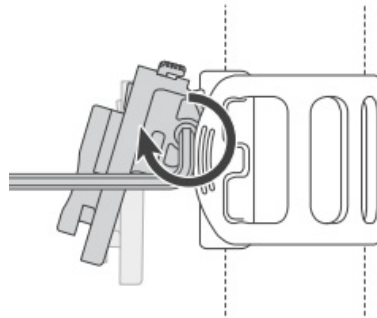
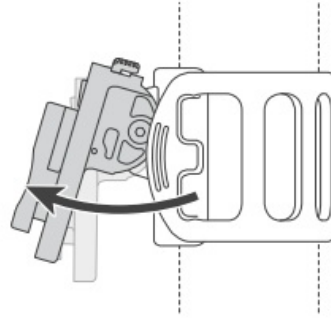
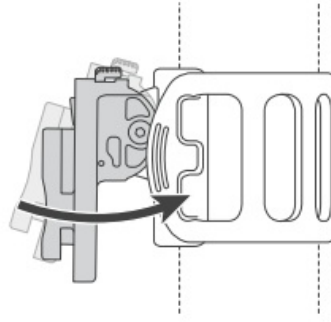

- Attach PakLite to the Mount

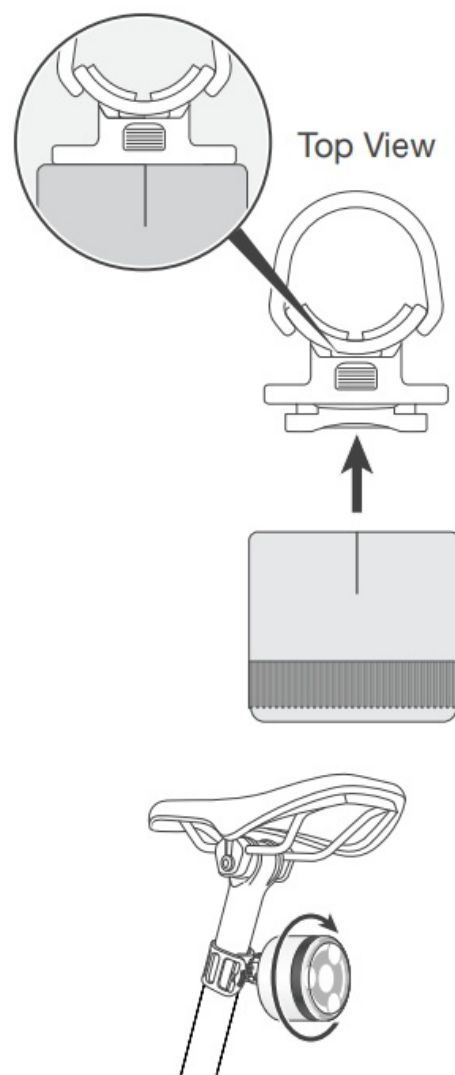

- Power On Light



### Switch Between Modes



- Battery Calculator

Light Must be OFF

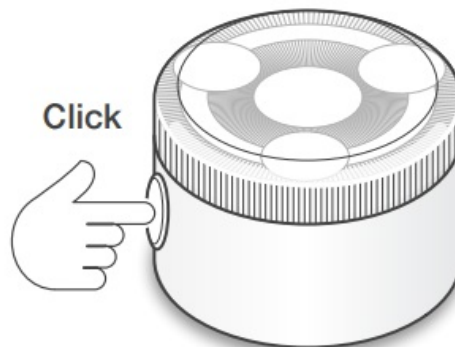

- 1-4x = remaining battery power

- Reading the Battery Calculator
  - C) blinks. Beloww 15% remaining.
  - 1 blink. Below 40% remaining.
  - 2 blinks. Below 65% remaining.
  - 3 blinks. Below 90% remaining.
  - 4 blinks. 90% and ABOVE remaining.
- Activate Auto On/Off

Light Must be ON



**3 Blinks = activated**

Now, power-on Paklite Mini to continue using

- Now, power on the Paklite Mn to continue using
- Now, power on the Paklite Mini to continue using

Deactivate Auto On/Off



**2 Blinks = Deactivated**

When Auto ON/OFF mode is activated, the PakLite Mini will turn off automatically after 60 seconds of no movement. Shake or continue riding to wake it up!

- Charging

## Charging

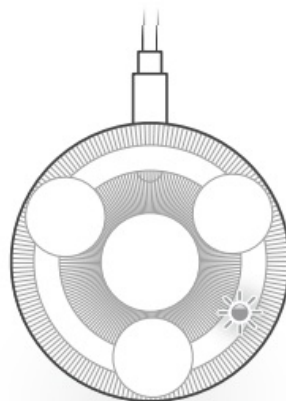
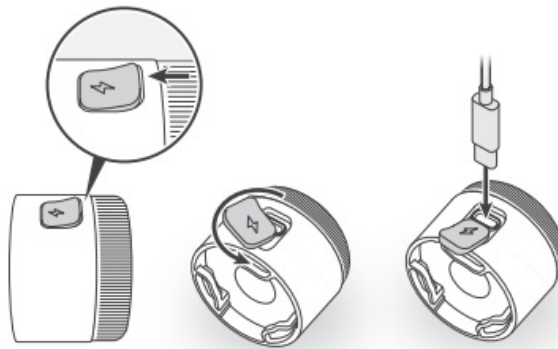

Light on = Charging  
Light off = Complete

	Steady On		Flash					
Light Modes	1	2	3	4	5	6	7	8
Lumen Power	70	35	110	220	110	220	110	220
Run-Time	6 hrs	22.5 hrs	20 hrs	7.5 hrs	29 hrs	11 hrs	58 hrs	22.5hrs
Brake Sensing			✓		✓		✓	
Flash Per Sec.			3 Flashes per second		2 Flashes per second		1 Flashes per second	

## Overview

The PakLite Mini is a high-output rear safety light that allows for easy installation and customization with other PakBrite products. Designed to enhance visibility on the road. Also works with Tri-Fin Seat Post Mount and Tri-Fin Saddle Mount.



## Key Features

- 220 Lumen LED Rear Safety Light.
- Advanced Electronic Features.
- Made from Nylon Glass for strength and weight savings.
- USB-C fast charging with up to 58 hours of battery life.
- IP67 Waterproof and Dustproof design.

## General Warnings

The PakLite Mini rear safety light is designed to enhance visibility and increase situational awareness while cycling. However, it is not a substitute for being alert and exercising caution on the road. Always operate your bicycle safely and responsibly, obeying traffic laws and staying aware of your surroundings. Failure to do so can result in serious injury or death.

## Legal Disclaimer

PakBrite assumes no liability for accidents or injuries resulting from improper use of the PakLite Mini. Use this product responsibly and in compliance with local cycling regulations. PakBrite is not liable for any injuries, damages, or accidents resulting from the misuse, improper installation, or unauthorized modifications of this product. The user assumes full responsibility for ensuring that the product is used and maintained according to the instructions and safety guidelines provided. By using this product, you agree to the terms outlined in this warning and the product manual.

## Usage Compliance

The PakLite Mini is designed for use on bicycles only. Misuse of this product or modification of its components will void any warranty.

## Warning

This product contains electronic components that may pose a risk of electric shock, fire, or injury if not used and handled properly. Follow all safety instructions and guidelines provided.

## Do Not Disassemble

Attempting to access, modify, or disassemble the internal electronics, battery, or

components of this device may result in damage, malfunction, injury, or electric shock. Any unauthorized tampering will void the warranty.

### **Avoid Water Damage**

Although this product is rated IP67 waterproof, it is not intended for long-term submersion in water. Ensure the charging port is properly sealed before exposure to rain or wet environments. Do not use or charge the product if it is wet or has been submerged in water.

### **Charging Safety**

Only use the supplied IJSB-C charging cable or an approved equivalent. Charging the product with an incompatible power source can lead to overheating, fire, or electric shock. Do not charge the device in unattended environments with temperatures.

**Notice:** Always ensure the light is properly charged and mounted before each ride. Do not look directly into the LED light, as it may cause eye discomfort or damage.

### **Battery Warning**

This device contains a rechargeable lithium-ion battery. Improper use, charging, or disposal of lithium-ion batteries may result in fire, explosion, or injury. Do not crush, puncture, incinerate, or short-circuit the battery.

### **Temperature Warning**

Do not expose the product to temperatures above 500 °C (1220°F) or below -1CC 140°F. Excessive heat or cold can damage the internal electronics and battery, leading to potential hazards.

### **Eye Safety**

The LED light in this device is extremely bright. Do not look directly into the light when it is powered on, as this may cause eye discomfort or injury. Keep away from children's reach.

### **Road Safety**

Always use this product by local traffic laws and regulations. Ensure the device is properly mounted and does not obstruct visibility while cycling.

## ENVIRONMENTAL HAZARD

Do not dispose of this electronic product or battery with regular household waste. Follow local electronic recycling guidelines for proper disposal. For additional safety information or assistance, please refer to the full user manual or contact our support team at [support@pakbritegear.com](mailto:support@pakbritegear.com).

## WARRANTY

**HARDWARE AND ELECTRONICS COVERAGE** PakBrite is committed to delivering top-tier performance and reliability in all our hardware and electronic cycling products. We offer a two-year warranty from the original purchase date on all our bicycle hardware, lights, and electronic products, covering any defects in materials or workmanship.

## NOT COVERED

Normal wear and tear (scratches, scuffs, fading, etc.), Damage caused by improper use, accidents, or negligence. Attempts to access, modify, or tamper with electronics or batteries. Water damage resulting from submersion beyond specified limits.

## FAQs

Q: Can the PakLite Mini be used in wet conditions?

A: While it is IP67 waterproof, it is not intended for long-term submersion. Ensure the charging port is sealed before exposure to rain or wet environments.

Q: How should I charge the PakLite Mini?

A: Only use the supplied USB-C charging cable or an approved equivalent. Do not leave the device unattended while charging.

Q: Is the PakLite Mini suitable for all types of bicycles?

A: The PakLite Mini is designed for use on bicycles and is compatible with cylindrical, aero, and D-shaped seat posts.

# Documents / Resources

	<p><a href="#">PAKBRITE PakLite Mini High Output Taillight [pdf]</a> User Manual</p> <p>PakLite Mini High Output Taillight, PakLite Mini, High Output Taillight, Output Taillight, Taillight</p>
	<p><a href="#">PAKBRITE PakLite Mini High Output Taillight [pdf]</a> User Manual</p> <p>PakLite Mini High Output Taillight, PakLite Mini, High Output Taillight, Output Taillight, Taillight</p>

## References

- [User Manual](#)

High Output Taillight, Output Taillight, PAKBRITE, PakLite Mini, PakLite Mini High Output Taillight, PAKBRITE Taillight

## Leave a comment

Your email address will not be published. Required fields are marked \*

Comment \*

Name

Email

Website

☐ Save my name, email, and website in this browser for the next time I comment.

**Post Comment**

**Search:**

**Search**

[Manuals+](#) | [Upload](#) | [Deep Search](#) | [Privacy Policy](#) | [@manuals.plus](#) | [YouTube](#)

This website is an independent publication and is neither affiliated with nor endorsed by any of the trademark owners. The "Bluetooth®" word mark and logos are registered trademarks owned by Bluetooth SIG, Inc. The "Wi-Fi®" word mark and logos are registered trademarks owned by the Wi-Fi Alliance. Any use of these marks on this website does not imply any affiliation with or endorsement.