



## PAC LPA-E4 Active Line Output Converter Installation Guide

[Home](#) » [PAC](#) » PAC LPA-E4 Active Line Output Converter Installation Guide 

### Contents

- [1 PAC LPA-E4 Active Line Output Converter](#)
- [2 Product Information](#)
- [3 Product Usage Instructions](#)
- [4 Wiring Connection Chart \(All Models\)](#)
- [5 Example Installation – 4-Channel Amplifier – \(HARNESS CUT REQUIRED\)](#)
- [6 Example Installation – Mono Amplifier – \(HARNESS CUT NOT REQUIRED\)](#)
- [7 ANC vs Amplifier](#)
- [8 ANC / Amp Location 2019+ RAM 1500](#)
- [9 ANC / Amp Location 2019+ RAM 2500/3500](#)
- [10 ANC / Amp Location Jeep Cherokee](#)
- [11 ANC / Amp Location Chrysler Pacifica](#)
- [12 ANC Location 2015-2016 Grand Cherokee](#)
- [13 Documents / Resources](#)
- [14 Related Posts](#)



**PAC LPA-E4 Active Line Output Converter**



## Product Information

The LPH Harness is a wiring harness that comes with an inline fuse installed. It is designed to work with OEM NON-AMPLIFIED systems and connects aftermarket amplifiers to the vehicle's audio system. It comes with a wiring connection chart that includes instructions for installation of both 4-channel and mono amplifiers. The LPH Harness uses DC Offset to turn on and trigger the REM OUT on the LPA. It can be used with or without a RED wire depending on whether the vehicle provides an ACC source.

The ANC Module and Amplifier are two components that can be connected with the LPH Harness. The ANC Module is located under the driver's seat of the 2019+ RAM 1500, above the glove box in a Jeep Cherokee, right of the glove box/above passenger kick in a Chrysler Pacifica, and behind the right quarter trim panel in a 2015-2016 Grand Cherokee. The Amplifier is located in the vehicle and is actually black in color.

## Product Usage Instructions

Before installing the LPH Harness, remove the inline fuse that comes with it and reinsert it once installation is complete.

If your vehicle does not provide ACC source, your harness will not have a RED wire to connect. Instead, it will use DC Offset to turn on and trigger the REM OUT on the LPA. On LPA-E4, there will be a jumper that you can move based on your application.

To install a 4-channel amplifier, cut the OEM radio harness and connect the loose wires from the LPH Harness to the radio connection. Connect the RCA and REM OUT from LPA to the aftermarket amplifier. For a mono amplifier, do not cut the OEM radio harness. Instead, connect the loose wires from the LPH Harness to the radio connection and connect the RCA and REM OUT from LPA to the aftermarket amplifier.

Make sure to fully open terminals before inserting wires and use the RED BUTT Connector to connect to your aftermarket system turn on for your amplifiers.

## Wiring Connection Chart (All Models)

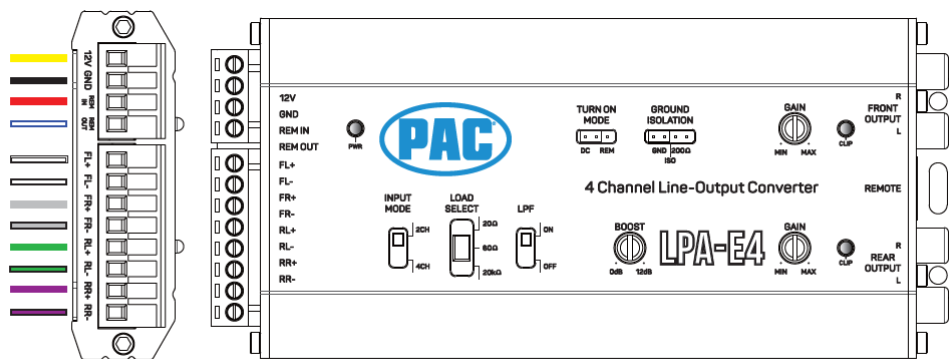

## MODELS:

- LPA-E4
- LPA2.4 / LPA2.2
- LPA1.4 / LPA1.2

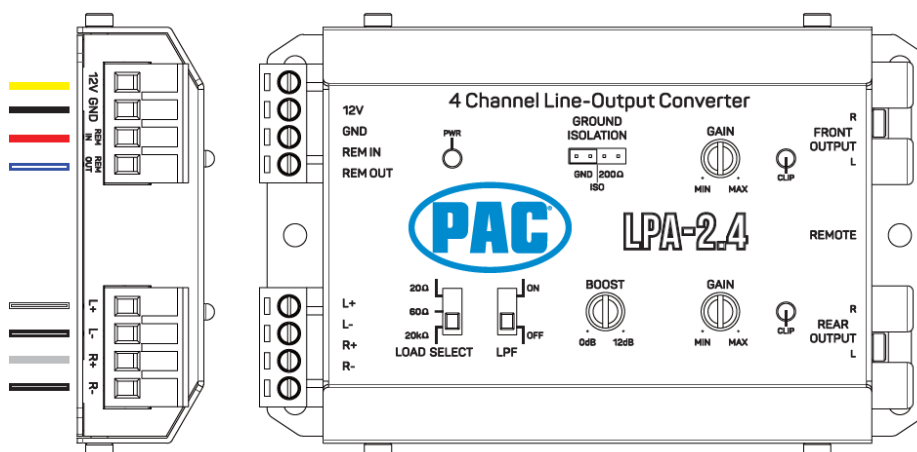

**Important Note:** This harness is provided with a inline fuse installed. Please remove prior to install and reinsert once finished.

If your vehicle does not provide ACC source your harness will not have a “RED” wire to connect.

It will use DC Offset to turn on as well as trigger the “REM OUT” on the LPA. On LPA-E4 there will be a jumper that you can move based on your application.

This harness is designed to work on OEM NON-AMPLIFIED systems.

Connect the RED BUTT Connector to the aftermarket system turn on for your amplifiers.

Wire Color	Function
Yellow	Constant 12V +
Black	Ground
Red	ACC / Rem Input
Blue/White	Amp Turn On +
White	Front Left +
White/Black	Front Left -
Gray	Front Right +
Gray/Black	Front Right -
Green	Rear Left +
Green/Black	Rear Left -
Purple	Rear Right +
Purple/Black	Rear Right -

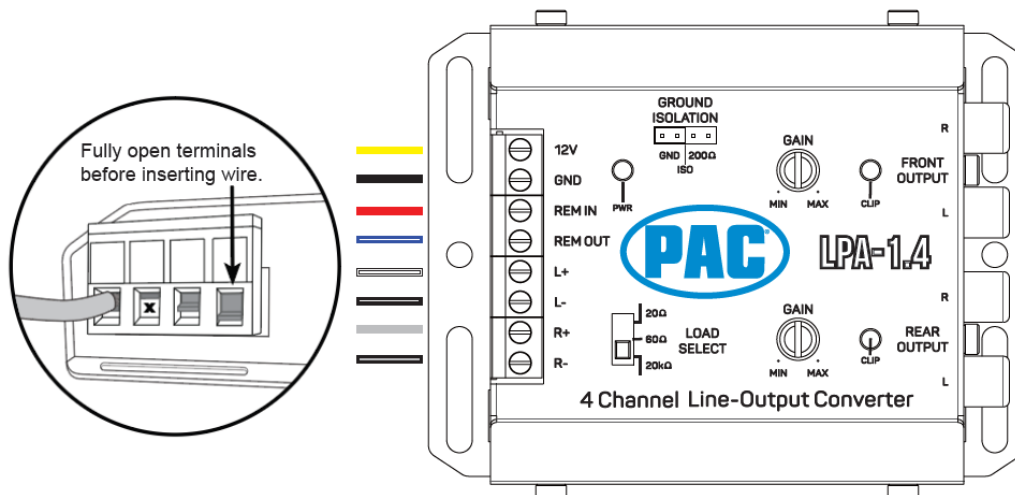

### Example Installation – 4-Channel Amplifier – (HARNESS CUT REQUIRED)

- Cut the harness close as possible to the "CUT HERE AND INSULATE" label. You must insulate wires to prevent damage to OEM radio.
- The cut speaker wires will need to be connected to your aftermarket amplifier. (REFER TO LABEL ON HARNESS)
- Please refer to the chart on the first page for wiring your loose wires to your LPA.
- This harness is designed to work on OEM NON-AMPLIFIED systems.

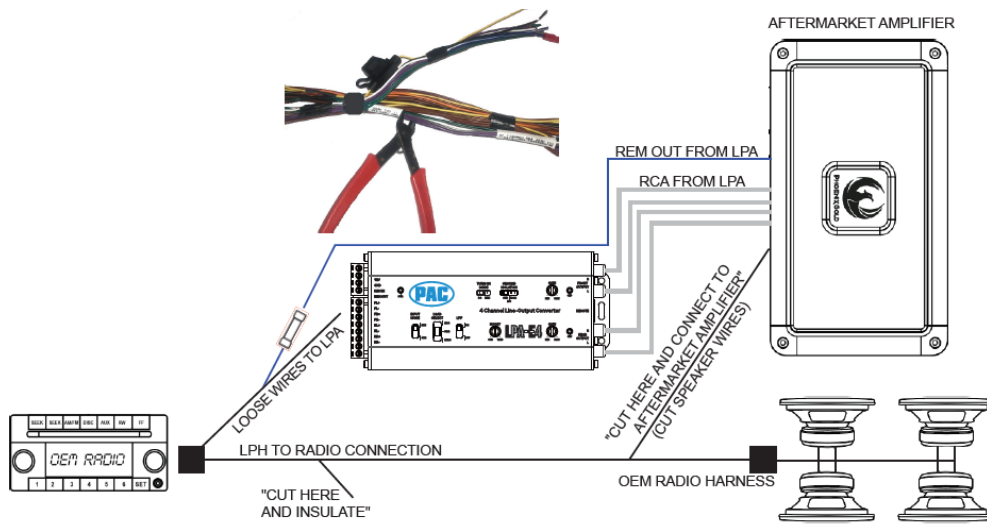

## Example Installation – Mono Amplifier – (HARNESS CUT NOT REQUIRED)

- If using a 2-Channel input LPA use the front speaker wires and insulate the remaining rear speaker wires.
- DO NOT CUT the speaker wires in-between the “CUT HERE” Labels in order to keep the factory speakers functional.
- This harness is designed to work on OEM NON-AMPLIFIED systems.

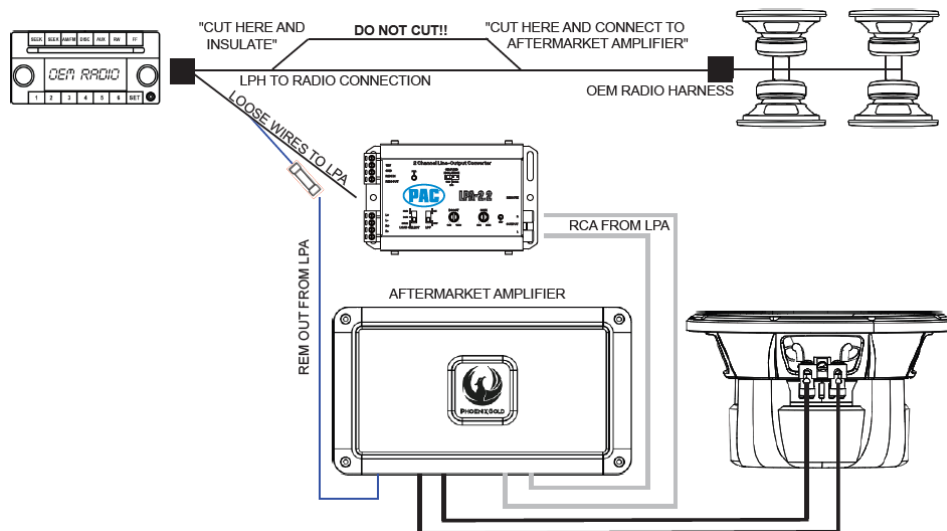

© 2021 AAMP Global.

All rights reserved.

PAC is a Power Brand of AAMP Global. [PAC-audio.com](http://PAC-audio.com)

## ANC vs Amplifier

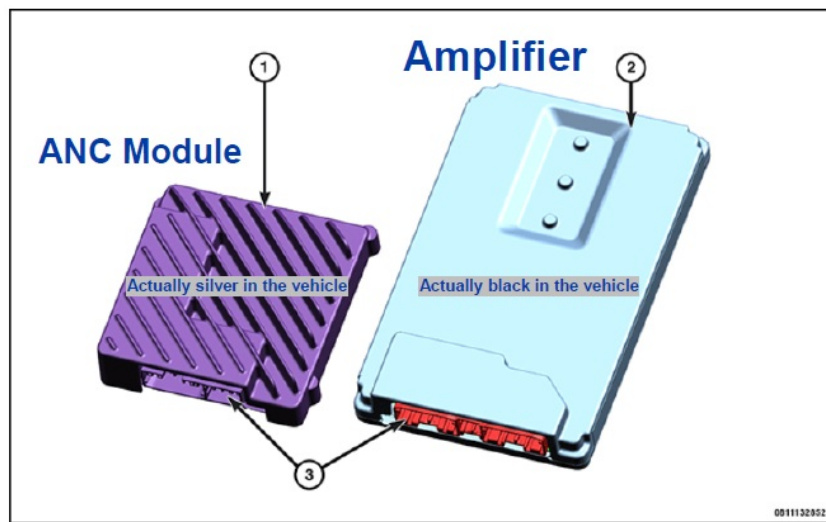

- Amp is larger/Black
- ANC is small/Silver
- Amp has 3 plugs
- ANC has 2 plugs

#### ANC / Amp Location 2019+ RAM 1500

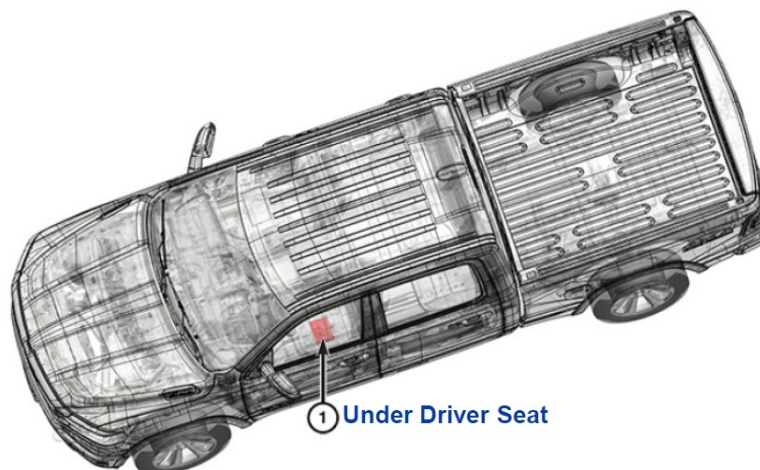

#### ANC / Amp Location 2019+ RAM 2500/3500

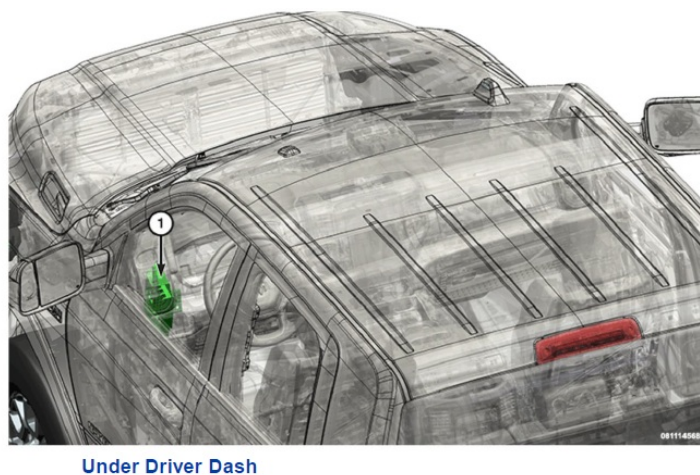

#### ANC / Amp Location Jeep Cherokee



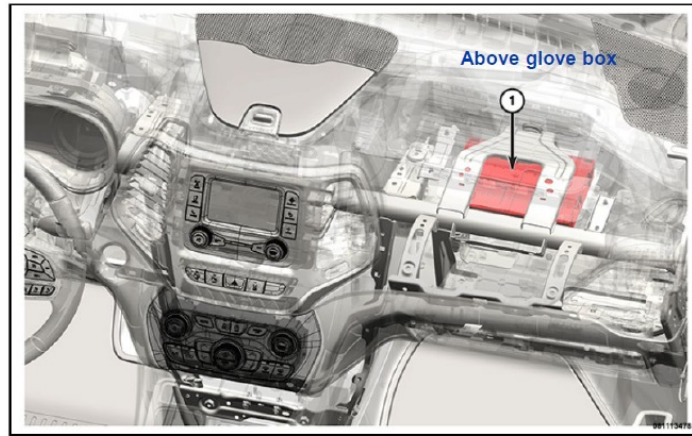

## ANC / Amp Location Chrysler Pacifica

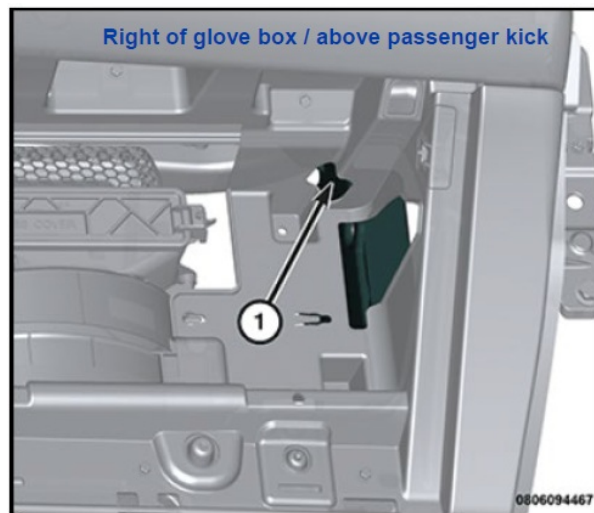

## ANC Location 2015-2016 Grand Cherokee

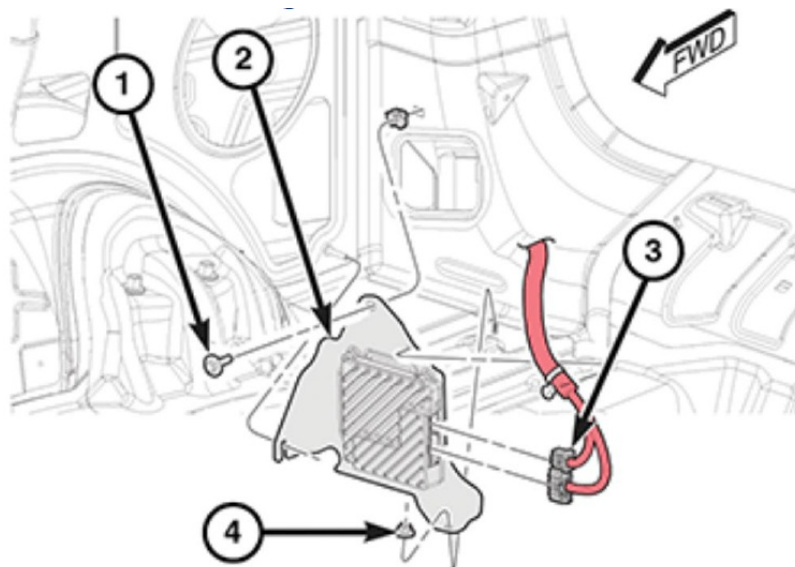

©2018 AAMP Global • All Rights Reserved.

**Documents / Resources**

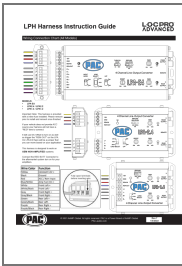

[PAC LPA-E4 Active Line Output Converter](#) [pdf] Installation Guide  
LPA-E4 Active Line Output Converter, LPA-E4, Active Line Output Converter, Line Output Converter, Output Converter, Converter