

Pablo Circa LED Ceiling Lamp Instruction Manual

[Home](#) » [Pablo](#) » Pablo Circa LED Ceiling Lamp Instruction Manual 

Contents

- [1 Pablo Circa LED Ceiling Lamp](#)
- [2 Product Information](#)
- [3 Product Usage Instructions](#)
- [4 CIRCA FLUSH MODELS](#)
- [5 COMPONENT LIST](#)
- [6 Documents / Resources](#)
 - [6.1 References](#)

Pablo®

Pablo Circa LED Ceiling Lamp



Product Information

The product is called CIRCA FLUSH, a 120V fixture designed for installation on ceilings or walls. It is available in

the color black. The assembly and installation instructions for this product can be found on page 33 of the user manual.

The CIRCA FLUSH model comes in four configurations:

1. CIRCA FLUSH DIRECT (CEILING MOUNTED)
2. CIRCA FLUSH INDIRECT (CEILING MOUNTED)
3. CIRCA FLUSH DIRECT (WALL MOUNTED)
4. CIRCA FLUSH INDIRECT (WALL MOUNTED)

Note that the instructions provided in the manual demonstrate the installation process for the CIRCA FLUSH DIRECT CEILING MOUNTED configuration. However, the same instructions can be followed for all the configurations listed above.

The product includes the following components:

- **A** TRANSFORMER
- **B** MOUNTING PLATE
- **C** JUNCTION BOX SCREWS
- **D** CANOPY SCREWS
- **E** CANOPY COVER
- **F** LAMP HEAD

For any inquiries, you can contact the manufacturer at INFO@PABLODESIGNS.COM or visit their website at PABLODESIGNS.COM.

Product Usage Instructions

1. Connect the building wiring to the 2-pole connector on the AC input side of the transformer.
 - Ensure the wire colors match across the two-pole connector.
 - **Wire Colors:** White (AC input), Black (AC input)
2. Connect the fixture wiring on the mounting plate to the 2-pole connector on the DC output side of the transformer.
 - Ensure the wire colors match across the two-pole connector.
 - **Wire Colors:** Red (DC output), Black (DC output)
3. Tuck the transformer and wiring into the junction box and screw the mounting plate into the junction box using the provided machine screws.
4. Fasten the canopy cover to the mounting plate using the provided machine screws. Ensure the transformer is positioned with the sticker facing out.
5. To assemble the fixture head, hold the outside of the shade with both hands and screw it into the canopy assembly.
6. If bulb replacement is required, use an LED flat-panel bulb. Contact the manufacturer for specific instructions on bulb replacement. An electronic low-voltage dimmer is recommended for this product.

IMPORTANT: WE RECOMMEND FIXTURE BE INSTALLED BY AN ELECTRICIAN

WARNING: FIXTURE MUST BE WIRED CORRECTLY OR RISK DAMAGE TO COMPONENTS

CIRCA FLUSH MODELS

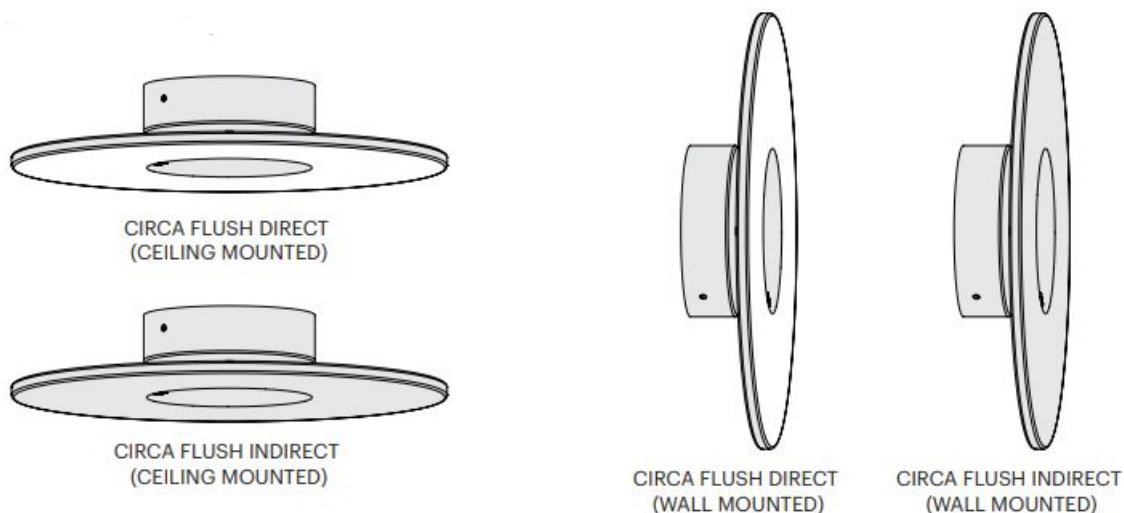

NOTE: INSTRUCTIONS SHOW INSTALLATION OF CIRCA FLUSH DIRECT CEILING MOUNTED, FOLLOW THE SAME INSTRUCTIONS FOR ALL CONFIGURATIONS LISTED ABOVE

COMPONENT LIST

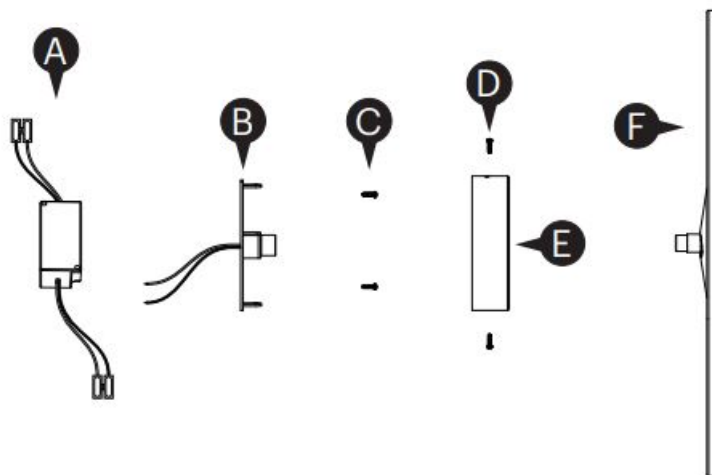

- **A** TRANSFORMER
- **B** MOUNTING PLATE
- **C** JUNCTION BOX SCREWS
- **D** CANOPY SCREWS
- **E** CANOPY COVER
- **F** LAMP HEAD

1. CONNECT BUILDING WIRING TO 2 POLE CONNECTORS ON THE AC INPUT SIDE OF TRANSFORMER

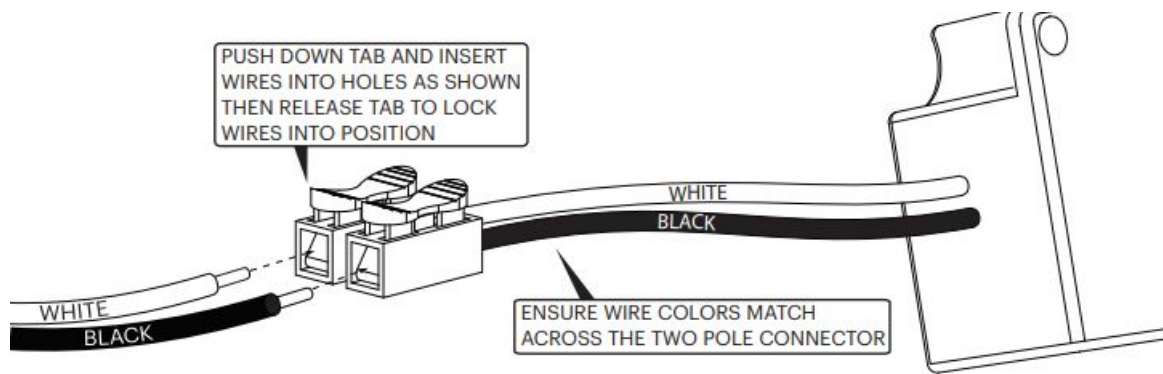

2. CONNECT FIXTURE WIRING ON MOUNTING PLATE TO 2 POLE CONNECTOR ON DC OUTPUT SIDE OF TRANSFORMER

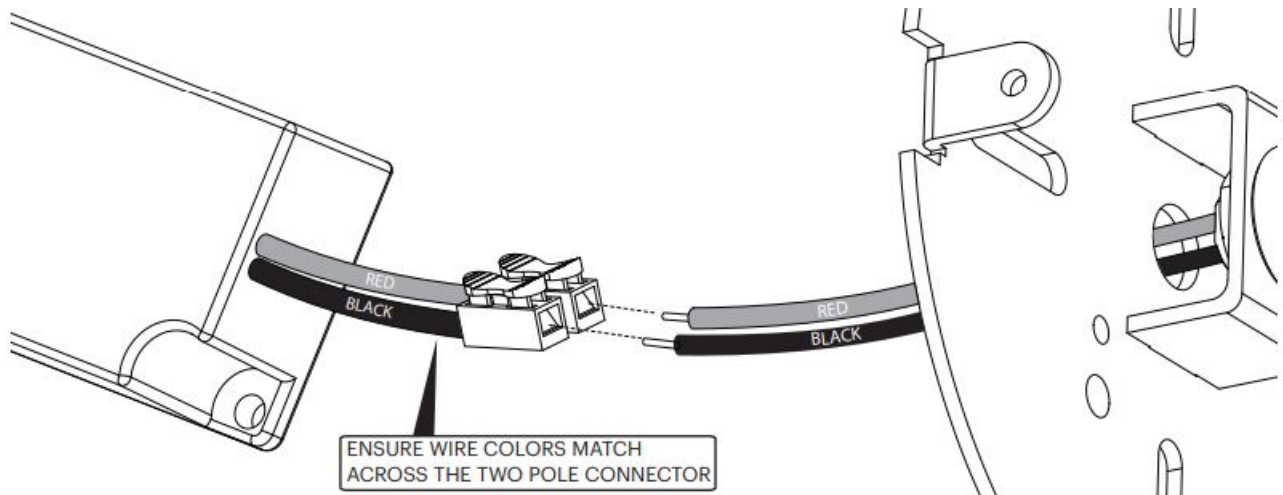

3. TUCK TRANSFORMER AND WIRING INTO JUNCTION BOX AND SCREW MOUNTING PLATE INTO JUNCTION BOX USING PROVIDED MACHINE SCREWS

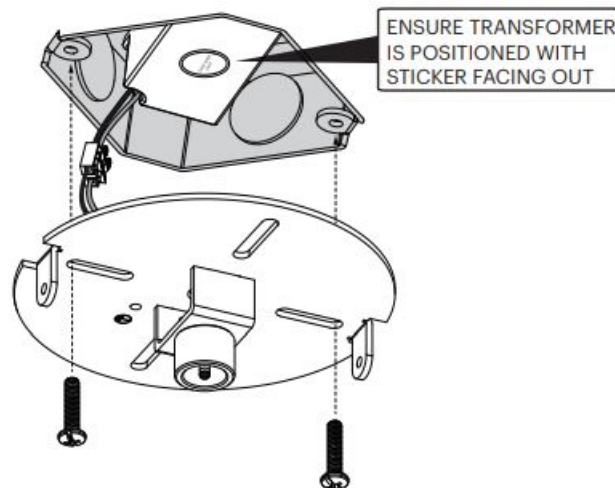

4. FASTEN CANOPY COVER TO MOUNTING PLATE USING PROVIDED MACHINE SCREWS

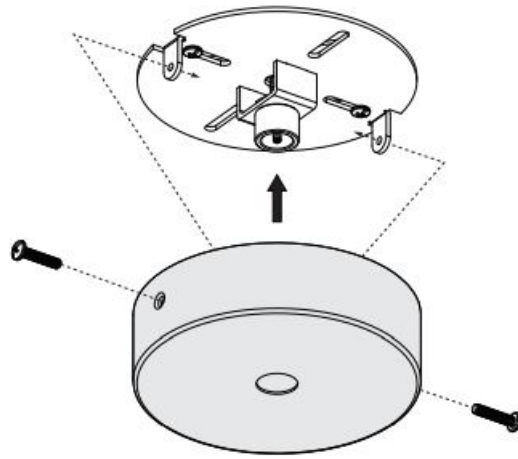

5. HOLD OUTSIDE OF SHADE WITH BOTH HANDS AND SCREW FIXTURE HEAD INTO CANOPY ASSEMBLY

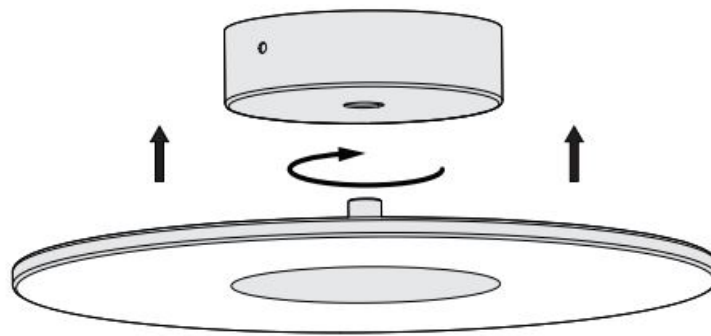

BULB TYPE

- LED FLAT PANEL

BULB REPLACEMENT

- CONTACT MANUFACTURER
- FOR BULB REPLACEMENT

ELECTRONIC

- LOW VOLTAGE DIMMER
- RECOMMENDED
- INFO@PABLODESIGNS.COM
- 888 MARIN STREET
- SAN FRANCISCO, CA
- 94124
- PABLODESIGNS.COM

Documents / Resources

