



# P.C. Richard & Son GDR50A1C Generations Dehumidifier User Manual

[Home](#) » [P.C. Richard & Son](#) » P.C. Richard & Son GDR50A1C Generations Dehumidifier User Manual 

## Contents

- [1 P.C. Richard & Son GDR50A1C Generations Dehumidifier User Manual](#)
- [2 IMPORTANT SAFETY INFORMATION READ ALL INSTRUCTIONS BEFORE USING](#)
- [3 GROUNDING INSTRUCTIONS](#)
- [4 UNIT SPECIFICATIONS](#)
- [5 FEATURES](#)
- [6 OPERATING INSTRUCTIONS](#)
- [7 AIR FILTER](#)
- [8 TROUBLESHOOTING GUIDE](#)
- [9 GENERATIONS™ – One-Year Limited Warranty](#)
- [10 Related Posts](#)



P.C. Richard & Son GDR50A1C Generations Dehumidifier User Manual



### **KEEP THESE INSTRUCTIONS FOR FUTURE REFERENCE**

If the unit changes ownership, be sure this manual accompanies the unit

### **WARNING**

Read and follow all safety rules and operating instructions before first using this product.

Thank you for choosing a Generations appliance. This Owner's Use and Care Guide will provide you with important safety information and information necessary for the proper care and maintenance of your new appliance. Please read the important safety information and instructions thoroughly and familiarize yourself with all of the operational aspects of this appliance. Your Generations Portable Dehumidifier is a multi-functional room air-exchanging, air-processing appliance, designed to offer you the functions of Dehumidifying, and Independent Fan. Each individual mode is featured with "oscillating" air swing capabilities. This unit can be conveniently moved from room to room within your home and set up in just minutes. Imagine the convenience of 4 Season Home Comfort at your fingertips, anywhere, anytime. For easy reference, may we suggest you attach a copy of your sales slip/receipt to this page, along with the following information, located on the manufacturer's nameplate on the rear panel of the unit?

This information will be necessary if your unit requires servicing and/or for general inquiries. To contact a Customer Service Representative, call P.C. Richard & Son Service TOLL-FREE: 1-800-696-2000

**KEEP THESE INSTRUCTIONS FOR FUTURE REFERENCE.**

### **IMPORTANT SAFETY INFORMATION READ ALL INSTRUCTIONS BEFORE USING**

### **WARNING**

For your safety, the information in this manual must be followed to minimize the risk of fire, electric shock, or personal injury. The instructions issued in this manual are not meant to cover all possible conditions and situations that may occur. It must be understood that common sense, caution, and care must be used when installing operating or maintaining any appliance. Failure to install, maintain, and/or operate the equipment according to these instructions may result in conditions that can produce bodily injury and/or property damage.

### **FOR YOUR SAFETY**

- Turn the dehumidifier OFF and unplug it before cleaning.
- To reduce the risk of fire or explosion, do not store or use gasoline or other flammable vapors or liquids in the

vicinity of this or any other appliance.

- DO NOT attempt to service this unit yourself.
- Never operate this dehumidifier in an area that is likely to have standing water. If there is water under or near the unit for your safety disconnect the power supply before stepping into the water.

## ELECTRICAL SERVICE INFORMATION

To reduce the risk of fire, electric shock, or personal injury, all wiring and grounding must conform with the latest edition of Local and National Electrical codes. If you have any questions regarding the following instructions contact a qualified electrician.

It is your responsibility to have the wiring and fuses checked by a qualified electrician to make sure adequate electrical power is available. Check the available power supply and resolve any wiring problems BEFORE installation and operation of this unit. This appliance is designed to operate on a separate branch, polarized, three-wire, effectively grounded 120 Volt 60 Hertz (alternating current) circuit protected by a 15-ampere fuse, equivalent fuse, or circuit breaker. The three-prong grounding plug on the power cord should be plugged directly into a polarized, three-slot, effectively grounded receptacle rated 110/120 V.A.C.

## GROUNDING INSTRUCTIONS

Improper connection of the equipment-grounding conductor can result in a risk of electrical shock. Check with a qualified electrician if you are in doubt as to whether your appliance outlets are properly grounded.

This appliance must be grounded. This appliance is equipped with a cord having an equipment-grounding conductor and 3 prong grounding plug. The plug must be connected to an outlet that is properly installed and grounded in accordance with all local codes and ordinances. Under no circumstance cut or remove the third (ground) prong from the plug provided with this appliance. Where a 2-prong wall outlet is encountered, or the plug will not otherwise properly fit the outlet, it is your personal responsibility and obligation to have a proper outlet installed by a qualified electrician. DO NOT use an adapter plug or extension cords with this unit. If the household electrical supply does not meet the above specifications, or if you are not sure your home has an effective ground, have a qualified electrician or your local electrical utility company check it and correct any problems.

## SAFETY PRECAUTIONS – CONTINUED

- DO NOT pull on the power cord to avoid breakage, potential danger, or injury.

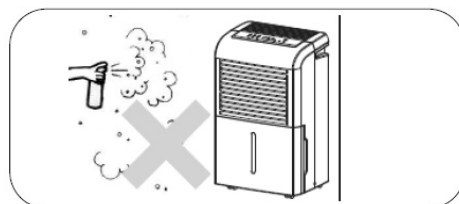
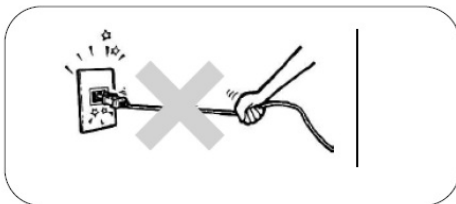

- DO NOT use insect/oil/paint spray around the machine; these might cause damage to plastic parts or start a fire.
- DO NOT place the unit on uneven ground to avoid shaking, noise, and water leakage.

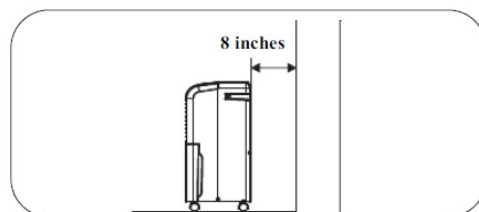
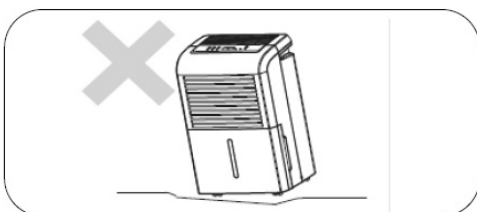

- Always keep the unit 8 inches or more from the wall to dissipate heat properly.
- DO NOT drop anything into the machine.

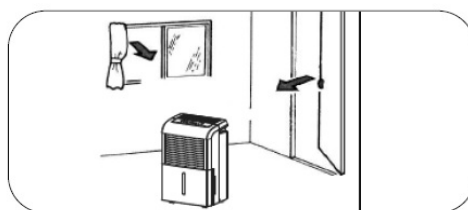
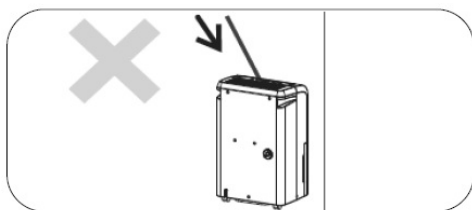

- Close all windows to allow for the maximum possible efficiency or remove moisture
- Keep the machine away from any type of heat source.

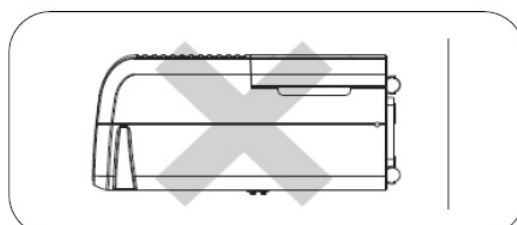
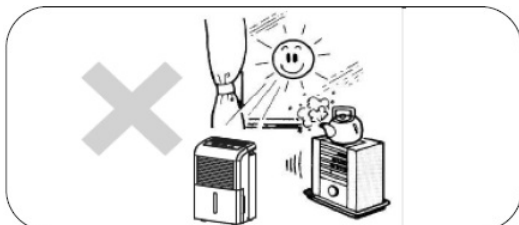

- When moving or putting in storage, do not place the dehumidifier on its side or upside down to avoid shaking.
- Do not use outdoors.
- This unit is intended only for indoor residential use and not for commercial use.

### CAUTION

Do not leave this unit unattended or operate in an area where people may not be able to react quickly to a failed unit. A failed unit may cause overheating, resulting in personal injury or property damage.

### UNIT SPECIFICATIONS

The manufacturer's nameplate is located on the rear wall of the water tank compartment. The nameplate contains electrical and other technical data specific to this unit.

<b>Model Number:</b>	GDR50A1C
Dehumidifying Capacity (Pints/ Liters)	50 / 23.7
Electrical Requirements	115 V / 60 Hz
Power Input (Watts)	600
Rated Amperage (Dehumidifying)	5.5
Air Flow Circulation- High Fan Speed	
(Cubic Feet per Minute)	238
Type of Refrigerant	R-410A
Water Tank Capacity (Pints / Liters)	14.2 / 6.8
Operating Noise Level (dB A)	54.8
Unit Dimensions (W x H x D)	15 4/16" x 25 3/16" x 14"

**NOTE:** Specifications are subject to change without notice, for further improvements.

### FEATURES

1. Soft Touch (Electronic) Control Key Pads

2. Remote Control
3. Auto-Sensing Humidity Control
4. Adjustable Humidity Settings (30%-90%)
5. 2 Fan Speed Settings (High/Low)
6. Delay Start Protection (compressor)
7. Auto-Defrost (De-Icer)
8. Full Bucket Indicator Light
9. Easy Roll Castors (4)
10. Front Mounted Water Tank (Removable)
11. Direct Drain Option (Hose Included) Standard Garden Hose can be used.
12. Quiet Operation
13. Removable Air Filter

## UNIT PARTS IDENTIFICATION

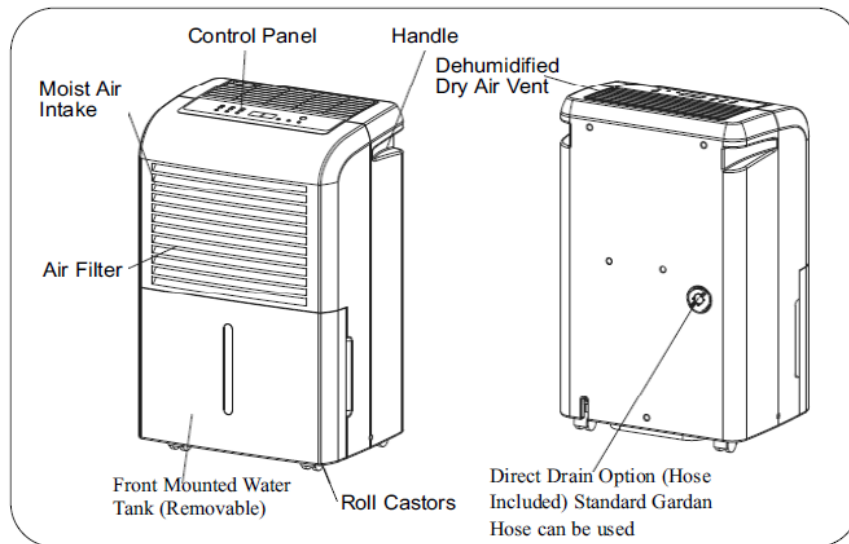

## FUNCTION EXPLANATION

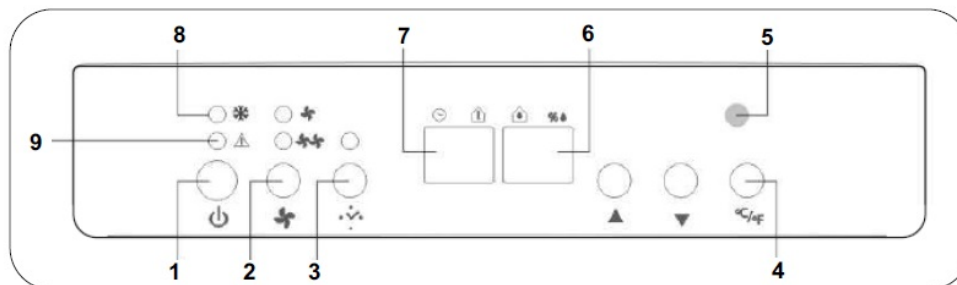

1. POWER Button: On / Off
2. FAN SPEED Button: High / Low
3. TIMER Button: When the unit is operating, press TIMER to set the number of hours desired until the unit will shut off. When the unit is on standby, press TIMER to set the number of hours desired until the unit will turn on. Setting timer from 1-24 hours. To cancel the timer, proceed as above but set the "timer off" to zero (0) hours.
4. °C/°F Button: Press the °C/°F button to toggle between Celsius and Fahrenheit.

5. Receiving Sensor
6. SET HUMIDITY/CURRENT HUMIDITY DISPLAY: When the machine is running, it displays the current humidity. Press the UP or DOWN buttons to select the humidity setting. The humidity is adjusted in increments of 5% by each press. The adjustable range is within 30%RH to 90%RH. 10 seconds after setting humidity, the display will change back to the current humidity.
7. CURRENT TEMP / TIMER SET DISPLAY: When the machine is running, it displays the current temperature. Press the TIMER button to set the machine to shut off automatically after a specified amount of time. seconds after displaying the timer, the display will change back to the current temperatures.
8. DEFROST LIGHT: When the temperature is low, the unit enters defrost mode, and defrost light illuminates.
9. BUCKET FULL LIGHT: When the water tank is full, the bucket full light illuminates.

## OPERATING INSTRUCTIONS

### REMOTE CONTROL

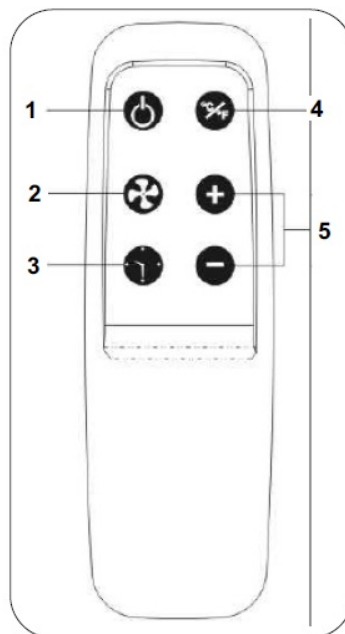

1. Power Key: On / Off
2. Fan Speed Key: High/Low
3. On / Off Timer Key:
  - In running mode: Auto switch Off
  - In standby mode: Auto switch on
4. Temperature display selector button (Celsius / Fahrenheit): Press the switch button to toggle between °C and °F.
5. Timer / Temperature Buttons:
  - Used for adjusting the timer and thermostat.
  - The default display is room temperature.
  - When the “+” or “-” button is pressed, the set temperature is displayed and may be adjusted. After 10 seconds the display will revert back to room temperature.

The remote operates within a range of 6 meters (16.4 ft.) from the receiver located inside the main unit. Any obstruction between the receiver and remote may cause signal interference, limiting the ability to program the

main unit. This Class B digital apparatus complies with Canadian ICES-003.

## PLACING BATTERIES IN THE REMOTE CONTROL

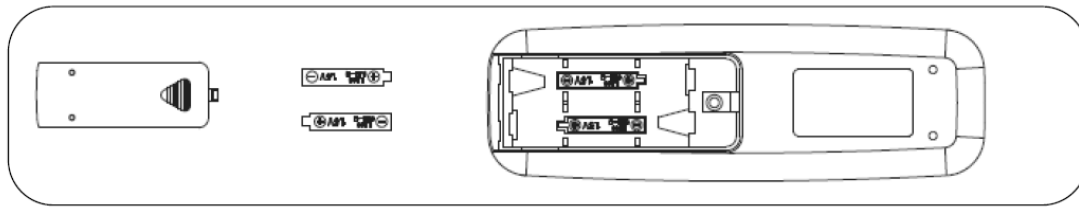

The functions work the same as your dehumidifier's touch controls. Batteries: Remove the cover on the back of the remote controller and insert the batteries with the (+) and (-) poles pointing in the proper direction.

**CAUTION** Use only AAA or IEC R03 1.5V batteries. Remove the batteries if the remote controller is not used for one month or longer. Do not attempt to recharge the supplied batteries. All batteries should be replaced at the same time. Do not dispose of the batteries in a fire as they may explode.

## CAUTION

1. Place the product in an upright position on a flat, stable, and heat-resistant surface. Make sure there is nothing flammable or heat sensitive within 100cm (39 inches). Operating the product in any other position could cause a hazard.

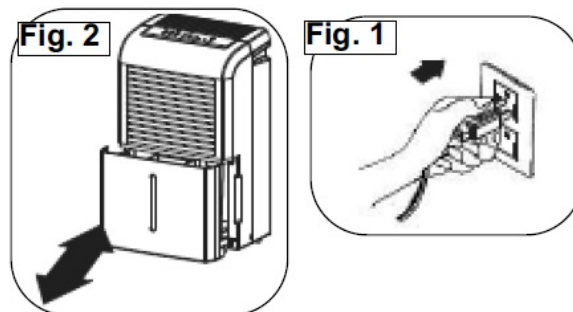

2. Insert the plug into a suitable 3-prong wall outlet (see "grounding instructions" on page 3) (Fig. 1). The dehumidifier is suitable for operating on an electricity supply having the same voltage as that shown on its rating label.
3. Make sure the water tank is correctly located. After switching on the machine for the first time, if the "Bucket Full" light illuminates, pull out the water tank, and check that the "float" lever is able to move freely, then return the water tank to the correct position (Fig.2).

## WATER FULL INDICATOR LIGHT(RED)

When the water tank is full and/or incorrectly positioned inside the cabinet, the water full red light turns on and remains on until such time that the tank is emptied and/or correctly re-positioned. This condition will result in the immediate shutdown of the dehumidifying system (both compressor and fan motor operations are terminated). This is a safety feature. When the water tank is emptied and/or correctly re-positioned, the dehumidifier will resume operation automatically.

**NOTE:** It may take several minutes before operating conditions resume.

## BUCKET FULL LIGHT ON

When the water tank is full the machine will stop and the "Bucket Full" light will illuminate. The water tank should be carefully removed from the machine by sliding it outward from the front of the unit, and it should be emptied. When the empty tank is replaced properly in the machine, the unit will start up and run normally (Fig. 3).

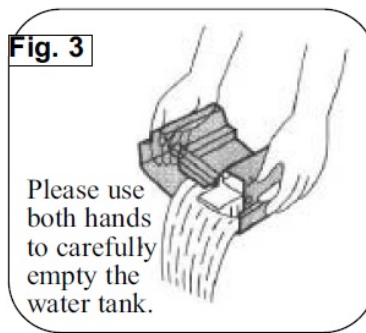

### FACTORY DEFAULT SETTING

Each time the unit is disconnected/re-connected and/or in the event of a power failure, the electronic circuit board automatically defaults to the following factory setting: Humidity Setting: 60% Fan Speed: Low

**NOTE:** In the event of a power failure, all previous settings are automatically erased/canceled. If your program setting was different from the above (default setting) it will be necessary to re-program your settings. When the unit is switched "Off" manually (using the on/off keypad) the unit will always default to the last program setting that was used.

### WATER TANK OPERATION

Proper installation of the water tank is crucial in maintaining reliable dehumidifier operation. The water tank holds accumulated condensed water and, by means of a safety switch, controls both the water level and operation of the dehumidification process. When the water tank is full and/or accidentally displaced inside the cabinet, the float switch actuator (inside the tank) breaks contact with the safety switch. This condition results in the immediate shutdown of the compressor and fan motor system, preventing moisture from being condensed.

**CAUTION:** Never tamper with or attempt to defeat the water level (safety) float switch system.

### DEFROST

When the machine is operated at low temperatures (less than 64.4°F), the surface of the evaporator may accumulate a layer of frost which would reduce the efficiency of the machine. When this happens the machine will go into periodic defrost mode. The machine will operate in temperatures down to 41°F. The time taken to defrost may vary. If the machine freezes up, it should be turned off at the power supply and restarted. If the room temperature remains below 41°F the machine should be switched off.

### DEHUMIDIFYING

Dehumidifying is a means of removing moisture from the air. A dehumidifier will help to protect your home and valued possessions from damage (swelling) caused by moisture in the air. Essentially a dehumidifier removes moisture from the air as the moist air passes over a dehumidifying (evaporator) coil. Moisture is condensed on the evaporator coil, drained, and collected inside an internal (removable) water tank located at the front of the unit. The exhausted air being returned into the room environment is elevated several degrees, causing the surrounding air temperature to increase (slightly). This process also contributes to lowering the relative humidity of the surrounding air

A dehumidifier will help to protect your home and valued possessions from damage (swelling) caused by moisture in the air. Essentially a dehumidifier removes moisture from the air as the moist air passes over a dehumidifying (evaporator) coil. Moisture is condensed on the evaporator coil, drained, and collected inside an internal (removable) water tank located at the front of the unit. The exhausted air being returned into the room environment is elevated several degrees, causing the surrounding air temperature to increase (slightly). This process also contributes to lowering the relative humidity of the surrounding air

### AIR FILTER

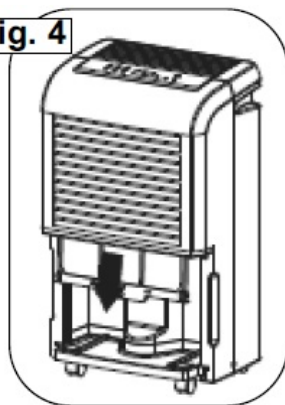

**Fig. 4**

Your dehumidifier features a removable Air Filter. This filter is located at the front of the unit (behind the air intake grill) directly above the water tank compartment. The air filter plays an important role in helping to reduce (minimize) dust/dirt particles from the surrounding environment. A blocked/clogged air filter reduces air intake, impacting negatively operating efficiency. To maintain maximum operating efficiency, the filter must be checked and cleaned regularly (every 2 weeks). More frequent cleaning may be required depending on indoor air quality.

### AIR FILTER CLEANING STEPS

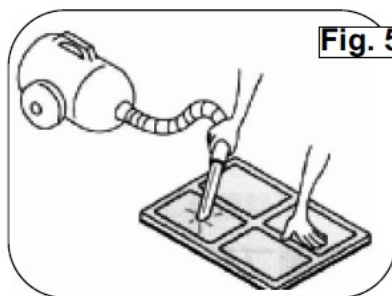
**Fig. 5**

1. Pull the air filter out gently (Fig. 4).
2. clean the filter with a vacuum cleaner, or wash it with clean water and dry it with a dry cloth. (Fig. 5)
3. Put the clean air filter back in place and continue to operate the dehumidifier.

**CAUTION:** Do not operate a dehumidifier without the filter because dirt and other debris will clog it and reduce its performance.

### INSTALLING PVC DRAIN HOSE

When using the continuous drain function, the PVC hose must be placed horizontally below the drainage hole. Avoid uneven ground and folding the hose. NOTE: Should you damage or misplace the PVC drain hose, a standard garden hose can be used.

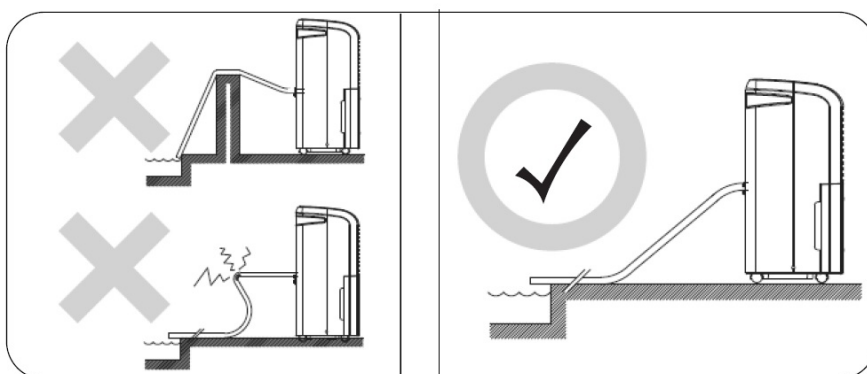

## CONTINUOUS DRAIN

The function of continuous drain can be performed using the following steps:

1. To save having to periodically empty the water tank, this unit can be configured for continuous drain. You can use the supplied drain hose to connect to the continuous drain connector.

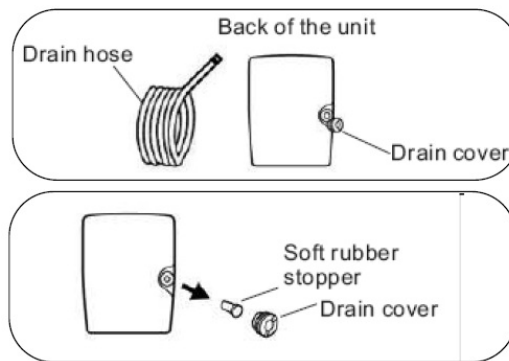

2. Unscrew and remove the drain cover at the rear of the unit.
3. Remove the soft rubber stopper, and place it in the water tank for safekeeping.

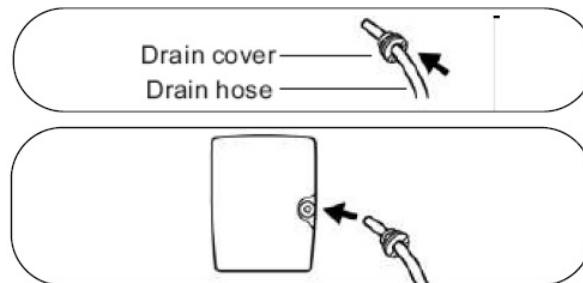

4. Insert the drain hose through the hole of the drain cover.
5. Connect the drain hose to the drain port.

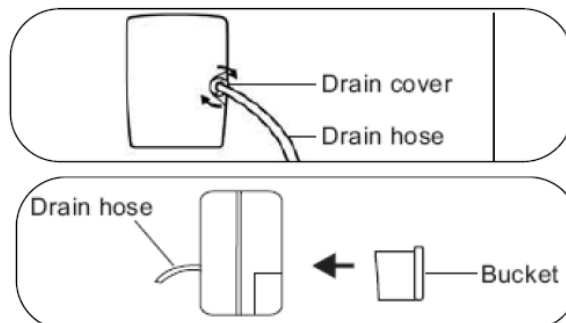

6. Tighten the drain cover in a clockwise direction onto the rear of the unit.
7. Place the bucket in its original location.

## CARE AND MAINTENANCE

### CLEANING THE UNIT

**CAUTION:** Before attempting to clean this unit, always disconnect the power supply cord from the electrical power supply/outlet.

1. DO NOT use gasoline, benzene, paint thinner, or any other chemicals to clean this unit, as these substances will damage/deform the plastic components and luster finish.
2. Never attempt to clean the unit by pouring water directly over any of the surface areas, as this will cause deterioration of electrical components and wiring insulation.
3. Use only a mild dishwashing detergent, lukewarm water, and a soft cloth to wipe the exterior surface of the unit and dry thoroughly.

## STORAGE

When the dehumidifier is not being used for long periods of time, please follow these instructions:

1. Disconnect the power cord from the power supply.
2. Empty the water tank and wipe (clean) thoroughly.
3. Clean the air filter thoroughly.
4. Re-package the unit in its original carton.
5. Store the unit upright in a dry location.

## TROUBLESHOOTING GUIDE

PROBLEM	POSSIBLE CAUSE
Unit will not operate	<ul style="list-style-type: none"><li>• Check power cord connection</li><li>• Check electrical outlet for blown fuse</li><li>• Check if water tank is full (if so, empty)</li><li>• Check water tank is properly installed</li></ul>
Dehumidifying capacity (moisture removal) low	<ul style="list-style-type: none"><li>• Air filter is dirty and/or blocked</li><li>• Ambient temp. too low (below 5°C/41°F)</li><li>• Poor airflow circulation/grill obstruction</li><li>• RH in surrounding environment very low</li></ul>
Relative Humidity (RH) setting not reached after long period of operation	<ul style="list-style-type: none"><li>• Check all doors and windows are closed</li><li>• Area/room is too large for the capacity of the dehumidifier</li></ul>

Some problems are of a minor nature and a service call may not be necessary. Use this troubleshooting guide to identify possible problems you may be experiencing. If the unit continues to operate improperly, call P.C. Richard & Son Service 1-800-696-2000.

## GENERATIONS™ – One-Year Limited Warranty

For One Year from the date of the original purchase, we will, at our option, either repair the unit or replace it if it fails due to any defects in material or workmanship. Any replacement part or unit is warranted for the remainder of the original warranty period. This warranty is extended only for home use within the contiguous USA.

### What is not covered

- Damage caused by abuse, or misuse, such as inadequate air circulation in the room or failure to provide maintenance.
- Improper power supply, power surges, accident, fire, flood, or acts of God.
- Damage caused by modifications to the unit, use in a commercial setting, or other unreasonable use, such as

use outdoors.

- Improper or incorrectly performed maintenance or repair.
- The cost of transporting or shipping the unit back for service or replacement.
- Service calls for explaining the operation of the unit (please refer to the Owner's Manual for this), replacing filters or other consumable parts, or correcting installation problems.
- Consequential or incidental damages.

Some states do not allow the exclusion or limitation of incidental or consequential damages, so the above limitation or exclusion may not apply to you. Exclusion of Implied Warranties: This warranty is given in place of all other warranties. Your sole and exclusive remedy is provided by this Limited Warranty. Any implied warranties, including the implied warranties of merchantability or fitness for a particular purpose, are limited to one year or the shortest period allowed by law. Some states do not allow limitations on how long an implied warranty lasts, so the above limitation may not apply to you. This warranty gives you specific legal rights, and you may also have other rights which vary from State to State.

### **To obtain Warranty service**

Keep your purchase receipt or delivery receipt as proof of the original purchase date is needed to make a warranty claim. To obtain service you can contact the warrantor, P.C. Richard & Son®, 150 Price Parkway, Farmingdale, NY, at 1-800-696-2000 or you may bring it to the P.C. Richard & Son® store where it was purchased.

### **PORTABLE DEHUMIDIFIER**

The model number can be found on the serial plate located on the back panel of the unit. All repair parts are available for purchase or special order when you visit your nearest service depot. To request service and/or the location of the service depot nearest you, call the TOLL FREE NUMBER. When requesting service or ordering parts, always provide the following information:

- Product Type
- Model Number
- Part Number
- Part Description

CALL P.C. RICHARD & SON FOR SERVICE 1-800-696-2000 P.C. Richard & Son 150 Price Parkway, Farmingdale, NY 11735

**Download PDF:** [P.C. Richard & Son GDR50A1C Generations Dehumidifier User Manual](#)