

OZARKE SKØRTER Floating Shoe Display LED Lamp



OZARKE SKØRTER Floating Shoe Display LED Lamp Instruction Manual

[Home](#) » [OZARKE](#) » OZARKE SKØRTER Floating Shoe Display LED Lamp Instruction Manual 

Contents

- 1 OZARKE SKØRTER Floating Shoe Display LED Lamp
- 2 Product Information
- 3 Product Usage Instructions
- 4 Before you get started
- 5 Installation Instructions
- 6 Documents / Resources
 - 6.1 References

OZARKÉ

OZARKE SKØRTER Floating Shoe Display LED Lamp



Product Information

Specifications:

- **Power Supply Range:** 100-240V, 50Hz
- **Optimized Weight Range:** 450-550 grams
- **Usage:** Indoor use only
- **Cleaning:** Wipe with a clean soft cloth, do not wash with water

Product Usage Instructions

Installation Instructions:

1. Weigh your shoe using a spring balance. If it weighs less than 450 grams, proceed to the next step.
2. Add glass marbles one by one into the shoe until the weight falls within the range of 450-550 grams.
3. Place the stand on a flat surface. Connect the cable to the DC port and plug the adapter into a 100-240VAC outlet.
4. Insert the magnet into the shoe, ensuring the small end marked 'TOP' securely attaches to your shoe. Hold both firmly and raise them by 0.2-0.4 inches until magnetic force locks the shoe in place.
5. Use the switch to control the LED lights.

FAQs (Frequently Asked Questions)

1. **Q: Can I use this product outdoors?**

A: No, this product is designed for indoor use only and should not be installed outdoors as per safety guidelines.

2. **Q: What should I do if my shoe exceeds 550 grams in weight?**

A: The device may not function correctly if the shoe exceeds 550 grams. To ensure proper usage, maintain the weight within the specified range by adding glass marbles.

3. Q: How should I clean the product?

A: Wipe the product with a clean soft cloth. Avoid washing it with water to prevent damage.

INSTRUCTION MANUAL

Thank you for shopping with Ozarké, we really appreciate your business. Our goal is to provide an excellent customer service before, during and after delivery. We've included a guide on how to install this light, should you require additional assistance please feel free to email us at info@ozarke.com and one of our customer service reps will reach out to assist you.

Before you get started

When working with electrical wiring, follow these safety instructions to prevent injury or damage:

1. **Turn off the power:** Before starting any work, turn off the power to the area you will be working in.
2. **Use appropriate tools:** Only use tools designed for electrical work and in good condition.
3. **Wear protective gear:** Wear safety glasses, gloves, and other protective gear as necessary.
4. **Test for power:** Use a non-contact voltage tester to check for electrical current before touching any wires.
5. **Avoid wet conditions:** Do not work with electrical wiring in wet or damp conditions.
6. **Keep a safe distance:** Stay away from exposed wires or electrical components.
7. **Seek professional help:** Consult a qualified electrician if you are unsure about any aspect of electrical wiring or encounter any problems.

WARNING!

1. Do not use the power supply beyond the specified range (100-240V,50Hz).
2. Avoid scratching the surface and wires of the lamp during installation.
3. Do not install the lamp outdoors.
4. The lamp should not be close to corrosive chemical objects or gases.
It should not be washed with water. It can only be wiped with a clean soft cloth.

Installation Instructions

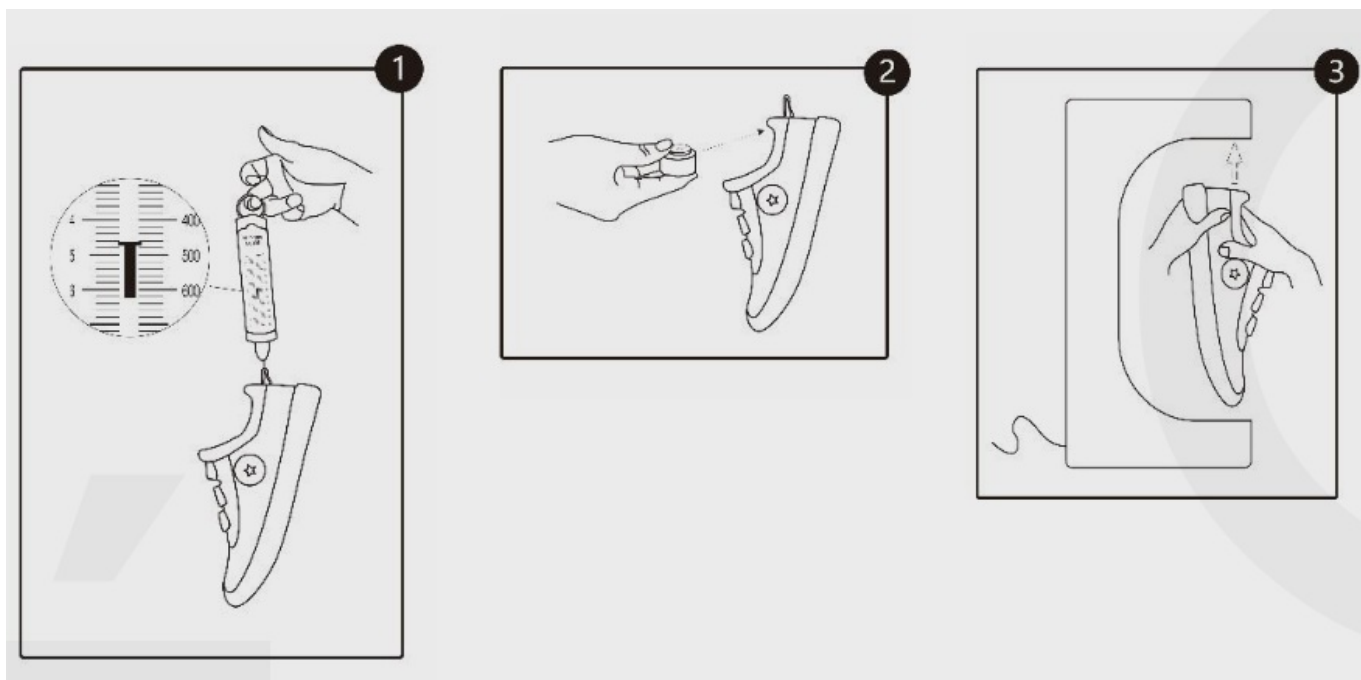

This device is optimized for use with shoes in the weight range of 450-550 grams. To achieve this specific weight range, glass marbles can be added to the shoe. The spring balance is calibrated to accurately measure weights within the 450-550-gram range. It's important to note that the device may not function correctly if the shoe exceeds 550 grams in weight.

Follow these steps for proper usage:

1. Use a spring balance to weigh your shoe. If the shoe weighs less than 450 grams, proceed to the next step. Add glass marbles one by one into the shoe until the spring balance panel shows a weight within the range of 450-550 grams. Alternatively, you can weigh the shoe using a scale to achieve the desired weight range.
2. Place the stand on a flat surface. Connect the cable to the DC port and plug the adapter into a 100-240VAC outlet.
3. Insert the magnet into the shoe, ensuring that the small end of the magnet (marked 'TOP') securely attaches to your shoe.
4. Hold the shoe and magnet firmly with both hands. Slowly move them upwards, raising them by approximately 0.2-0.4 inches. Once you sense the magnetic force locking the shoe in place, gently release your hands.

The switch is used to turn the LED lights ON/OFF.

Documents / Resources

	<p>OZARKE SKØRTER Floating Shoe Display LED Lamp [pdf] Instruction Manual SK RTER Floating Shoe Display LED Lamp, SK RTER, Floating Shoe Display LED Lamp, Shoe Display LED Lamp, Display LED Lamp, LED Lamp</p>
--	---

References

- [User Manual](#)

[Manuals+](#), [Privacy Policy](#)

This website is an independent publication and is neither affiliated with nor endorsed by any of the trademark owners. The "Bluetooth®" word mark and logos are registered trademarks owned by Bluetooth SIG, Inc. The "Wi-Fi®" word mark and logos are registered trademarks owned by the Wi-Fi Alliance. Any use of these marks on this website does not imply any affiliation with or endorsement.