



OxyLED T-02 Motion Sensor Lights Indoor User Manual

[Home](#) » [OxyLED](#) » OxyLED T-02 Motion Sensor Lights Indoor User Manual 

Contents

- [1 OxyLED T-02 Motion Sensor Lights Indoor](#)
- [2 PRECAUTIONS](#)
- [3 Activating the Infrared Sensor](#)
- [4 FAQs](#)
- [5 Installation Steps](#)
- [6 FCC](#)
- [7 Documents / Resources](#)
 - [7.1 References](#)
- [8 Related Posts](#)



OxyLED T-02 Motion Sensor Lights Indoor



At OxyLED, our high quality lighting designs improve the quality of life for our customers for a diversity of uses. Shed light on the situation with a variety of motion sensor lights, cabinet lights, string lights, and solar garden lighting, from classic to contemporary. From your kitchen, garden, office or bedroom and everything in between, you'll always have a bright future with OxyLED.

Thank you for your purchase of our T-02 USB rechargeable motion sensor closet lights, which you can use to shed light on your situation to find your things more easily. Using passive infrared technology, it will detect your motion when you come near. It can turn on automatically within 3m/10ft and will automatically turn off after 15-20 seconds of no sensing motion, or use the switch to turn it off directly. Bright enough to illuminate the darkest, clothes-strewn corners of your closet, it has 10 SMD2835 LEDs to brighten up bedrooms, basements, attics, garages and more. No more stumbling around in the dark!



PRECAUTIONS

- Please note that the light will turn on automatically when motion is detected at dark night or during the daytime if the ambient light is not bright enough. You can also turn off the light manually after each use to save the light.
- If you want to install multiple sensor lights, make sure to not place them too close together. Otherwise their signals will cross and neither will work.
- The light should be installed on a clean, dry, and smooth surface. Avoid using it under conditions of high temperature to extend its service life.
- Once the sensor light is installed, we recommend not moving the magnetic tape so as not to wear it down.
- If the lamp you received is not bright enough, please first make sure it is fully charged. (Charge cable is included.)

- Fully charged



Fully charged



Not fully charged

- Not fully charged

- No hardware is needed to install the magnetic tape. To charge the lamp, simply remove the lamp body from the magnetic tape. There is no need to remove the magnetic tape.
- Keep away from humidity, flammable and explosive items in charging process. Don't charge it without supervision.

DON'T Install the Lights in the Following Situations:



Installed in moist or damp places



Mounted near heat sources

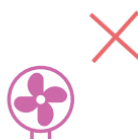

Mounted facing towards air vents

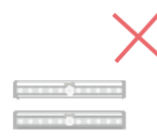

2 lights are installed too close



2 lights are installed too close

Activating the Infrared Sensor

Vertical Installation:

light will face downwards

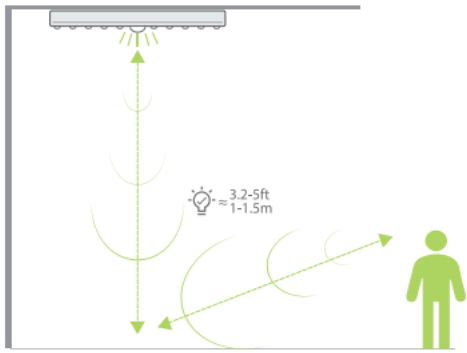

Sensing distance: 1-1.5m (3.2-5ft)

Horizontal Installation:

light will directly face person triggering sensor



Sensing distance: 3 or less than 3m/9.8ft

FAQS

- **My light doesn't work!**

Please note that this motion sensor light only lights up under a dark environment when it senses motion. If you are sure that your light isn't working, please contact us and we will provide A FREE replacement for you.

- **The light keeps falling down!**

Please make sure you mount the light on a smooth and dry surface. For maximum stickiness, we suggest not moving the light once you've mounted it. If the problem persists, please contact us and we will provide you a FREE replacement.

- **The light doesn't light up even after I wave my hand over the detector!**

Please make sure the batteries are sufficiently charged. Make sure to charge the device for several hours. If it still doesn't work, please contact us and we'll send a FREE replacement.

- **The light lights up repeatedly!**

The light may be affected by the surrounding lighting devices. Install it in another location and try again. If the problem persists, please contact us and we will provide you a FREE replacement.

- **The light can't be charged!**

Please contact us and we will provide you a FREE replacement

Contact us by

Support@Oxyled.com

Installation Steps

1. Peel off the protective coating of the adhesive tape

- Choose a smooth and dry surface where you want to mount the light. Make sure the surface is clean before affixing the adhesive tape
- Mount the lights onto the magnetic strip

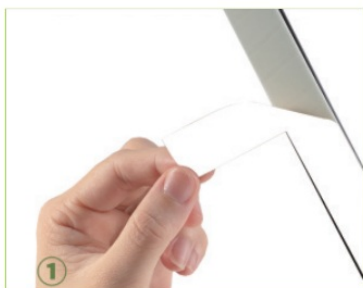

- Remove the lamp body from the magnetic tape to charge its batteries (leave the adhesive tape affixed to the wall)
- Please use the provided Micro USB cable to charge the lamp
- After charging the batteries, remount the lamp body onto the magnetic tape

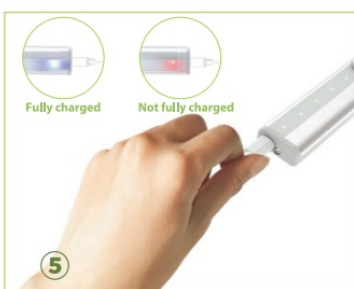

OxyLED Motion Sensor Closet Lights – Soft, ambient lighting for a cozier home

Model	LED	Power Source	Sencsor Type	Size	Image
T-02	10	USB Rechargeable	Motion + Light Sensor	7.5"	
T-02	10	Battery Operated	Motion + Light Sensor	7.5"	
T-02	10	Battery Operated	Remote Control	7.5"	
T-02U	20	USB Rechargeable	Motion + Light Sensor	7.3 "	
T-02S	20	USB Rechargeable	Motion + Light Sensor	14.2"	
T-02US	36	USB Rechargeable	Motion + Light Sensor	14.3"	
T-02P	36	USB Rechargeable	Motion + Light Sensor	17.1"	
T-01	4	Battery Operated	Touch Sensor	7.2"	
T-02 Touch	10	Battery Operated	Touch Sensor	8.3"	
T-02S Touch	20	USB Rechargeable	Touch Sensor	14.6"	

FCC

This device complies with Part 15 of the FCC Rules. Operation is subject to the following two conditions: (1) this

device may not cause harmful interference, and (2) this device must accept any interference received, including interference that may cause undesired operation.

Learn more about the EU Declaration of Conformity, Please click below link to download.

<http://files.oxyled.com/t02-8120-eu.pdf>

We have all your lighting needs covered.

Documents / Resources

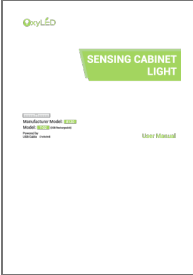
	<p>OxyLED T-02 Motion Sensor Lights Indoor [pdf] User Manual</p> <p>T-02 Motion Sensor Lights Indoor, T-02, Motion Sensor Lights Indoor, Sensor Lights Indoor, Lights Indoor, Indoor</p>
---	--

References

- [User Manual](#)