



# OXBOX BX-SVN-JAYSQRD-1A Square to Round Adapter Kit Instruction Manual

[Home](#) » [Oxbox](#) » OXBOX BX-SVN-JAYSQRD-1A Square to Round Adapter Kit Instruction Manual 

## Contents

- [1 OXBOX BX-SVN-JAYSQRD-1A Square to Round Adapter Kit](#)
- [2 Product Information](#)
- [3 Product Installation Instructions](#)
- [4 Safety Section](#)
- [5 General Data](#)
- [6 Installation Instructions](#)
- [7 Documents / Resources](#)
  - [7.1 References](#)



**OXBOX BX-SVN-JAYSQRD-1A Square to Round Adapter Kit**



## Product Information

The Square to Round Adapter Kit (BX-SVN-JAYSQRD-1A-EN) is designed to facilitate the conversion from square opening supply and return to standard round ducts. It is intended for use with gas-electric units and heat pump units.

## Safety Information

It is important to follow all safety instructions provided in the manual. Failure to do so may result in property damage, personal injury, or even death. Qualified licensed service personnel should carefully read and understand these instructions before attempting installation or operation.

## General Data

The kit includes one supply adapter, one return adapter, and a gasket.

## Product Installation Instructions

1. Confirm that the adapter kits are correct for your unit by referring to Table 1 in the manual.
2. Inspect the kit for any shipping damage. Report any damage to the transportation company immediately. If any parts are missing, contact your supplier for authorized replacements.
3. If installing the kit on a gas-electric unit:
  - Remove the panels covering both the horizontal supply and return openings on the unit.
  - Attach the gasket to the flanges on both adapters.
  - Place one adapter over the supply opening on the cabinet. Align it approximately 2.27 inches from the side of the cabinet and 1.27 inches from the bottom. Secure it with sheet metal screws.

- Place another adapter over the return opening on the cabinet. Align it approximately 5.71 inches from the right side flange of the supply adapter and 1.27 inches from the bottom. Secure it with sheet metal screws.

4. If installing the kit on a heat pump unit:

- Follow Steps 1 and 2 as instructed for gas-electric units.

## RECOGNIZE THIS SYMBOL AS AN INDICATION OF IMPORTANT SAFETY INFORMATION

### WARNING

These instructions are intended as an aid to qualified licensed service personnel for proper installation, adjustment and operation of this unit. Read these instructions thoroughly before attempting installation or operation. Failure to follow these instruction may result in improper installation, adjustment, service or maintenance possibly resulting in fire, electrical shock, property damage, personal injury or death.



### DO NOT DESTROY THIS MANUAL

Please read carefully and keep in a safe place for future reference by a serviceman.

## Safety Section

### WARNING: HAZARDOUS VOLTAGE!

- Failure to follow this Warning could result in property damage, severe personal injury, or death.
- Disconnect all electric power, including remote disconnects before servicing. Follow proper lockout/ tagout procedures to ensure the power cannot be inadvertently energized.

### CAUTION: SHARP EDGE HAZARD!

- Failure to follow this Caution could result in personal injury.
- Be careful of sharp edges on equipment or any cuts made on sheet metal while installing or servicing.
- Personal injury may result.

## General Data

The purpose of the adapter kit is to provide easy conversion from square opening supply and return using the standard round ducts.

## Kit Contents

Items	Quantity
Supply Adapter	1
Return Adapter	1
Gasket	A/R

## Inspection

- Check carefully for any shipping damage. This must be reported to and claims made against the transportation company immediately.
- Any missing parts should be reported to your supplier at once and replaced with authorized parts only.

## Kit Identification

Confirm that the supply and return duct adapter kits are correct for your unit. Refer to the Table 1 to verify proper adapter kits and product model number.

**Table 1.** Adapter Kits Matching Units

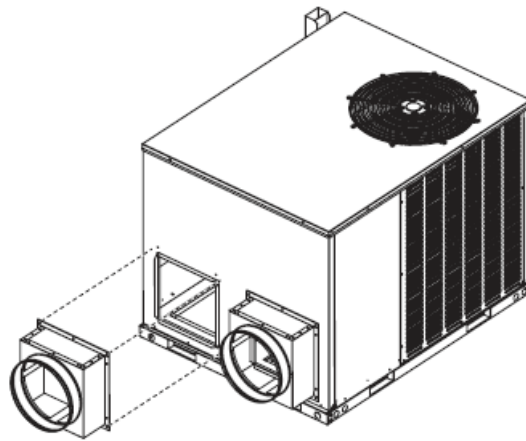
Unit Type	Models	Adapter Kits	
		Supply	Return
Gas/Electric Unit	24 – 60	JAYSQRD001	JAYSQRD001
Heat Pump Unit	24 – 36	JAYSQRD001	JAYSQRD004
	42 – 60	JAYSQRD001	JAYSQRD005
Double Deck Gas Units	24 – 42	JAYSQRD002	JAYSQRD002
	48 – 60	JAYSQRD003	JAYSQRD003

## Installation Instructions

### Install Adapter Kits to Gas-Electric Units

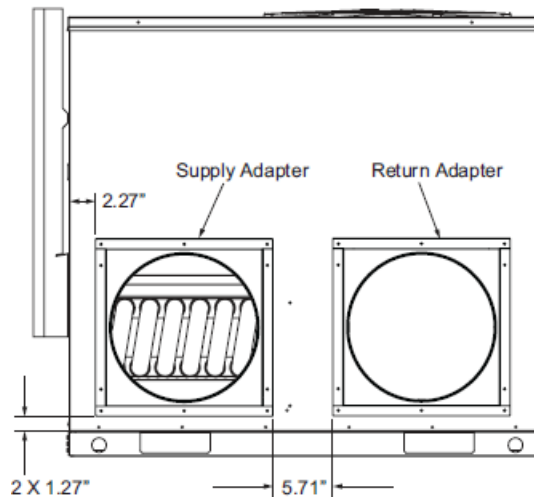
1. Remove the panels covering both the horizontal supply and return openings on the unit.
2. Attach gasket to the flanges on both the adapters.

**Figure 1. Install Supply Adapter**



3. Place one adapter over the supply opening on the cabinet. Align the adapter so that the approximate position of the adapter is 2.27" from the side of the cabinet and 1.27" from the bottom of the cabinet. Secure with sheet metal screws. See Figures 1 and 2.

**Figure 2. Install and Align Return Adapter**

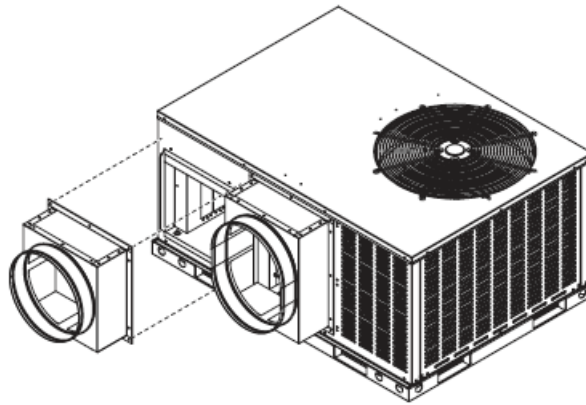


4. Place another adapter over the return opening on the cabinet. Align the adapter so that the approximate position of the adapter is 5.71" from the right side flange of the supply adapter and 1.27" from the bottom of the cabinet. Secure with sheet metal screws. See Figure 2.

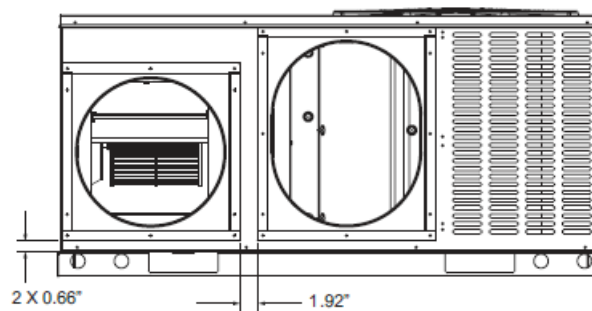
### **Install Adapter Kits to Heat Pump Units**

1. Do the Steps 1 and 2 as instructed in the procedure "Install Adapter Kits to Gas-Electric Units".
2. For \*\*\*\*\*24 – 36 Heat Pump Units –

**Figure 3. Install Supply Adapter**  
(\*\*\*\*\*24 – 60 models)



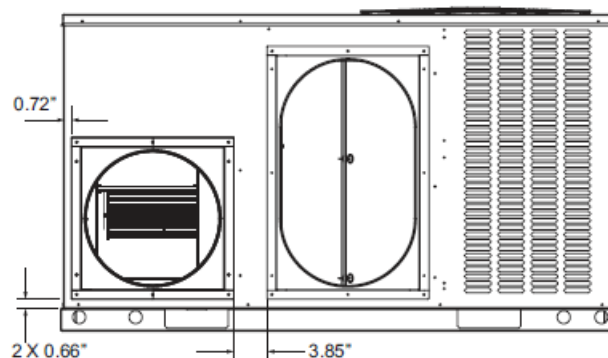
**Figure 4. Install and Align Return Adapter**  
(\*\*\*\*\*24 – 36 models)



- Place one adapter over the supply opening on the cabinet. Align the adapter so that the left side flange of the adapter is flush with the side of the cabinet and the bottom flange of the adapter is approximately 0.66" from the bottom of the cabinet. Secure with sheet metal screws. See Figures 3 and 4.
- Place another adapter over the return opening on the cabinet. Align the adapter so that the approximate position of the adapter is 1.92" from right side flange of the supply adapter and 0.66" from the bottom of the cabinet. Secure with sheet metal screws. See Figure 4.
  - **NOTE:** Notice orientation of the return adapter. The shorter side of the return adapter is either at the top or bottom.

3. For \*\*\*\*\*42 – 60 Heat Pump Units –

**Figure 5. Install and Align Return Adapter**  
(\*\*\*\*\*42 – 60 models)



- Place one adapter over the supply opening on the cabinet. Align the adapter so that the approximate position of the adapter is 0.72" from the side of the cabinet and 0.66" from the bottom of the cabinet. Secure with sheet metal screws. See Figures 3 and 5.
- Place another adapter over the return opening on the cabinet. Align the adapter so that the approximate

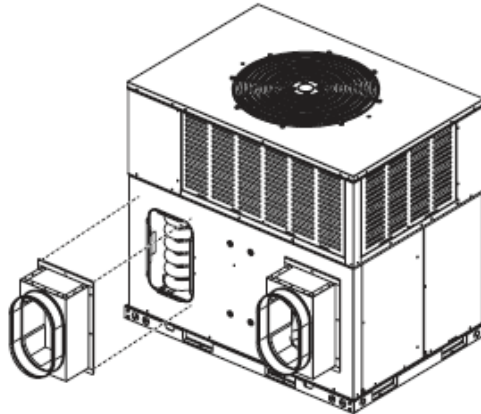
position of the adapter is 3.85" from the right side flange of the supply adapter and 0.66" from the bottom of the cabinet. Secure with sheet metal screws. See Figure 5.

- **NOTE:** Notice orientation of the return adapter. The shorter side of the return adapter is either at the top or bottom.

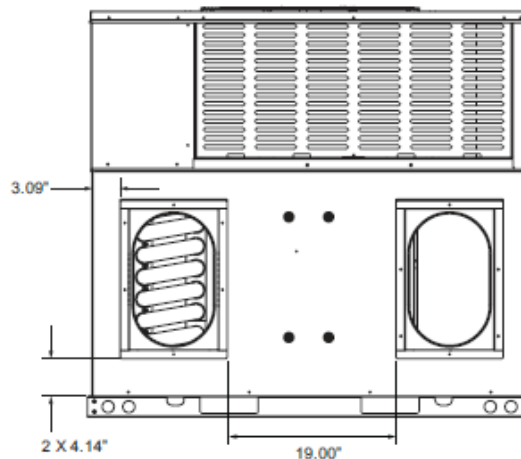
### Install Adapter Kits to Double Deck Gas Units

1. Do the Steps 1 and 2 as instructed in the procedure "Install Adapter Kits to Gas-Electric Units".
2. For \*\*\*\*\*24 – 42 Double Deck Gas Units –

**Figure 6. Install Supply Adapter**  
(\*\*\*\*\*24 – 42 models)

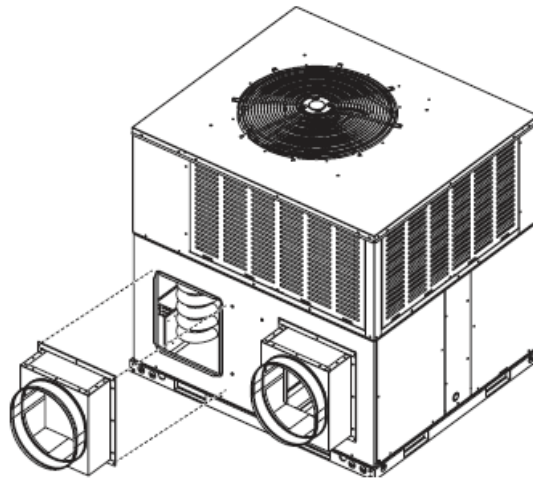


**Figure 7. Install and Align Return Adapter**  
(\*\*\*\*\*24 – 42 models)

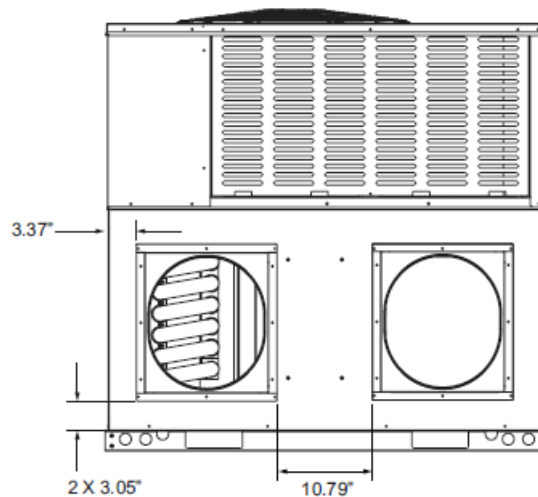


- Place one adapter over the supply opening on the cabinet. Align the adapter so that the approximate position of the adapter is 3.09" from the side of the cabinet and 4.14" from the bottom of the cabinet. Secure with sheet metal screws. See Figures 6 and 7.
  - Place another adapter over the return opening on the cabinet. Align the adapter so that the approximate position of the adapter is 19.00" from the right side flange of the supply adapter and 4.14" from the bottom of the cabinet. Secure with sheet metal screws. See Figure 7.
    - **NOTE:** Notice orientation of both the supply and return adapters. The shorter side of both the adapters are either at the top or bottom.
3. For \*\*\*\*\*48 – 60 Double Deck Gas Units –

**Figure 8. Install Supply Adapter**  
(\*\*\*\*\*48 – 60 models)



**Figure 9. Install and Align Return Adapter**  
(\*\*\*\*\*48 – 60 models)



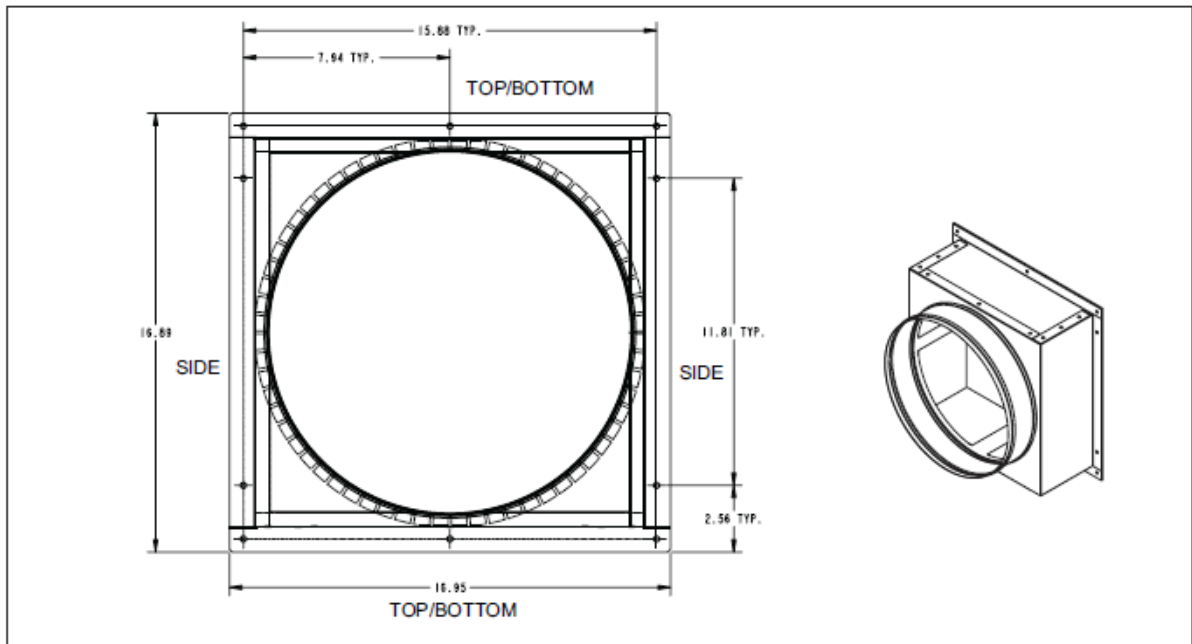
- Place one adapter over the supply opening on the cabinet. Align the adapter so that the approximate position of the adapter is 3.37" from the side of the cabinet and 3.05" from the bottom of the cabinet. Secure with sheet metal screws. See Figures 8 and 9.
- Place another adapter over the return opening on the cabinet. Align the adapter so that the approximate position of the adapter is 10.79" from the right side flange of the supply adapter and 3.05" from the bottom of the cabinet. Secure with sheet metal screws. See Figure 9.
  - **NOTE:** Notice orientation of both the supply and return adapters. The shorter side of both the adapters are either at the top or bottom.

Connect field supplied flex duct to the adapters and secure with field supplied clamps. See Figure 10 for dimensional drawings for flex duct sizing.

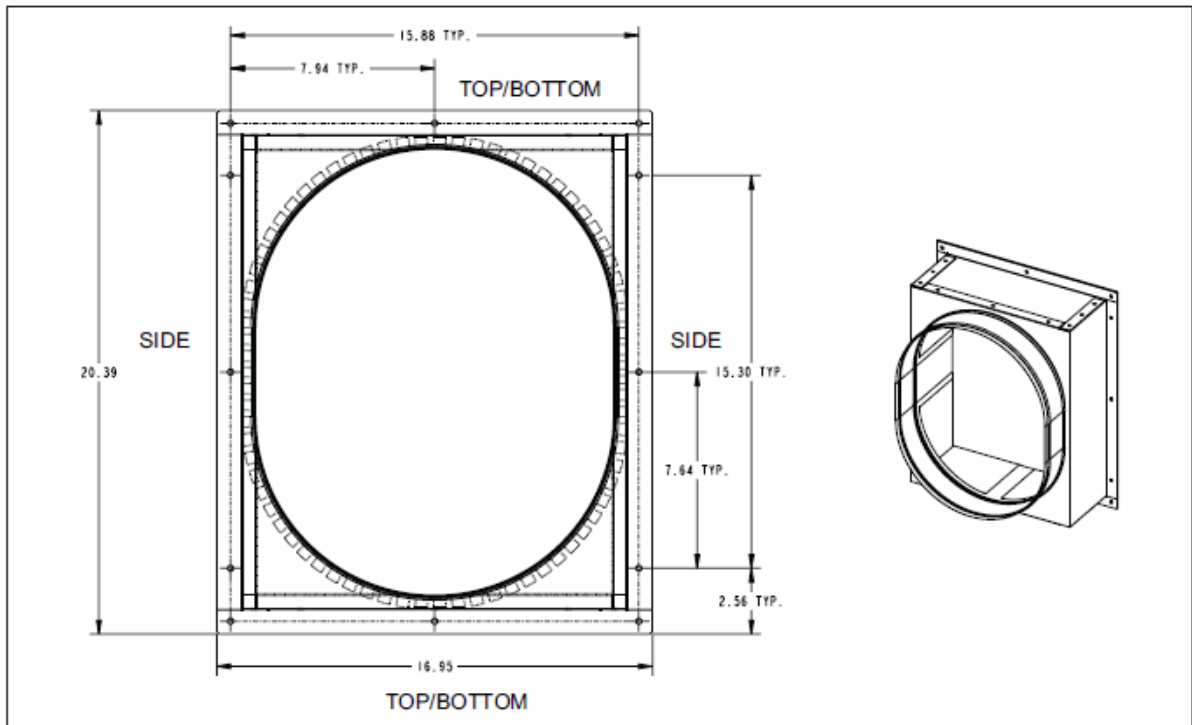
**Figure 10. Dimensional Drawings**



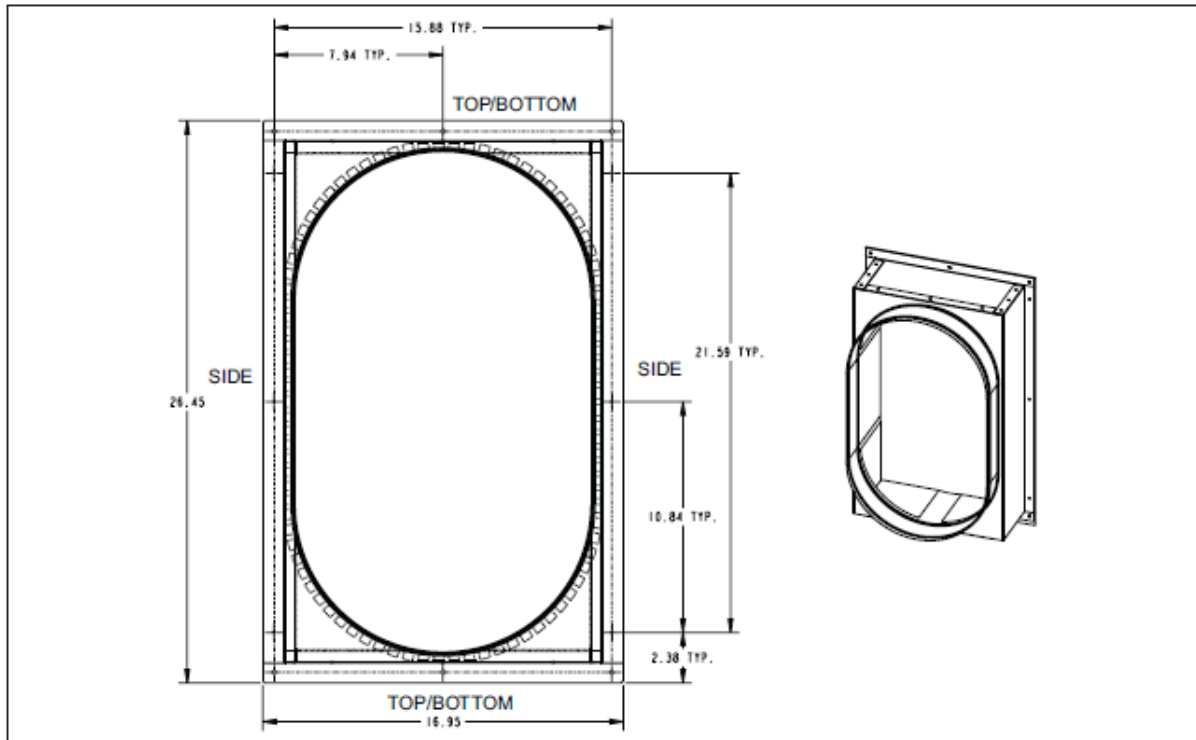
**Figure 10. Dimensional Drawings**  
**JAYSQRD001 (For use on Gas-Electric and Heat Pump Units)**



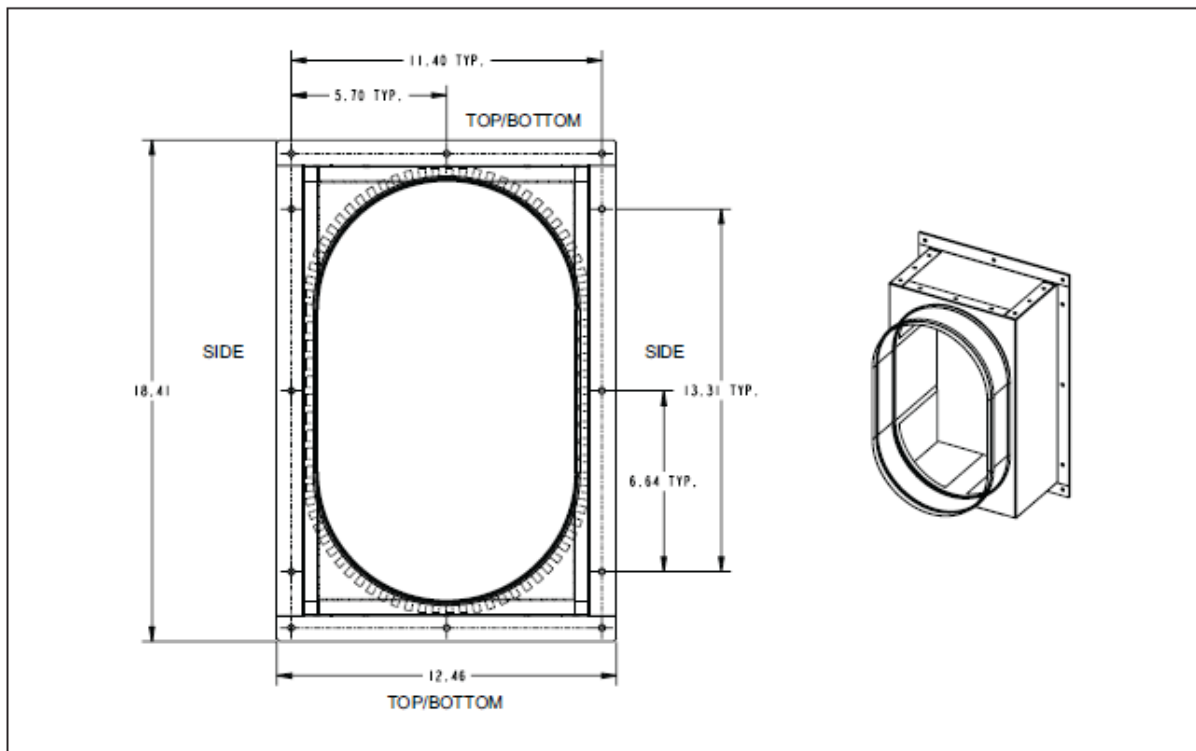
**JAYSQRD004 (For use on \*\*\*\*\*24 - 36 Heat Pump units)**

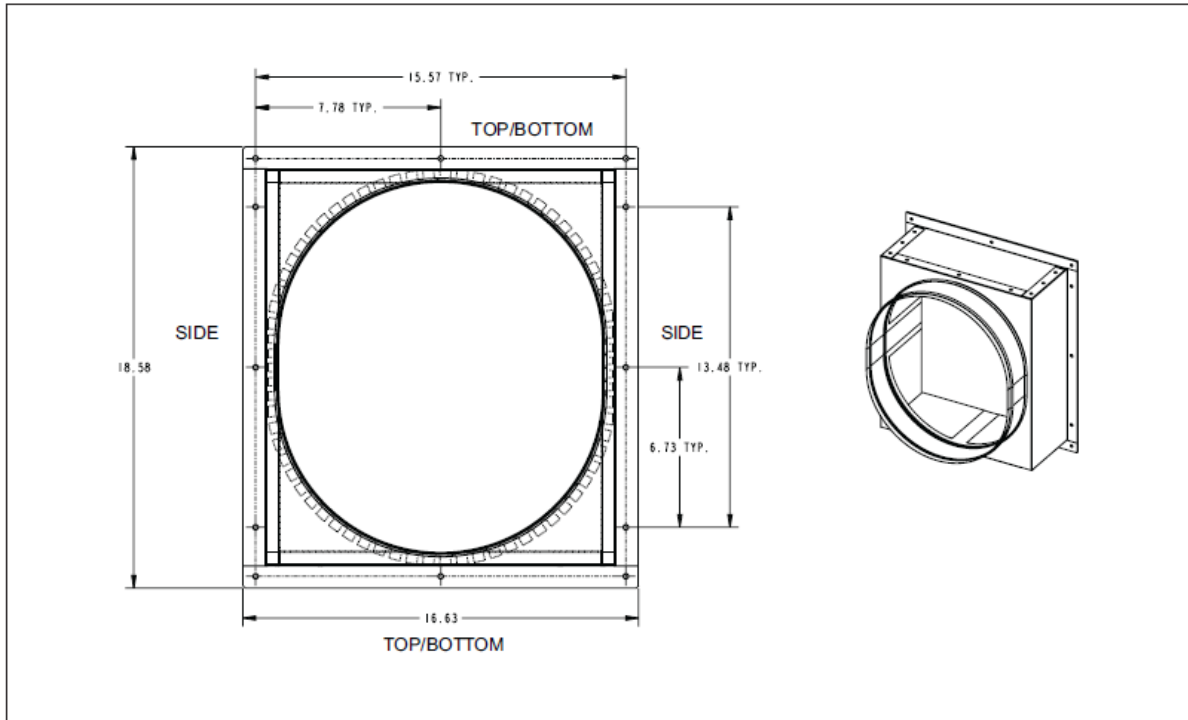


JAYSQRD005 (For use on \*\*\*\*\*42 - 60 Heat Pump units)



JAYSQRD002 (For use on \*\*\*\*\*24 - 42 Double Deck Gas Units)






Oxbox®, endorsed by Trane®, offers simple, affordable residential heating and cooling solutions strong enough to tackle the toughest conditions. For more information visit [www.oxboxhvac.com](http://www.oxboxhvac.com).

The manufacturer has a policy of continuous data improvement and it reserves the right to change design and specifications without notice. We are committed to using environmentally conscious print practices. Representative-only illustrations included in this document.

## Documents / Resources

	<p><a href="#">OXBOX BX-SVN-JAYSQRD-1A Square to Round Adapter Kit</a> [pdf] Instruction Manual  BX-SVN-JAYSQRD-1A Square to Round Adapter Kit, BX-SVN-JAYSQRD-1A, Square to Round Adapter Kit, Round Adapter Kit, Adapter Kit</p>
---	--

## References

- [Oxbox | Affordable quality heating and cooling systems](#)