



OttLite CSNWC51W Twist LED Desk Lamp with Wireless Charging User Manual

[Home](#) » [OttLite](#) » OttLite CSNWC51W Twist LED Desk Lamp with Wireless Charging User Manual 

Ott Lite CSNWC51W Twist LED Desk Lamp with Wireless Charging



Contents

- [1 Discription](#)
- [2 CONGRATULATIONS!](#)
- [3 PRODUCT REGISTRATION FORM](#)
- [4 WIRELESS CHARGING INSTRUCTIONS](#)
- [5 FCC PART 15](#)
- [6 Documents / Resources](#)
 - [6.1 References](#)
- [7 Related Posts](#)

Discription

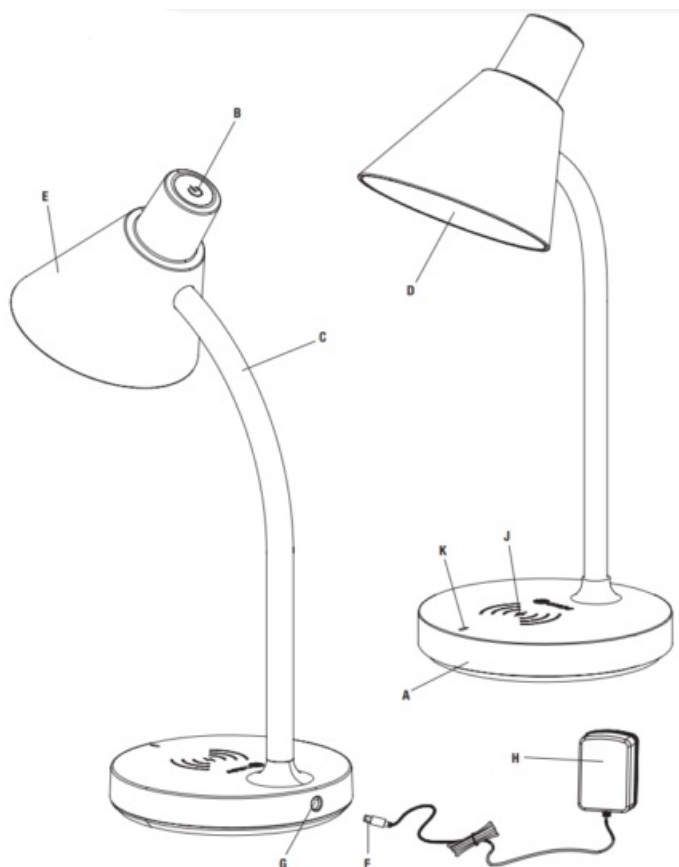

CONGRATULATIONS!

You've purchased the finest in natural lighting technology with your new Ott Lite® product.

PRODUCT REGISTRATION FORM

Please complete the enclosed Product Registration Form and return it today by mail, or register online by going to: OttLite.com/warranty

WARNING: To prevent electric shock, make sure the lamp is not plugged in until all steps are complete.

NOTE: THIS UNIT IS FULLY ASSEMBLED

1. Remove lamp from packing, placing lamp body base (A) flat on a steady surface.
2. Connect power adapter input (F) into connector (G) in the rear-bottom of the lamp.
3. Plug the power adapter (H) into a standard household 120V AC outlet.

NOTE: Only use with the supplied power adapter to avoid damage or fire.

4. Turn the lamp ON & OFF using power switch (B) located on the top of the lamp head. Power switch (B) is a "touch" switch that controls the dimmer function for 3 levels of brightness.
5. To power LED settings, slightly touch the switch to achieve the following:
 - turn lamp "ON" to low brightness; touch the switch "once";
 - for medium brightness; touch the switch "twice";
 - for high brightness level; touch the switch "three-times";
 - to turn lamp "OFF"; touch the switch "four-times".
6. This lamp provides three color modes. To adjust lighting color mode slightly "press and hold" switch (B) for two

seconds to switch light color temperature mode; 5000K, 2700K, 3500K.

7. Wireless charger (J) is located in the center of base (A). See Wireless Charging Instructions section for details.
8. To position the shade simply bend the flex-neck (C) as needed to point the light. Please hold the lamp base (A) while adjusting the lamp.

WIRELESS CHARGING INSTRUCTIONS

To wirelessly charge a device, perform the following:

- Place the device, which supports wireless charging, face up on the middle of the wireless charging icon (J).
- When the device is centered on the wireless charging icon (J) a solid BLUE light (K) will come on noting charging mode active. Your device should show charging is taking place.
- Check the charge level on your device periodically to determine when device is fully charged.

CAUTION! Device may become warm during charging. This is normal and part of the process. Charging times vary by device.

SAFETY WARNING: TO REDUCE THE RISK OF FIRE, ELECTRIC SHOCK, OR INJURY TO PERSONS

1. Turn lamp off and WAIT UNTIL LAMP HEAD (E) IS COOL before handling.
2. The LED panel (D) might get hot after several hours of continuous use DO NOT place your hands directly on LED light panel.
3. Never use with an extension cord unless the plug can be fully inserted into the receptacles in the extension cord.
4. Do not alter the plug.
5. The lamp head included with this unit cannot be replaced by the consumer.
6. INDOOR USE ONLY.

NOTE: The important safety instructions appearing in this instruction sheet are not meant to cover all possible conditions and situations that may occur. It must be understood that common sense, caution, and care must be used with any electrical product.

CAUTION! IF THE EXTERNAL FLEXIBLE CABLE OR CORD OF THIS LUMINAIRE IS DAMAGED, IT SHALL BE EXCLUSIVELY REPLACED BY THE MANUFACTURER OR ITS SERVICE AGENT OR A SIMILAR QUALIFIED PERSON IN ORDER TO AVOID A HAZARD. INDOOR USE ONLY.

CAUTION! THE LIGHT SOURCE OF THIS LUMINAIRE IS NOT REPLACEABLE; WHEN THE LIGHT SOURCE REACHES ITS END OF LIFE THE WHOLE LUMINAIRE SHALL BE REPLACED.

CAUTION: Any change or modification to product not expressly recognized by Ott Lite voids Ott Lite's responsibility for proper function of product.

FCC PART 15

Note: This equipment has been tested and found to comply with the limits for a Class B digital device, pursuant to Part 15 of the FCC rules. These limits are designed to provide reasonable protection against harmful interference in a residential installation. This equipment generates, uses and can radiate radio frequency energy and, if not installed and used in accordance with the instructions, may cause harmful interference to radio communications.

However, there is no guarantee that the interference will not occur in a particular installation. If this equipment does cause harmful interference to radio or television reception, which can be determined by turning the equipment off and on, the user is encouraged to try to correct the interference by one or more of the following measures:

- Reorient or relocate the receiving antenna.
- Increase the separation between the equipment and receiver.
- Connect the equipment into an outlet on a circuit different from that to which the receiver is connected.
- Consult the dealer or an experienced radio/TV technician for help.

Changes or modifications not expressly approved by the party responsible for compliance could void the user's authority to operate the equipment.

This device complies with Part 15 of the FCC Rules. Operation is subject to the following two conditions:

1. this device may not cause harmful interference, and
2. this device must accept any interference received, including interference that may cause undesired operation.

FCC RF RADIATION EXPOSURE STATEMENT CAUTION:

To maintain compliance with the FCC's RF exposure guidelines, place the product at least 20cm from nearby persons.

POWER ADAPTER SPECIFICATION:

Input: AC 100-240V, 50/60 Hz, 0.6A

Output: 13V DC, 1.2A with a Male DC Plug

WIRELESS CHARGER SPECIFICATION: Output: 5V, 1A or 5 watts



Documents / Resources



[OttLite CSNWC51W Twist LED Desk Lamp with Wireless Charging](#) [pdf] User Manual
INS240813, PL-0370Q, CSNWC51W Twist LED Desk Lamp with Wireless Charging, CSNWC51
W, Twist LED Desk Lamp with Wireless Charging, LED Desk Lamp with Wireless Charging, Des
k Lamp with Wireless Charging, Lamp with Wireless Charging, Wireless Charging, Charging

References

- [User Manual](#)

[Manuals+](#), [Privacy Policy](#)

This website is an independent publication and is neither affiliated with nor endorsed by any of the trademark owners. The "Bluetooth®" word mark and logos are registered trademarks owned by Bluetooth SIG, Inc. The "Wi-Fi®" word mark and logos are registered trademarks owned by the Wi-Fi Alliance. Any use of these marks on this website does not imply any affiliation with or endorsement.