



## OttLite CS4QTK1Z LED Table Lamp With Wireless Charging User Manual

[Home](#) » [OttLite](#) » OttLite CS4QTK1Z LED Table Lamp With Wireless Charging User Manual 



### Contents

- [1 OttLite CS4QTK1Z LED Table Lamp With Wireless Charging](#)
- [2 Wireless Charging LED Table Lamp](#)
- [3 WARNING:](#)
- [4 WIRELESS CHARGING INSTRUCTIONS:](#)
  - [4.1 CAUTION!](#)
  - [4.2 SAFETY WARNING!](#)
- [5 CAUTION!](#)
- [6 FCC PART 15](#)
- [7 Documents / Resources](#)
- [8 Related Posts](#)

**OttLite CS4QTK1Z LED Table Lamp With Wireless Charging**



**Wireless Charging LED Table Lamp**

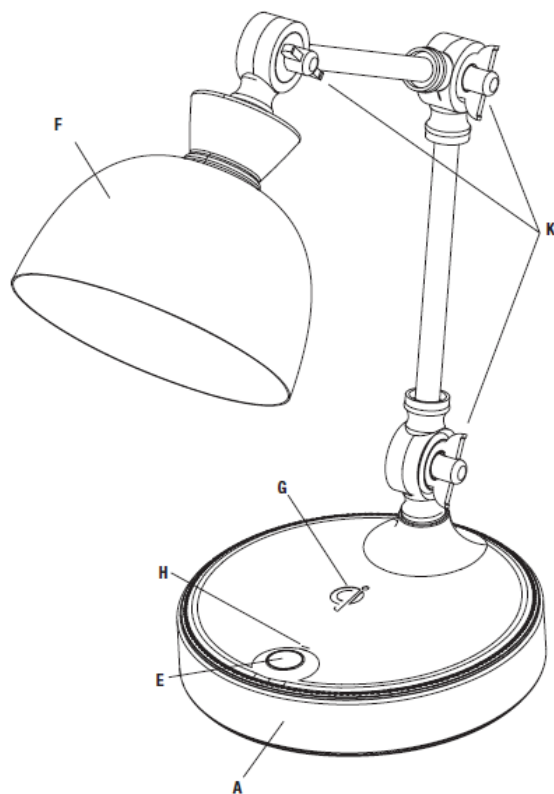

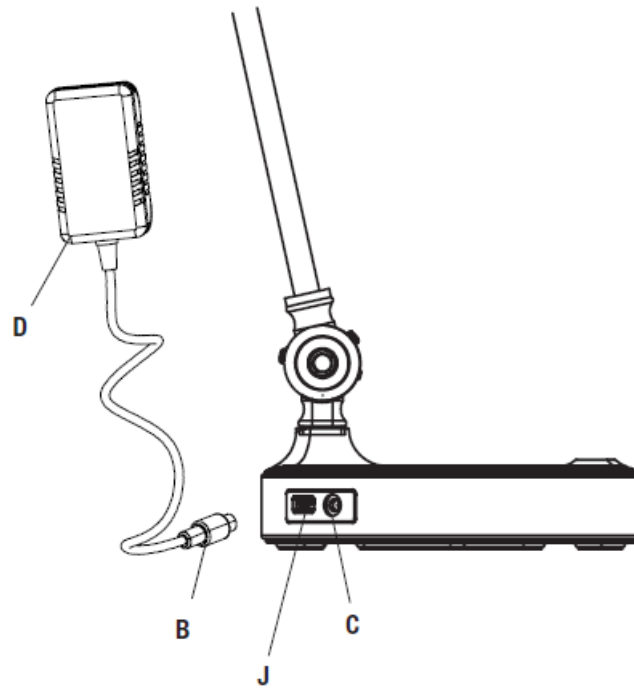

## CONGRATULATIONS!

You've purchased the finest in natural lighting technology with your new OttLite® product.

## WARNING:

To prevent electric shock, make sure the lamp is not plugged in until all steps are complete.

**NOTE:** THIS UNIT IS FULLY ASSEMBLED

1. Remove lamp from packing, placing lamp body base (A) flat on a steady surface.
2. Connect power adapter input (B) into connector (C) in the rear-bottom of the lamp.
3. Plug the power adapter (D) into a standard household 120V AC outlet.

**Note:** Only use with the supplied power adapter to avoid damage or fire.

4. Turn the lamp ON & OFF using power switch (E) located in the front-upper side of base (A). Power switch (E) is a "touch" switch that controls the dimmer function for 3 levels of brightness and the color mode function of the lamp.
5. To power LED settings, slightly touch the switch to achieve the following:
  - to turn lamp "ON" to first lower-brightness; touch the switch "once";
  - for medium-brightness; touch the switch "twice";
  - for high-brightness; touch the switch "three-times";
  - to turn the lamp "OFF"; touch the switch "four times".
6. This lamp provides three color modes. To adjust lighting color mode slightly "press and hold" switch (E) for three seconds to switch light color temperature mode; 5000°K, 2700°K, 4000°K. **NOTE:** 5000°K is the default color mode.
7. A wireless charger for Qi-certified devices (G) is located in the center of the base (A). See the Wireless Charging Instructions section for details.
8. To position, the shade simply moves the shade (F) as needed to point the light. Adjust joint screws (K) to

position the lamp to the desired position.

## **WIRELESS CHARGING INSTRUCTIONS:**

Wireless charging requires a Qi-certified device. To determine if your device is Qi-certified, please visit the Wireless Power Consortium website.

To wirelessly charge a device, perform the following:

- Place the device, which supports Qi wireless charging standard, face-up on the middle of the Qi wireless charging emblem (G).
- When the device is centered on the Qi wireless charging icon (G), a solid RED light (H) will indicate the device is charging properly. NOTE: If the RED light is blinking this indicates the device is not charging and needs to be properly centered.
- Check the charge level on your device periodically to determine when the device is fully charge

### **CAUTION!**

THE DEVICE MAY BECOME WARM DURING CHARGING. THIS IS NORMAL AND PART OF THE PROCESS. CHARGING TIMES VARY BY DEVICE.

### **SAFETY WARNING!**

TO REDUCE THE RISK OF FIRE, ELECTRIC SHOCK, OR INJURY TO PERSONS

1. The light shade (F) might get hot after several hours of continuous use. Use caution when moving the shade.
2. Never use with an extension cord unless the plug can be fully inserted into the receptacles in the extension cord.
3. Do not alter the plug.
4. The lamp head included with this unit cannot be replaced by the consumer.
5. INDOOR USE ONLY.

**NOTE:** This product is intended for indoor use and the instructions may not cover all possible indoor conditions or situations. Common sense, caution and care must be used with any electrical product.

### **CAUTION!**

IF THE EXTERNAL FLEXIBLE CABLE OR CORD OF THIS LUMINAIRE IS DAMAGED, IT SHALL BE EXCLUSIVELY REPLACED BY THE MANUFACTURER OR ITS SERVICE AGENT OR A SIMILAR QUALIFIED PERSON IN ORDER TO AVOID A HAZARD. INDOOR USE ONLY. ONLY USE WITH THE SUPPLIED POWER ADAPTER TO AVOID DAMAGE OR FIRE. THE LIGHT SOURCE OF THIS LUMINAIRE IS NOT REPLACEABLE; WHEN THE LIGHT SOURCE REACHES ITS END OF LIFE THE WHOLE LUMINAIRE SHALL BE REPLACED.

Any change or modification to product not expressly recognized by OttLite Technologies voids OttLite's responsibility for proper function of product.

## **FCC PART 15**

**Note:** This equipment has been tested and found to comply with the limits for a Class B digital device, pursuant to Part 15 of the FCC rules. These limits are designed to provide reasonable protection against harmful interference in a residential installation. This equipment generates, uses and can radiate radio frequency energy and, if not

installed and used in accordance with the instructions, may cause harmful interference to radio communications. However, there is no guarantee that the interference will not occur in a particular installation. If this equipment does cause harmful interference to radio or television reception, which can be determined by turning the equipment off and on, the user is encouraged to try to correct the interference by one or more of the following measures:

- Reorient or relocate the receiving antenna.
- Increase the separation between the equipment and receiver.
- Connect the equipment into an outlet on a circuit different from that to which the receiver is connected.
- Consult the dealer or an experienced radio/TV technician for help.

Changes or modifications not expressly approved by the party responsible for compliance could void the user's authority to operate the equipment.

This device complies with Part 15 of the FCC Rules. Operation is subject to the following two conditions:

1. this device may not cause harmful interference, and
2. may cause undesired operation

#### **FCC/IC RF RADIATION EXPOSURE STATEMENT CAUTION:**

To maintain compliance with the FCC's RF exposure guidelines, place the product at least 20cm from nearby persons.

#### **IC CANADA**

This device contains licence-exempt transmitter(s)/receiver that comply with Innovation, Science and Economic Development Canada's licence-exempt RSS(s). Operation is subject to the following two conditions:

1. This device may not cause interference.
2. This device must accept any interference, including interference that may cause undesired operation of the device.

CAN RSS-216/CNR-216

CAN ICES-005 (B)/NMB-005 (B)

#### **POWER ADAPTER SPECIFICATION:**

Input: AC 100-240V, 50/60 Hz, 1.0A Max

Output: 12V DC, 2.5A with a Male DC Plug

#### **Qi CHARGER SPECIFICATION:**

Output: up to 5 Watts depending on device

THIS LAMP CONTAINS a 5V, 2.1A USB output port (J) located on the bottom rear of lamp. USB port can charge items such as tablets, cellular phones, etc.

The "Qi" symbol is a trademark of the Wireless Power Consortium

## **Documents / Resources**



[OttLite CS4QTK1Z LED Table Lamp With Wireless Charging](#) [pdf] User Manual  
W13, 2AI7B-W13, 2AI7BW13, CS4QTK1Z, LED Table Lamp With Wireless Charging