



OSRAM V4 LEDCOMFO Downlight User Guide

[Home](#) » [OSRAM](#) » OSRAM V4 LEDCOMFO Downlight User Guide 

OSRAM

LEDCOMFO® Downlight V4

Contents

[1 V4 LEDCOMFO
Downlight](#)

[2 Documents / Resources](#)

[2.1 References](#)

V4 LEDCOMFO Downlight

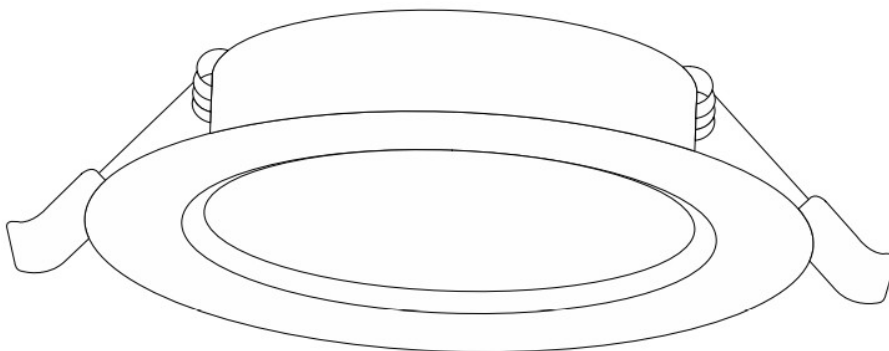

- Please read instruction carefully before assembling and installation
- Please keep instruction as reference in the future

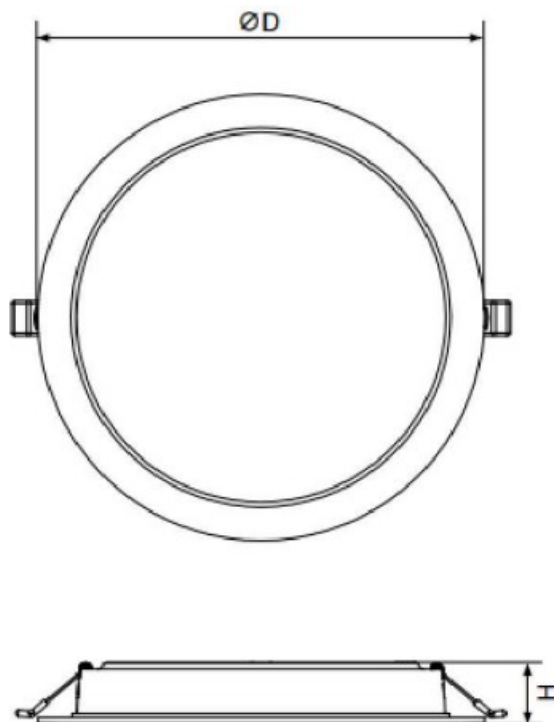

	Ø [mm]	H [mm]	 [mm]
LEDCOMFO DL V4 8W	119	26	100
LEDCOMFO DL V4 10W	149	27	130
LEDCOMFO DL V4 16W	176	28	155
LEDCOMFO DL V4 24W	220	30	195

	Wattage	Input Voltage	Input Current	Beam Angle	CCT	PF	ta
LEDCOMFO DL V4 8W	8W	220-240V~	0.065A	110°	3000K/ 4000K/ 6500K	>0.5	40°C
LEDCOMFO DL V4 10W	10W		0.086A				
LEDCOMFO DL V4 16W	16W		0.144A				
LEDCOMFO DL V4 24W	24W		0.205A				

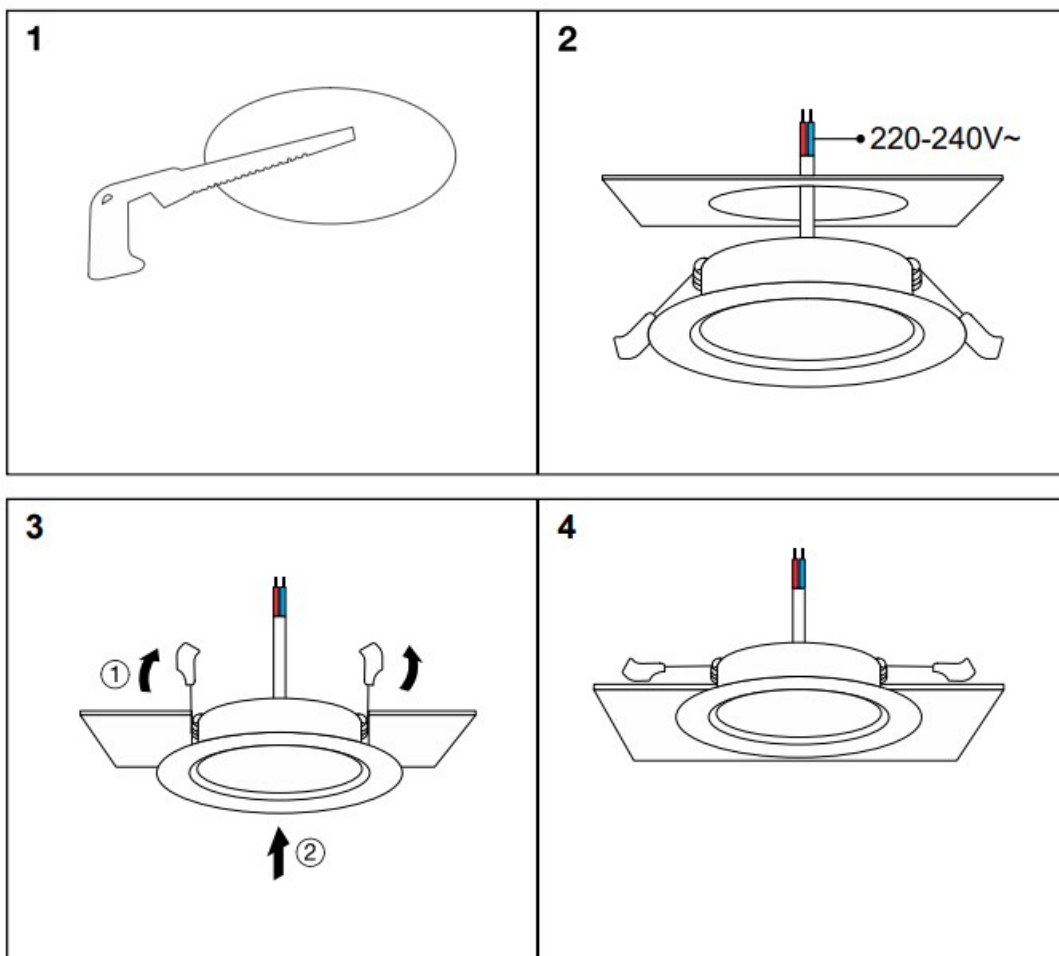
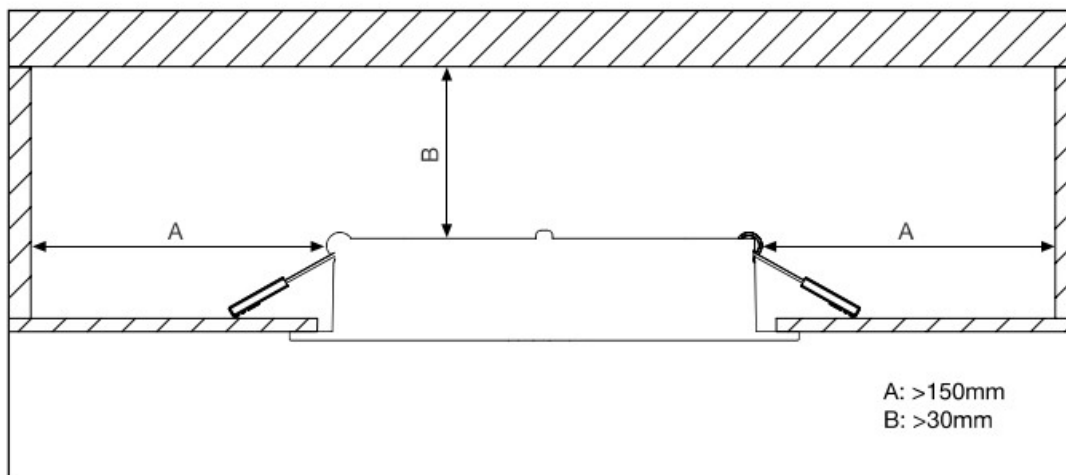

WARNING

- This product must be installed by a licensed electrician, and installation should follow national installation rules.
- Indoor use only.
- The light source of this luminaire is not replaceable; when the light source reaches its end of life the whole luminaire shall be replaced.
- The external flexible cord of this luminaire cannot be replaced; if the cord is damaged, the luminaire shall be destroyed.
- Terminal block not included. Installation may require advice from a qualified person.

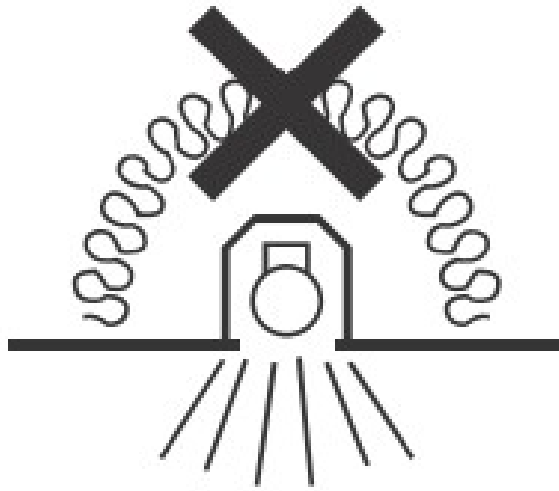

- Luminaires not suitable for covering with thermally insulating material.

Conformance to:

7000.1
7000,202
T 17743

IEC 60598-1 Luminaires – Part 1: General requirements and tests
IEC 60598-2-1 Part 2: Particular requirements
Section One – Fixed general purpose luminaires

Traxon Technologies Ltd.

Room 113, 1/F, Wireless Centre, 3 Science Park East Avenue, Shatin, New Territories, Hong Kong
Traxon Technologies Europe GmbH
Karl-Schurz-Str. 38, 33100 Paderborn, Germany

Traxon Lighting Company Limited

B402 – B421, Building 6, Northwest Shenjiu Science and Technology Pioneer Park, the intersection of Taohua Road and Binglang Road, Fubao Community, Fubao Street, Futian District, Shenzhen





[OSRAM V4 LEDCOMFO Downlight](#) [pdf] User Guide V4 LEDCOMFO Downlight, V4 LEDCOMFO Downlight, LEDCOMFO Downlight, Downlight

References

- [Traxon e:cue](#)
- [User Manual](#)

[Manuals+](#), [Privacy Policy](#)

This website is an independent publication and is neither affiliated with nor endorsed by any of the trademark owners. The "Bluetooth®" word mark and logos are registered trademarks owned by Bluetooth SIG, Inc. The "Wi-Fi®" word mark and logos are registered trademarks owned by the Wi-Fi Alliance. Any use of these marks on this website does not imply any affiliation with or endorsement.