



OSRAM V3 Ledcomfo Downlight Installation Guide

[Home](#) » [OSRAM](#) » OSRAM V3 Ledcomfo Downlight Installation Guide 

OSRAM



LED COMFO® Louver V3

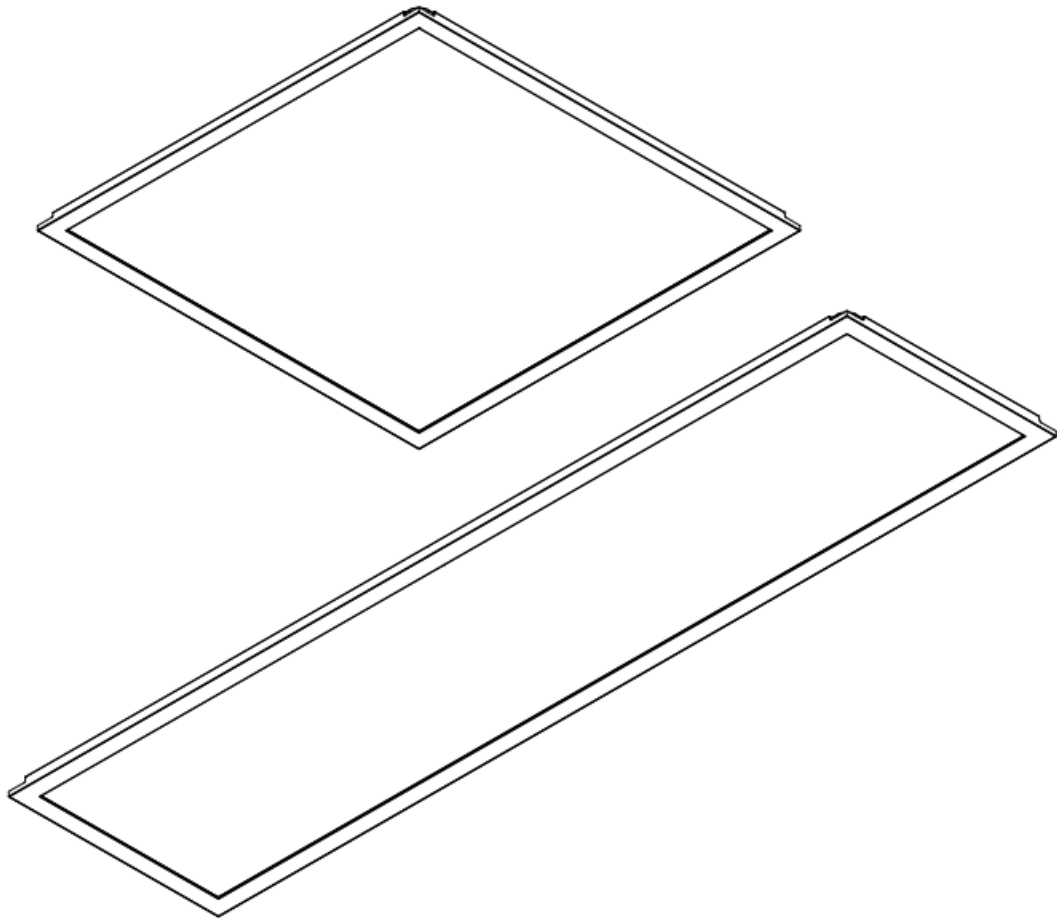

- Please read instruction carefully before assembling and installation
- Please keep instruction as reference in the future

Contents

[1 LEDCOMFO® Louver V3](#)

[2 Documents / Resources](#)

[2.1 References](#)

[3 Related Posts](#)

LEDCOMFO® Louver V3

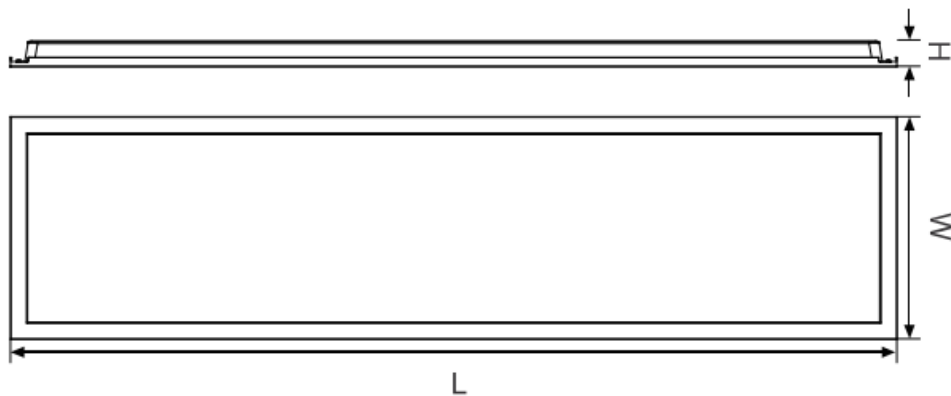

Dimension, Series	LxWxH (mm)
LCM LV V3 0312 34W	1195x295x35
LCM LV V3 0312 34W IT	1200x300x35

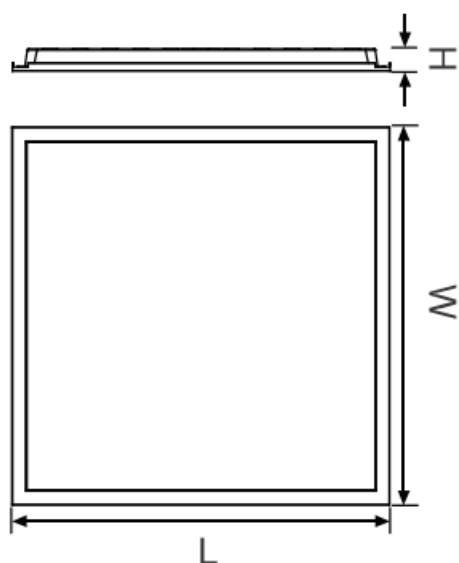

Dimension, Series	LxWxH (mm)
LCM LV V3 0606 34W.	595x596x25
LCM LV V3 0606 34W IT	600x600x25

Integrated ceiling mount

A1

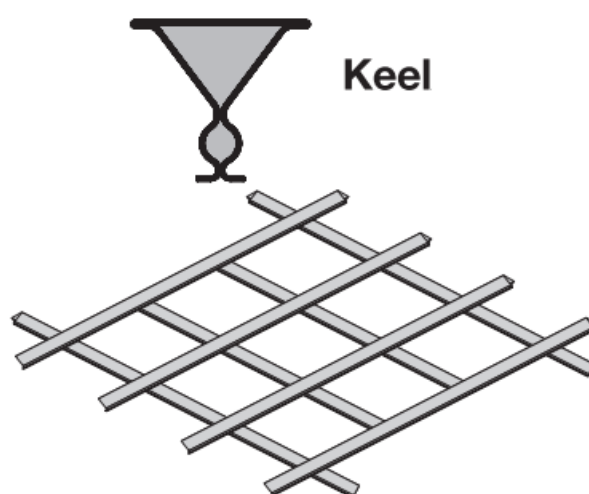

Series: models with suffix "IT"/

A2

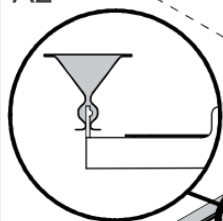

"click"

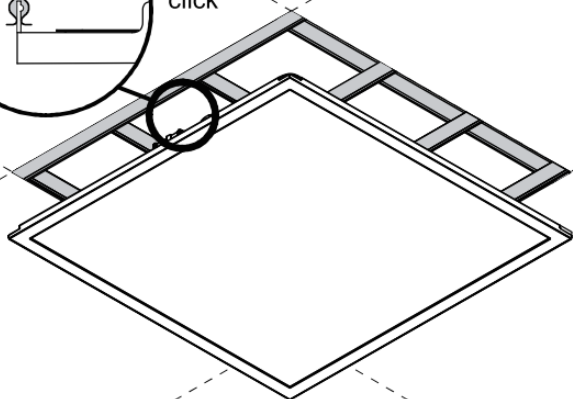

A3

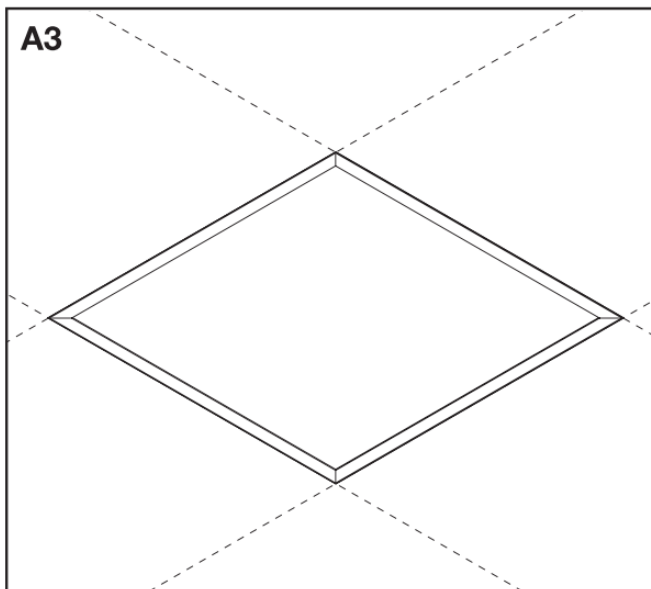

Recessed mount

B1

Series: models

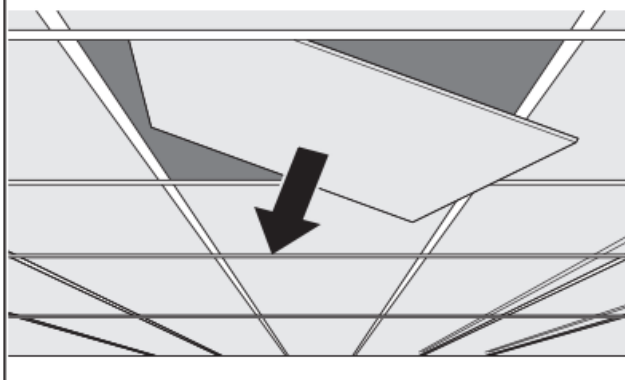

B2

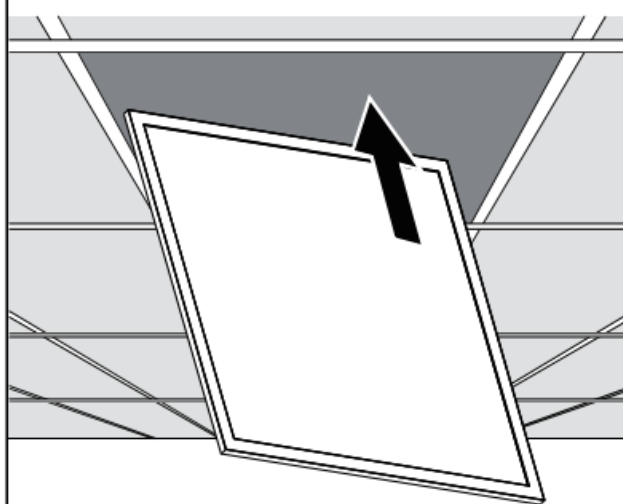

B3

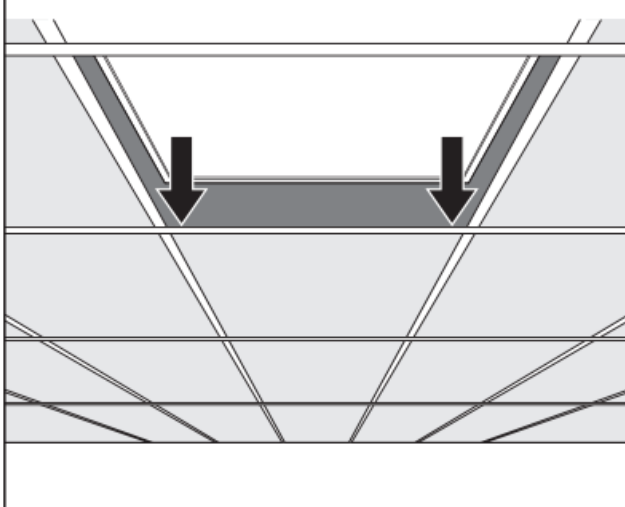

B4

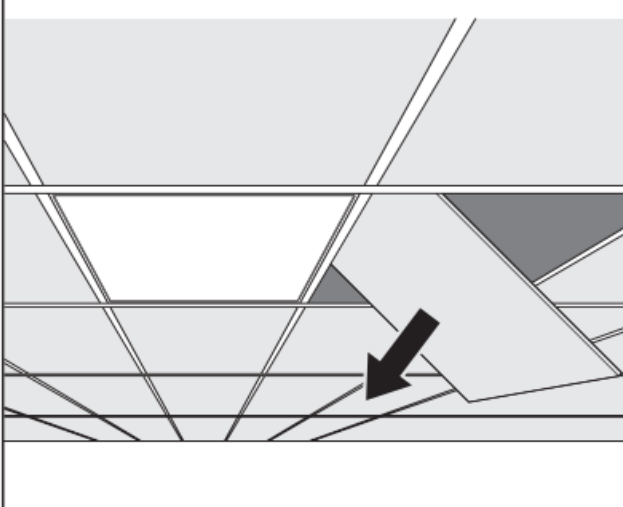

B5

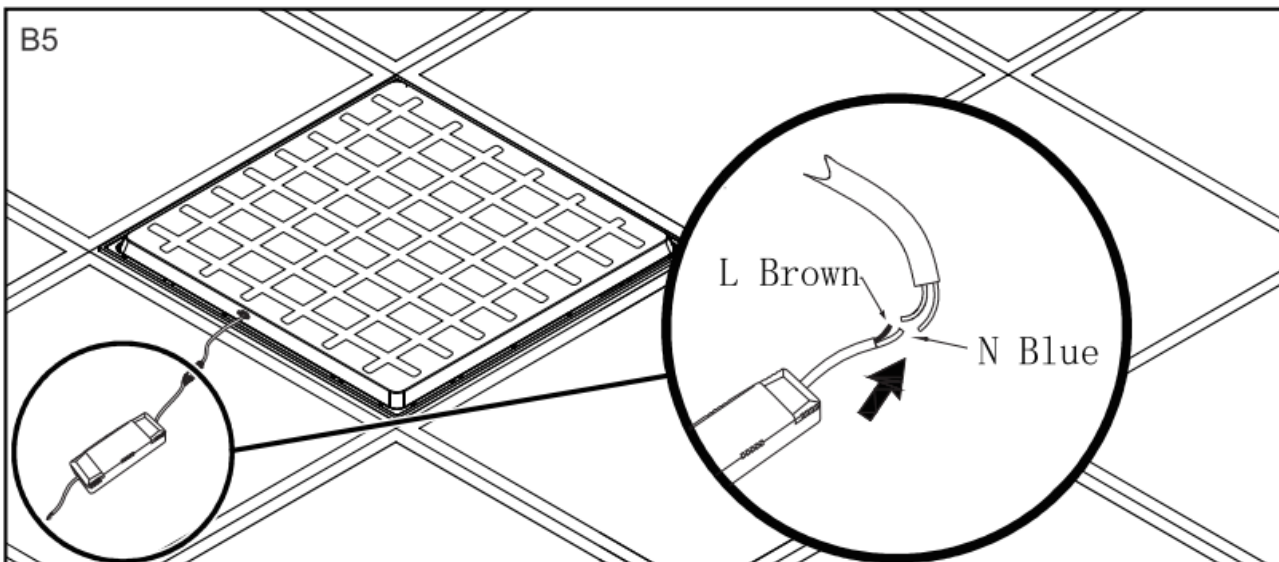

B6

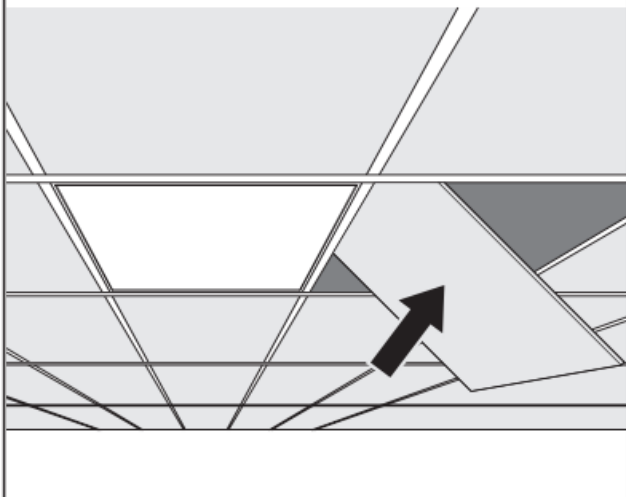

Suspension mount.

C

Accessories not included/

Series: models

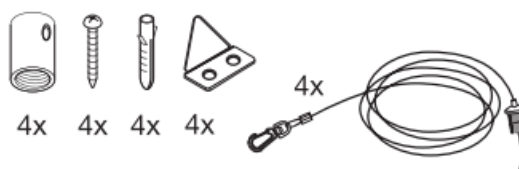

C1a

LCM LV V3 0606 34W

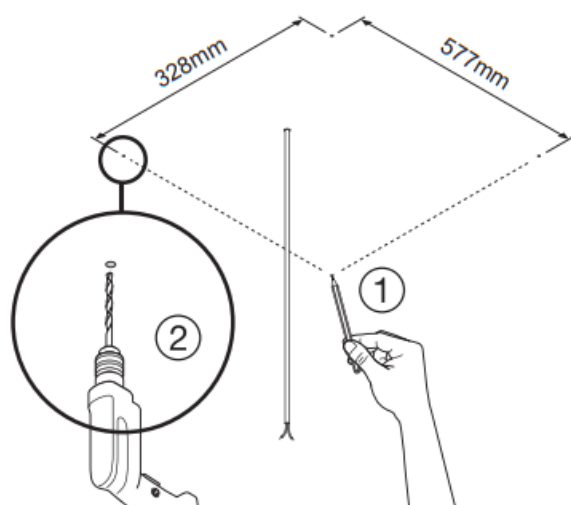

C1b

LCM LV V3 0312 34W

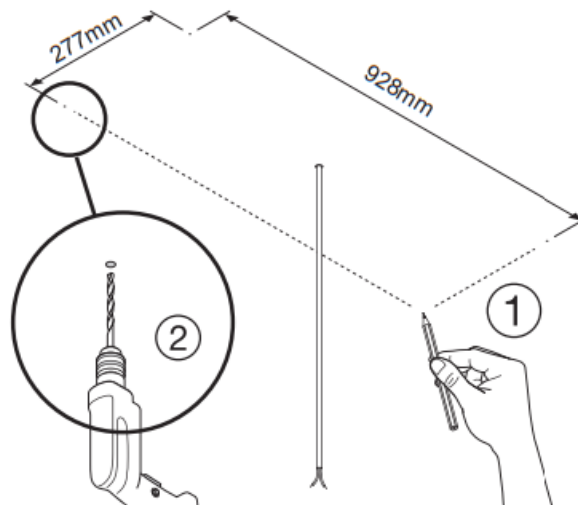

C2

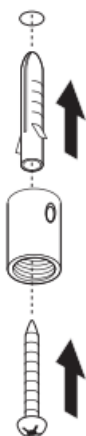

C3

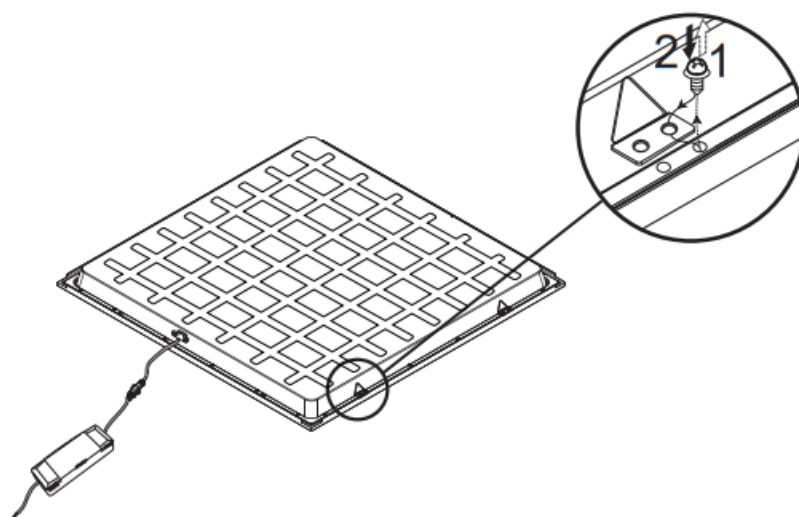

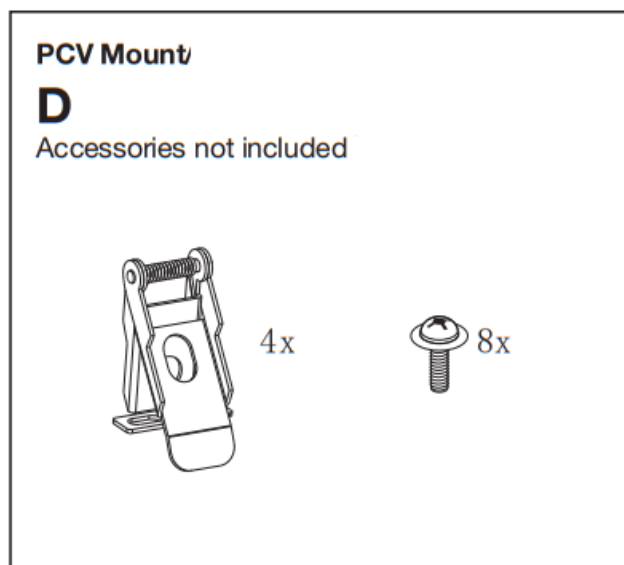
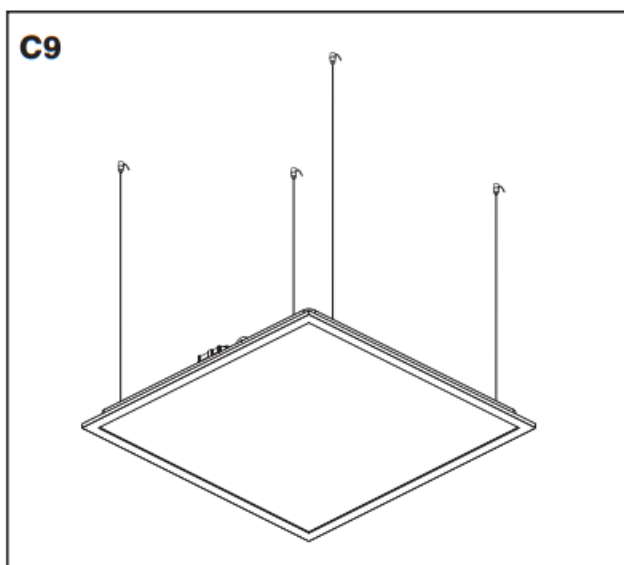
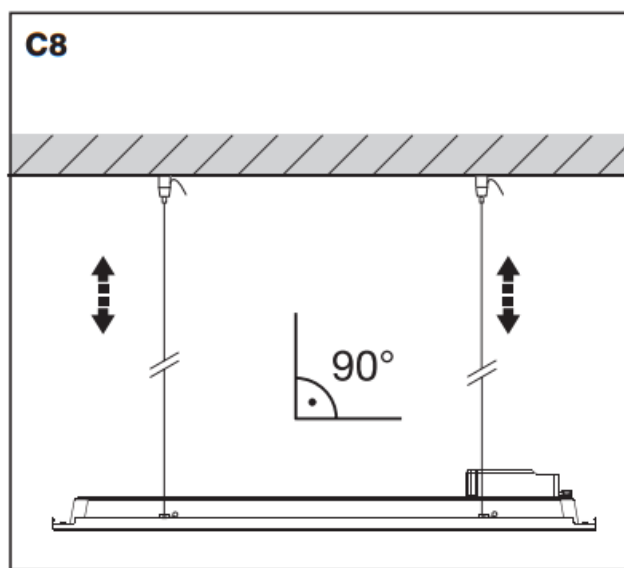
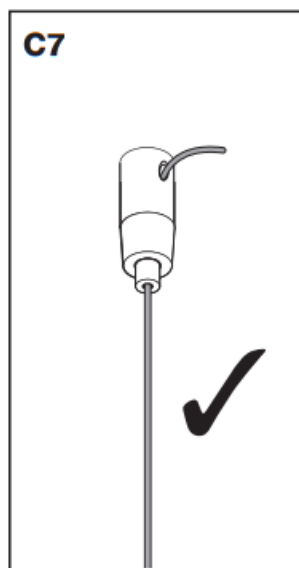
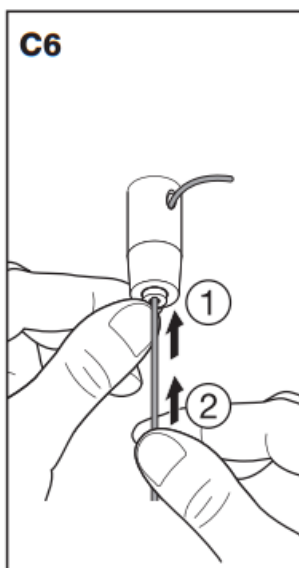
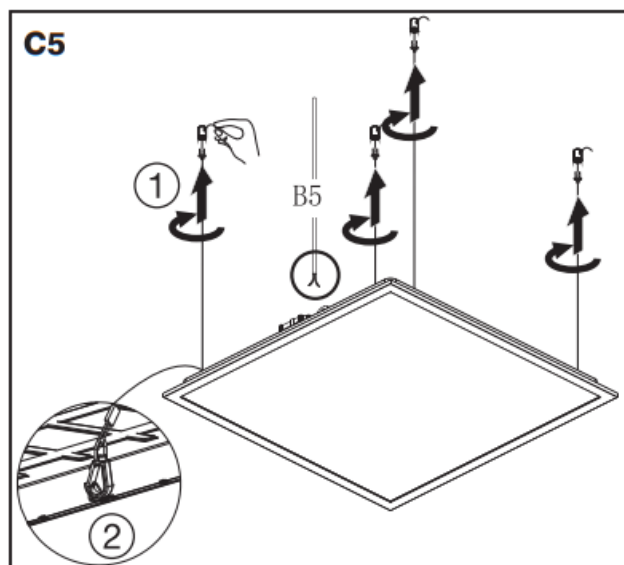
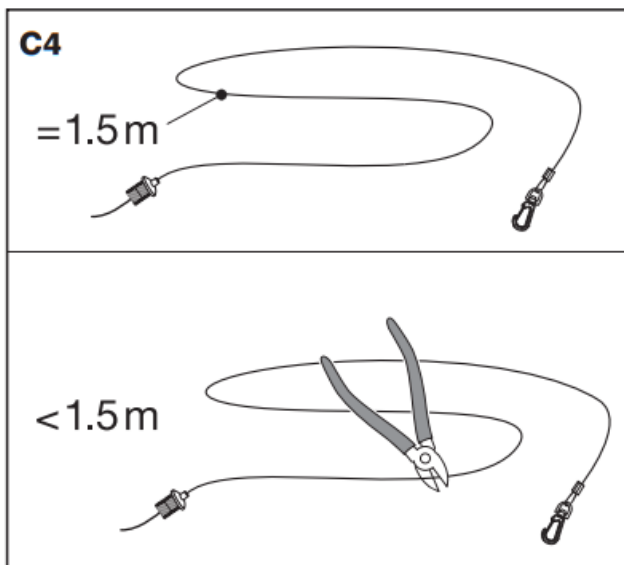

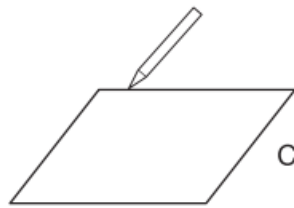
D1

Cut out size.

LCM LV V3 0606 34W	585x585mm
LCM LV V3 0312 34W	285x1185mm

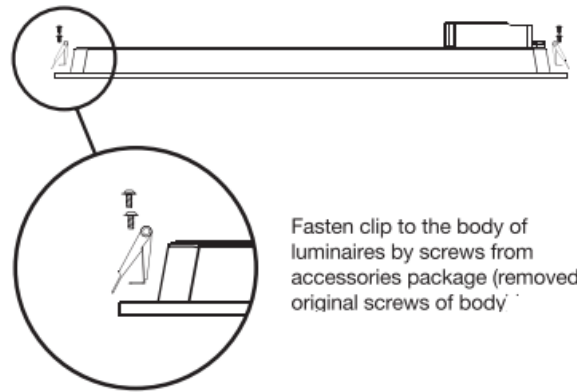
D2

Fasten clip to the body of
luminaires by screws from
accessories package (removed
original screws of body)

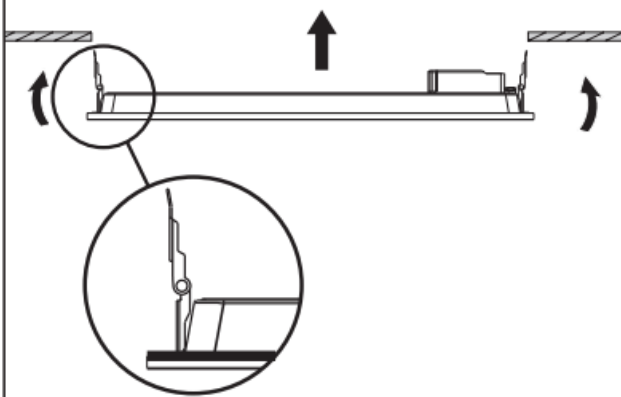
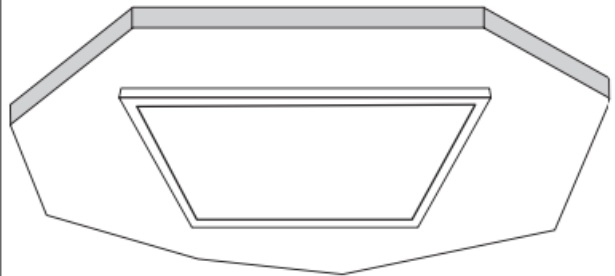
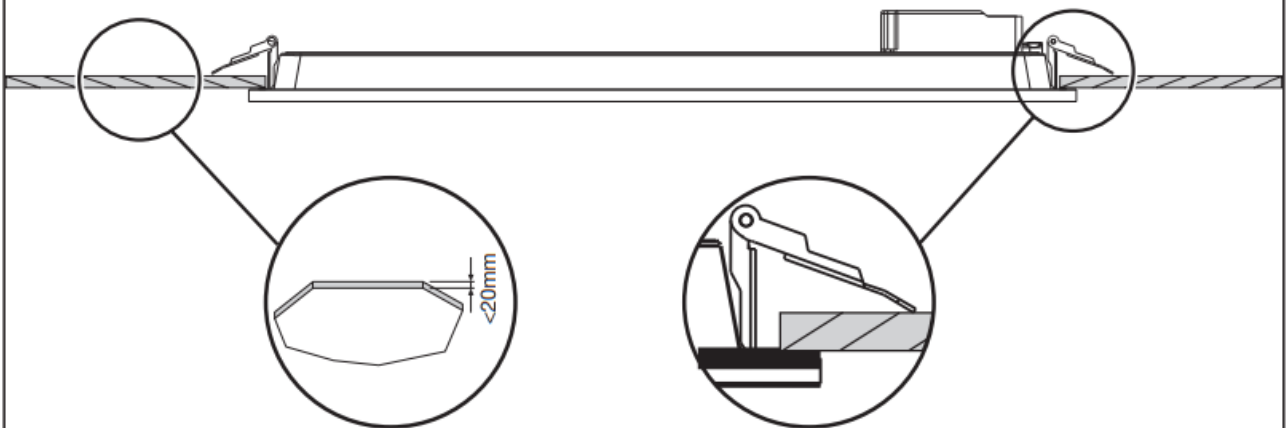
D3**D4****D5****WARNING**

1. Ensure that any installation and maintenance be performed by a qualified electrician and that luminaire be wired in accordance with the latest IEE electrical regulations or the local equipments.
2. Ensure that the power supply is off before perform installation and maintenance and not switched on until the installation or maintenance complete.

3. If the external flexible cord of this luminaire is damaged, it shall be exclusively replaced by the manufacturer or his service agent or a similar qualified person in order to avoid a hazard.
4. The light source contained in this luminaire shall only be replaced by the manufacturer or his service agent or similar qualified person. Non-user replaceable LEDs.
5. The luminaire cannot be covered with thermal insulation matting or similar materials.
6. Terminal block not included. Installation may require advice from a qualified person.



The luminaire cannot be covered with thermal insulation matting or similar materials.

Traxon Technologies Ltd.

Room 113, 1/F, Wireless Centre, 3 Science Park East Avenue, Shatin, New Territories, Hong Kong

Traxon Technologies Europe GmbH

Karl-Schurz-Str. 38, 33100 Paderborn, Germany

Traxon Lighting Company Limited

B402 – B421, Building 6, Northwest Shenjia Science and Technology Pioneer Park, the intersection of Tachua Road and Binglang Road, Fubao Community, Fubao Street, Futian District, Shenzhen

www.traxon-ecue.com

IP20 (IP40 for front lighting panel/:40)



10104490591

G15061765

2023-06-26

OSRAM

TRAXON | ecue
MEMBER OF PROSPERITY GROUP

Documents / Resources

 <p>LED COMFO™ Louver V3 哈曼三代LED模组 哈曼三代LED模组</p> <p>TRAXON ecue OSRAM</p>	<p>OSRAM V3 Ledcomfo Downlight [pdf] Installation Guide V3 Ledcomfo Downlight, V3, Ledcomfo Downlight, Downlight</p>
--	--

References

-  [Traxon e:cue](#)
- [User Manual](#)

[Manuals+](#), [Privacy Policy](#)

This website is an independent publication and is neither affiliated with nor endorsed by any of the trademark owners. The "Bluetooth®" word mark and logos are registered trademarks owned by Bluetooth SIG, Inc. The "Wi-Fi®" word mark and logos are registered trademarks owned by the Wi-Fi Alliance. Any use of these marks on this website does not imply any affiliation with or endorsement.