



OSRAM LEDSC02-1 LeDriving Smart Canbus User Manual

[Home](#) » [OSRAM](#) » OSRAM LEDSC02-1 LeDriving Smart Canbus User Manual 

Contents

- [1 LEDSC02-1 LeDriving Smart Canbus](#)
- [2 Product Information](#)
- [3 Product Usage Instructions](#)
- [4 LEDriving® SMART CANBUS](#)
- [5 Documents / Resources](#)
 - [5.1 References](#)
- [6 Related Posts](#)

OSRAM

LEDSC02-1 LeDriving Smart Canbus

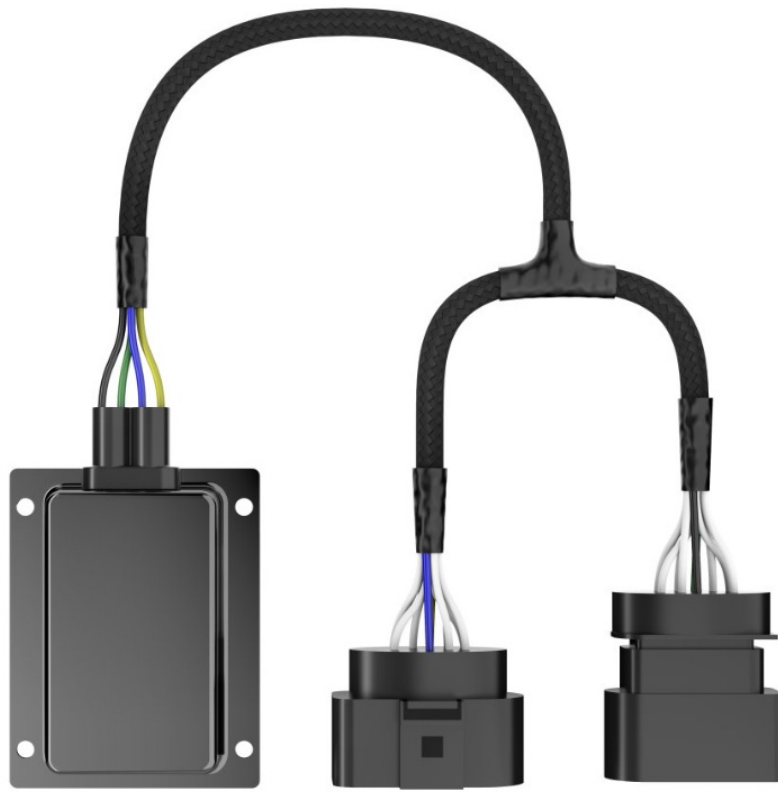

Product Information

The LEDSC02-1 is an electronic load resistor designed for use with Audi A4 B7 headlights. It is used to address issues that may arise due to the use of LED bulbs instead of halogen bulbs, such as hyper-flashing, bulb out warnings, and other warning signals.

The load resistor is connected to the vehicle's SMART CANBUS system and helps maintain the proper electrical load on the system.

It is easy to install and comes with cable ties for secure mounting.

Product Usage Instructions

Note: Before attempting to install the LEDSC02-1 load resistor, please refer to the vehicle's user manual for specific instructions on how to remove the air intake duct, air filter, and headlight connections.

1. Detach and remove the air intake duct.
2. Pull the hose from the air filter by loosening the clamp.
3. Pry out and remove the air filter by loosening the locking pin.
4. Connect the SMART CANBUS (load resistor) plug to the vehicle connector.
5. Connect the SMART CANBUS (load resistor) socket with the headlight.
6. Mount the SMART CANBUS (load resistor) to the vehicle's body (metal). Use the cable ties provided and pull them until they are taut.
7. Reinstall the air filter.
8. Reinstall the air intake duct.

Note: The load resistor should be mounted to a metal surface on the vehicle's body. This will help dissipate heat generated during operation. For any questions or technical problems regarding maintenance, please contact OSRAM customer service via email at automotive-service@osram.com.

LEDSC02-1

Audi A4 B7

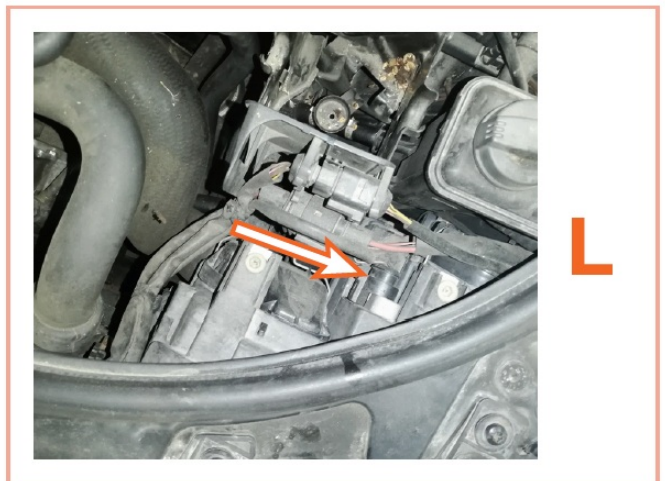
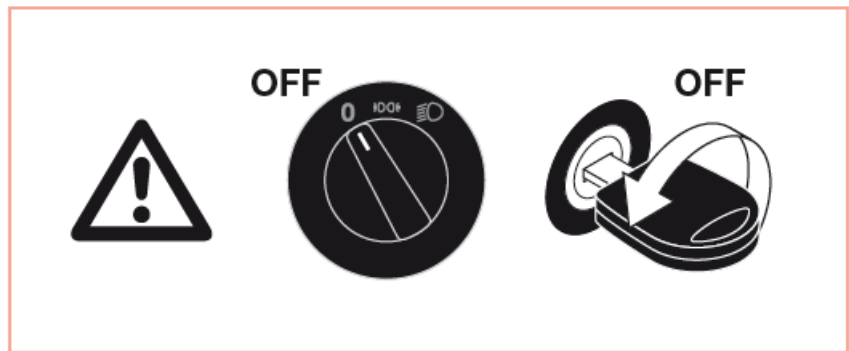
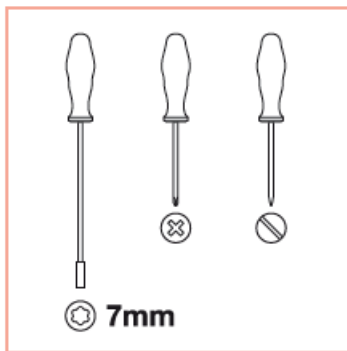
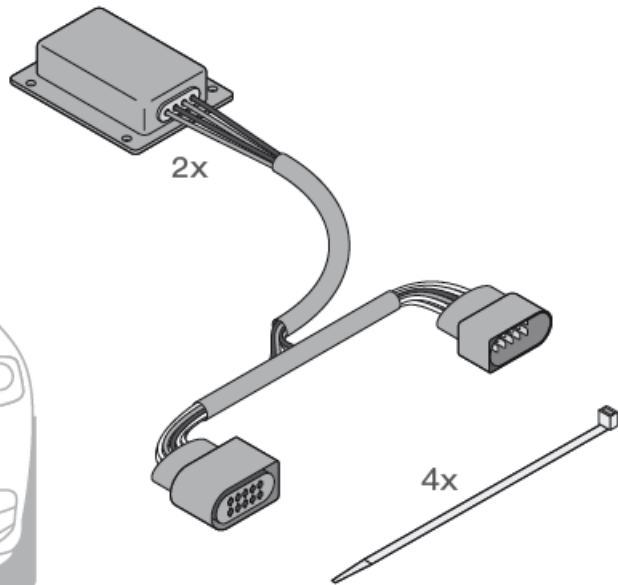
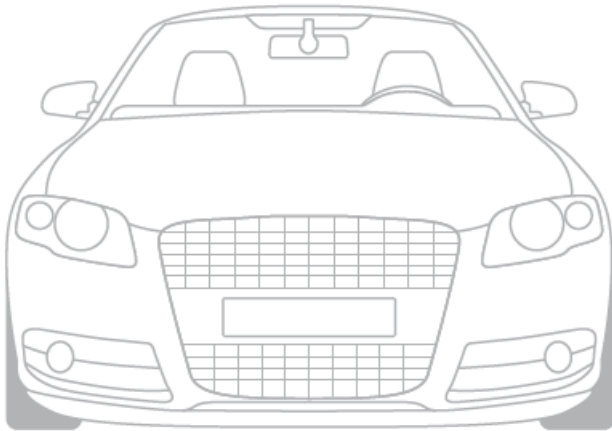

1

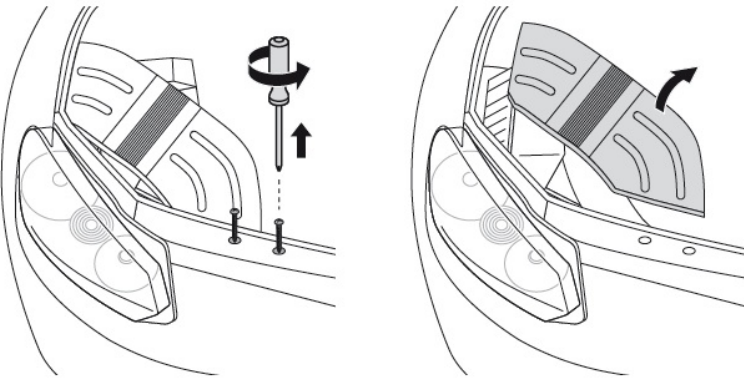

Detach and remove air intake duct. 2)

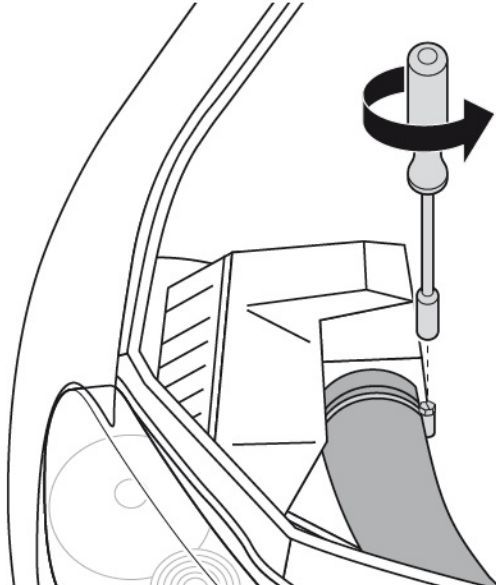

Pull hose from air filter by loosening the clamp. 3)

3

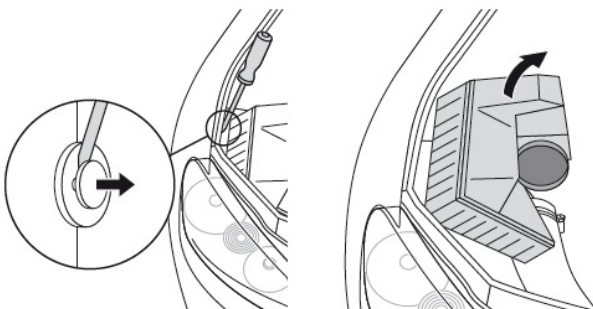

Pry out and remove the air filter by loosening the locking pin. 4)

4

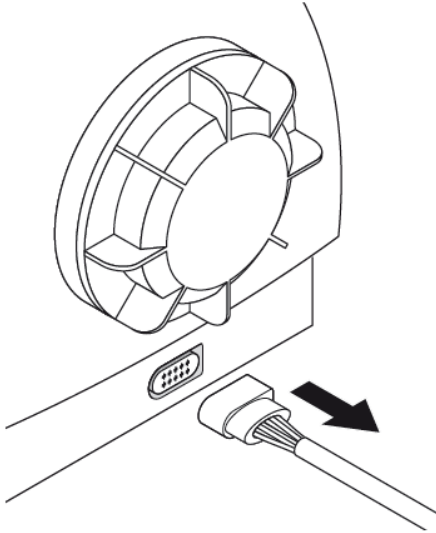

5

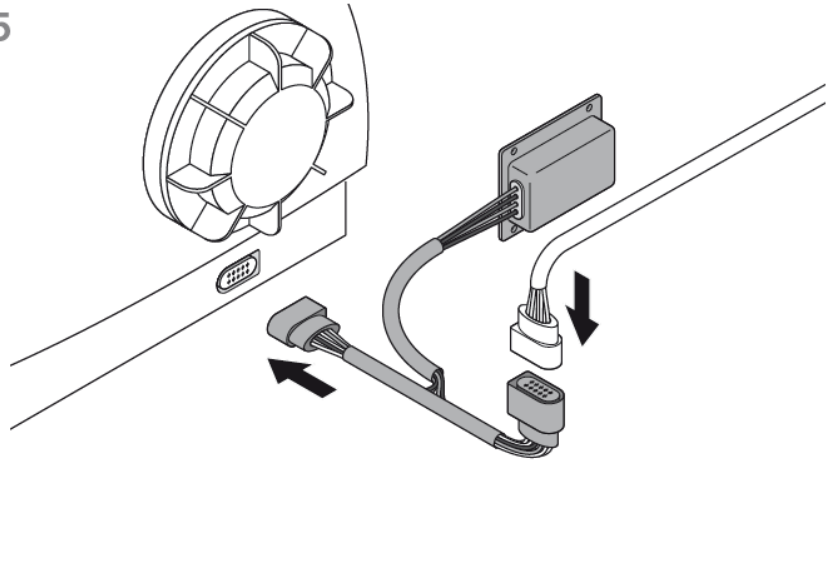

1. Connect the SMART CANBUS (load resistor) plug to the vehicle connector.
2. Connect the SMART CANBUS (load resistor) socket with the headlight. 5)

6

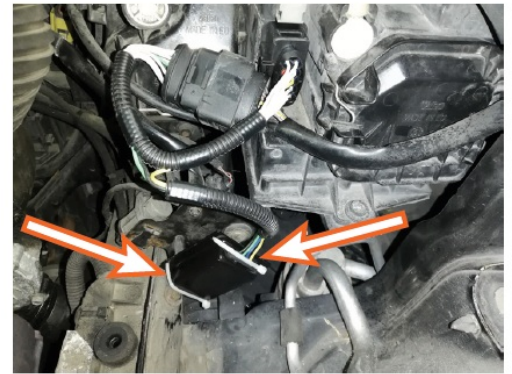
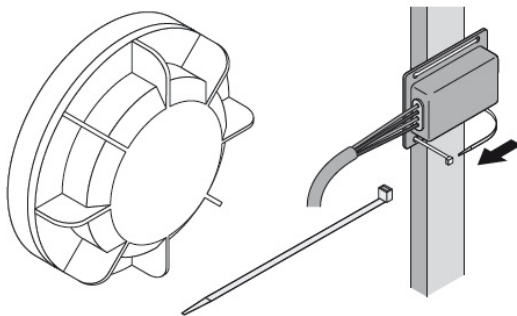

Mount the SMART CANBUS (load resistor) to the vehicle's body (metal). Please note: Pull the cable ties until they are taut. 6)

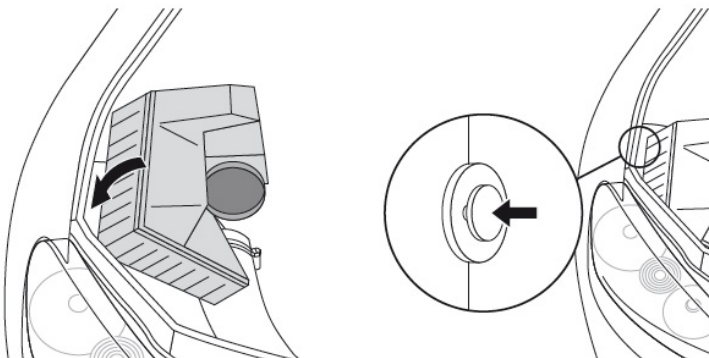

Reinstall the air filter. 7)

8

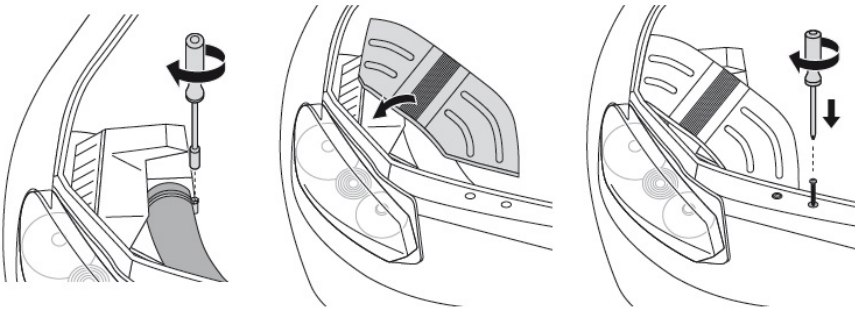

Reinstall the air intake duct. 8)

1

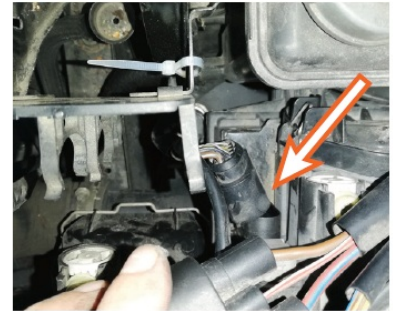
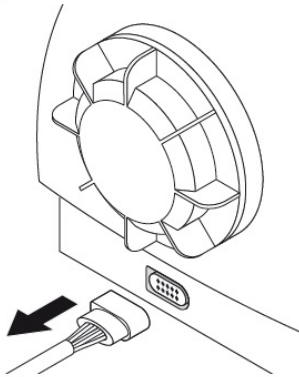

2

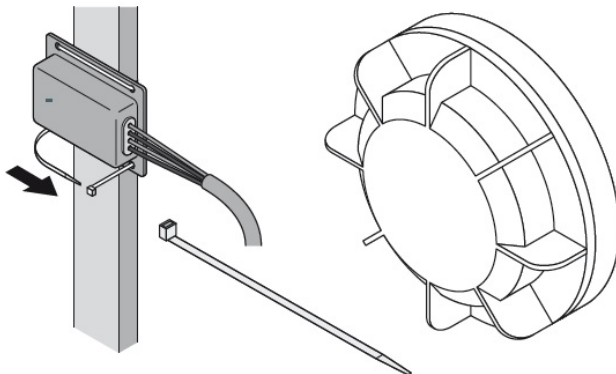

Mount the SMART CANBUS (load resistor) to the vehicle's body (metal).

Please note: Pull the cable ties until they are taut. 6)

3

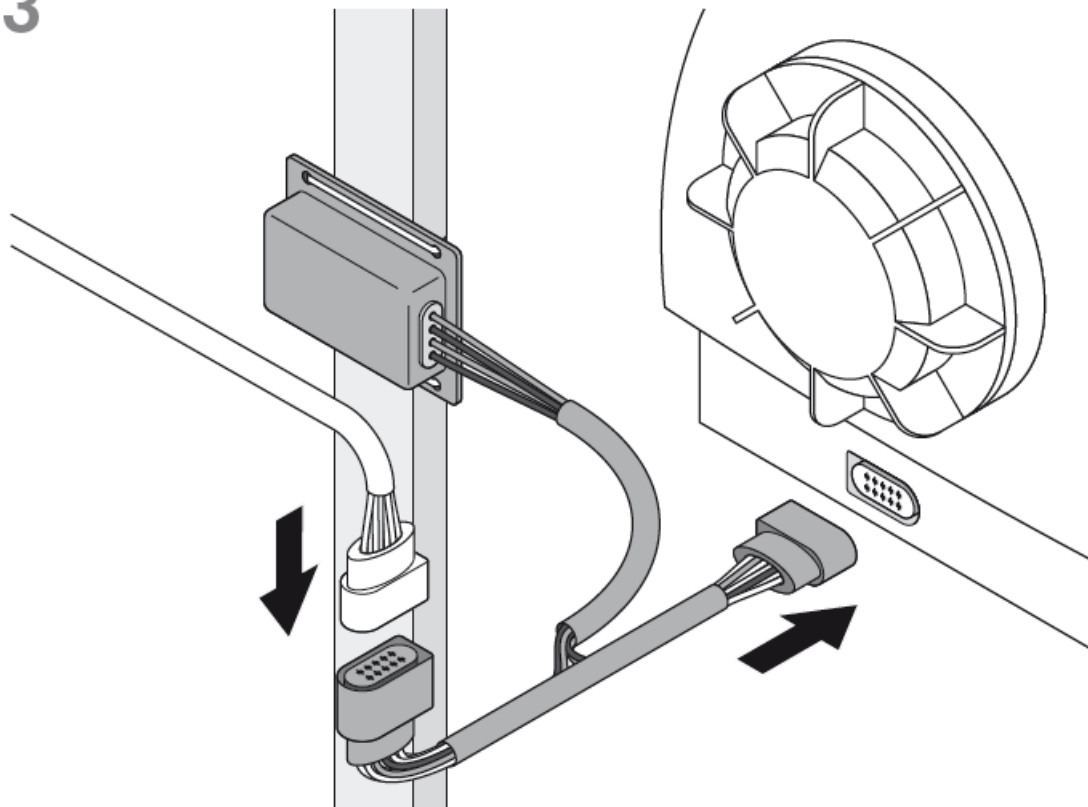

1. Connect the SMART CANBUS (load resistor) plug to the vehicle connector.
2. Connect the SMART CANBUS (load resistor) socket with the headlight. 5)

4

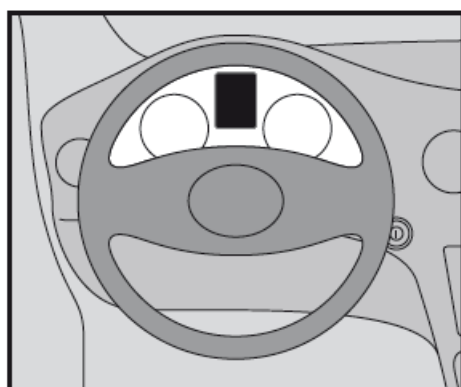
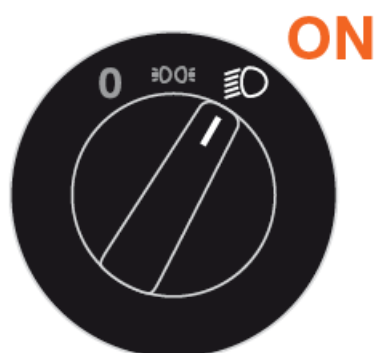

Documents / Resources

 The image shows the cover of the OSRAM LEDSC02-1 LeDriving Smart Canbus User Manual. It features the OSRAM logo at the top right. The main title is 'LEDSC02-1 LeDriving Smart Canbus'. Below the title, there is a diagram of a car's front end with the headlights highlighted. To the right of the car diagram is a small image of the LEDSC02-1 module. Below the car diagram, there are two small images showing the installation of the module into the headlight housing, labeled 'R' (Right) and 'L' (Left). At the bottom left, there is a small icon of a screwdriver and a warning symbol (a triangle with an exclamation mark).	<p>OSRAM LEDSC02-1 LeDriving Smart Canbus [pdf] User Manual</p> <p>LEDSC02-1 LeDriving Smart Canbus, LEDSC02-1, LeDriving Smart Canbus, Smart Canbus, Canbus</p>
---	--

References

- [OSRAM Americas](#) | [OSRAM SYLVANIA Homepage](#)

Manuals+.