

[Skip to content](#)

## **Manuals+**

User Manuals Simplified.



# **OSQ 0-304 Mini WiFi Projector User Manual**

[Home](#) » [OSQ](#) » OSQ 0-304 Mini WiFi Projector User Manual

Contents [hide](#)

[1 OSQ 0-304 Mini WiFi Projector](#)

[2 FCC WARNING STATEMENT](#)

[3 FUNCTION OVERVIEW](#)

[4 REMOTE CONTROL](#)

[4.1 BATTERIES STATEMENT AND NOTICES](#)

[4.2 PROJECTION DISTANCE & SIZE](#)

[4.3 PROJECTION MODE](#)

[4.4 INPUT SOURCE](#)

[5 BLUETOOTH SETTING](#)

[6 WIFI CONNECTION & SCREEN MIRRORING](#)

[6.1 SCREEN MIRRORING](#)

[6.2 DIGITAL ZOOM](#)

[7 SPECIFICATION](#)

[8 TROUBLE SHOOTING](#)

[9 WARRANTY](#)

[10 Documents / Resources](#)

[11 Related Posts](#)



## **OSQ 0-304 Mini WiFi Projector**



## **FCC WARNING STATEMENT**

### **FCC Statement**

This device complies with part 15 of the FCC rules. Operation is subject to the following two conditions:

1. This device may not cause harmful interference.
2. This device must accept any interference received, including interference that may cause undesired operation.

The manufacturer is not responsible for any radio or tv interference caused by unauthorized modifications or changes to this equipment. Such modifications or changes could void the user's authority to operate the equipment.

**NOTE:**

This equipment has been tested and found to comply with the limits for a Class B digital device, pursuant to part 15 of the FCC Rules. These limits are designed to provide reasonable protection against harmful interference in a residential installation.

This equipment generates, uses, and can radiate radio frequency energy and, if not installed and used in accordance with the instructions, may cause harmful interference to radio communications. However, there is no guarantee that interference will not occur in particular installation. If this equipment does cause harmful interference to radio or television reception, which can be determined by turning the equipment off and on, the user is encouraged to try to correct the interference by one or more of the following measures:

- Reorient or relocate the receiving antenna.
- Increase the separation between the equipment and receiver. Connect the equipment into an outlet on a circuit different from that to which the receiver is connected.
- Consult the dealer or an experienced radio/TV technician for help.

**Warning:**

The device has been evaluated to meet general RF exposure requirements.

**RF Exposure Information**

This equipment complies with FCC radiation exposure limits set forth for an uncontrolled environment. This equipment should be installed and operated with minimum distance 20cm between the radiator and your body.

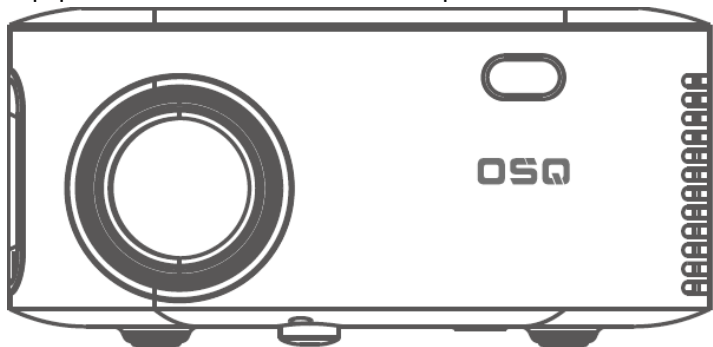

- WiFi Projector



- LENS Cover

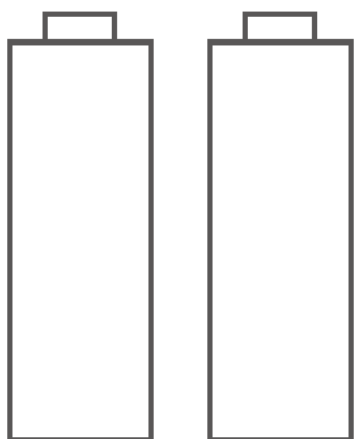
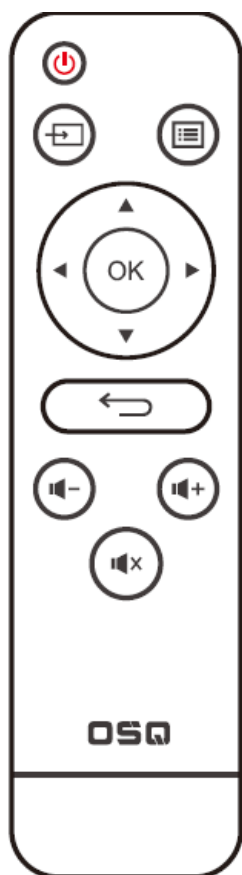

- Remote control

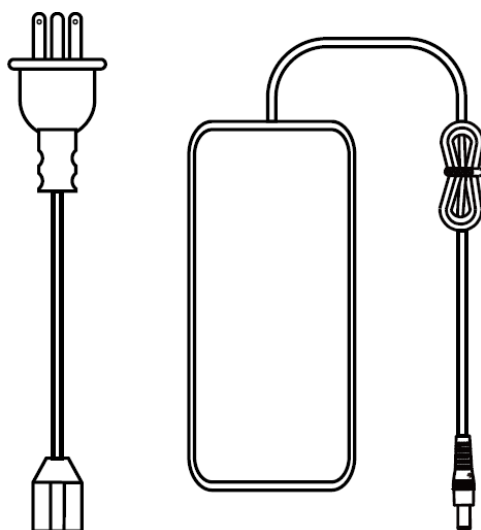

- 2 AA Batteries

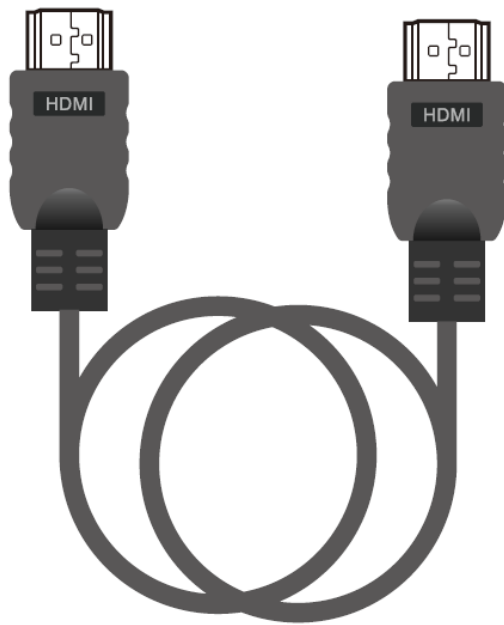

- Power Cable



- HDMI Cable



- User Manual
- Lens Cleaning Cloth

## NOTICE

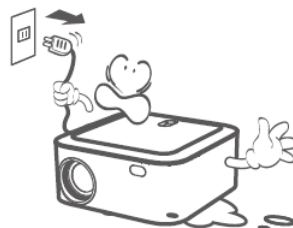
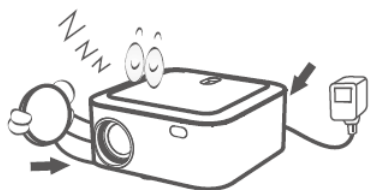
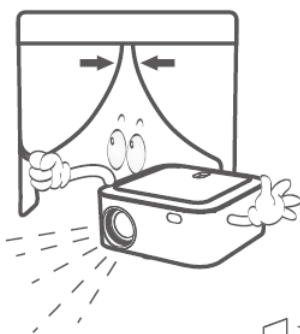

**Recommended**

**NOT Recommended**

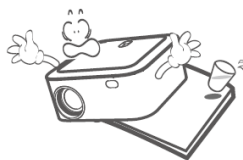
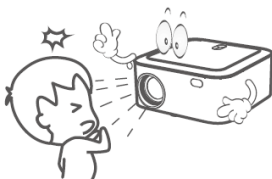
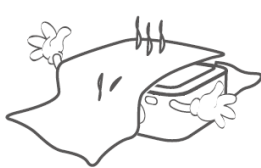

## FUNCTION OVERVIEW

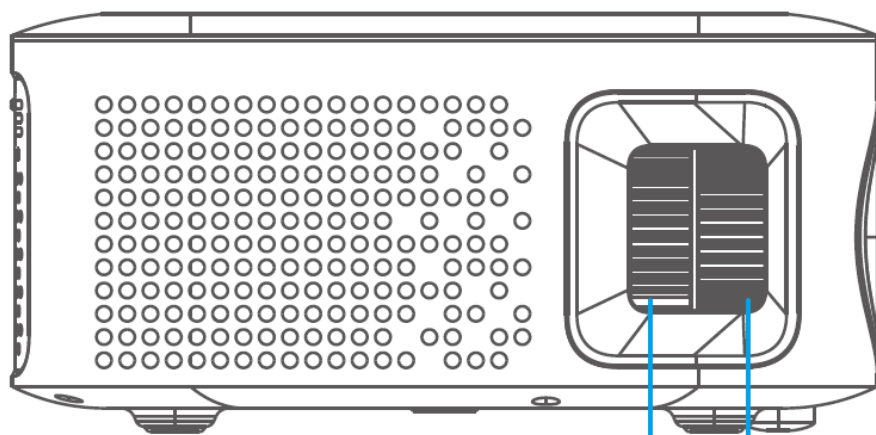

Keystone Focus

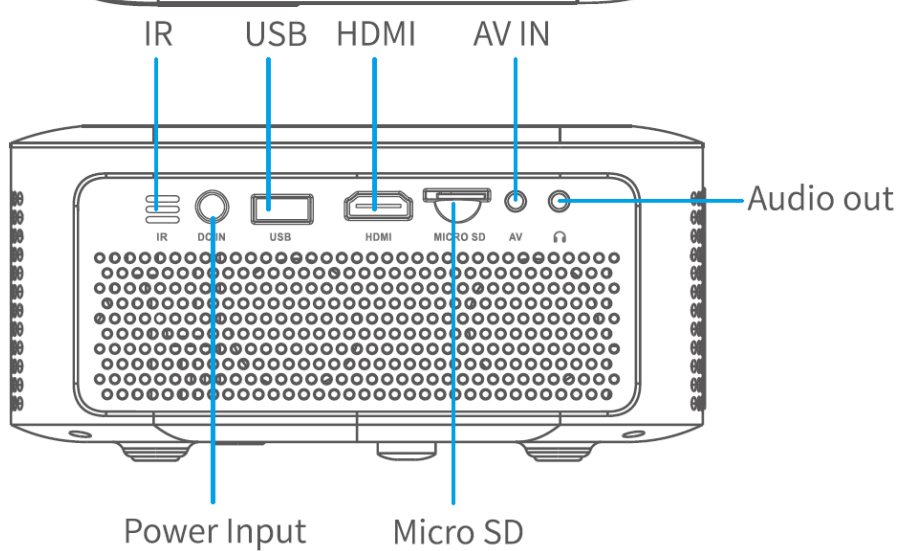
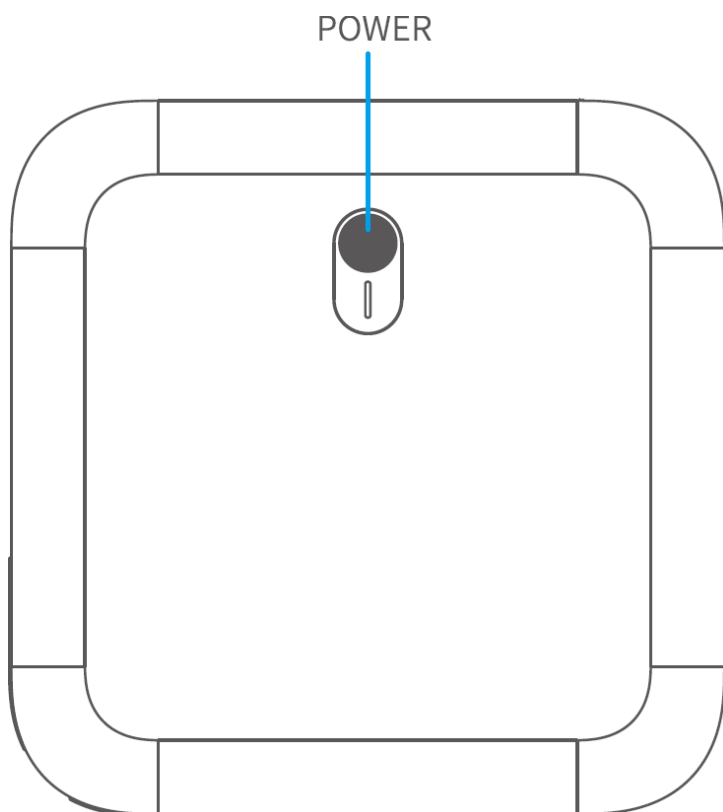
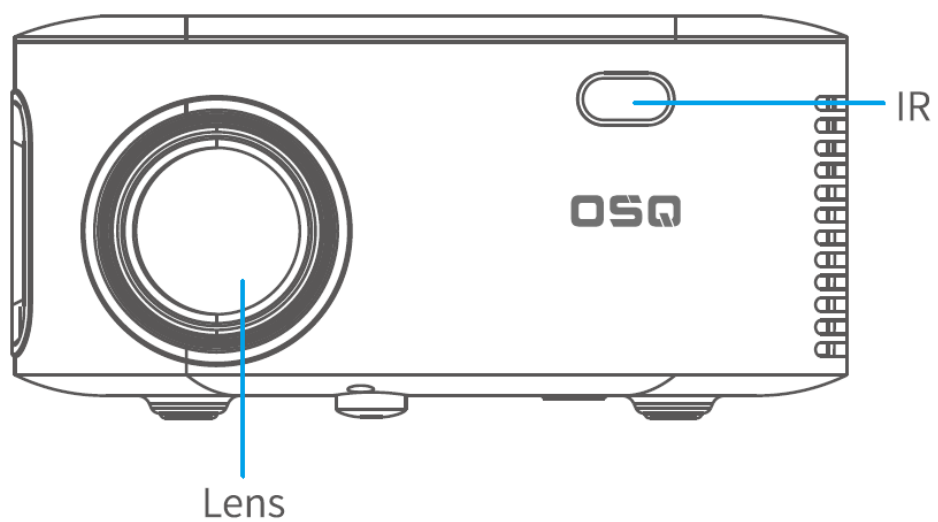

## REMOTE CONTROL

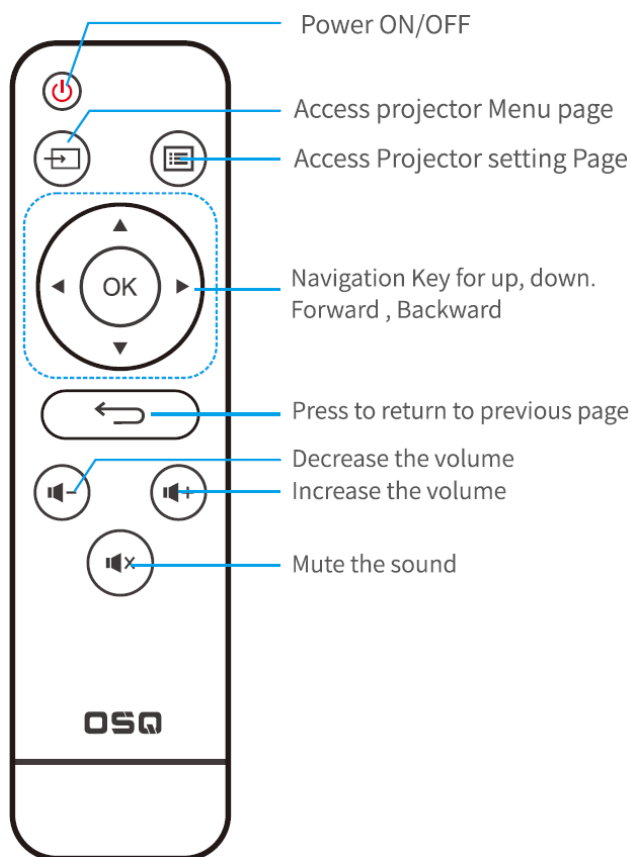

#### BATTERIES STATEMENT AND NOTICES

Remove the battery compartment cover on the back of your remote by carefully sliding to open. The battery cover can then be lifted away. Fit the correct batteries, referring to the polarity markings. Finally, replace the cover.

#### NOTE:

- When you receive the product and find that the batteries of the remote control is swollen or softened, please do not use it before you change it.
- Batteries shall not be exposed to excessive heat such as sunshine, fire.
- Make sure that the batteries are installed polarity correctly.
- Only same or equivalent type batteries as recommend are to be used .
- Do not dispose of batteries in fire, battery may explode or leak. Do not try to recharge a battery.
- Do not mix old and new batteries.
- Do not mix alkaline, standard(carbon-zinc), or rechargeable (ni-cad,ni-mh,etc) batteries.

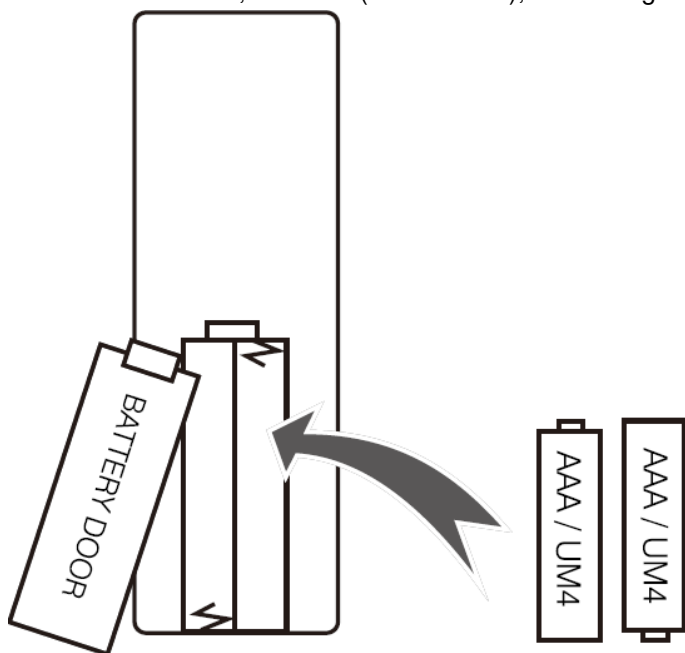

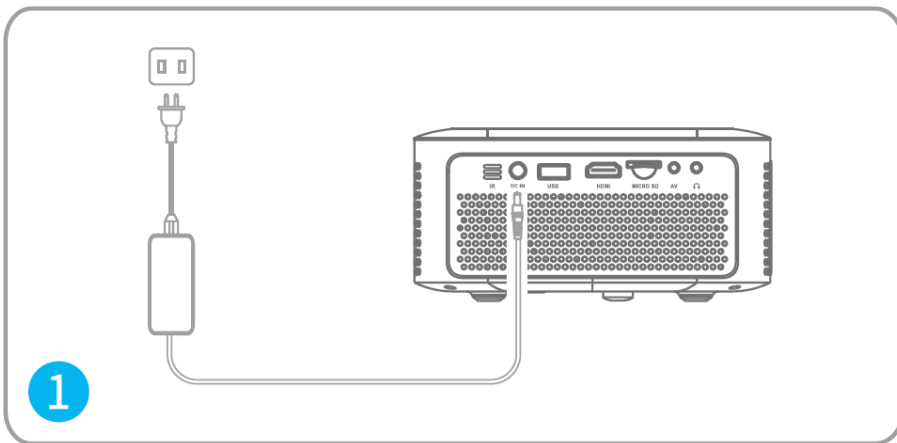

- Plug the power cord into an outlet.

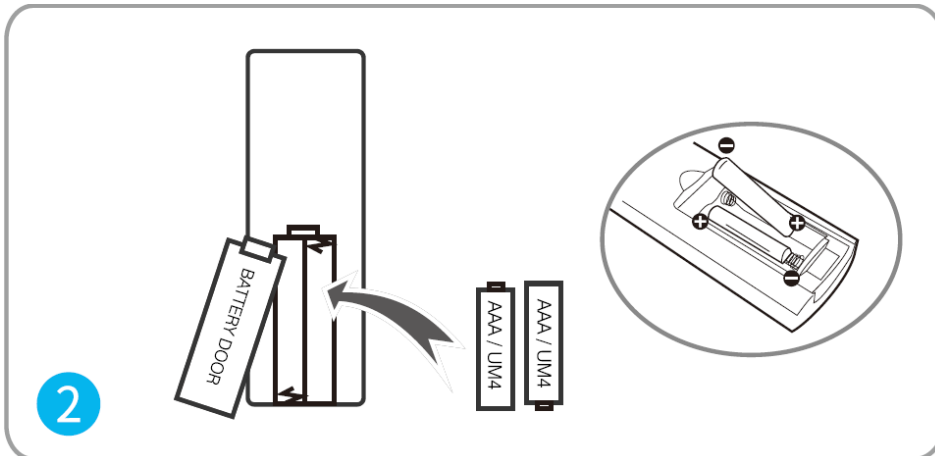

- Install batteries in the remote control

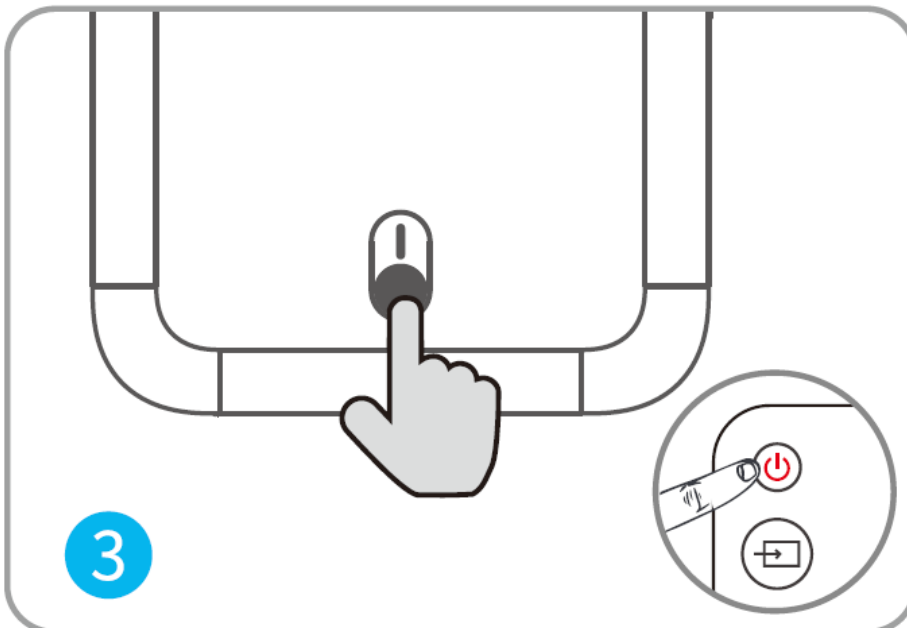

- Press the Power Button to turn on the projector.



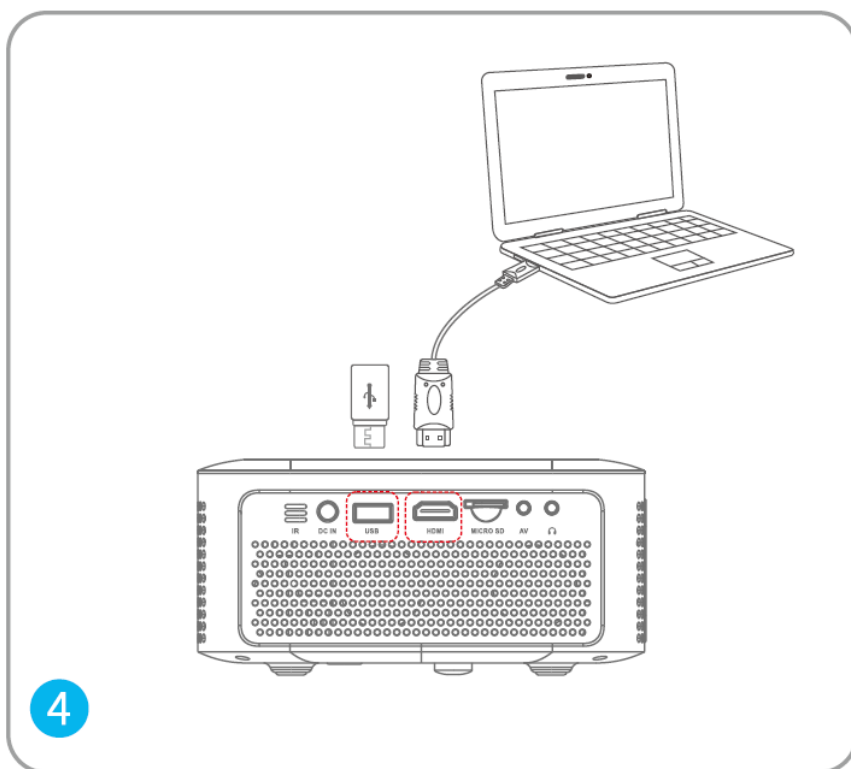

- Connect your device to the projector correctly.



- Use the remote control to select the correct input source.

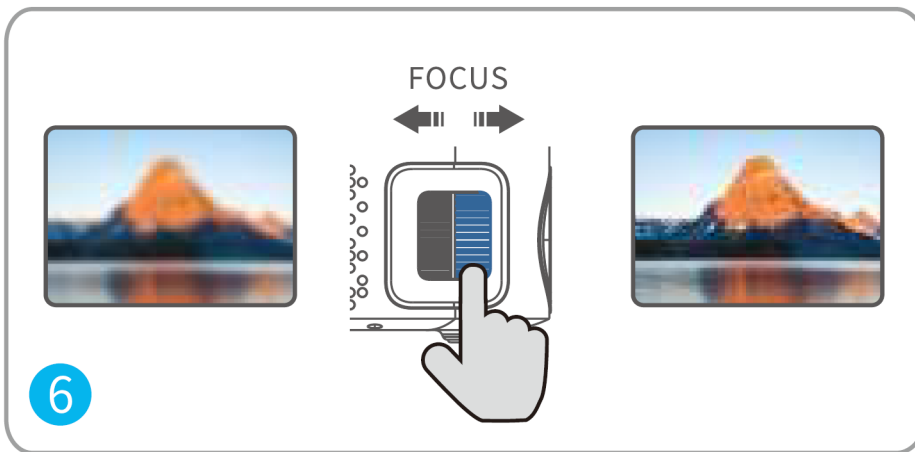

- Adjust the focus ring to get the best image performance.

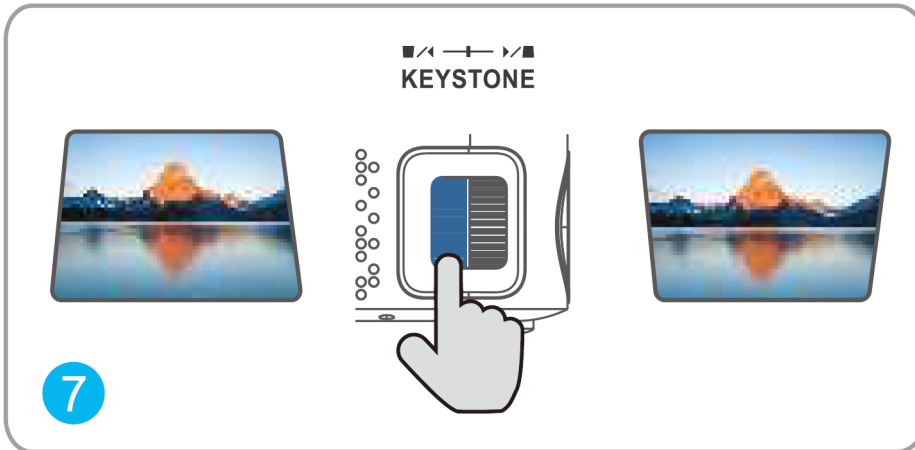

- Adjust the keystone to get the suitable size

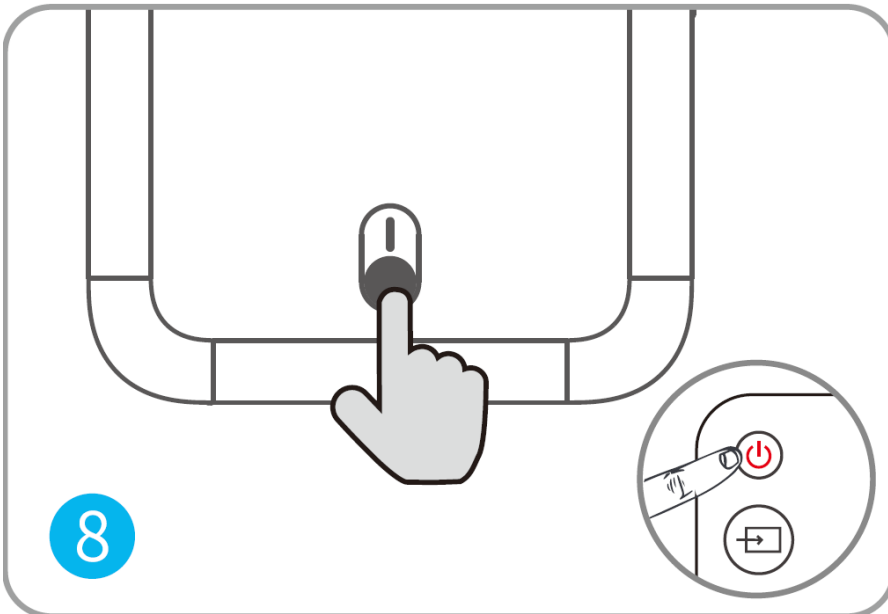

- Press the Power Button to turn off the projector.

#### PROJECTION DISTANCE & SIZE

The recommended projection screen is around 80 inches with a distance of around 9.7 ft. Ambient darkness will improve the clarity of the projected images.

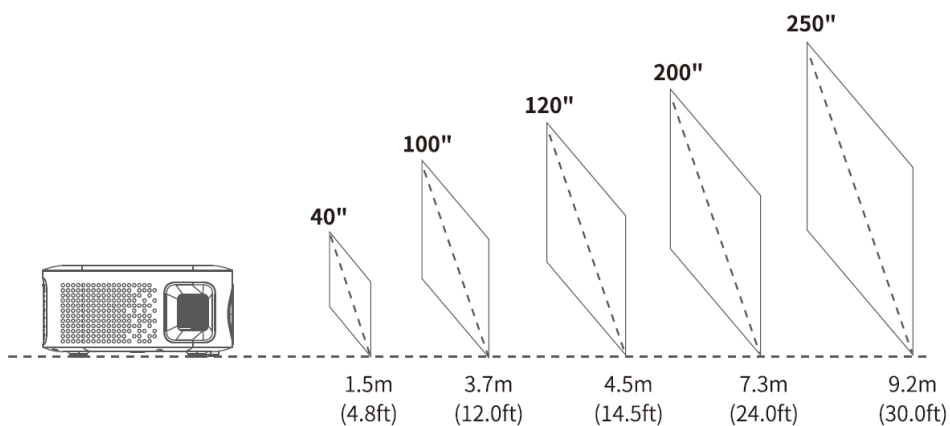

## PROJECTION MODE

If you want to hang the projector to the ceiling, a projector mount will be needed. If you want to project in different way, please select corresponding mode in the setting page .



## FRONT TABLE

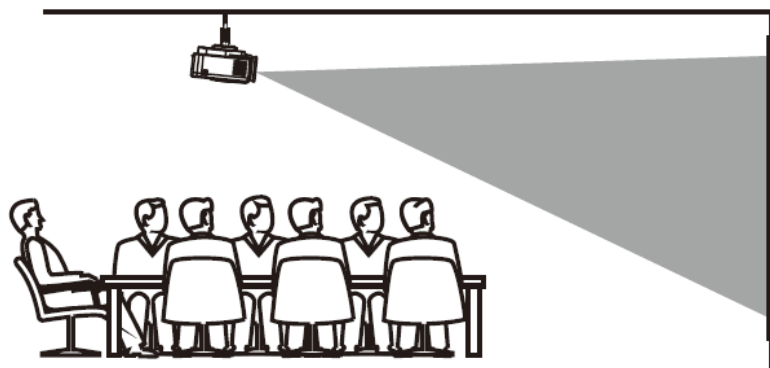

FRONT CEILING

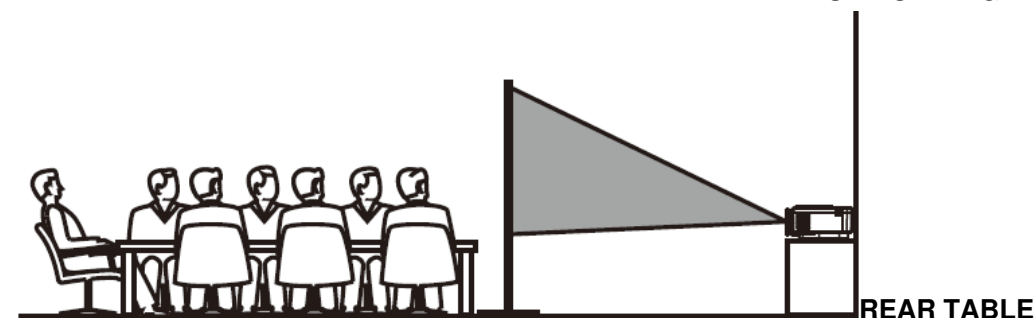

REAR TABLE

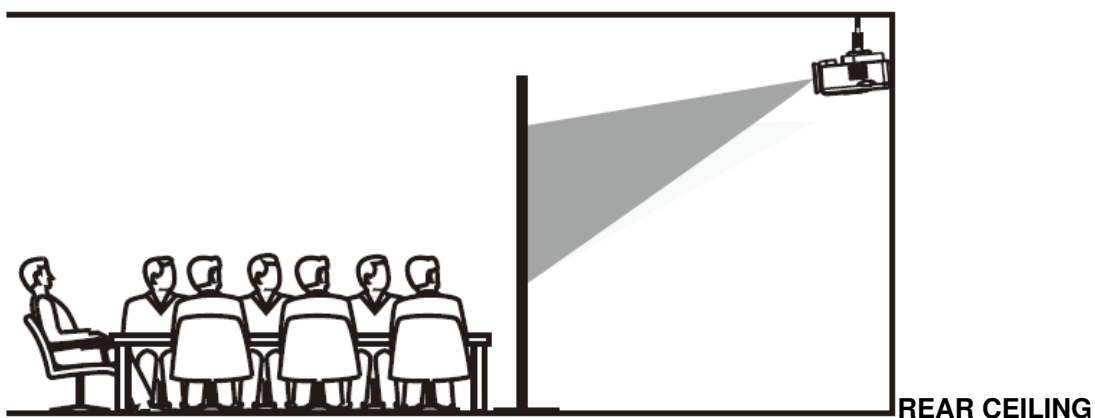

REAR CEILING

## INPUT SOURCE

Press @ on the remote to enter the interface of the Input Source.

### A. HDMI Connection

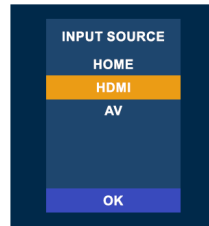
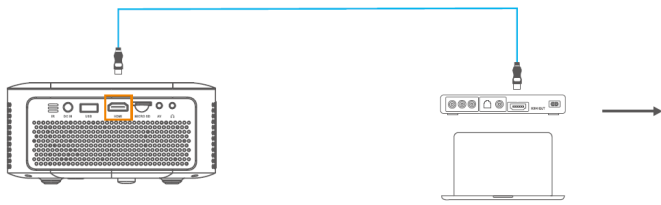

### B. AV Connection

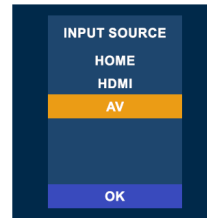
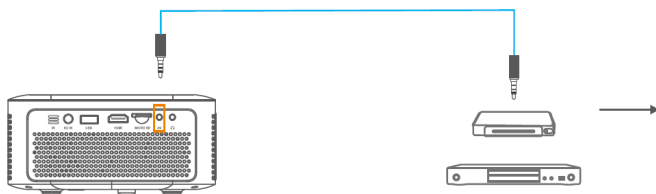

### C. USB Connection

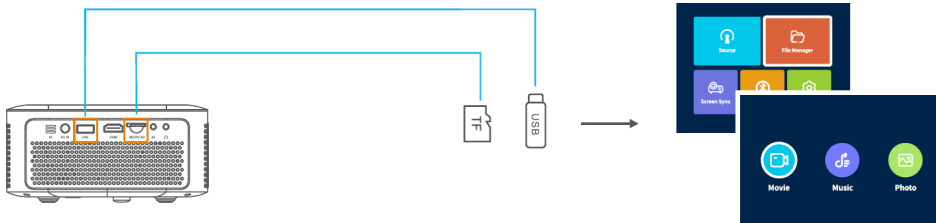

## BLUETOOTH SETTING

### Bluetooth Connecting

1. Go to (Home Page) >(Bluetooth Settings)
2. Turn the Bluetooth function @ID and search for nearby Bluetooth devices.
3. Choose correct Bluetooth device to connect.

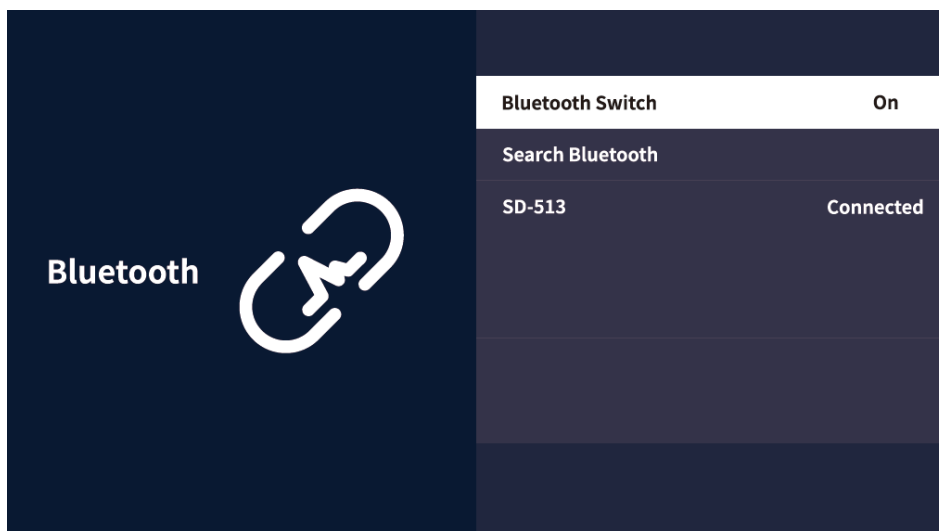

### NOTE:

1. Bluetooth function is ONLY for audio transfer with audio devices, like Bluetooth speaker/headset/sound bar, NOT support video/audio sync with smartphone/Pad.
2. Due to compatibility issues with the Bluetooth protocol, some brands of Bluetooth speakers may not support connection to OSQ projectors.
3. Control the Bluetooth switch by the left/ right buttons on controller

## WIFI CONNECTION & SCREEN MIRRORING

## WIFI CONNECTION

1. Go to(Homepage J >(Setting) >(Network J > (WiFi settings J
2. Scan and Choose your WiFi, then enter password to connect.

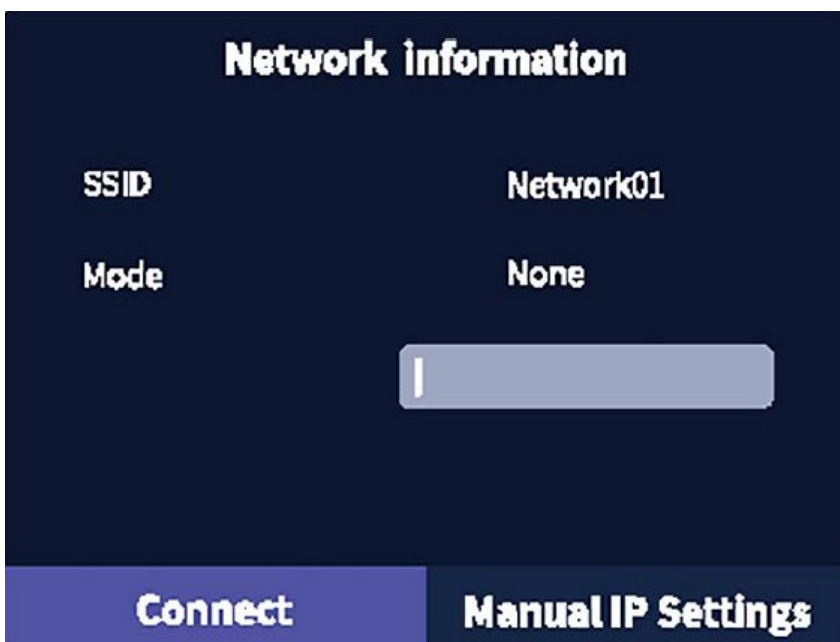
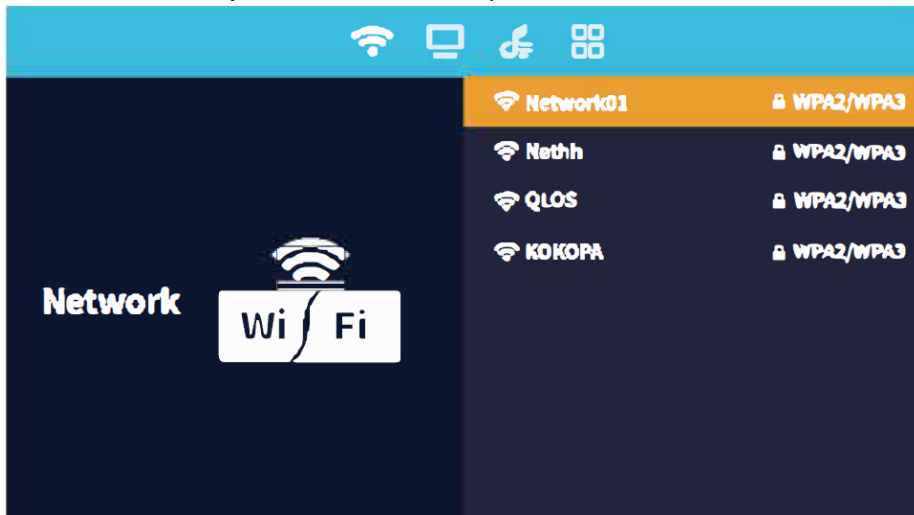

## SCREEN MIRRORING

### MIRACAST (For Android System)

1. Go to(Home Page)> (Multi Screen)> (MIRACAST )
2. On your Android device launch the Multiscreen/Wireless Display/Screen Mirroring/Smart View Function.
3. Looking for device that can be mirrored.
4. Select your Miracast receiver from the list to connect.

### Miracast

To connect Android Mobile/Pad Device with Projector Based on WiFi-Display Technology



 Pad  
 Mobile

**1. On your Android Mobile/Pad, open the settings menu.**  
**2. Access your display settings or screen-mirroring.**  
**3. Select your Miracast receiver:**

**Miracast Dongle initialize. Please wait**

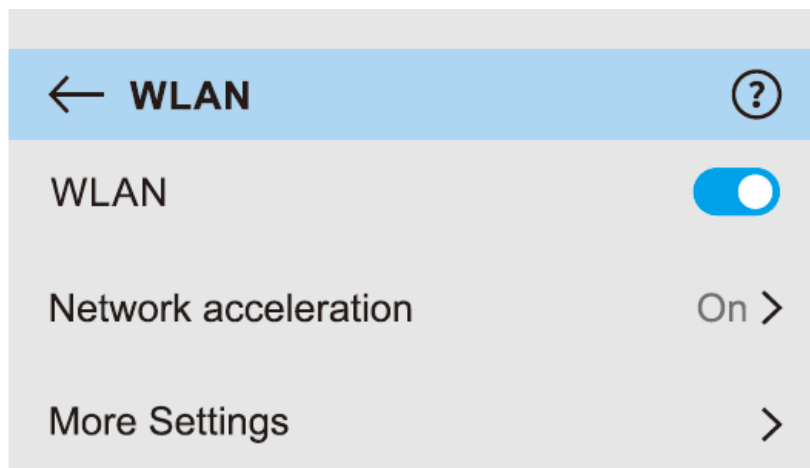

#### NOTE:

Please remember to turn on the WiFi function on your Android device, but not necessary to connect to any WiFi signal.

#### iOS CAST (For iOS System)

1. Go to (Home Page) > (Multi Screen) > (iOS CAST)
2. On your iOS device open control center and tap Screen Mirroring.
3. Looking for device that can be mirrored.
4. Select your iOS Cast receiver from the list to connect.

### iOS CAST

Make sure that your IOS device is connected to the same network as your projector



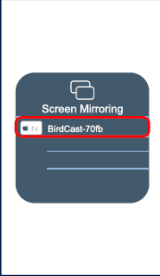

1. On your IOS device, open Control Center and tap Screen Mirroring.

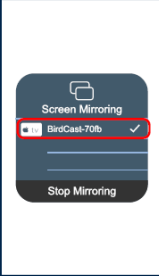

2. Looking for devices that can be mirrored on.



3. Select BirdCast-70fb from the list.

 Network error
  BirdCast-70fb

#### DLNA (For Android and iOS Device)

1. Make sure that your device is connected to the same network as your projector.
2. Open your video player software
3. Click the icon and select the projector name BirdCast-XXXX to connect

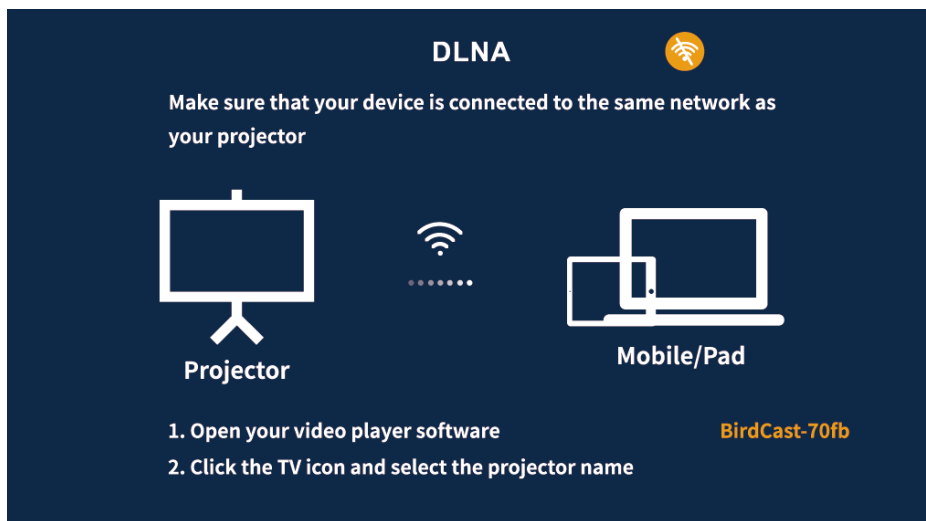

#### NOTE:

1. The DLNA connection can be operated in any page of the projector.
2. Through the DLNA connection, the mobile phone can continue to be used normally, and the projected video/image will continue to be played, but the mobile phone interface will not be displayed synchronously.

#### DIGITAL ZOOM

1. Go to (Homepage)> (Setting) >(Option), then choose the ( Digital Zoom) function, Adjust the screen size from 100% to 75% through the parameters.

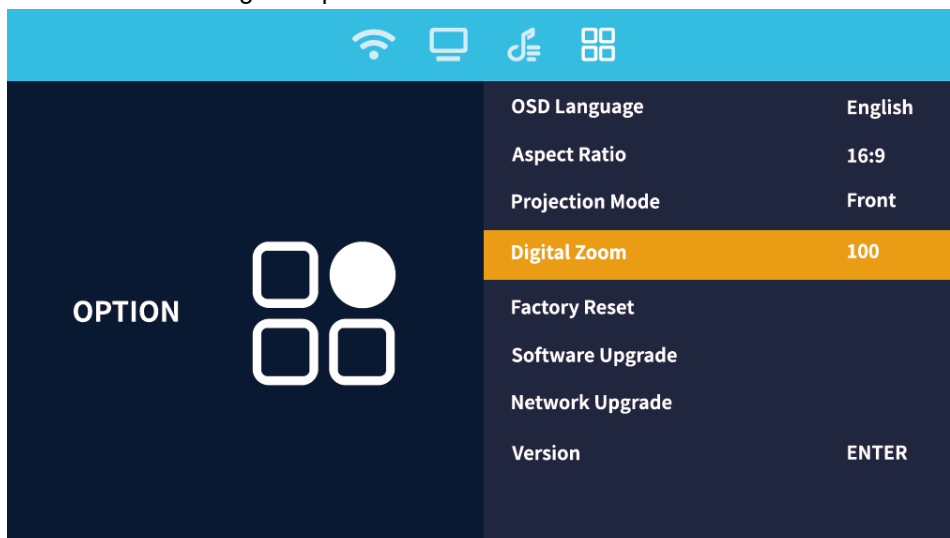

#### NOTE:

Digital Zoom could be set on this interface or through MENU button on controller.

#### SPECIFICATION

Display Technology	LCD	Light Source	LED
Resolution	1280 x720	Input Signal	HDMI / USB / AV / MICRO SD
Aspect Ratio	16:9 / 4:3	Focus	Manual
Keystone	±15°	Speaker	2.7W
Bluetooth	Version 5.0	Power Input	AC 100-240V 50/60Hz
Power Output	30.0V / 2.4A 68W	Photo Format Supported	jpg. Bmp. Jpeg. png. ipeg
Audio Format Supported	wav .wma .asf .aac .ac3 .mp1 .mp2 .mpa .mp3 .mp4 .m4a .ra .ram .flac	Video Format Supported	avi .mpg .mpeg .vob .dat .m1v .m2v .mp4 .mpeg4 .m4v .wmv .rm rmvb .mov .qt .3gp .3g2 .asf .mkv divx .ts .tp .trp .msts .MTS
Ports	HDMI / AV / USB / MICRO SD/ DC IN / AUDIO 3.5MM	Brightness	100 ASIN
Unit Dimension	160*160*78mm	Unit Net Weight	0.76KG

## TROUBLE SHOOTING

### Remote control not work?

- Make sure the batteries are effective and installed in the correct way.
- Please contact our after-sales team to get a new remote control.

### Upside down image?

- Press “Flip” button on the remote control.
- Enter “Projection Settings” to change the Projection Mode.

### Blurry Image?

- Adjust focus ring/keystone to get the best image.
- The quality of the projection screen will also affect the image quality. Recommended to use it on a white wall or a better quality screen. Not suggest to use it on a thin white gauze screen, which will reduce the image quality.

### No Sound?

- Turn off the Dolby Audio in external device;
- Mute mode is running, press the Mute button on remote control can restore the sound
- External Bluetooth Headphone/Earbuds was connected with the projector

### Missing accessories?

- If the device is damaged or any accessories missing, please contact our after-sales department for help.

### The content form HULU, Netflix, and similar services can not be mirrored or cast?

- This is not the Projector or phone issue. Due to those video are restricted from mirroring screen directly by phone with the copyrighted issue.
- Connect a TV stick, Roku or chromecast to the projector can playback those video perfectly anytime.

### Automatic shut-down?

- Self-Protection mechanism is activated. Please use it under a cool or ventilated environment will be best.
- Please unplug the power adapter from outlet each time to prolong the service life after turned off the device.



## WARRANTY

OSQ provides the following service for each customer:

- 30-days full refund or free replacement
- 1-year Technical Support
- Lifetime professional consult

## Documents / Resources



[OSQ 0-304 Mini WiFi Projector](#) [pdf] User Manual

O-304, O304, 2ATFTO-304, 2ATFTO304, 0-304 Mini WiFi Projector, 0-304, Mini WiFi Projector, WiFi Projector, Mini Projector, 0-304 Projector, Projector

### [Manuals+](#),

- [home](#)
- [privacy](#)