

OSD NERO SRT1 GEN2 Network Music Player



OSD NERO SRT1 GEN2 Network Music Player Owner's Manual

[Home](#) » [OSD NERO](#) » OSD NERO SRT1 GEN2 Network Music Player Owner's Manual 

Contents

- [1 OSD NERO SRT1 GEN2 Network Music Player](#)
- [2 Product Usage Instructions](#)
- [3 FAQ](#)
- [4 Introduction](#)
- [5 In The Box](#)
- [6 IMPORTANT SAFETY PRECAUTIONS](#)
- [7 FRONT /REAR PANEL](#)
- [8 CONNECTION](#)
- [9 Connection Options Diagram](#)
- [10 SETUP](#)
- [11 SPECIFICATIONS](#)
- [12 WARRANTY](#)
- [13 Documents / Resources](#)
 - [13.1 References](#)



OSD NERO SRT1 GEN2 Network Music Player



Specifications

- Product Name: NERO STR1 Gen2 Single Zone Wi-Fi Smart Preamp Streamer
- Compatibility: OSD Player app
- Zone: Single-zone
- Applications: Commercial and residential
- Controls: Wireless BT, Wi-Fi antennas, IR Remote Control
- Inputs: 3.5mm, Dual RCA, Stereo RCA
- Power Adaptor: 12V, 1A US Power Adaptor

Product Usage Instructions

Unboxing and Setup

1. Remove the NERO STR1 Gen2 from the box and check for any damage.
2. Ensure all packaging contents are accounted for.
3. Connect the Wireless BT and Wi-Fi antennas to the back panel connectors.
4. Find the DC Adaptor and connect it to the NERO STR1 Gen2 before plugging it into an AC outlet.

Additional Connections

Refer to the manual for additional connection options. Ensure the device is not powered on when connecting or disconnecting other devices.

Contact Information

If you have any questions about your NERO STR1 Gen2, contact us directly at:

- Website: www.osdaudio.com
- Email: support@osdaudio.com
- Phone: [888-779-4968](tel:888-779-4968)

FAQ

- **Q: What should I do if my NERO STR1 Gen2 shows signs of damage upon unboxing?**
 - A: If you notice any damage, please contact our customer support immediately for assistance.
- **Q: Can I control multiple sources/music services with the OSD Player app?**
 - A: Yes, the NERO STR1 Gen2 is compatible with the OSD Player app for selecting and controlling multiple sources/music services.
- **Q: How do I mount the NERO STR1 Gen2?**
 - A: The package includes wall mount brackets and hardware for mounting. Follow the provided instructions for proper installation.

Introduction

OSD – The Best Value in Sound

Thanks for joining the OSD owners club. Thank you for purchasing the NERO STR1 Gen2 Single Zone Wi-Fi Smart Preamp Streamer. This single-zone preamp is ideal for commercial and residential applications. The SRT1 Gen2 is compatible with the OSD Player app for selecting and controlling multiple Sources/Music services. It can be grouped with other OSD streaming and integrated amp/preamps. Remove the SRT1 Gen2 from the box and look over the device to ensure it is free of any damage and that all the packaging contents are accounted for before proceeding? Connect the Wireless BT and Wi-Fi antennas to the back panel connectors. Find the DC Adaptor and connect it to the SRT1 Gen2 before plugging it into an AC outlet. See additional connection options in this manual. Ensure the SRT1 Gen 2 is not powered On when connecting or disconnecting other devices.

If you have any questions about your SRT1 GEN2, please contact us directly.

- www.osdaudio.com
- email: support@osdaudio.com
- Phone: [888-779-4968](tel:888-779-4968)



In The Box

- QR Manual Card Qty: 1
- 12Volt 1A US Power Adaptor Qty: 1
- Antennas Qty: 2
- IR Remote Control Qty: 1
- 3.5mm to Dual RCA Cable Qty: 1
- Stereo RCA Patch Cord Qty: 1
- Wall Mount Brackets Qty: 2
- Wall Mount Bracket Hardware Qty: 4

IMPORTANT SAFETY PRECAUTIONS

WARNING

- TO PREVENT FIRE OR SHOCK HAZARD, DO NOT USE THIS PLUG WITH AN EXTENSION CORD, RECEPTACLE OR OTHER OUTLET UNLESS THE BLADES CAN BE FULLY INSERTED TO PREVENT BLADE EXPOSURE.
- TO PREVENT FIRE OR SHOCK HAZARD, DO NOT EXPOSE THIS APPLIANCE TO RAIN OR MOISTURE.
- TO PREVENT ELECTRICAL SHOCK, MATCH WIDE BLADE PLUG TO WIDE SLOT, FULLY INSERT.

 <p>This lightning flash with arrowhead symbol, within an equilateral triangle, is intended to alert the use to the presence of un-insulated dangerous voltage within the products enclosure that may be of sufficient magnitude to constitute a risk of electric shock to persons.</p>	<div>CAUTION</div> <div>RISK OF ELECTRIC SHOCK DO NOT OPEN</div> <p>This lightning flash with arrowhead symbol, within an equilateral triangle, is intended to alert the use to the presence of un-insulated dangerous voltage within the products enclosure that may be of sufficient magnitude to constitute a risk of electric shock to persons.</p>	 <p>The exclamation point within the equilateral triangle is intended to alert the user to the presence of important operating and maintenance (servicing) instructions in the literature accompanying appliance.</p>
--	---	--

IMPORTANT SAFETY INSTRUCTIONS

1. Read these instructions.
2. Keep these instructions.
3. Read all warnings.
4. Follow all Instruction.
5. Do not use this apparatus near water.
6. Clean only with dry cloth.
7. Do not block any ventilation openings. Install in accordance with the manufacturers instructions.
8. Do not install near heat sources such as radiators, heat registers, stoves, or other apparatus (including amplifiers) that produce heat.
9. Do not defeat the safety purpose of the polarized or grounding type plug. A polarized plug has two blades with one wider than the other. A grounding type plug has two blades and a third grounding prong. If the provided plugs does not fit into your outlet, consult an electrician for replacement of the obsolete outlet.
10. Protect the power cord from being walked on or pinched particularly at the plugs, convenience receptacles, and at the point where they exit form the appliance.
11. Only use attachments or accessories specified by the manufacturer.
12. Unplug the apparatus during lightning storms or when unused for long periods of time.
13. Refer all servicing to qualified personnel. Servicing is required when the apparatus has been damaged in anyway, such as power supply cord or plug is damaged, liquid has been spilled or objects have fallen into the apparatus, the apparatus has been exposed to rain or moisture, does not operate normally, or has been dropped

FRONT /REAR PANEL

Front Panel Description



1. Power Switch
2. Volume/Mode Select Knob
3. IR Sensor for IR Remote
4. LED Status Indicators

Rear Panel Description

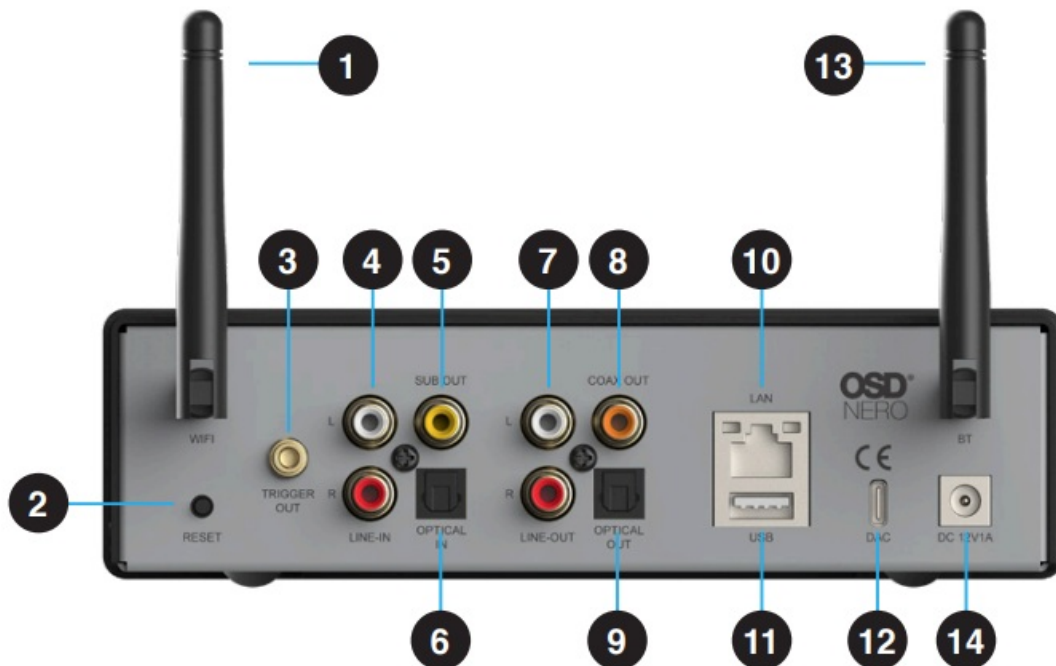

1. Wi-Fi Antenna
2. RESET Button
3. Trigger Output
4. RCA Stereo Line-In
5. Single RCA Subwoofer Output
6. Fiber Optical Input
7. RCA Line-Out
8. Coaxial Output
9. Optical Output
10. LAN Port
11. USB Port
12. DAC Port
13. BT Antenna
14. DC 12V1A Port

8. Digital Coaxial Output
9. Digital Optical Output
10. LAN Network Input
11. USB Jump Drive Reader
12. DAC Digital Computer Input
13. Wireless BT External Antenna
14. DC12V1A Power Supply Input

CONNECTION

Remote Control



Connection Options Diagram

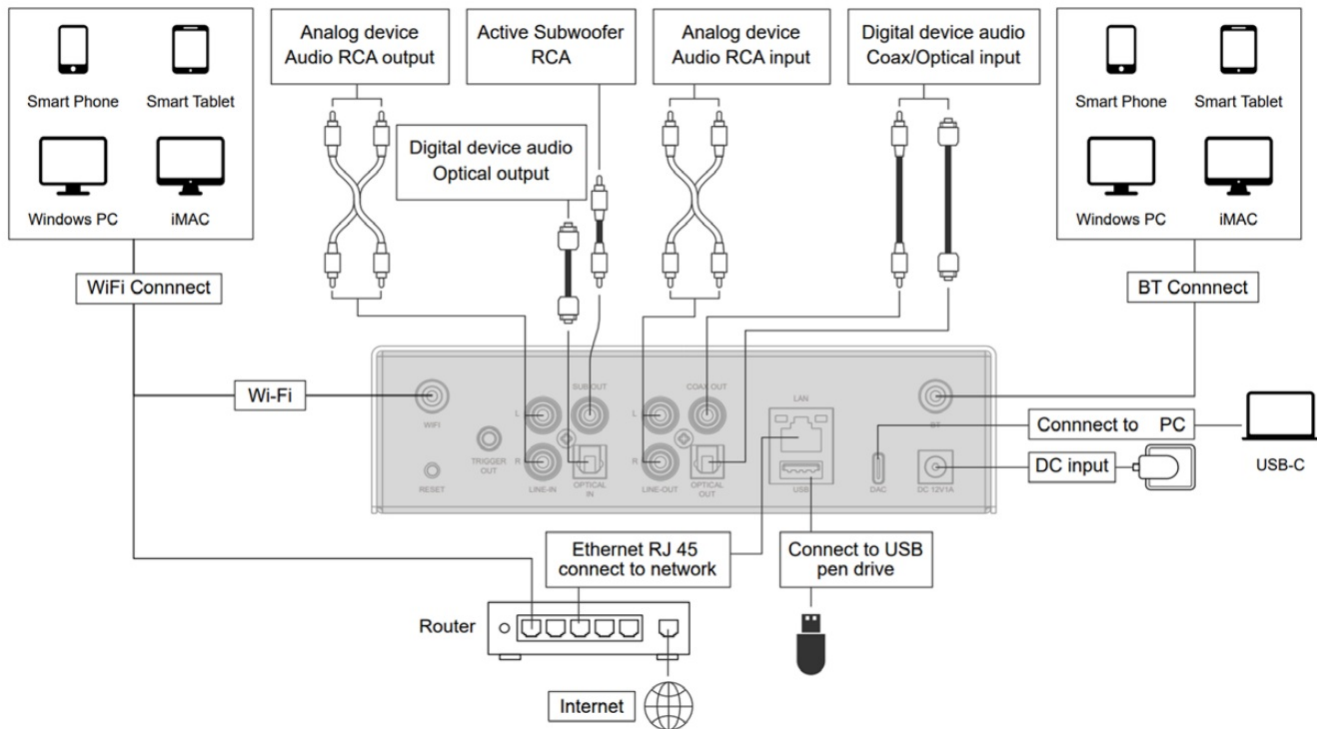

SETUP

Setup & Operation

Once the SRT1 Gen2 is connected and in the desired location, plug the included power supply into the SRT1 Gen2 and into an available AC outlet. Note, the SRT1 Gen2 can connect directly to the network by connecting a network cable to the LAN connection on the back panel. Unlike the SRT1 Gen2 the SRT1 Gen2 can connect wirelessly as well which is especially handy in case there is no LAN connection near SRT1 Gen2 install location. The next step is to connect the SRT1 Gen2 to your network and control the sources using the OSD Audio Player App.

LAN Direct Wire/Cable connectivity for SRT1 Gen2

1. Download and install the OSD app by scanning the QR code or search "OSD Player" in the App store/Google Play store.

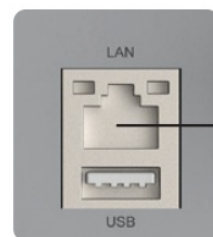

Direct LAN
Connect Option

2. Connect the SRT1 Gen2 to your network router using the RJ45 Ethernet LAN port on the rear panel.
3. LAN connection will automatically setup a zone for the SRT1 Gen2. Ensure your mobile device is connected to the same network and open the OSD Audio Player App

Connection Via Wireless BT Receiver Mode

The SRT1 features Wireless BT Connect as an option. You can access the Wireless BT 5.0 using the OSD Audio Player App, manually using the front panel Volume/Source Select Knob or by using the IR Remote that is included

with the SRT1 Gen2.



When in receiver mode, the BT LED will be flashing which indicates it is waiting for connection in your BT Transmitter device (cell phone, pad, TV) you can search device name “OSD Player”. Once connected, the BT LED will stay on which indicates the connection is successful and you can start playing music from the connected device and hear the sound coming out of the connected passive speakers.

SRT1 Gen2 Streaming Services:

Listen to Online Music

The SRT1 Gen2 can work with many popular streaming music services like Spotify, Tidal, Napster, and AMAZON MUSIC. Plus, Internet Radio Apps like TuneIn, iHeartradio, and VTuner. You can easily stream music or playlists from your account wirelessly and listen on your home audio system.

Spotify

To use Spotify, you will need to have Spotify premium account. You will find the OSD Audio Streaming device in the device list in Spotify Application and choose that device you want to stream.

AMAZON Music

To use AMAZON Music like Spotify, you will need to have an AMAZON Music premium account as well. You will find the OSD Audio Streaming device in the device list in AMAZON Music Application and choose that device you want to stream.

Airplay 1

The device supports Airplay1, you can choose Airplay1 in iOS device and play music.

Listen to local music

The SRT1 Gen2 can stream local music stored in your Smartphone, USB storage device, NAS using DLNA protocol, PC software like iTunes, or UPnP/DLNA 3rd party software. Click on “My Music” to select the local device you want to play from.

Note: iOS-based devices have blocked the access to iTunes library. Our system only supports NAS using DLNA protocol.

Using the SRT1 Gen2

Once you have connected your mobile to network and installed the OSD Audio Player App in your mobile device, you can start playing music to different rooms or the same music in all rooms in sync.

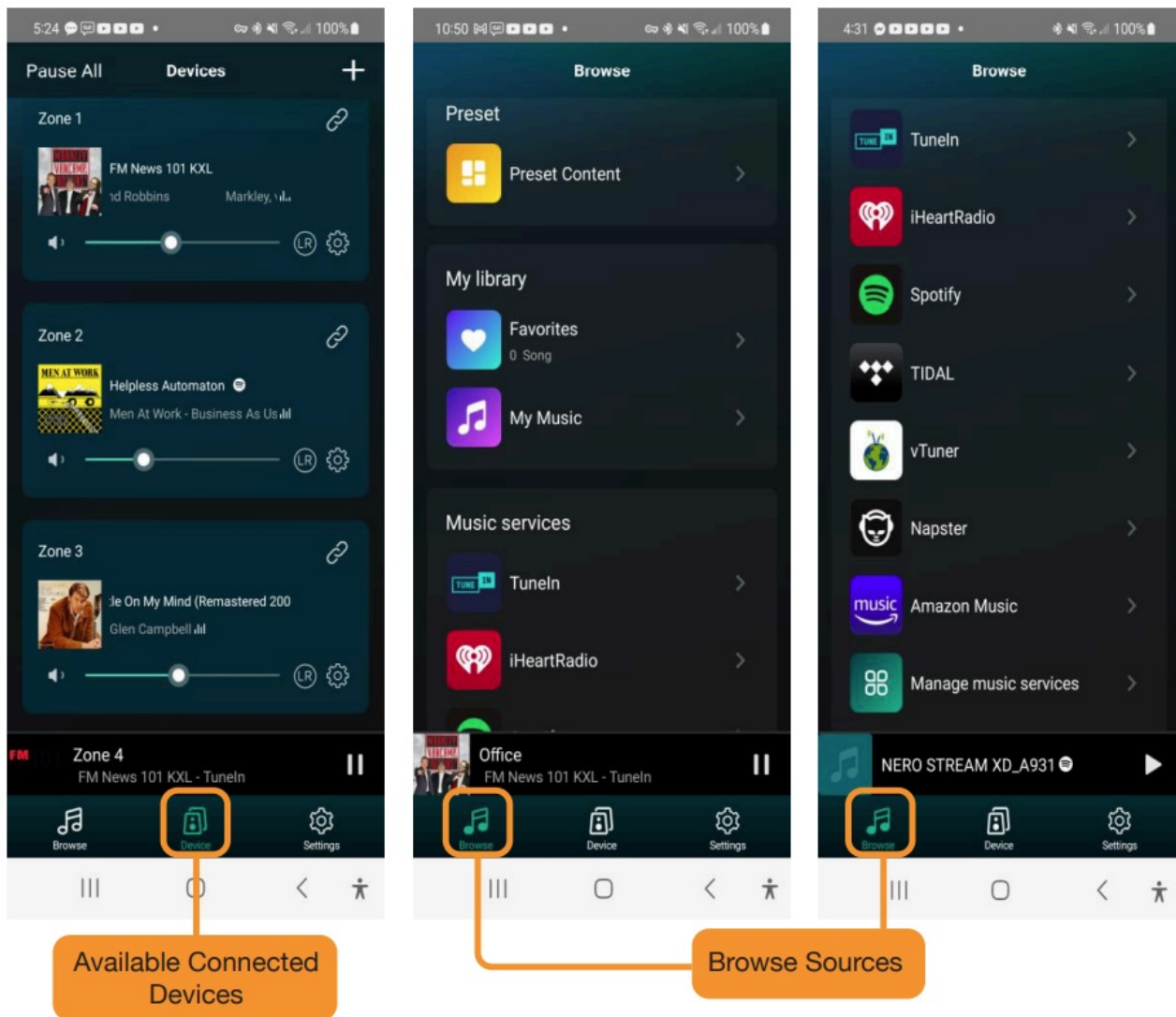

Selecting a Zone

In the OSD Audio Player APP you will see all the connected devices in the same network

1. Select the device you want to control; A green rectangle will highlight the selected Device
2. Select Browse on left side of the Bottom Tool Bar, note the highlighted selection turns dark green
3. From the Browse Screen, Select an online or local music source from the list to start streaming your music
(Some sources will need a subscription)

Play the Same Music in Multiple Rooms

Using the OSD Audio Player App, you can play the same music in multiple rooms simultaneously by grouping two or more devices. First, in the Device screen, you select the primary Device (Highlighted by a green rectangle). Select the Link in the upper right corner of the highlighted Device. A new screen will then appear featuring the selected Primary device and a blank circle for each additional device available to group with it. Just select the devices you want to add and Press the Done Button. Another Screen shows The Group Volume Master control, followed by the primary individual volume control and the independent volume for each grouped Zone.

Primary Zone Group Link

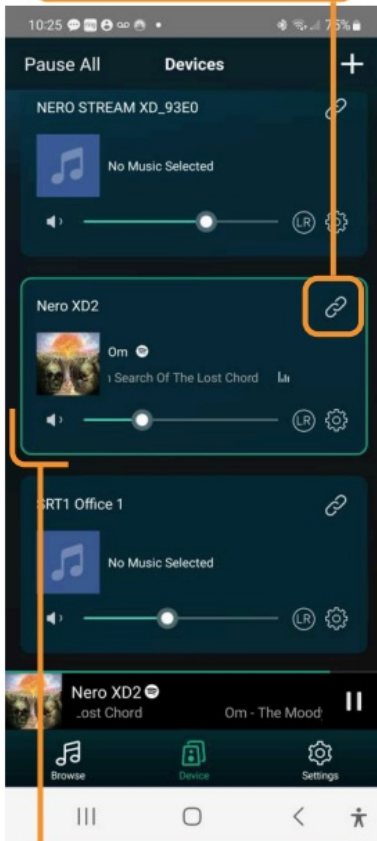

Green Highlight indicates selection

Selected Primary Zone

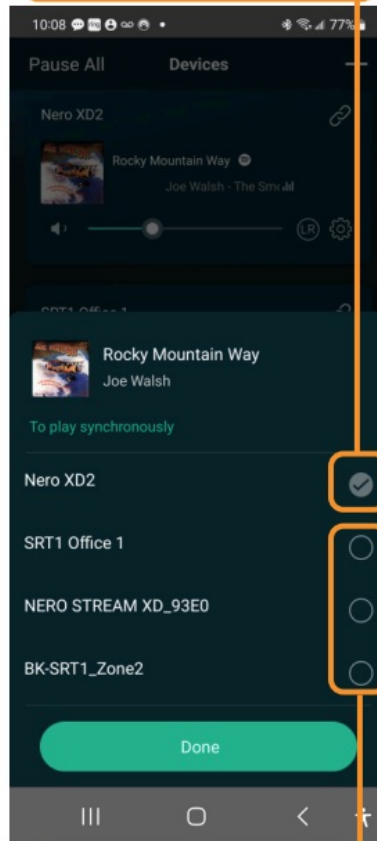

Zones available to group with the Primary Zone

Group Master Volume Control

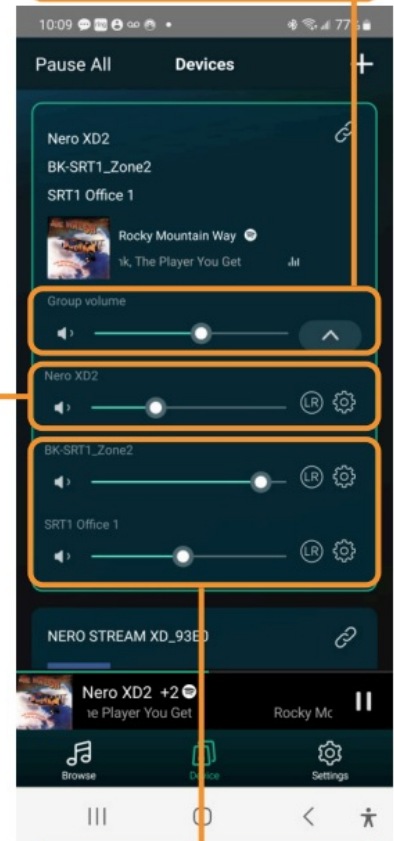

Additional Zones in the group, w/individual Volume Controls

SPECIFICATIONS

Specifications		SRT1 Gen2
I/O Interface	DC Input	DC 12V/1A
	Analog Audio Input	RCA 2V RMS
	Digital Audio Input	Optical Input
	Analog Audio Output	RCA 2V RMS
	Analog Sub Output	Single RCA
	Digital Audio Output	Coaxial, Optical
	Trigger Output	12V
	USB	Connect USB Storage Drive
	DAC connection	Yes USB-C
	Ethernet	LAN Connection RJ45
	LED Indicator	Status LED / Wi-Fi / BT / Line In / Optical/DAC/ USB
	IR Remote	IR Remote/IR Sensor Front Panel
	Volume Knob/Source Select	Volume Knob/ Source Select
	Reset Button	Reset Button
Network	Wireless Network	IEEE 802.11 b / g / n 2.4G
	Wireless BT	Wireless BT 5.0
	Wired Network	Ethernet RJ45
	Streaming Protocols	AirPlay / DLNA / Spotify Connect
Audio Parameter	Music Format	FLAC / MP3 / AAC / AAC + / ALAC / APE / WAV
	Audio Decode	16/24 Bit / 44kHz to 192 kHz
	Frequency Response	20Hz - 20kHz
	THD + N	0.0003
	SNR	100dB
	Wireless BT Range	15 M
	LinkPlay Module	LinkPlay A31
Application	OSD Player App/LinkPlay	Updated OSD Player App
	iTunes	For MAC & Windows PC
	foobar2000 and other support UPnP, DLNA 3rd party program	For MAC & Windows PC
Audio Source	Online Music Streaming Services	Spotify / Napster / Tidal / TuneIn / iHeart Radio / AMAZON Music / vTuner
	Local Storage	Music file store in Mobile phone, NAS & USB disk drive
	Analog Input	RCA R&L Analog
	Digital Input	Optical Input / DAC
General	Dimension	189mm W x 138mm D x 53mm H
	Inches	7.44" W x 5.43" D x 2.08" H
	Weight	0.8KG/1.76LBS
Power		12Volt 1AAC DV 100-240V FCC and UL external

The information contained in this guide is believed to be accurate and reliable. OSD assumes no responsibility for any errors contained in this guide. OSD reserves the rights to make changes in the specifications and/or design of the above-mentioned product without prior notice. The diagrams contained in this guide may not fully represent the product that you are using, and they are for illustration purpose. OSD assumes no responsibility for any differences between the product mentioned in this guide and the product you may have.

WARRANTY

Warranty Info

All OSD NERO electronics products have a (2) year Limited Warranty against defects in materials and workmanship. Proof of purchase must accompany all claims. During the warranty period OSD AUDIO will replace any defective part and correct any defect in workmanship without charge for either parts or labor OSD AUDIO may replace returned speakers with a product of equal value and performance. In such cases, some modification to the mounting may be necessary and are not OSD AUDIO's responsibility. For this warranty to apply, the unit must be installed and used according to its written instructions. If necessary, repairs must be performed by OSD AUDIO. The unit must be returned to OSD AUDIO at the owner's expense and with prior written permission. Accidental

damage and shipping damage are not considered defects, nor is damaged resulting from abuse or from servicing performed by an agency or person not specifically authorized in writing by OSD Audio OSD AUDIO sells products only through authorized dealers and distributors to ensure that customers obtain proper support and service. Any OSD AUDIO product purchased from an unauthorized dealer or other source, including retailers, mail over dealers and on-line sellers will not be honored or serviced under existing OSD AUDIO warranty policy. Any sale of product by an unauthorized source or other manner not authorized by OSD AUDIO shall void the warranty on the applicable product. Damage to or destruction of components due to application of excessive power voids the warranty on those parts. In these cases, repairs will be made on the basis of the retail value of the parts and labor. To return for repairs, you must email customer service at RMA@audiogeargroup.com for a Returned Merchandise Authorization (RMA) number# then the unit must be shipped to OSD AUDIO at the owner's expense, along with a note explaining the nature of service required. Be sure to pack the unit(s) in a corrugated container with at least 3 inches of resilient material to protect the unit from damage in transit.

This Warranty Does Not Cover:

Damage caused by abuse, accident, misuse, negligence, or improper operation (installation) • Any products that have been altered or modified • Any product whose identifying number of decal, serial #, etc. has been altered, defaced or removed • Normal wear and maintenance

- osdaudio.com

Documents / Resources

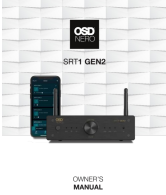
	<p>OSD NERO SRT1 GEN2 Network Music Player [pdf] Owner's Manual SRT1 GEN2, SRT1 GEN2 Network Music Player, Network Music Player, Music Player, Player</p>
---	---

References

- [User Manual](#)

[Manuals+.](#) [Privacy Policy](#)

This website is an independent publication and is neither affiliated with nor endorsed by any of the trademark owners. The "Bluetooth®" word mark and logos are registered trademarks owned by Bluetooth SIG, Inc. The "Wi-Fi®" word mark and logos are registered trademarks owned by the Wi-Fi Alliance. Any use of these marks on this website does not imply any affiliation with or endorsement.