



## OSD AUDIO OSD Control App Instructions

[Home](#) » [OSD AUDIO](#) » OSD AUDIO OSD Control App Instructions 



### OSD Control App Instructions

#### Contents

- [1 OSD Control App](#)
- [2 Documents / Resources](#)
- [2.1 References](#)

### OSD Control App

\*After Updating/Installing the OSD Control App, this will be the first screen you are met with. The following instructions will walk-thru setting up the OSD Control App to the Nero-Max12/Max8/Control12.

Once you open the OSD Control App, you will first see this screen. For proper configuration, please keep “Group 1” selected and proceed with selecting the “Settings” Button.

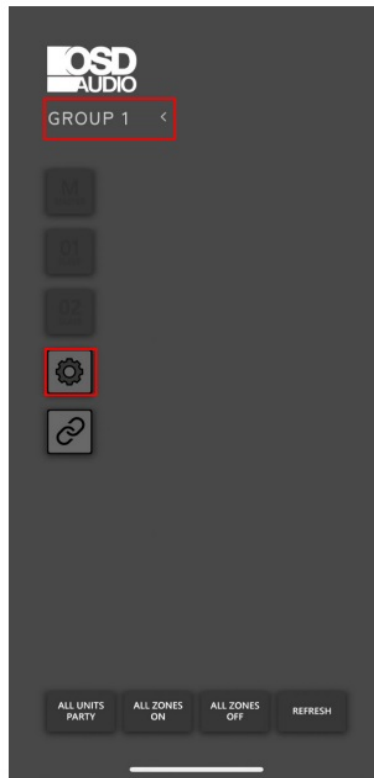

\*Please note, the Wireless Device using the OSD Control App, should be connected to the same Wi-Fi Network that is hardwired into the Nero-Max12/Max8/Control12.

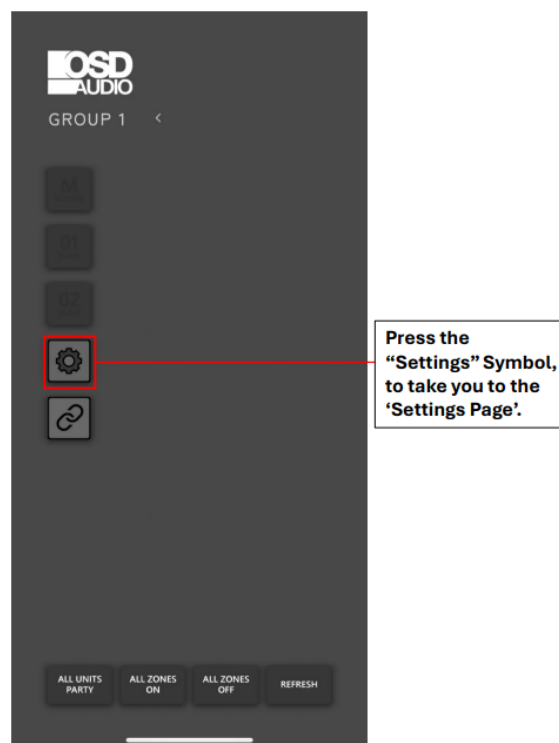

This is the 'Settings Page', and the available features you can Adjust, Update, and Configure.

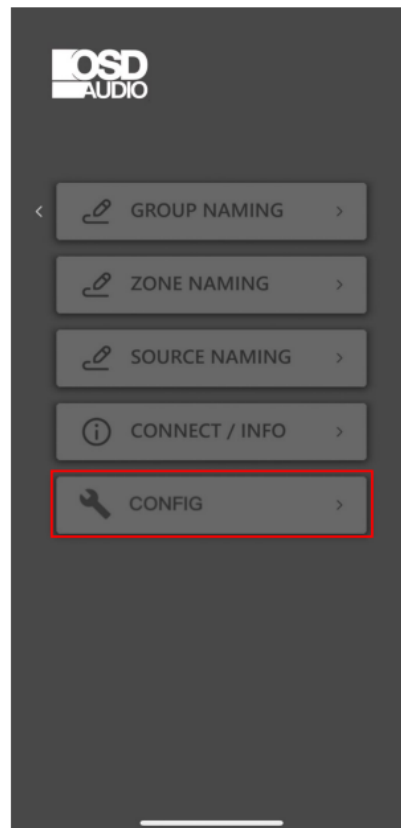
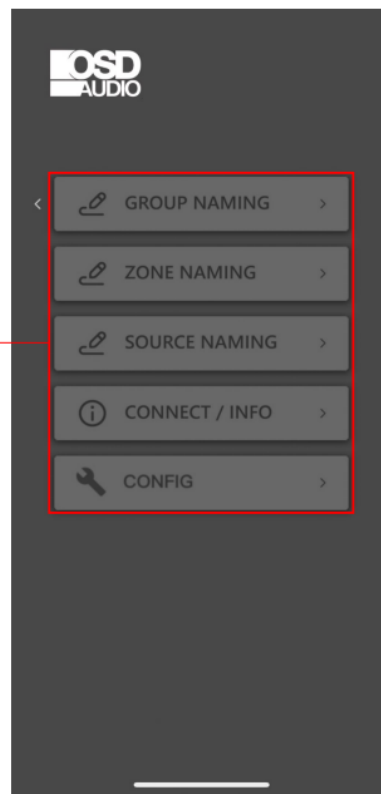

In the Settings Page, "Config" is where you can access the different 'Groups,' and the selected devices in each of the Groups.

\*Upon setup, you will want to enter this page, and change/adjust the device from the available 'Drop-down Menu'. Based on the unit you have, you will be able to choose from "Max12", "Max8", and "Control12". Please select your correct unit for Configuration.

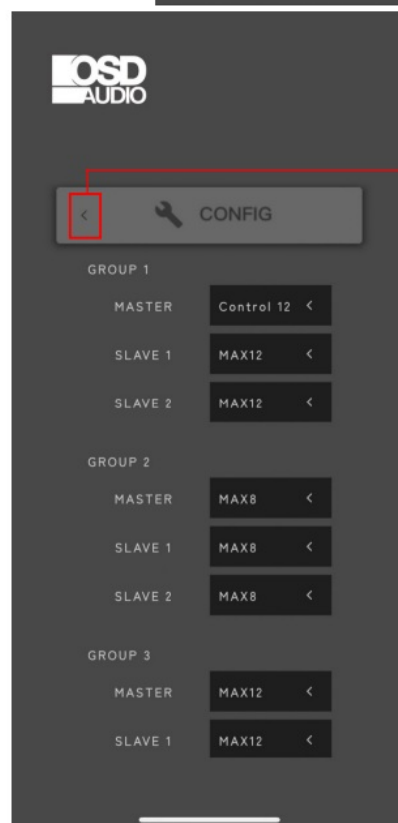
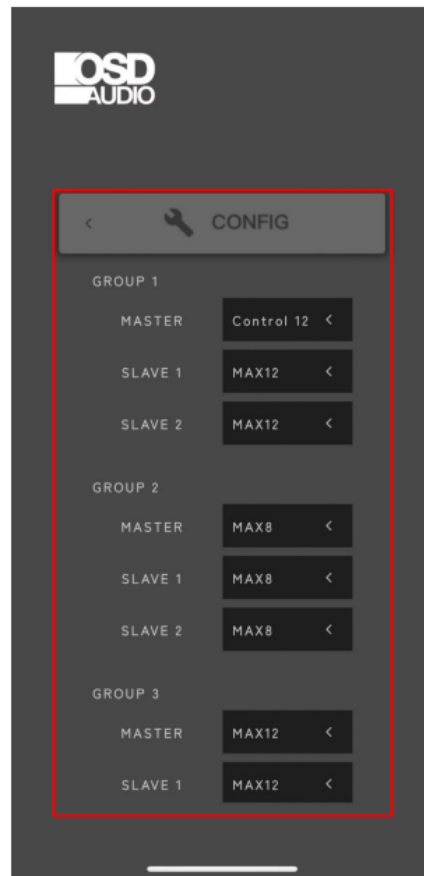

Use the “back-arrow”  
to go back to the  
previous screen.

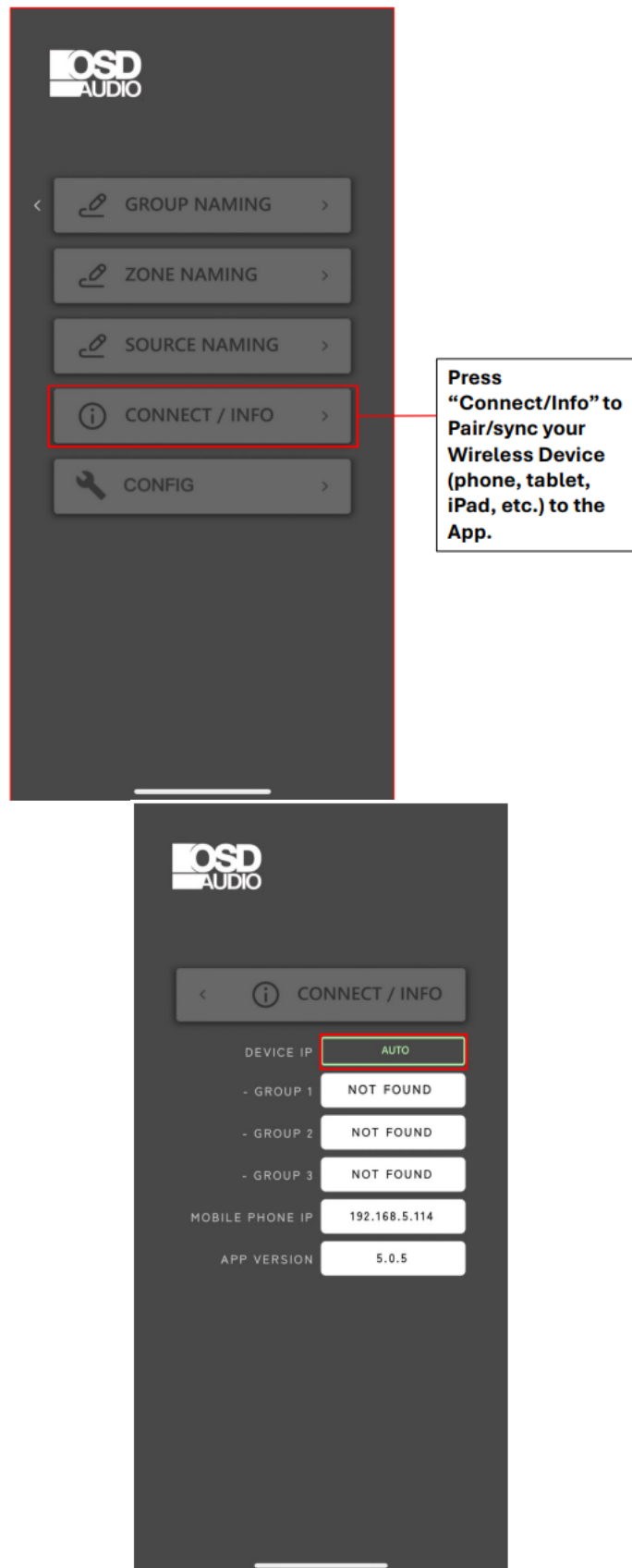

This is the "Connect/Info" Screen.

You will want to change the 'Device I.P' Setting from "Auto" to "Manual", by pressing the "Auto" Button.

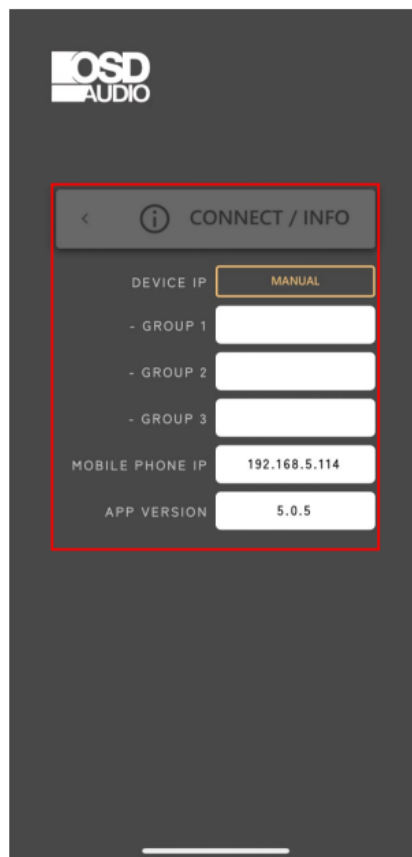

Your screen should look similar to this.

After the button is adjusted to “Manual”, you will need to press it again, to change to “Auto.

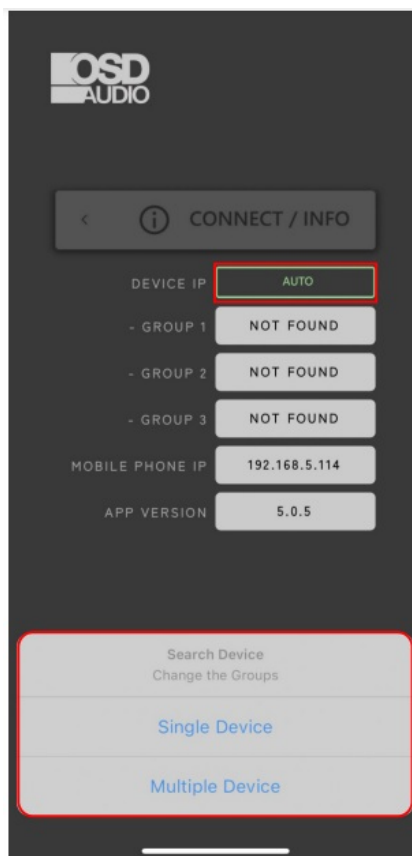

Here, the “Manual” button has been pushed to show “Auto”.

A pop-up will appear at the bottom of the screen, asking if you are Connecting a ‘Single Device’, or ‘Multiple Devices’.

This is solely based on the number of Nero-Max12, Max8 and Control12 devices you have and are looking to connect at one time.



After clicking “Single Device” or “Multiple Devices”, it will take you to this screen. This screen will show the OSD Control App cycling through the different I.P Addresses within your Network. This will continue to cycle through I.P’s until it finds the NeroMax12/Max8/Control12 on your Network



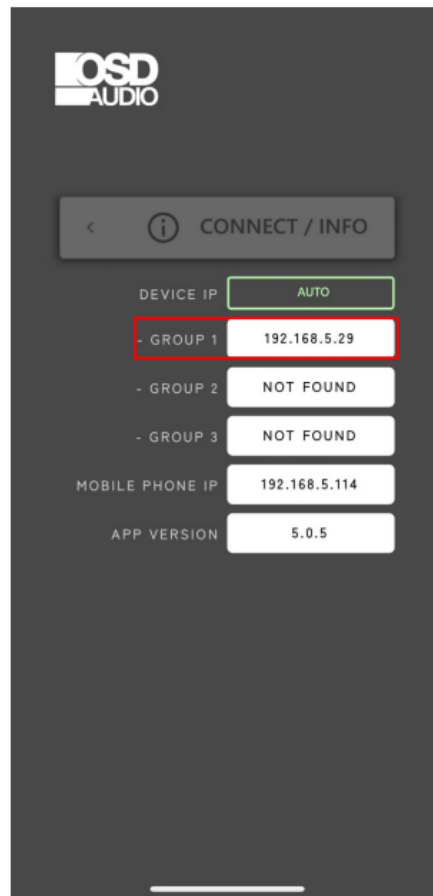

Once the OSD Control App finds the NeroMax12/Max8/Control12 I.P Address, it will refresh, and come back to this “Connect/Info” Screen. If you only have x1 NeroMax12/Max8/Control12, then it will only display “Group 1” with an available I.P Address. If you have multiple NeroMax12/Max8/Control12 units, then it will display the other I.P Address’ in a different ‘Group’ number.

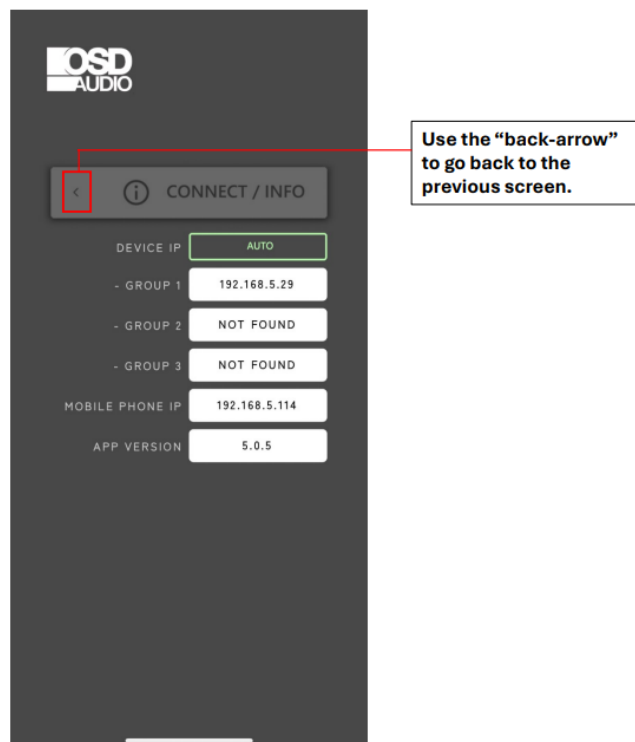



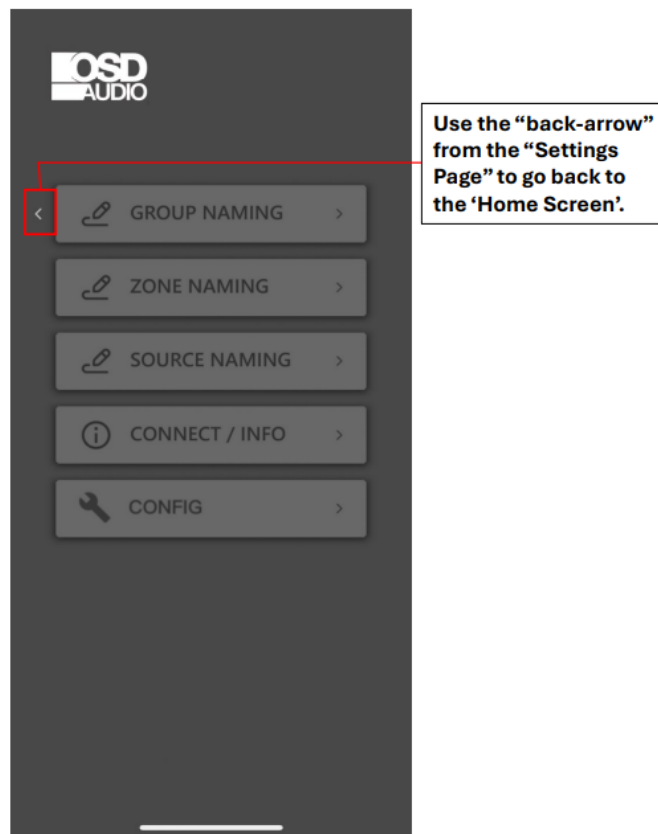

\*Your device is now connected!  
This will be the updated Home Screen.



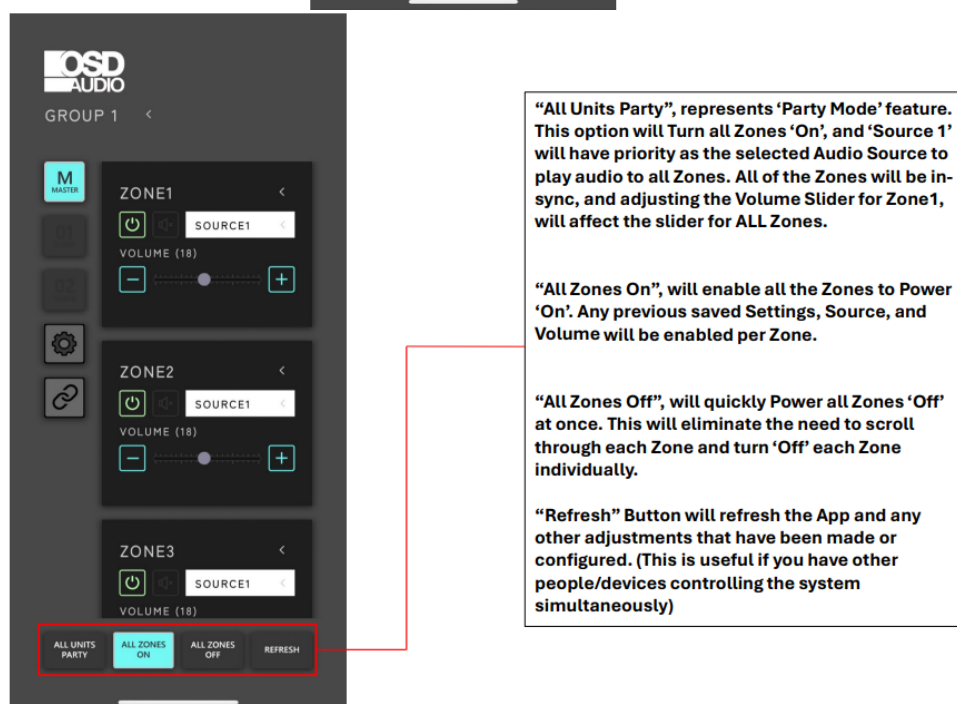
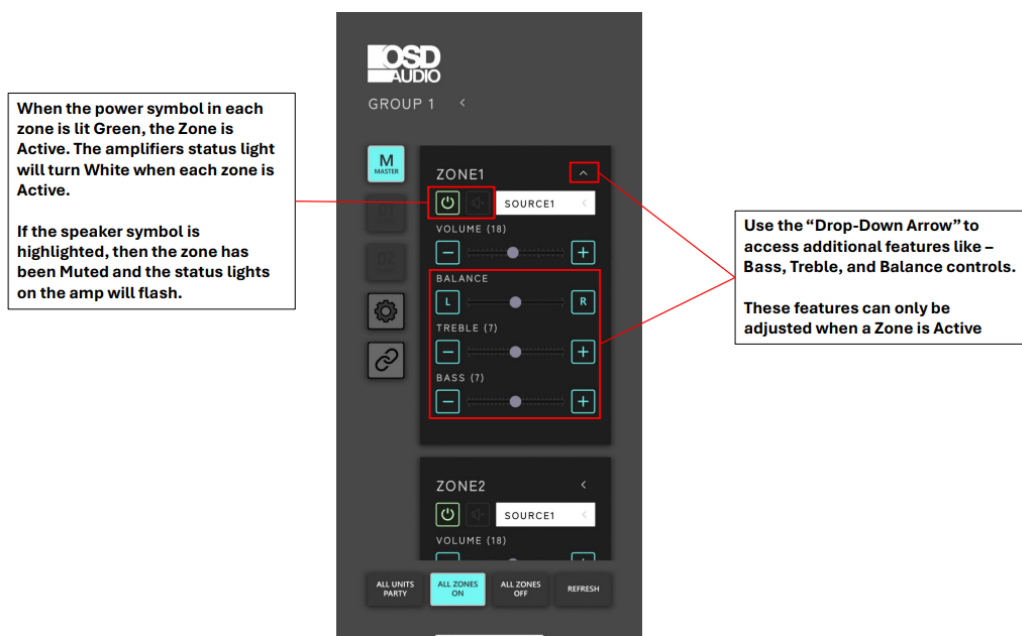
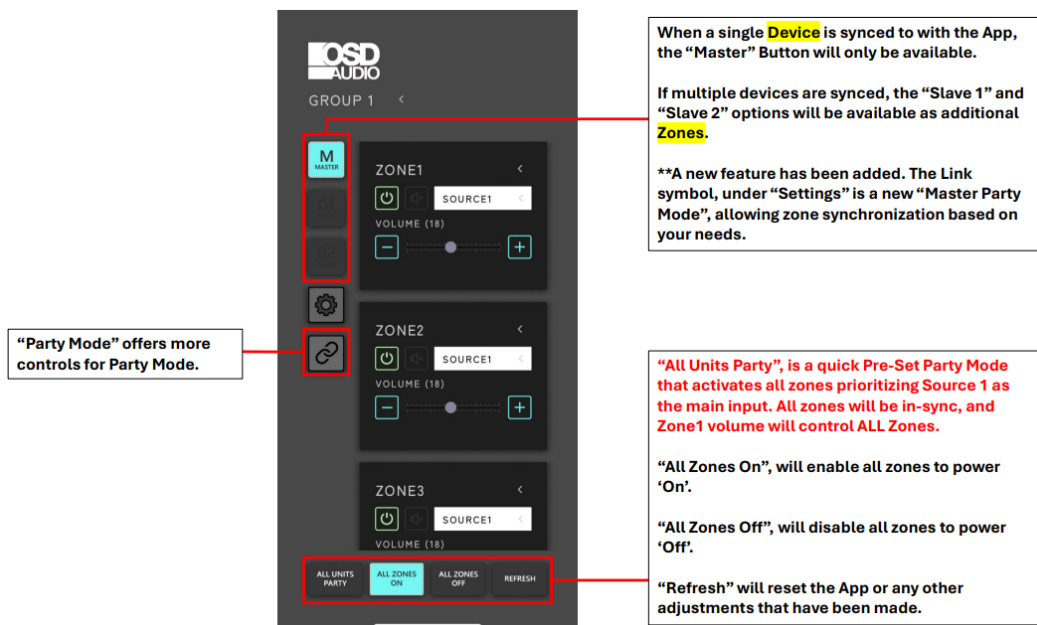



The new "Master Party Mode" Button will feature a new pop-up screen. Here, you can select if you want this feature to be 'On'/'Off', Volume Level Up/Down, and Select the Source of Audio. Additionally, you can pick-and-choose which Zones you want to be synced together in 'Party Mode'.

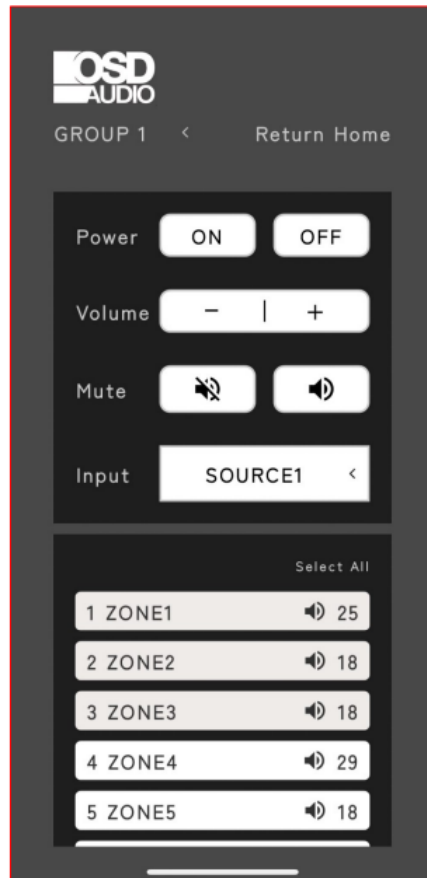

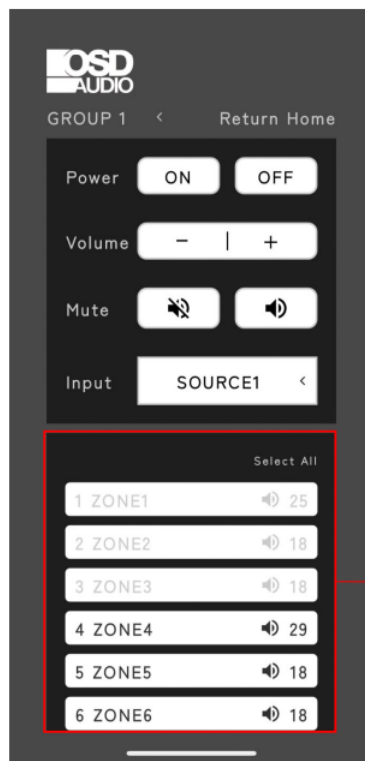

Here, only Zones 4-6 are selected to be 'On', and playing 'Source 1'. You can clearly view that Zones 1-3 are not highlighted, and are enabled 'Off'.

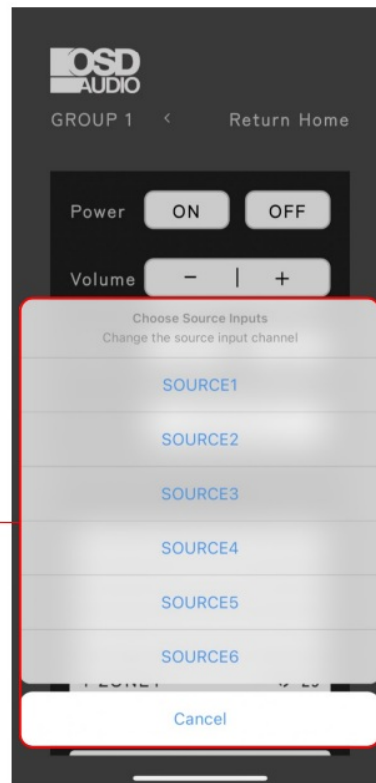

When pushing the drop-down for the 'Input', you will be able to select your Audio Source from Source 1-6.

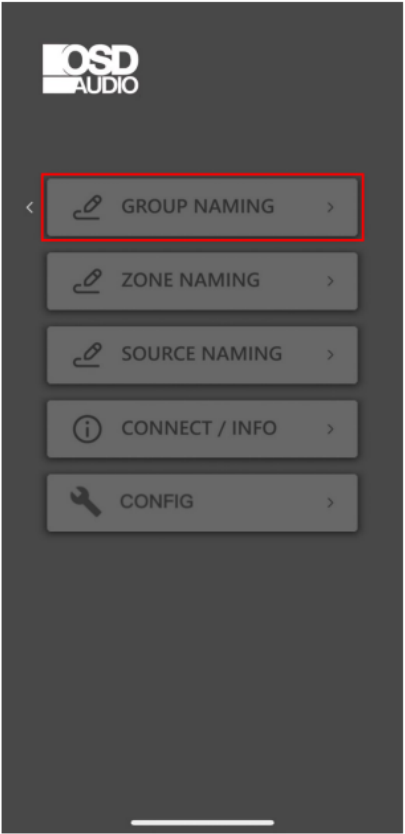

Here, you can change/adjust the "Name" of each Group. The 'Group' will represent your unit – Nero-Max12/Max8/Contro l12

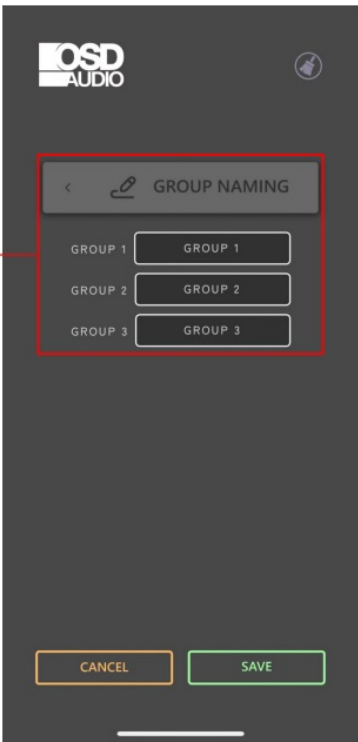

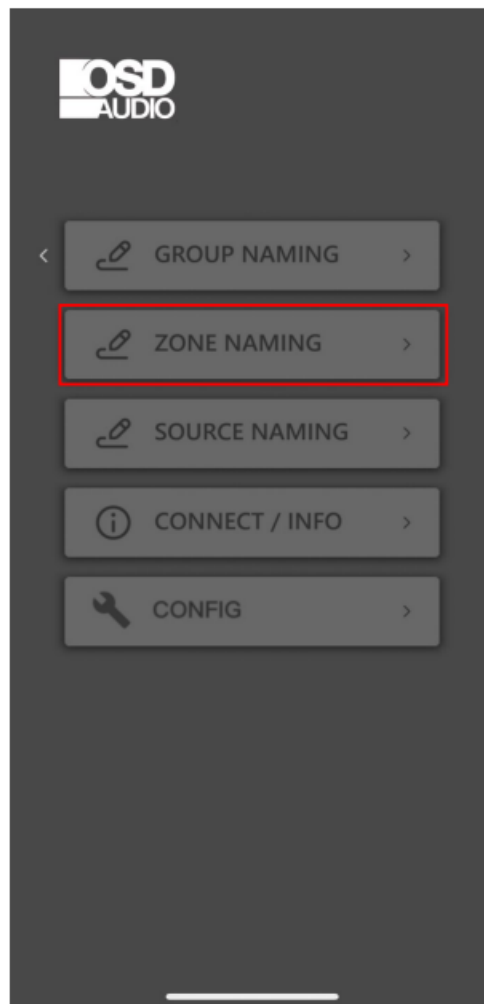

In the Settings Page, “Zone Naming” is where you can access the “Zone Names” and change the name.

Ex. Bedroom 1, Bathroom, Kitchen, Dining Room.

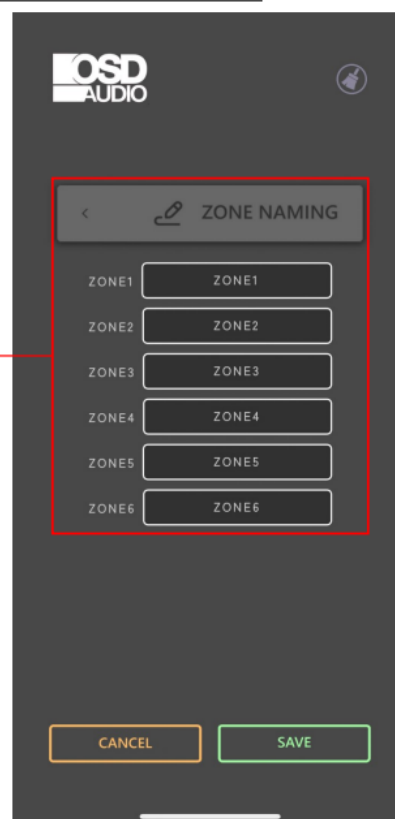

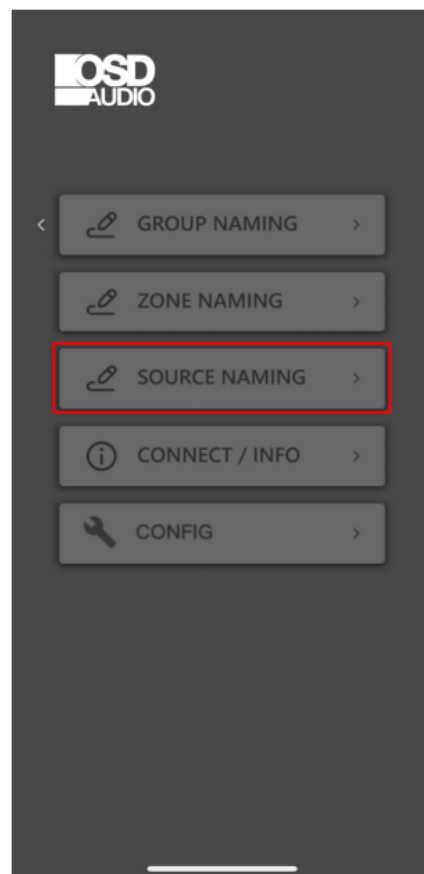

In the Settings Page, "Source Naming" is where you can rename the "Source Names".

Ex. TV, A/V Receiver, Streamer, etc.

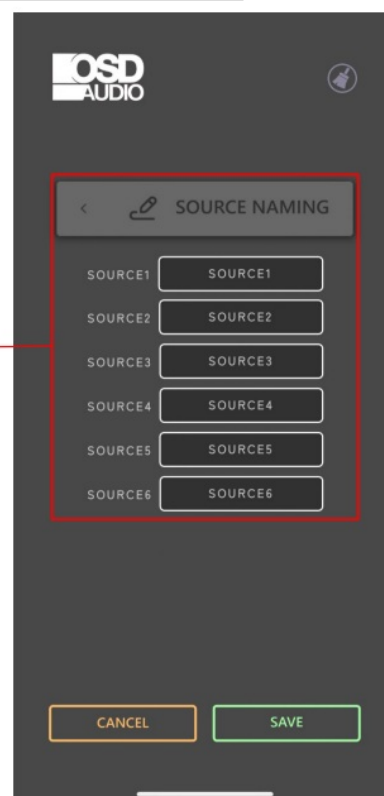

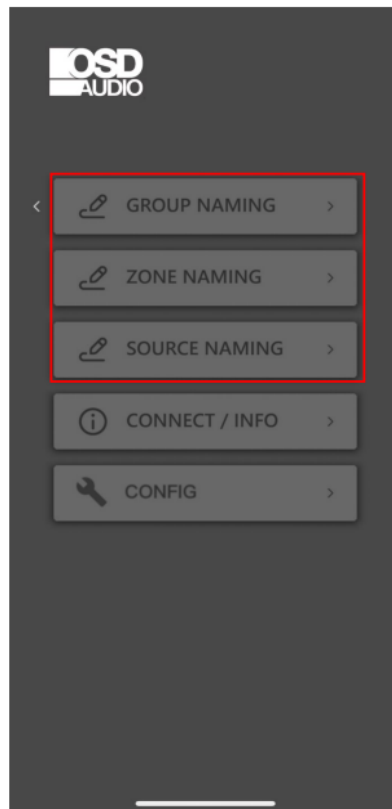

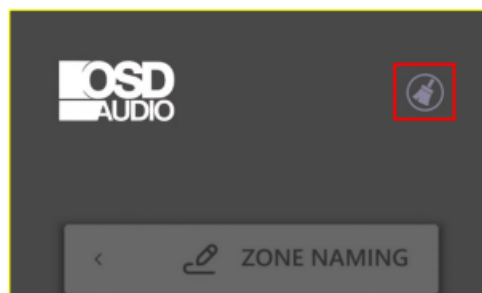

Each of the customer 'Naming' features now feature a new button 'Broom', in the top-right corner. You can use this button to 'Clear All' of the Names that have been updated/adjusted.



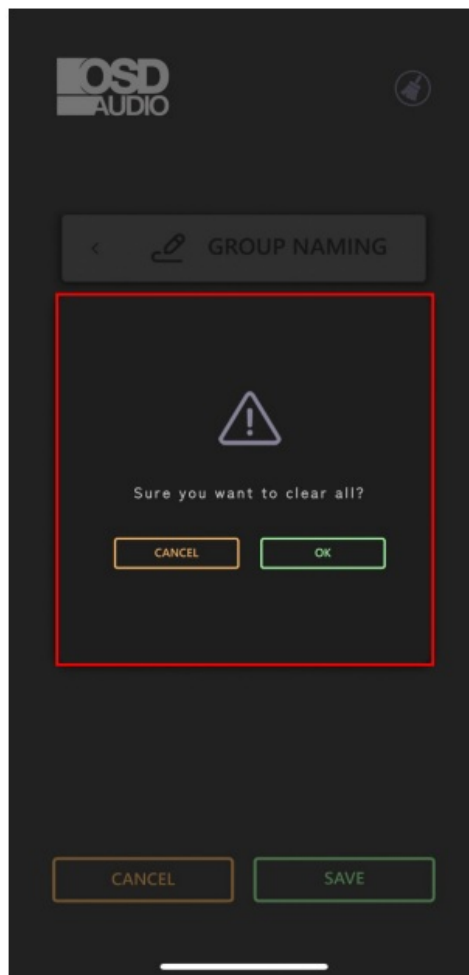



## Documents / Resources

	<a href="#">OSD AUDIO OSD Control App</a> [pdf] Instructions Max12, Max8, Control12, OSD Control App, Control App, OSD App, App
---	--

## References

- [User Manual](#)

[Manuals+](#), [Privacy Policy](#)

This website is an independent publication and is neither affiliated with nor endorsed by any of the trademark owners. The "Bluetooth®" word mark and logos are registered trademarks owned by Bluetooth SIG, Inc. The "Wi-Fi®" word mark and logos are registered trademarks owned by the Wi-Fi Alliance. Any use of these marks on this website does not imply any affiliation with or endorsement.