



ORVIBO DS Smart Dimmer Switch with Remote Control User Manual

[Home](#) » [ORVIBO](#) » ORVIBO DS Smart Dimmer Switch with Remote Control User Manual 



Smart Dimmer
Remote & Bracket Kit
User Manual

Any help needed, please contact us by support.us@orvibo.com
Support: <https://www.orvibo.com/en/support>

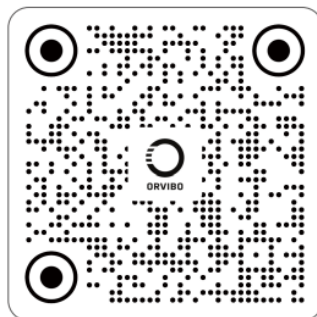

<https://www.orvibo.com/en/support/UserGuide>

The app will be optimized and updated, please refer to the electronic manual by scan QR code for the latest usage.

Contents

- [1 Product Description](#)
- [2 Packing List](#)
- [3 Specification](#)
- [4 Installation — A11 Smart Dimmer Switch](#)
- [5 Installation — EU1254 Remote Switch](#)
- [6 Control Instruction](#)
- [7 Matching Mode](#)
- [8 Removing Matching Mode](#)
- [9 Download App and Register](#)
- [10 Add Devices Manually](#)
- [11 Support Amazon Alexa and Google Home](#)
- [12 Set Up with Matter](#)
- [13 Failed to Set Up”?](#)
- [14 FAQ](#)
- [15 Warranty Range And Duration](#)
- [16 FCC](#)
- [17 Documents / Resources](#)
 - [17.1 References](#)

Product Description

ORVIBO Smart Dimmer Switches can quickly replace traditional single—pole switches, enabling remote control from anywhere with your smart phone app. You could create the automation for the switch by setting the timer schedules, sunrise/sunset, or together with compatible ORVIBO smart home products. It adopts a Wi—Fi communication protocol and also can work with Amazon Alexa, Google Assistant and Siri Shortcuts. The switch is for indoor use only. The neutral wire is required. It works with single—pole switches, not with 3—way switches. The Remote Switch is a portable control switch. It works without Wi—Fi and is not limited by router distance. Self-generating technology, no need to charge or worry about running out of power. No batteries required, can be placed anywhere.

Packing List



Smart Dimmer Switch x1

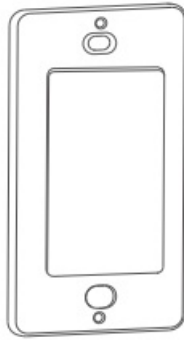

Base Plate x1

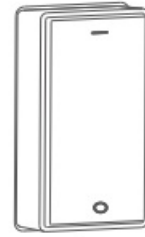

Remote Switch x1

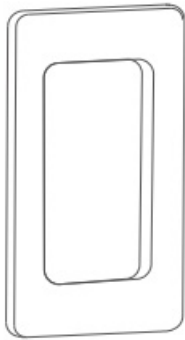

Bracket x2



Logo Sticker x1



User Manual x1

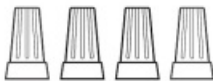

Wire Connector x4



Double Sided Tape x1



Screw x4

Screw x4

Specification

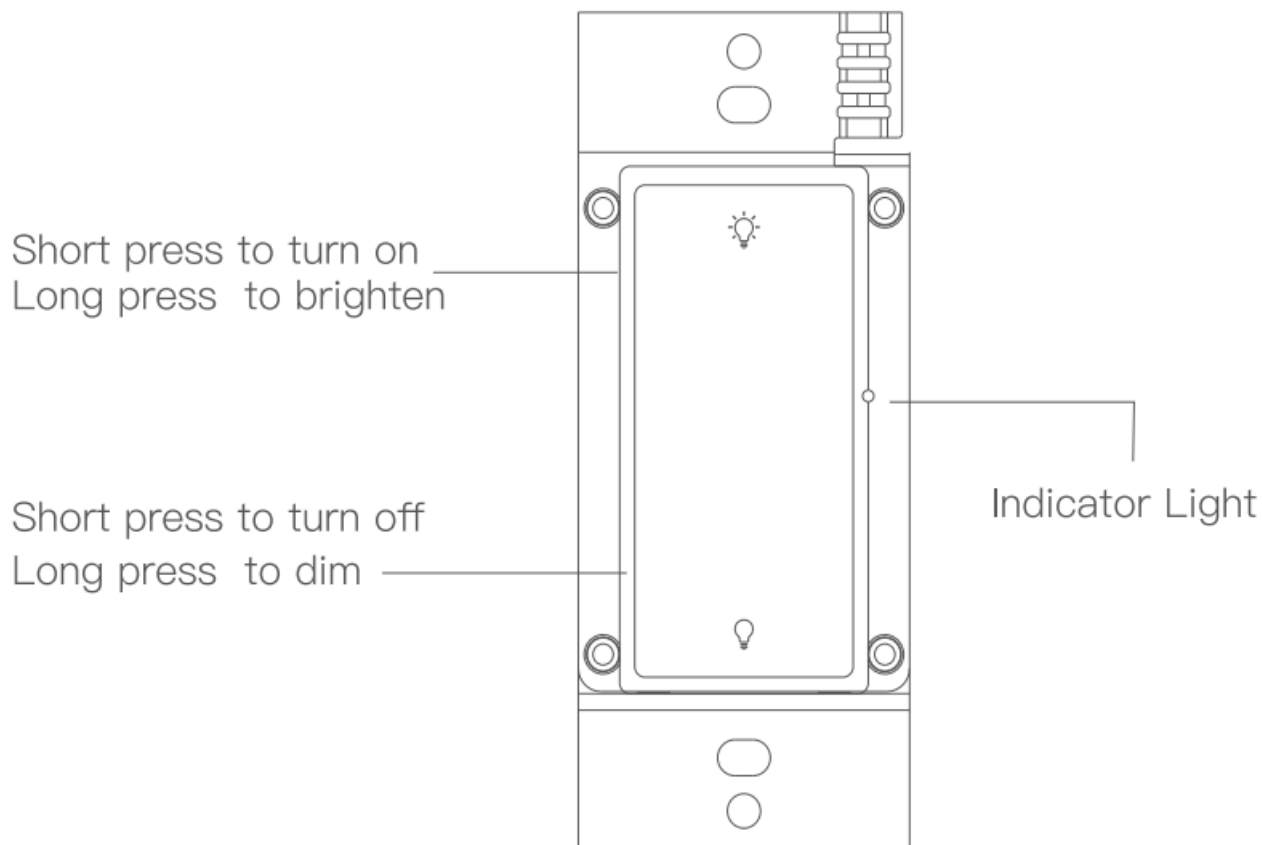

Product Model	A1
Product Size	4.21*1.73*1.61 in.
Input Voltage	100-240VAC 50/60Hz
Load Range	300W INC 200W LED or CFL
Wireless Type	2.4GHz WiFi & 902MHz RF
Working Temperature	32°F-122°F
Working Humidity	≤90%RH (Non—condensing)

Short press to turn on
Long press to brighten

Short press to turn off
Long press to dim

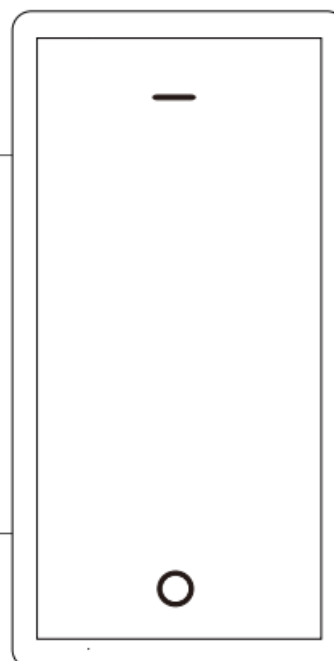

Product Model	EU1254
Product Size	2.56*1.3*0.63 in.
Operating Voltage	Self-powered DC3.3V
Wireless Type	902MHz RF
Working Temperature	32°F-122°F
Working Humidity	≤ 90%RH (Non—condensing)

Installation — A11 Smart Dimmer Switch

1. Turn off the power at circuit **breaker!**

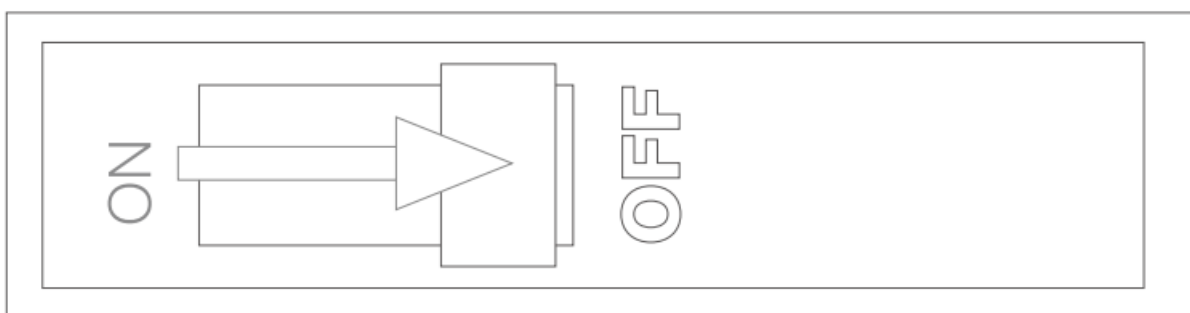

WARNING: Shock Hazard May result in serious injury or death. Turn off power at circuit breaker or fuse before installing.

2. Pull out existing switch from wall.
 - 1 Remove the wallplate from the switch.

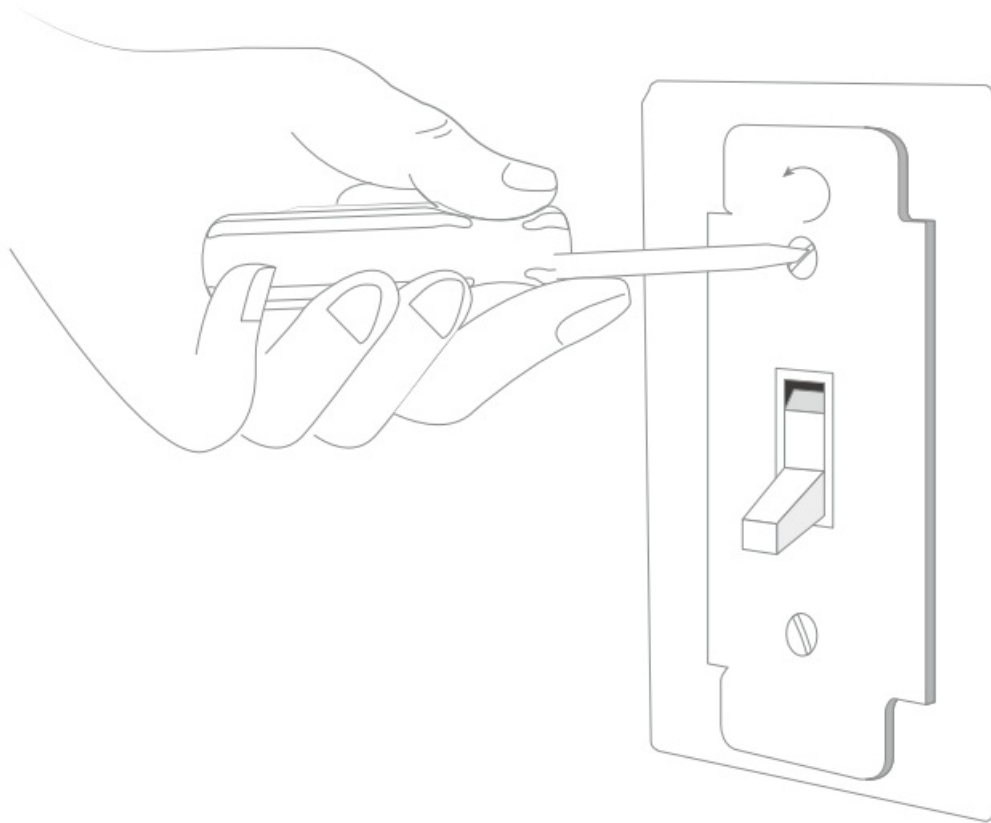

2) Unscrew the switch from the wall.

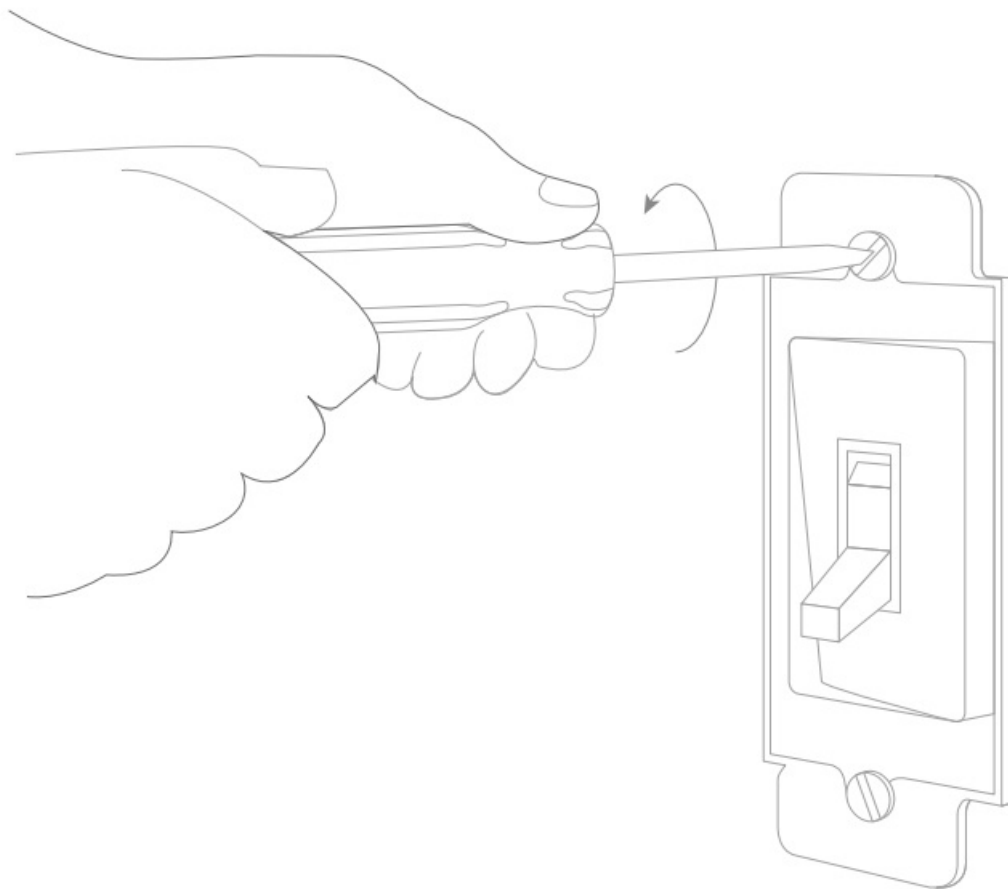

3 Pull it out of the junction box, keep them wired.

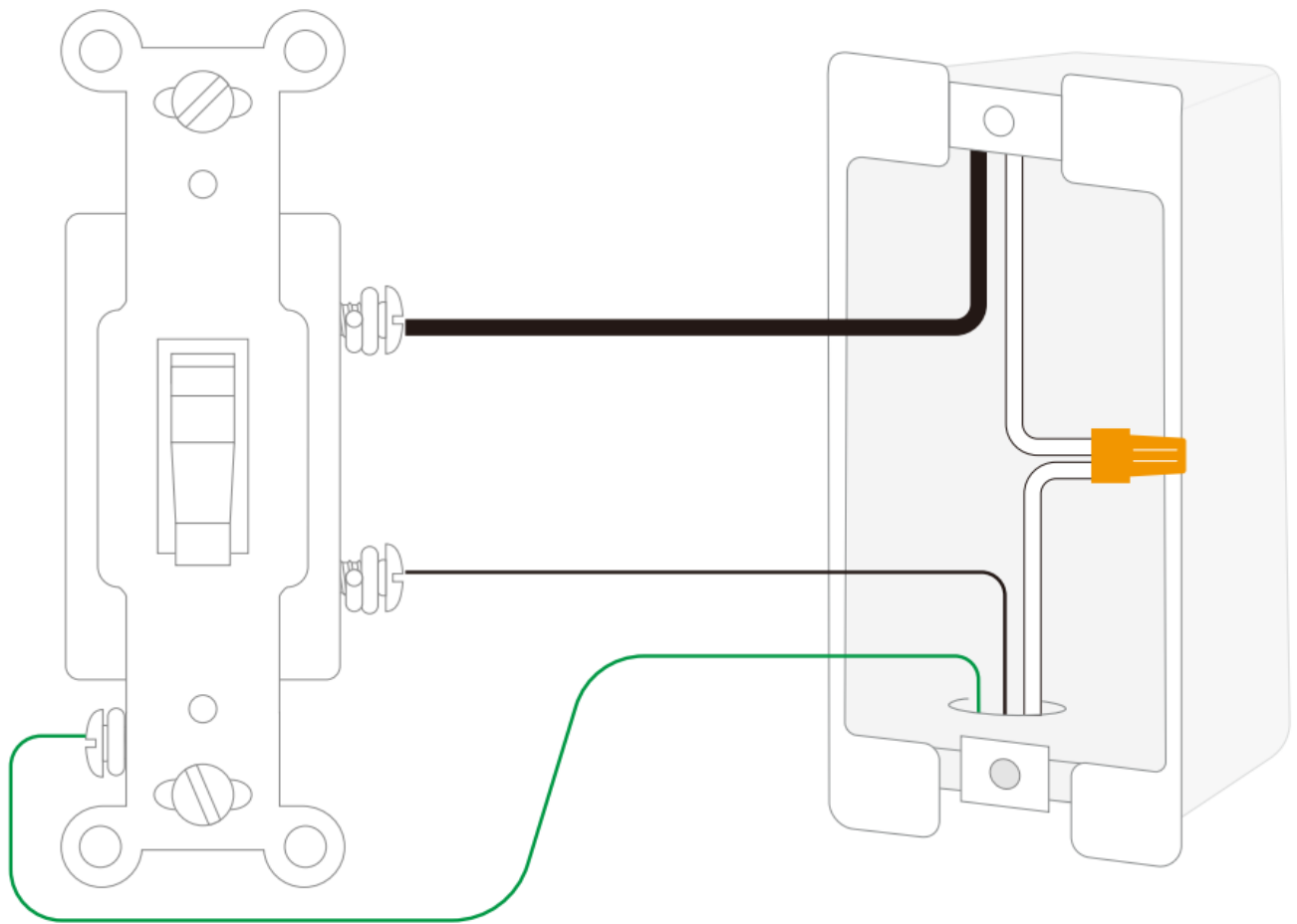

3. Identify and label the wires.

(1) Identify the Neutral wires, and label the wires with the “Neutral” sticker.

Note:

- a. The Neutral wire is usually white or grey.
- b. If there is no neutral, please call an electrician for help.

2) Identify the Ground wires (most likely a bare copper or green) and label the wires with the “Ground” sticker.

3 Identify the Line wires and label the wire with “Line” sticker.

@ Identify the Load wires and label the wire with “Load” sticker.

Note:

- a. You can use an electrical tester to identify the Line and load wires or call an electrician for help.

b. The Line wire is always energized whether the light is on or off and the Load wire is only energized when the light is on.

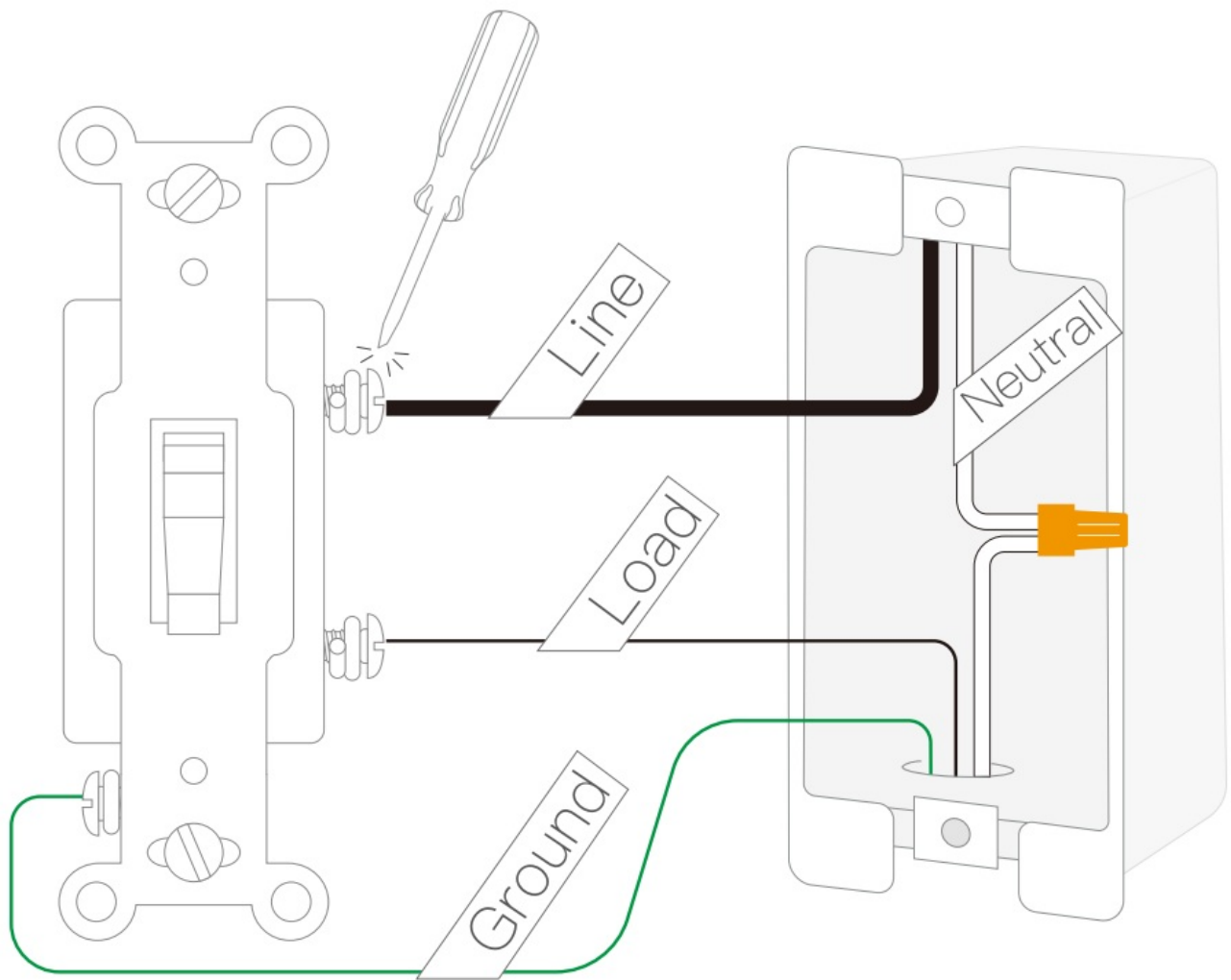

4. Remove the existing switch.

Make sure the circuit breaker is power off.

Disconnect all wires from the switch.

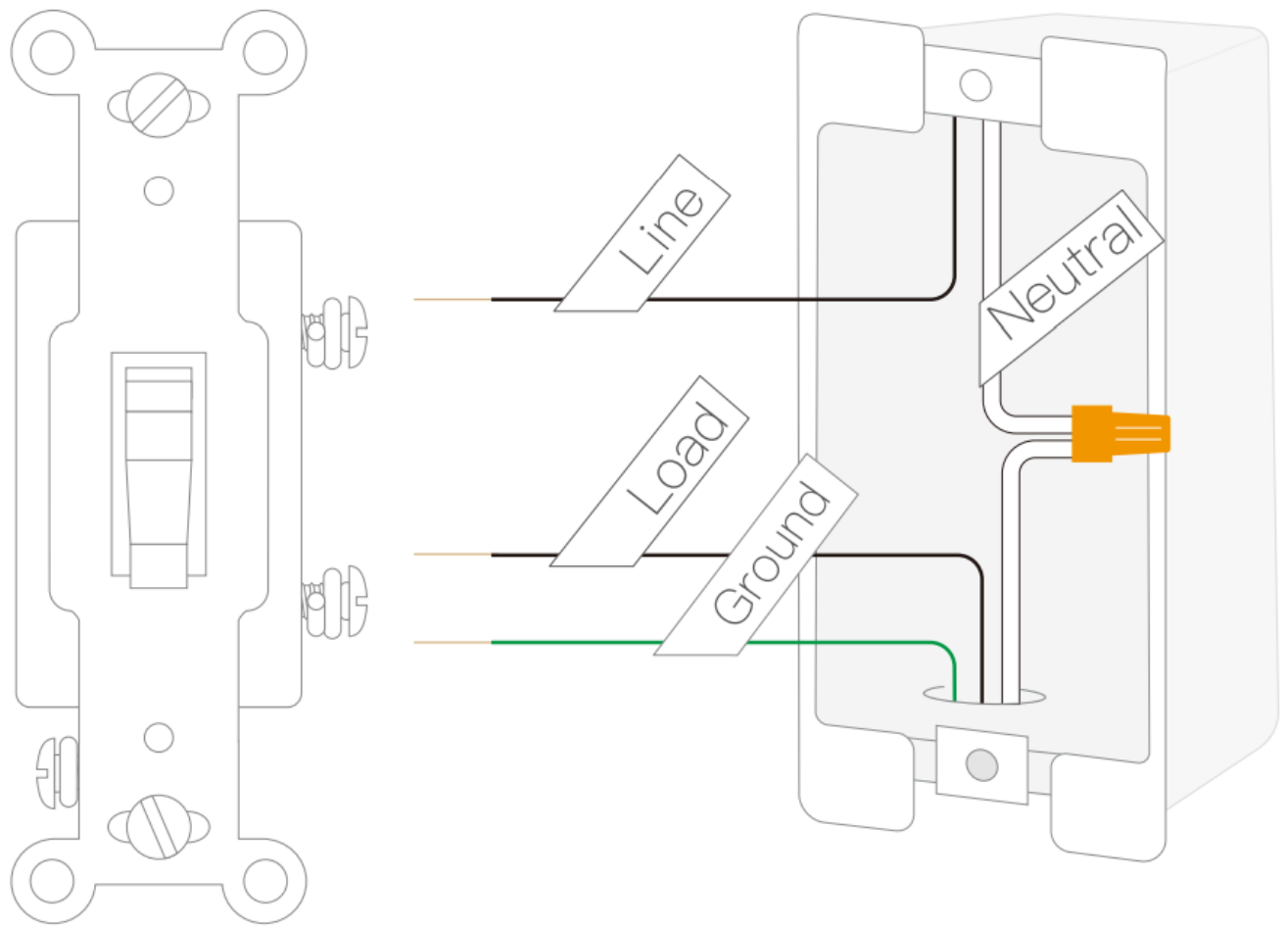

5. Connect the Smart Dimmer Switch from the switch.

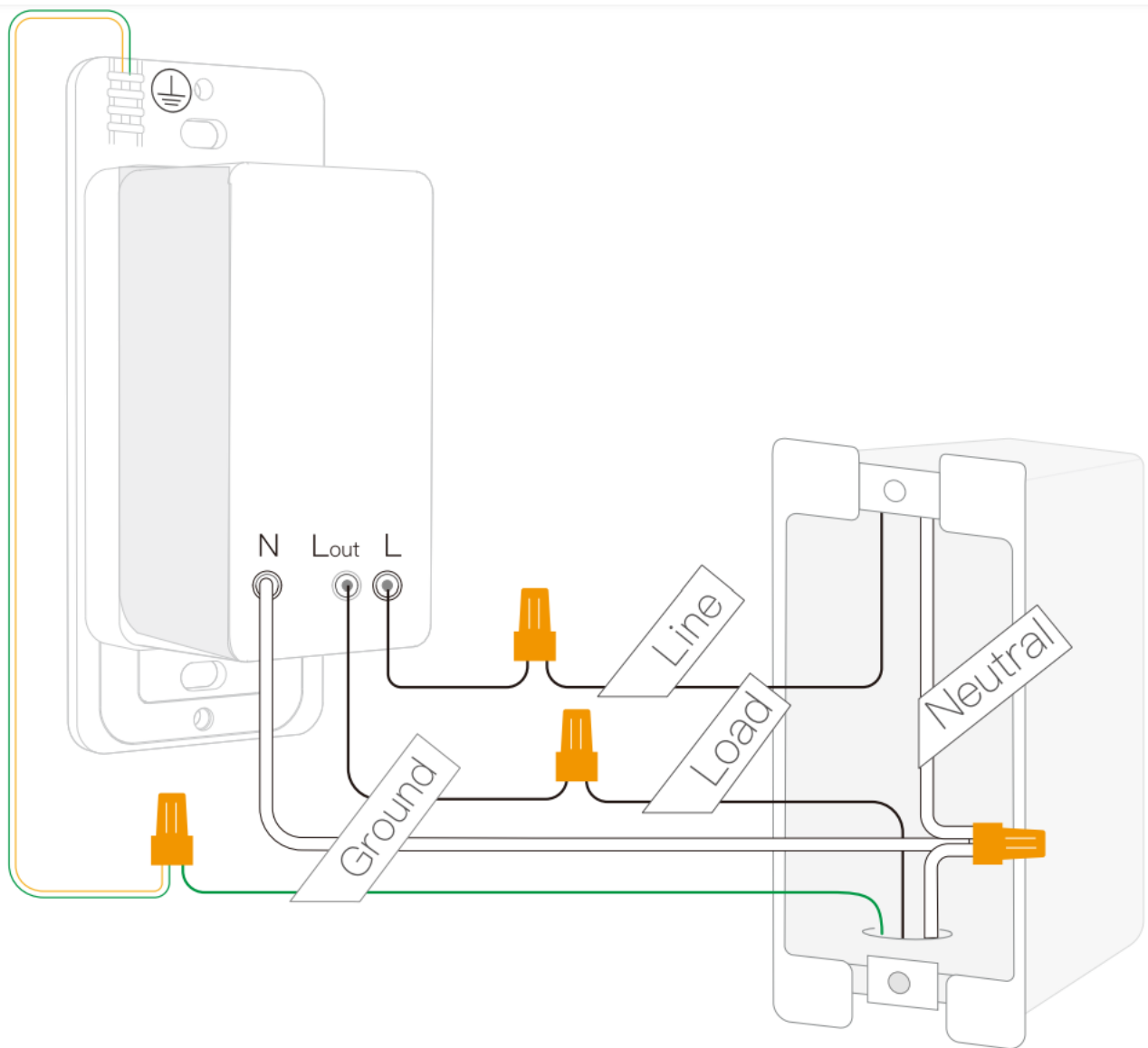

Make sure the circuit breaker is power off. Use wire connector connect the wires on the Smart Dimmer Switch to the labeled wires coming from the wall in order.

(1 Connect Neutral wires to N wire of the switch

(@ Connect Ground wires to @ wire of the switch

(@ Connect Line wires to L wire of the switch

(4 Connect Load wires to Lout wire of the switch

6. Mount the switch and wallplate. (D Use the screws provided.

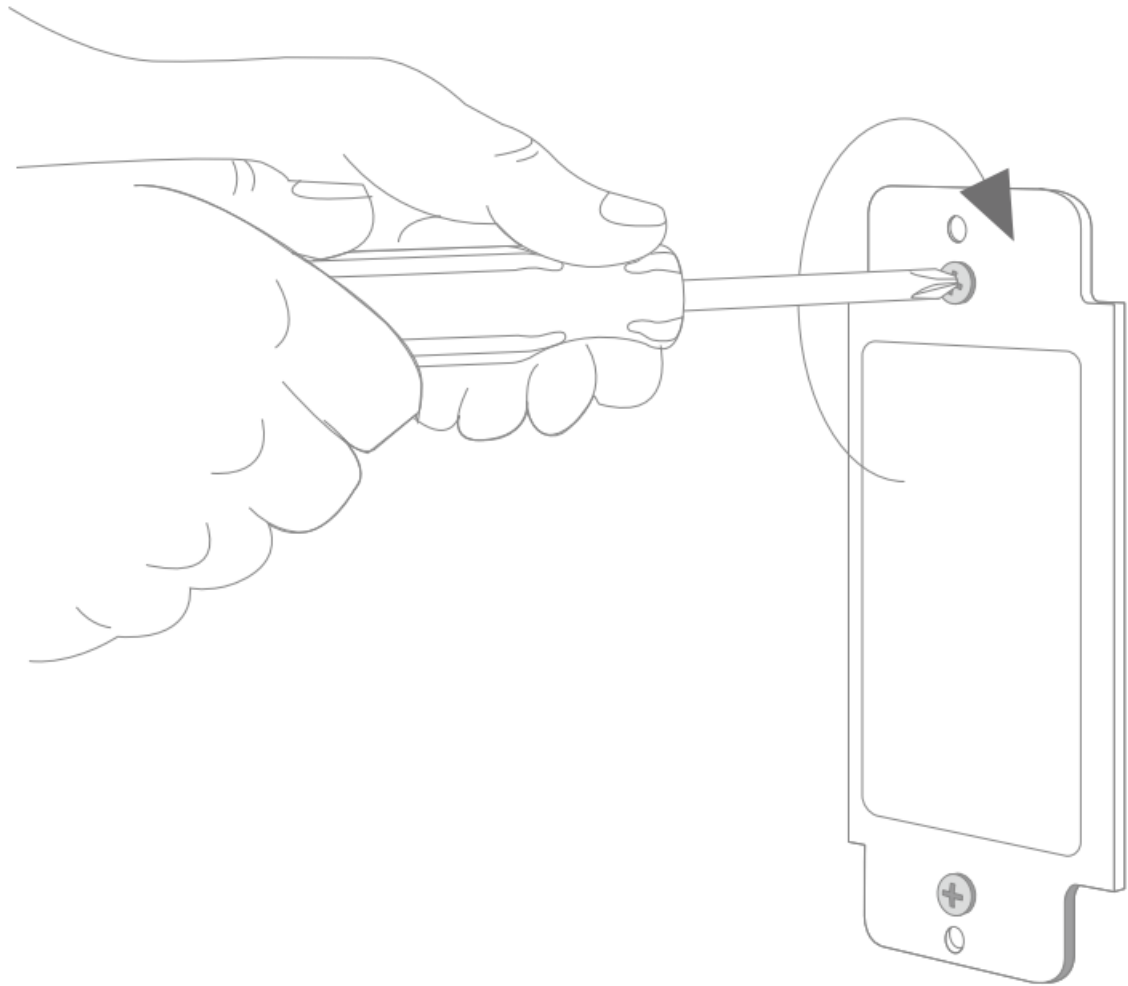

2 Attach brack panel of the bracket to the switch using the screws.

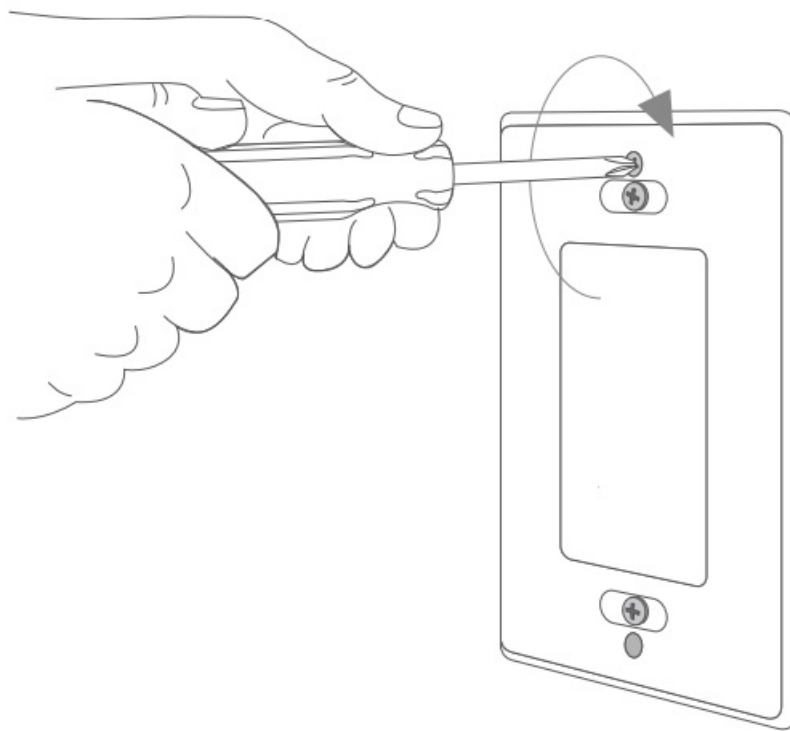

3 Snap on front panel of the bracket.

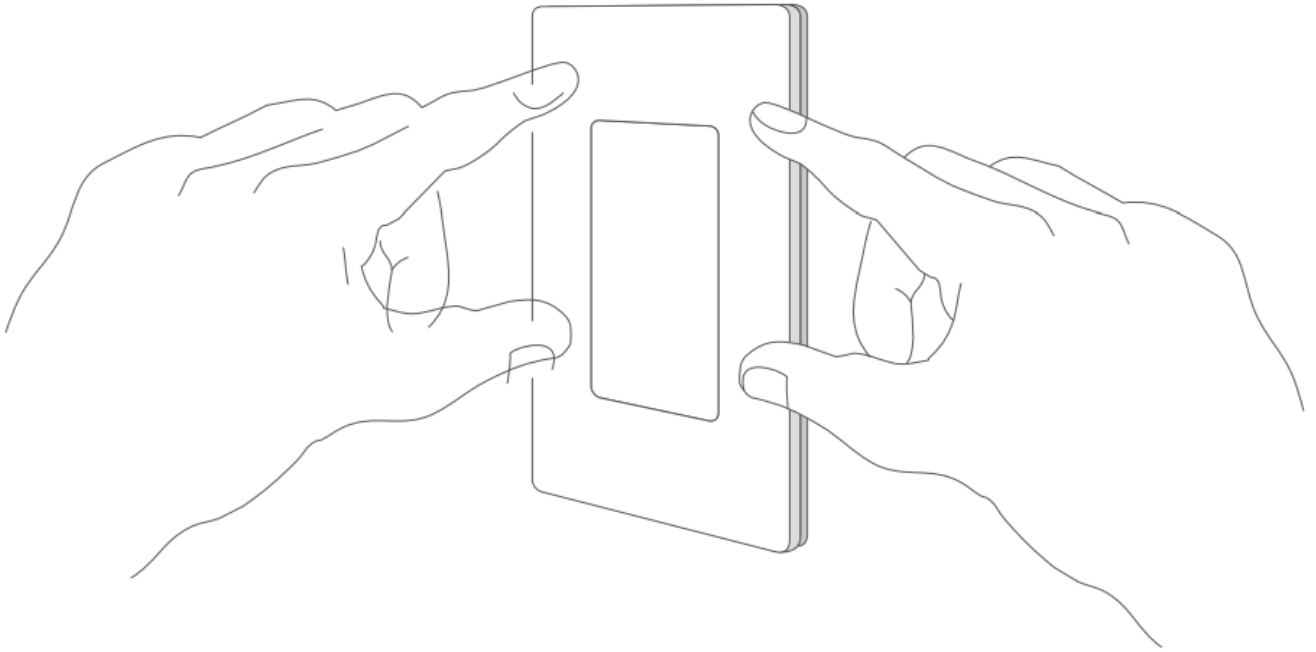

7. Turn power on at circuit breaker.

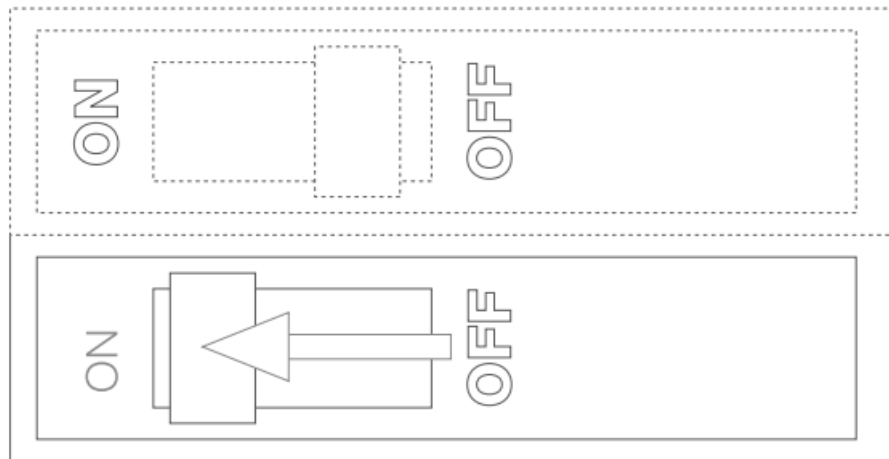

Installation — EU1254 Remote Switch

1. Mount the switch on the wallbox.
(D Use the screws mount the base plate.

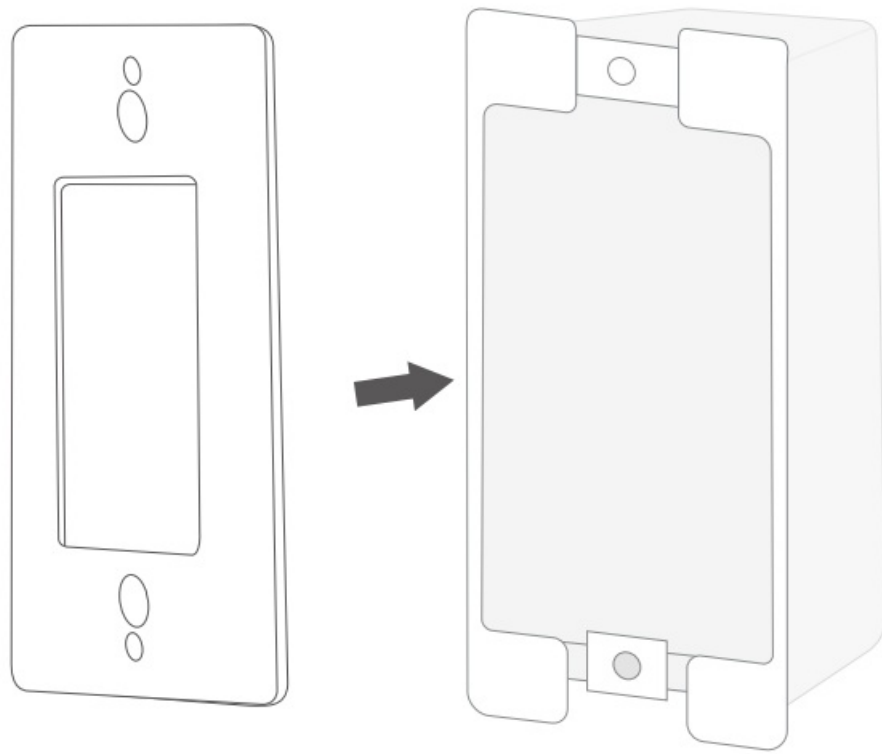

2 Attach back panel of the bracket to the switch using the screws.

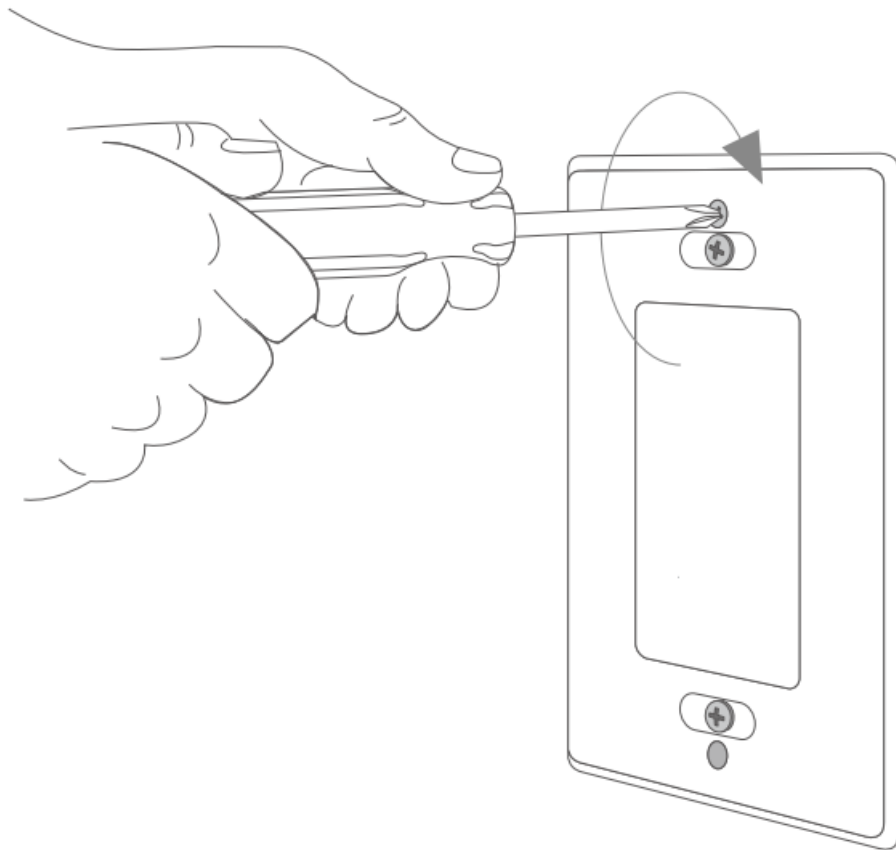

3 Snap on the front panel of the bracket.

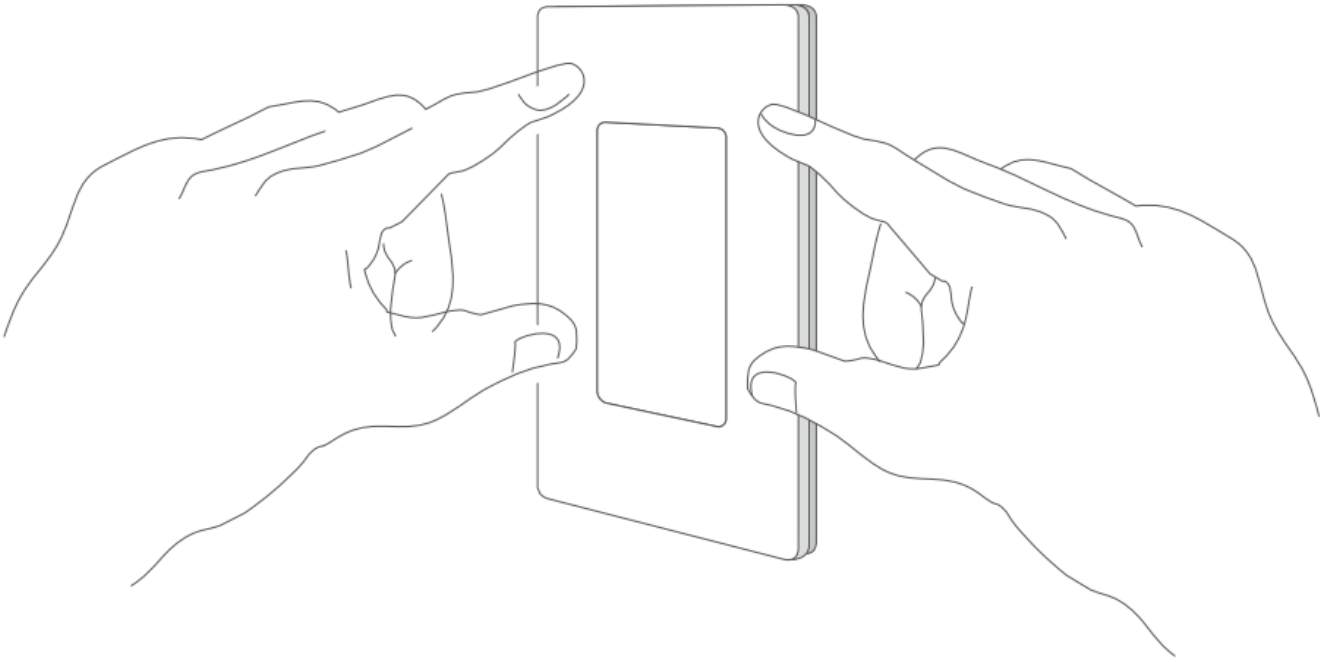

4 Put the Remote Switch on the wallplate.

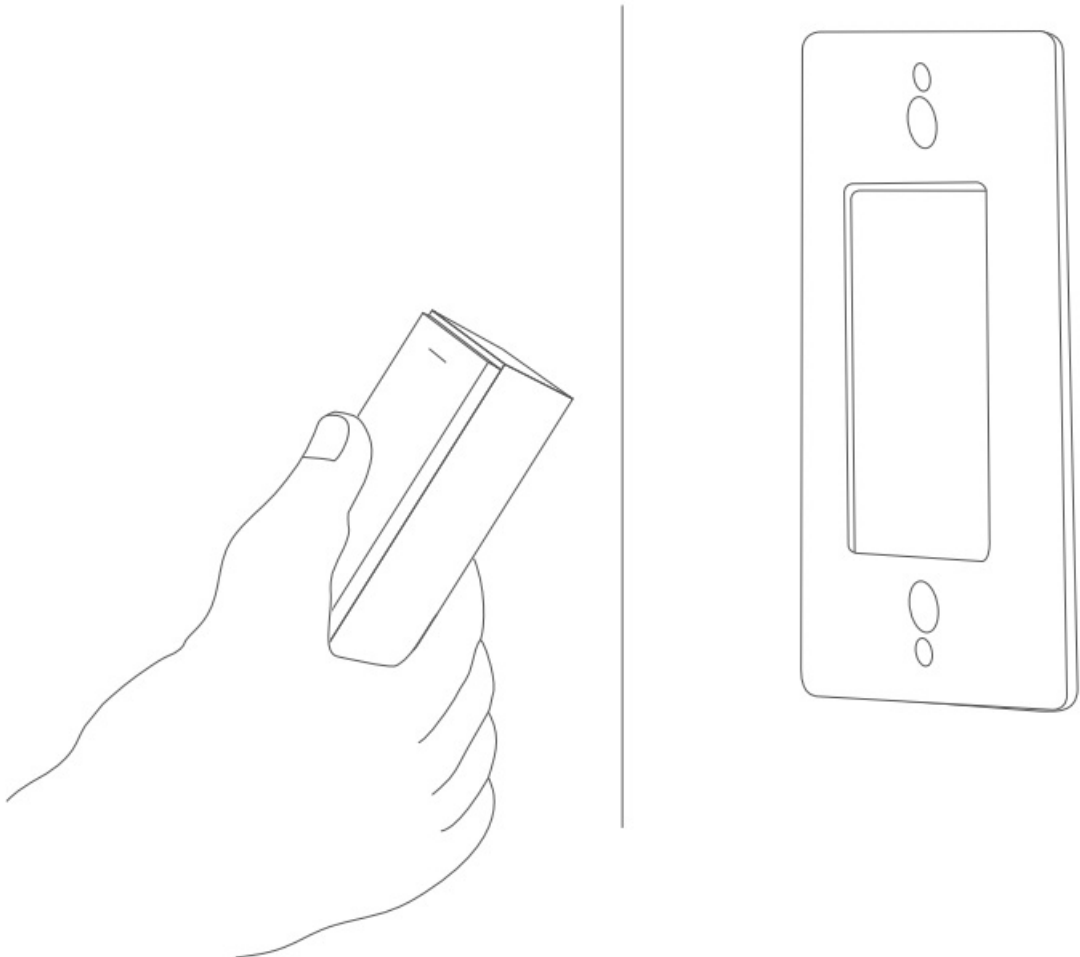

2. Placed anywhere with double sided tape.

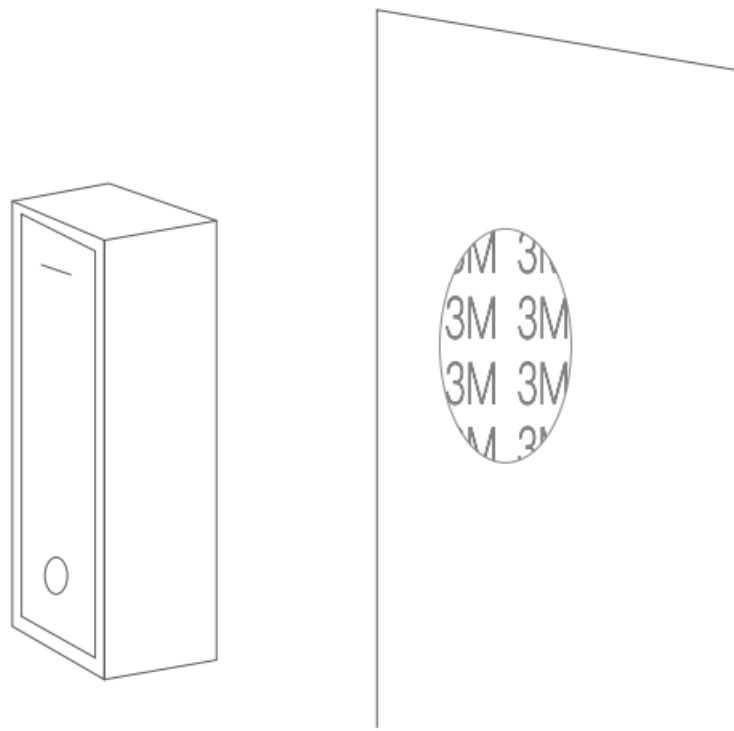

3. Control the switch remotely.

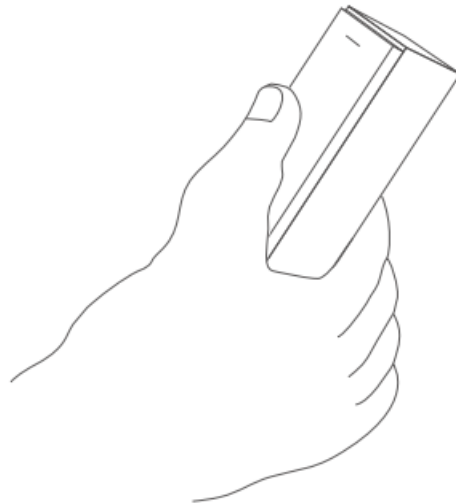

4. Put it on the fridge.

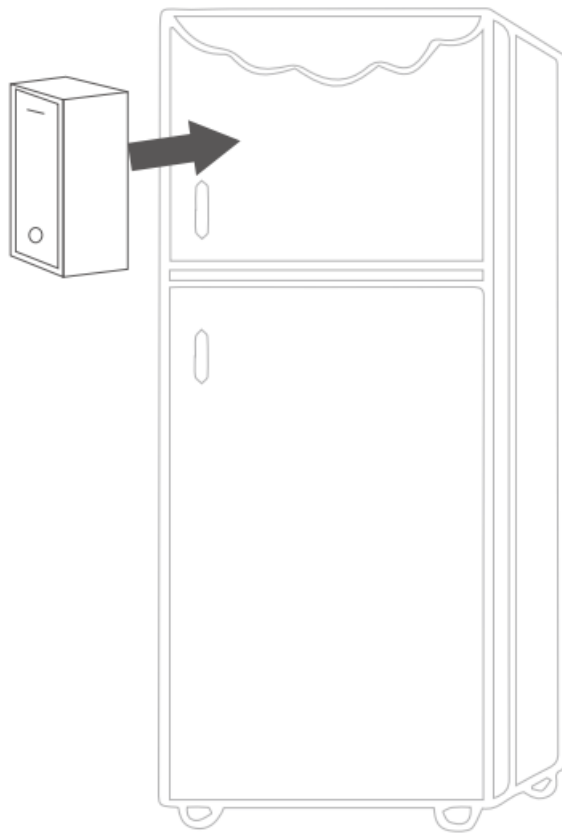

Control Instruction

The Remote Switch can control the Smart Dimmer Switch, one or multiple at one time. At the same time, multiple Remote Switches can control one Smart Dimmer Switch, but the number of Remote Switches could not be more than 10.

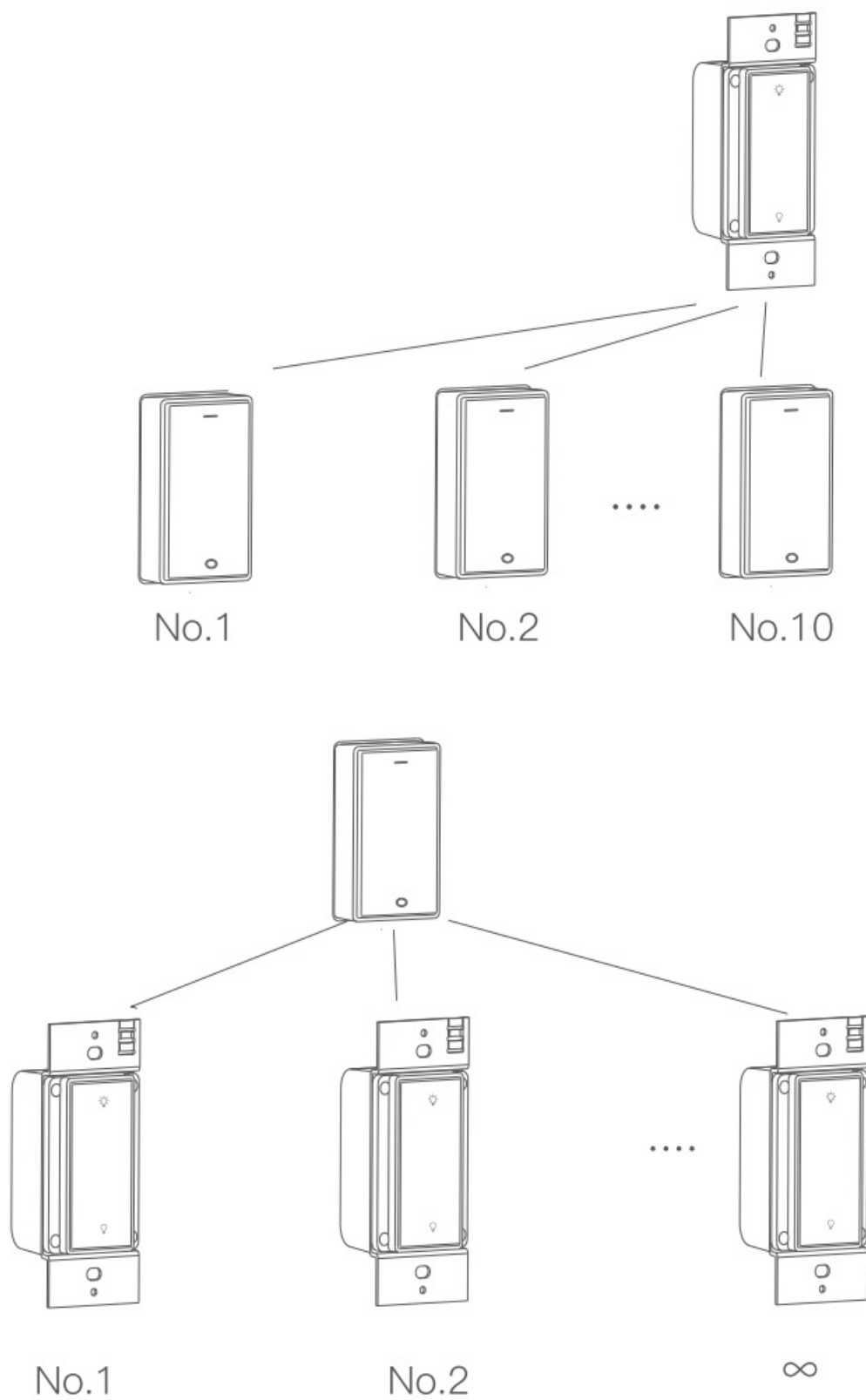

Matching Mode

1. Press the button for 10 seconds until the indicator light flashes blue.

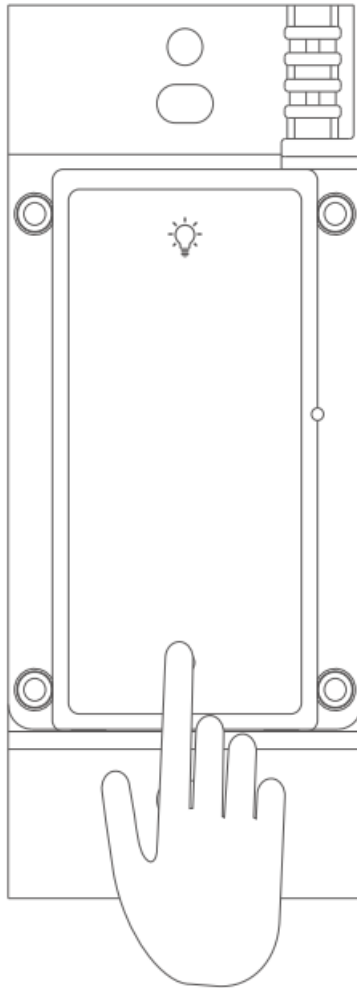

2. Press any button on the remote switch once.

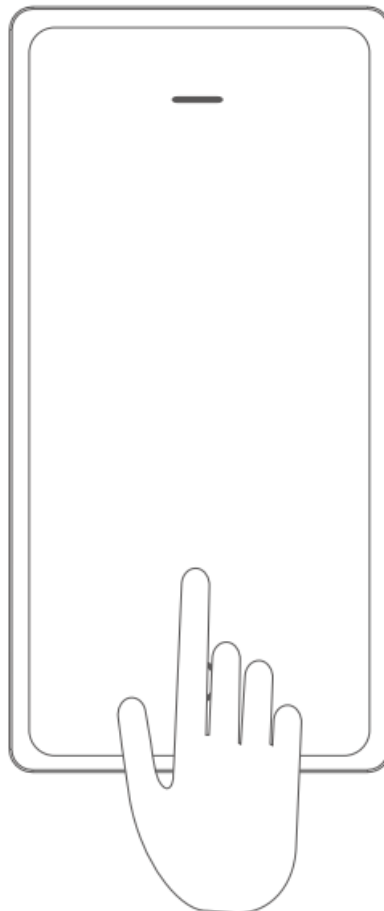

3. The light is off to indicate a successful pairing.

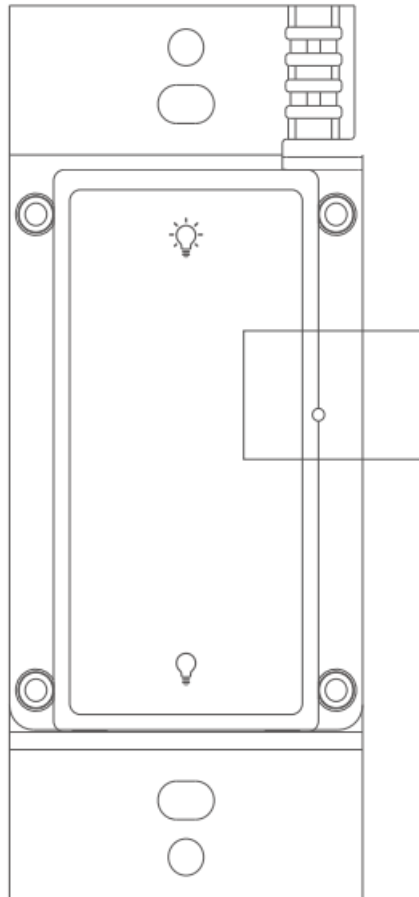

Removing Matching Mode

1. Press the button for 10 seconds until the indicator light flashes blue.

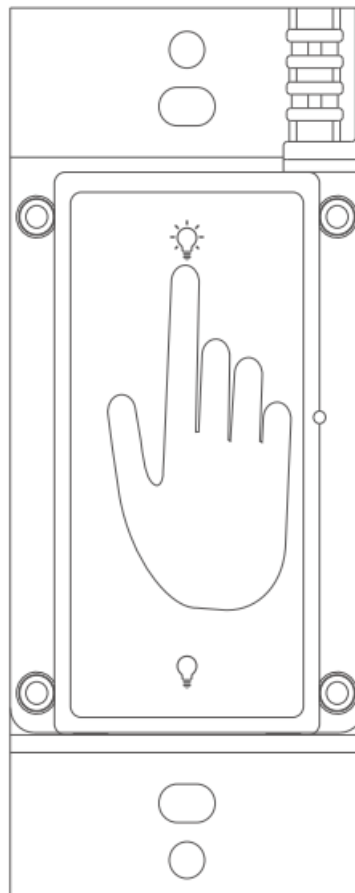

Download App and Register

Download the ORVIBO Home App

1. Scan the QR code to download the ORVIBO Home App.

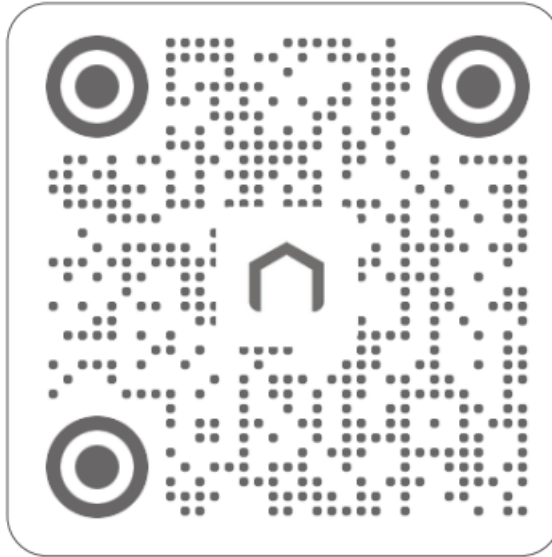

ORVIBO Home App

<http://www.orvibo.com/software/365.html?id=691>

2. Go to the App Store or Google Play to download the ORVIBO Home App.



Register

Launch the ORVIBO Home App and register a new account or log in.

Add Device and Configuration

Add Devices Automatically

1. Launch the ORVIBO Home App.
2. Turn power on at circuit breaker.
3. If the indicator light flashes white slowly, you can add devices automatically and use the ORVIBO Home App to complete all remaining steps.

Add Devices Manually

If the indicator light flash white slowly, you can add devices automatically.

1. Tap on “+” at the upper right corner at the Home page of the App.
2. Tap on “Scan QR code to add device”.
3. Scan the QR code.

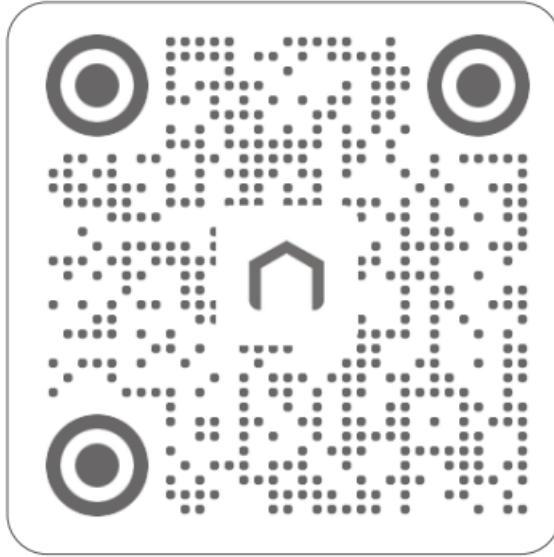

ORVIBO Home App

<http://www.orvibo.com/software/365.html?id=691>

4. Use the ORVIBO Home App to complete all remaining steps.

Note: This switch only supports 2.4GHz Wi-Fi.

If the indicator light does not flash white, press the button 4 times quickly, then press the button again until the indicator flashes slowly.

Utilize the App Feature

1. Timer/Countdown

You can edit the schedule by setting the time, sunrise, sunset countdown.

2. Holiday Mode

Lights turn on/off randomly within the set time when you are away to keep your home safe.

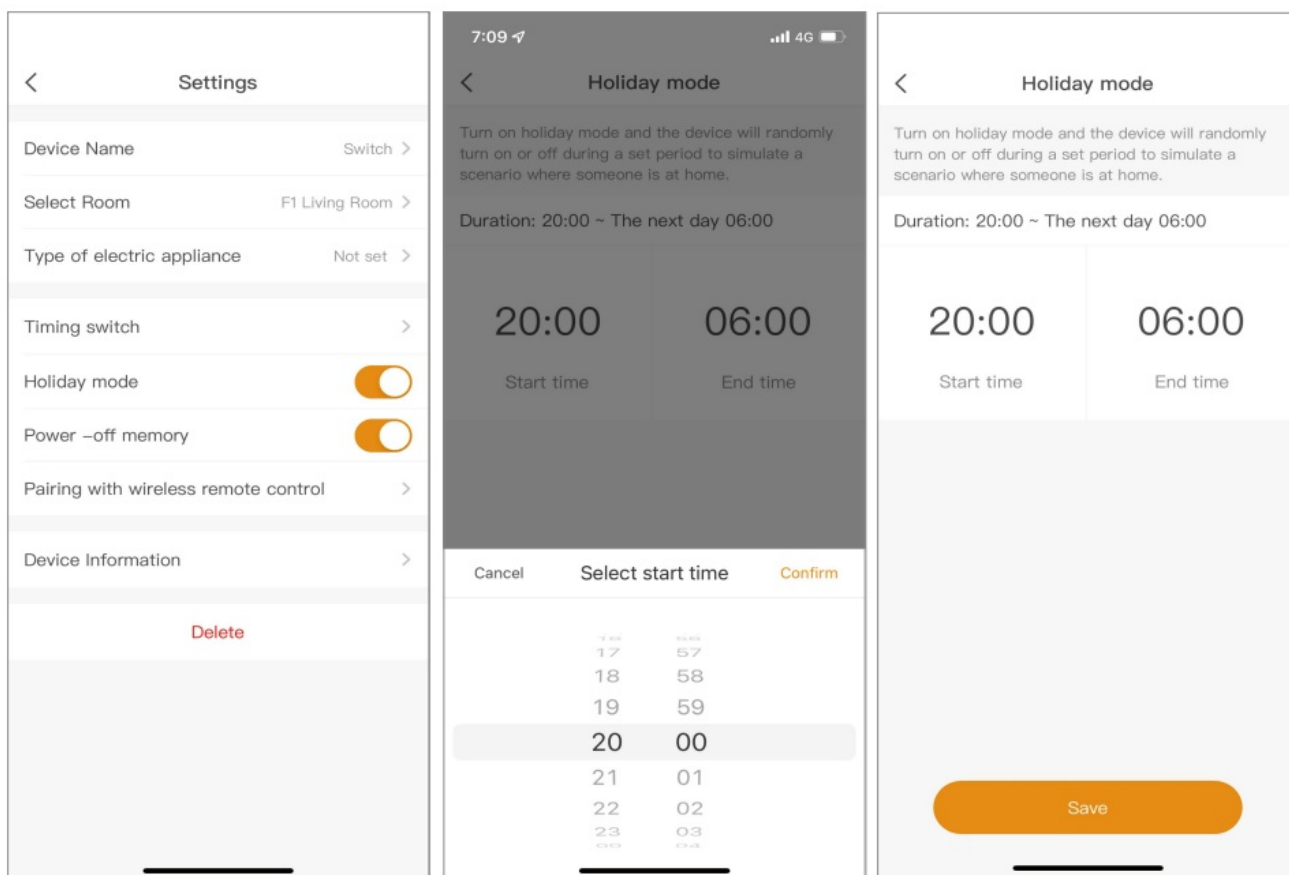

3. Control

Short press the switch icon to turn on/off the light.

Long press the switch icon 2 seconds for **dimming**.

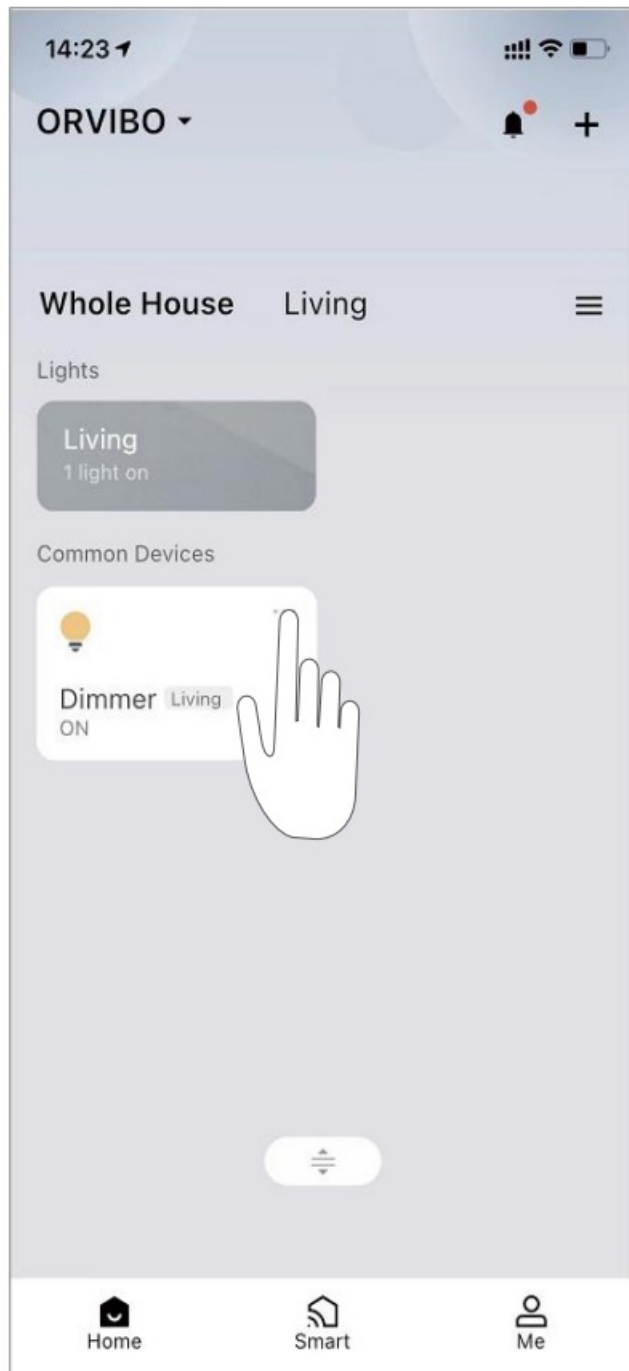

Note:

Different bulbs have different minimum brightness values, SO please set the minimum brightness to keep the light on during the first time.

Create Scenes

Smart scene control allows you to control multiple devices together at one touch via voice command or a scene timer.

1. Go to the scene page, and tap “+” to create a new scene.
2. Complete the new scene setting.

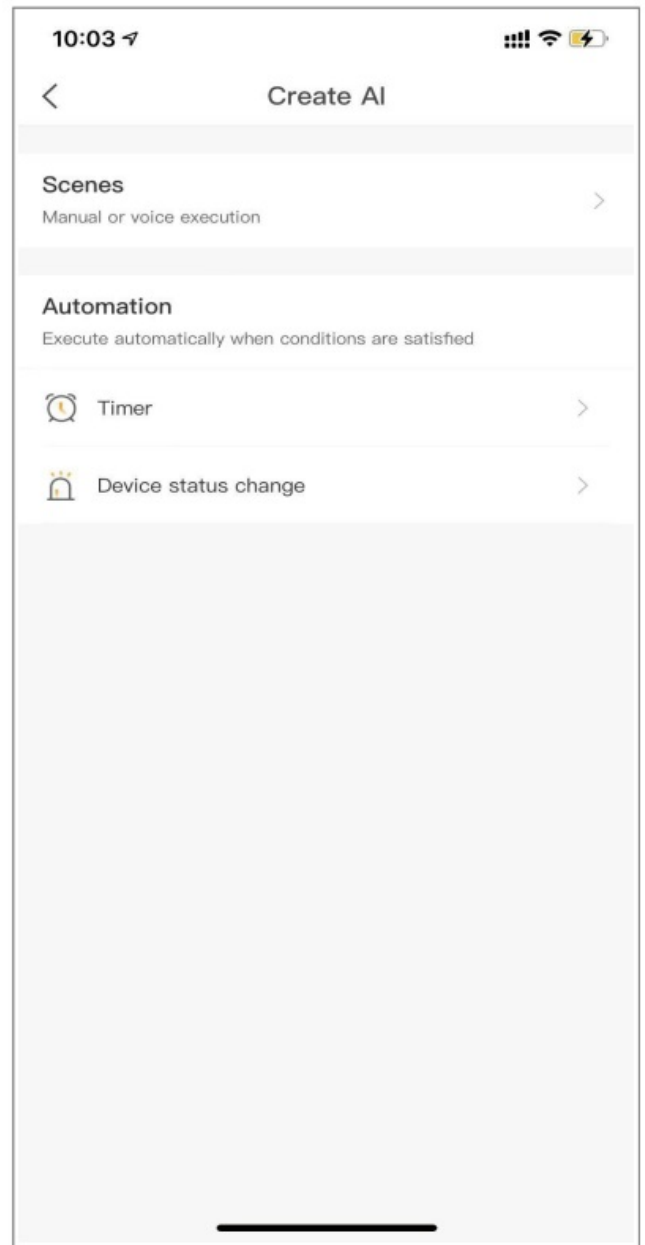
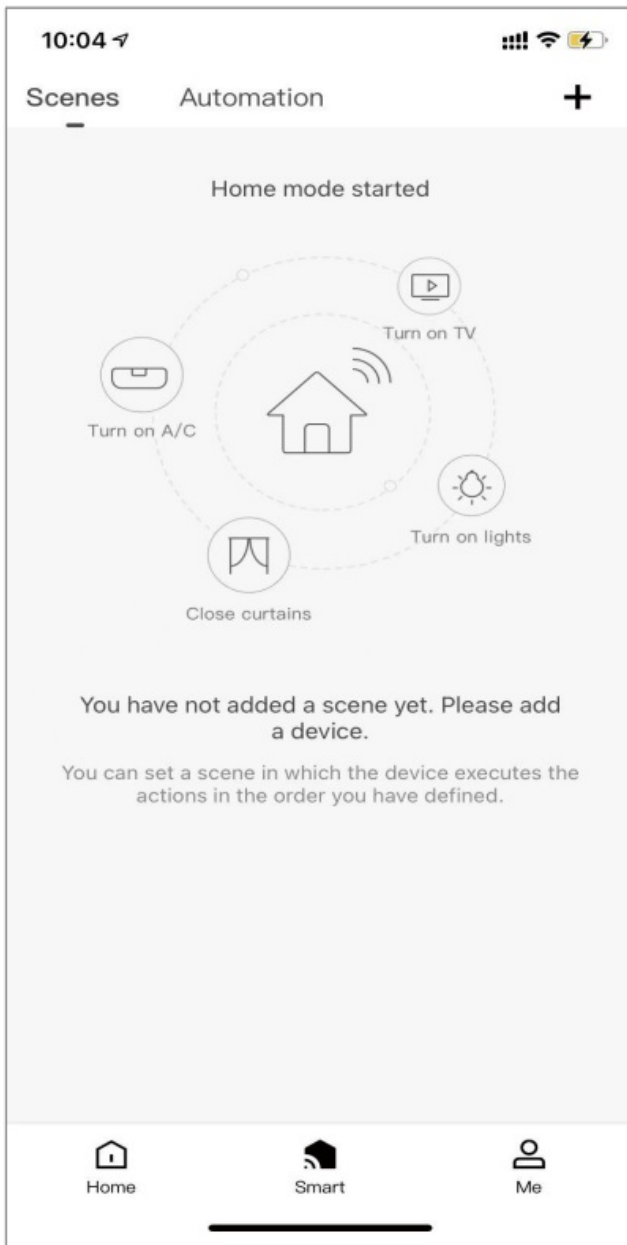

Voice Control Via Siri

You can enable Siri voice control with Apple devices.

Set Siri Shortcuts.

Go to "Me", find "Siri Shortcuts".

Click "Add to Siri" to customize your voice control from your Apple devices to home Appliances.

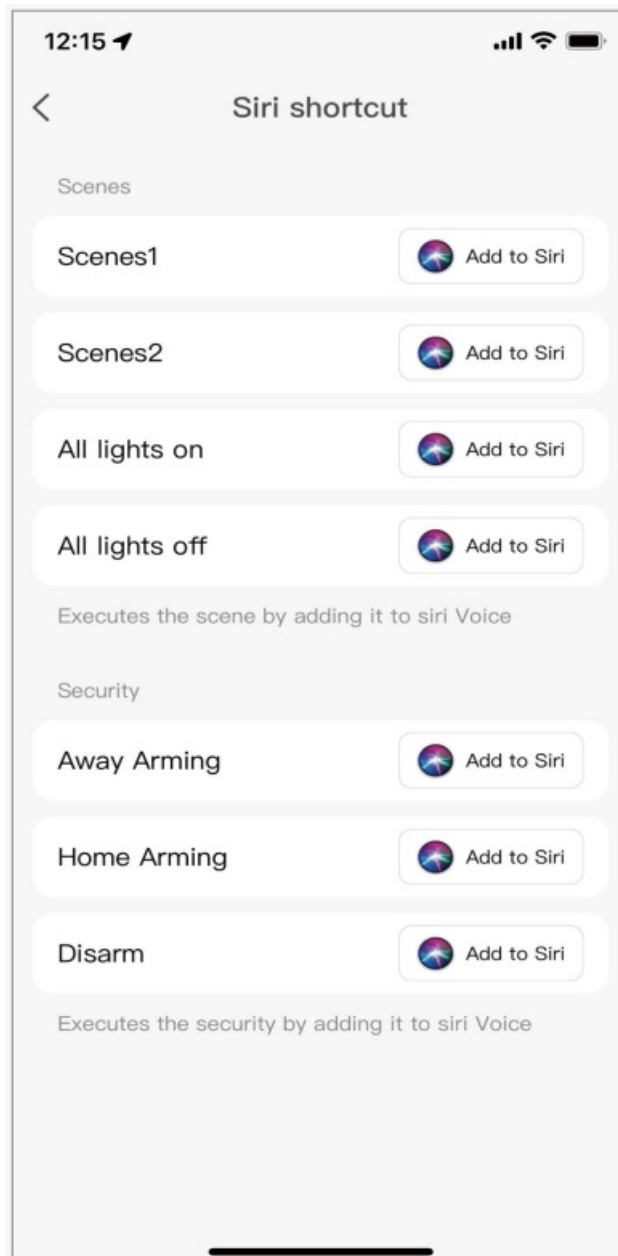

Note : Siri only works with scene.
Siri Voice command starts with “Hey, Siri.”.....

Support Amazon Alexa and Google Home

1. Link ORVIBO to Amazon Alexa/Google Assistant

Launch the ORVIBO Home App, Find the guide via this path: “Me”—>”Intelligent voice” —>”Smart speaker service”, you can choose Amazon Alexa/Google Home for detailed instructions.

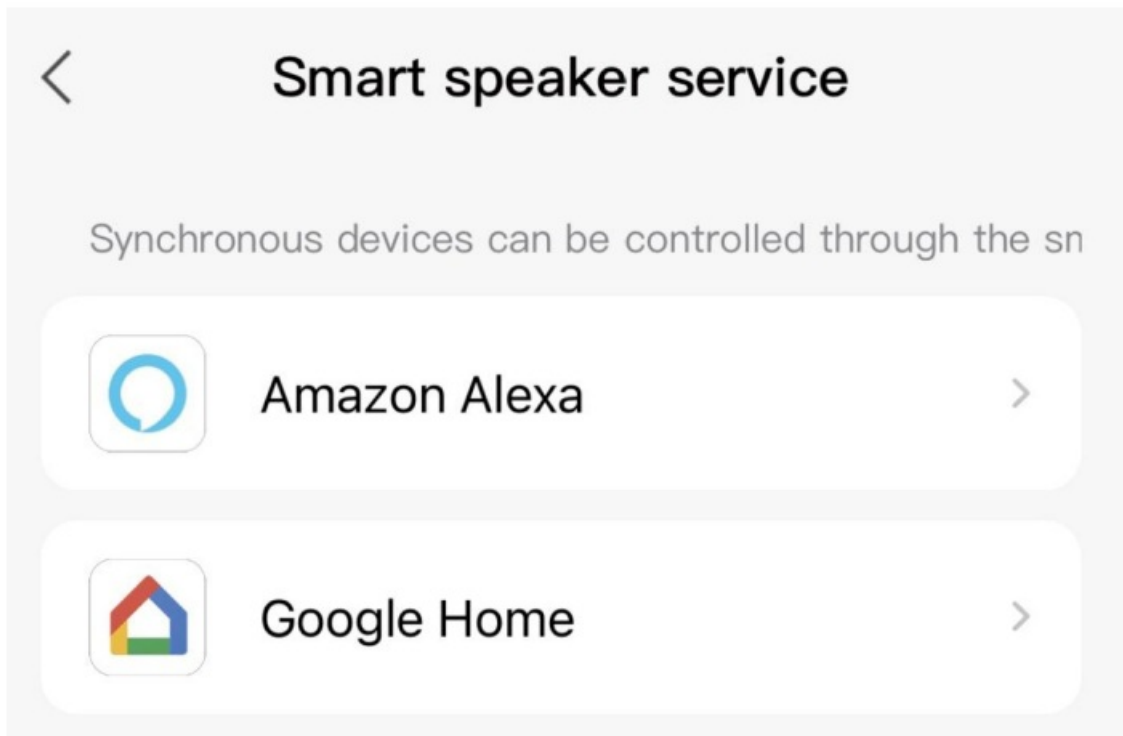

2. Control by Amazon Alexa/Google Assistant

Voice command try this..

AMAZON ALEXA

Alexa, turn off the lights

Alexa, turn off the lights

Google Assistant

Hey Google, turn on the lights

Hey Google, turn off the lights

Set Up with Matter



You can integrate this device into any Matter ecosystem you prefer for controlling by its App or setting up routines with other matter devices.

How to Set Up:

A Matter—supported controller and smart home app of the same ecosystem are required.

1. Turn on Bluetooth on your phone.
2. Open the smart home app and scan the provided Matter QR code on the switch or the one attached to the user manual.
3. Follow the instructions in the app to complete setup.

Note: Setup processes may vary between different ecosystems.

Failed to Set Up”?

1. Try to connect your phone to a stable 2.4GHz Wi-Fi network with internet access instead of a bGHz network.
2. Turn off, then turn on the power to restart the device
3. Refer to the FAQ for detailed instructions: <https://www.orvibo.com/en/support/supportFags.html>



<https://www.orvibo.com/en/support/supportF>

4. For technical support, contact: support.us@orvibo.com

FAQ

1. The light is not ON.

- a. Light bulb(s) burned out
- b. Breaker is OFF or tripped
- c. Light not properly installed
- d. Wiring error

2. How to reset the device?

You can reset after the installation completed. Quickly press the turn off button repeatedly for 4 times and then press the turn off button till the white light flashes slowly indicating the device is reset successfully and ready to be configured.

3. **Why does the lamp appear dim or flickering?**

Some brand lamps flicker or dim if the power of lamp is low. This phenomenon is related to the structure and drive of the lamp, and is not a switch quality problem. You can replace lamps with higher power or connect safety capacitors in parallel at both terminals of the lamp.

4. Why can't find the switch when add it? a. Confirm whether the switch enters the configuration state. b. Re—power the power of switch and try again.

Warranty Range And Duration

One year warranty applies to most ORVIBO products unless specified at the time of purchase. Accessories included with the main device and batteries have a warranty of six months when buying ORVIBO products, the product warranty remains measured from the time it was bought by the original owner. Any other promises made by dealers beyond the guarantee of ORVIBO, ORVIBO will not assume any liability. The following cases do not belong to free repair scope and ORVIBO will provide paid services. Please note. Fill to provide warranty card and related sales invoices. Cleaning of product and wear loss under normal circumstances such as natural loss of casing, inserting components, aging and wear. Any product failure or damage caused by installation, usage maintenance, and storage that are not in accordance with usage instructions. Alter or tear up barcode on products or warranty card without authorization. For those beyond change or warranty period. Product serial number or type on warranty card does not match the product itself. Without getting the permission of ORVIBO, change its inherent structure circuit privately, or dismantling or modifying without authorization. Product damage caused by accident, human abuse/misuse, such as output short circuit, high—voltage input, overload work, high temperature, water inflow, mechanical damage, broken serious oxidation or rusty and etc. Damage caused by transportation loading and unloading on the way of return for repair. Product failure or damage caused by force majeure such as earthquake, fire, flood lightning and so on. Product failure or damaged caused by any problem other than product design, technology, manufacturing, quality and others. Accessories are not included in free repair scope. This regulation shall come into effect since the issuing date. ORVIBO will keep the final interpretation right and revise.

FCC

FCC Statement

This device complies with part 15 of the FCC Rules.

Operation is subject to the condition that this device does not cause harmful interference.

1. this device may not cause harmful interference.
2. this device must accept any interference received, including interference that may cause undesired operation.

Any changes or modifications not expressly approved by the party responsible for compliance could void the user's authority to operate the equipment.

Warning: Changes or modifications not expressly approved by the party responsible for compliance could void the user's authority to operate the equipment.

Note: This equipment has been tested and found to comply with the Notice: This equipment has been tested and found to comply with the limits for a Class B digital device, pursuant to Part 15 of the FCC Rules.

These limits are designed to provide reasonable protection against harmful interference in a residential installation. This equipment generates, uses, and can radiate radio frequency energy and, if not installed and used in accordance with the instructions, may cause harmful interference to radio communications. However, there is no guarantee that interference will not occur in a particular installation.

If this equipment does cause harmful Interference to radio or television reception, which can be determined by turning the equipment off and on, the user is encouraged to try to correct the interference by one or more of the following measures:

- Reorient or relocate the receiving antenna.
- Increase the separation between the equipment and receiver.
- Connect the equipment into an outlet on a circuit different from that to which the receiver is connected.
- Consult the dealer or an experienced radio/TV technician for help.

FCC ID: 2AWF7-A11
FCC ID: 2AL7Q-EU1254



Documents / Resources

<div><p>Smart Dimmer Remote & Bracket Kit</p><p>User Manual</p></div>	<p>ORVIBO DS Smart Dimmer Switch with Remote Control [pdf] User Manual DS Smart Dimmer Switch with Remote Control, DS, Smart Dimmer Switch with Remote Control , Dimmer Switch with Remote Control, Remote Control</p>
--	--

References

- [ORVIBO FAQs| Register Product, FAQs, Video & Download, Warranty & Return, Contact Us, Coupons & Giveaways](#)
- [User Manual](#)