



ORTECH OE-316 LED Running Man Exit Sign Instruction Manual

[Home](#) » [Ortech](#) » ORTECH OE-316 LED Running Man Exit Sign Instruction Manual 

Contents

- [1 ORTECH OE-316 LED Running Man Exit Sign](#)
- [2 WARNING](#)
- [3 CAUTION](#)
- [4 INSTALLATION GUIDE](#)
- [5 Documents / Resources](#)
- [6 Related Posts](#)

ORTECH

ORTECH OE-316 LED Running Man Exit Sign



WARNING

WARNING — THE INSTALLATION MUST BE CARRIED OUT BY A QUALIFIED ELECTRICIAN.

1. LED Exit Signs are for INDOOR USE ONLY
2. Please keep the LED Exit Signs away from any corrosive substance, and please use dry cloth when you clean it
3. LED Exit Signs can only be installed by a qualified electrician
4. Before installation or maintenance, please disconnect the power to prevent electric shock

Application Notice



1. All electrical connections MUST be in accordance with local codes, ordinances and the National Electric Code
2. Equipment should be mounted in locations and at heights where it will not be subjected to tampering by unauthorized personnel
3. The use of accessory equipment is not recommended by the manufacturer. DO NOT use the LED Exit Sign other than intended use
4. DO NOT mount in hazardous locations or near gas or electric heaters. DO NOT let power cords touch hot surfaces
5. Disconnect power at fuse or circuit breaker before installing or servicing
6. Allow battery to charge for 24 hours before first use

CAUTION

PLEASE READ THE INSTRUCTIONS BEFORE COMMENCING INSTALLATION AND RETAIN FOR FUTURE REFERENCE. Electrical products can cause death or injury, or damage to property. If in any doubt about the installation or use of this product, consult a competent electrician.

INSTALLATION GUIDE

Mounting Instruction

THE FIXTURE IS SUITABLE FOR WALL, SIDE, AND CEILING MOUNTING

1. Open front cover and assemble 2pc lamp heads on the frame
2. Knockout appropriate mount screw hole and cable hole, mount back plate on the wall after feeding building AC Supply Cable into back plate (see Fig.1)

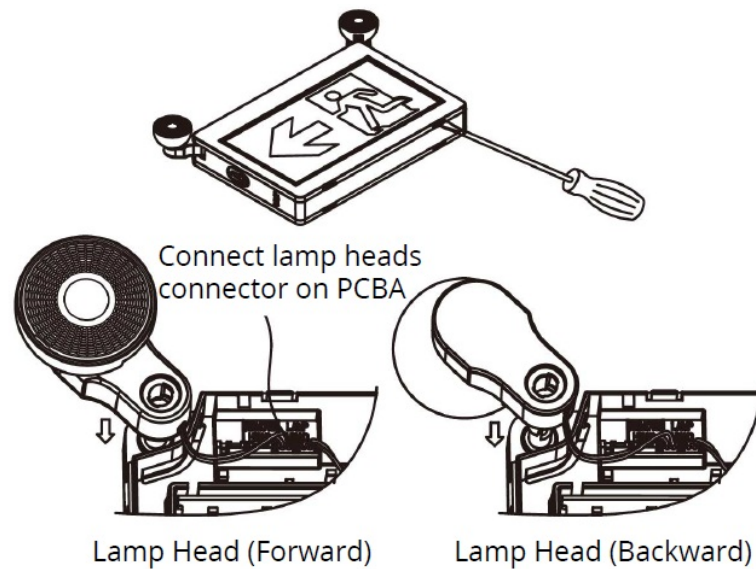

Assembly Lamp Heads

1. Open the front cover by a flat screwdriver
2. Insert the lamp heads at the corners of the main frame. Select the direction of the lamp head before inserting
3. Connect male connector on lamp head to female connector on PCBA
3. For ceiling and side mounting purposes, remove the mounting hole cover on the top or side of unit, and assemble the canopy (see Fig.2, Fig.3, Fig.5, and Fig.4)

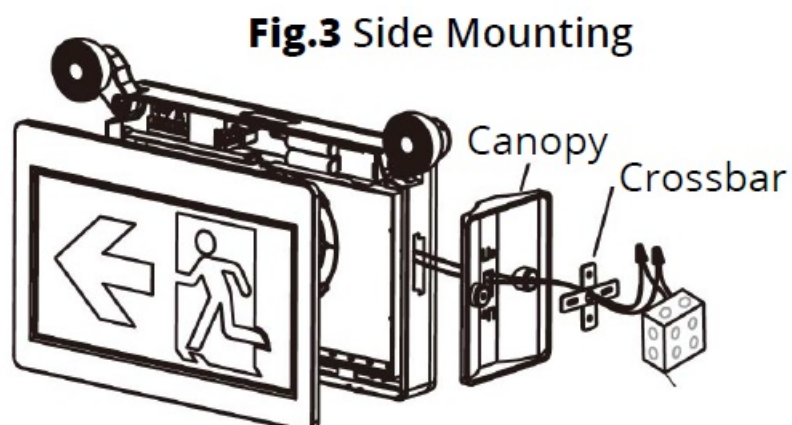
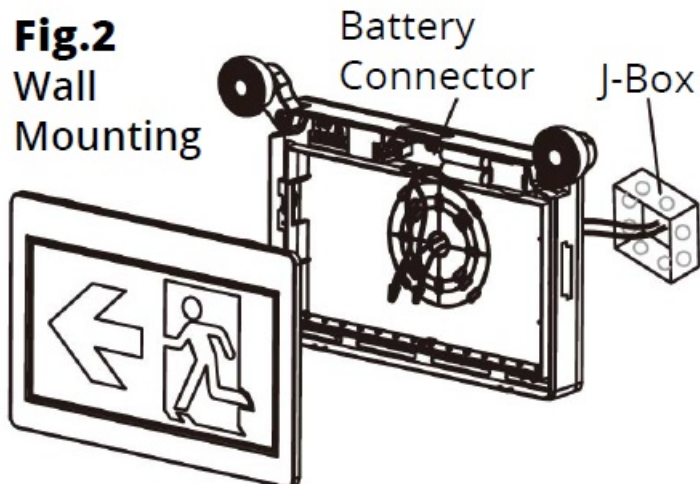

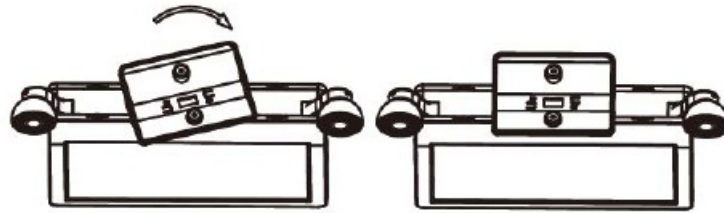
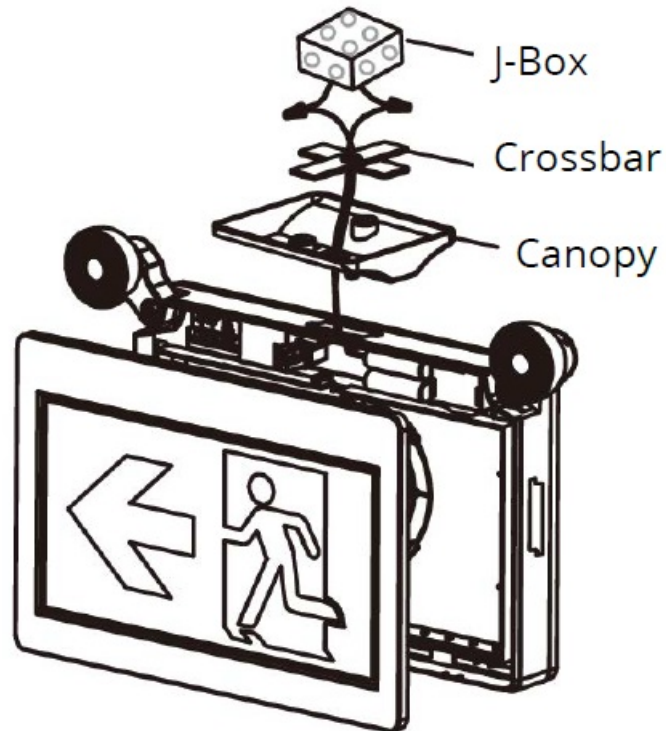
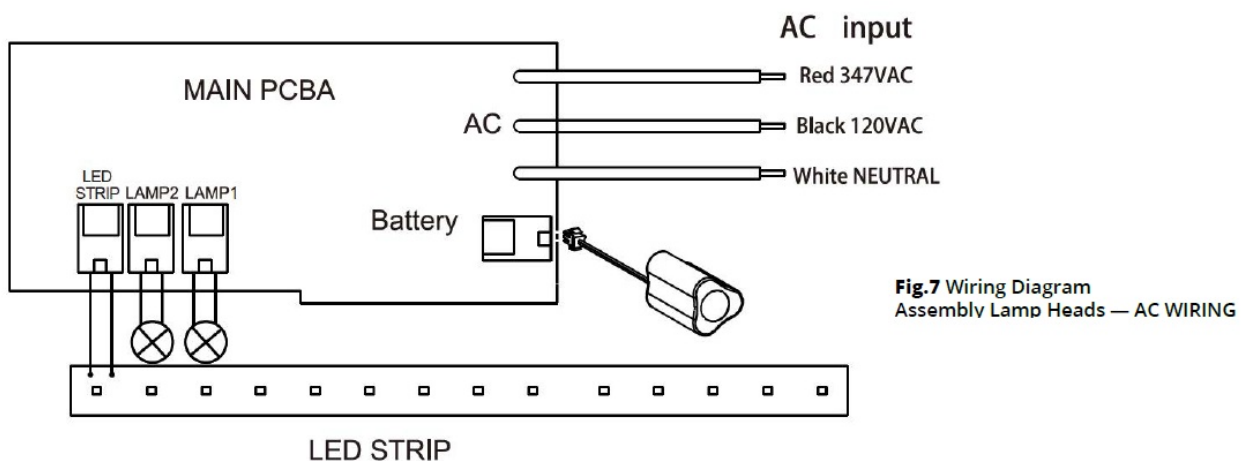

Fig.4 Canopy Assembly

Fig.5
Ceiling
Mounting



4. Attach crossbar to the junction box, set the longer blade of crossbar touching the J-Box
5. Route the proper wires through the mounting hole out of the housing
6. Make electrical connections inside the J-Box using the wiring diagram (see Fig.7)



Connect the WHITE wire to NEUTRAL. If using 120V, connect the BLACK wire to the hot lead. if using 347V, connect the RED wire to the hot lead. Cap unused lead.

7. Push excess wire into J-Box, use screws to tighten canopy to the crossbar so the canopy is securely fastened and tight against the wall
8. Attach battery connector to PC Board, restore front cover on the unit, adjust the position of lamp heads as

needed

9. If the pictogram direction assembled is not suitable, change the pictogram direction or replace the pictogram and then insert it into the diffuser (see Fig.6)

Fig.6
Change
direction of
pictogram

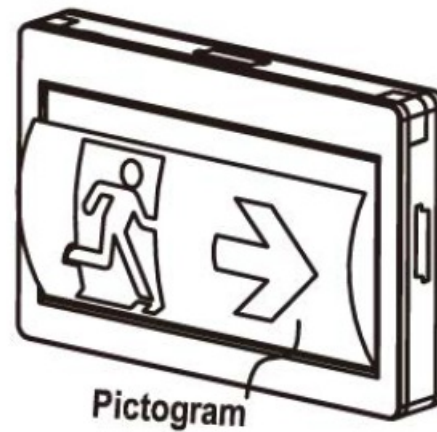

ORTECH reserves the right to modify at any time, without notice, any or all of our product's features, designs, components and specifications to meet market changes.

info@ortechindustries.com
www.ortechindustries.com

Documents / Resources

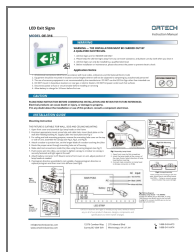

[ORTECH OE-316 LED Running Man Exit Sign](#) [pdf] Instruction Manual
OE-316, LED Running Man Exit Sign, Running Man Exit Sign, Man Exit Sign, OE-316, Exit Sign