

ORION DR13-A805C 9.7 Inch LED Viewfinder Field Monitor



# ORION DR13-A805C 9.7 Inch LED Viewfinder Field Monitor User Guide

[Home](#) » [Orion](#) » ORION DR13-A805C 9.7 Inch LED Viewfinder Field Monitor User Guide 

## Contents

- 1 ORION DR13-A805C 9.7 Inch LED Viewfinder Field Monitor
- 2 SAFETY INSTRUCTION
- 3 FCC RF INTERFERENCE STATEMENT
- 4 PRODUCT DESCRIPTION
- 5 INSTALLATION
- 6 DV BATTERY MOUNT PLATE
- 7 WIRING INSTRUCTIONS
- 8 SETTING MENU
- 9 ACCESSORIES
- 10 SPECIFICATIONS
- 11 TROUBLESHOOTING
- 12 YEAR LIMITED WARRANTY
- 13 Documents / Resources
  - 13.1 References



ORION DR13-A805C 9.7 Inch LED Viewfinder Field Monitor



## SAFETY INSTRUCTION

Follow this safety instruction to use the monitor properly and prevent damage.

**This safety instruction has “Warning” & “Caution” as below**

- Warning – If the user does not follow this instruction, it may cause serious damage to the user.
- Caution – If the user does not follow this instruction, it may cause slight damage to the user or cause some damage to the monitor.

Keep this user's guidebook for later use.

### Warning

Never remove the back cover and touch the inside of the monitor.  
If you need a service, please contact the service center.



Keep away the monitor from the direct sunlight and a heating appliance.



Never push objects of any kind into this product as they may result in a risk of fire or electric shock.



Connect the power cord to the wall outlet tightly. If the power cord or plug are defective and the wall outlet is not tight, please do not use them.



Do not install this monitor on the outside and near water. It may cause damage to the product, electric shock and fire.



For cleaning do not use liquid cleaners. Never touch the power plug with wet hands.



When lightning and thundering, unplug the monitor from the wall outlet and never touch it.



Unplug this product from the wall outlet, when it does not operate for a long time.

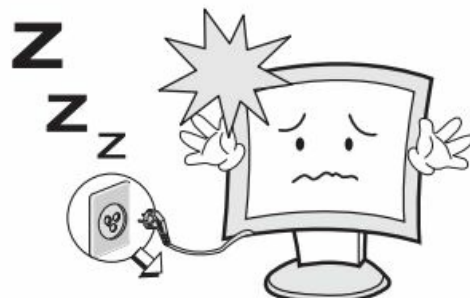

When smoking and noising from the monitor, unplug the product from the wall outlet and contact a service center.

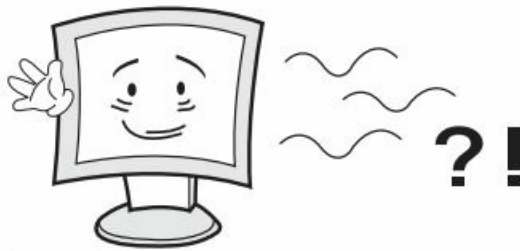

#### **WARNING : How to fix**

- Do not open this product as it contains high voltage inside.
- It may create an electric shock.
- If the user disassembles and removes the back cover, it does not make sure to make up for the damages and do a service and exchange the monitor.

#### **Cautions**

Install this monitor some distance  
From the wall and do not install unless  
Proper ventilation is provided.



Place this product on a stable place.  
If not, it may fall, causing serious  
Damages to the monitor and people.



The openings must not be blocked by  
curtain, rug or other similar surface.



When carrying this monitor, be careful  
not to damage the panel and drop it  
It may cause some trouble.



Before carrying the monitor, turn it off and Unplug the signal cables and the power cord from the wall outlet.



Take the power plug out from the wall outlet. Do not pull the cable. It may snap the inner-wires and cause overheating and fire.

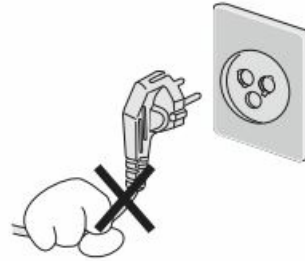

Install this monitor about 50cm far from the eyes and an angle of 0~15 degrees below eyes. Too close installation may cause having weak sight.

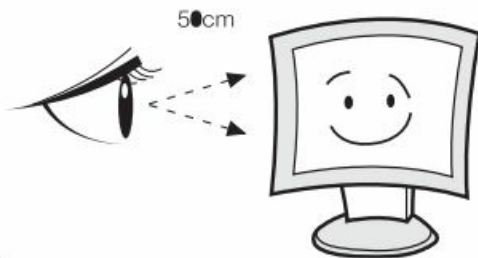

Do not press the LCD panel with hands or the sharpened material hardly.



For cleaning, unplug the monitor from the Wall outlet. Do not use the liquid cloth. Use the soft cloth.



Do not use the chemical liquid for cleaning. It may cause fading and breakage.



## FCC RF INTERFERENCE STATEMENT

### NOTE

This equipment has been tested and found to comply with the limits for a Class A digital device, pursuant to Part 15 of the FCC Rules. These limits are designed to provide reasonable protection against harmful interference in a residential installation. This equipment generates, uses and can radiate radio frequency energy and, if not installed and used in accordance with the instructions, may cause harmful interference to radio communications. However, there is no guarantee that interference will not occur in a particular installation. If this equipment does cause harmful interference to radio or television reception which can be determined by turning the equipment off and on, the user is encouraged to try to correct the interference by one or more of the following measures.



- Reorient or relocate the receiving antenna.
- Increase the separation between the equipment and the receiver.
- Connect the equipment into an outlet on a circuit different from that to which the receiver is connected.
- Consult the dealer or an experienced radio, TV technician for help.
- Only a shielded interface cable should be used.

Finally, any changes or modifications to the equipment by the user not expressly approved by the grantee or manufacturer could void the users authority to operate such equipment.

## DOC COMPLIANCE NOTICE

This digital apparatus does not exceed the Class A limits for radio noise emissions from digital apparatus set out in the radio interference regulation of Canadian Department of Communications.

## PRODUCT DESCRIPTION

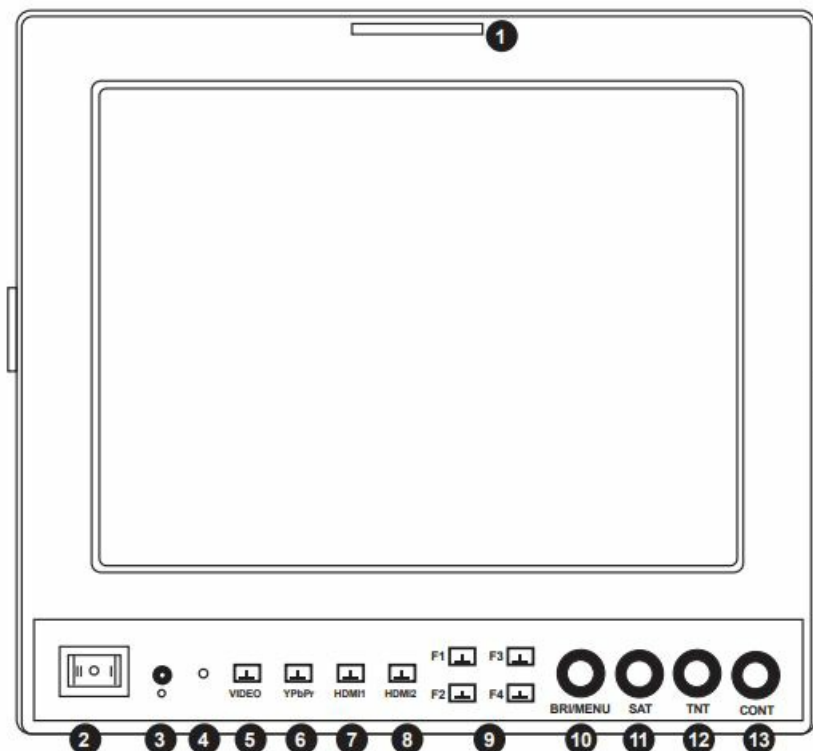

1. TALLY (indicator light)
2. Battery Power On / Off switch "II" is battery power, "O" is power off, "I" is DC power
3. Earphone jack
4. Power indicator light ON/OFF (Light turns to red when power on)
5. The VIDEO Indicator lights up when the signal switches to video state
6. YPbPr Indicator lights up when signal switch to the YPbPr state
7. **HDMI1** Indicator lights up when signal switch to HDMI1 state
8. HDMI2 Indicator lights up when signal switch to HDMI2 state
9. F1, F2, F3, F4
  - User-definable buttons
    - F1 Peaking
    - F2 False Color
    - F3 Exposure

- F4 Histogram

10. Knob BRI/M/SEL Press the knob to access the menu function, pressing the knob in the menu to return to the previous page or exit the menu.
  - Rotate knob to select an option
  - Default as Brightness function
11. Knob SAT/ADJ Press the knob to select main MENU options; rotate the knob to confirm the selection and adjust parameter values
  - Default as Saturation function
12. Knob TINT Default as Tint function
13. Knob CONTRAST Default as Contrast function

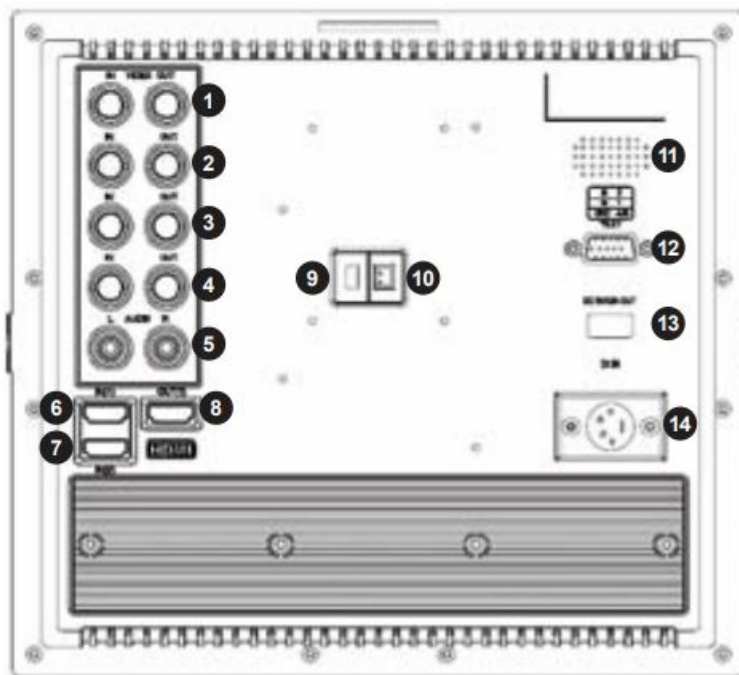

REAR VIEW

1. Video signal output/input
2. Y signal input/output
3. Pb signal input/output
4. Pr signal input/output
5. Audio (L/R) input
6. HDMI 1 signal input
7. HDMI 2 signal input
8. HDMI signal loop output
9. Mini USB input (Only for program upgrades, do NOT use if non-professionals)
10. Power cable interface (connecting to the battery plate)
11. Speaker
12. TALLY signal input
13. 4-pin XLR DC power input

	Pin Number	Signal
	1	GND
	2, 3	.....
	4	+12V

## INSTALLATION

### Installation of Sunshade Cover

Pushing to close / open sunshade from assigned round area when assembly/disassembly.(i.e. assembly instruction ② / disassembly instruction ①); otherwise assembly/disassembly failed, and even damaged.

### Assembly instructions

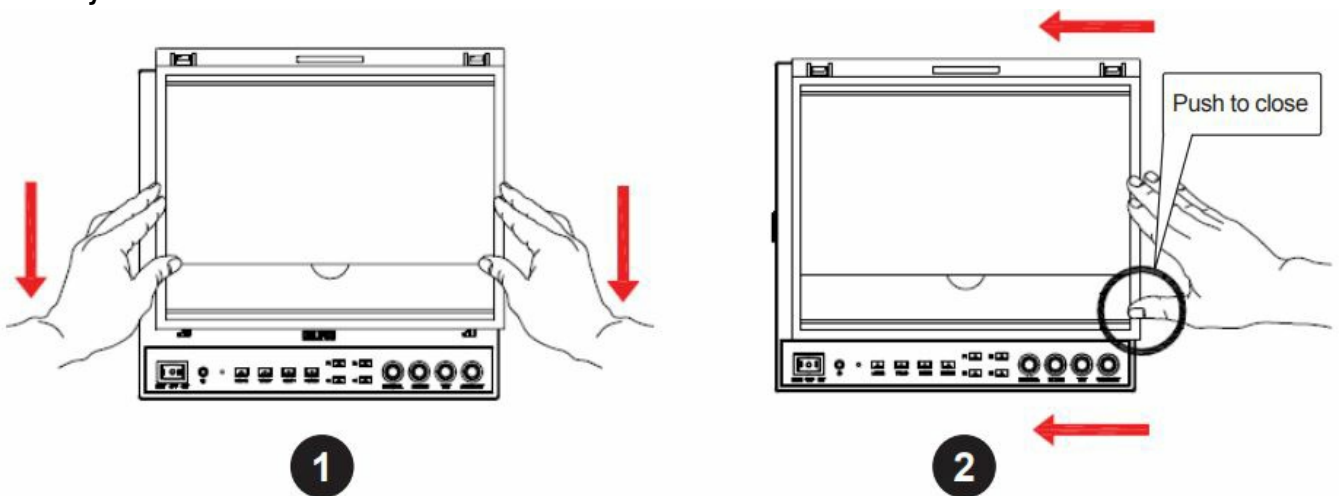

### Disassembly instructions

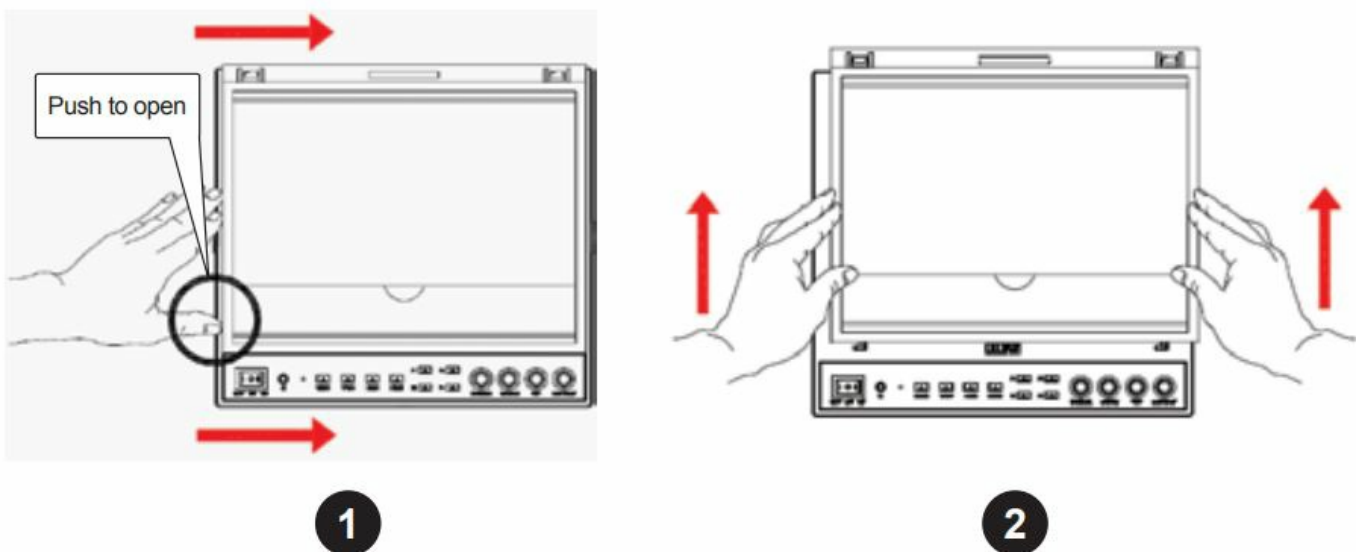

## DV BATTERY MOUNT PLATE

### Standard Mounts Precess



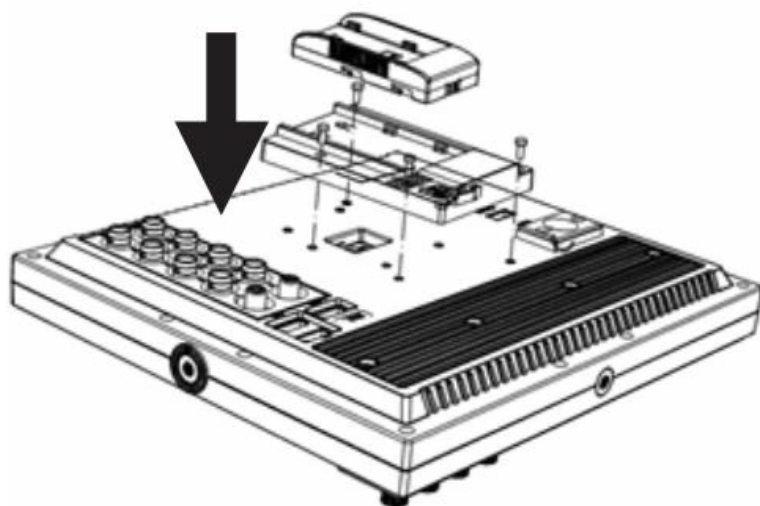

Following two types of battery plates are suitable for this device, model F970 & LP-E6.



F-970



LP-E6

### DV Battery Mount Plate Specification

1. Model F970 for battery of SONY DV DCR-TRV series, DCR-TRV E series, VX2100E PD P series, CCD-SC / TR3 / FX1E / HVR-AIC, HDR-FX1000E, HVR-Z1C, HVR-V1C, FX7E F330
2. Model LP-E6 for battery of Canon DSLR 5D Mark II / EOS7D / EOS60D

### V-mount battery plate (optional)

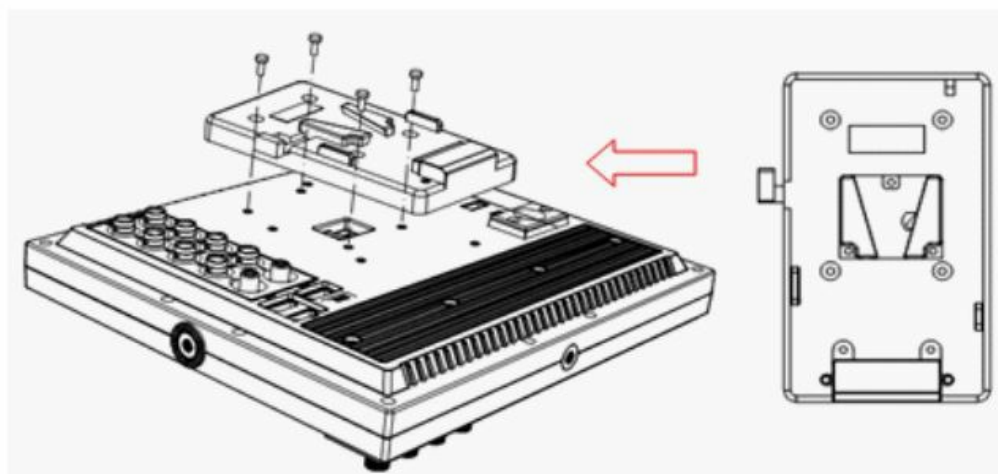

BB-IDX

### Anton Bauer mount battery plate (optional)

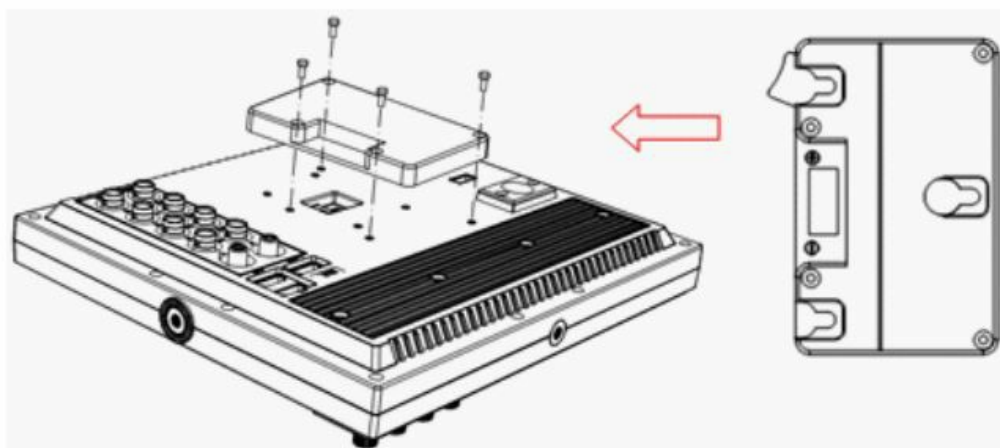

BB-AB

## WIRING INSTRUCTIONS

### Power & TALLY cable

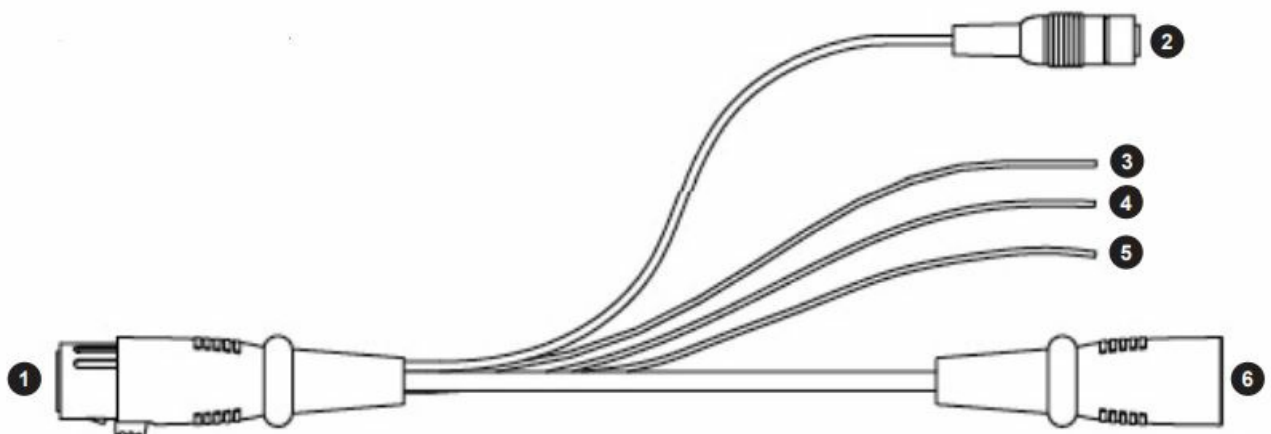

1. XLR (M) connector: to connect the XLR connector on device.
2. DC Power adapter connector.
3. Red: for TALLY red light connector. (0 ~ 0.5V or short to No 5)
4. Green: for TALLY green light connector. (0 ~ 0.5V or short to No 5)
5. Black: for grounding.
6. XLR (F) connector: for the XLR adapter.

## SETTING MENU

Before setting the functions, please make sure the device is connected correctly. When power on, press the BRI/M/SEL knob on the device, and function menus will pop-up on the screen. After confirming the option value, then press the BRI/M/SEL knob to return to the previous, and press the BRI/M/SEL knob again to exit the menu settings. BRI/M/SEL knob: to select an option. SAT/ADJ knob to select the main menu, adjust option values and confirm the selection.

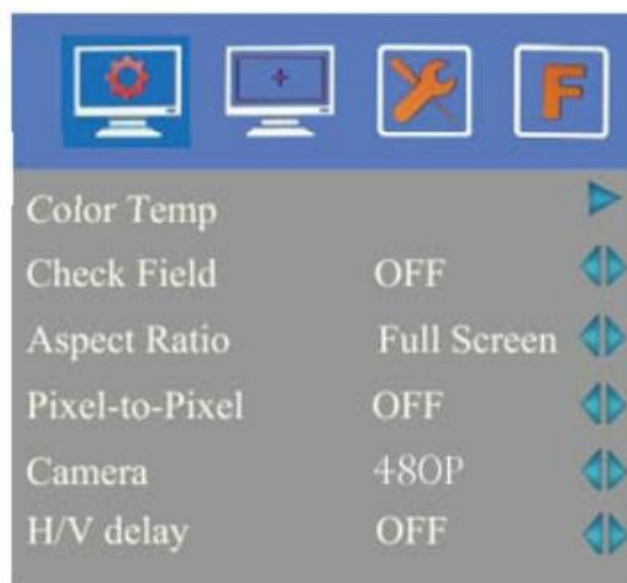

- **Color Temp**
  - Settings: User, 6500° K, 7500° K, 9300° K.
- **Default: User**

- In User mode, user can adjust RGB gain and bias. User mode is recommended for professional users only.
- **Check Field**
  - Settings: Off, Mono, Red, Green, Blue
- **Default: Off**
  - Setting Mono, Red, Green or Blue display color
- **Aspect Ratio**
  - Settings: 4:3, 16:9, Full Screen.
- **Default: 4:3**
  - Setting screen aspect ratio: 4:3, 16:9 and fullscreen

## **Pixel-to-Pixel**

- Setting: On, Off
- Default: Off

Shows the original picture with 1:1 pixel mapping, if the picture is larger than the monitor's LCD resolution, the center part of the picture is shown. BRI / M / SEL knob operation you can see part of the picture is not completely displayed.

## **Camera**

- Settings: 480P, 1080I
- Default: 480P

For 480P screen pixel DSLR camera, such as Canon 5D II camera For 1080I screen pixel DSLR camera, such as Canon 5D III camera

## **H/V delay**

- Settings: Off, H&V delay, V delay, H delay.
- Default: Off

H/V Delay allows you to check the outside signal of the active picture area. This mode is for broadcast professionals.

## **Underscan**

- Settings: On, Off
- Default: Off

HDMI monitor can not display the best resolution pixel-to-pixel mode, the output resolution is smaller than the display resolution, the display will appear black side of this situation is called HDMI underscan; Conversely, the display can not display the entire contents of the image that HDMI overscan. Underscan/overscan principle each pixel point average tensile or compression so that the image can be completely displayed on the screen.

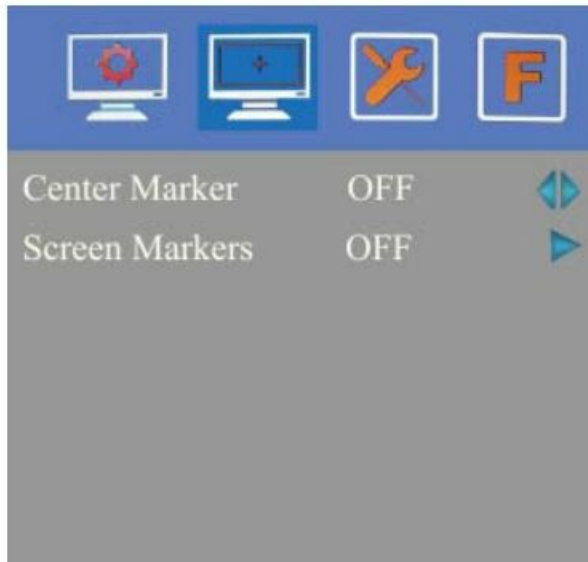

### Center Marker

- Settings: On, Off
- Default: Off

Set to display centre marker or not.

### Screen Markers

- Settings: Off, 95%, 93%, 90%, 88%, 85%, 80%
- Default: Off

The box-shaped mark display on or off can be set in accordance with the desired ratio.



### Language

- Settings: English, Chinese
- Default: English
- Set English / Chinese switch.

## **PIP**

- Settings: Small, Medium, Large, PBP, POP
- Default: Small

PIP top life of the display default, Set small, medium, and large screen in screen, as well as painting outside source adjustments and interchangeable, the small screen, screen and big screen, you can also adjust the display position , respectively, for the upper left , upper right , lower left and lower right. The shortcut key of the PIP function will be available after setting in the menu.

## **Input Format OSD**

- Settings: 5s, 10s, 15s
- Default: 5s

The menu signal display period displays the length of time can be set according to individual needs.

## **LOGO**

- Settings: On, Off
- Default: Off
- Boot LOGO settings.

## **Freeze Input**

- Settings: On, Off
- Default: Off

The lock screen displays the current mode.

## **Peaking**

- Settings: Mono, Color
- Default: Mono
- Adjust Mono or Color.

## **Assistant Func.**

- Settings: Manual, Auto
- Default: Auto

Auxiliary functions automatically. Automatically set to adjust the brightness, contrast and hue corresponding menu function can also be set manually.

## **Manufacturer Default**

- Settings: OK, Cancel
- Default: Cancel

When on the picture shows a size error, the “Manufacturer default” operation of the equipment, which restores the factory settings, the previous record on the device no default to factory settings. Reverse the SAT / ADJ knob to select “OK”

### ISP

For program upgrades, Please reboot your computer if pressed accidentally.

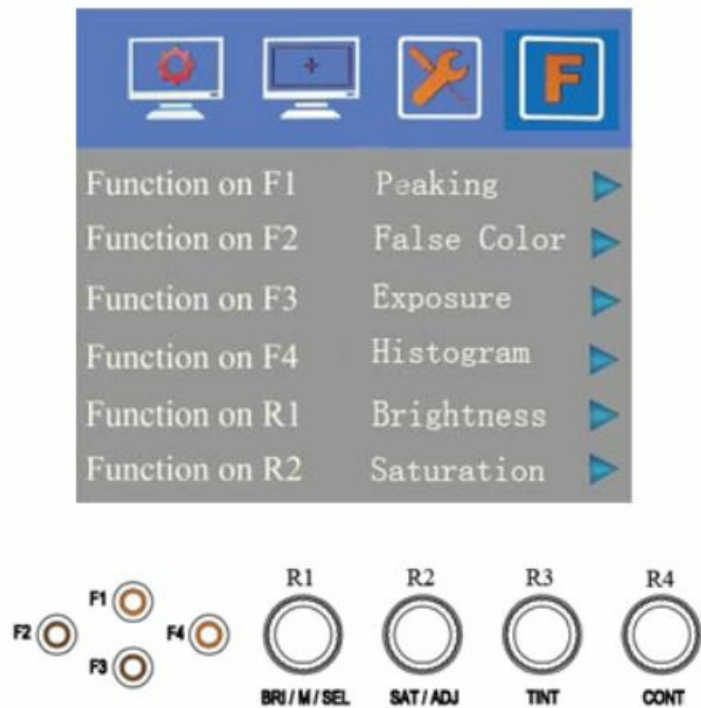

The function of buttons and knobs can be customized by users' needs. Functions of F1-F4 buttons can also be customized: Aspect Ratio, Center Marker, Screen Marker, Check Field, Color Bar, Camera, PIP, Zoom, Pixel-to-Pixel, Freeze Input, Underscan, H/V delay, Peaking, False Color, Exposure and Histogram. Long keep press any F1-F4 button to pop-up the shortcut menu when the screen without a menu. As follows (item selected default as blue font):



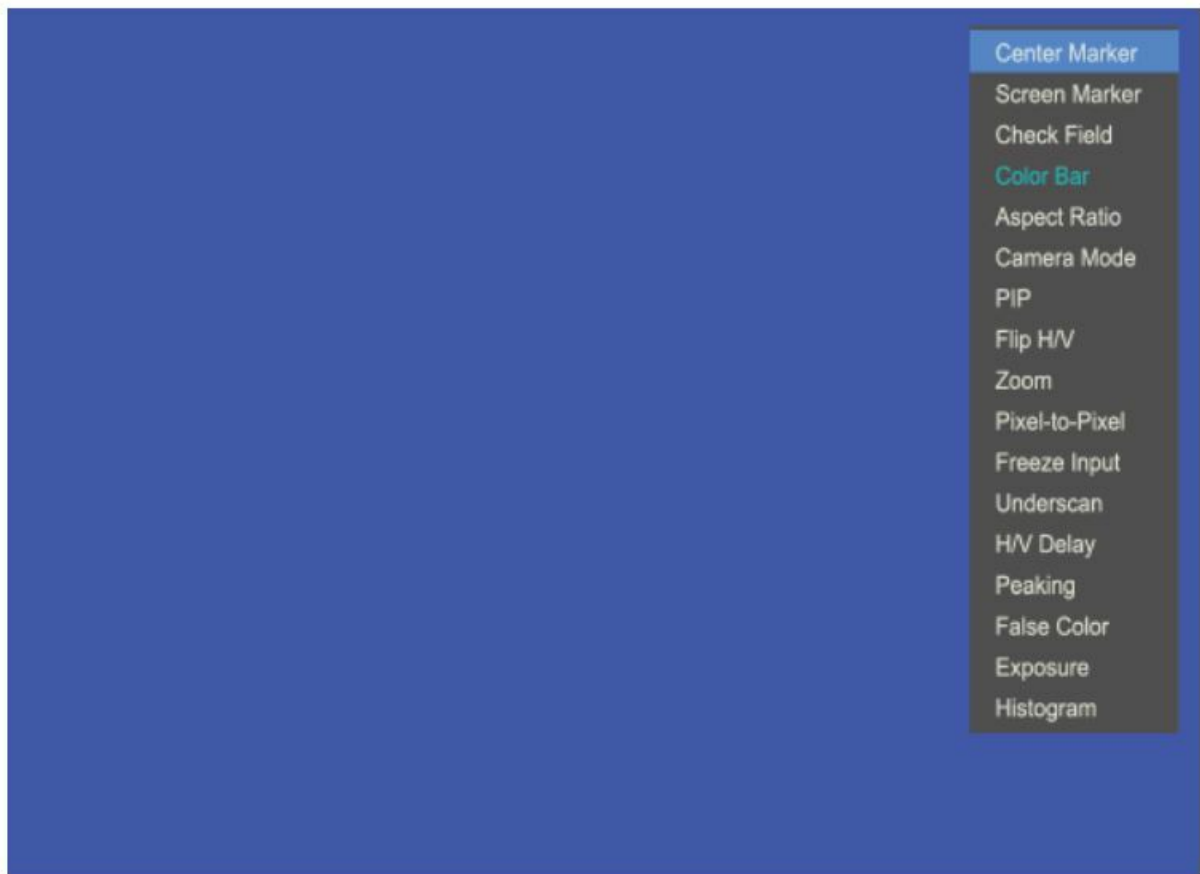

Functions of R1-R4 buttons can also be customized: Contrast, Brightness, Saturation, Tint, Volume, Sharpness and Back Light.

## ACCESSORIES

### Standard Accessories



NO.	Name of Each Part	Qty
①	Flexible folding Sun Shade Cover	1 piece
②	Battery plate (F-970 / LP-E6)	2 pieces
	Plate Bracket is attached to the Monitor	1 piece
③	HDMI Type A-A	1 piece
④	TALLY Connector	1 piece
⑤	DC12V Power Adapter (XLR Connector)	1 piece
⑥	12V DC adapter	1 piece
⑦	Operation Manual	1 copy

### Optional Accessories



NO.	Name of Each Part	Qty
①	Gimbals Bracket	1 piece
②	Anton Bauer Mount Battery Plate, BB-AB	1 piece
③	V-mount Battery Plate, BB-IDX	1 piece

### SPECIFICATIONS

Model No.	VF972HC
Screen Size	9.7" LED backlit
Max. Resolution	1024 x 768, support up to 1920 x 1080
Brightness	400cd/
Contrast	600:1
Viewing Angle	178°/ 178° (H/V)
Input Voltage	DC12V (XLR DC Connection)
Input Signal	CVBS, YPbPr, HDMI1, HDMI2 and Ear Phone Jack
Power Requirement	100V AC to 240V AC (with AC Adaptor, XLR Connector)
Power Consumption	≤18W
Size:(LWD)	246 × 224 × 31mm / 167.5mm (with cover open)
Weight	1068g / 1388g (with cover)

### TROUBLESHOOTING

1. Only black-and-white display Check whether the color saturation is properly set up.
2. Power on but no pictures Check whether the cables of Video, HDMI, YPbPr and SDI are correctly connected.  
Please use the standard power adapter coming with the product package. Improper power input may cause the device.
3. Wrong or abnormal colors Check whether the cables are correctly and properly connected. Broken or loose pins of the cables may cause a bad connection.
4. When on the picture shows a size error Press "BRI/MENU → Underscan" to zoom in / out pictures automatically When receiving HDMI signals.
5. Other problems Please press the "BRI/MENU" button and choose → Manufacturer Default → OK
6. According to the ISP, the machine can not function properly ISP for program upgrades, non-professionals do not use it. Please reboot your computer if press accidentally!

It is normal to see some bright lines appear on the screen when turning off the device.

## YEAR LIMITED WARRANTY

All ORION Images products carry a limited warranty from the ship date against defects in materials and workmanship. ORION Images is not liable for improper installation that results in damage to mounts, adapters, display equipment or personal injury.

Contact ORION Images In the event of missing and/or damaged equipment, or technical questions, the following information can help in the completion of the installation.

- **Address:** 7300 Bolsa Avenue, Westminster, CA 92683
- **Tel:** 714-766-6300 / Fax: 714-766-6310
- Email: [sales@orionimages.com](mailto:sales@orionimages.com)
- Website: <http://www.orionimages.com>
- <http://www.orionimages.com>

---

## Documents / Resources

	<b><a href="#">ORION DR13-A805C 9.7 Inch LED Viewfinder Field Monitor</a></b> [pdf] User Guide DR13-A805C 9.7 Inch LED Viewfinder Field Monitor, DR13-A805C, 9.7 Inch LED Viewfinder Field Monitor, LED Viewfinder Field Monitor, Viewfinder Field Monitor, Field Monitor, Monitor
---	---

## References

- [User Manual](#)

[Manuals+](#), [Privacy Policy](#)

This website is an independent publication and is neither affiliated with nor endorsed by any of the trademark owners. The "Bluetooth®" word mark and logos are registered trademarks owned by Bluetooth SIG, Inc. The "Wi-Fi®" word mark and logos are registered trademarks owned by the Wi-Fi Alliance. Any use of these marks on this website does not imply any affiliation with or endorsement.