

ORIGIN MILLWORK
CO2 Soda Stream
Single Mount
Template



Origin Millwork CO2 Soda Stream Single Mount Template User Guide

[Home](#) » [Origin Millwork](#) » Origin Millwork CO2 Soda Stream Single Mount Template User Guide 

Contents

- [1 Origin Millwork CO2 Soda Stream Single Mount Template](#)
- [2 INTRODUCTION](#)
- [3 Specifications:](#)
- [4 Product Usage Instructions:](#)
- [5 Frequently Asked Questions](#)
- [6 Documents / Resources](#)
 - [6.1 References](#)
- [7 Related Posts](#)

ORIGIN MILLWORK

Origin Millwork CO2 Soda Stream Single Mount Template



INTRODUCTION

Introducing our premium Soda Stream CO2 bottle holder, designed to optimize your Soda Stream experience and keep your space organized. Whether you're an avid soda enthusiast or just enjoy the occasional fizzy drink, our bottle holder offers unparalleled convenience and functionality. Crafted with precision using strengthened PLA material, our mounts are 3D printed to ensure durability and reliability. While slight layer lines may be visible due to the printing process, rest assured that our industrial-grade printer delivers a smooth finish for a sleek appearance in your cabinet. Choose between our single or dual bottle mount options, both of which include a template and hardware for hassle-free installation. With the ability to store your empty bottles upside down, identifying used bottles has never been easier. Simply utilize 24 inches of cabinet height for optimal upside-down storage. However, if space is limited, our versatile design allows for a 21-inch configuration by placing the base against the cabinet floor. For those with a rough-and-tumble lifestyle, we recommend securing the base against the floor to prevent potential damage over time. Each full CO2 bottle weighs approximately 3 pounds, and improper handling could lead to wear and tear on the mount. Say goodbye to cluttered cabinets and unstable CO2 bottles with our premium Soda Stream CO2 bottle holder. Elevate your Soda Stream experience today and enjoy the convenience of organized storage at your fingertips.

Please note

That our template is specifically configured for vertically mounting the holder in either a 21" or 24" space. While it's possible to position the mounts sideways, individual cabinet constructions and face frame overhangs may vary. As such, we recommend adjusting the spacing accordingly to suit your specific setup. Our included screws are designed to securely fasten the holder to surfaces with a minimum thickness of 1/2", ensuring a snug fit without the risk of poking through to the other side. **\$13.99 USD PRICE**

Specifications:

- **Product Name:** Soda Stream Single Mount Template
- **Clearance Requirement:** 15.5 inches above the line for smooth bottle sliding
- **Storage Option:** Upside-down storage available, with the bottom edge of the template positioned 3 inches above the cabinet floor
- **Safety Note:** Users are responsible for their safety during tool handling

Product Usage Instructions:

Step 1: Prepare the Template

- Use scissors to cut out the rectangular template, ensuring both parts remain attached as one solid rectangle.

Step 2: Position the Template

- Place the template on the cabinet wall, ensuring it is level and plumb.



Step 3: Mark Hole Locations

- Using a sharp object, mark the center of the hole locations labeled one through six on the template.

Frequently Asked Questions

Q: Is there a specific tool required for cutting the template?

A: You can use scissors to cut out the template as instructed.

Q: What should I do if I don't have the recommended clearance space?

A: It's crucial to ensure the specified clearance to allow smooth bottle movement.

Q: Can the template be used for multiple installations?

A: The template is designed for single mount usage. For multiple installations, additional templates may be needed.

Documents / Resources

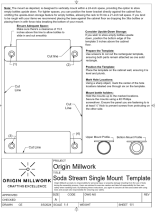

[Origin Millwork CO2 Soda Stream Single Mount Template](#) [pdf] User Guide
CO2 Soda Stream Single Mount Template, CO2, Soda Stream Single Mount Template, Single Mount Template, Mount Template, Template

References

- **[User Manual](#)**

[Manuals+](#), [Privacy Policy](#)

This website is an independent publication and is neither affiliated with nor endorsed by any of the trademark owners. The "Bluetooth®" word mark and logos are registered trademarks owned by Bluetooth SIG, Inc. The "Wi-Fi®" word mark and logos are registered trademarks owned by the Wi-Fi Alliance. Any use of these marks on this website does not imply any affiliation with or endorsement.