



# OREI USBC2HDMI SplitExtend HDMI Splitter Extended Display for Dual Monitor User Manual

[Home](#) » [OREI](#) » OREI USBC2HDMI SplitExtend HDMI Splitter Extended Display for Dual Monitor User Manual 

## Contents

- [1 OREI USBC2HDMI SplitExtend HDMI Splitter Extended Display for Dual Monitor](#)
- [2 Registration page](#)
- [3 Technical Support](#)
- [4 Safety Instructions](#)
- [5 Introduction](#)
- [6 Features](#)
- [7 Package Contents](#)
- [8 Operation controls and functions](#)
- [9 System Requirements](#)
- [10 Driver Installation](#)
- [11 Display Mode Setting](#)
- [12 Troubleshooting Common Issues](#)
- [13 Connection Diagram](#)
- [14 Documents / Resources](#)
  - [14.1 References](#)



**OREI USBC2HDMI SplitExtend HDMI Splitter Extended Display for Dual Monitor**

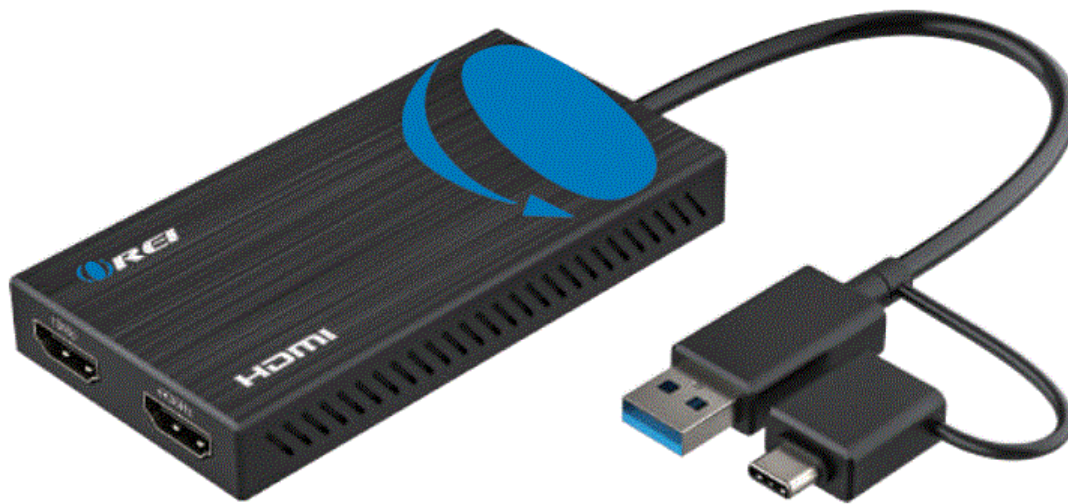

USB3.0 (USB-A or USB-C) to Dual HDMI Adapter Supports 4K@30Hz+1080P@60Hz for Windows and Mac OS

Follow us on YouTube and Facebook



[www.orei.com](http://www.orei.com)

Thank you for purchasing this product

For optimum performance and safety, please read these instructions carefully before connecting, operating, or adjusting this product. Please keep this manual for future reference.

**Surge protection device recommended**

This product contains sensitive electrical components that may be damaged by electrical spikes, surges, electric shock, lightning strikes, etc. Use of surge protection systems is highly recommended in order to protect and extend the life of your equipment.

**Registration page**

Please Activate your warranty by registering our product through the link below –

<https://www.orei.com/pages/warranty-registration>

**Technical Support**

**Need Help?**

Our experienced Technical Support Team is here for you to answer your questions, give technical advice or help troubleshoot your project to get you installed on time and on budget. Call, email or chat with us now.

OREI Live Technical Support Hours

US team (US/Canada/Mexico): Monday-Friday, 9 a.m. – 6 p.m. Central Time

Support Email – [info@orei.com](mailto:info@orei.com) | Support Number – 877-290-5530

Or

Chat Live on [www.orei.com](http://www.orei.com)

Send us an instant message now. Our Technical Support Team will respond momentarily. Available during live support hours.

**Safety Instructions**

Before using this product, please carefully read the following safety instructions to ensure its proper use and keep

this manual for future reference:

1. To prevent electric shock, do not attempt to open the product.
2. Only qualified personnel should perform any repairs or maintenance.
3. Always place the product on a stable, flat surface to prevent it from falling.
4. Do not expose the product to water, moisture, or high-humidity environments to avoid the risk of damage.
5. To prevent damage from direct sunlight or high temperatures, do not expose the product to such environments.
6. Do not place the product near heat sources like radiators, heat registers, stoves, or other heat-producing apparatus.
7. Do not place any objects on top of the product to avoid damage.
8. Use only the attachments and accessories specified by the manufacturer.
9. During lightning storms or prolonged periods of disuse, unplug the power supply to prevent damage.

## Introduction

The USB 3.0 to HDMI Dual Display Adapter, which connects USB-A or USB-C to two HDMI displays. This adapter is designed to support Mirror/Extend/Rotate/Clamshell modes and can display up to 4K@30Hz and 1080p@60Hz. This adapter allows you to extend or duplicate your Laptop or computer screen to two displays adding accessibility and convenience to your setup. We have tested this product to meet all specifications and features. To ensure long-term enjoyment of this product, please read the following information before installation.

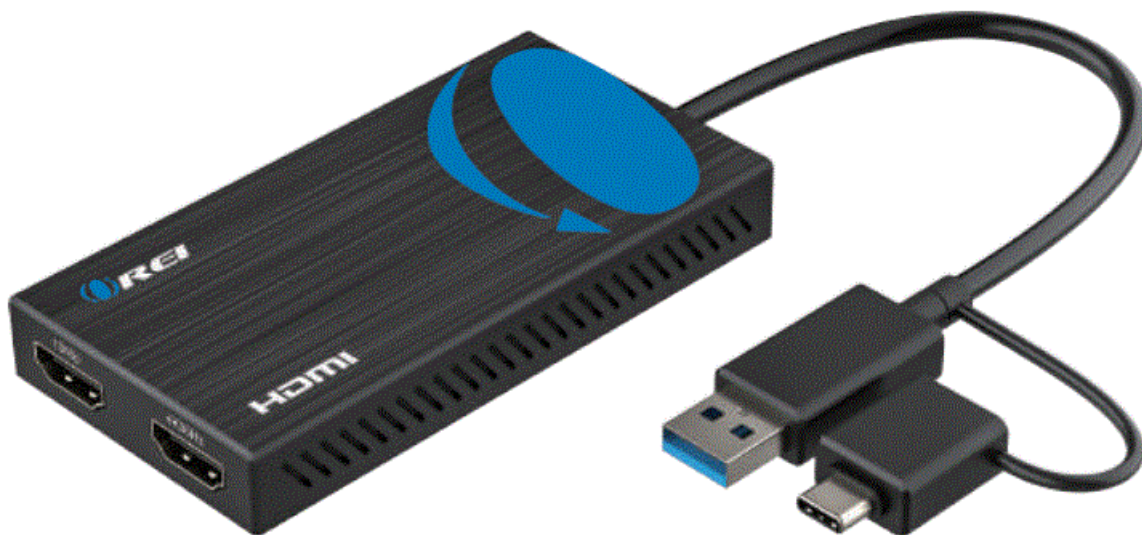

## Features

1. Dual display output, supporting one display at 4K@30Hz and another at 1080p@60Hz.
2. Supports video decoding in multiple formats, including H.264, H.263, MP4, MP2, DivX, AVS, JPEG, and more.
3. Compatible with USB-C, USB-A, Thunderbolt 3/4, and USB 4 standard ports.
4. Allows you to extend your PC screen to multiple displays, supporting up to 8 displays on Windows and up to 6 displays on Mac OS

## Package Contents

USB 3.0 to HDMI Dual Display Adapter User Manual

## Operation controls and functions

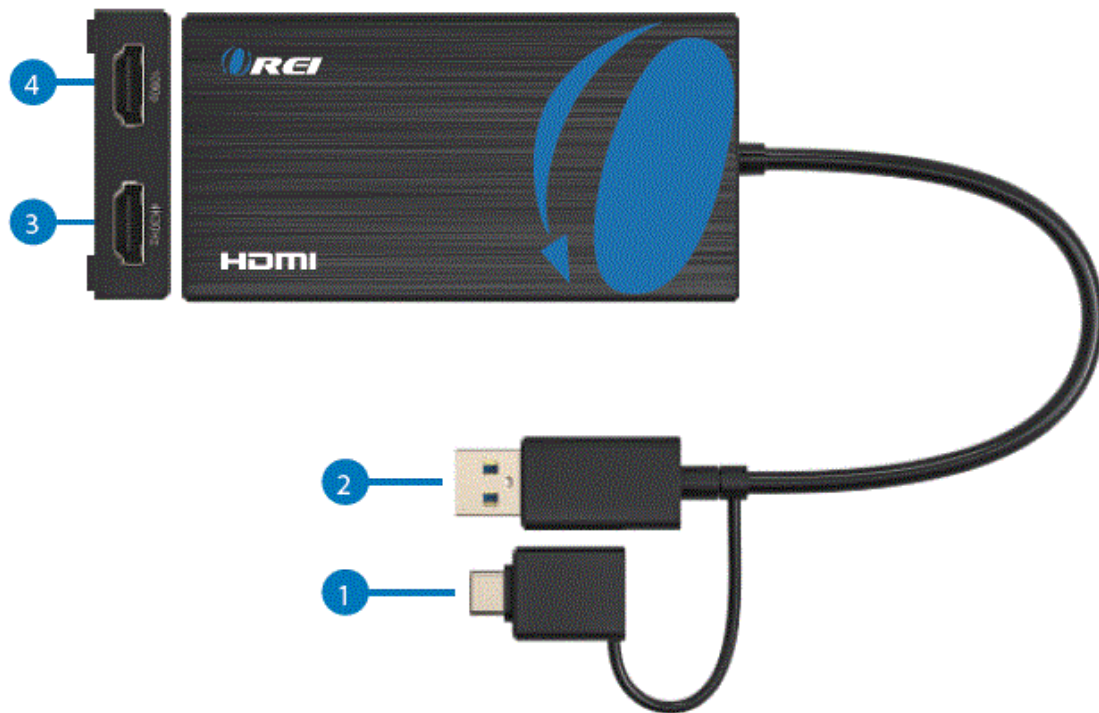

1. USB-C Male Adapter: Connect to the USB-C port of the Laptop/Notebook with USB3.0 Data Output
2. USB3.0 Port: Connect to the USB 3.0 Data Port of the PC/ Laptop/ Notebook/USB 3.0 Hub
3. 4K30Hz: Connect to HDMI Display to Output Resolution up to 4K@30Hz Max
4. 1080p Connect to HDMI Display to Output Resolution up to 1080p Max

## System Requirements

To ensure proper installation and operation of this product, please ensure that your system meets the following requirements:

1. Windows 7/8/8.1/10 and above or Mac OS 10.10.x and above.
2. CPU Processor: Core i5 and above.
3. RAM: 4GB and above.
4. Monitor: Supports 4K resolution.

## Resolutions

OS/Ports		1080p Port	4K Port
Windows	Mirror mode	1920×1080@60Hz	1920×1080@60Hz
	Extend mode	1920×1080@60Hz	3840×2160@30Hz
Mac OS	Mirror mode	1920×1080@60Hz	3840×2160@30Hz
	Extend mode	1920×1080@60Hz	3840×2160@30Hz

## Driver Installation

Enter the website:

[www.siliconmotion.com](http://www.siliconmotion.com)>Products>Graphics-Display-SoCs> Downloads>Drivers, and download the correct driver zip file as follows:





## SM76x Driver Download



### Windows

OS Description	Version	Release Date	Release Notes	Download
Windows 11, Windows 10, Windows 7, Windows 8.1 Driver	V0.14.881	Jan 3, 2023	<a href="#">Release Notes</a>	<a href="#">Download</a>

### macOS

OS Description	Version	Release Date	Release Notes	Download
Recommended: Install this display application with USB Support macOS 13 Ventura, 12 Monterey, 11 Big Sur and 10.15 Catalina including MacBook Air (M1) (M1 & Intel powered)	V0.14.894	Jan 3, 2023	<a href="#">Release Notes</a>	<a href="#">Download</a>
Legacy Display Driver for macOS 10.15 Catalina, 18-19 Mojave and 19-20 High Sierra	V0.2.16.0	Jan 3, 2021	<a href="#">Release Notes</a>	<a href="#">Download</a>
Legacy Display Driver for macOS 10.14, 10.11 and 10.12	V0.1.A0001	Dec 12, 2016	<a href="#">Release Notes</a>	<a href="#">Download</a>

### Android

OS Description	Version	Release Date	Release Notes	Download
Android T.T and above	V0.14.881	Jan 3, 2023	<a href="#">Release Notes</a>	  <a href="#">Download</a>

1. Unzip the driver file, double click to open the “.exe” file, and then click “INSTALL”.

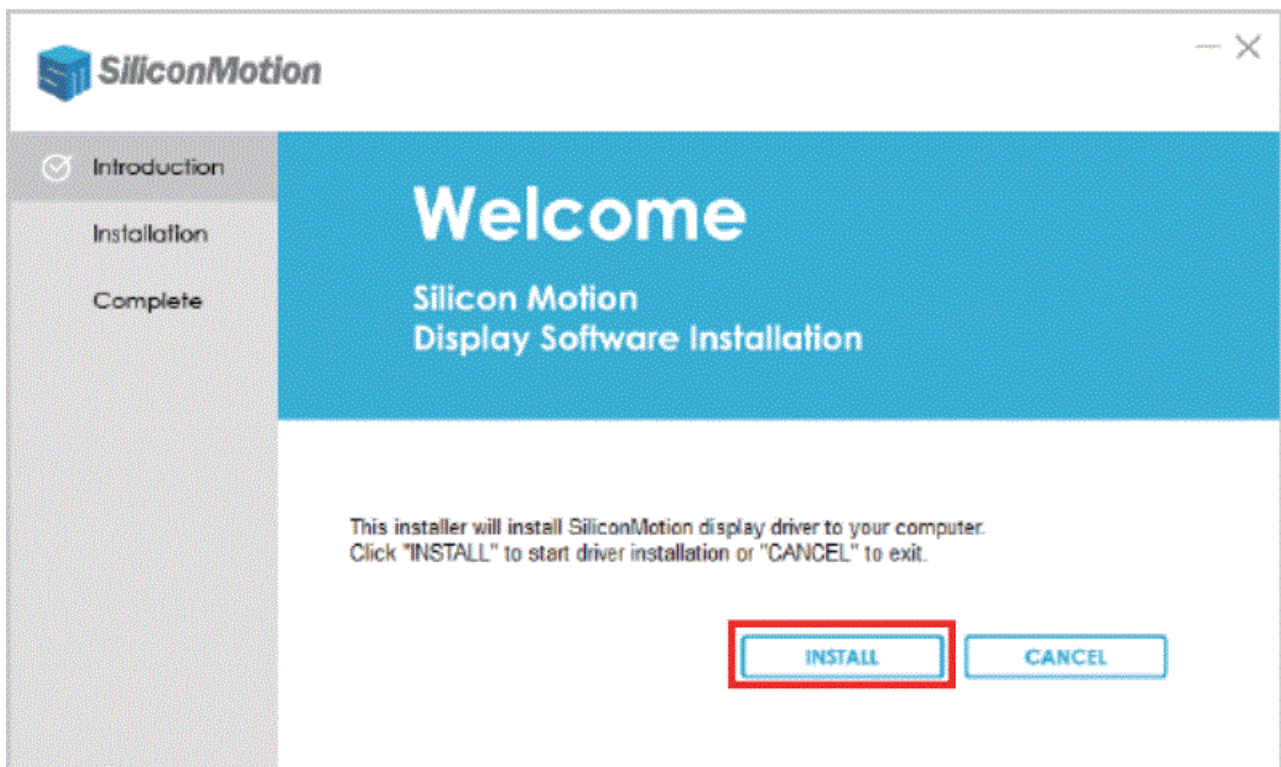

**Note:** If a security prompt pop-up appears, click “INSTALL”.

2. After installation, click “REBOOT” to restart the computer.

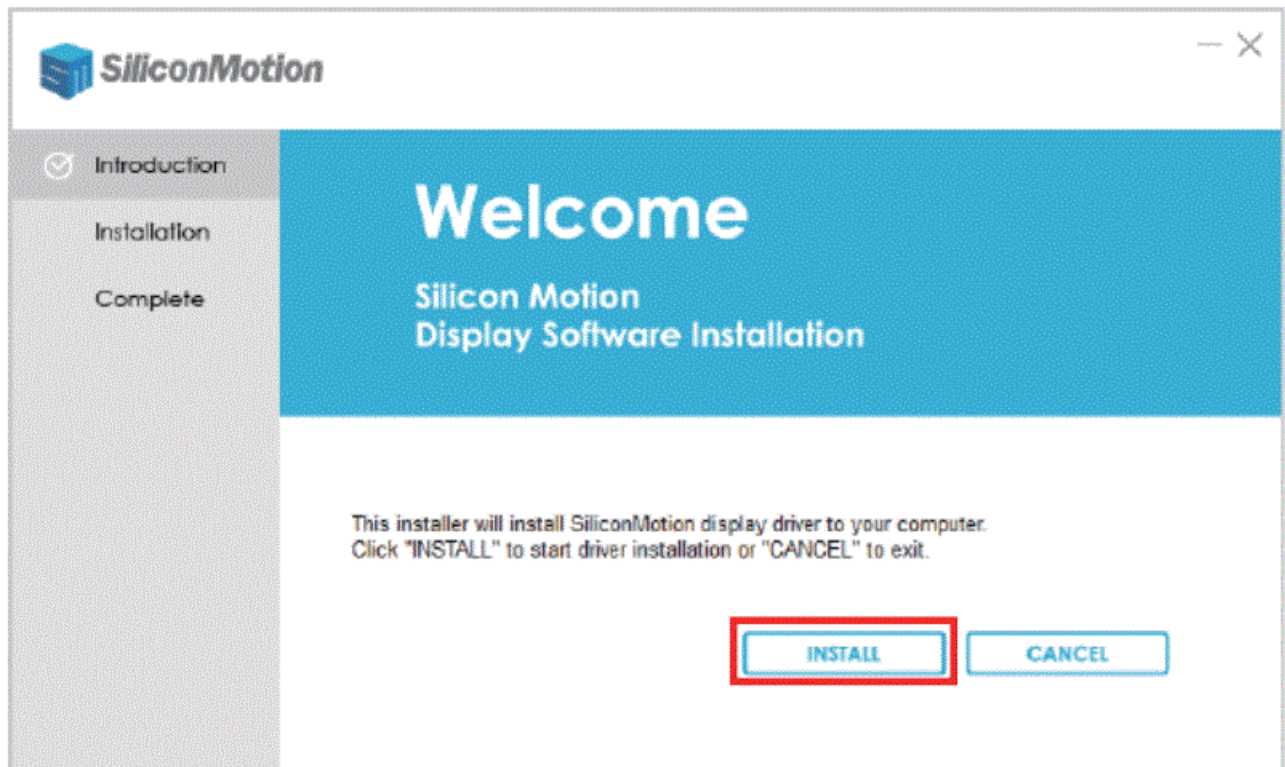

## Display Mode Setting

### For Windows

1. Right-click the blank space on the desktop and select "Display settings".

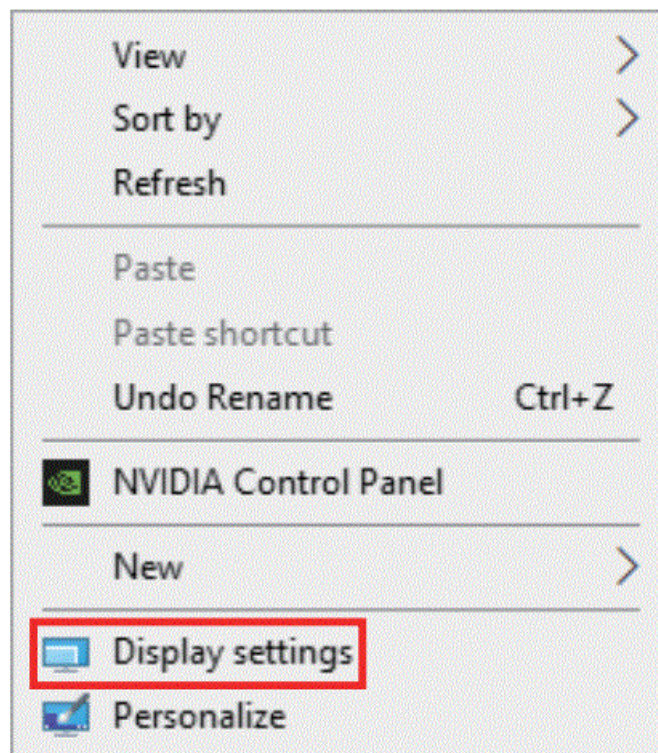

2. At the "Display" area, click each of the display icons to set the needed resolution or other settings.



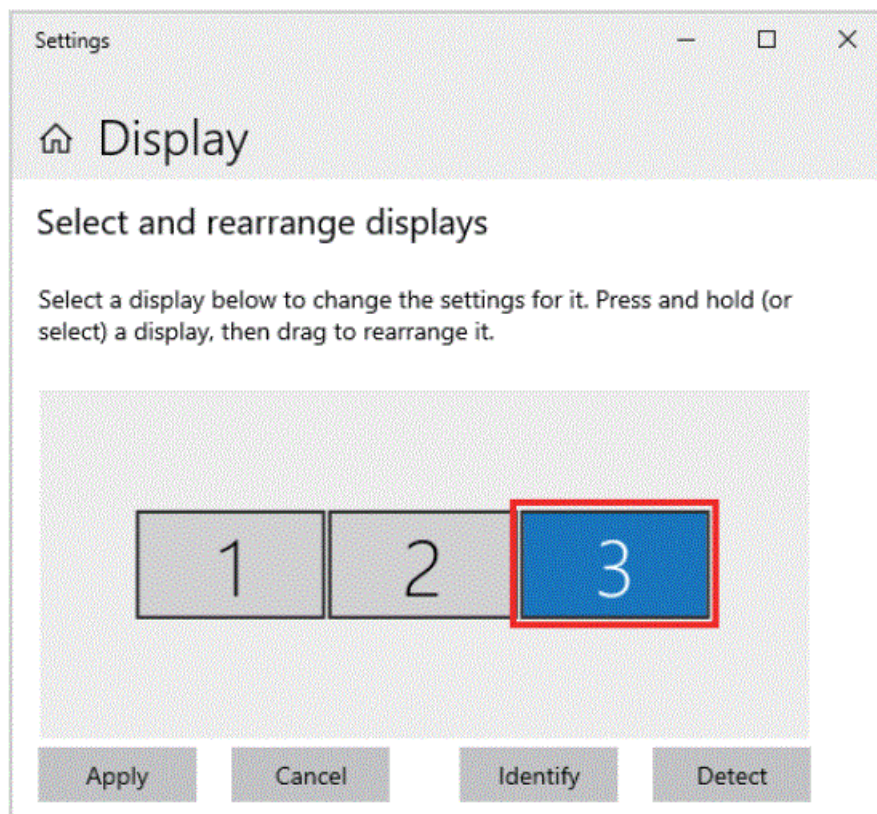

3. Scroll down to “multi-display settings” and select the desired mode in the drop-down list.

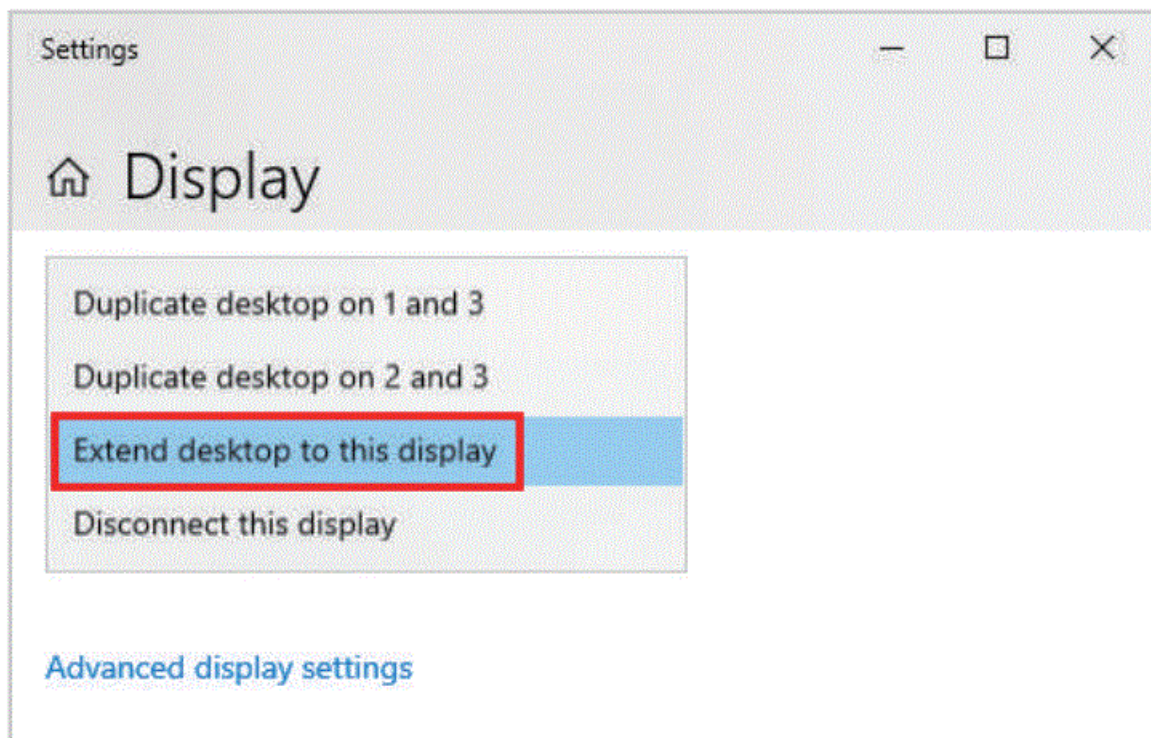

#### For Mac OS

1. Left click the apple icon and select “System Preferences”, and click “Displays”.

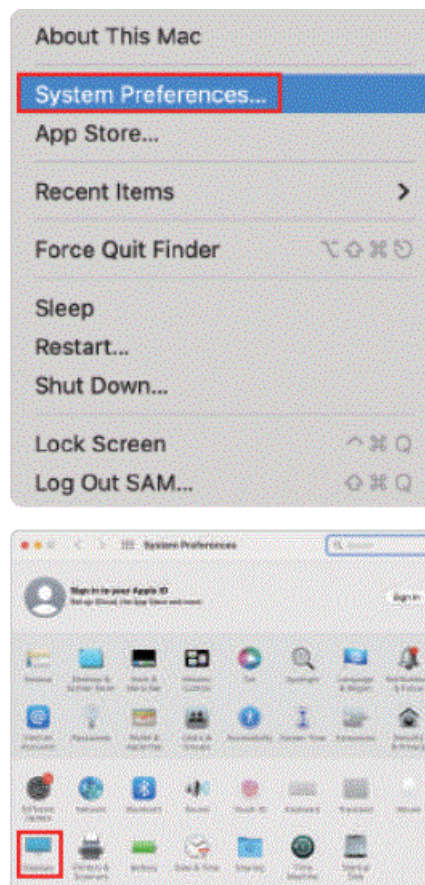

2. At the “Display” area, click each of the display icons to set the location or change to mirror or extend mode.

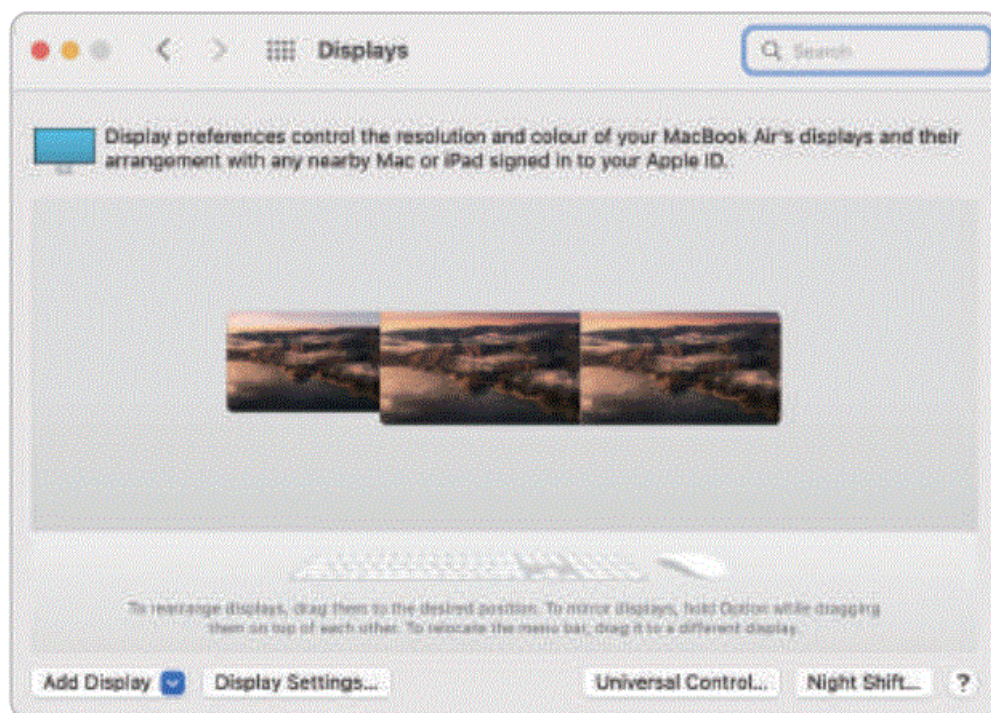

3. Click “Display Setting”, and choose each connected display to set correct resolution and mode.



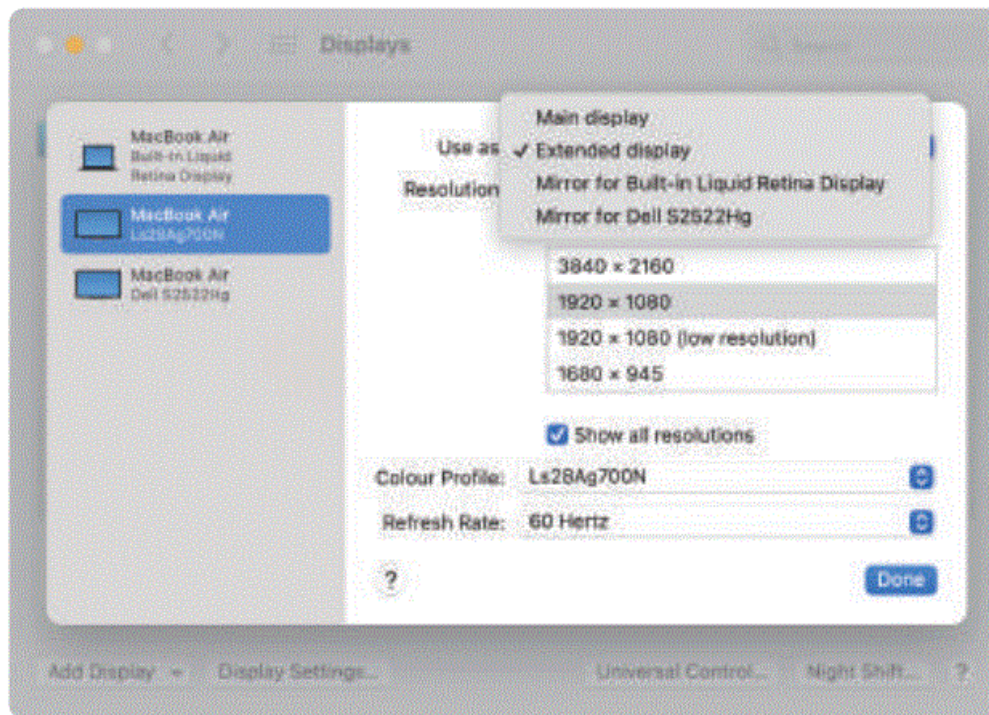

## Note

1. Please note that Mac-based devices do not support rotation mode, but M1/M2 Mac supports clamshell mode while Intel Mac does not.
2. To use this adapter, your USB-C™/USB3.0 equipped device must support USB 3.0 data transmission.
3. Please be aware that this adapter does not support playback of HDCP-protected content on sites like Netflix and Hulu.

## Support Resolution

	1080p Port	4K Port
<b>Windows</b>	1920×1080@60Hz	3840×2160@30Hz
	1680×1050@60Hz	2560×1440@60Hz
	1600×1200@60Hz	1920×1080@60Hz
	1600×900@60Hz	1680×1050@60Hz
	1440×1050@60Hz	1600×1200@60Hz
	1440×900@60Hz	1600×900@60Hz
	1280×1024@60Hz	1440×1050@60Hz
	1280×800@60Hz	1440×900@60Hz
	1280×720@60Hz	1280×1024@60Hz
	1152×864@60Hz	1280×800@60Hz
	1024×768@60Hz	1280×720@60Hz
	800×600@60Hz	1152×864@60Hz
	720×480@60Hz	1024×768@60Hz
	640×480@60Hz	800×600@60Hz
	—	720×480@60Hz
	—	640×480@60Hz
<b>Mac OS</b>	1920×1080@60Hz	3840×2160@30Hz
	1920×1080@30Hz	2560×1440@60Hz
	1600×900@60Hz	1920×1080@60Hz
	1280×720@60Hz	1920×1080@30Hz
	—	1600×900@60Hz
	—	1280×720@60Hz

Input Ports	USB-C Male or USB 3.0 Male x 1
Output Ports	HDMI x 2
Data Transmission Rate (Max)	5Gbps
Data Transmission Standard	USB 3.0 ( USB 3.1 GEN 1)
Compatible OS	Windows 7/8.1/10/11 and above Mac OS  10.10.x and above Android 7.1 and above ( Android devices only support mirroring mode with resolutions up to 1080P)
Operating Temperature	0°C to 60°C
Storage Humidity	5% to 90% RH non-condensation
Power Supply	USB3.0 USB-C from PC or notebook
Power Consumption (Max)	5W
Unit Cert	FCC, CE, RoHS
Dimension (LxWxH)	3.94x 1.97x0.53in (100x50x13.5mm)
Net Weight	78g
Material	ABS
User Manual	English Version

**Note:** Specifications are subject to change without notice.

## Troubleshooting Common Issues

Q: My USB 3.0 to HDMI Dual Display Adapter is not working. What should I do?

A: First, please check the following

1. Ensure that your device's USB port has a current output of 900mA or more. If not, try a different port.
2. Check if the correct drivers have been installed on your device.
3. Make sure that your HDMI cable and adapter are securely connected to your device.
4. Verify that your video source is compatible with the adapter.
5. Restart your device and see if this resolves the issue.

Q: My second display flickers when I use the adapter. What could be causing this?

A: This may be caused due to loose fitting cables or incompatible video sources or USB ports

1. Make sure the HDMI cable and adapter are securely connected.
2. Try using a different HDMI cable to see if this resolves the issue.
3. Check that your device is providing sufficient power to the adapter (900mA or more).
4. Verify that your video source is compatible with the adapter.
5. Try using a different USB 3.0 port or restarting your device

Q: The adapter is not displaying video on my second monitor. How can I fix this?

A: Please check the following items:



1. Ensure that your HDMI cable and adapter are securely connected.
2. Verify that your video source is compatible with the adapter.
3. Check the driver version for the adapter, and make sure it is up-to-date.
4. Make sure your device is providing sufficient power to the adapter (900mA or more).
5. Try using a different USB 3.0 port or restart your device.

## Connection Diagram

### 1. Mirror Mode

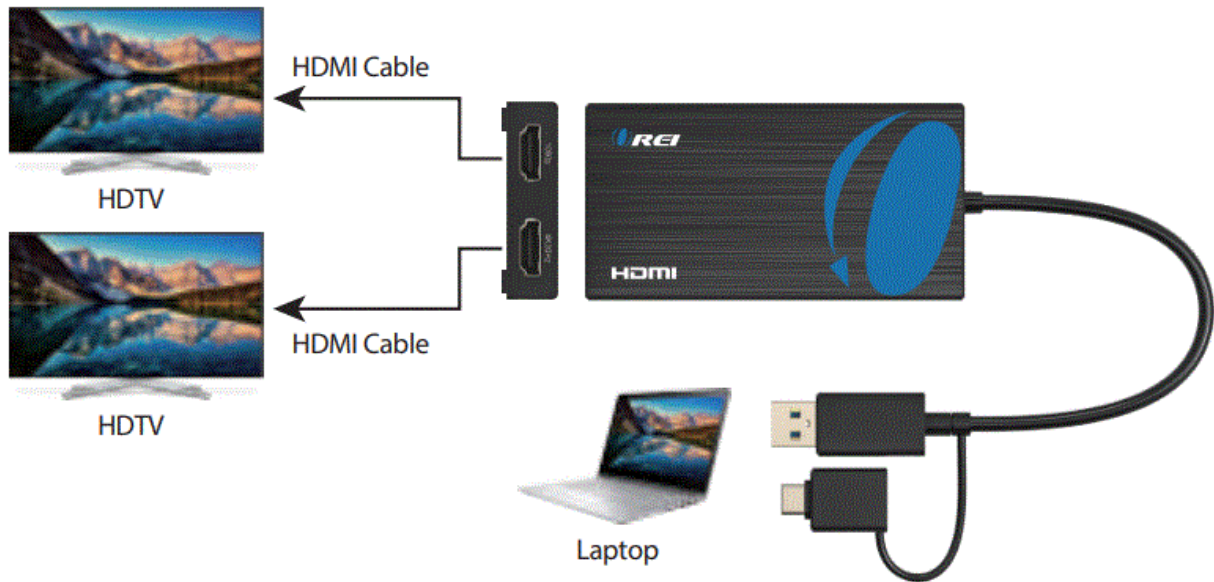

### 2. Extend Mode

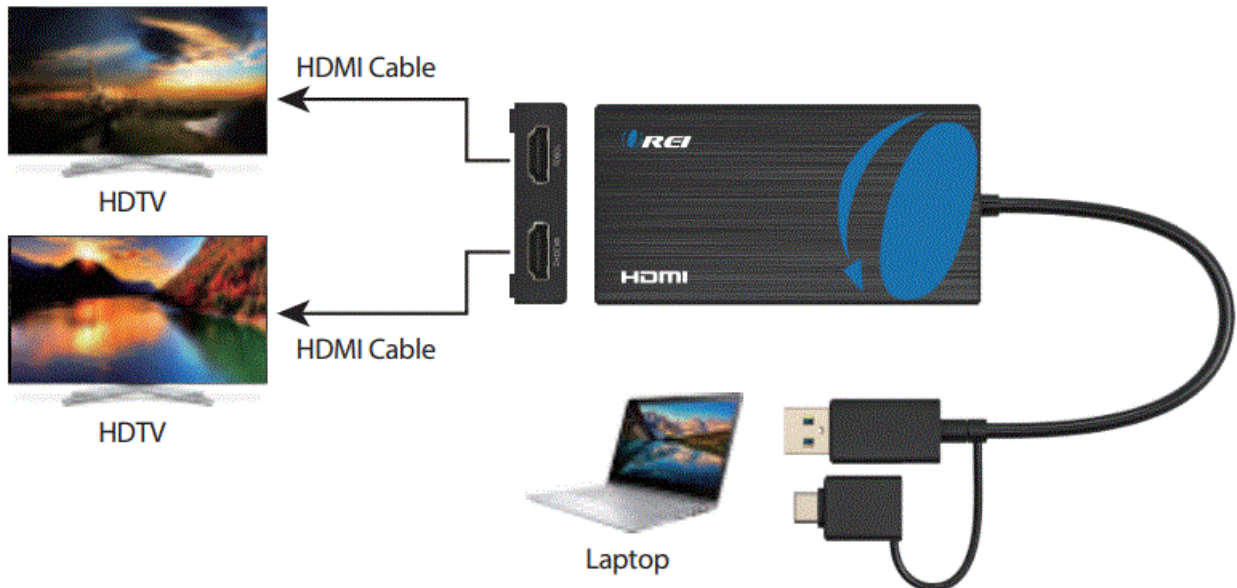

The Adopted Trademarks HDMI, HDMI High-Definition Multimedia Interface, and the HDMI Logo are trademarks or registered trademarks of HDMI Licensing Administrator, Inc. in the United States and other countries. All other trademarks, registered trademarks, or service marks are the property of their respective owners.

USB3.0 (USB-A or USB-C) to Dual HDMI Adapter  
Supports 4K@30Hz+1080P@60Hz for Windows and Mac OS  
[www.orei.com](http://www.orei.com)

Documents / Resources

	<p><a href="#">OREI USBC2HDMI SplitExtend HDMI Splitter Extended Display for Dual Monitor</a> [pdf] User Manual</p> <p>USB3.0 USB-A or USB-C to Dual HDMI Adapter, USBC2HDMI2_Manual, 91MrBzdpcJL.pdf, USBC2HDMI, USBC2HDMI SplitExtend HDMI Splitter Extended Display for Dual Monitor, SplitExtend HDMI Splitter Extended Display for Dual Monitor, HDMI Splitter Extended Display for Dual Monitor, Splitter Extended Display for Dual Monitor, Extended Display for Dual Monitor, Display for Dual Monitor, Dual Monitor, Monitor</p>
---	---

References

- [User Manual](#)