



# ORAY CINEFRAME Portable Projection Screen User Manual

[Home](#) » [ORAY](#) » ORAY CINEFRAME Portable Projection Screen User Manual 

## ORAY CINEFRAME Portable Projection Screen User Manual



### Contents

- [1 INSTALLATION](#)
- [2 SECURITY WARNING](#)
- [3 GARANTIE](#)
- [4 Documents / Resources](#)
  - [4.1 References](#)
- [5 Related Posts](#)

## INSTALLATION

1. Slide 4 pieces M6 nuts into the long side slot and one M6 nut into each short side slot.
2. Insert the plastic L parts to the frame to connect them.

**Note:** allow 2 L in the last side to be mounted. Use the M5x10 screws to secure the set.

3. Insert the spring hooks into the frame slot and turn to 90°
4. Insert the Ø5 steel rods into the four edges of the screen fabric. Short edges first.
5. Put the prepared screen fabric into the frame. Use the spring hook to fix them. Short edges first. Check and adjust to ensure the flatness.

**Note:** Put the hooks at the middle of the fabric hole.

6. Use M6x12 screws to fix the square steel plate to the frame angle.
7. Then use the right way to fix the frame screen to the wall.

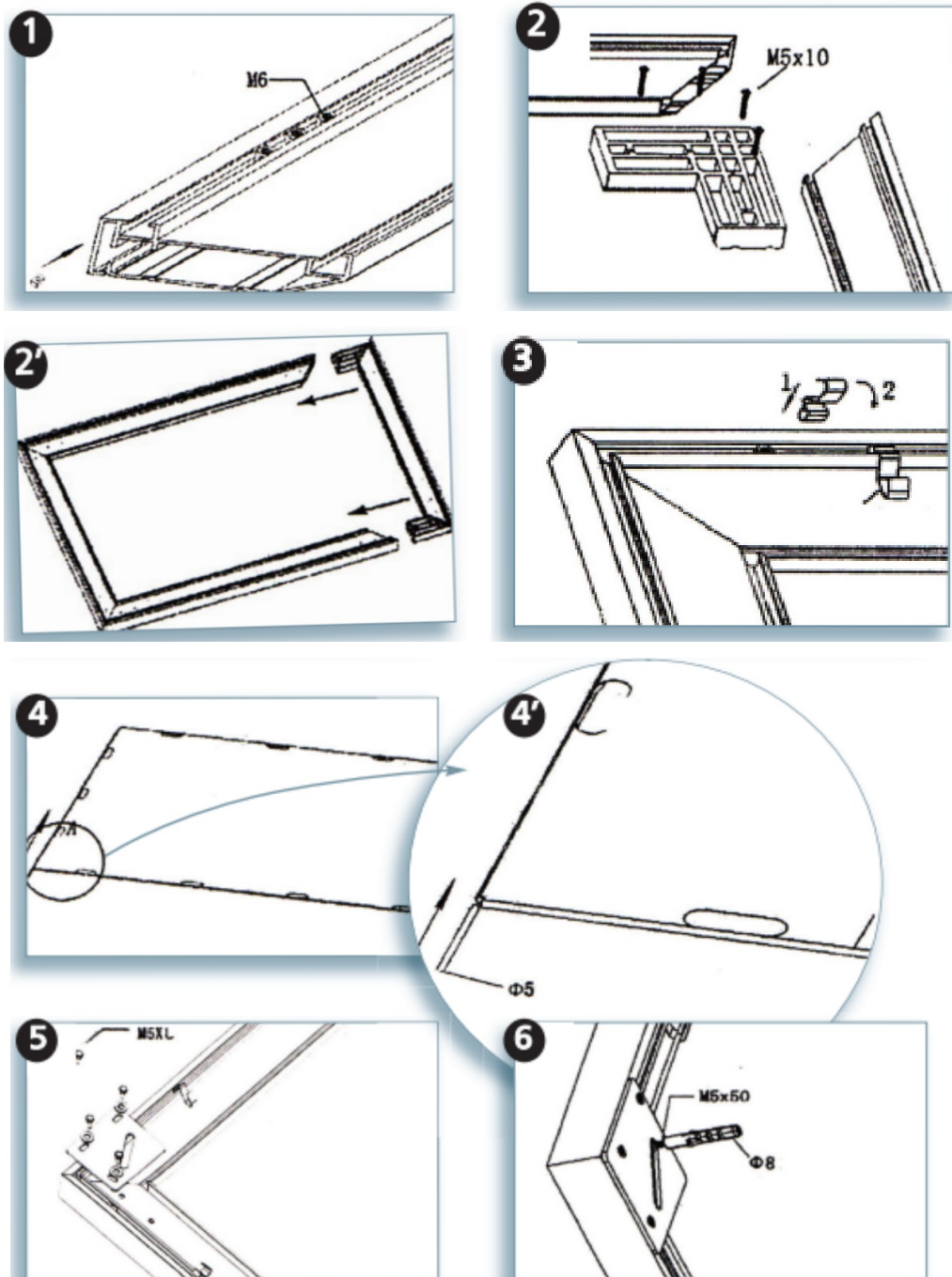

## SECURITY WARNING

To avoid product damage due to improper installation or use, please read this manual carefully before installing the display.

- Dangerous for children! Adult use only!

- Do not attach any objects on the screen (danger of injury)!

## **GARANTIE**

### **1. Defects covered by warranty**

According to the legal warranty concerning latent defect as stated in the Article 1641 of the French Commercial Code, the Manufacturer will commit to deal with any malfunction due to design defect or manufacturing defect in the limit of the hereafter listed conditions. The Manufacturer's liability will be limited to the replacement or refund of such products at the Manufacturer's discretion and will exclude any compensation or transport and travelling expenses.

### **2. Warranty limitations**

**Warranty will not be extend to:**

- parts that show natural wear and tear
- damages or accidents that may occur if products are improperly handled and installed by the Customer or a third part
- products misused or improperly maintained
- products improperly stored and neglected
- products modified or altered by the Customer There will be warranty on products unpaid by the Customer. The Customer will not be able to use this limitation to suspend or delay payments.

### **3. Beginning and end of warranty**

The warranty is only applicable to defects that will be notified to the Manufacturer within a period of two years from the invoice date or the installation date if prior to the invoice date. Repairs and replacements done within the warranty period do not start a new warranty or extend the initial one.

### **4. The Customer's liability**

The Customer will communicate to his own customers the conditions of the present warranty. To ensure the application of the warranty, the Customer will have to justify and mention all existing defects to the Manufacturer, without delay and in writing. The Customer will also allow the Manufacturer to proceed to the examination of these defects and to perform the necessary repairs, if applicable. Under no circumstance will the Customer himself or a third party attempt to repair or replace defective parts.

### **5. Liability**

The Manufacturer's liability is strictly limited to the above defined warranty. Whatever the cause, corporal damage and serious fault excepted, this liability is limited to the amount of the due sums received according to the contract. The Manufacturer will not be liable to compensate for, including, but not limited to, any special, direct, indirect, incidental, or consequential damages, expenses, lost profits, lost savings, business interruption, claim from a third party, etc





## Documents / Resources

	<p><a href="#">ORAY CINEFRAME Portable Projection Screen</a> [pdf] User Manual CINEFRAME Portable Projection Screen, CINEFRAME, Portable Projection Screen, Projection Screen, Screen</p>
---	---

## References

- [ACCUEIL - Oray](#)
- [User Manual](#)