

**oraimo**  
**oraimo OSW-803N**  
**Smart Watch**



## oraimo OSW-803N Smart Watch User Guide

[Home](#) » [oraimo](#) » oraimo OSW-803N Smart Watch User Guide 

### Contents

- [1 oraimo OSW-803N Smart Watch](#)
- [2 Product Overview](#)
- [3 Setting Up Your Smart Watch](#)
- [4 BT Calling](#)
- [5 Getting To Know Your Smart Watch](#)
- [6 Troubleshooting & FAQ](#)
- [7 Basic Product Specifications](#)
- [8 Customer Service](#)
- [9 Warranty Certificate](#)
- [10 Warranty Terms & Conditions](#)
- [11 FCC](#)
- [12 Documents / Resources](#)
  - [12.1 References](#)

**oraimo**

**oraimo OSW-803N Smart Watch**



## WELCOME GUIDE

Watch 4 Lite | OSW-803N |

For safety issue, the product remains low capacity during shipping.  
Please fully charge the product before initial use!

## Product Overview

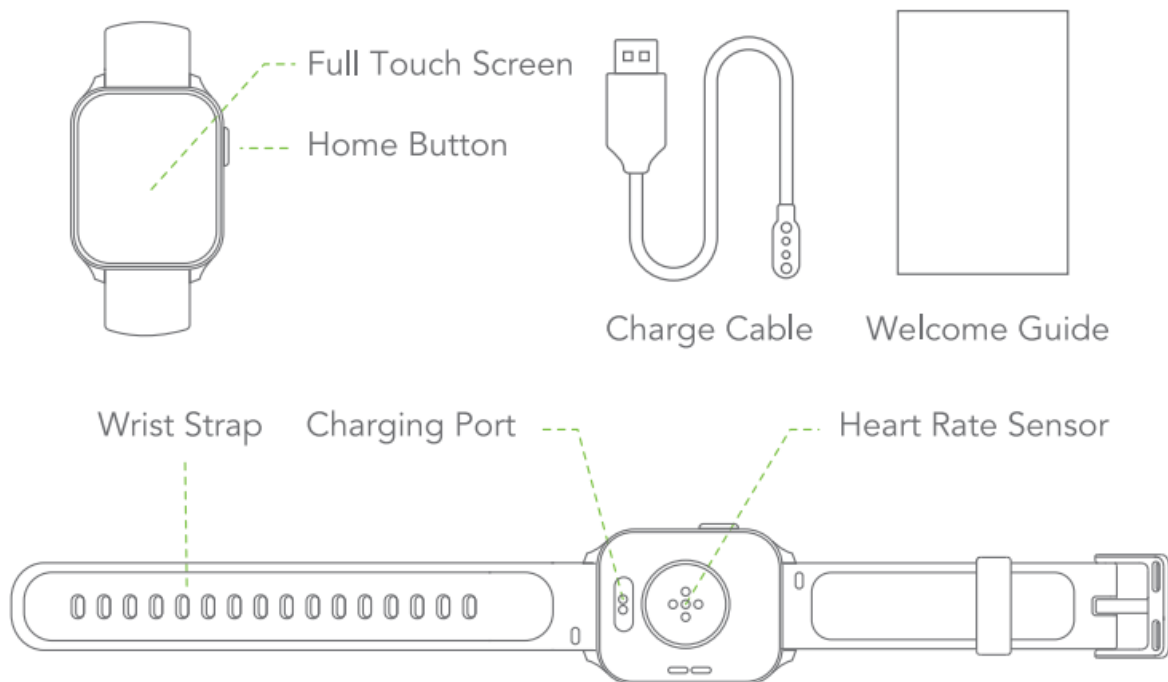

## Setting Up Your Smart Watch

For the best experience, we recommend using the updated oraimo Health App for iOS and Android.



iOS 12.0 or above



Android 7.0 or above

## Pair With Your Phone

1. Get ready with the oraimo Health App, scan the QR code on your watch or find the oraimo Health App in one of these locations, depending on your device:

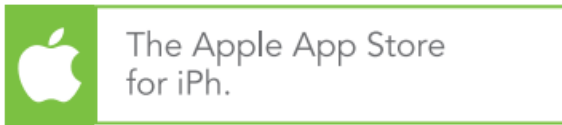

2. When the App is installed, open it and follow the instructions that help you create your account, or login to your existing account.
3. Your account asks for information such as height, weight, and gender to make various calculations and tailor your experience using the app. You can modify your information in oraimo Health – Account – User
4. Long press the Home Button of the watch to turn it on, follow the onscreen instructions to setup the language, and get ready pairing with the phone.

## Scan the QR code to pair

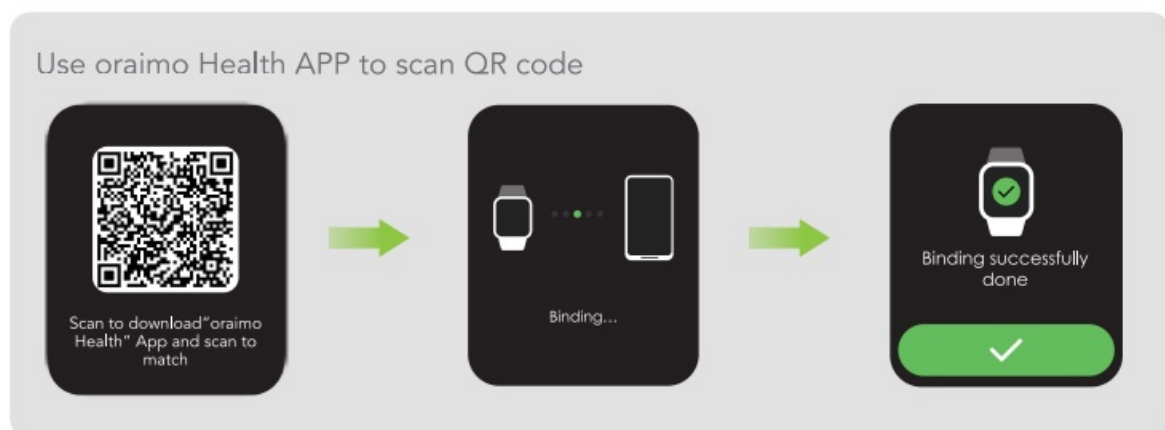
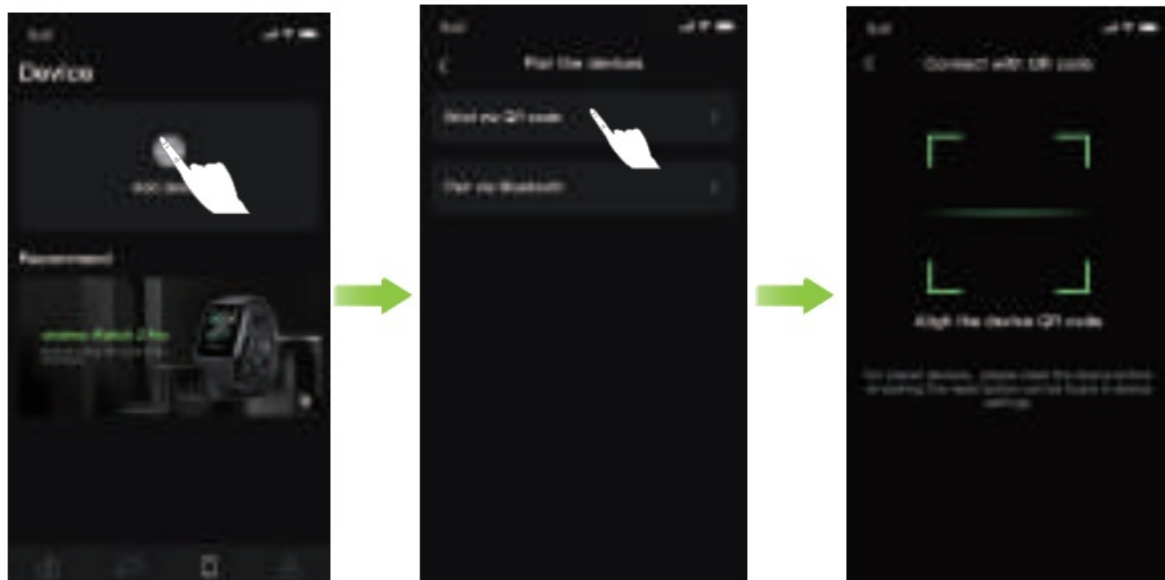

If you can't pair successfully, try the following methods:

1. Make sure the BT permission is allowed for the app;
2. Make sure the watch is not connected with another phone;
3. Try turning off and on again the BT switch on your phone;

4. If none of these work, try rebooting your phone and the watch, and repeat the above steps. After pairing with your phone, read through this guide to explore the various functions!

## BT Calling

Before pairing your phone and the watch for the BT Calling function, make sure the BT for call on the watch is switched on:

### Method 1:

Press the home button in the main dial, tap the Phone menu item to switch on the BT for call on the watch.



### Method 2:

On the watch face, swipe down and see the following control panel, press the BT icon to enable BT calling.



In the BT list of the mobile system, connect to “oraimo Watch 4 Lite” and you can use the watch to make calls. Some phones have separate BT and BLE, and you need to connect two devices with the same BT name. Please check the BT list in the search and connect them.

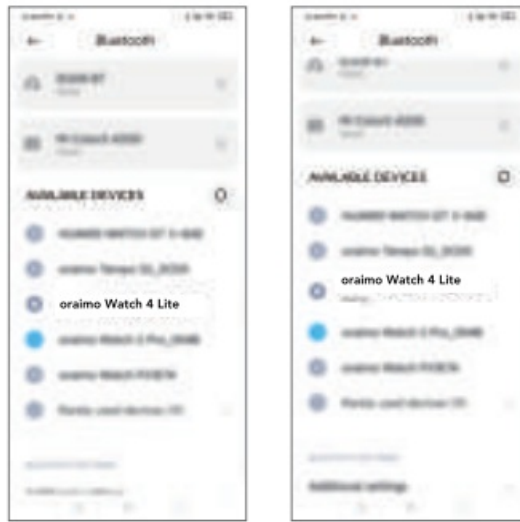

In Android



In iOS

## Getting To Know Your Smart Watch

### Wrist Placement

For all-day wear, your watch should usually rest a finger's width below your wrist bone and lay flat, as you would normally wear a watch.

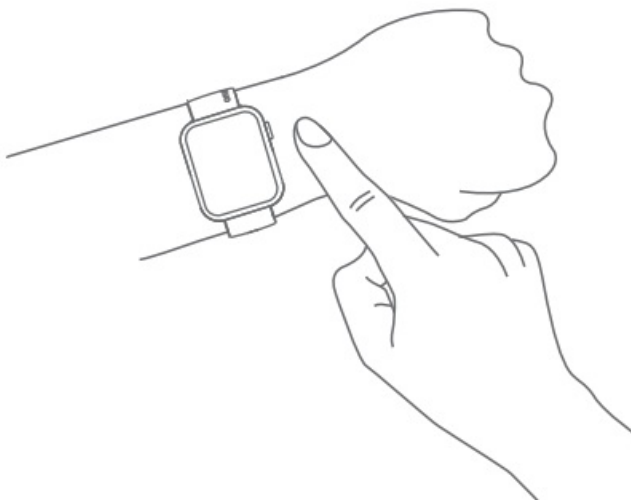

## Charge Your Watch

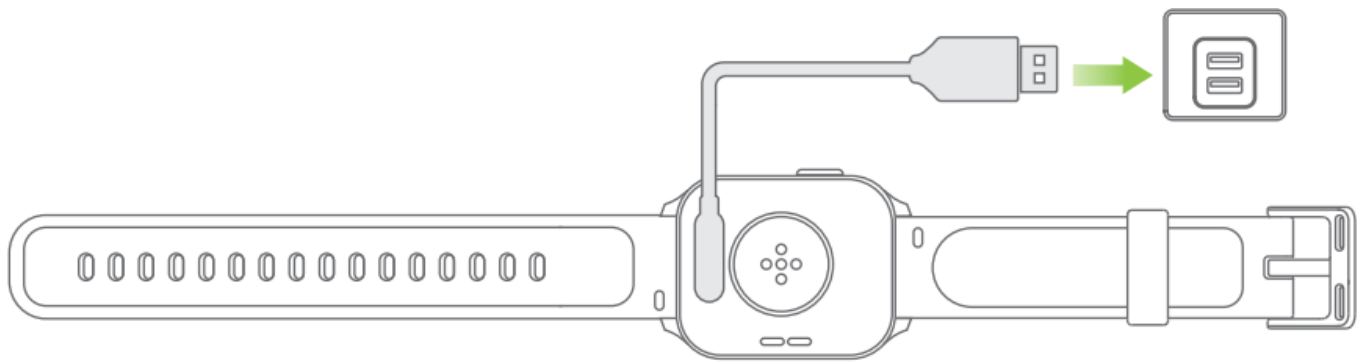

The device's screen will light up, showing the battery level.



If the smartwatch was in contact with water, please use a clean, dry towel or a microfiber cloth to gently pat the watch dry, and wipe the metal contacts before charging.

## Power On/Off

- To turn on the watch, make sure that the device is fully charged and then long-press the Home button for 3 seconds.
- To turn off the watch, light up the device and then long-press the Home button for 3 seconds and confirm the shutdown. Then the watch will vibrate and power off. You can also turn off the watch from its Settings menu.
- If the watch malfunctions, connect it to a power supply and long-press the Home button for more than 12 seconds for a hard reboot.

## Wake Up the Watch

- Method 1: Press the Home button to light up the display.
- Method 2: Turn your wrist. (This “Raise to Wake” function is active by default. You can turn it off by tapping the Raise to Wake icon.)



"Raise to Wake" On

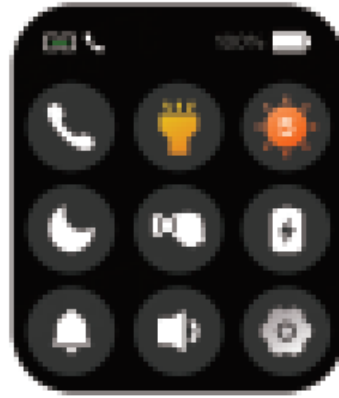

"Raise to Wake" Off

### Turn On Do-not-disturb (DND) Mode

Tap the Do-not-disturb icon to turn on the DND mode. Once activated, there will no longer be message pop-ups displayed on the watch.



DND Mode On

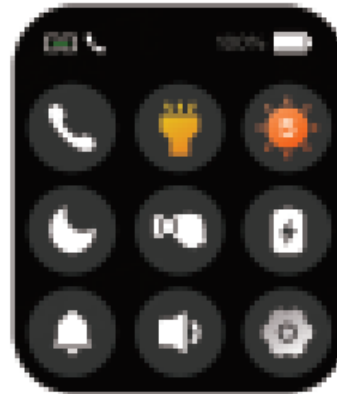

DND Mode Off

### Explore Functions with Full-screen Gesture

- Swipe Left to control the music player and access calls, workout functions and settings.
- Swipe Right to explore Daily Activities, Heart Rate, Blood Oxygen, Respiratory Rate, Pressure and Sleep statistics.
- Swipe Down from the top to turn on/off Raise to Wake and DND Mode, and adjust Brightness. Tap to access the Settings menu.
- Swipe Up from the bottom to check the message inbox.

### Troubleshooting & FAQ

Can't connect with BT.

Make sure that your device supports BT Version 5.2 and that your phone system is iOS 12.0 and above or Android 7.0 and above. Make sure that you've set up the BT permission for the oraimo Health app. Check if the watch is connected to another phone. If yes, please disconnect and retry. Disconnect the BT on your phone and reconnect after 20 seconds. Reboot the watch and your phone and repeat the above steps.

Cannot find the watch through BT.

Make sure that your location services are enabled (GPS is working) and the device has sufficient power. Keep the device screen activated and place it close to your phone. Make sure that the watch is not connected to another phone. Disconnect the Bluetooth on your phone and reconnect after 20 seconds.

Cannot monitor heart rate or blood oxygen.

Make sure that the optical monitoring sensor is in direct contact with your skin.

Cannot receive notifications after enabling it.

For Android users, please make sure that the device is connected to your phone. Set up notifications permission for the oraimo Health app in the phone system as well as in oraimo Health app settings. Add the oraimo Health app to the trust list if any security software installed prevents its functioning. For iPhone users, please make sure that the device is connected to your phone. Reboot your phone and try to reconnect.

Is the watch waterproof?

This watch has an IP68 rating. You can wear it while washing hands, having a cold shower, or washing a car. However, please do not wear it while diving.

Do I need to connect to the BT all the time? Will my health and sleep data be stored while it's disconnected?

The data will be kept on the watch for 7 days. When reconnected to the phone, your health and sleep data will be synced automatically. Please synchronize data in time to get maximized utility.

## Basic Product Specifications

- Display Screen: 1.83" TFT 240\*284
- BT Version: V5.2



- Battery Capacity: 300mAh
- Battery Type: Lithium polymer
- Charging Time: 3 hours
- Normal Using Time: 7 days
- Standby Time: 20 days
- Watch Size: 52.46\*38.8\*11.8mm (without strap)
- Weight: 40.5g (with strap)
- Material: ABS/PC/Silica Gel
- Waterproof: 1P68

## Customer Service

### 365 DAYS WARRANTY



### E-Mail

- India: [care@oraimo.com](mailto:care@oraimo.com)
- Nigeria: [care.ng@oraimo.com](mailto:care.ng@oraimo.com)
- Kenya: [care.ke@oraimo.com](mailto:care.ke@oraimo.com)
- Ghana: [care.gh@oraimo.com](mailto:care.gh@oraimo.com)
- Morocco: [care.ma@oraimo.com](mailto:care.ma@oraimo.com)
- Egypt: [care.eg@oraimo.com](mailto:care.eg@oraimo.com)
- South Africa: [care.za@oraimo.com](mailto:care.za@oraimo.com)
- Cameroon: [care.cmr@oraimo.com](mailto:care.cmr@oraimo.com)
- Tanzania: [care.tz@oraimo.com](mailto:care.tz@oraimo.com)
- UAE: [care.ae@oraimo.com](mailto:care.ae@oraimo.com)
- Ivory Coast: [care.ci@oraimo.com](mailto:care.ci@oraimo.com)
- Brazil: [care.br@oraimo.com](mailto:care.br@oraimo.com)
- Colombia: [care.co@oraimo.com](mailto:care.co@oraimo.com)
- Others: [service@carlcare.com](mailto:service@carlcare.com)

## Warranty Certificate

<b>Name :</b>	
<b>Address :</b>	
<b>Tel. No. :</b>	
<b>Date of purchase :</b> (dd/mm/yy)	
<b>Store name :</b>	
<b>Warranty period :</b>	

## Warranty Terms & Conditions

- All quality-related defects on items sold directly by Oraimo or Oraimo's authorized resellers are covered by an extensive warranty, starting from the date of purchase.
- oraimo's limited warranty is restricted to the country of purchase. The limited warranty is void on items taken outside the country they were originally bought in or shipped to directly from an authorized online purchase.
- This warranty covers only original oraimo products. It does not apply to normal wear and tear, or any defects arising from damage caused by misuse of this product.
- Warranty is for the primary product only nor transferable. Any free additional products) are not covered in this warranty.
- If the product fails regardless of usage in compliance with the instruction manual and other written precautions, replacement will be provided free of charge.
- To receive a replacement, bring the warranty certificate and the product itself to the store from where you have purchased the product.

## User Manual

Smart Watch

Model: OSW-803N

Hereby, ORAIMO TECHNOLOGY LIMITED

Declares that this Smart Watch is in compliance with the essential requirements and other relevant provisions of directive 2014/53/EU.

## CAUTION:

1. Risk of explosion if the battery is replaced by an incorrect type, dispose of used batteries according to the instructions.  
disposal of a battery into fire or a hot oven, or mechanically crushing or cutting of a battery, that can result in an explosion; leaving a battery in an extremely high temperature surrounding environment that can result in an explosion or the leakage of flammable liquid or gas; a battery subjected to extremely low air pressure that may result in an explosion or the leakage of flammable liquid or gas.
2. EUT Temperature: 0C ~ +45 C (Standalone). 5 C ~ +40 C (with adapter). Operating Frequency: BT: 2400-2483.5MHz (TX/RX); Modulation mode GFSK, π/4-DQPSK, 8DPSK (BT) GFSK (BLE) Max. Of Transmit power: BT(EDR): 4.23dBm BLE:1.06dBm

## EU DECLARATION OF CONFORMITY

1. in accordance with Annex VI of Directive 2014/53/EU of the European Parliament and of the Council

For the following Radio equipment:

- Model: OSW-803N
- Product: Smart Watch
- Trade name or Brand: oraimo
- Software / Hardware number: V1.1.5/ RH281L\_V02\_20220624

2. Name and address of the manufacturer or his authorized representative:

- Manufacturer: ORAIMO TECHNOLOGY LIMITED
- Address: FLAT N 16/F BLOCK B UNIVERSAL INDUSTRIAL CENTRE 19-25 SHAN MEI STREET FOTAN NT HONGKONG

3. This declaration of conformity is issued under the sole responsibility of the Manufacturer.

4. Object of the declaration (identification of the radio equipment allowing traceability; it may include a colour image of sufficient clarity where necessary for the identification of the radio equipment):

5. The object of the declaration described above is in conformity with the relevant Union harmonization legislation: Directive 2014/53/EU (RED)

6. References to the relevant harmonized standards used or references to the other technical specifications in relation to which conformity is declared:

- Article 3.1a Health:  
EN 62479:2010  
EN 50663:20171
- Article 3.1a Electrical Safety:  
EN62368-1:2014+A11:2017  
EN IEC 62368-1:2020+A11:2020
- Article 3.1b:  
ETSI EN 301 489-1 V2.2.3 (2019-11)  
ETSI EN 301 489-17 V3.2.4(2020-09)
- Article 3.2:  
ETSI EN 300 328 V2.2.2 (2019-07)

7. Notified Body Name: Eurofins Electrical and Electronic Testing NA, Inc.

Notified Body Number: 0980 Notified Body Assessment Performed: Module B/C on Article 3.1a, 3.1b and 3.2

Technical File Identification Number: N/A

8. Where applicable, a description of accessories and components, including software, which allow the radio equipment to operate as intended and covered by the EU declaration of conformity: User instructions are provided in the User Manual. The Software and Hardware versions are specified above.

**9. Additional information:**

Referring to Article 10.2 of the Directive, this equipment is so constructed that it can be operated in all Member States, without infringing applicable requirements. In order to receive, there are no restrictions on putting this equipment into service or of requirements for authorization of use.

Please refer to the User Manual for details.

**1. On behalf of:**

Manufacturer: ORAIMO TECHNOLOGY LIMITED

Address: FLAT N 16/F BLOCK B UNIVERSAL INDUSTRIAL CENTRE 19-25

SHAN MEI STREET FOTAN NT HONGKONG (place and date of issue): Shenzhen, 2024-04-16 (name,

function): YangDaozhuang/ Manager (signature):



(Name and signature of person responsible)

## FCC

### FCC Caution:

Labeling requirements.

This device complies with Part 15 of the FCC Rules. Operation is subject to the following two conditions:

1. This device may not cause harmful interference.
2. This device must accept any interference received, including interference that may cause undesired operation.

### Information to user

Any changes or modifications not expressly approved by the party responsible for compliance could void the user's authority to operate the equipment.

**Note:** This equipment has been tested and found to comply with the limits for a Class B digital device, pursuant to Part 15 of the FCC Rules. These limits are designed to provide reasonable protection against harmful interference in a residential installation. This equipment generates uses and can radiate radio frequency energy and, if not installed and used in accordance with the instructions, may cause harmful interference to radio communications. However, there is no guarantee that interference will not occur in a particular installation. If this equipment does cause harmful interference to radio or television reception, which can be determined by turning the equipment off and on, the user is encouraged to try to correct the interference by one or more of the following measures:

- Reorient or relocate the receiving antenna.
- Increase the separation between the equipment and the receiver.
- Connect the equipment into an outlet on a circuit different from that to which the receiver is connected.
- Consult the dealer or an experienced radio/TV technician for help

Note: This device and its antenna(s) must not be co-located or operated in conjunction with any other antenna or transmitter.

### RF Exposure Statement

The device has been evaluated to meet general RF exposure requirements.  
The device can be used in portable exposure conditions without restriction

**For more information, please visit:**



[www.oraimo.com](http://www.oraimo.com)

## Documents / Resources



[oraimo OSW-803N Smart Watch](#) [pdf] User Guide  
2AXYP-OSW-803N, 2AXYPOSW803N, osw 803n, OSW-803N Smart Watch, OSW-803N, Smart Watch, Watch

## References

- [User Manual](#)

[Manuals+](#), [Privacy Policy](#)

This website is an independent publication and is neither affiliated with nor endorsed by any of the trademark owners. The "Bluetooth®" word mark and logos are registered trademarks owned by Bluetooth SIG, Inc. The "Wi-Fi®" word mark and logos are registered trademarks owned by the Wi-Fi Alliance. Any use of these marks on this website does not imply any affiliation with or endorsement.