



oraimo OIM-812A Nugget Ice Maker User Guide

[Home](#) » [oraimo](#) » oraimo OIM-812A Nugget Ice Maker User Guide 

oraimo OIM-812A Nugget Ice Maker User Guide



Contents

- 1 Product Instruction
- 2 CONTROL BUTTONS
- 3 LED DISPLAY
- 4 GETTING STARTED
- 5 AUTOMATIC REFILLING
- 6 SELF-CLEANING
- 7 REGULAR CLEANING
- 8 REMOVAL OF SCALE /MINERAL BUILD-UP
- 9 Documents / Resources
 - 9.1 References
- 10 Related Posts

Product Instruction



This ice maker may have been tilted or placed upside down during transportation. Please set it upright for at least 2 hours before initial use to allow the refrigerant fluid to settle.

FRONT

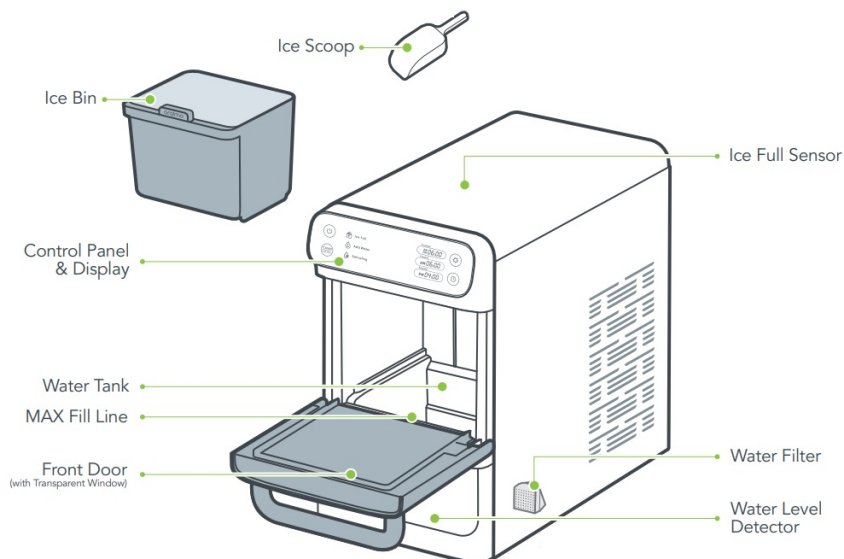

REAR

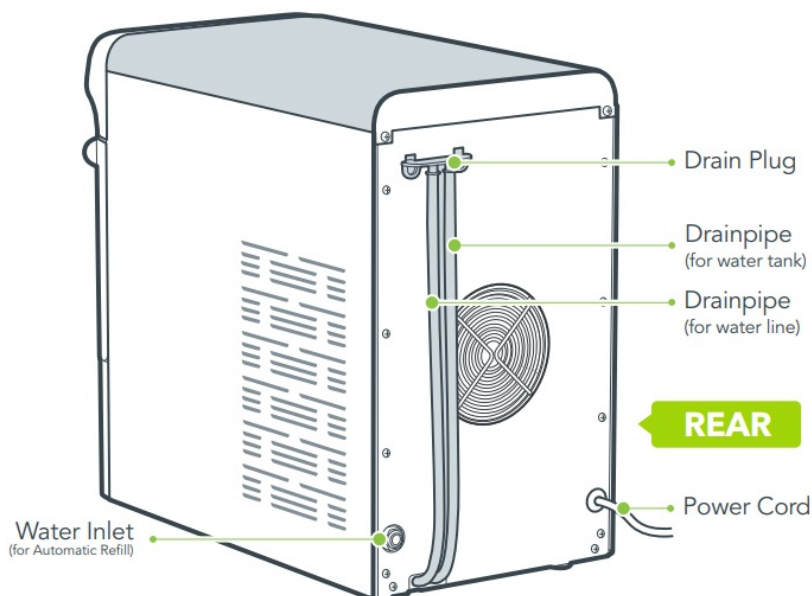

Inlet Pipe (9.8ft. / 3m)



CONTROL BUTTONS



ON/Standby

- Press to start making ice or turn the unit off (standby mode).



- Stays solid on during ice making cycle

- Preset time setting is available under both ice making and standby mode. When pressing



or





under standby mode, the display will turn off if no other operation is done in 1 min.



Self-cleaning

- Hold for 3s to start or cancel self-cleaning cycle

- For each cleaning cycle, the ice maker auto cleans for the first 3mins ( stays on). After 3mins,  will flash quickly for 5mins to confirm whether to deep clean the unit. If yes, press to  confirm. If no operations is done in 5mins, the cleaning cycle will stop automatically

- Once cleaning is done or cancelled, the ice maker will enter standby mode.

- After continuous running for 100 hours,  will flash slowly for 30s to remind you to clean the ice maker. Hold for 3s to start cleaning.



Preset/Current Time Setting

- Press to enter Current/Preset 1/ Preset 2 time setting. With the time flashing, press  to adjust the specific time in 5s
- The preset time is the time that the ice making cycle starts. To cancel preset time setting, hold for 3s.

- If power is disconnected, the current time will be remembered  for 90 days.



Time Adjustment

- After entering preset/ current time setting, press to adjust the time period, hour or minute.
- During preset time setting, press until — displayed to cancel.
- If power is disconnected, the preset time will always be remembered.

LED DISPLAY



Ice Bin Full

Indicator stays solid on when ice bin is full. Remove ice in time.



Add Water

Indicator stays solid on when tank is lack of water. Add water in time.



Defrosting

Indicator stays solid on during auto defrosting (30-45mins). The buttons are not responsive during defrosting. Once completed, the ice making cycle will start automatically.

Current



Current Time

(AM 12:00~11:59/
PM 12:00~11:59)

Preset 1



Preset Time 1

(AM 12:00~11:59)

Preset 2



Preset Time 2

(PM 12:00~11:59)



GETTING STARTED



Make sure the drain plug is firmly inserted before use.

The ice maker will stop making ice when the ice bin has been pulled out for more than 5mins. Once pulled out, remember to place it back within 5 mins to continue the ice making cycle.

Locate and Clean

Locate upright on a flat, level surface with at least 6 inches of clearance on the sides and back. Clean the tank, ice bin and ice scoop, then settle for at least 2 hours before first use.

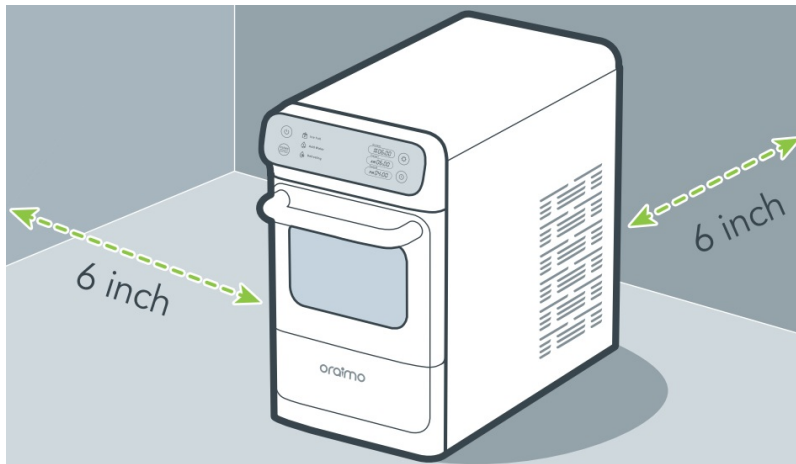

Add Water Manually

Open the front door and pull the ice bin out. Fill the water tank with potable water below MAX line. Place the ice bin back and close the door.

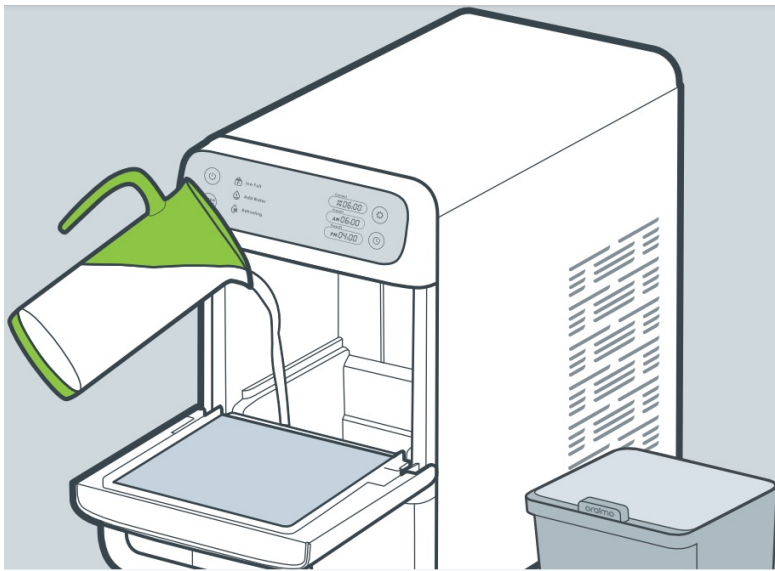

- Recommended water type: distilled or demineralized water (hardness 12 grains per gallon) at 40~82°F.

Start Making Ice

Plug into a properly installed grounded outlet, then press button to start ice making cycle. It will keep making ice until the ice bin is full.

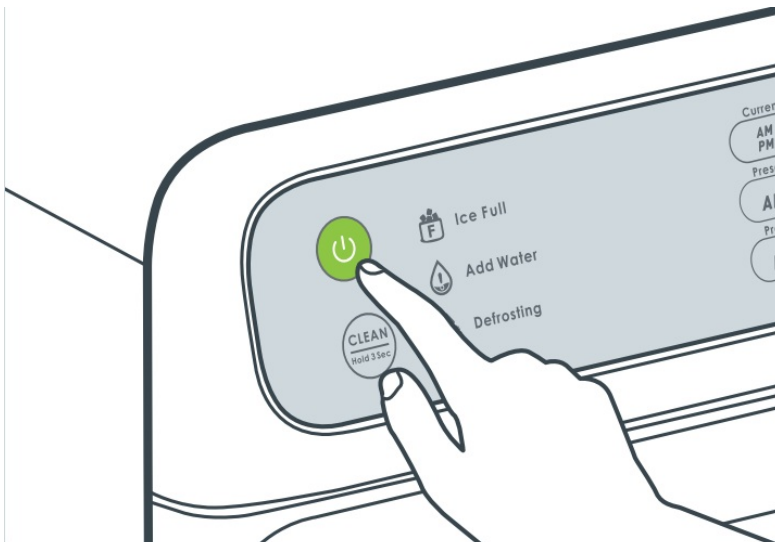

Scoop Ice Out

The ice maker will start to produce ice in 15 minutes. Scoop the ice cubes out once made. Put in use or store in freezer to avoid melting.



- If the ice bin is placed back in 5mins, the ice maker will continue making ice.

AUTOMATIC REFILLING



To add water automatically, connect the included hose to the water supply system as instructed. An adapter (not included) may be required as per the type of water supply system in your home.

To avoid overflow of water, do not add water manually when the ice maker is already connected to the water supply system.

Insert the Hose



- Fully insert the included hose into the water inlet till the end is reached.
- To remove, hold against the gray ring and pull out.

Connect with Water Supply System

Connect the other end with water supply system. A 1/4" connector may be required.

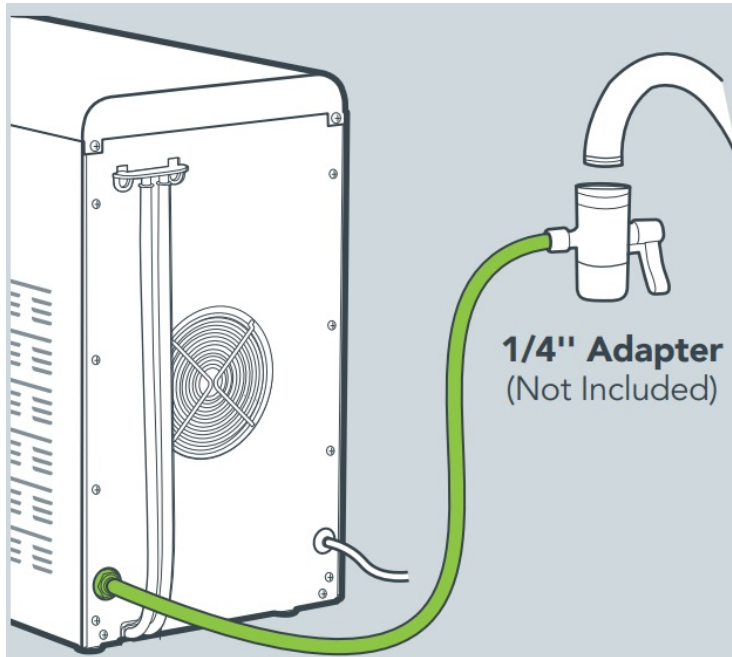

- It is recommended to connect with water filtration system to avoid blockage by scale or mineral build-up



SELF-CLEANING



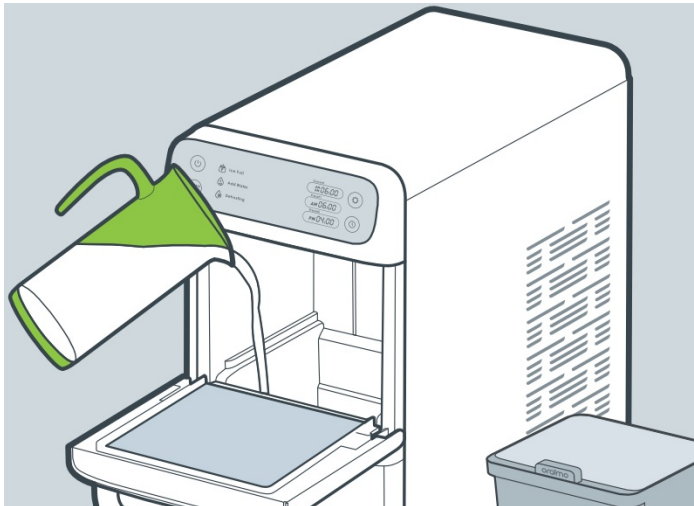

To keep your nugget ice tasting fresh, we recommend that you carry out self-cleaning at least once every 1 to 2 weeks.

Fill the tank with water below MAX line or connect with water supply system.





Hold  for 3s to start a self-cleaning cycle. The ice maker auto cleans for the first 3mins ( stays on).

After 3mins,  will flash quickly for 5mins to confirm whether to deep clean the unit. If yes, press  to confirm. If no operations is done in 5mins, the cleaning cycle will stop automatically

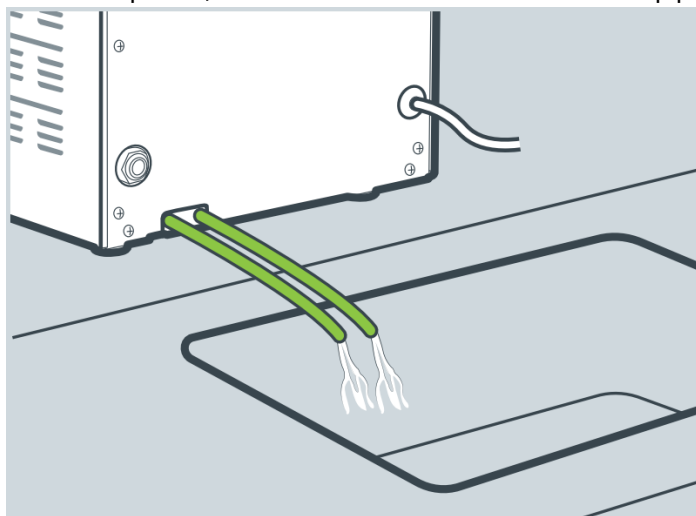

Once completed, will turn off. Unhook the drainpipe and lay down to a sink.



- To resume ice making, press  again.

REGULAR CLEANING







1. Unplug and take out the ice bin. Remove the water filter on the right corner of the tank.
2. Rinse clean the ice bin and water filter with diluted detergent and warm water.
3. Clean the water tank with diluted detergent, warm water and a soft cloth. Add water to rinse and drain out the water.
4. Gently wipe the exterior with a soft, damp cloth.

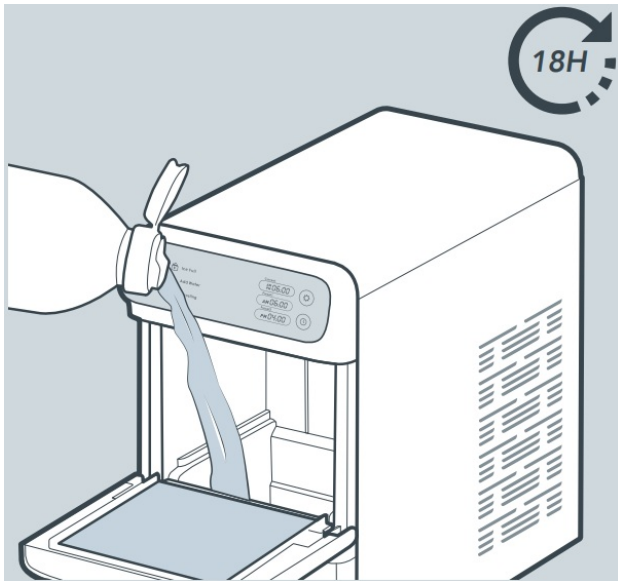

To remove the fallen dirt or fibers, D we recommend cleaning the ice bin and water tank once a week.
Unplug before cleaning

REMOVAL OF SCALE /MINERAL BUILD-UP



1. Fill the water tank with warm water (around 90°F) below MAX line.
2. Add in distilled white vinegar or ice maker cleaner. Set aside for at least 18 hours.
3. Hold  for 3s to start self-cleaning cycle. If  flashes, press  to continue. Repeat for at least 3 cleaning cycles.
4. Drain the mixture and continue running 3 cleaning cycles with fresh water for each rinse.



For scale or mineral build-up. follow the directions to deep clean periodically or when needed. Do not clean with solvents or chemicals

When not in use for an extended period of time, drain the water tank and clean as instructed. Cover and store in a cool, dry location away from direct sunlight.



[oraimo OIM-812A Nugget Ice Maker](#) [pdf] User Guide
OIM-812A Nugget Ice Maker, OIM-812A, Nugget Ice Maker, Ice Maker, Maker

References

- [User Manual](#)

Manuals+.