



OPT7 Tailgate Warning LED Light Bar Instruction Manual

[Home](#) » [OPT7](#) » OPT7 Tailgate Warning LED Light Bar Instruction Manual 

OPT7[®]

WARNING
LIGHT BAR
INSTALLATION GUIDE
Tailgate

Contents

- 1 What's included
- 2 INSTALLATION
- 3 HOW TO USE
- 4 DISCLAIMER
- 5 Documents / Resources
 - 5.1 References

What's included

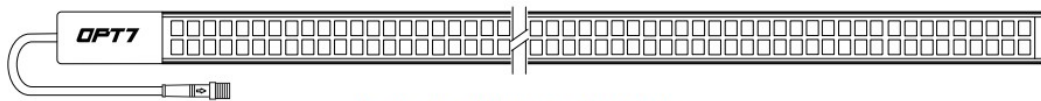

Tailgate Warning Light Bar



Keychain Remote

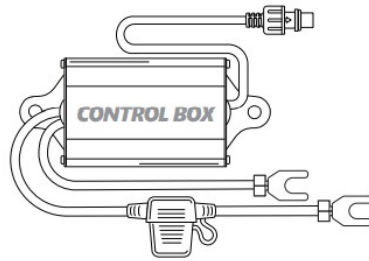

Control Box

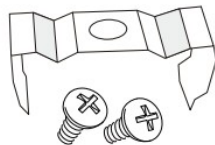

Mounting
Brackets



Adhesive
Booster

INSTALLATION

Example

Recommendation for methods and location

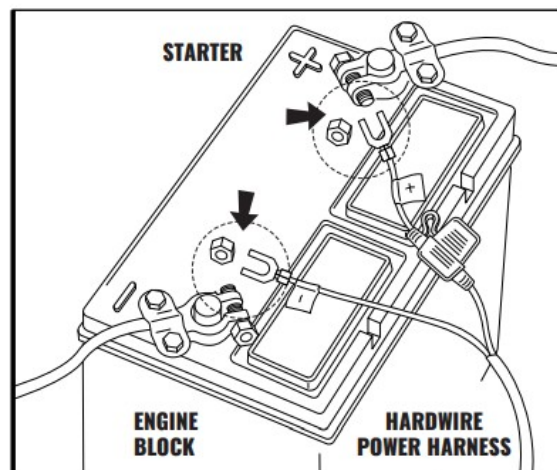
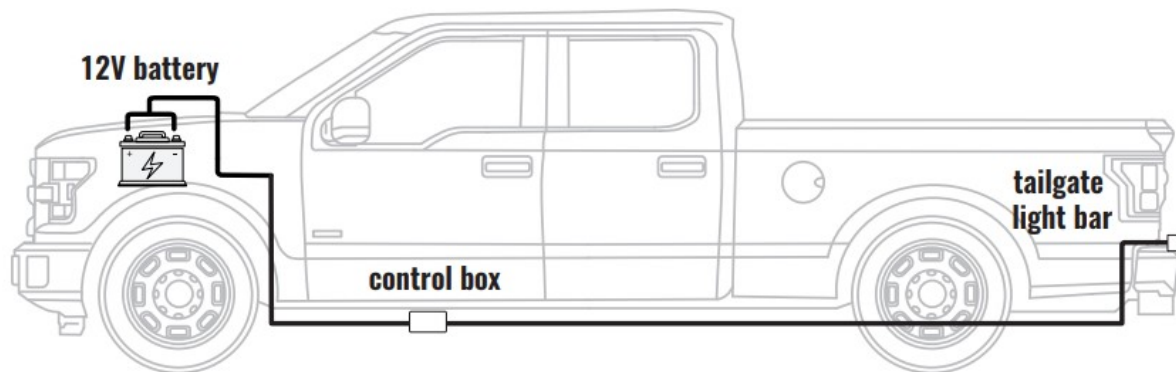

HOW TO CONNECT POWER HARNESS TO YOUR VEHICLE

- Connect the Red wire (+) of power harness to the vehicle battery's positive terminal.
- Connect the Black wire (-) of power harness to the vehicle battery's negative terminal or an unpainted area on your vehicle's frame.

⚠ WARNING

1. Connecting to more than 10 AMP will override the kit and cause early failure, ensure it is 10AMPs or less!!
2. Please ensure that the LED bars or strips/control box/wiring all are mounted in areas where will not exceed 85°C or 185°F.

⚠ IMPORTANT ⚠

BE SURE TO CONFIRM THE CORRECT DIRECTION OF THE ARROW!!
TO AVOID PRODUCT DAMAGE DUE TO INCORRECT INSTALLATION.

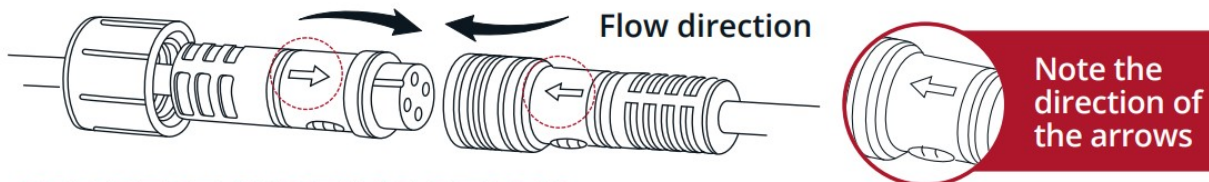

CORRECT INSTALLATION

STEP1

Test the Light Bar by attaching the wires to the battery before installing onto the vehicle.

STEP2

The Tailgate Light Bar requires a flat surface for installation.

*Recommend making necessary measurements prior to the installation.

STEP3

Thoroughly clean the area where the LED Bar will be mounted.

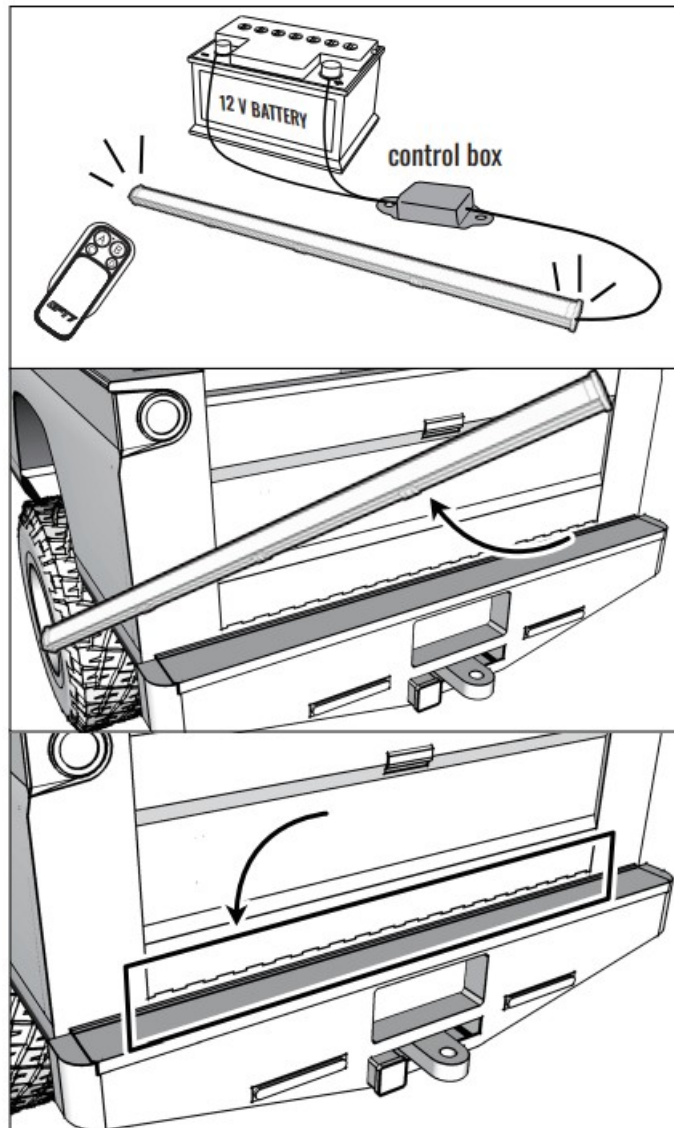

STEP4

OPTION 1

Apply the Adhesive Booster to the cleaned area.

STEP5

1. Peel the back off of adhesive on each end of the LED bar.
2. When this is all done, hold the LED bar with both hands and apply firmly to the cleaned area.

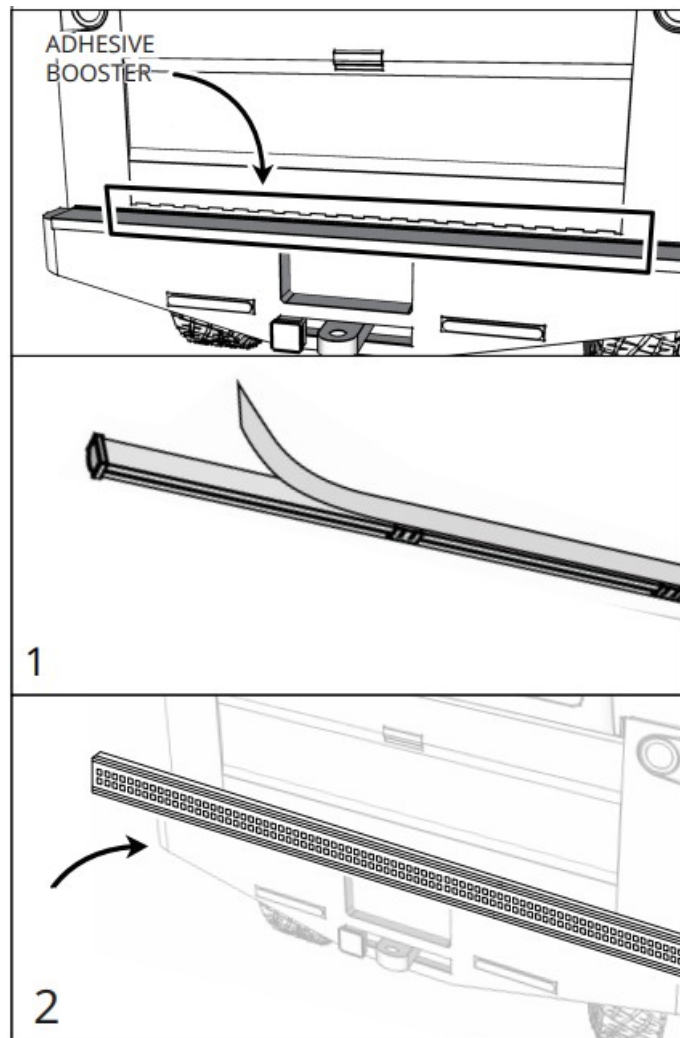

STEP4

OPTION 2

For optimal installation of the LED Bar, carefully plan and mark the desired bracket mounting locations, taking placement into consideration to ensure a straight application.

STEP5

Securely mount the LED Bar to your vehicle using the provided screws and clips to ensure a solid installation.

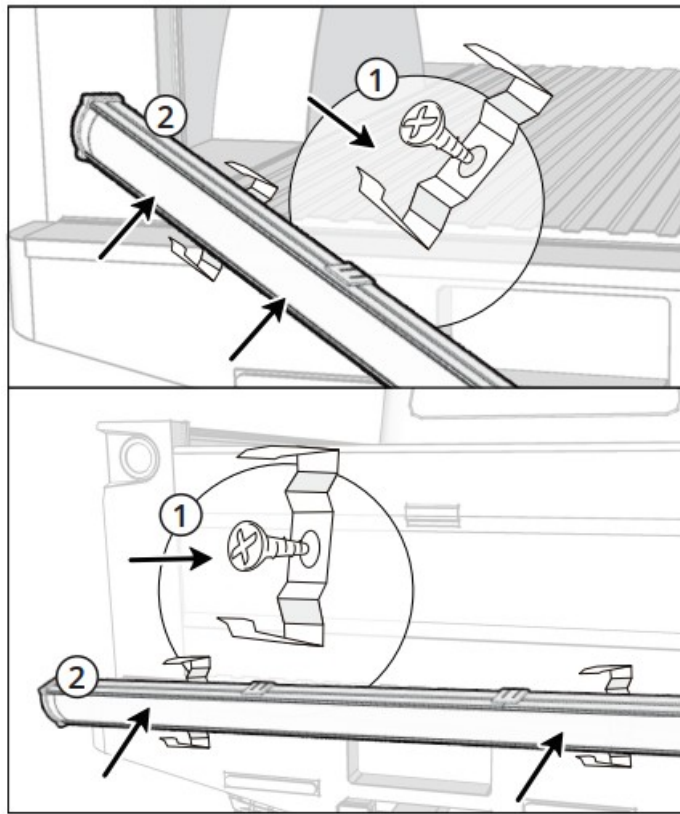

HOW TO USE

THE WARNING MODE LIGHTING FUNCTIONS

Press the "A" button to enable the warning light function. You may easily switch between modes using the B,C,D on the RF remote.

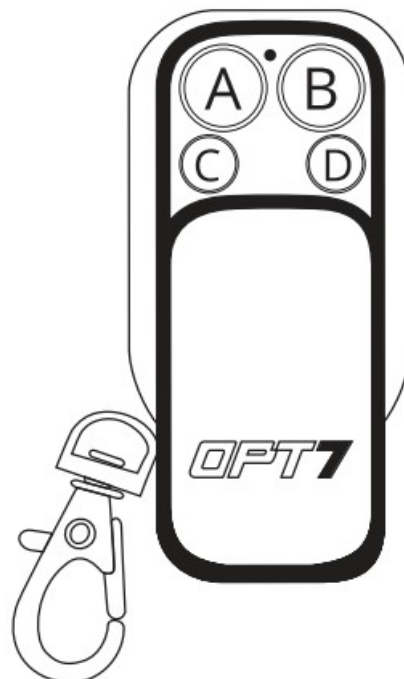

- A Power ON/OFF
- B Speed Adjust (5 Speed Option)
- C Mode Up (12 Level)
- D Mode Down (12 Level)

NOTES

1. When you use this product, keep it within 10m/33ft as much as possible.
2. When the warning light is turned on, the vehicle signals reception will be temporarily disabled. It won't be

restored until you turn it off.

DISCLAIMER

OPT7 Lighting is not liable for damages, injuries, or death while installing this product. The Installation Guide is intended as assistance to reduce setup time. OPT7 Lighting assumes no responsibility for improper installation. If you are unfamiliar with your vehicle or inexperienced with aftermarket upgrades, please seek professional assistance.

OPT7 recommends installation for safety and guidance.

Modified installations or installation recommendations not specified by OPT7 Lighting will void product warranty.

1 YEAR WARRANTY



Documents / Resources

 A thumbnail image of the product's installation guide. It features the 'OPT7 TAILGATE WARNING LIGHT BAR' logo at the top, followed by 'INSTALLATION GUIDE' and 'WHAT'S INCLUDED'. Below this, there are small icons representing the light bar, mounting brackets, and wiring components.	<p>OPT7 Tailgate Warning LED Light Bar [pdf] Instruction Manual</p> <p>Tailgate Warning LED Light Bar, Tailgate, Warning LED Light Bar, LED Light Bar, Light Bar, Bar</p>
--	---

References

- [User Manual](#)