



OPT7 Redline Triple LED Tailgate Bar Rear Sensor Installation Guide

[Home](#) » [OPT7](#) » OPT7 Redline Triple LED Tailgate Bar Rear Sensor Installation Guide 

Contents

- [1 OPT7 Redline Triple LED Tailgate Bar Rear Sensor](#)
- [2 DISCLAIMER](#)
- [3 WHAT'S INCLUDED](#)
- [4 INSTALLATION](#)
- [5 Documents / Resources](#)
- [6 Related Posts](#)



OPT7 Redline Triple LED Tailgate Bar Rear Sensor



DISCLAIMER

OPT7 Lighting is not liable for damages or personal injuries while installing this product. The Installation Guide is intended as assistance to reduce setup time. OPT7 Lighting assumes no responsibility for improper installation. If

you are unfamiliar with your vehicle or inexperienced with aftermarket upgrades, please seek professional assistance.

WHAT'S INCLUDED

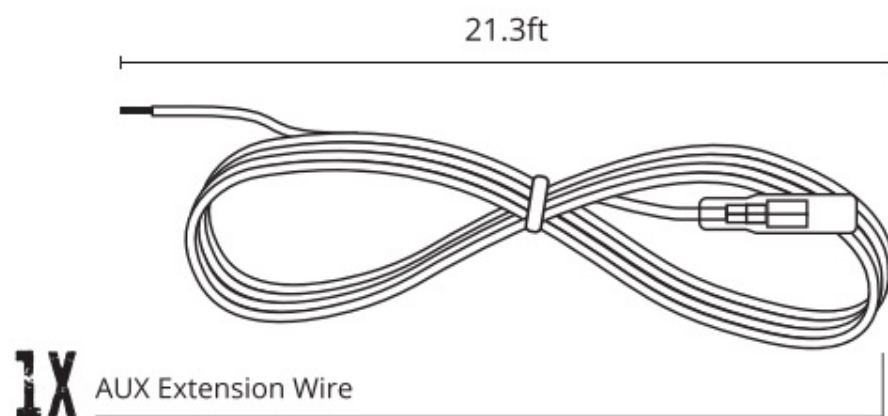
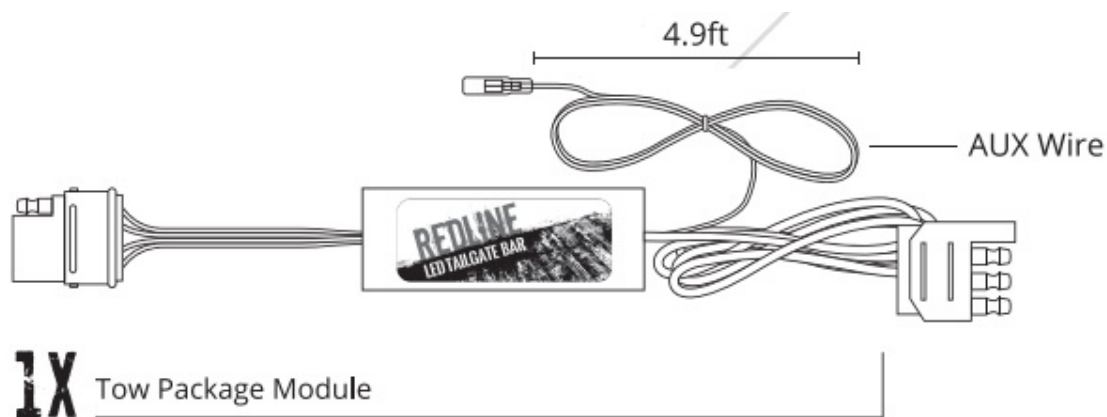

INSTALLATION

OPTION 1

STEP1

Tailgate Light Bar

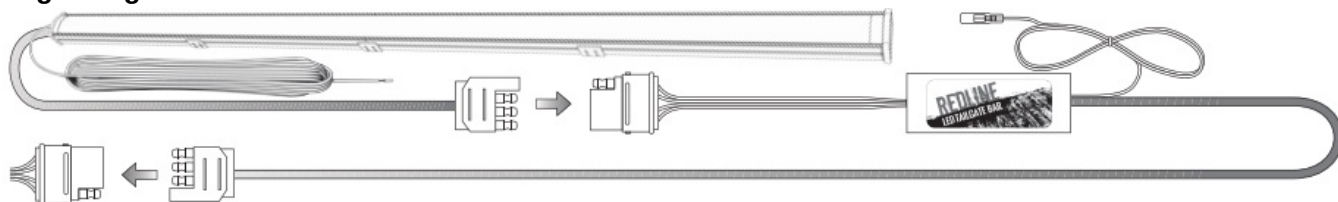

- Grab your "Tow Package Module Wires" and connect one end to your tailgate light bar and the other end to 4-way flat extension wire.

STEP2

AUX Extension Wire

STEP2

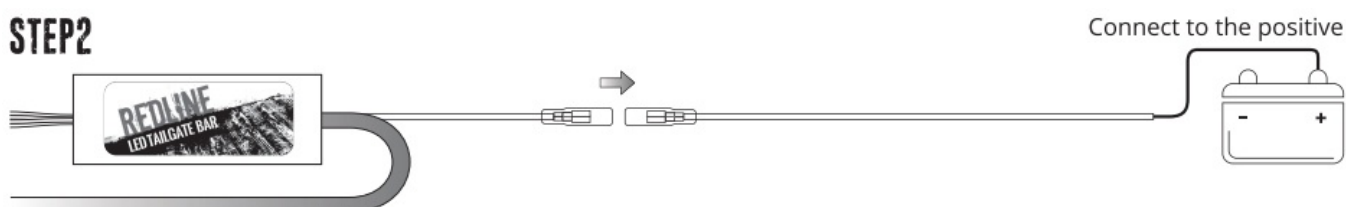

- Next, find the “AUX Extension Wire” we have provided and connect one end to the red wire connector on the tow package module and the other end to the battery 12V(+) position of your vehicle to power your light bar.

OPTION 2

7-Way Trailer Plug Wiring

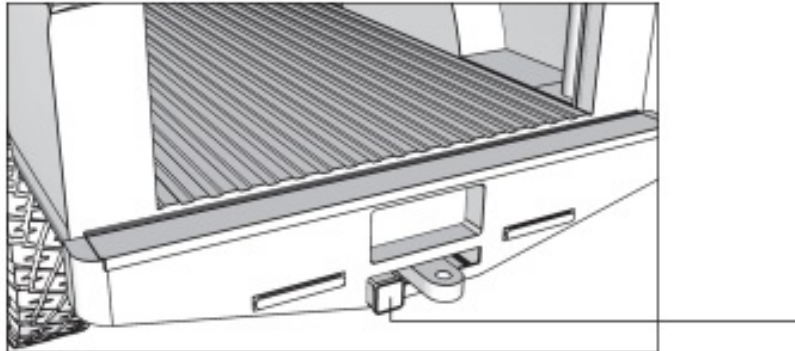

If your vehicle have a 7-way trailer outlet, you can directly connect the “AUX Red Wire” to the “AUX 12V(+)” to power the light bar.

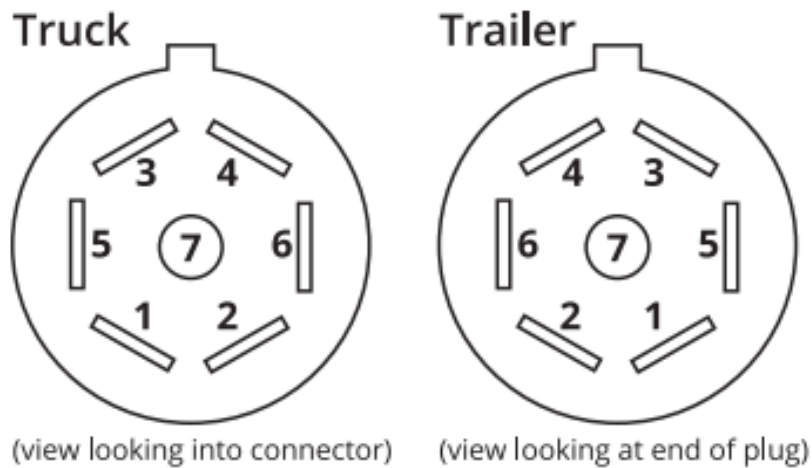

1. Ground
2. Trailer Brakes
3. Tail/ Running Lights
4. AUX 12V(+) Charging
5. L Turn/ Stop Lights
6. R Turn / Stop Lights
7. Backup Lights

Documents / Resources

	<p>OPT7 Redline Triple LED Tailgate Bar Rear Sensor [pdf] Installation Guide</p> <p>Redline Triple LED Tailgate Bar Rear Sensor, Triple LED Tailgate Bar Rear Sensor, Tailgate Bar Rear Sensor, Rear Sensor, Sensor</p>
--	---

