

OPT7[®]
Glow
Application



OPT7 Glow Application User Guide

[Home](#) » [OPT7](#) » OPT7 Glow Application User Guide 

Contents

- 1 OPT7 Glow Application
- 2 Product Usage Instructions
- 3 HOW TO DISCONNECT
- 4 DEVICE SETTING
- 5 FAQs
- 6 Documents / Resources
 - 6.1 References

OPT7[®]

OPT7 Glow Application



Specifications

- Product Name: OPT7 GLOW
- Sensitivity: 100
- Compatibility: Supports car media system with Bluetooth and Android Auto (not compatible with Apple Carplay)

Product Usage Instructions

Device Settings:

To edit device settings, slide the device to the left to find “Edit” and click on it to access the setting page.

RGB Mode:

This mode allows you to customize RGB settings for your lights.

Rhythm Mode:

In this mode, lights sync with music or sound rhythms for a dynamic lighting effect.

Light Mode:

This mode offers various presets for different lighting effects.



NOTICE OPT7 GLOW supports the car media system with Bluetooth and Android Auto, but does not support Apple Carplay.

How TO CONNECT

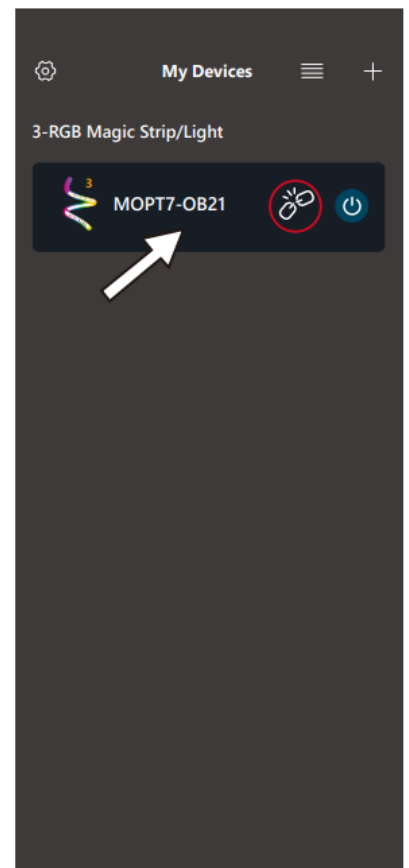
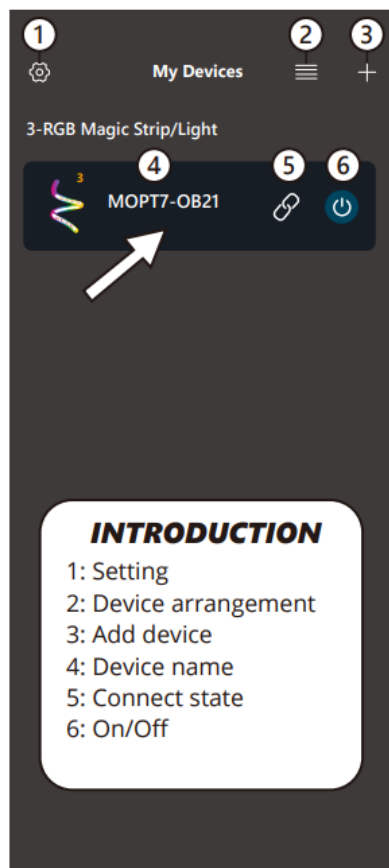
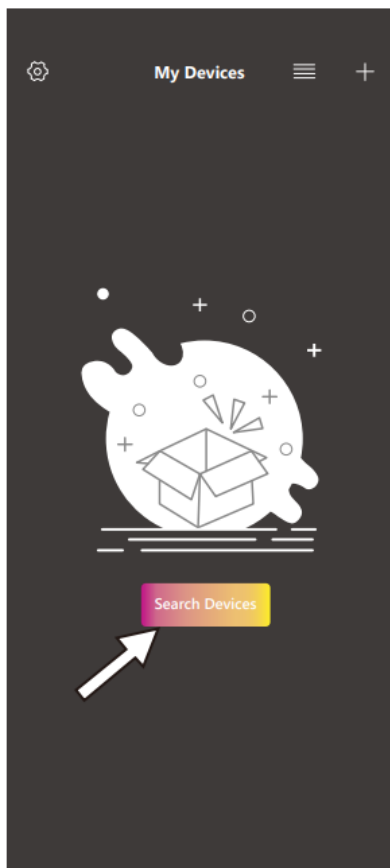

• STEP 1

First view the OPT7 GLOW. After installing the OPT7 light Kits, open the OPT7 GLOW and keep the Bluetooth open then click “Search Devices” to connect.

• STEP 2

OPT7 GLOW will detect OPT7 light Kits automatically. Click the device into the light control mode.

• NOTICE

If the OPT7 GLOW shows the icon , which means the device is not connected. Please click this icon again or check if the Bluetooth and the OPT7 light kits work normally.

IMPORTANT

- On the Android system, it needs to allow the Nearby Devices Permission to search the devices.
- OPT7 GLOW connects a maximum of 4 devices.
- If there is no device on the list, please check the Auto Add Devices. (See more system settings on the page 3.)

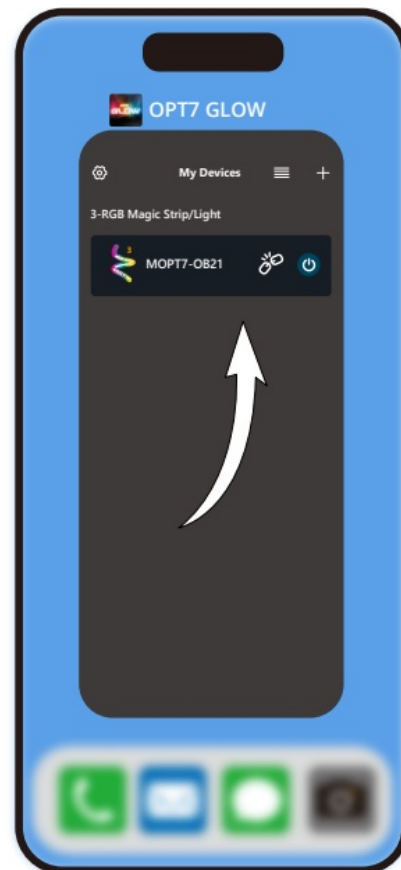
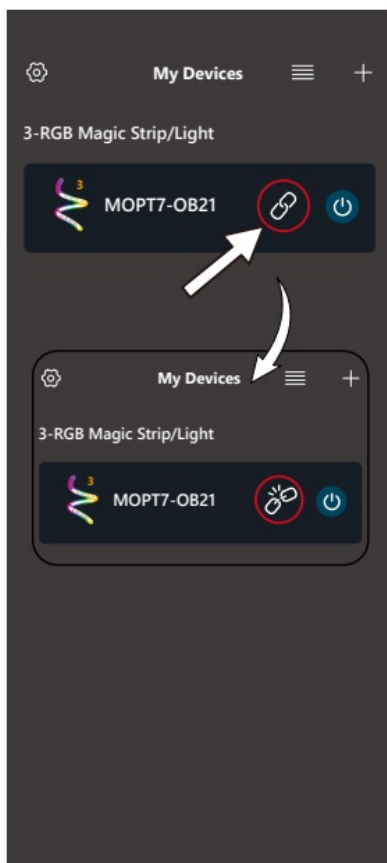
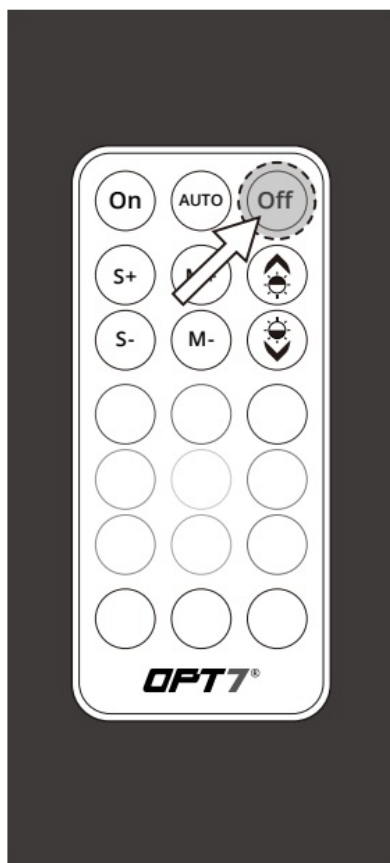

HOW TO DISCONNECT



- **STEP 1**

Use the remote control to disconnect the OPT7 light kits. *need to align the control box

- **STEP 2**

To disconnect the OPT7 light kits . Click the icon  to  .

- **STEP3**

Ensure the OPT7 light kits are turned off using the remote control. Then, disconnect the OPT7 GLOW and slide the App out to power it off.

IMPORTANT

Turning off the OPT7 GLOW completely helps avoid excessive battery consumption and extends the lifespan of the OPT7 light kits.

System SETTINGS

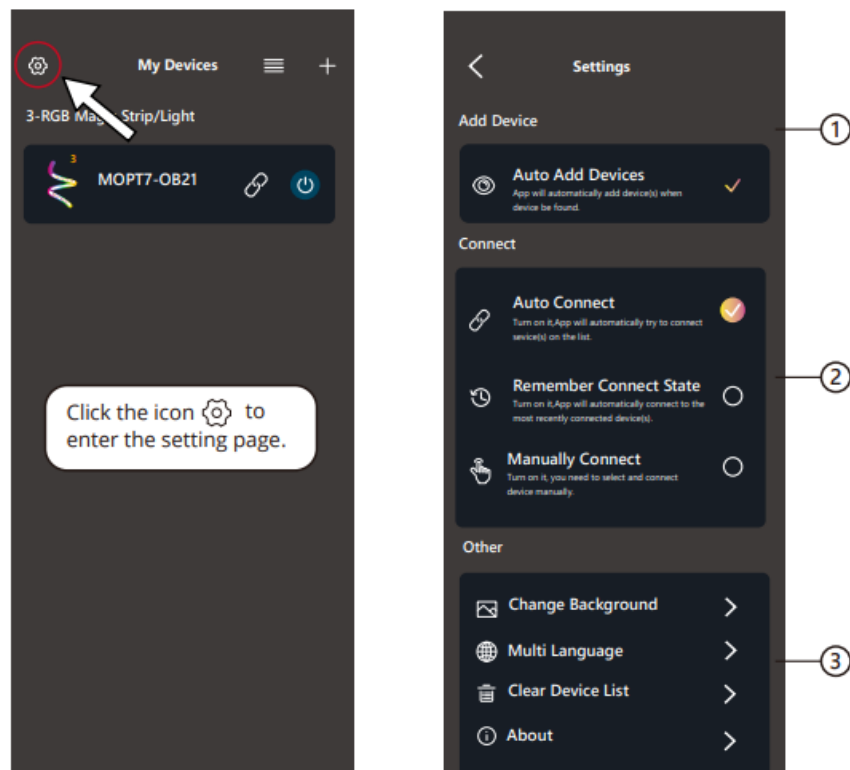

1. INTRODUCTION 1

- OPT7 GLOW will detect the OPT7 light kits automatically.
- Recommended to enable the function

2. INTRODUCTION 2 Auto Add Devices:

- OPT7 GLOW will connect all devices on the list.
- Remember Connect State OPT7 GLOW will remember the last connected device(s) and light mode.
- Manually Connect
- OPT7 GLOW will not connect any devices until choosing one.

3. INTRODUCTION 3 Other settings:

Customized settings, including background, language, and clear device list.

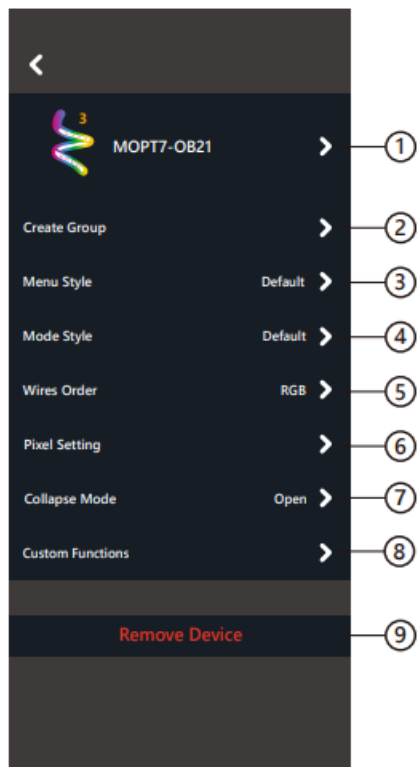
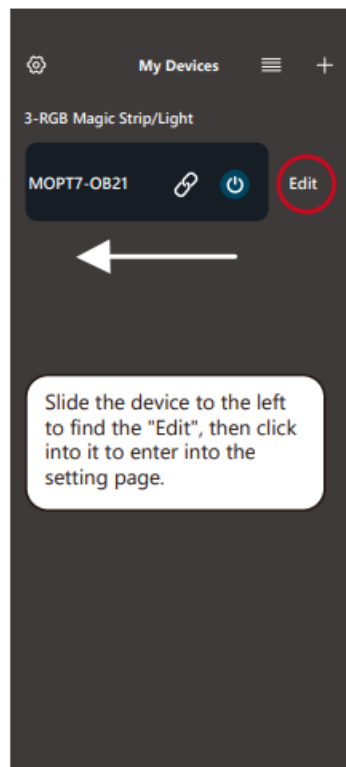

INTRODUCTION

1. Device setting (Icon /name)
2. Group setting
3. Menu Style setting (Default/Tab Bar/Beehive)
4. Light Mode Style (Default/GIF/Text)
5. Wire Setting (Adjust RGB order)
6. Pixel Setting (Not support)
7. Collapse Mode (Not support)
8. Custom Functions (Not support)
9. Remove Device (Clear and forget the device)

DEVICE SETTING

How To Rename the Devices and Create a Group

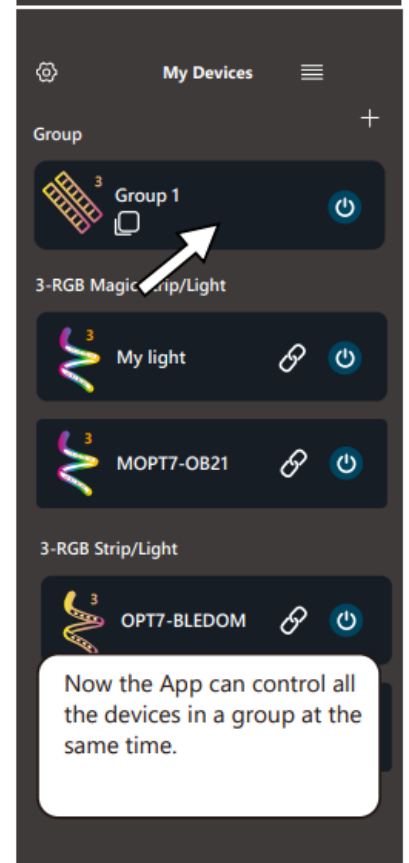
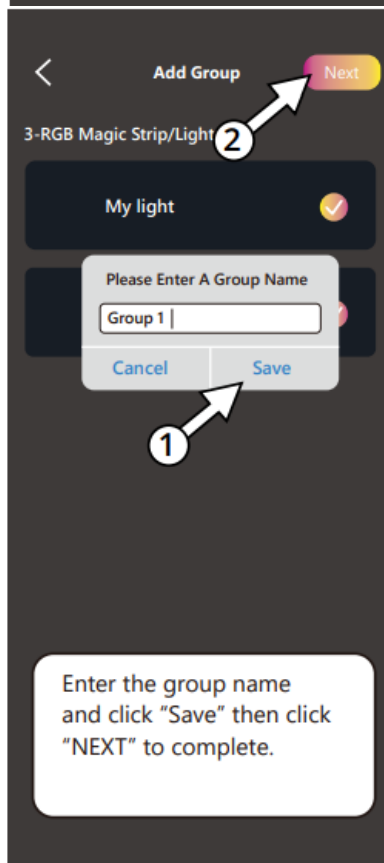
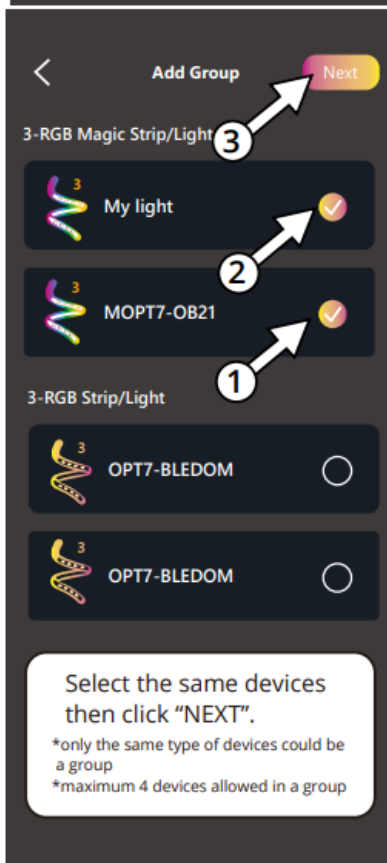
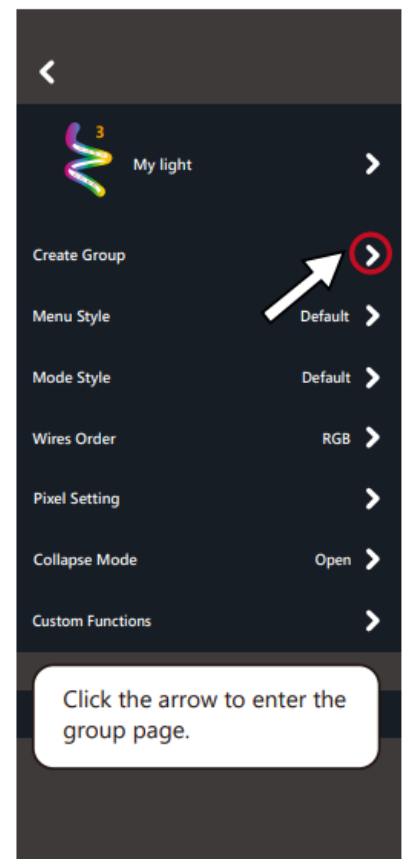
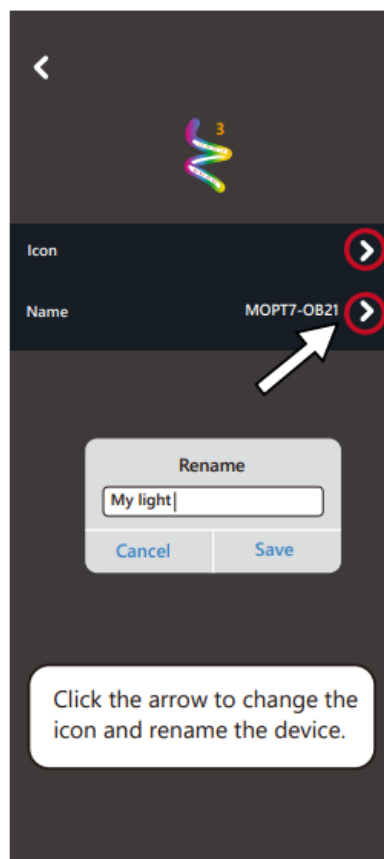
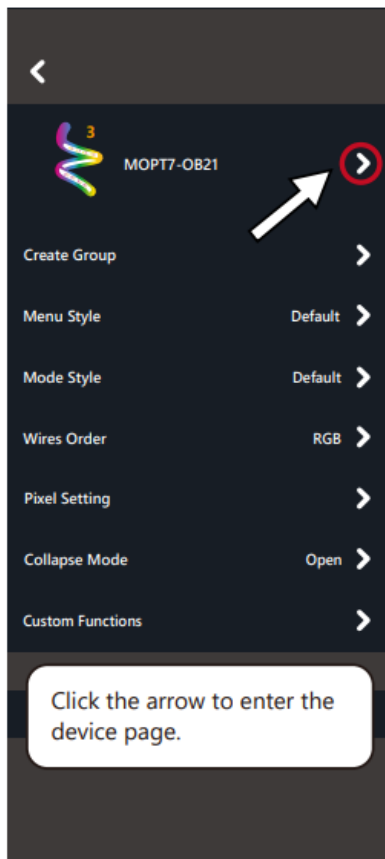

RGB MOOD

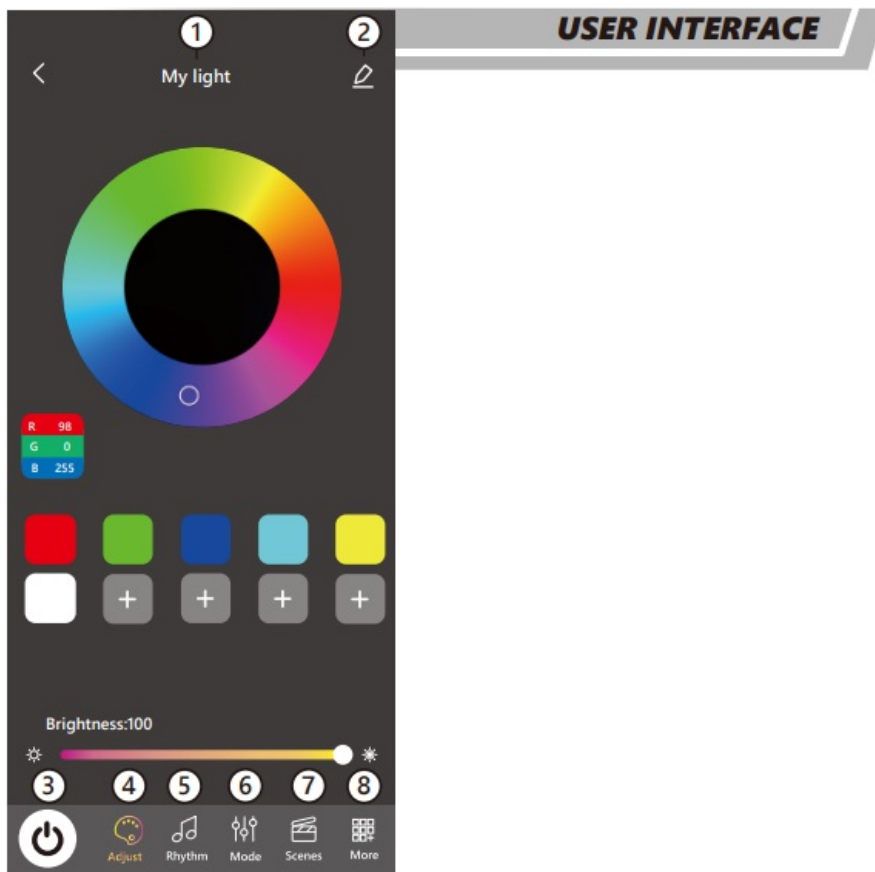

INTRODUCTION

1. Device name
2. Device setting
3. On/Off
4. RGB mode
5. Rhythm mode
6. Light mode
7. Scenes mode
8. More information

RGB MODE

INTRODUCTION

1. Touch to choose color
2. Shortcut color (6 color)
3. Favorite color (4 color) (click + then choose a color to create a shortcut; press the shortcut to delete)
4. Brightness adjust (0-100)

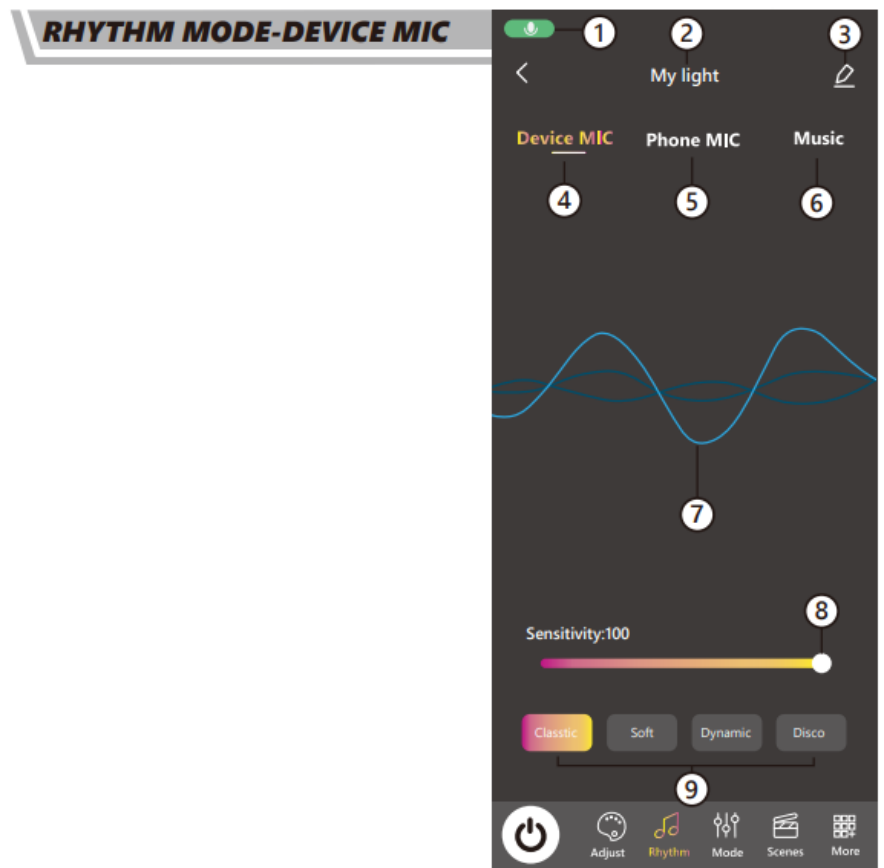
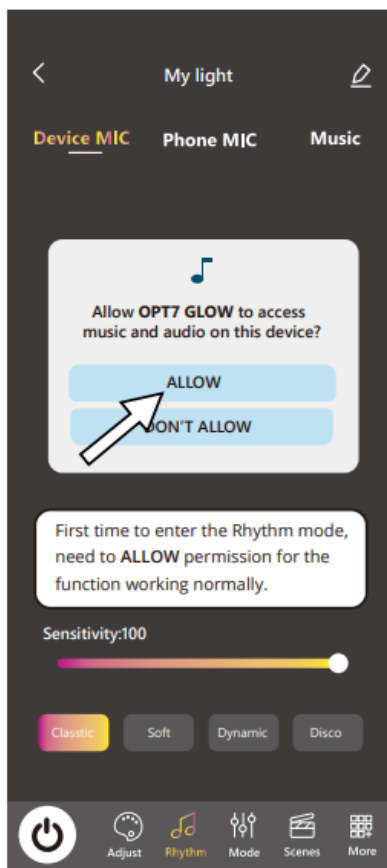

RHYTHM MODE-DEVICE MIC

INTRODUCTION

1. Cellphone MIC is receiving (Not all cellphone support)
2. Device name
3. Device setting
4. Device MIC (use the control box of the OPT7 light kits to receive)
5. Phone MIC (use the cellphone to receive)
6. Music MIC (use the cellphone music)
7. Sound wave (changes with the audio)
8. Record sensitivity adjust (0-100)
9. Light effect (4 modes)

*Not all OPT7 light Kits support the device MIC function.

RHYTHM MODE

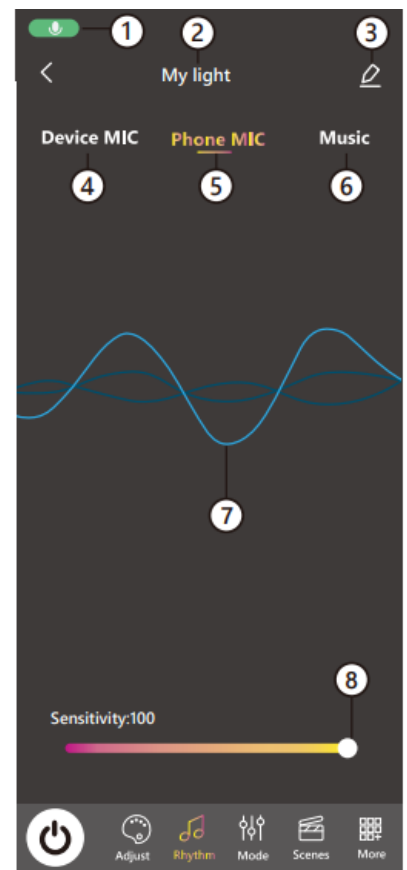
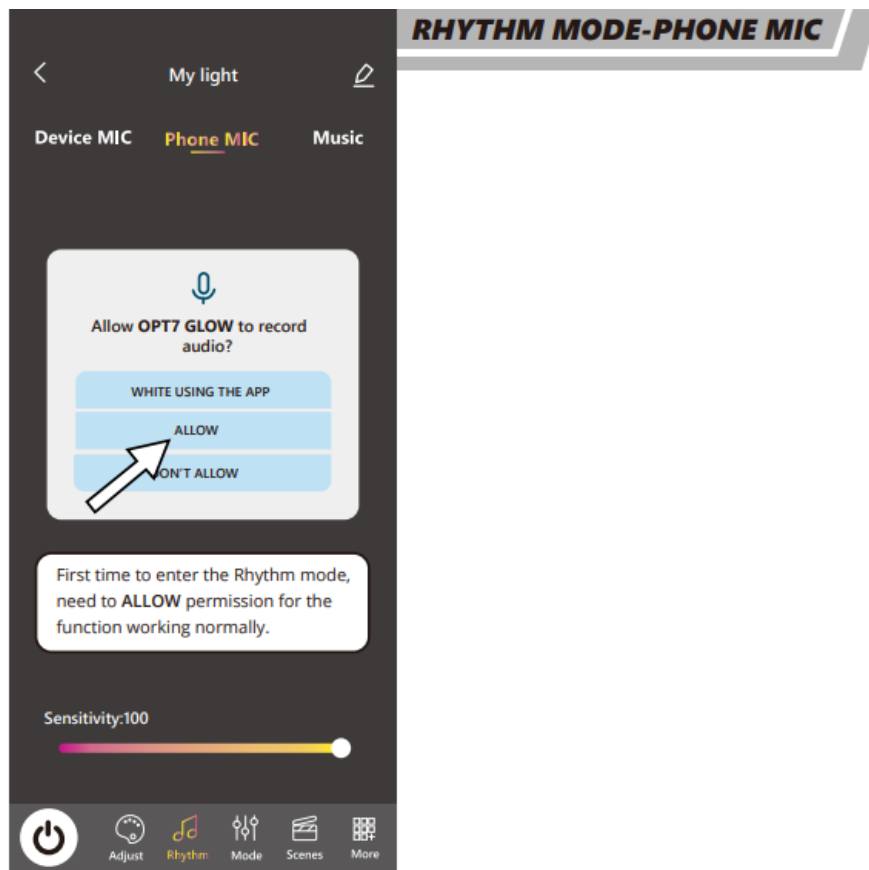

INTRODUCTION

1. Cellphone MIC is receiving (Not all cellphone support)
2. Device name
3. Device setting
4. Device MIC (use the OPT7 light to receive)
5. Phone MIC (use the cellphone to receive)
6. Music MIC (use the cellphone music)
7. Sound wave (changes with the audio)
8. Radio sensitivity adjust

IMPORTANT

- The Phone MIC supports Android Auto only
- When using the Phone MIC, users must enable the background permissions.
- Phone MIC supports only a device or a group at once.

RHYTHM MODE-MUSIC MIC

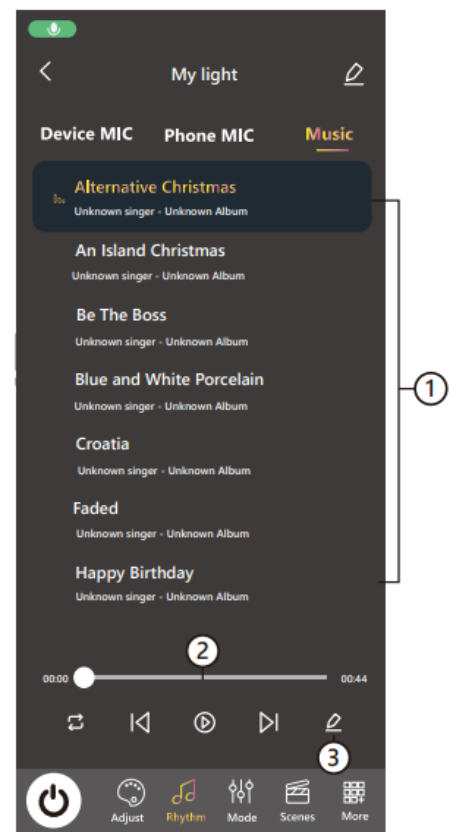
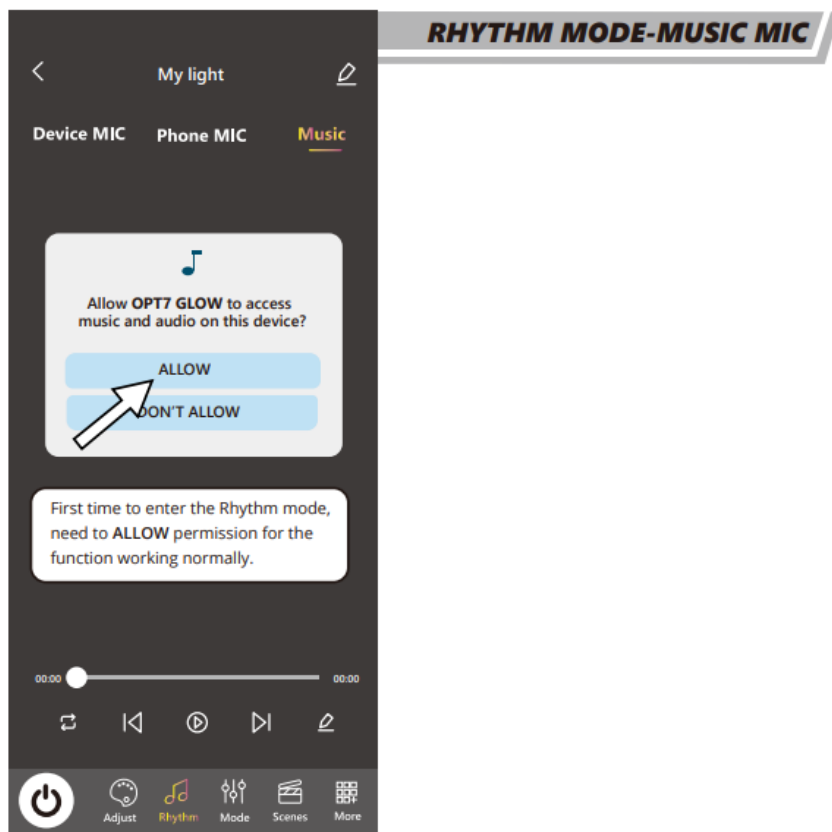

INTRODUCTION

1. Playlist (9 built-in songs)
2. Media player
3. Edit the playlist

HOW TO USE PHONE MUSIC

ANDROID

The music files on the phone will be imported into the playlist automatically.

IOS

Need to connect to iTunes on a computer to download the music file to the iPhone.

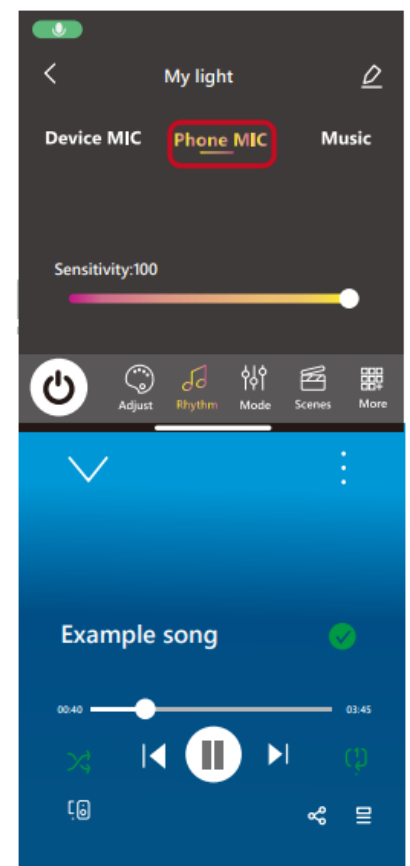

ANDROID SYSTEM

BACKGROUND PLAYING

The Phone MIC in the APP allows music to play in the background while users are using other Apps.

SPLIT SCREEN

The OPT7 GLOW supports the split screen function so keep both the music app and the OPT7 GLOW on the screen, the function will work.

IMPORTANT

- The Phone MIC supports Android Auto only.
- When using the Phone MIC, users must enable the background permissions.
- Not all the cellphones support the split screen function.
- Music supports only a device or a group at once.

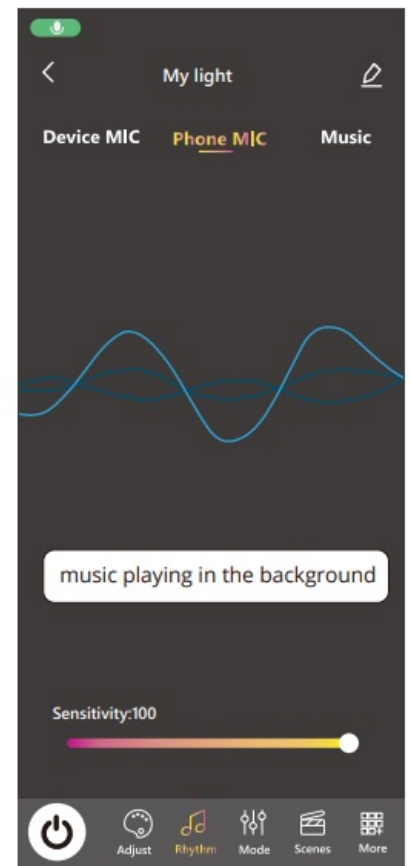
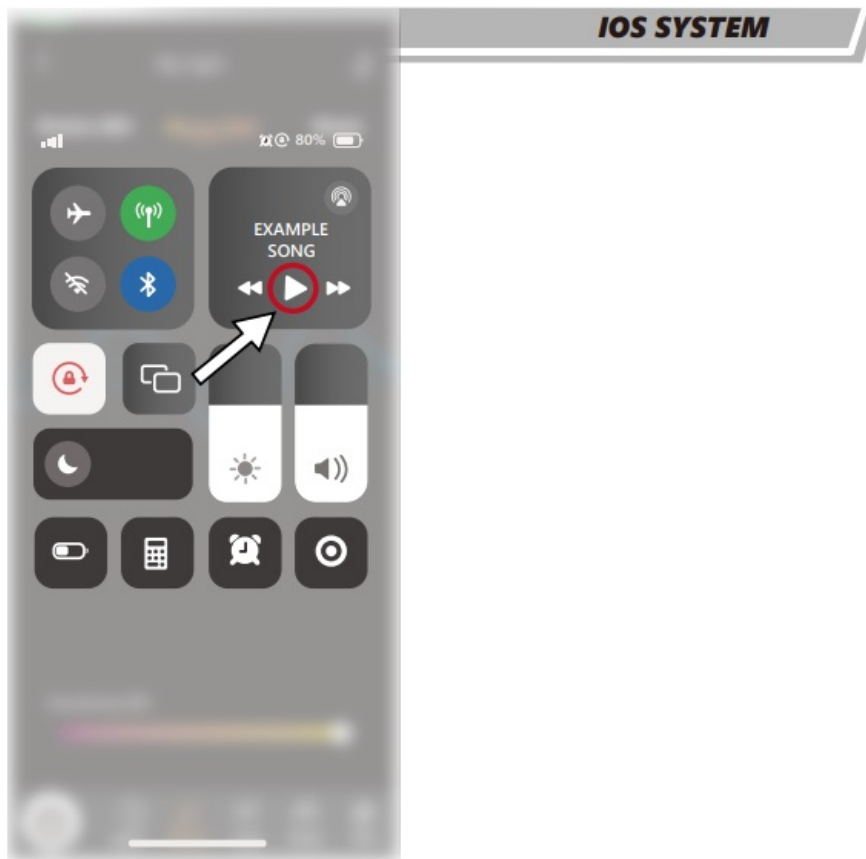

IOS SYSTEM

BACKGROUND PLAYING

The Phone MIC in the APP allows music to play in the background while users are using other Apps.

IMPORTANT

- The Phone MIC does not support Apple CarPlay.
- When using the Phone MIC, users must enable the background permissions.

LIGHT MODE

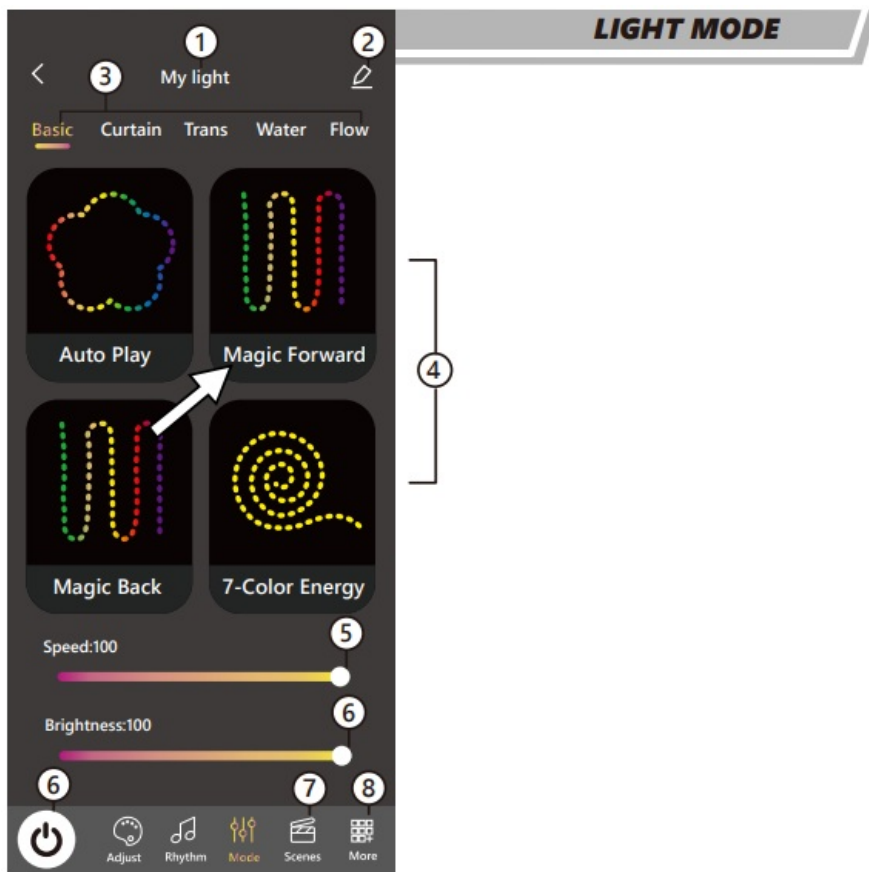

INTRODUCTION

1. Device name
2. Device setting
3. Light mode catalog
4. Light mode with animation (touch one to set)
5. Speed adjust
6. On/Off
7. Scenes mode
8. More information

SCENES MODE

INTRODUCTION

1. Device name
2. Device setting
3. 4 scene modes (touch to set the light mode, not supposed to add one)
4. On/Off
5. More information



MORE INFORMATION

INTRODUCTION

1. FAQ (KNOWLEDGE BASE)

Access our Knowledge Base for comprehensive guides and instructional videos to support your installation requirements effectively.

2. OPT7 CUSTOMER SUPPORT

OPT7 offers comprehensive customer support, including assistance with your questions, technical issues, and app functionality.

3. WARRANTY REGISTRATION

Learn how to file a warranty claim and register your product for warranty.

4. SOCIAL MEDIA

Stay updated with OPT7 on social media for new tips, tricks, giveaways, and the latest information for auto enthusiasts.

5. INSTALLATION GUIDES:

Explore our install guides for a seamless experience.

6. VIDEO TUTORIAL

Subscribe to the OPT7 YouTube Channel for installation tutorials, product highlights, and more.

7. USER TERMS

Learn about our privacy policy and find out what information we collect when placing an order.

8. GOOGLE CLOUD TERMS OF SERVICE

FAQs

Q: What is the maximum number of devices OPT7 GLOW can connect to?

A: OPT7 GLOW can connect a maximum of 4 devices simultaneously.

Q: How can I conserve battery life and extend the lifespan of my OPT7 light kits?

A: Make sure to completely turn off the OPT7 GLOW when not in use to avoid excessive battery consumption.

Documents / Resources

	<p>OPT7 Glow Application [pdf] User Guide MOPT7-OB21, Glow Application, Glow, Application</p>
---	---

References

- [User Manual](#)

[Manuals+](#), [Privacy Policy](#)

This website is an independent publication and is neither affiliated with nor endorsed by any of the trademark owners. The "Bluetooth®" word mark and logos are registered trademarks owned by Bluetooth SIG, Inc. The "Wi-Fi®" word mark and logos are registered trademarks owned by the Wi-Fi Alliance. Any use of these marks on this website does not imply any affiliation with or endorsement.