



OPCOM Farm Grow Box 2 Free Stackable Farming User Manual

[Home](#) » [OPCOM Farm](#) » OPCOM Farm Grow Box 2 Free Stackable Farming User Manual 

OPCOM

Contents

- [1 OPCOM Farm Grow Box 2 Free Stackable Farming](#)
- [2 GrowBox2](#)
- [3 Assemble GrowBox2](#)
- [4 Seedling](#)
- [5 Growing Stage](#)
- [6 Young plant stag](#)
- [7 Optional](#)
- [8 Maintenance](#)
- [9 Troubleshooting](#)
- [10 Documents / Resources](#)
- [11 Related Posts](#)

OPCOM Farm Grow Box 2 Free Stackable Farming



GrowBox2

Thank you for purchasing OPCOM GrowBox2, the indoor hydroponics growing system. It is designed with easy-to-use and efficient growth by one-touch AUTO mode. It holds up to 59 plants capacity. Please read the quick guide carefully before setting it up. For a detailed user manual and assembly video, please visit the Official Website: <http://www.opcomfarm.com> Sprouts and Microgreens

Hardware



Grow Kit



Manual



Warranty Card



Quick Guide Manual

PH adjusters



13 soda#1 50ml x 1



14 Lomon#1 50ml x 1

Nutrition



16 Salt#1 250ml x 1



Large X 1
 Medium X
 Small X 1

17 Scoop for Adjust
 of Nutritio

Assemble GrowBox2



1. Install Rod A at the rear right corner. Insert other 1 Vertical aluminum rod to each corner of the box and follow the arrow on the bar to assemble. Install the top LED Panel and position it in the indicated location by
2. following the arrow on the bar.
3. Connect the LED cable to the LED Panel.
4. Put the planting tray into the water tank to complete the assembly.
5. Fill 6.6 gallons/ 25L (80%) water into the box.
6. Connect the adaptor cable to the adaptor.

Chart 1: Control Box Mode

| Fuction | Status | Operation | Light | Time(On/Off) | Note |
|---------|--------|-----------|-------|----------------|---------------|
| LED | Auto | One Click | ● | 16H / 8H | |
| | On | One Click | ● | 24H / 0H | |
| | High | One Click | ● | 18H / 6H | |
| | Low | One Click | ● | 10H / 14H | |
| | Off | One Click | ● | 0H / 24H | |
| Pump | Auto | One Click | ● | 12 Cycles/ day | 10 mins/cycle |
| | On | One Click | ● | 48 Cycles/ day | 10 mins/cycle |
| | High | One Click | ● | 4 Cycles/ day | 10 mins/cycle |
| | Low | One Click | ● | 2 Cycles/ day | 10 mins/cycle |
| | Off | | ● | 0 Cycles/ day | |

- Most plants can be grown using the AUTO mode.
- Remote controller support wireless remote control.
- When Power On, press hold POWER button until 2 beep sound (About 5 second) to reset power on timeline.
- When Power Off, press hold POWER button until 2 beep sound (About 5 second) to reset power off timeline.

Seedling

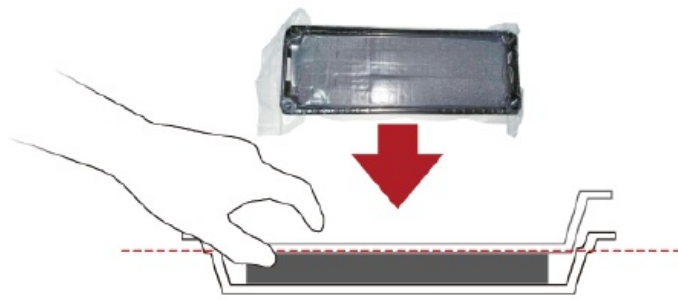

Fig 1

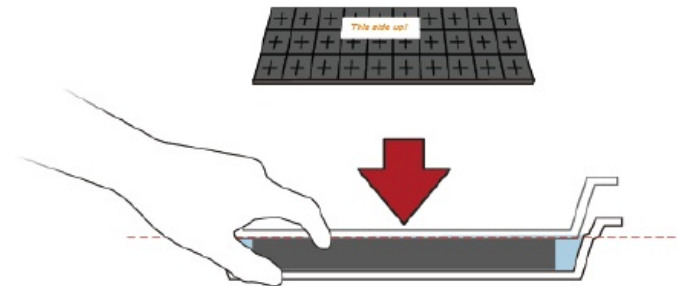

Fig 2

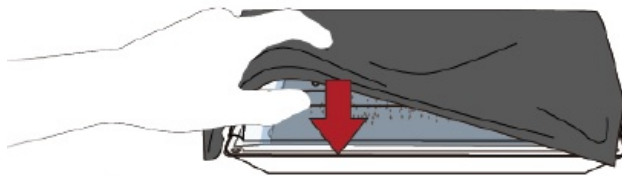

Fig 3

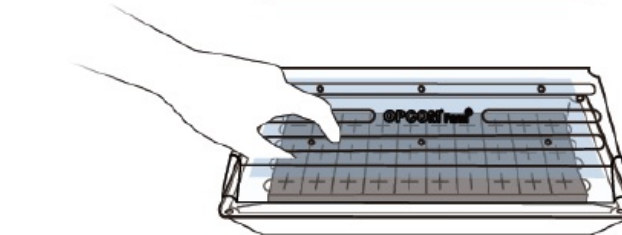

Fig 4

1. Add water to the seedling tray, up to the water (red) level. (Fig1)
2. Second-time sprout: Open Grow Sponge package, put each sponge piece into the water of the seedling tray (make sure the front side with the seed label is side up), press the sponges into water 5 seconds and ensure the sponges absorb water completely. Put seed moisturizing cover on the sponges.(Fig2)
3. Place the seedling tray with cover in the shade. (Fig3)
4. Suggest using Watering Spray water to sponges and keep them wet every day.
5. During 0~ 7 days, find the sprouted ones in the tray: pick them out, and move them into the product (make sure the sponges lineup with the black dot on the partition Fig4)

Chart 3,4 Electrical conductivity (EC) & pH adjustment instructions

| Status | 0.0-0.5 | 0.5-1.0 | 1.0-1.5 | Over 2.0 |
|--------|---------|---------|----------------|-----------|
| Salt#1 | 10g | 5g | Standard range | Add water |

Growing Stage

1. When plants grow to over 2 inches in height, switch the control box to auto mode. Please refer to Chart 2

2. After 4-6 weeks, harvest the larger plants growing.
3. To save time, sow the new seeds in a sprouting tray one week before you restart the planting process.
4. When water less than water level(red) on the tank, please refill new water until over water level(red).

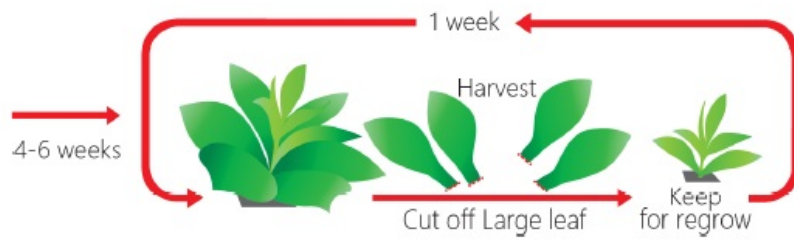

Chart 2: Plant Stage

| Status | 4.0-4.5 | 4.5-5.0 | 5.0-5.5 | 5.5-6.5 | 6.5-7.0 | 7.0-7.5 |
|---------|----------------|---------|---------|----------------|---------|---------|
| Soda#1 | 30g | 20g | 10g | Standard range | | |
| Lemon#1 | Standard range | | | 10g | 20g | |

Young plant stag

Before your next seedling, take advantage of the seedling tray for sprouts and microgreens, it takes 7-10 days to harvest.

1. Put seeds in warm water(recommended temperature is 95° F , not over 104° F) for 24 hours.
2. Put the wet paper towels into the tray.
3. Place the seedling tray with cover in the shade or cover it with black cloth.
4. After germination, during the rowing stage, keep the green sprout under the light and white sprout in the shade or cover it with black cloth; In 7-10 days, you can harvest.



Optional



Black Cloth



Anti-Insect Net



Auto Heater



Seeding Tray



Seeding Sponge

Maintenance

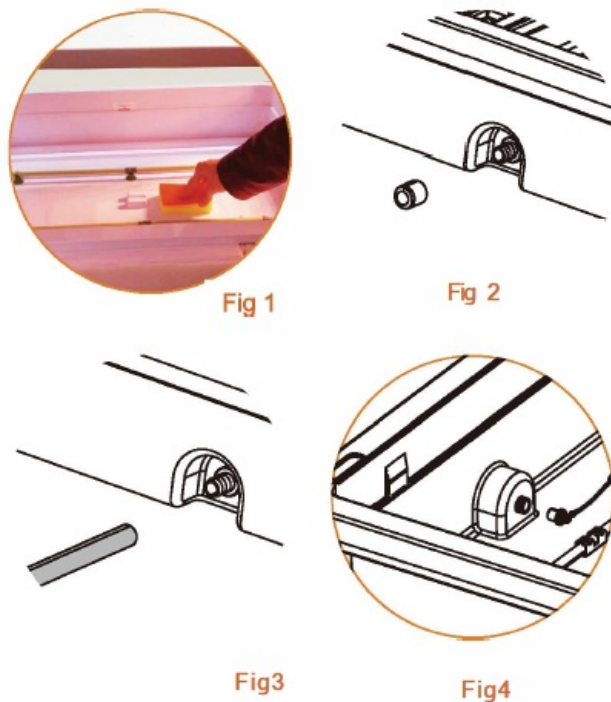

Add Water

Measure the pH value every week and add water to achieve the value balance.

Change Water

1. After a cycle of planting, you should change water or clean the unit(Fig1 .)
2. When changing water, you can use water outlet on the left side to leak the water. Plug out plastic lid(Fig2), plug-in water pipe(Fig3), then plug out water tank inside stopper.(Fig4)
3. After drain the water, please wipe off the water tank.

EC/ pH Meter Use and Calibration

1. Everytime you use the EC/pH Meter, please wash electrode by regular water and keep it dry.
2. Cover the electrode protective cap when not in use.
3. Turn off the meter when not in use for an extended amount of time.

Troubleshooting

- Issue
 - Checkpoints/ Solution
- Lighting problem
 - Make sure all power cables are connected.
 - Make sure Power button is ON.
 - Make sure LED status is ON
 - If LED Status is on HI or LOW mode, the lamp has off time, during 24-hour cycle.
- Pump buzzing noise
 - The pump may give off a buzzing sound in the beginning due to air inside the pump. After a minute with water running through the pump, this could be reduced.

- The lamp/ pump stop after hours
 - Control Box is designed with Auto, HI and LOW modes, which turn the lamps and the pump on and off at certain intervals. It simulates an outdoor daily cycle to offer the best growing condition. Rotate the ring at the front end of the pump clockwise or counterclockwise to get the most suitable water flow.

Documents / Resources

| | |
|---|---|
|  | <p>OPCOM Farm Grow Box 2 Free Stackable Farming [pdf] User Manual Grow Box 2, Free Stackable Farming, Grow Box 2 Free Stackable Farming</p> |
|---|---|