



## Onvian A2 115dB Bike Alarm with Remote User Manual

[Home](#) » [ONVIAN](#) » Onvian A2 115dB Bike Alarm with Remote User Manual 

### Contents

- 1 Onvian A2 115dB Bike Alarm with Remote User Manual
- 2 Charge to activate the remote control before the first use !!!
- 3 Product information
- 4 Instruction of Remote
- 5 Arming & Disarming
- 6 ) Alarm:
- 7 3) Electric Bell:
- 8 (4) Personalized Setting:
- 9 make personalized settings for the above 1,2 and 3 items, press the remote control[ ] key after the settings are completed, the settings are successful.
- 10 Instruction of Remote
- 11 Low Power:
- 12 Accessories
- 13 Installation of Remote Control
- 14 Installation of Bracket
- 15 Placement of Main Unit
- 16 QUESTIONS & ANSWERS
- 17 Why is the alarm not sensitive?
- 18 Why not able to control the main unit by remote?
- 19 (2) Why can not charge the main unit ? Or why is the charging so slow?
- 20 (1) Arming & Disarming
- 21 (5) How to cancel the pairing with main unit once you lost the remote? And how to pair with a new remote controller
- 22 Read More About This Manual & Download PDF:
- 23 Documents / Resources
- 24 Related Posts

## Onvian A2 115dB Bike Alarm with Remote User Manual

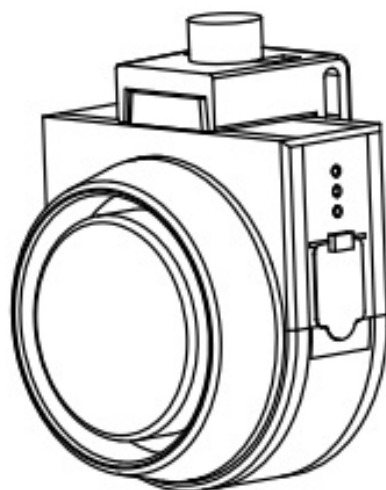

**Charge to activate the remote control before the first use !!!**



USB Charging



Long Battery Life



Concealed  
Installation



Flash Placement



Industrial Plastic



IPX5 Waterproof



Electric Bell



Personalized  
Setting



Power Display



Wireless Bike  
Search

### Product information

model A2			
Color:	black	texture of material:	PC+ABS
Product size:	46X43X41(MM)	Net weight:	66g
BatteQ capacity:	400mAh(3.7V)lithium batteQ	Sound decibel:	115db
Bracket	Cable tie + hand screw	Remote control distance:	0-80M
Remote control batteQ:	12V/27A Alkaline batteQ	Remote control size:	58×35×15(MM)
Applicable models:	Applicable to bicycles, electric bicycles, electric vehicles, motorcycles, outdoor camping equipment and personal safety protection		

## Instruction of Remote

Arming/ 3 Levels of Vibration Sensitivity Adjustment Disarming/Long Press 7s to Settings Alarming/Volume Adjustment  
 Ringtone/5 Ringtones Options

## Arming & Disarming

Arming: Shok press the remote control [ ] lock button will sound "Do-Re-Mi", at this time the main unit has entered the arming state. 3 seconds later to hear "DI", during this period touch the main unit will issue a "di-di". If you continue to touch the main frame again, the alarm will be "biu-biu-biu" for 30 seconds.

30 seconds after touching it again, the alarm will continue.

Disarming: In the arming state, shok press the remote control [ ] unlock button, the main unit will sound "mi-re-do", at this time, the main unit has been disarmed.

## **) Alarm:**

In disarming mode shok press [ ] lightning button the main unit will keep alarming "biu-biu-biu". You can shok press [ ] unlock button to exit.

## **3) Electric Bell:**

In disarming mode, shok press remote [ ] bell button, the main unit will sound the previously set electric bell. Shok press shok ring, long press long ring.

## **(4) Personalized Setting:**

1. Alarm vibration sensitivity setting: Press and hold the remote control [ ] button until the remote control LED lights up again, and the alarm will have a "Bi". At this time and then press the remote control [ ] button, each time you press, the vibration sensitivity switch level. Sensitivity has 3 levels adjustable: high-medium-low. The corresponding sound is "BiBiBi(high)", "BiBiBi(medium)", "BiBiBi(low)", after setting, press the remote control [ ] button to exit the setting.
2. Alarm has 3 levels of volume can be set: high-medium-low. Press and hold the remote control [ ] button and do not release your hand until the remote control LED lights up again, while the alarm will have a "Bi" prompt, at this time in the remote control [ ] button, each press, switch the volume once, each switch to play the corresponding volume of "Bi" sound. When the setting is finished, press the remote control [ ] button to exit the setting.
3. Ringtone Setting: When it is not in the armed state, you can set 5 kinds of Press and hold the remote control [ ] button until the remote control LED lights up again, while the alarm will have a "Bi" sound. At this time in the remote control [ ] button, each time you press, the bell switch once, and play the corresponding ringtone. When the setting is complete, press the remote control [ ] button to exit the setting. The five ringtones are "horn sound 1", "horn sound 2", "horn sound 3", "bird sound" and "di-di sound".

Note: The above 3 settings can be done at once. Press and hold the remote control [ ] key and don't release your hand until the remote control LED lights up again and there will be a "Bi" sound at the same time, then you can

**make personalized settings for the above 1,2 and 3 items, press the remote control [ ] key after the settings are completed, the settings are successful.**

## **Instruction of Remote**

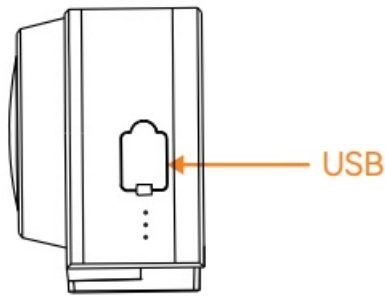

Please use our included 2A USB charge cable, you can connect to your PC USB po, or by your sma phone5V/2A adaptor, or power banks.

1. 2 Hours fully charged.
2. When charging, the power indicator 1,2,3 in turn gradually increase until 3 bars are always on for a full charge.
3. When the power is low, the power indicator 3,2,1 in order to reduce to 1bar of power, please charge.
4. When charging, it is recommended to use the power bank to charge directly or the main unit screw loosened and removed before charging

### Low Power:

The following conditions require timely charging:1.Indicator shows I bar of power.2.The remote control distance becomes shoer.3.The remote control is not sensitive.

### Accessories

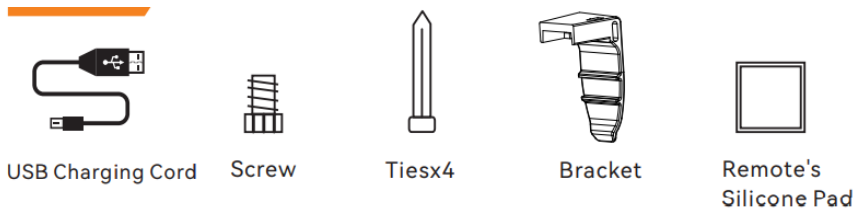

### Installation of Remote Control

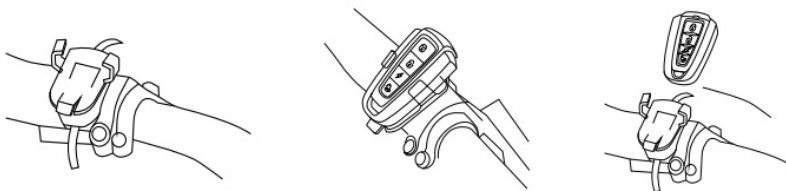

1. The remote' bracket is xed with a tie in a position that is easy to touch with the left and right thumbs.
2. Place the remot
3. Press and hold the bottom snap position of the bracket to remove the remote.

### Installation of Bracket

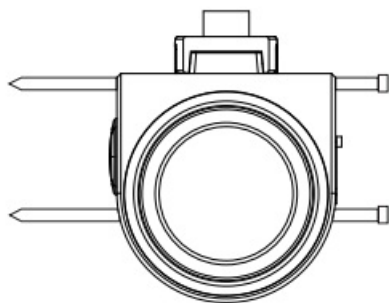

## Placement of Main Unit

1. Choose any position on the bike where it can be fixed.
2. Secure and tie down the main unit and cut off the excess wire.
3. Insert the main unit into the fixing bracket and tighten the screw.
4. The main unit can be removed by loosening the screw in an anticlockwise direction.

## QUESTIONS & ANSWERS

When you meet any questions during the operation, normally you can follow up below Q&A to solve the:

(p.s.: below questions are based on the battery fully charged for main unit and remote controller, if low battery power, please charge it in time.)

Long time placed and not operated, please charge the battery regularly, in order to ensure the battery working life.

### Why is the alarm not sensitive?

Please do not immediately move or touch the bike after setting the alarm, after pressing the LOCK button to set the alarm, you need to wait for 5 seconds more and hear one “di” sound, it enters into the alarm mode.

### Why not able to control the main unit by remote?

In such case, first to make sure whether the host or remote controller has enough power? Mainly caused by the battery out of power for main unit or remote controller, just charge to the main unit or change new battery for remote controller, then you can solve the problem.

### (2) Why can not charge the main unit? Or why is the charging so slow?

Suggest to use our included 2A USB charging cable, make sure the micro USB plug to

**Patented product, illegal infringement is subject to prosecution.**

Anti-theft Alarm Power Indicator Wireless Bike Search Personalized Setting Pleasant Ringtone Concealed Installation

### (1) Arming & Disarming

**Arming:** Shock press the remote control [ ] lock button will sound “Do-Re-Mi”, at this time the main unit has entered the arming state. 3 seconds later to hear “DI”, during this period touch the main unit will issue a “di-di”. If you continue to touch the main frame again, the alarm will be “biu-biu-biu” for 30 seconds. 30 seconds after touching it again, the alarm will continue.

**Disarming:** In the arming state, shock press the remote control [ ] unlock button, the main unit will sound “mi-re-

do”, at this time, the main unit has been disarmed.

**USB can connect to your PC USB port, or by your smartphone 5V/2A adaptor, or power banks.**

- 2 Hours fully
- When charging, the power indicator 1,2,3 in turn gradually increase until 3 bars are always on for a full
- When the power is low, the power indicator 3,2,1 in order to reduce to 1 bar of power, please
- When charging, it is recommended to use the power bank to charge directly or the main unit screw loosened and removed before charging.
- The remote's bracket is fixed with a tie in a position that is easy to touch with the left and right
- Place the remote
- Press and hold the bottom snap position of the bracket to remove the

be completely connected, if you see If you see the light on the side of the main unit flashing means it is under charging.

### **(5)How to cancel the pairing with main unit once you lost the remote? And how to pair with a new remote controller**

Once you lost the remote controller, in order to prevent your bike from stolen, In the Non-alarm mode, just long press to the function button for 7 seconds, when you hear a long “di” sound, the lost remote won't be able to control the main unit at all. After you purchase a new remote, longpress to the function button for 3 seconds, after you hear a short “di” sound, just need to press any button on remote controller, when you hear 2 times of “di” warning tone, it was successfully paired. (6) If lost the remote controller, can I buy a new one?

One host can be paired with 3 remote controllers, please contact with our after custom service, purchase a new remote.

NOTICE: if above Q&A are not able to solve your problem, please contact our after custom service for any support.

#### **WARNING & NOTICES:**

(1) Please do not put the alarm close to your ears, avoid the sharp alarming hurt your hearing, keep away from the alarm at least 2 meters.

(2) Do not give to kids for playing.

(3) Do not put the alarm into the rain.

(4) If you need to put the host into water for testing, make sure the charge port to be covered firmly.

(5) The final interpretation of this manual is vested in our company.

Patented product, illegal infringement is subject to prosecution.

### ***Read More About This Manual & Download PDF:***

#### **Documents / Resources**

	<a href="#">Onvian A2 115dB Bike Alarm with Remote</a> [pdf] User Manual A2 115dB Bike Alarm with Remote, A2, 115dB Bike Alarm with Remote, Bike Alarm with Remote, Alarm with Remote
---	--