



Onn ONA19TB007 Tablet With Detachable Keyboard User Manual

[Home](#) » [Onn](#) » Onn ONA19TB007 Tablet With Detachable Keyboard User Manual 

Contents

- [1 Onn ONA19TB007 Tablet With Detachable Keyboard User Manual](#)
- [2 Introduction](#)
- [3 Important Safety Instructions](#)
- [4 In The Box](#)
- [5 Connecting to the Internet](#)
- [6 Important Safety Instructions](#)
- [7 Compliance Information](#)
- [8 References](#)



Onn ONA19TB007 Tablet With Detachable Keyboard User Manual



Introduction

Thank you for purchasing the onn Android™ 9 Pie tablet with Google™™ Play. Featuring a fast and responsive quad-core processor, this tablet is perfect for accomplishing everyday tasks, streaming music and movies, taking photos, checking emails, and engaging with social media. The tablet offers 16GB of internal storage, Bluetooth connectivity, a Micro SD slot for up to 128GB of additional storage, on-the-go productivity services, and a utility app. The following information will help you get the most out of your tablet.

What You Should Know to Ensure Best Performance

- Charge the battery completely before first use.
- While updates download in the background, tablet performance can be affected until completed.
- Close unused applications. Open apps that run in the background will affect overall performance.
- Battery Consumption: Play times on a fully charged battery will vary depending on your display settings, apps that remain open, and internet use (ie: streaming video content).
- Suggest customers use tablet screen protectors and tablet cases to protect the tablets.

Important Safety Instructions

1. Read these instructions the safety and operating instructions should be read before this product is operated.
2. Keep these instructions safe and operating instructions should be retained for future reference.
3. Heed all warnings warnings on the appliance and in the operating instructions should be adhered to.
4. All instructions operating and use instructions should be followed.
5. Do not use this apparatus near water-The appliance should not be used near water or moisture for example, in a wet basement or near a swimming pool, and the like.
6. Clean only with a dry cloth.
7. Do not block any ventilation openings. Install by the manufacturer's instructions.
8. Do not install near any heat sources such as radiators, heat registers, stoves, or other apparatus (including

amplifiers) that produce heat.

9. Do not defeat the safety purpose of the polarized or grounding plug. An apolarized plug has two blades one wider than the other.
10. A grounding plug has two blades and a third grounding prong. The wide blade or the third prong is provided for your safety.
11. If the provided plug does not fit into your outlet. Consult an electrician for the replacement of the obsolete outlet.
12. Protect the power cord from being walked on or pinched particularly at the plugs, convenience receptacles, and at the point where they exit from the apparatus.
13. Only use attachments/accessories specified by the manufacturer.



14. Use only with the cart, stand, tripod, bracket, or table specified by the manufacturer, or sold with the apparatus. When a cart or rack is used. Use caution when moving the cart/apparatus combination to avoid injury from tip-over.
15. Unplug the apparatus during lightning storms or when unused for long periods.
16. Refer all servicing to qualified personnel. Servicing is required when the apparatus has been damaged in any way, such as the power supply cord or plug is damaged, liquid has been spilled or objects have fallen into the apparatus has been exposed to moisture, does not operate normally, or has been dropped.
17. **CAUTION:** These servicing instructions are for use by qualified service personnel only.
18. To reduce the risk of electric shock, do not perform any servicing other than that contained in the operating instructions unless you are qualified to do so.
19. Do not install this equipment in a confined or building-in space such as a bookcase or similar unit. And maintain a good ventilation condition at the open site.
20. The ventilation should not be impeded by covering the ventilation openings with items such as newspaper, tablecloths, curtains etc.
21. **WARNING:** Only use attachments/accessories specified or provided by the manufacturer(such as the exclusive supply adapter, battery etc).
22. **WARNING:** The mains plug is used as a disconnect device, the disconnect device shall remain readily operable.
23. **WARNING:** To reduce the risk of fire or electricity, do not expose this apparatus to rain or moisture. The apparatus shall not be exposed to dripping or splashing and objects filled with liquids. Such as vases, shall not be placed on the apparatus.
24. This lightning flash with an arrowhead symbol within an equilateral triangle is intended to alert the user to the presence of non-insulated"dangerous voltage" within the product's encoded sure that may be of sufficient magnitude to constitute a risk of electric shock.
Warning: To reduce the risk of electric shock, do not remove the cover(or back)as there are no user-serviceable parts inside. Refer servicing to qualified personnel. The exclamation point within an equilateral triangle is intended to alert the user to the presence of important operating and maintenance instructions in the literature accompanying the appliance.
25. **WARNING:** Please refer to the information on the exterior bottom enclosure for electrical and safety information before installing or operating the apparatus. Use the devices where the ambient temperature is between 0°

and 35° C (32° to 95° F). Low- or high-temperature conditions might cause the device to change its behaviour to regulate its temperature. Using an Android device in very cold conditions outside of its operating range might temporarily shorten battery life and could cause the device to turn off. Battery life will return to normal when you bring the device back to higher ambient temperatures. Using the devices in very hot conditions can permanently shorten battery life.

In The Box

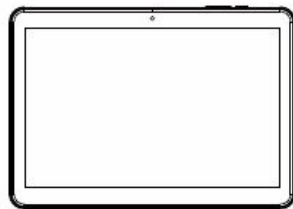

10.1" tablet

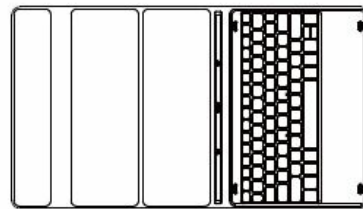

keyboard



User Manual



Mircro USB cable

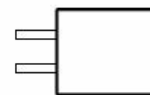

Charger

size:61*41*24mm
Input:100-240V~50/60Hz,0.3A
Output:5.0V== 2.0A

1. Camera (Front)

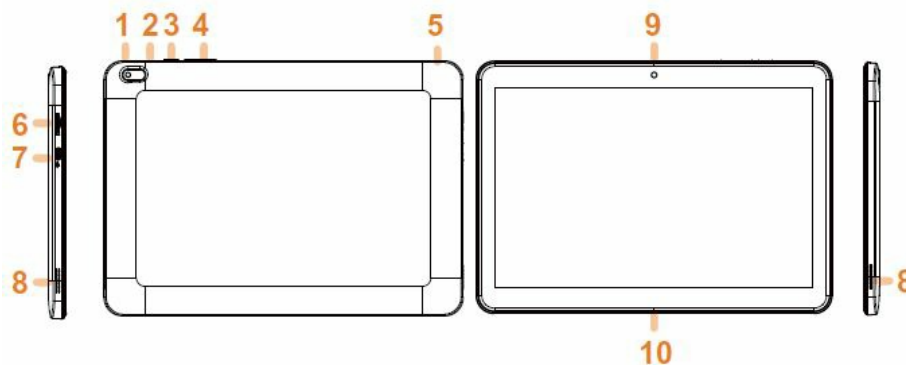

2. Camera (Rear)

3. Micro USB

4. TF Card Slot

5. Volume Control

6. Speakers

7. Reset

8. Power On/Off

9. Earphones

10. Pogo Pin

Working with keyboard

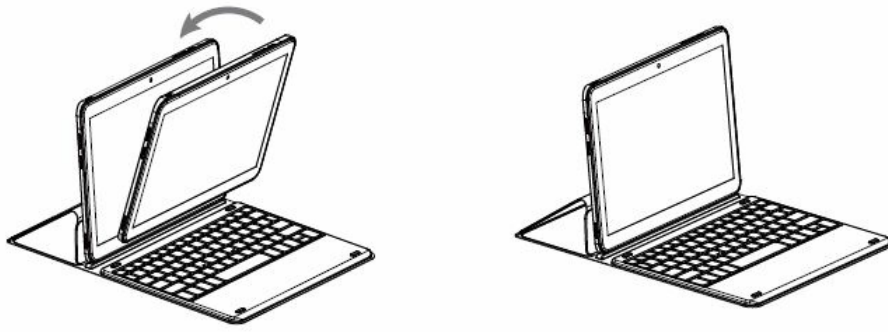

The keyboard unfolds easily to support the tablet and provide a familiar typing experience. Use the keyboard to type into note-taking applications, websites, and search bars. Enjoy the freedom of a tablet with the responsive and familiar feel of a physical keyboard. When you are finished using the tablet, fold the keyboard up for a thin portable device that you can take anywhere.

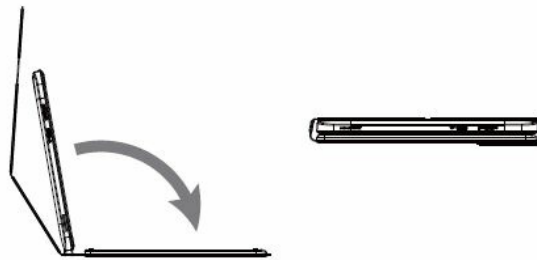

Starting Your Tablet

1. Press and hold the Power button for 3 seconds. (If your tablet does not turn on, or instructs you to “Connect your charger”, connect the AC adapter and charge the unit.)
2. At the Start-up screen, slide your finger up to unlock.



3. Once you've arrived at the Home screen, you can begin using your tablet.

Home Screen At-a-Glance

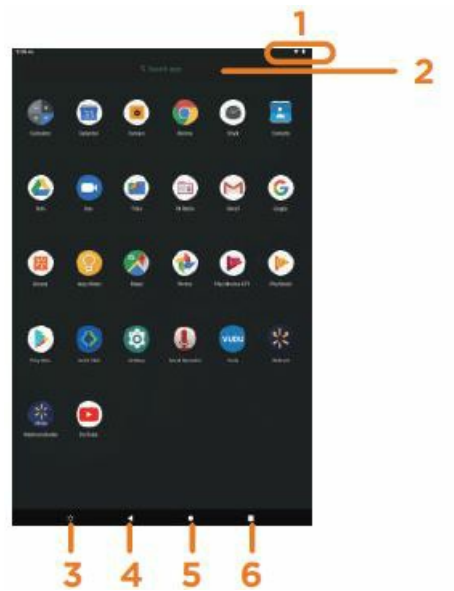

1. Status Bar
2. Search Box
3. Walmart App Suite
4. Go Back
5. Home screen
6. Recent Used

Using the Cameras



1. Switch Cameras (Front/Rear)
2. Normal Mode
3. Recent Photo
4. Take Photo

Tablet Updates

To ensure the tablet runs smoothly, it is recommended to perform periodic system software updates, especially during the initial set-up of the tablet. You may receive notifications (on the Lock screen) from time to time that software updates are available. Tap the notification to be directed to the update.

Other options to access updates

From the Home screen tap on Settings >  System > About Tablet > Wireless Update.

NOTE: To perform an update, you must be connected to WiFi.

Google Play Updates

The first time you sign on to Google Play Store, updates will automatically start downloading onto the tablet. The download icon  will appear in the status bar at the top left of the screen. Installing a new application when multiple apps are downloading will reduce tablet speed and performance. After all downloads and updates have been installed, the tablet will resume normal operating performance. To view the progress of downloads working in the background, slide your finger down from the top edge of the screen.



Touching and Typing



To select an item on the screen, simply tap it once with your fingertip. Some items may require you to “double-tap” To type into a text field (i.e., when inputting your name, or a web address), tap the text field.



The on-screen keyboard will appear, and allow you to type the information you wish to enter. Touch and Hold: Keep your finger on an on-screen item until it glows or activates an alternate menu: Drag: Move an App or object by four finger no-die estimation screens on the site side one or more fingers from one side.



Connecting to the Internet



To connect to the internet, you will need the following:

- A wireless router or an access point with a broadband internet connection.
- The name of your network (SSID), as well as the password or other credentials, if your network is secure.



The wireless router must support WiFi 802.11a/b/g/n connections. Go to **SETTINGS > Network & internet > WiFi**. Tap on WiFi to activate wireless connectivity. The Tablet will scan for available WiFi networks within range. Secured networks will require a password. Once you have successfully entered your information the tablet will remember your settings.



Connecting Bluetooth

Your Tablet is compatible with Bluetooth-capable devices. Once your tablet searches for devices with Tate. A device follows on a section in compatible device your tablet follows:

1. Turn on the compatible Bluetooth device and make it discoverable.
2. Open the Settings > Connected devices.
3. Tap on Pair new Device to view available devices.

Charging Your Tablet

It is recommended to fully charge the tablet before first use. To charge the tablet, plug 1) a USB cable into the AC adapter, and 2) attach the other end to the Micro-USB input on the tablet. 3) Plug the AC adapter into a wall outlet. When the tablet is ON and charging, the battery icon will pulsate. A complete battery charge may take up to 2.5 hours. It is normal for the tablet to get warm while charging, playing high-intensity games, or streaming video. Battery life will vary depending on usage.

Note: Leave the tablet in a well-ventilated area while charging.

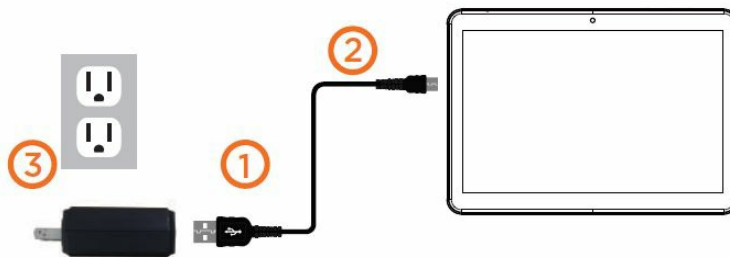

Important Safety Instructions

- We would like you to have a safe and enjoyable experience.
- Please read the following instructions and notices before using your tablet.
- Warning: This product may contain a chemical known to the State of California to cause cancer, birth defects, or other reproductive harm.
- Avoid using the tablet in extremely hot, cold, dusty, damp or wet environments.
- The tablet is not moisture/water-resistant. Avoid using the tablet around sources of water.
- Avoid dropping or forcibly placing the tablet onto a hard surface. This may damage the screen or internal electronic components and void the warranty.
- Do not use alcohol, thinner or benzene to clean the surface of the tablet. Use only cleaning products designed for computer tablet devices.
- Do not use the tablet while walking or driving.
- Excessive use of earphones at high volume may lead to hearing impairment. Limit earphone usage, and adjust the volume to a moderate level when doing so.
- The images in this guide may vary slightly from the actual product.
- Charge the tablet battery under any of the following circumstances:
- The battery level icon indicates low power, by showing a drained, red battery icon.

- The tablet powers off automatically and continues to do so even after restarting.
- On-screen keys do not work.
- Do not suddenly disconnect the tablet when formatting, uploading or downloading data. This can lead to program errors (e.g., system or screen “freezing” .)
- Static discharge is normal and can occur in an electronic device. Although not life-threatening, it may corrupt files or damage memory and its content.
- Dismantling the tablet will void the manufacturer’s warranty.
- The tablet functions, hardware, software, and warranty information may be improved or modified by the manufacturer or their respective owners and is subject to change without notice.

Compliance Information

FCC NOTICE

The following statement applies to all products that have received FCC approval. Applicable products wear the FCC logo, and /or a subtle to the rowing to conditions: (his he vice may no Tu’s device interference and 5 this device must accept

interference received, including interference that may cause undesired operation. This mobile device has been tested and found to comply with the limits for a Class B digital device, under Part 15 of the FCC Rules. These limits are designed to provide real– reasonable protection against harmful interference in a residential installation. This equipment generates, uses and can radiate radio-free- quency energy and, if not installed and used by the instructions, may cause harmful interference to radio or television reception, which can be determined by turning the equipment off and on, the user is encouraged to try to correct the interference by one or more of the following measures:

- Reorient or relocate the receiving antenna.
- Increase the separation between the equipment and the receiver.
- Connect the equipment to an outlet on a circuit different from that to which the receiver is connected.
- Consult the dealer or an experienced radio/TV technician for help.

Changes or modifications not expressly approved by the party responsible for compliance could void the user’s authority to operate the equipment. The antenna(s) used for this transmitter must not be co-located or operating in conjunction with any other antenna or transmitter. From the Home screen tap on Settings-System-Certification Information to View Certification Information.

Warning Statement

Operation is subject to the following two conditions: this device may not cause interference, and this device must accept any interference, including interference that may cause undesired operation of the device.

IMPORTANT NOTICE

IC Radiation Exposure Statement This equipment should be installed and operated with a minimum distance of 0.5cm between the radiator and your body. This device and its antenna(s) must not be co-located or operating in conjunction with any other antenna or transmitter.

Walmart Stores, Inc. Limited Warranty

Walmart warrants this product against defects in material or workmanship for one (1) year from the original date of purchase. During this period, Walmart will replace a defective part with a new or refurbished part without a charge to you. If your unit is deemed unrepairable, we will replace the unit with a new or refurbished unit at Walmart’s sole discretion. The customer is responsible for transportation costs and insurance charges (if applicable) to Corporate. It is the customer’s responsibility to retain the original packaging or provide like packaging to facilitate the warranty process.

Walmart will incur no liability whatsoever to provide packaging for warranty items. Should the product be damaged due to insufficient packaging, the warranty may be voided. You must receive a return authorization number (RMA #) before sending the unit in for service. Service that is provided is warranted for the duration of the original warranty or 45 days whichever is greater.

Your Responsibility

It is strongly recommended to make a backup copy of the contents on your hard drive in case of operational failure. Walmart will not be held liable for content that is on the device. Retain a copy of the bill of sale to provide proof of purchase. The warranty extends only to defects in materials or workmanship as limited above and does not extend to a cracked screen, damaged USB or DC port, cosmetic damage, or any other products, parts or accessories that have been lost, discarded, damaged by misuse or accident, neglect, acts of God such as lightning, voltage surges in the home, improper installation, or serial number rendered illegible. Please contact Customer Support directly at 1-800-985-9728. Hours of operation are from

Walmart Stores, Inc. Limited Warranty

8:00 AM to 5:00 PM Monday through Friday. You will be instructed on how your claim will be processed so have information is available including date of purchase, serial number and the problem with the product. Should a problem be determined to be within the limits of the warranty you will be provided with an (RMA) authorization number and instructions. Proof of purchase must be confirmed before any warranty service can be provided. Should a claim not be covered by the limited warranty, you will be asked whether you wish to have service provided for a fee. Google, Android, Google Play and other marks are trademarks of Google LLC.

Certification Information

This device complies with Part 15 of the FCC Rules. Operation is subject to the following two conditions: (1) this device may not cause harmful interference, and (2) this device must accept any interference received, including interference that may cause undesired operation.

Download PDF: [Onn ONA19TB007 Tablet With Detachable Keyboard User Manual](#)

References

- [User Manual](#)