

onn B22 5-Button Wireless Mouse User Guide

[Home](#) » [Onn](#) » onn B22 5-Button Wireless Mouse User Guide 

Contents

- [1 onn B22 5-Button Wireless Mouse](#)
- [2 Product Information](#)
- [3 Product Usage Instructions](#)
- [4 FEATURES](#)
- [5 Overview](#)
- [6 Safety Precautions](#)
- [7 Operation, Setting Up Mouse](#)
- [8 CONNECTION](#)
- [9 CONNECTION](#)
- [10 Operation, Setting Up Computer](#)
- [11 PAIRING](#)
- [12 Warranty](#)
- [13 Troubleshooting](#)
- [14 Documents / Resources](#)
 - [14.1 References](#)
- [15 Related Posts](#)

onn

onn B22 5-Button Wireless Mouse

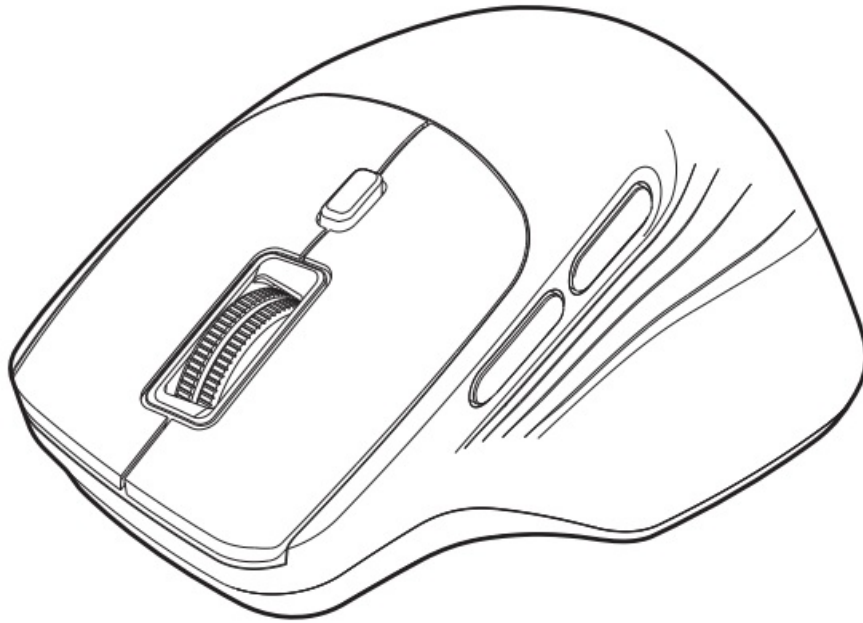

Product Information

Specifications

- Model: 100162481_EN_10302024
- Wireless 5-button mouse with Quick-Scroll Wheel
- Features: Left, Back, Forward, Right buttons, Easy Switch Bluetooth, Scroll off wheel, USB nano receiver, Middle button, LED indicator, DPI switch

Product Usage Instructions

Safety Precautions

Before using the wireless mouse, please read and follow the safety precautions outlined in the user manual to ensure safe operation.

Setting Up Mouse

1. Remove the battery cover and insert the battery.
2. Connect the USB nano receiver to your computer's USB port.
3. Switch on the mouse and ensure it is in pairing mode (LED indicator blinking).

Setting Up Computer

Follow these steps to set up the mouse with your computer:

1. For USB Receiver Connection:

- Set the connection to the USB receiver and turn on the power.

2. For Bluetooth Connection:

- Insert the USB receiver into an available USB-A port.
- Set the connection to Bluetooth and press and hold Connect to set the mouse in Bluetooth pairing mode.

Pairing Instructions

- **Windows:** Click on Start -> Settings -> Devices -> Bluetooth & other devices -> Turn on Bluetooth -> Add a device (Bluetooth), find onn BTMouse in the list and complete Bluetooth pairing.
- **MacOS:** Click on Apple menu -> System Preferences -> Bluetooth -> Turn it on. Follow the same steps as Windows to complete Bluetooth pairing.

FAQ

- **Q: How do I change the DPI settings on the mouse?**

A: To change the DPI settings, use the DPI switch located on the mouse. Toggle through the available DPI options according to your preference.

- **Q: What should I do if the LED indicator does not stop blinking during pairing?**

A: If the LED indicator continues to blink during pairing, check the battery level of the mouse and ensure it is sufficiently charged. If the issue persists, try resetting the mouse by turning it off and on again.

FEATURES

- Metal Quick-Scroll Wheel
- 5 Clickable buttons, on/off switch, and connection switch
- Comfortable ergonomic design with finger rest 5 Adjustable DPI sensitivity levels: 600/1000/1600/2400/3600 DPI
- Bluetooth® wireless technology
- 2.4GHz wireless connection with USB nano receiver (stores in battery compartment when not in use)
- Windows, MacOS, ChromeOS, Android, and iOS compatible
- USB plug-and-play

SCAN HERE FOR MORE PRODUCT INFORMATION AND LEAVE US A REVIEW!



Overview

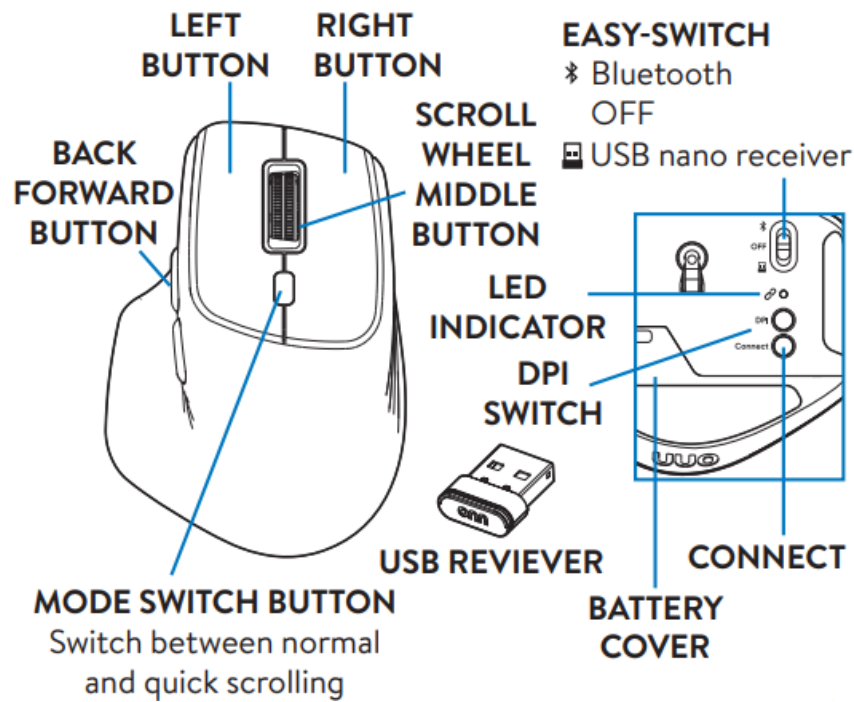

Safety Precautions

WARNING

FCC compliance statement

This equipment has been tested and found to comply with the limits for a Class B digital device, pursuant to Part 15 of the FCC Rules. These limits are designed to provide reasonable protection against harmful interference in a residential installation. This equipment generates, uses and can radiate radio frequency energy and, if not installed and used in accordance with the instructions, may cause harmful interference to radio communications. However, there is no guarantee that interference will not occur in a particular installation.

If this equipment does cause harmful interference to radio or television reception, which can be determined by turning the equipment off and on, the user is encouraged to try to correct the interference by one of the following measures:

- Reorient or relocate the receiving antenna.
- Increase the separation between the equipment and receiver.
- Connect the equipment into an outlet on a circuit different from that to which the receiver is connected.
- Consult the dealer or an experienced radio/TV technician for help.

This device complies with Part 15 of the FCC Rules. Operation is subject to the following two conditions:

1. This device may not cause harmful interference, and
2. This device must accept any interference received, including interference that may cause undesired operation.

Radiation Exposure Statement:

The product comply with the FCC portable RF exposure limit set forth for an uncontrolled environment and are safe for intended operation as described in this manual. The further RF exposure reduction can be achieved if the product can be kept as far as possible from the user body or set the device to lower output power if such function is available.

FCC Caution: Any changes or modifications not expressly approved by the party responsible for compliance could void the user's authority to operate this equipment

Operation, Setting Up Mouse

INSTALLING BATTERY

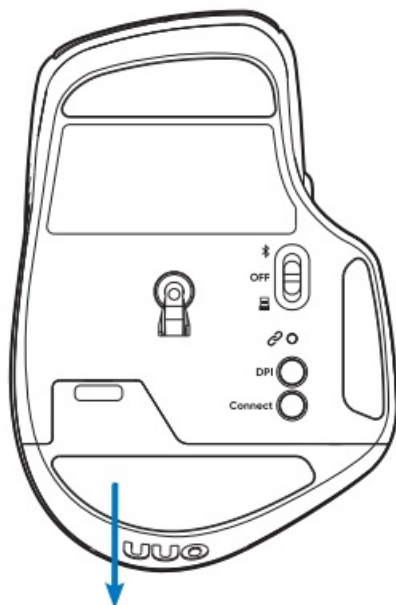

1. Remove
battery cover

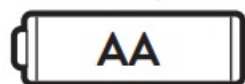
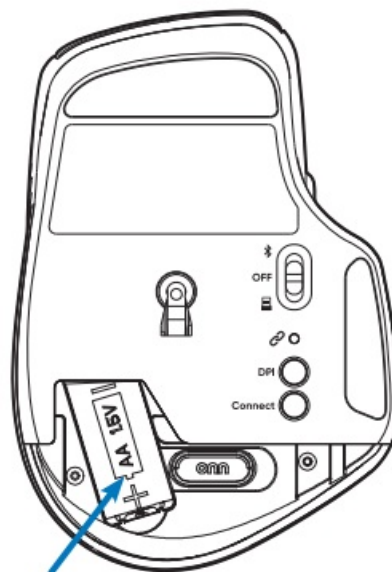

2. Insert battery

CONNECTION

USB Receiver

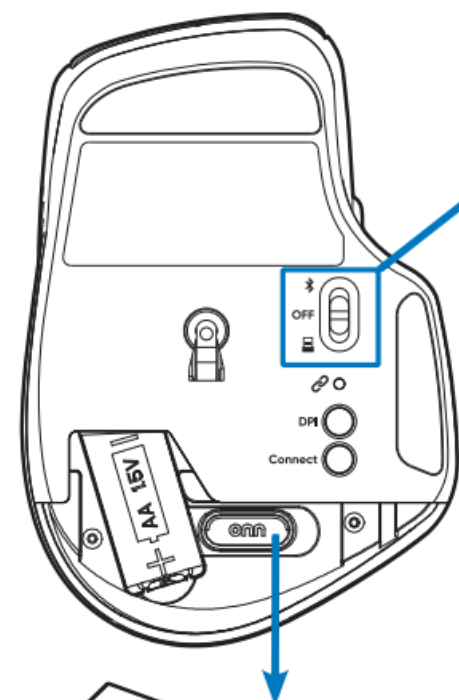

1. Take out
USB receiver

3. Set the connection to usb
receiver and turn on power

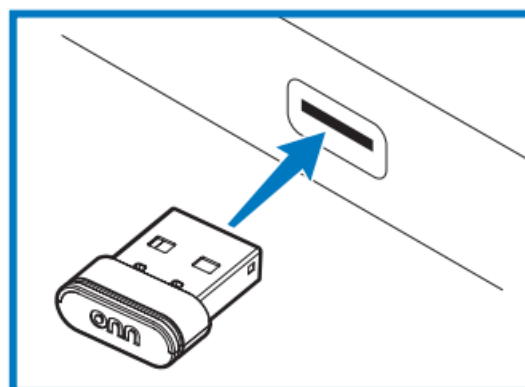

2. Insert it into available
USB-A port

CONNECTION

Bluetooth

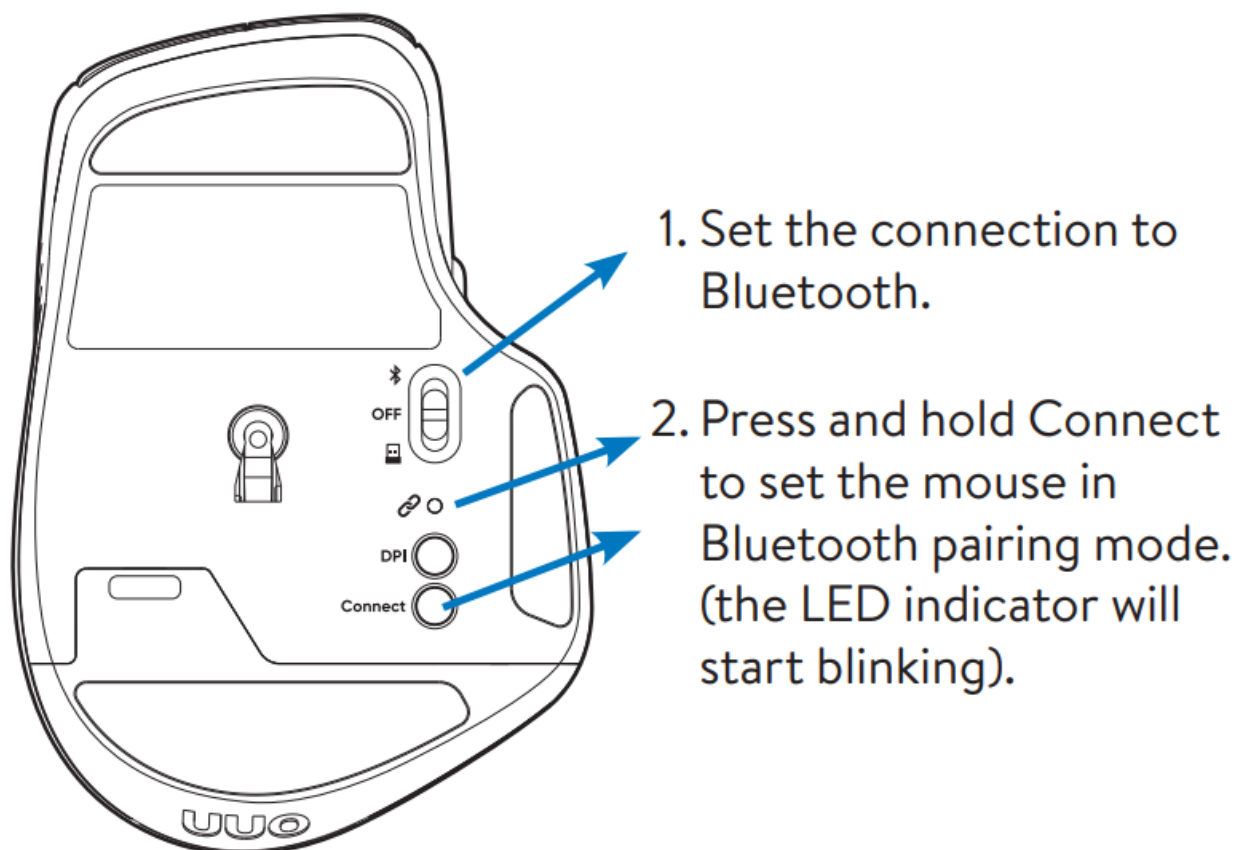

Operation, Setting Up Computer

PAIRING

Windows

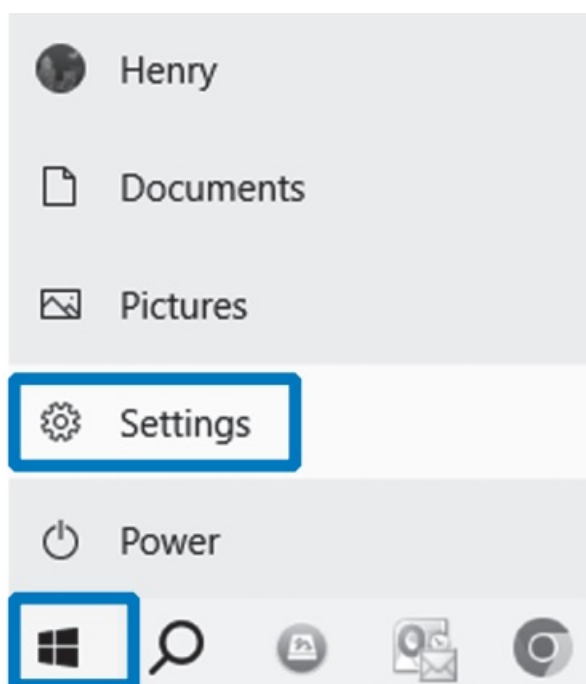

- Click on “Start” .
- Go to Settings.
- -> Device -> Bluetooth & other devices
-

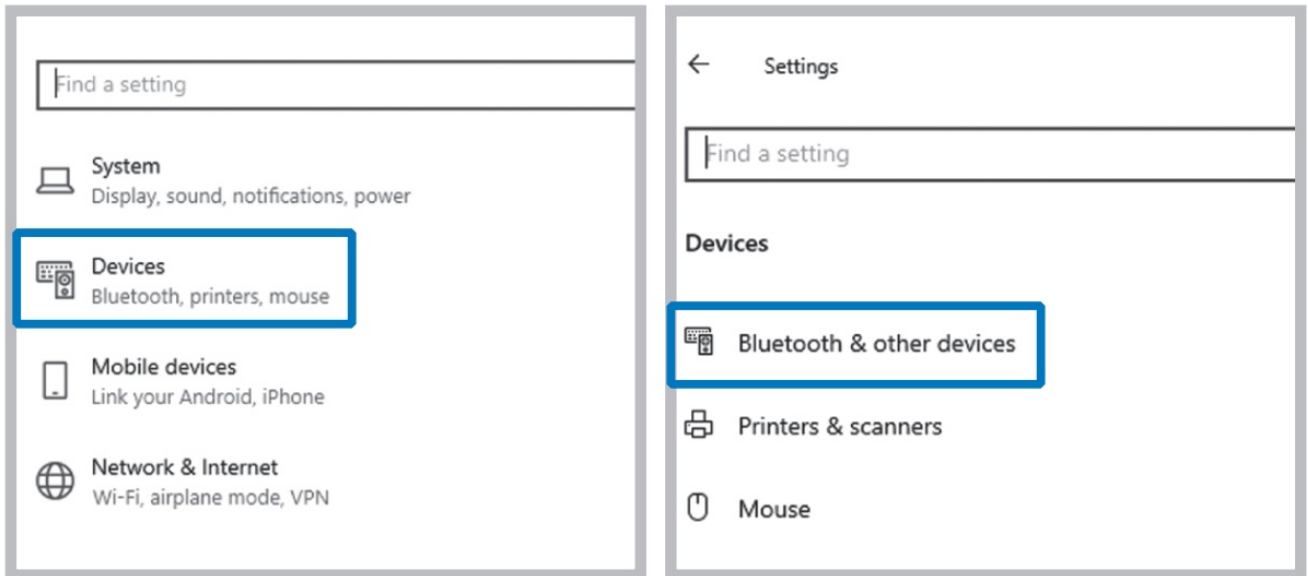

- > Turn on Bluetooth
- > Add Bluetooth or other device
- > Add a device (Bluetooth), find “onn BTMouse” in the list and complete Bluetooth pairing.

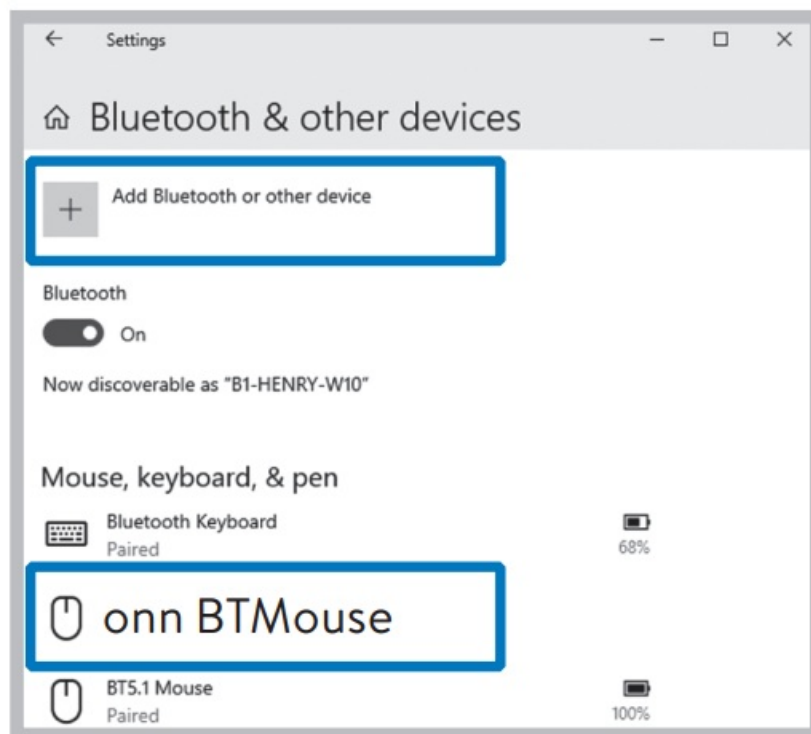

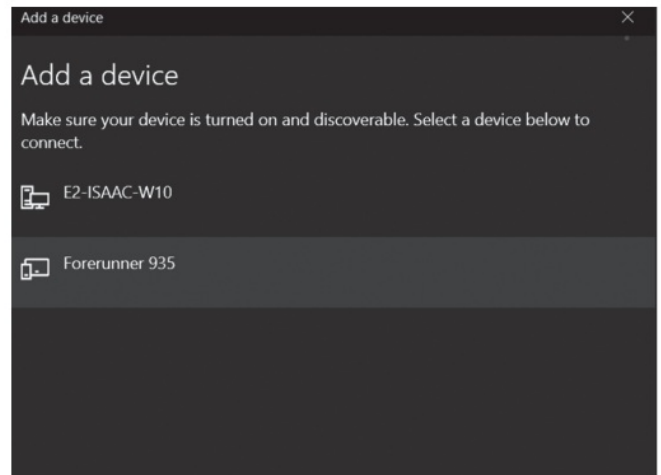
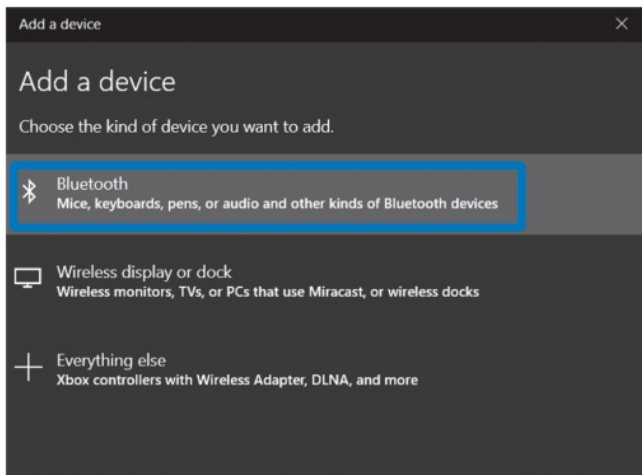

PAIRING

MacOS

Click on "Apple menu". Go to System Preferences -> Bluetooth -> Turn it on
Follow same steps as "Windows" to complete Bluetooth pairing.



Warranty

YEAR LIMITED WARRANTY COVERING DEFECTIVE PARTS

Contact Manufacturer for Additional Information

- This warranty is non-transferable and does not cover failures due to misuse of proper installation or maintenance.
- All warranty coverage applies only if barricaded is used in the United States.

Specifications

Buttons

5

DPI

600 ~ 3600

Dimensions

4.61 x 3.18 x 1.67 inch
11.7 x 8 x 4.2 cm

Operating System

Windows® 7/8/10/11
or later, MacOS 10.5
or later, Android
Chrome OS

Troubleshooting

Problem	Cause	Solution/Prevention
Mouse is not working on USB receiver	Lost connection	Re-plug USB receiver into USB port on computer, set the channel on USB receiver, press the Connect button on the bottom for 10 seconds (keep mouse close to receiver).
	USB port is malfunctioning	Try other proper functioning USB ports on the computer.

Problem	Cause	Solution/Prevention
Mouse is not working on Bluetooth	Lost connection	Set the mouse in Bluetooth pairing mode and pair it with the computer again.
	Connected to wrong device	Under Bluetooth connection (either Bluetooth 1 or 2) mouse should automatically reconnect to its last connected computer, but you can always re-pair again.
LED indicator keeps blinking	Battery is low	Change battery (AA)

For product assistance & missing or replacement parts: WE CAN HELP

1-[888-516-2630](tel:888-516-2630)

7 DAYS/WEEK

7:00am – 9:00pm CST

THIS GUIDE CONTAINS IMPORTANT SAFETY INFORMATION.
PLEASE READ AND KEEP FOR FUTURE REFERENCE.

Find more at [Walmart.com](https://www.walmart.com)

Documents / Resources

	onn B22 5-Button Wireless Mouse [pdf] User Guide MU139, PRDMU139, 100162481, B22 5-Button Wireless Mouse, B22, 5-Button Wireless Mouse, Wireless Mouse, Mouse
---	--

References

- [!\[\]\(694fcb4611893e9db5249daba48abfc1_img.jpg\) **Black Friday Deals Are Here**](#)
- [**User Manual**](#)

[Manuals+](#), [Privacy Policy](#)

This website is an independent publication and is neither affiliated with nor endorsed by any of the trademark owners. The "Bluetooth®" word mark and logos are registered trademarks owned by Bluetooth SIG, Inc. The "Wi-Fi®" word mark and logos are registered trademarks owned by the Wi-Fi Alliance. Any use of these marks on this website does not imply any affiliation with or endorsement.