

**onn.**<sup>TM</sup>

AAGRY100081914 Large  
Rugged Speaker



## Onn.AAGRY100081914 Large Rugged Speaker User Manual

[Home](#) » [Onn.](#) » Onn.AAGRY100081914 Large Rugged Speaker User Manual 

### Contents

- [1 Onn.AAGRY100081914 Large Rugged Speaker User Manual](#)
- [2 What's in the Box?](#)
- [3 Get to Know Small Rugged Speaker](#)
- [4 Power on/ off & Bluetooth Pairing](#)
- [5 References](#)

**onn.**<sup>TM</sup>

Onn.AAGRY100081914 Large Rugged Speaker User Manual



## What's in the Box?

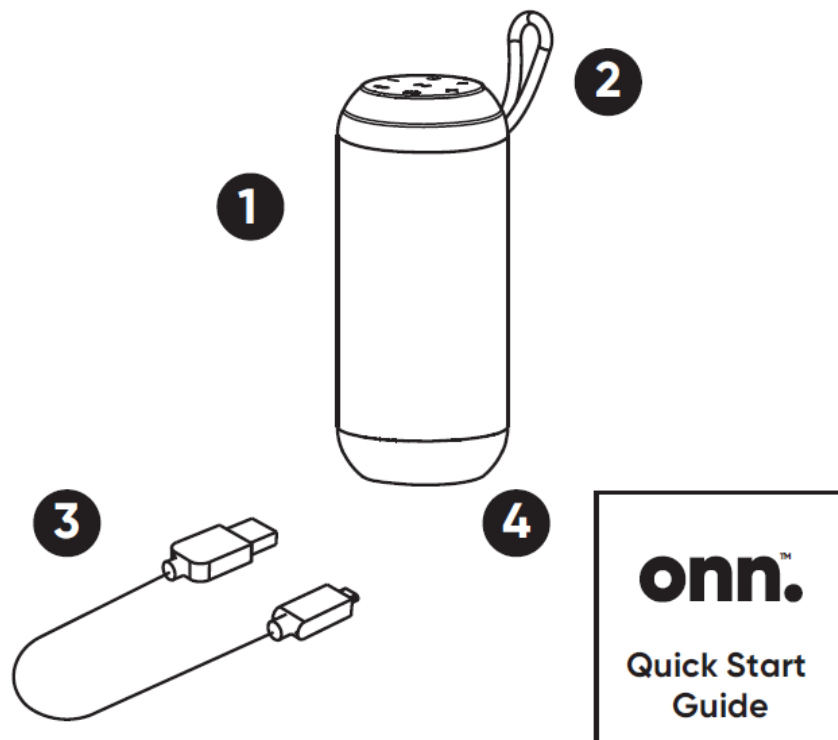

1. Bluetooth Speaker
2. Strap
3. Charging Cable
4. Quick Start Guide

## Get to Know Small Rugged Speaker

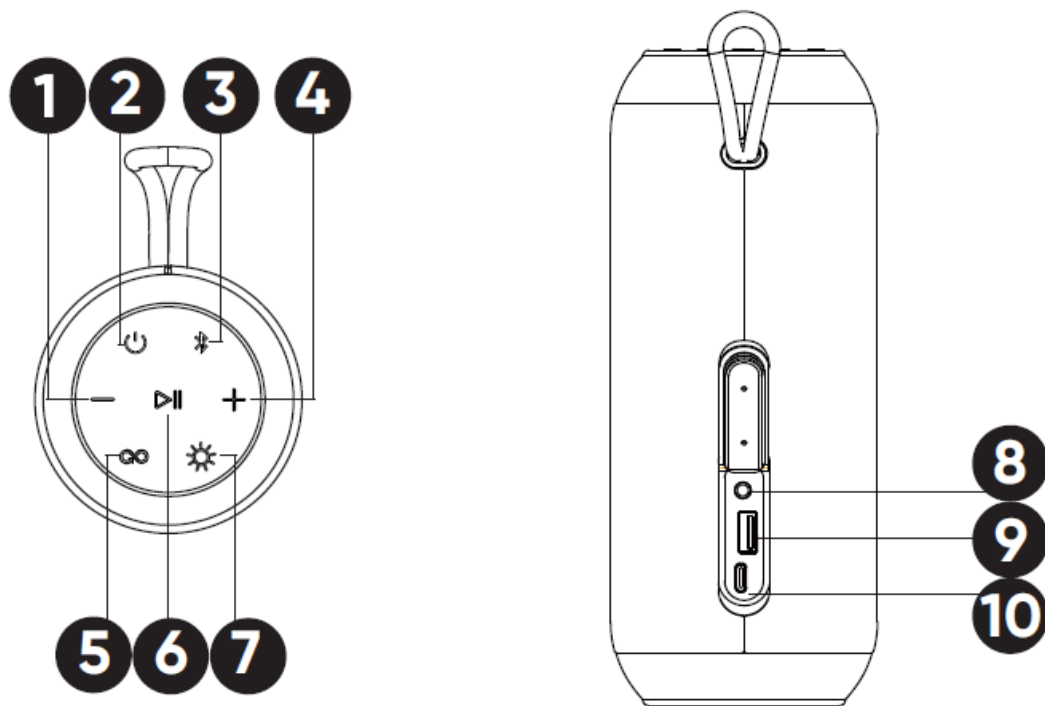

1. Volume -
2. Power
3. Bluetooth
4. Volume +
5. broadcast
6. Play / Pause
7. Light
8. AUX port
9. USB-A
10. charging port

### Power on/ off & Bluetooth Pairing

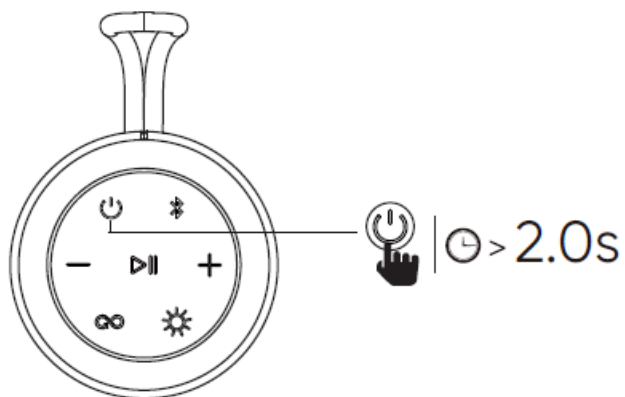

- Press the “” button for 2s to turn on or turn off.

- Short press the “” button to activate the Bluetooth device.
- Use the phone to search for the device’s pairing name “onn.”
- Rugged Speaker L”, and click the pairing name for connection and pairing.

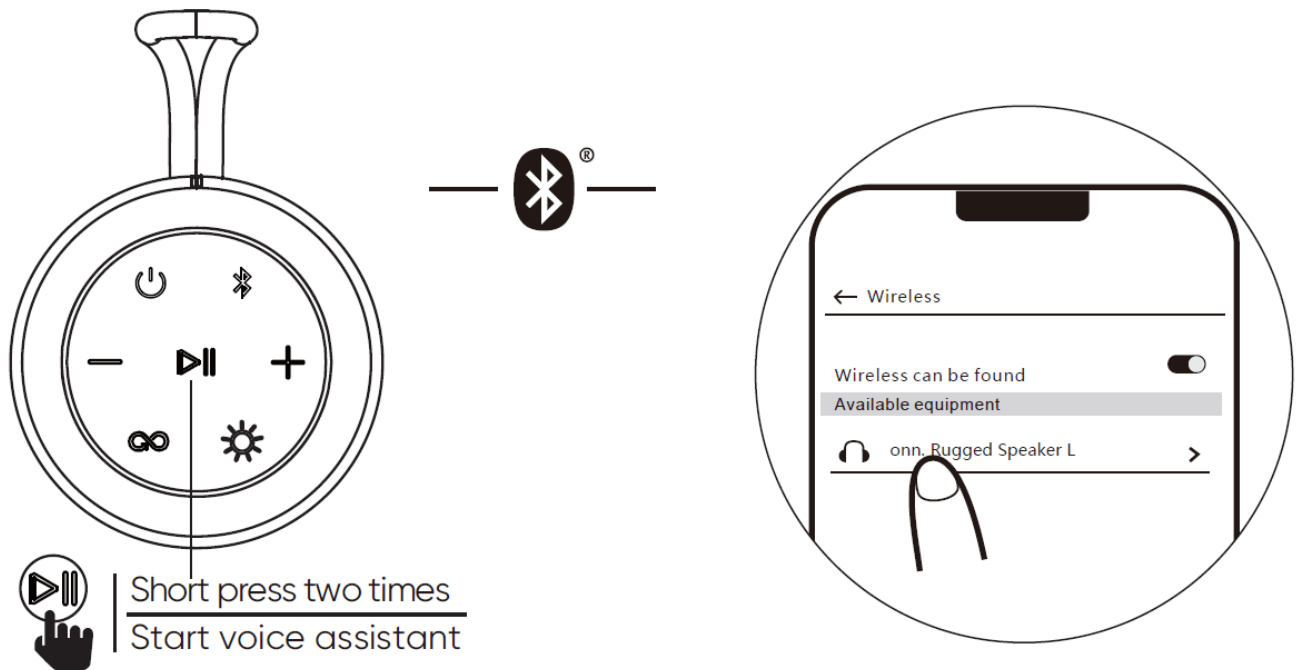

## Playmusic

- Short press the “” button to execute play and pause.
- Short press volume “+” to increase volume.
- Long press volume “+” to the next song.
- Short press volume “-” to reduce volume.
- Long press volume “-” to the previous song.

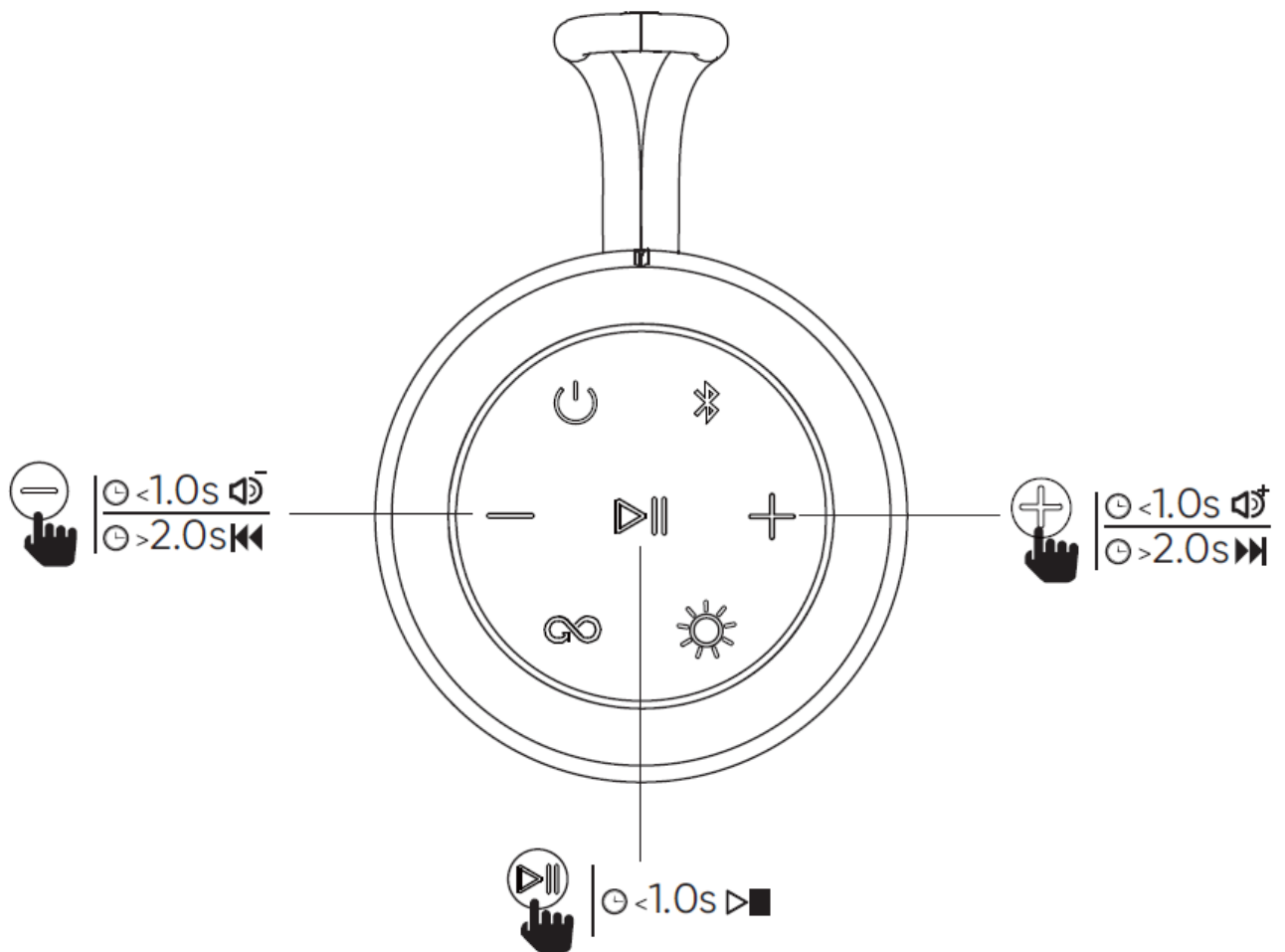

### Answer/End/Reject a call

- Short press the “▶||” button to answer incoming calls.

Short press “▶||” to end the call.

Long press the “▶||” button for 3s to reject a call.

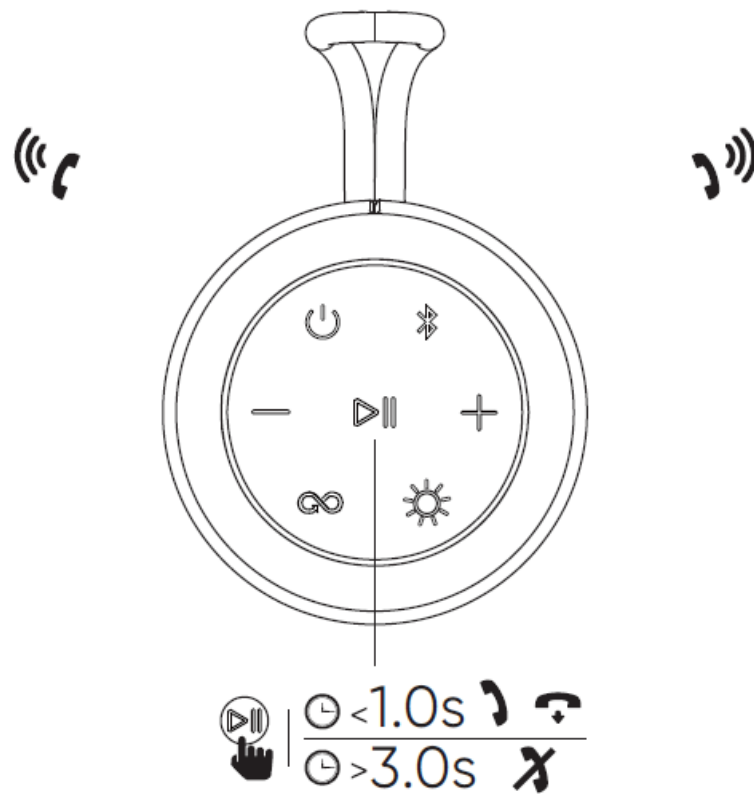

### Pairing two speakers together

Power on two speakers at the same time, and wait for the prompt tone “ Searching for connection ” from both speakers. Then choose one of the speakers as primary, and long press the “ ∞ ” button for 3s to enter TWS pairing mode. You will hear “ left channel, right channel ” and now the two speakers are paired. Use your mobile device to pair with the primary speaker by Bluetooth pairing method, you are now able to play audio in unison using your mobile device. In addition, pressing the “ ∞ ” button two times will disconnect the TWS.

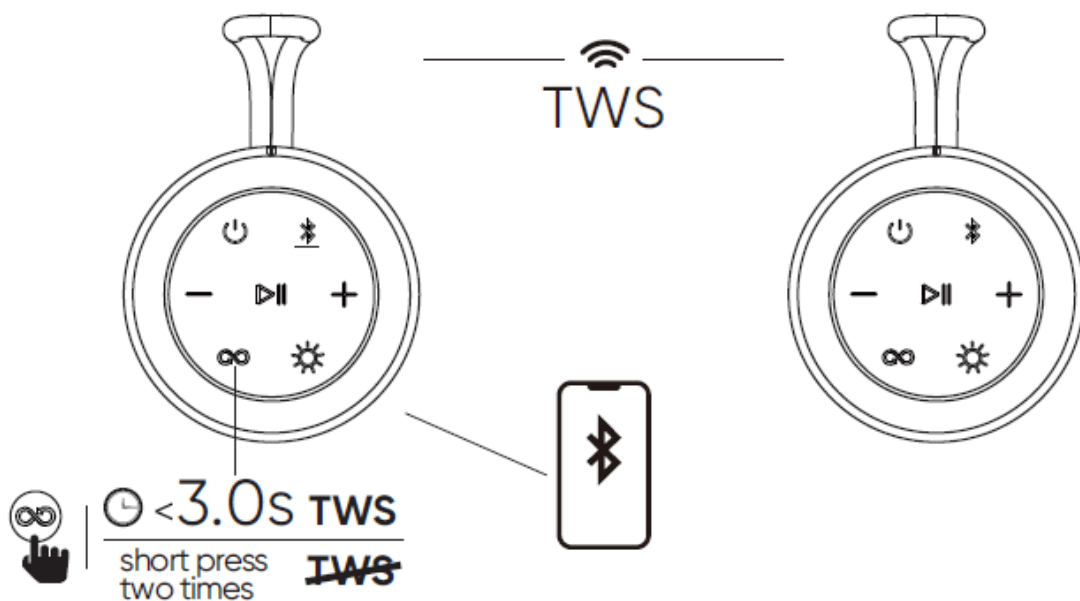

### Clear pairing records and reset speaker

- Press “ ” “ ” for 3s, all pairing records will be cleared and restore the default volume.
- Press “ ” for 10s, The speaker can be reset.

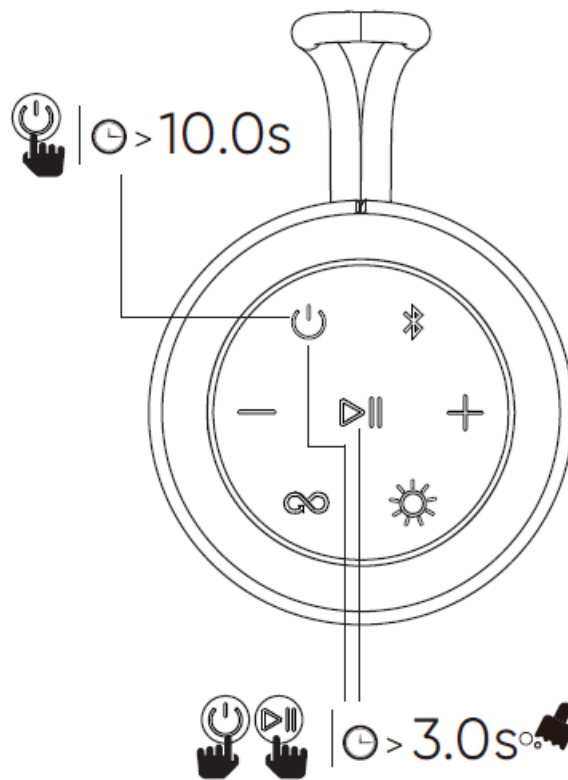

### Charging and connecting outside audio

- To preserve battery lifespan, fully charge at least once every 45 days.
- It takes about four hours to fully charge.

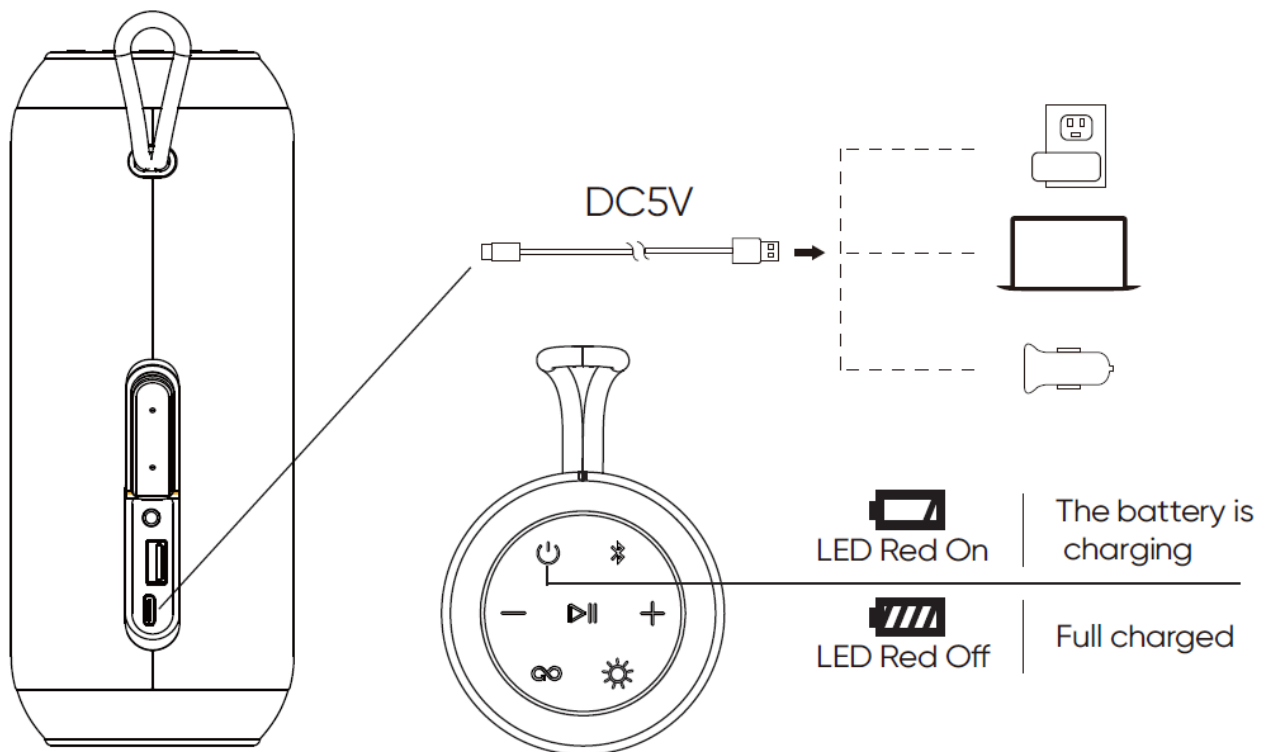

### WARNING

Changes or modifications to this unit not expressly approved by the party responsible for compliance could void the user's authority to operate the equipment.

**NOTE:** This equipment has been tested and found to comply with the limits for a Class B digital device, under Part 15 of the FCC Rules. These limits are designed to provide reasonable protection against harmful interference in a

residential installation. This equipment generates, uses, and can radiate radio frequency energy and, if not installed and used by the instructions, may cause harmful interference to radio communications.

However, there is no guarantee that interference will not occur in a particular installation. If this equipment does cause harmful interference to radio or television reception, which can be determined by turning the equipment off and on, the user is encouraged to try to correct the interference by one or more of the following measures:

- Reorient or relocate the receiving antenna.
- Increase the separation between the equipment and the receiver.
- Connect the equipment to an outlet on a circuit different from that to which the receiver is connected.
- Consult the dealer or an experienced radio/TV technician for help.

This device complies with Part 15 of the FCC Rules. Operation is subject to the following two conditions:

- (1) this device may not cause harmful interference, and
- (2) this device must accept any interference received, including interference that may cause undesired operation.

### **Need help?**

We're here for you every day from 7 a.m. – 9 p.m. CST.

Give us a call at 1-[888-516-2630](tel:888-516-2630)

2022 Walmart onn. is a trademark of Walmart  
All Rights Reserved

We'd love to hear from you. Scan with your Walmart app and let us know what you think.

**Download PDF:** [Onn.AAGRY100081914 Large Rugged Speaker User Manual](#)

### **References**

- [User Manual](#)

[Manuals+](#), [Privacy Policy](#)

This website is an independent publication and is neither affiliated with nor endorsed by any of the trademark owners. The "Bluetooth®" word mark and logos are registered trademarks owned by Bluetooth SIG, Inc. The "Wi-Fi®" word mark and logos are registered trademarks owned by the Wi-Fi Alliance. Any use of these marks on this website does not imply any affiliation with or endorsement.