



## ONKYO CP-1030F Direct Drive Turntable Record Player Owner's Manual

[Home](#) » [ONKYO](#) » ONKYO CP-1030F Direct Drive Turntable Record Player Owner's Manual 

# ONKYO®

SERVICE MANUAL  
QUARTZ SINGLE-PLAY  
FULLY AUTOMATIC  
TURNTABLE  
Model CP-1030F

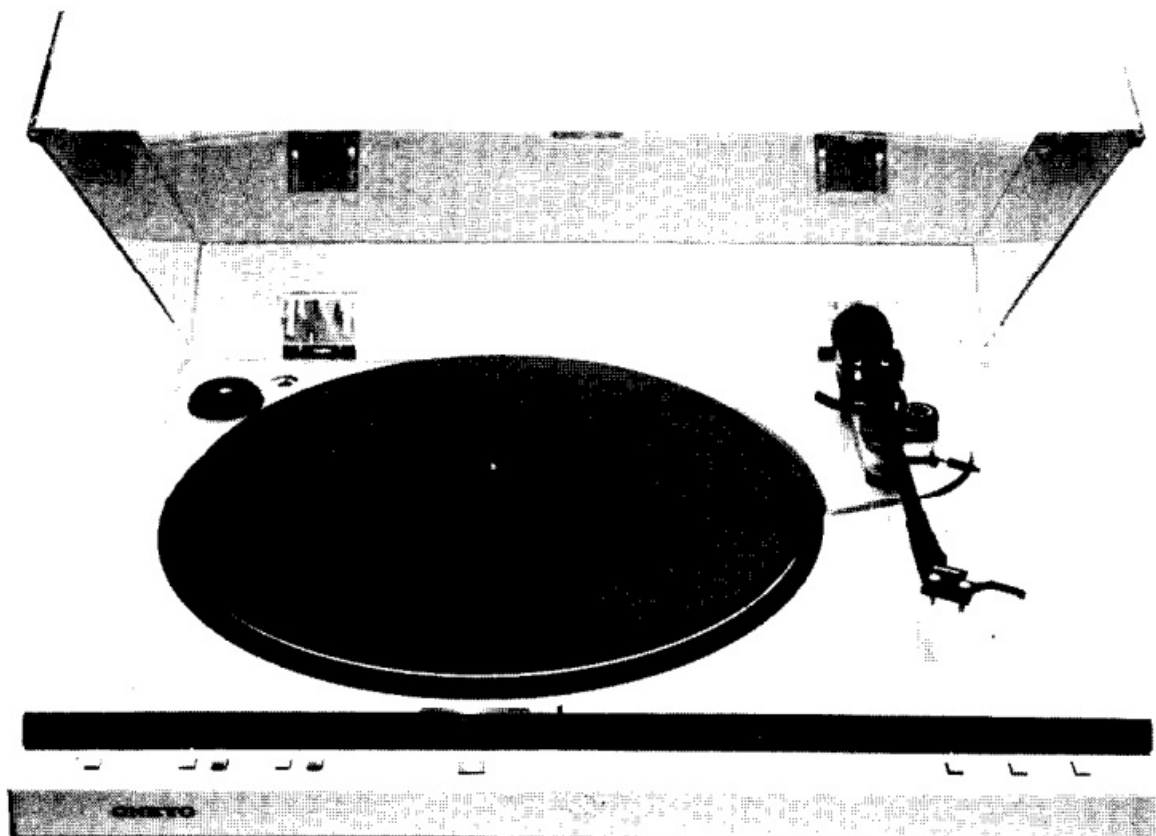

## Contents

- [1 SPECIFICATIONS](#)
- [2 BLOCK DIAGRAM](#)
- [3 PACKING PROCEDURES](#)
- [4 PARTS LIST](#)
- [5 Turntable “Flattens” Warps](#)
- [6 Documents / Resources](#)
- [6.1 References](#)

## SPECIFICATIONS

Type:	2-speed fully-automatic turn- table with cueing lever
Turntable Platter:	31 cm (12-3/16") Aluminum diecast
Motor:	Brushless, coreless, slotless, DC Quartz Direct Drive
Speeds:	33-1/3 rpm, 45 rpm
Wow & Flutter:	0.03%WRMS
Signal-to-Noise Ratio:	75 dB (DIN B)
Tonearm:	Static balanced straight pipe
Effective Arm Length:	224mm (8-13/16")
Overhang:	13mm (/2")
Maximum Tracking Error:	+3 degrees, 1 degree
Usable Cartridge Weight:	Min. 5.0 g, Max. 8.5 g
Power Supply Rating:	AC 110-120, 220-240V, 50/60 Hz (or 240V 50Hz, 120V 60Hz, only)
Power Consumption:	6 watts
Dimensions (W x D x H):	17-7/8" 14-1/2' x5-1/4°
Weight:	6.5 kg (14.3 lbs.)
Cabinet Composition	
Turntable Board:	Polystyrene
Bottom Board:	Fiber Reinforced Polyethylene
Dust Cover:	Polystyrene

In the interest of further product improvements specifications are subject to change with~ut notice.

## BLOCK DIAGRAM

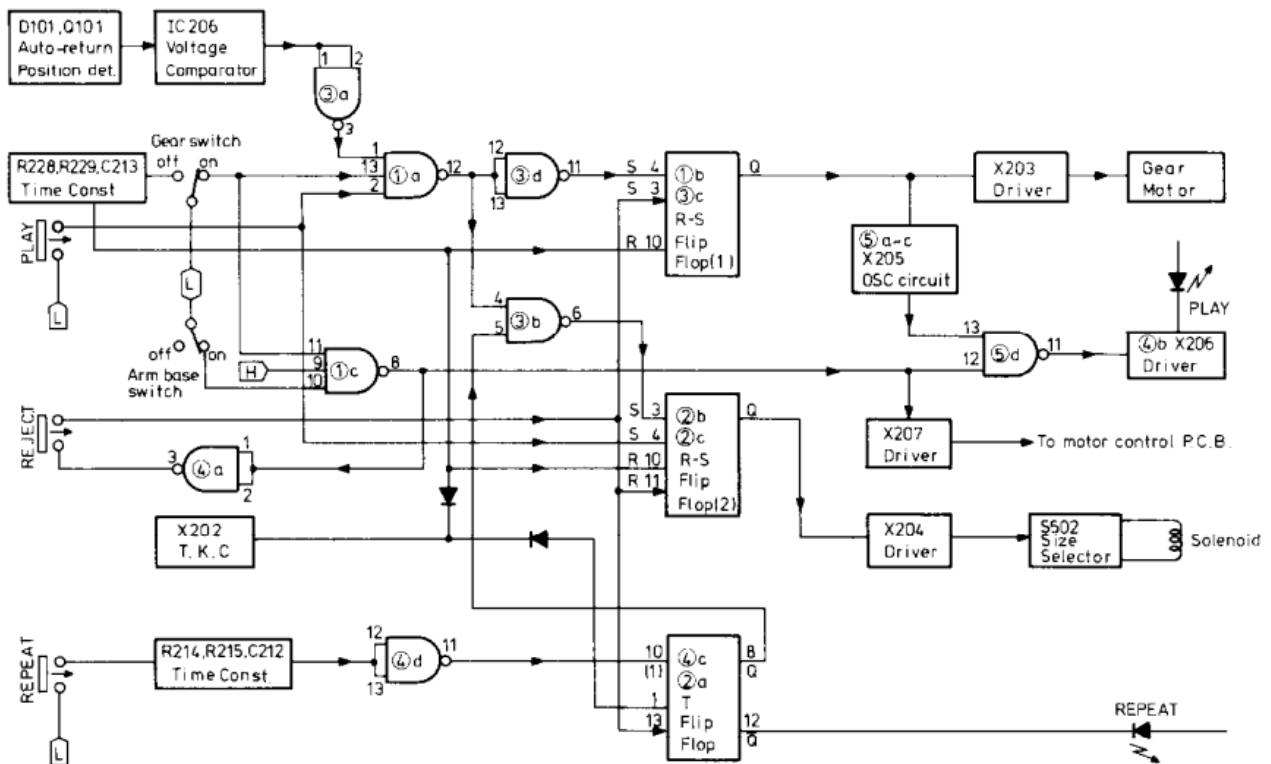

## Service Technology (Part 1)

### Note

1. Refer to the circuit diagram and block diagram.
2. "L" and "H" denote TTL positive logic, while the figures in circles denote IC pin terminal numbers and printed circuit board terminal numbers.
3. FF denotes flip-flop.

#### Play operation

- When IC1a (2) is dropped to "L" level, IC1a (12) is switched over to "H" and IC 1 b ( 6) is switched to "H" to turn X203 on, the main gear drive motor is started.
- When IC2b ( 4) is dropped to "L" level and IC2b ( 6) switched to "H" level to turn X204, the record size selector solenoid is activated.
- When the main gear drive motor is started, the main gear is rotated and SW7 gear switch is turned on.
- When the main gear switch is turned on, IC1c (11) is switched over to "L" and IC 1 c (8)is switched to "H" to turn X207 on, the turntable platter drive motor is started.
- When the main gear is rotated, the tonearm is operated and the tonearm switch is turned on.
- When the IC5a (1) input of oscillator circuit is switched "H" level, it's circuit is operated, thereby the play indicator repeat to turn on and off.
- When the rotation of main gear is finished, the gear switched restores R-F flip-flops to the initial condition and the play indicator is turned on.

#### 4. Reject Operation

- When IC1b(3) is dropped to "L" level and IC1b (6) switched to "H" to turn X203 on, the main gear drive motor is again started up.
- When IC2c (10) is dropped to "L" level, IC2c (8) is switched to "H" and IC2b (6) to "L" to cut X204 off, thereby inhibiting the record size selector solenoid.

#### 5. Repeat Operation

- When IC4c (10) is dropped to “L level, IC4c (8) is switched to “H’ and IC3b (5) kept at “H”. When IC2a (1) is switched to “H’ level, IC2a (12) is dropped to “L” to turn the repeat indicator L.E.D. on. When the tonearm returns automatically at the end of the record, IC206 (6) generates an H pulse ([1]) which is then inverted by IC3d to become an L pulse. When this pulse is applied to IC1a (1), resulting in IC1a (12) being switched to “H level. Thereby when IC3b (6) switched “L” level, IC2b (6) switch to “H’ to turn X204 on and activate the record size selector solenoid.

To release the repeat mode, simply press the REJECT key. In this case, IC2a(13) is dropped to “L level, IC2a (12) switched to “H and IC4c(8) to “L’, followed by IC3b(5) being switched to “L” and IC3b(6) to “H Then in conjunction with the reject operation described above, the repeat mode is released by reject action. In other words, the repeat mode is maintained only as long as IC3b(5) is kept at “H level.

### **Restoration of Initial Condition**

When the main gear drive motor is started up for play or reject operations, the main gear is also rotated. SW7 coupled to the main gear restores two R-S flip-flops initial condition.

### **Auto-Return**

When an eccentric pin of the lead arm coupled to the tone arm is inserted between D601 and Q601, it serves as a shut off mechanism which turns the Q601 phototransistor off.

The difference in voltage is applied to a comparator via IC206 (3), resulting in the generation of a positive pulse which serves as the comparator output appearing at IC206 (6). This pulse is subjected to rectification and inversion at the CR and IC3a, thereby forming a negative pulse which is applied to IC1a(1). This is then followed by return or repeat operation in the same way as described above.

### **Manual Play**

When the tonearm is raised from the arm rest by hand, the tone arm switch drops IC1c(10) to “L level, resulting in IC1c(8) being switched to “H” to turn X207 on, thereby starting up the turntable motor by turn on of X207.

### **Stopping the Turntable Motor**

- When the tonearm is returned manually to the arm rest IC 1 c(10) is switched instantaneously to “H level and IC 1 c(8) to “L”, thereby turning X207 off to bring the turntable motor to a stop.
- When the main gear starts to rotate during reject or auto return mode, the SW7 gear switch is set to “on” position during rotation, and to “off” position end the end of one revolution. As soon as this single revolution is completed, IC1c(11) is switched to “H level.

The arm switch is at “off” position ( on the arm rest) at this time, and IC1c(10) is at “H” level. At the instant that IC1c(8) is switched to “L”, resulting in X207 being cut off to stop the turntable motor.

### **Power On Reset**

When the power switch is turned on, three FFs at X202 time constant circuit are reset to their prescribed initial state.

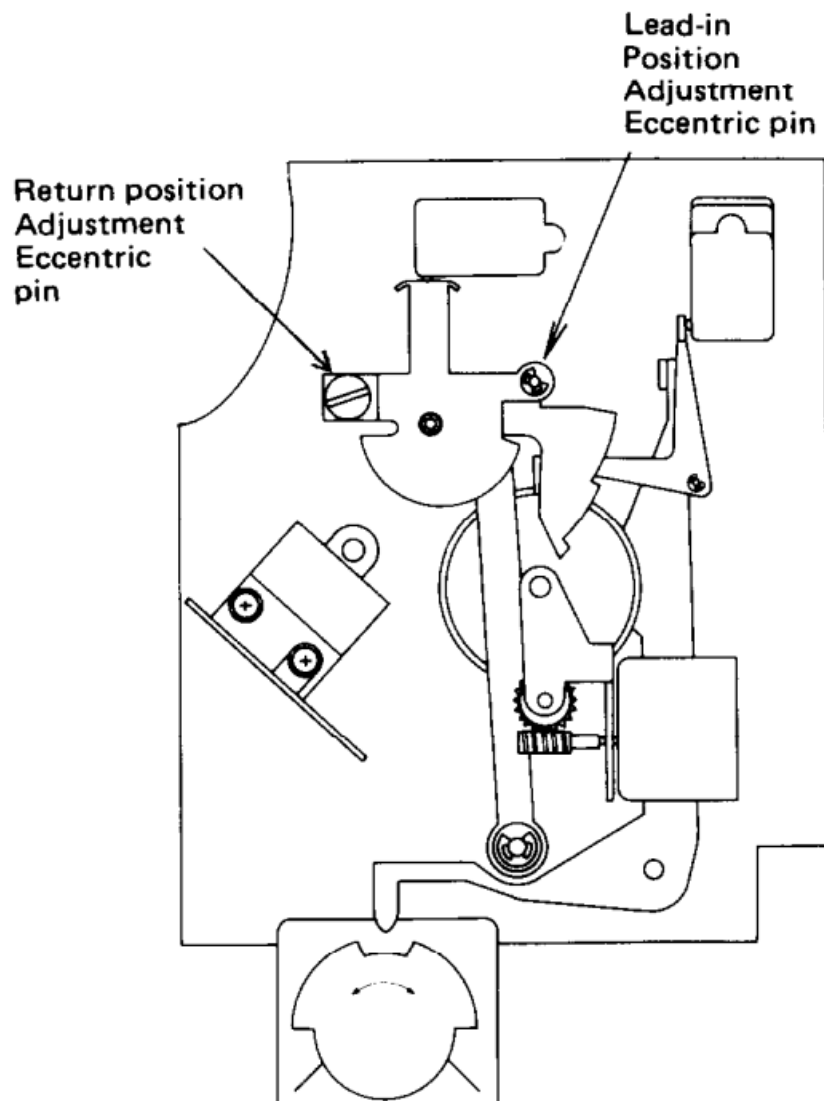
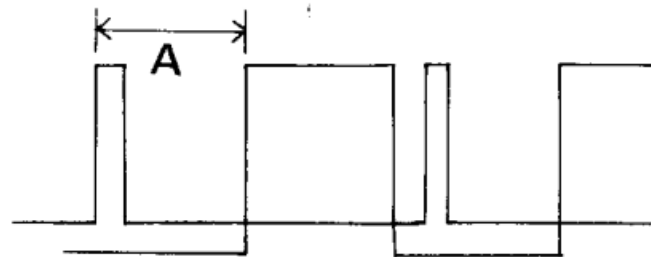
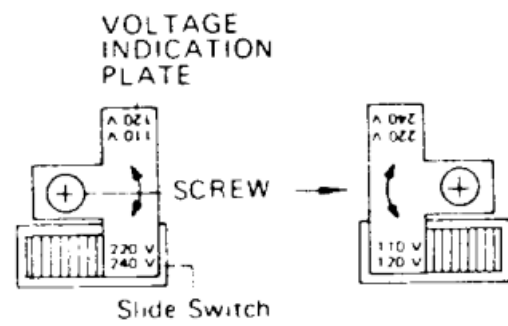

## PACKING PROCEDURES

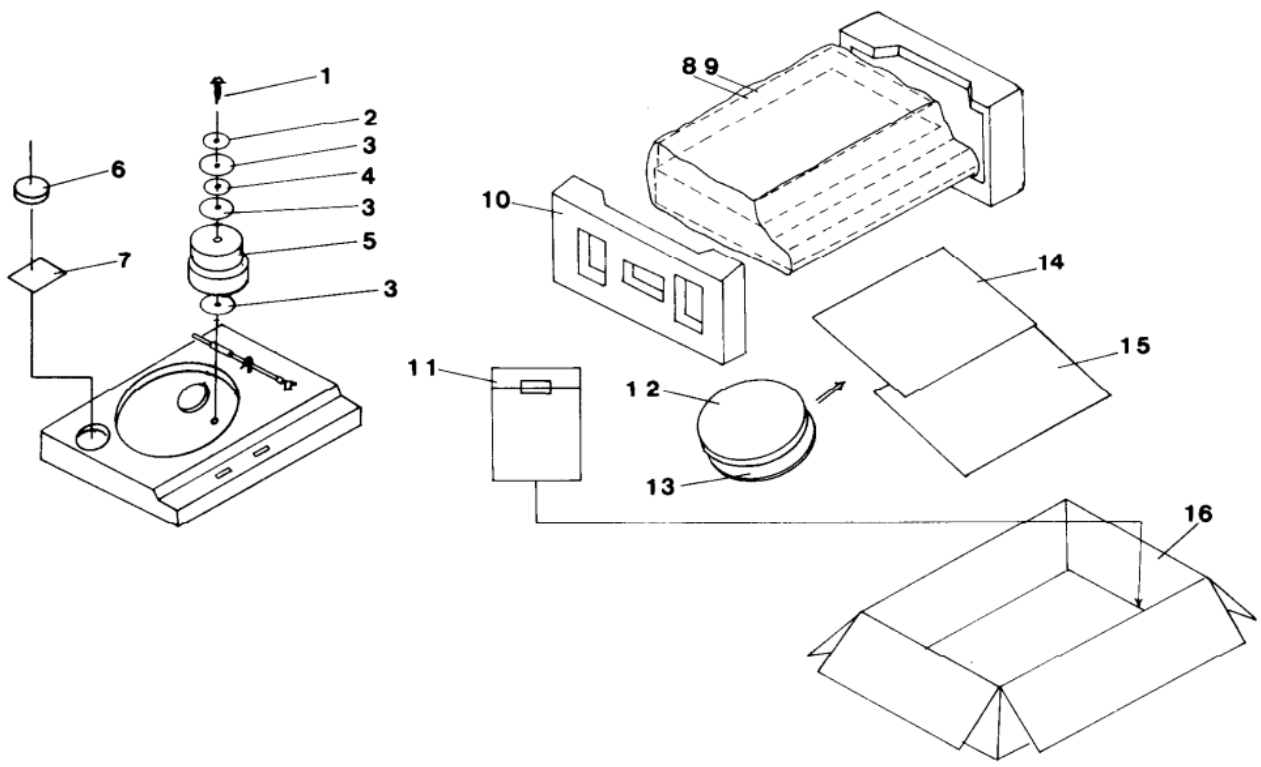

REF. NO.	PARTS NO.	DESCRIPTION
1	24059147	FMT#4 x 30, Screw
2	870063	FW4.6ϕ x 10ϕ x 0.5", Washer
3	24500464	Caution card
4	24506248	FW4.7 x 28ϕ x 0.4°, Washer
5	24501246	Counter weight
6	292049A	45 adaptor
7	24509061	Poly sheet
8	29095097	280 x 200 mm, Protection sheet (Power supply cord)
	29100042	550 x 550 mm, Protection sheet (Dust cover)
	29095012	800 x 500 mm, Protection sheet (Cabinet)
9	29100018	750 x 650 mm, Poly bag
10	24509139	Pad
11	29100005 29340369	220 x 330 mm, Poly bag Instruction manual (Universal and 240V model)
	29340370 25055018	Instruction manual (Only 120V model) CV-K-1, Conversion plug (Only Universal model)
	29365006	Warranty card (Only U.S.A. model)
	29365005-2	Warranty card (Only Germany model)
	24509168	Overhang gage
12	24502088	Turntable platter
13	24509085	T.T. mat
14	29100008	350 x 450 mm, Poly bag
15	24509162	500 x 420 mm, Bottom pad sheet
16	29050299	Carton box

## EXPLODED VIEW

REF. NO.	PARTS NO.	DESCRIPTION
1	24506255	Mechanism chassis
2	24506256	Selector ass'y
3	893032	E3, 2, Circlip
4	24503082	Spring for 2
5	24503081	Main gear (2)
6	24503080	Main gear (1)
7	24503083	Gear (1)
8	24505097	Switch p.c.b. complete
8-1	24506322	Switch p.c.b.
8-2	24504286	Seat for switch
8-3	25035163	NPS-111-S127, Switch
8-4	28320303	Push switch knob
8-5	24504285	Button sleeve
9	82113006	FM + 3 x 6, Pan head screw
10	24506259	Rotation plate
11	24506288	W5φ x 13φ x 1 <sup>1</sup> / <sub>2</sub> , Washer
12	24502079	Friction rubber
13	893040	E-4, Circlip
14	24506260	Switch arm
15	893020	E-2, Circlip
16		Play and Repeat indicator p.c.b.
17	24502080	L.E.D. p.c.b. complete
17-1	24506261	Record size selector solenoid ass'y
17-2	24506289	Sub-chassis
17-3	24506308	Magnet ass'y
17-4	82112006	Selector cam ass'y
17-5	24506293	FM + 2 x 6, pan head screw
17-6	24506293	W3.1φ x 6φ x 0.1 <sup>1</sup> / <sub>2</sub> , Poly slider washer
17-7	24502081	Spool ass'y
17-8	893020	E-2, Circlip
17-9	82112604	FM + 2.6 x 4, Pan head screw
18	24503090	Damper
19	82112612	Switch ass'y
20	24506280	FM + 2.6 x 12, Pan head screw
20-1	24506281	Arm base ass'y (1)
20-2	24506282	Arm base ass'y (1)
20-3	24506287	Eccentric pin
20-4	24503089	E-4, Circlip
20-5	841130140	Arm spring
20-6	24506283	M3 x 14, Hexagone bolt
21	24505099	Eccentric pin
22	831130082	Tonearm control p.c.b. complete
23	24506313	3STW + 8BQ, Tapping screw
23-1	24503085	Sensor holder ass'y
23-2	24506268	Sensor holder
23-3	24506268	Connector ass'y
23-4	260208	Binder
23-5	24506263	Sensor bracket
24	82113006	FM + 3 x 6, Pan head screw
24-1	24505101	Power supply p.c.b. (UU)
24-2	24505102	Power supply p.c.b. (UD)
25	24505068	Power supply cord (UU)
26	24505076	Power supply cord (UD)
26-1	24505098	L.E.D. p.c.b. complete
26-2	24506328	Switch bracket ass'y (1) (UU)
26-3	24506332	Switch bracket ass'y (1) (UD)
26-4	25035162	NPS-222-222-L126, Push switch
26-5	25035149	NPS-121-L113P, Power switch (UU)
26-6	25035150	NPS-111-L114P, Power switch (UD)
26-7	24506262	Seat for switch
26-8	24506327	Switch bracket (2)
26-9	28320303	Push switch knob
27	83813006	BT + 3 x 6, Tapping screw
28	82113006	FM + 3 x 6, Pan head screw
29	24505112	Control p.c.b. complete
30	371121044	0.1μF, 50V, Mylar capacitor
31	24502087	Motor/control p.c.b. complete (UU)
32	24502086	Motor/control p.c.b. complete (UD)
33	831140124	FMT + 4 x 12, Screw
34	230341	NPT-689DQ, Power transformer (UU)
34-1	230342	NPT-689D, Power transformer (UD)
34-2	24505079	Terminal ass'y (UU)
34-3	24505084	Terminal ass'y (UD)
35	24505061	Shielded wire (UU)
36	24505075	Shielded wire (UD)
37	24505012	3 x 14, Tube
38	24506151	Terminal
39	24501250	Tonearm ass'y
40	24506241	E-9, Circlip
41	24506240	FW10φ x 22φ x 1 <sup>1</sup> / <sub>2</sub> , Washer
42	24504278	Elevation shaft
43	24504279	Spring for 38
44	893030	E3, Circlip
45	24504280	Elevation plate
46	24506276	Lifter arm
47	24506277A	Cueing lever
48	24506278	Lifter lever knob
49	24506279	Plate for cam
50	83313006	FMT + 3 x 6, Tapping screw
51	24506275	Special nut
52	24503088	Spring for cam
53	24504270	I.F.C. knob
54	24506243	Washer
55	24503077	I.F.C. spring
56	24504271	I.F.C. cam
57	831130062	3STW + 6BQ, Tapping screw
58	24501221	Arm rest
59	87113006	SSW3, Washer
60	861330	FLN3, Nut
61	833240124	FMT + 4 x 12, Tapping screw
62	24504263B	Lamp cover
63	833240164	FMT + 4 x 16, Tapping screw
64	24506304	Bracket, power supply (UU)
65	24506292	Bracket, power supply (UD)
66	290280	SR4K-4, Strainrelief (UU)
67	270025	SR-3P-4, Strainrelief (UD)
68	24509100	Leg (UU)
68-1	24509169	Leg (UD)
68-2	24509175	Leg (UU)
69	24509174	Leg (UD)
70	24506172	Receptacle for leg
71	24504277	Receptacle for leg
72	24509104	Mounting stud
73	24509157A	Bottom case
73-1	24509126	Dust cover ass'y
73-2	24504275	Name plate
74	24509127	Dust cover
75	24509128	Cushion
	24506234	Hinge
	24502088	Turntable platter
	24509085	T.T mat
	292049A	45 rpm adaptor
	24509173	Cabinet ass'y
	24504282	Operation plate
	24509172	Cabinet
	24503084	Gear (2)
	24502084	DML-148Q-12, DC motor with 74

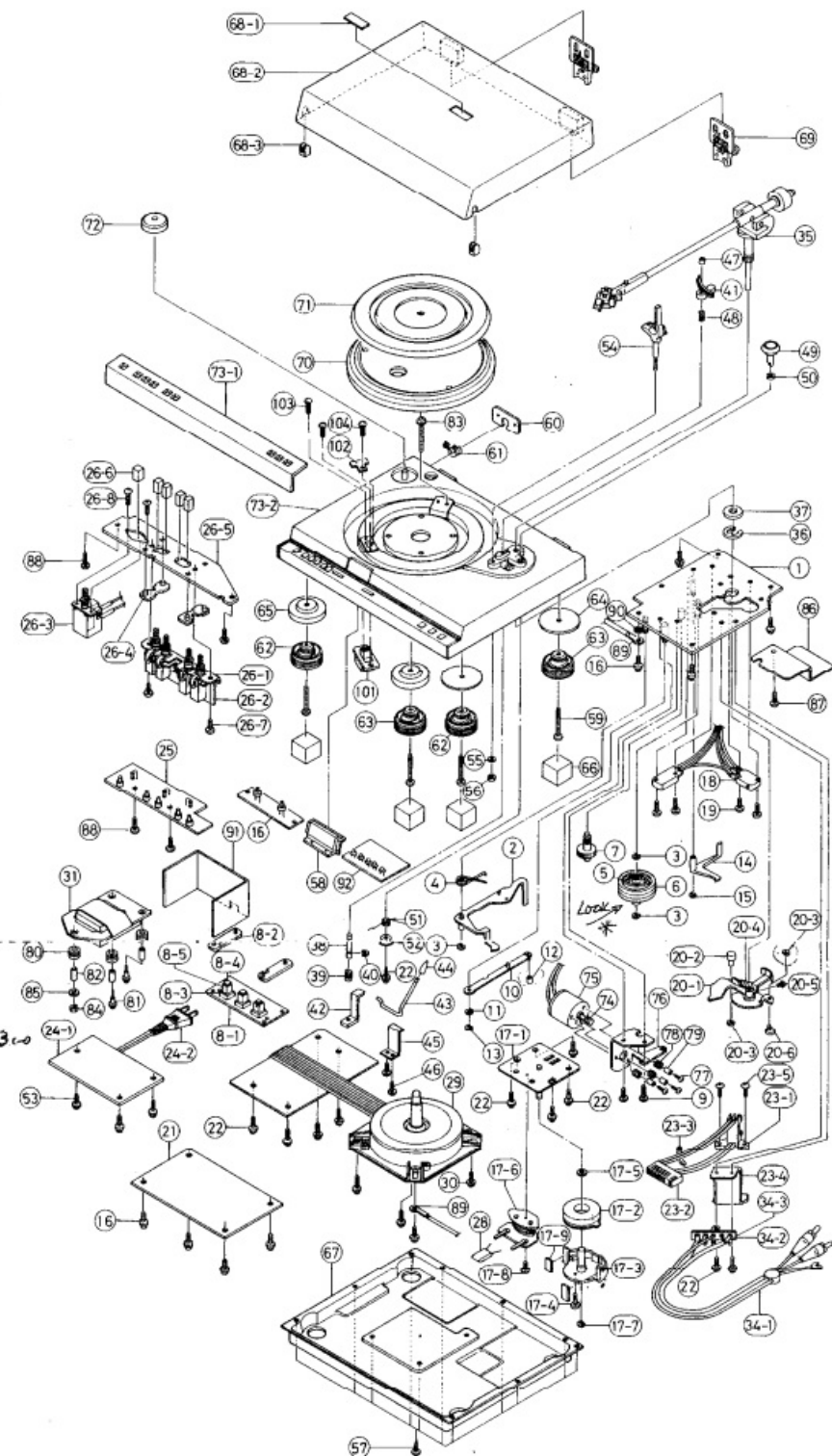

REF. NO.	PARTS NO.	DESCRIPTION
76	24506258	Bracket for gear
77	801212	FM + 2.6 x 6, Pan head screw
78	24610125	Rubber cushion
79	24610124	Coil for motor
80	24506331	Rubber cushion
81	24509179	Special screw
82	24506330	Sleeve
83	82233040	M3 x 40, Screw
84	86233010	WN3 x 10FN, Nut
85		
86	24506291	Shielded plate
87		
88	838130082	BT + 3 x 8, Tapping screw
89	24505081	Ground wire
90	87313008	TOW-3, Tooth washer
91	24506333	Shielded plate
92	24505096	Strobe Scope p.c.b. complete
93	28135061	Q mark badge
101	250159	Slide switch (UU)
102	24505065	Voltage plate (UU)
103	82113012	FM + 3 x 12, Pan head screw (UU)
104	838130082	BT + 3 x 8, Tapping screw (UU)
105	24509176	Rubber cap (UD)

NOTE: (UU) Only Universal model  
(UD) Only U.S.A. model



# PARTS LIST

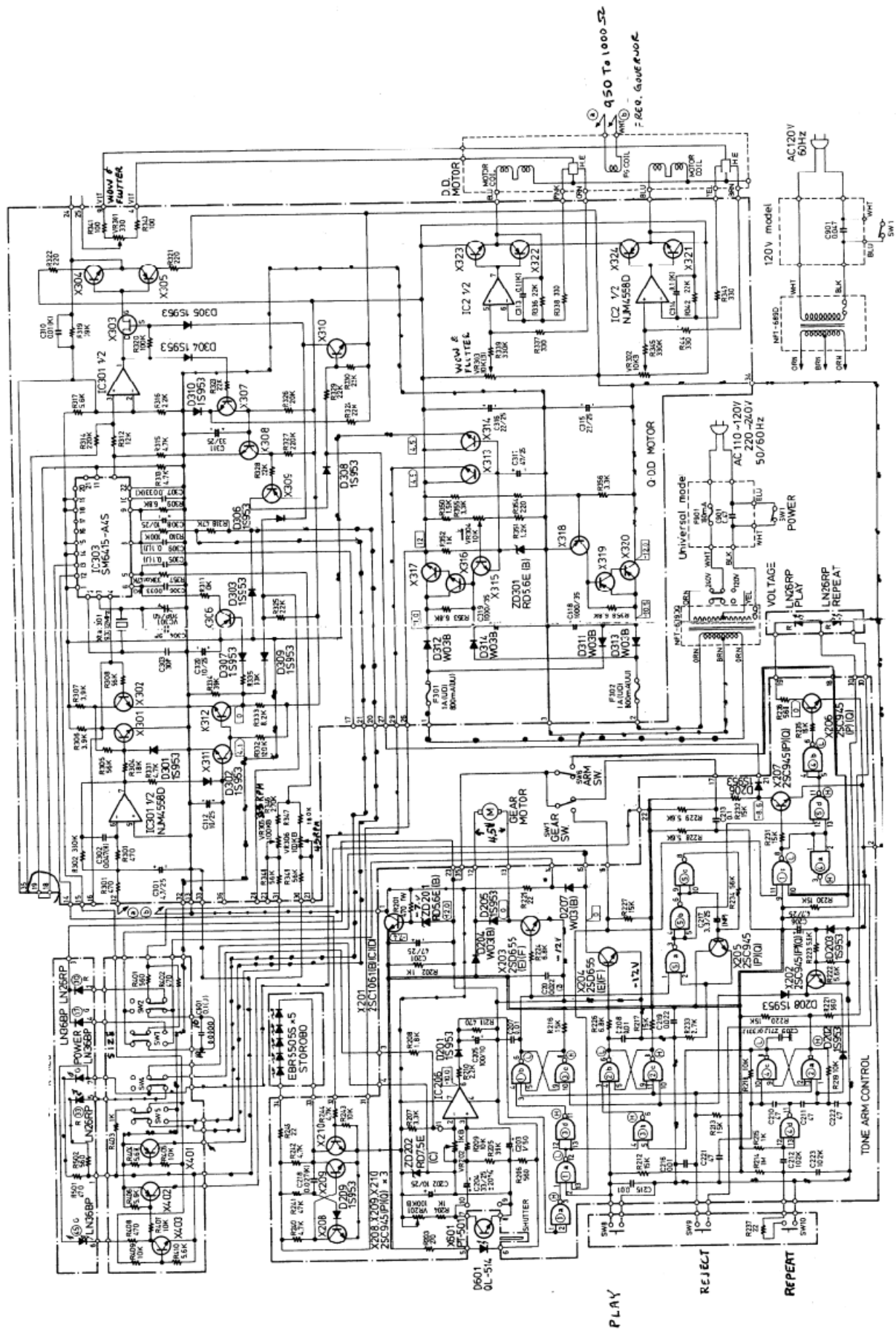

REF. NO.	CIRCUIT NO.	PARTS NO.	DESCRIPTION
8		24505097	Switch p.c.b.
16			Play and repeat indicator p.c.b.
21		24505099	Tonearm control p.c.b.
24		24505101	Power supply p.c.b. (UU)
		24505102	Power supply p.c.b. (UD)
25		24505098	Power/Speed/Size indicator p.c.b.
27		24505112	Control p.c.b.
29		24502087	Motor/control p.c.b. (UU)
		24502086	Motor/control p.c.b. (UD)
92		24505096	Strobo scope p.c.b.
	SW1	25035149	NPS-121-L113P, Power switch (UU)
	SW1	25035150	Power switch (UD)
	SW2-SW5	25035162	NPS-222-222-L126, Push switch
	SW6	24503049	K-3, Micro switch
	SW7	24503040	K-1, Micro switch
	SW8-SW10	25035163	NPS-111-S127, Tact switch
		225036	GL-514, L.E.D. for return detector
		226001	PT-501A, Phototransistor
35		24501250	Tonearm ass'y
		24501247	Screw for tonearm
		24501246	Counter weight
		24501252	Headshell
		24501231	Screw for cartridge
		24501232	Nut for cartridge
		24500079	Washer for cartridge
		24505106	2P+7P, Connector ass'y
		24505105	2P, brown and orange, Connector ass'y
		24505107	2P, yellow and green, Connector ass'y
		24505108	3P, Connector ass'y
		24505109	6P, Connector ass'y
		24505104	2P, red and blue, Connector ass'y

#### TONEARM CONTROL PC BOARD – PARTS LIST

CIRCUIT NO.	PARTS NO.	DESCRIPTION
	<b>ICs</b>	
IC201, IC202	222439 or	SN7410N or HD7410P
	222481 or	
IC203, IC204	222425 or	SN7400N or HD7400P
	222478 or	
IC205	222586 or	SN74LS00 or HD74LS00
	222582 or	
IC206	222545	μPC741C
	<b>Transistors</b>	
	2201082,	
X201	2201083 or	2SC1061(B), (C) or (D)
	2201084	
	2210353	
X202	2210354 or	2SC945(P) or (Q)
	2211705	
X203, X204	2211706 or	2SD655(E) or (F)
	2210353	
X205-X210	2210354 or	2SC945(P) or (Q)
	<b>Diodes</b>	
	223947 or	RD5.6E or HZ6A-3L
ZD201	224091 or	
	223954	RD7.5E(C)
ZD202	223127	1S953
D201-D203	223851	W03(B)
D204	223127	1S953
D205, D206	223851	W03(B)
D207	223127	1S953
D208, D209	223127	1S953
	<b>Resistors</b>	
R201	441624714	470Ω, 1W, Metal oxide film
VR201	5225015	N10HR10KBD, Semi-fixed
VR202	5225024	N10HR1KBD, Semi-fixed
	<b>Capacitors</b>	
C201	352754701	47μF, 25V, Elect.
C202	352741001	10μF, 16V, Elect.
C203	352780101	1μF, 50V, Elect.
C204	352743301	33μF±20%, 16V, Elect.
C205	352741011	100μF, 16V, Elect.
C206	352750471	4.7μF, 25V, Elect.
C217	352950336	3.3μF, 25V, Non-polar elect.
	<b>Terminals</b>	
Z4	24506302	2P
Z5	24506301	3P

	Connector posts
Z7	24506318 2P
Z8	24506319 3P
Z9	24506299 4P
Z10	24506297 5P
Z11	24506320 6P

#### MOTOR/CONTROL PC BOARD – PARTS LIST

CIRCUIT NO.	PARTS NO.	DESCRIPTION
	<b>ICs</b>	
IC301, IC302	222465	NJM-4558D
IC303	222583	SM6415A-4S
	<b>Transistors</b>	
	2210351	2SC945(K)
X301, X302	2211672 or	2SC2308(B) or
	2211292	2SK68(L)
X303	2210351	2SC945(K)
	2211672 or	2SC2308(B) or
X304	2211362	2SA844(B)
	2210803 or	2SA733(P) or
X305, X306	2210351	2SC945(K)
	2211672 or	2SC2308(B) or
X308, X307	2211362	2SA844(B)
	2210803 or	2SA733(P) or
X309	2210351	2SC945(K)
	2211627 or	2SC2308(B) or
X310-X316	2200842	2SC1419(B)
	2211362	2SA844(B)
X317	2210803 or	2SA733(P) or
X318, X319	2200852	2SA755(B)
	2201112	2SD794(R)
X320	2201122 or	2SC1162(B) or
	2201132	2SB744(R) or
X321, X323	2201142 or	2SA715(B) or
	<b>Diodes</b>	
	224082	WZ056
ZD301	223947 or	RD5.6EB or
	223127	1S953
D301-D310	223851	W03(B)
D311-D314		
	<b>X'tal</b>	
Q301	3010039	9.3312MHz
	<b>Semi-fixed resistors</b>	
	5225025	N10HR330BD
VR301	5225015	N10HR10KBD
VR302-VR304	5225080	N10HR100KBDM
VR305, VR306		
	<b>Capacitors</b>	
	352750471	4.7μF, 25V, Elect.
C301	352751001	10μF, 25V, Elect.
C308	352753301	33μF, 25V, Elect.
C311	352751001	10μF, 25V, Elect.
C312	352752201	22μF, 25V, Elect.
C315, C316	352744701	47μF, 16V, Elect.
C317	352761021	1,000μF, 35V, Elect.
C318, C319	352751001	10μF, 25V, Elect.
C320	3060008	NTC20P07, Trimmer
VC301		
	<b>Terminals</b>	
	24506302	2P
Z4	24506301	3P
Z5	24506300	4P
Z6	24506303	5P
Z7		
	<b>Fuseholder</b>	
	24506098	(UD)
	24506312	(UU)
	<b>Fuse</b>	
	252066	1A (UD)
	252080	800mA (UU)
F301, F302		
	<b>Fuse label</b>	
	24505110	800mA (UU)
	2827281A	1A (UD)

## Turntable “Flattens” Warps

Onkyo's new CP-1030F turntable is a single-play, fully automatic, direct-drive model with a quartz-lock speed control and a specially designed low-mass carbon-fiber

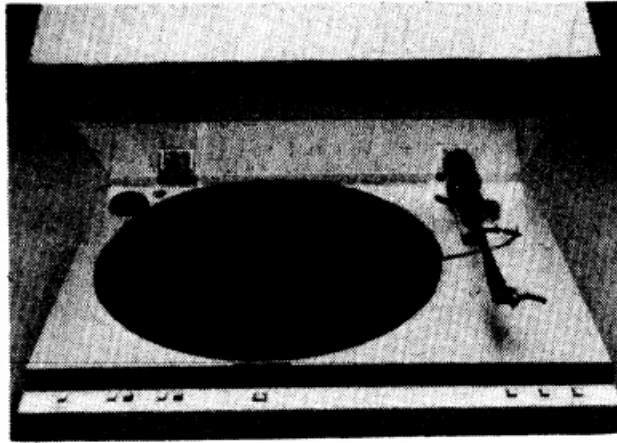

tonearm said to give optimum results with today's high-compliance cartridges. Low frequency resonance of the arm and a typical high-compliance cartridge is controlled well enough, according to Onkyo, to allow warped records to be played with a minimum of distortion. In addition, the turn-table has a rated signal-to-noise ratio of 75 dB and wow and flutter less than 0.03% (WRMS). Reliability of the unit is said to be enhanced by the use of an additional motor dedicated to tonearm functions. A set of LED indicators show what functions are engaged. \$315. CIRCLE NO. 98 ON FREE INFORMATION CARD

### Digital Encoder Interface

Sensor Technology has introduced an incremental encoder, the Digipot®, which provides an interface manually with a digi

### ONKYO CORPORATION

International Division: No. 24 Mori Bldg., 23-5, 3-chome, Nishi-Shinbashi, Minato-ku, Tokyo, Japan

Telex: 2423551 ONKYO J.

Phone: 03432-6981

### ONKYO U.S.A. CORPORATION

Eastern Office

42-07 20th Avenue, Long Island City, New York 11105, U.S.A. Phone: (212) 728-4639

Midwest Office

935 Sivert Drive, Wooddale, Illinois 60191, U.S.A. Phone: (312) 595-2970

### ONKYO DEUTSCHLAND GMBH, ELECTRONICS

8034 M~nchen-Germering, Industriestrasse 18, West Germany. Telex: 521726 Telefon: (089)-84-5041

## Documents / Resources

	<p><a href="#">ONKYO CP-1030F Direct Drive Turntable Record Player</a> [pdf] Owner's Manual  CP-1030F Direct Drive Turntable Record Player, CP-1030F, Direct Drive Turntable Record Playe  r, Drive Turntable Record Player, Turntable Record Player, Record Player, Player</p>
--	---

## References

-  [Manual-Hub.com](https://www.manual-hub.com) - Free PDF manuals!

- [User Manual](#)

[Manuals+](#), [Privacy Policy](#)

This website is an independent publication and is neither affiliated with nor endorsed by any of the trademark owners. The "Bluetooth®" word mark and logos are registered trademarks owned by Bluetooth SIG, Inc. The "Wi-Fi®" word mark and logos are registered trademarks owned by the Wi-Fi Alliance. Any use of these marks on this website does not imply any affiliation with or endorsement.