



OMOTON M503 Bluetooth Wireless Mouse User Manual

[Home](#) » [OMOTON](#) » OMOTON M503 Bluetooth Wireless Mouse User Manual 

Contents

- [1 OMOTON M503 Bluetooth Wireless Mouse](#)
- [2 Product Information](#)
- [3 Product Usage Instructions](#)
- [4 Specifications](#)
- [5 Package Contents](#)
- [6 Compatible Systems](#)
- [7 Product Overview](#)
- [8 Instructions for Use](#)
- [9 Preparations for the Mouse](#)
- [10 Cursor Speed Control \(DPI\)](#)
- [11 Power management](#)
- [12 Troubleshooting](#)
- [13 Important Safeguards & Precautions](#)
- [14 Documents / Resources](#)
 - [14.1 References](#)
- [15 Related Posts](#)

OMOTON

OMOTON M503 Bluetooth Wireless Mouse



Product Information

- **Product Name:** Wireless Mouse M503

Specifications:

- **Compatible Systems:** iPadOS 13/ MacOS 10.15.5 or newer; Windows 7/ 8/ 10; Android system
- **Package Contents:** 1 x Wireless Mouse, 1 x User Manual

Product Overview:

1. Left Button
2. Right Button
3. Scrolling Wheel
4. The Blue Indicator Light
5. Bluetooth Connection Button
6. ON/OFF Slider

Product Usage Instructions

Preparations for Pairing with iPad

ATTENTION:

1. Make sure the system of your iPad has been updated to iPadOS13 or newer.
2. Go to Settings – Select Accessibility – Turn on the Assistive Touch.

3. Enable the Bluetooth function of your iPad. Note: The same preparation goes for iPhone Series.

Preparations for the Mouse

BATTERY INSTALLATION STEPS:

1. Open the battery cover.
2. Insert one AA battery.
3. Cover the battery cover.

Note:

Open the battery cover and install one AA battery. The ON/OFF slider should be in the ON position.

- Press and hold the Bluetooth connection button for more than 3 seconds until the blue light flashes quickly. You can start pairing now.
- Select and click "BT5.0 Mouse" on your device. The connection is completed.

Cursor Speed Control DPI

Press the vertical scrolling and right button for more than 3 seconds at the same time to switch among 800/1200/1600 DPI.

1. First press for toggling to 800 DPI.
2. Second press for toggling to 1200 DPI.
3. Third press for toggling to 1600 DPI.

Power Management

Power Saving Mode:

The mouse will automatically go to sleep after 30 minutes of inactivity. Press any button and wait 3 seconds to reactivate it.

Replacing Batteries

Lift the battery compartment cover up. Replace the spent battery with one new AA battery and put the cover back on (Battery not included).

Note:

Make sure that the positive (+) and negative (-) terminals are on the correct sides.

Troubleshooting

If you cannot connect the Bluetooth mouse to your device, or if the mouse is not working, please try the following:

1. Make sure your device has Bluetooth and Bluetooth is enabled.
2. Restart the device and try to pair again.
3. Install a new battery and try to pair again.
4. Cancel your device's Bluetooth connection with other devices, and try to pair again.
5. Check to see if the Bluetooth software has been updated recently. If it hasn't, update the software and try to pair again.

6. Make sure the Bluetooth mouse is within 33ft / 10m of your device.

Important Safeguards & Precautions

1. SAVE THESE INSTRUCTIONS. They contain essential safety and operating instructions.
2. Please remove the battery when the mouse is not in use for a long period of time.
3. For indoor use only. Do not expose the mouse to direct sunlight or wet conditions.
4. Do not use the mouse if equipment is damaged.
5. Do not disassemble the product. Disassembly can result in safety hazards.
6. Do not throw or shake the product.

Contact Information:

- **Web:** www.omoton.com
- **E-mail:** service@omoton.com

Made in China.

Specifications

- **Connection Mode:** Bluetooth
- **Bluetooth Edition:** BT 5.0
- **Lifespan :** 3 million clicks
- **Number of Buttons:** 3
- **DPI Levels:** 800/1200/1600 DPI
- **Operating Range:** 33 ft/10 m
- **Battery:** 1 x AA battery
- **Net Weight:** 55g ± 5g
- **Dimensions:** 110 x 63 x 23 mm

Package Contents

- 1 x Wireless Mouse
- 1 x User Manual

Compatible Systems

- iPadOS 13/ MacOS 10.15.5 or newer;
- Windows 7/8/10;
- Android system

Product Overview

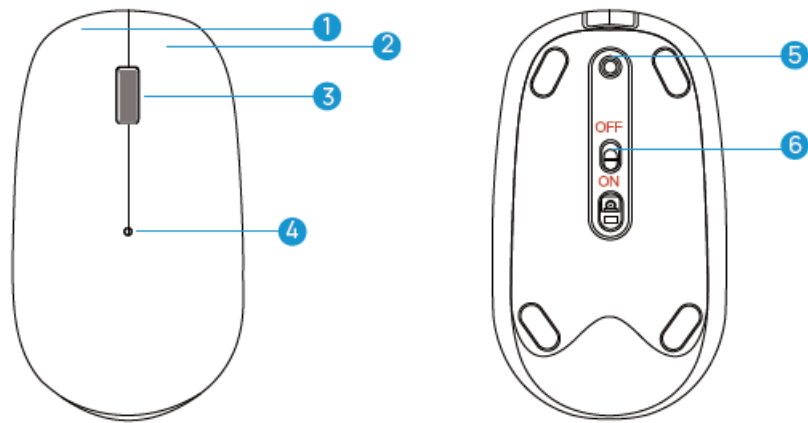

1. Left Button
2. Right Button
3. Scrolling Wheel
4. The Blue Indicator Light
5. Bluetooth Connection Button
6. ON/OFF Slider

Instructions for Use

Preparations for Pairing with iPad

ATTENTION

1. Make sure the system of your iPad has been updated to iPadOS13 or newer.
2. Go to Setting-Select Accessibility-Turn on the "Assistive Touch".
3. Enable the Bluetooth function of your iPad.

Note: The same preparation goes for iPhone Series.

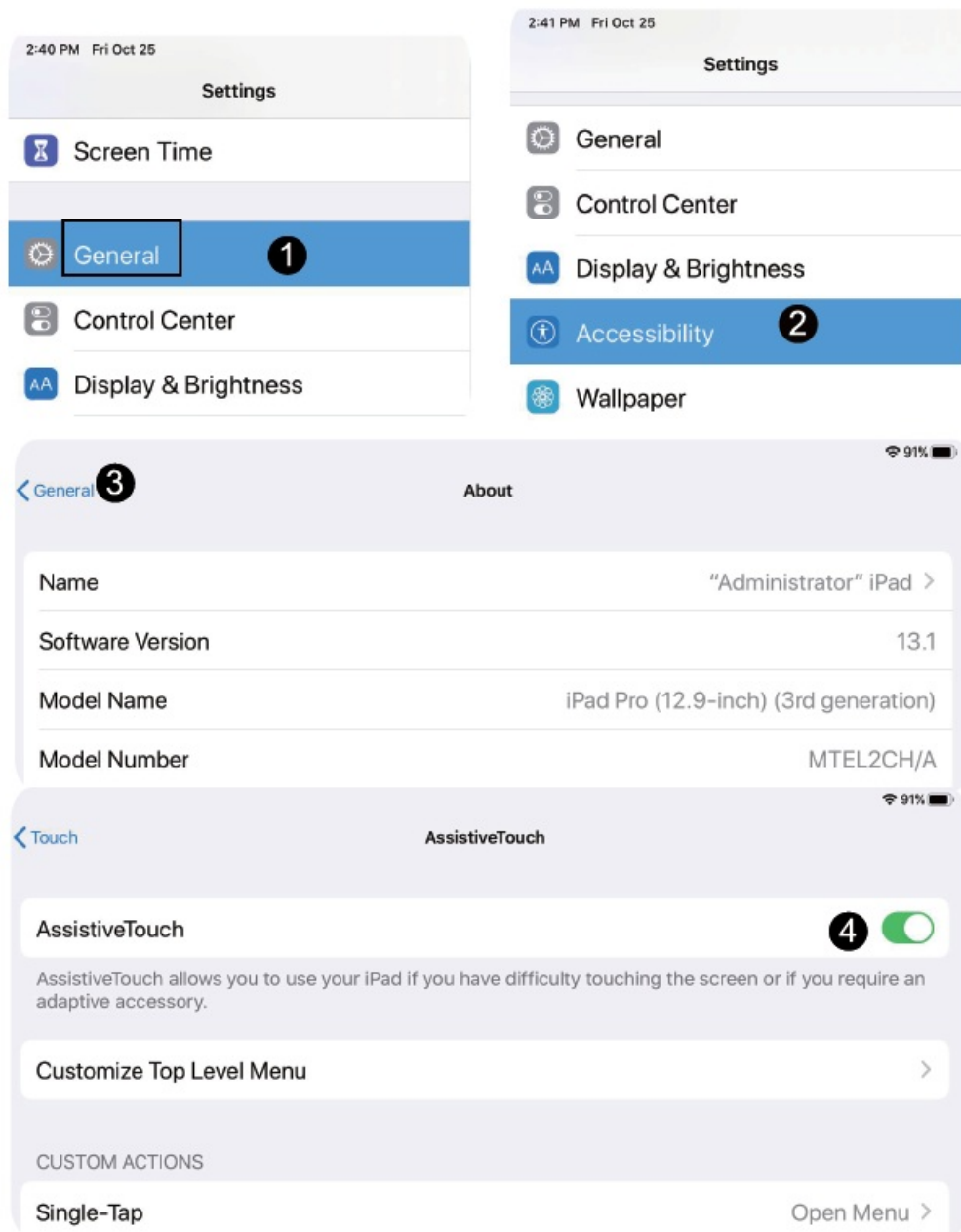

Preparations for the Mouse

BATTERY INSTALLATION STEPS



Note:

Open the battery cover and install one AA battery.

1. The ON\OFF slider should be in the ON position.

2. Press and hold the Bluetooth connection button for more than 3 seconds until the blue light flashes quickly.

You can start pairing now.

3. Select and click "BT5.0 Mouse " on your device. The connection is completed.

Cursor Speed Control (DPI)

Press the vertical scrolling and right button for more than 3 seconds at the same time to switch among 800/1200/1600 DPI.

1. First press for toggling to 800 DPI;
2. Second press for toggling to 1200 DPI;
3. Third press for toggling to 1600 DPI.

Power management

Power Saving Mode

The mouse will automatically go to sleep after 30 minutes of inactivity. Press any button and wait 3 seconds to reactivate it.

Replacing Batteries

Lift the battery compartment cover up. Replace the spent battery with one new AA battery and put the cover back on (Battery not included).

Note:

Make sure that the positive (+) and negative (-) terminals are on the correct sides.

Troubleshooting

If you cannot connect the Bluetooth mouse to your device, or if the mouse is not working, please try the following:

1. Make sure your device has Bluetooth and Bluetooth is enabled.
2. Restart the device and try to pair again.
3. Install the new battery and try to pair again.
4. Cancel your device's Bluetooth connection with other devices, and try to pair again.
5. Check to see if the Bluetooth software has been updated recently. If it hasn't, update the software and try to pair again.
6. Make sure the Bluetooth mouse is within 33ft/10 m of your device.

Important Safeguards & Precautions

1. SAVE THESE INSTRUCTIONS-They contain essential safety and operating instructions.
2. Please remove the battery when the mouse is not in use for a long period of time.
3. For indoor use only. Do not expose the mouse to direct sunlight or wet conditions.
4. Do not use the mouse if equipment is damaged.
5. Do not disassemble the product. Disassembly can result in safety hazards.
6. Do not throw or shake the product.

Contact Information

- Web: www.omoton.com
- E-mail: service@omoton.com.

Made in China.

Documents / Resources

	OMOTON M503 Bluetooth Wireless Mouse [pdf] User Manual M503 Bluetooth Wireless Mouse, M503, Bluetooth Wireless Mouse, Wireless Mouse, Mouse
---	--

References

-  [Elevating Your Tech | OMOTON](#)
- [User Manual](#)