



# omnipod DASH Podder Insulin Management System User Guide

[Home](#) » [omnipod](#) » **omnipod DASH Podder Insulin Management System User Guide** 

## Contents

- [1 omnipod DASH Podder Insulin Management System](#)
- [2 How to Deliver a Bolus](#)
- [3 Reminder](#)
- [4 How to Set a Temp Basal](#)
- [5 Did You Know?](#)
- [6 Suspend and Resume Insulin Delivery](#)
- [7 Reminder](#)
- [8 How to Change a Pod](#)
- [9 Don't forget!](#)
- [10 How to View Insulin and BG History](#)
- [11 History at Your Fingertips!](#)
- [12 Documents / Resources](#)
  - [12.1 References](#)
- [13 Related Posts](#)



## omnipod DASH Podder Insulin Management System



### How to Deliver a Bolus

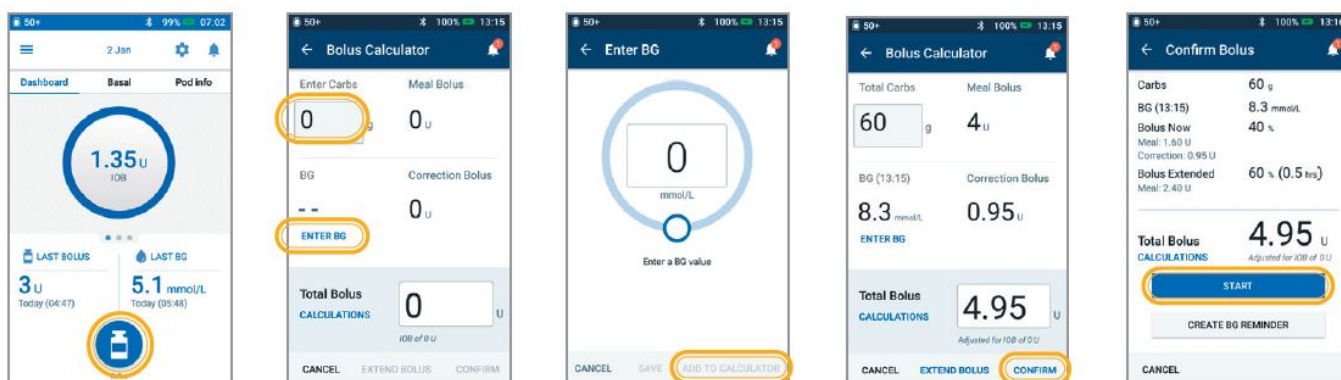

1. Tap the Bolus button on the Home screen
2. Enter grams of carbs (if eating) Tap "ENTER BG"
3. Enter BG manually Tap "ADD TO CALCULATOR"
4. Tap "CONFIRM" once you have reviewed your entered values
5. Tap "START" to begin bolus delivery

### Reminder

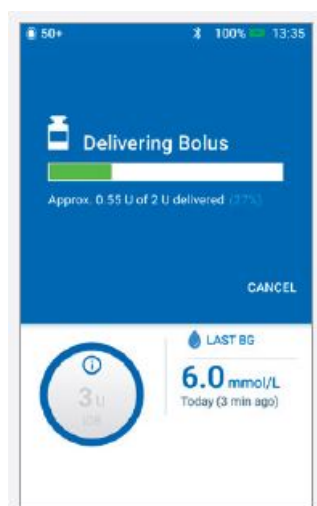

The Home screen displays a progress bar and details while you are delivering an immediate bolus. You cannot

use your PDM during an immediate bolus.

## How to Set a Temp Basal

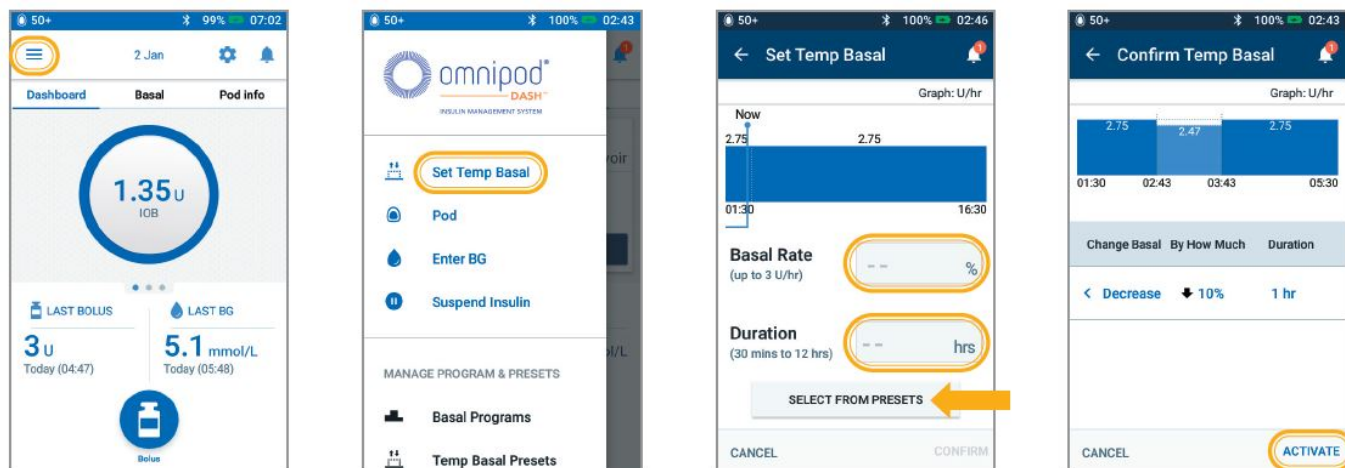

1. Tap the Menu icon on the Home screen
2. Tap “Set Temp Basal”
3. Tap Basal Rate entry box and select your % change Tap Duration entry box and select your time duration Or tap “SELECT FROM PRESETS” (if you have saved Presets)
4. Tap “ACTIVATE” once you have reviewed your entered values

## Did You Know?

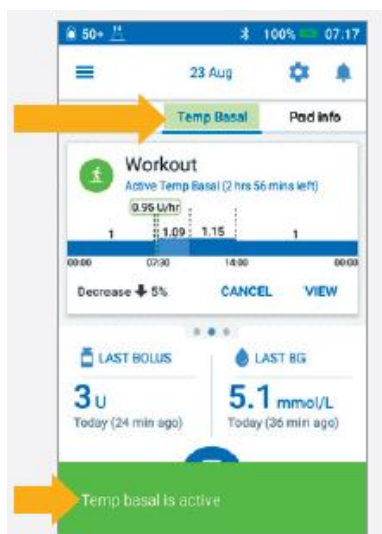

- Temp Basal is highlighted in green if there is an active temp basal rate running
- You can swipe to the right on any green confirmation message to dismiss it sooner

## Suspend and Resume Insulin Delivery

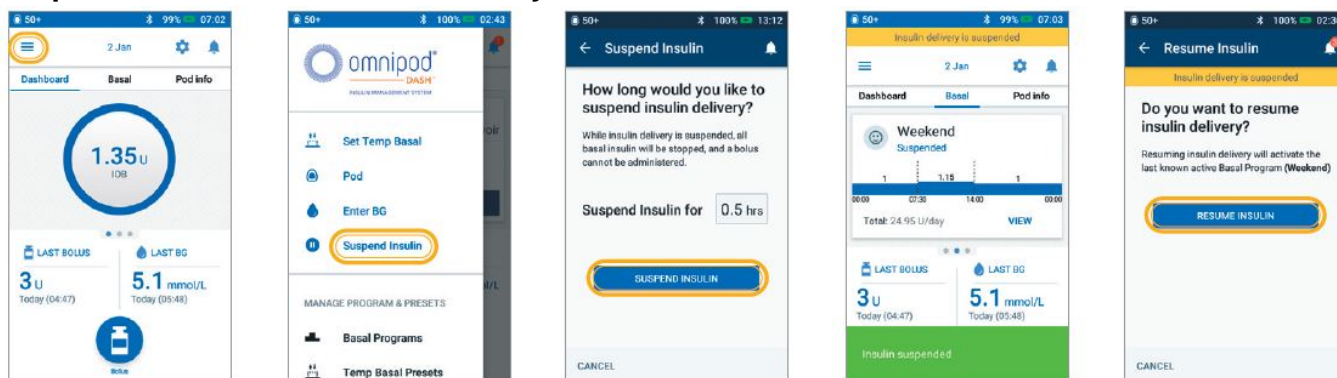

1. Tap the Menu icon on the Home screen
2. Tap “Suspend Insulin”
3. Scroll to the desired duration of insulin suspension Tap “SUSPEND INSULIN” Tap “Yes” to confirm you want to stop insulin delivery
4. The Home screen displays a yellow banner stating insulin is suspended
5. Tap “RESUME INSULIN” to start insulin delivery

## Reminder

- You **MUST** resume insulin, insulin does not automatically resume at end of the suspension period
- The Pod beeps every 15 minutes throughout the suspension period to remind you that insulin is not being delivered
- Your temp basal rates or extended boluses are canceled when insulin delivery suspends

## How to Change a Pod

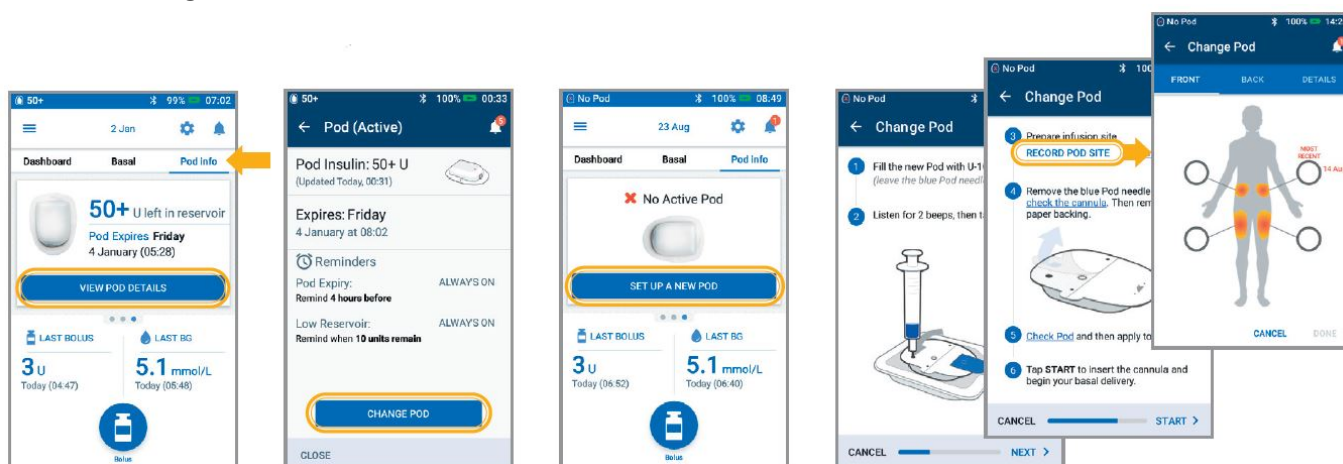

1. Tap “Pod Info” on the Home screen • Tap “VIEW POD DETAILS”
2. Tap “CHANGE POD” Carefully follow the on-screen directions Pod will be deactivated
3. Tap “SET UP NEW POD”
4. Carefully follow the on-screen directions For more detailed instructions refer to the Omnipod DASH® Insulin Management System User Guide

**Don't forget!**

- Keep the Pod in a plastic tray during fill and prime
- Place the Pod and PDM next to each other and touch during priming
- Record your pod site and ensure you are rotating your pod sites well

## How to View Insulin and BG History

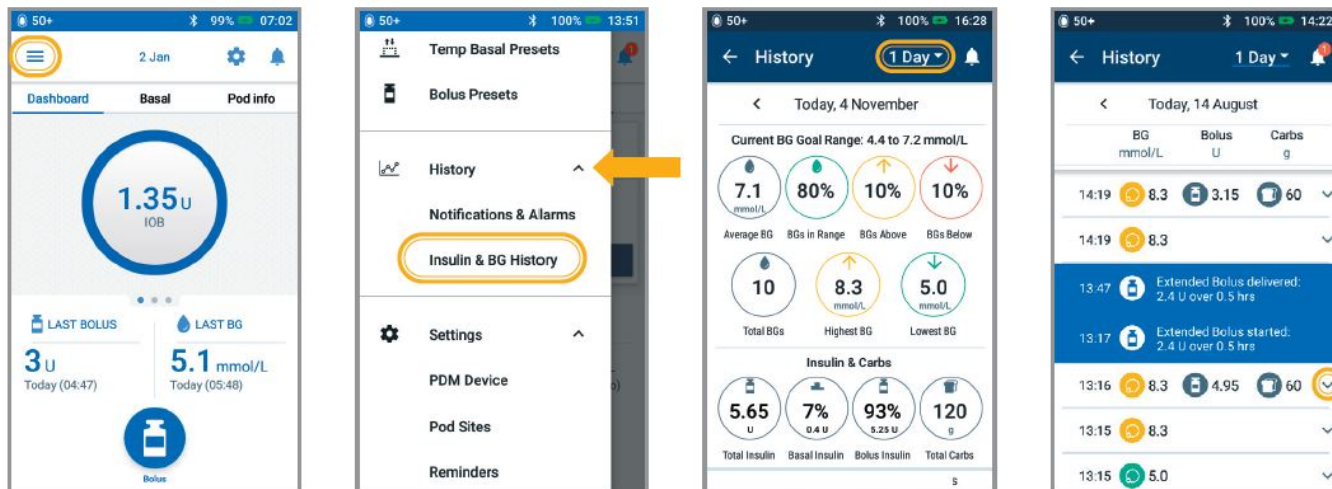

1. Tap Menu icon on the Home screen
2. Tap “History” to expand list Tap “Insulin & BG History”
3. Tap the day drop-down arrow to view 1 day or multiple days
4. Continue swiping up to see the details section Tap the down arrow to display more details

## History at Your Fingertips!

- BG info:
  - Average BG
  - BG in Range
  - BGs Above and Below range
  - Average Readings per day
  - Total BGs (in that day or date range)
  - Highest and Lowest BG
- Insulin info:
  - Total Insulin
  - Avg Total Insulin (for a date range)
  - Basal Insulin
  - Bolus Insulin
  - Total Carbs
- PDM or Pod events:
  - Extended Bolus
  - Activation/reactivation of a Basal program
  - Start/end/cancellation of a Temp Basal
  - Pod activation and deactivation

input from your healthcare provider, and the Omnipod DASH® Insulin Management System User Guide. Personal Diabetes Manager imagery is for illustrative purposes only and should not be considered suggestions for user settings. Refer to the Omnipod DASH® Insulin Management System User Guide for complete information on how to use the Omnipod DASH® System, and for all related warnings and cautions. The Omnipod DASH® Insulin Management System User Guide is available online at Omnipod.com or by calling Customer Care (24 hours/7 days), at 1-855-POD-INFO (763-4636). This Podder™ Quick Glance Guide is for the Personal Diabetes Manager model PDM-CAN-D001-MM. The Personal Diabetes Manager model number is written on the back cover of each Personal Diabetes Manager. © 2021 Insulet Corporation. Omnipod, the Omnipod logo, Simplify Life, DASH, and the DASH logo are trademarks or registered trademarks of Insulet Corporation in the United States of America and other various jurisdictions. All rights reserved. The Bluetooth® word mark and logos are registered trademarks owned by the Bluetooth SIG, Inc. and any use of such marks by Insulet Corporation is under license. Other trademarks and trade names are those of their respective owners. INS-ODS-02-2021-00035 v1.0

Documents / Resources

	<a href="#">omnipod DASH Podder Insulin Management System</a> [pdf] User Guide DASH, Podder Insulin Management System, DASH Podder Insulin Management System
---	---

References

-  [Omnipod | Insulin Pump Therapy, Simplified](#)