



Omnipod DASH Podder Insulin Management System User Guide

[Home](#) » [Omnipod DASH](#) » Omnipod DASH Podder Insulin Management System User Guide 

Contents

- [1 Omnipod DASH Podder Insulin Management System](#)
- [2 How to deliver a bolus](#)
- [3 How to set a temp basal](#)
- [4 How to suspend and resume insulin delivery](#)
- [5 How to change a Pod](#)
- [6 How to view insulin and BG history](#)
- [7 Documents / Resources](#)
- [8 Related Posts](#)



Omnipod DASH Podder Insulin Management System



How to deliver a bolus

1. Tap the Bolus button on the home screen.

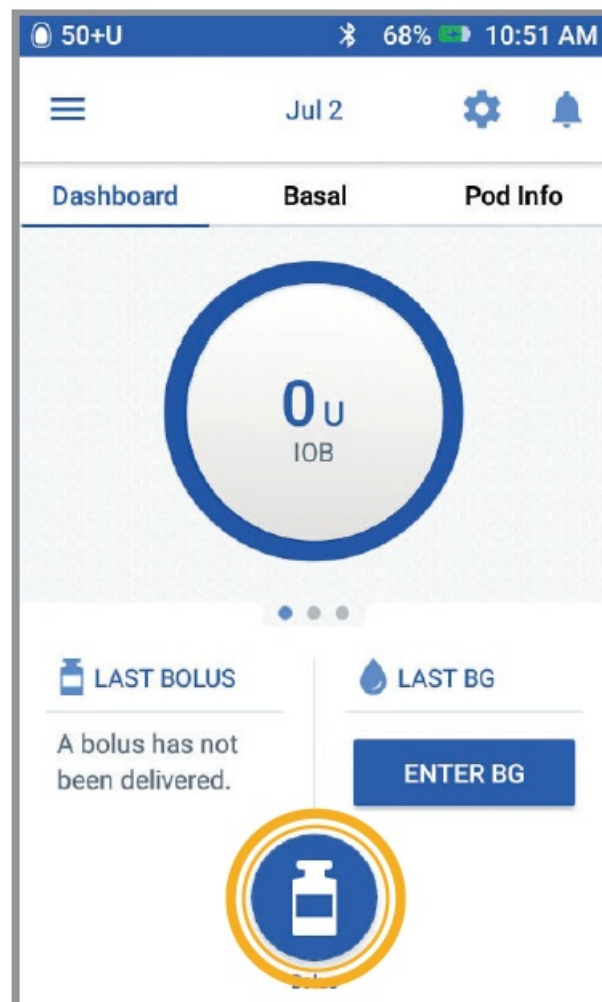

2. Enter grams of carbs (if eating). Tap "ENTER BG".

50+U 67% 10:52 AM

← Bolus

Total Carbs Meal Bolus

30 2_U

FOOD LIBRARY

BG Correction Bolus

-- 0_U

ENTER BG

Total Bolus

CALCULATIONS 2_U

IOB of 0 U

CANCEL EXTEND BOLUS CONFIRM

3. Tap "SYNC BG METER*" or enter BG manually.

Tap "ADD TO CALCULATOR". *From CONTOUR@NEXT ONE BG Meter

50+U 100% 12:13 PM

← Enter BG

0
mg/dL

Enter a BG value

SYNC BG METER

CANCEL ADD TO CALCULATOR

4. Tap "CONFIRM" once you have reviewed our entered values.

50+U 66% 10:53 AM

← Bolus

Enter Carbs Meal Bolus

30 g 2 U

FOOD LIBRARY

BG (10:53 am) Correction Bolus

185 mg/dL 1.70 U

ENTER BG

Total Bolus

CALCULATIONS 3.70 U

Adjusted for IOB of 0 U

CANCEL EXTEND BOLUS CONFIRM

5. Tap “START” to begin bolus delivery.

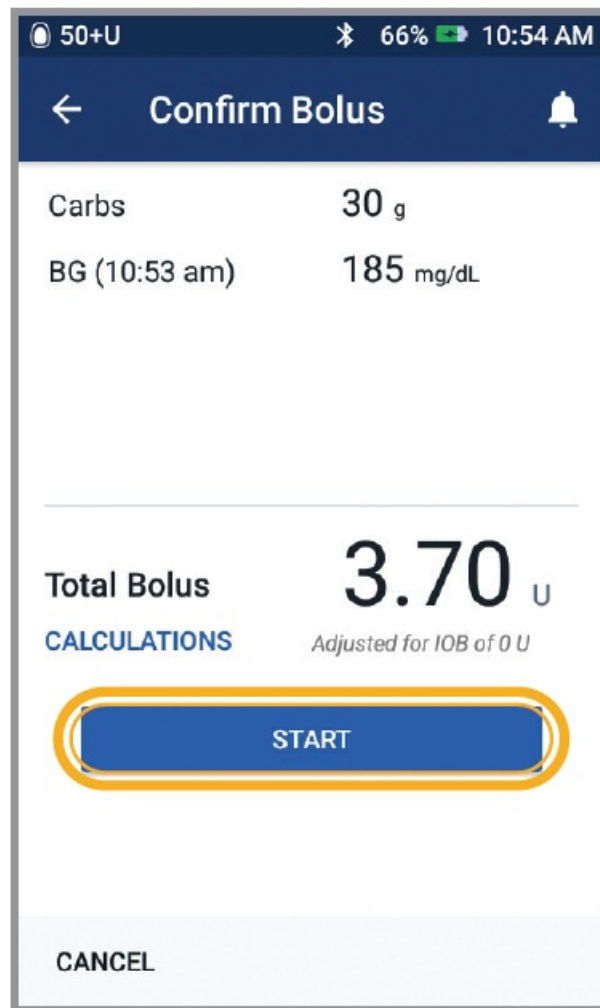

The "Confirm Bolus" screen displays the following information:

- Carbs: 30 g
- BG (10:53 am): 185 mg/dL
- Total Bolus: 3.70 U
- CALCULATIONS: Adjusted for IOB of 0 U
- A large blue button with a yellow border labeled "START"
- A "CANCEL" button at the bottom left.

REMINDER

- The home screen displays a progress bar and details while you are delivering an immediate bolus.
- You cannot use your PDM during an immediate bolus.

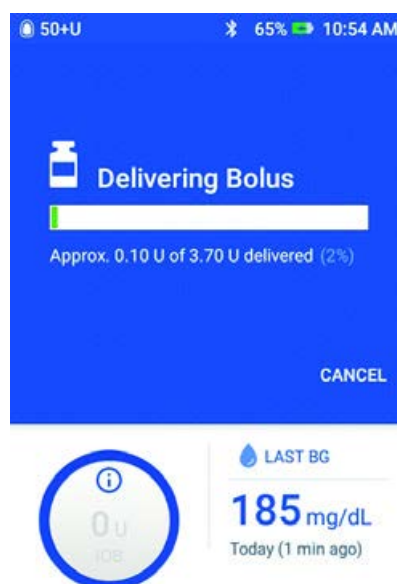

The "Delivering Bolus" screen displays the following information:

- A progress bar showing the delivery status.
- Approx. 0.10 U of 3.70 U delivered (2%)
- A "CANCEL" button at the bottom right.

Below the screen, the home screen displays the following information:

- A circular icon with an "i" and "0 U IOB".
- A "LAST BG" section showing 185 mg/dL Today (1 min ago).

How to set a temp basal

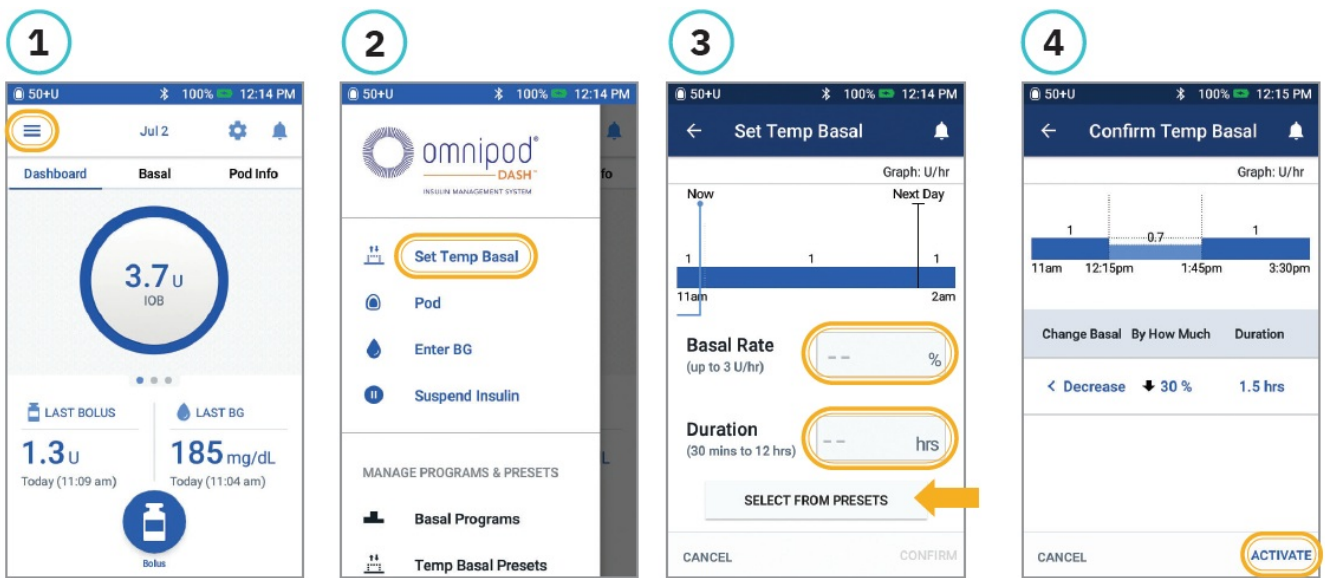

1. Tap the menu icon on the home screen.
2. Tap "Set Temp Basal".
3. Tap "Basal Rate" box, and select your % change.
Tap "Duration" box, and select your time. Or tap "SELECT FROM PRESETS" (if you have saved Presets).
4. Tap "ACTIVATE" once you have reviewed your entered values.

DID YOU KNOW?

- "Temp Basal" is highlighted in green if there is an active temp basal rate running.
- You can swipe to the right on any green confirmation message to dismiss it sooner.

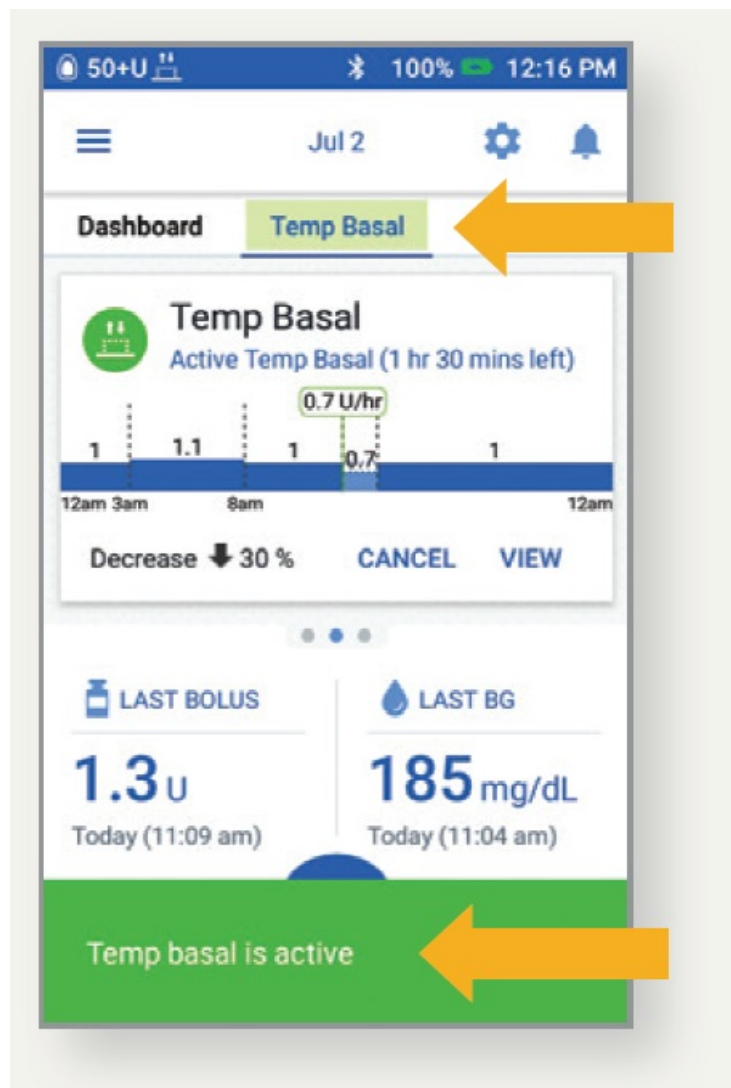

How to suspend and resume insulin delivery

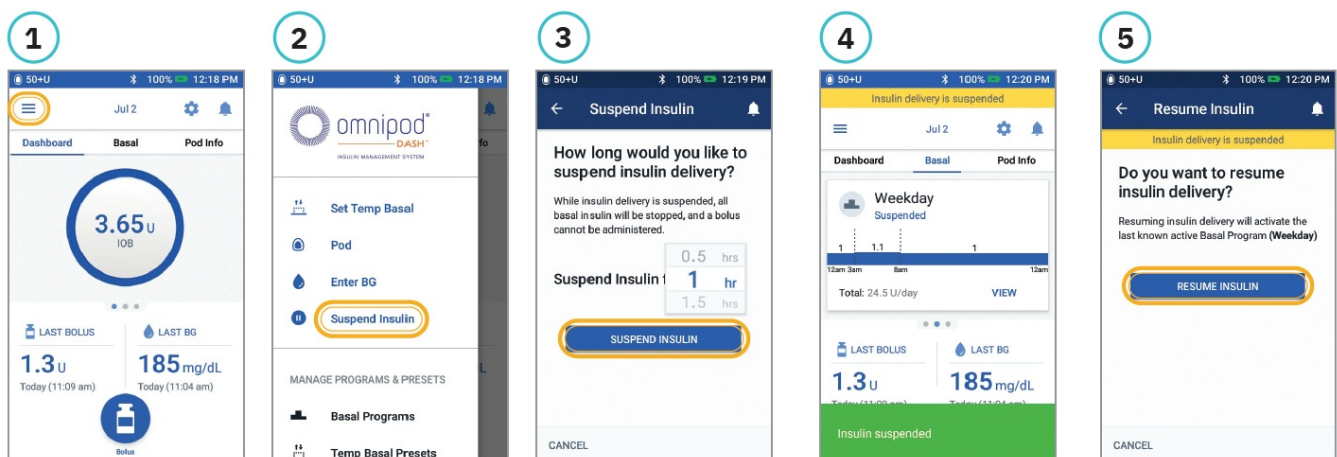

1. Tap the menu icon on the home screen.
2. Tap "Suspend Insulin".
3. Scroll to desired duration of insulin suspension. Tap "SUSPEND INSULIN". Tap "Yes" to confirm you want to stop insulin delivery.
4. The home screen displays a yellow banner stating insulin is suspended.
5. Tap "RESUME INSULIN" to start insulin delivery.

REMINDER

- You **MUST** resume insulin, insulin does not automatically resume at end of suspension period.
- The Pod beeps every 15 minutes throughout the suspension period to remind you that insulin is not being delivered.
- Your temp basal rates or extended boluses are canceled when insulin delivery suspends.

How to change a Pod

1

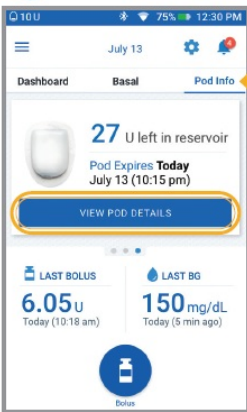

Tap “Pod Info” on the home screen.
Tap “VIEW POD DETAILS”.

2

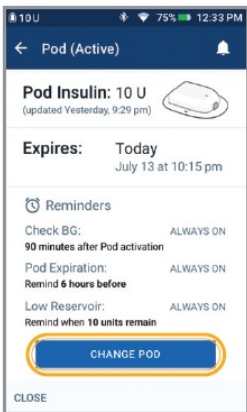

Tap “CHANGE POD”.
Carefully follow the on-screen directions.
Pod will be deactivated.

3

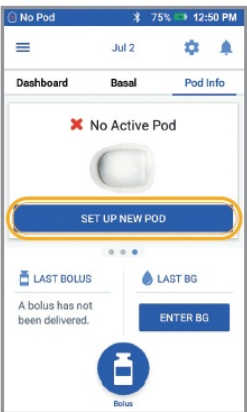

Tap “SET UP NEW POD”.

4

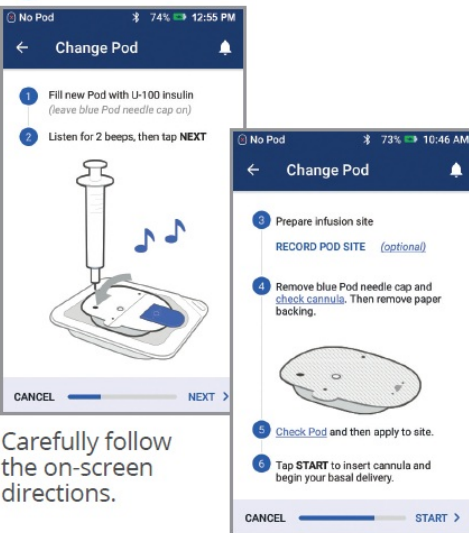

Carefully follow the on-screen directions.

For more detailed instructions, refer to the Omnipod DASH® Insulin Management System User Guide.

1. Tap “Pod Info” on the home screen. Tap “VIEW POD DETAILS”.
2. Tap “CHANGE POD”. Carefully follow the on-screen directions. Pod will be deactivated.
3. Tap “SET UP NEW POD”.
4. Carefully follow the on-screen directions.

For more detailed instructions, refer to the Omnipod DASH® Insulin Management System User Guide.

DON'T FORGET!

- Keep the Pod in plastic tray during fill and prime.
- Place the Pod and PDM next to each other and touching during priming.
- A “Check BG” reminder alerts you to check your blood glucose level and infusion site 90 minutes after Pod activation.

How to view insulin and BG history

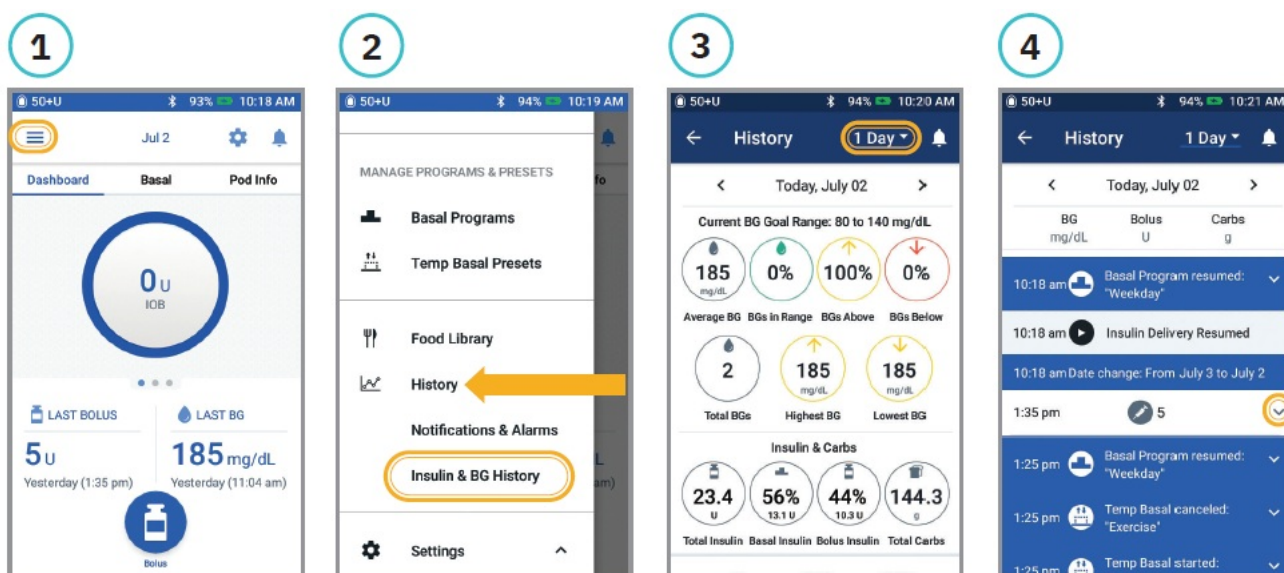

1. Tap the menu icon on the home screen.
2. Tap “History” to expand list. Tap “Insulin & BG History”.
3. Tap the “Day drop-down” arrow to view 1 day or multiple days.
4. Continue swiping up to see the details section. Tap the “down” arrow to display more details.

HISTORY AT YOUR FINGERTIPS!

- **BG info:**

- Average BG
- BG in Range
- BGs Above and Below range
- Average Readings per day
- Total BGs (in that day or date range)
- Highest and Lowest BG

- **Insulin info:**

- Total Insulin
- Avg Total Insulin (for date range)
- Basal Insulin
- Bolus Insulin
- Total Carbs

- **PDM or Pod events:**

- Extended Bolus
- Activation/reactivation of a Basal program
- Start/end/cancellation of a Temp Basal
- Pod activation and deactivation

This Podder™ Quick Glance Guide is intended to be used in conjunction with your Diabetes Management Plan, input from your healthcare provider, and the Omnipod DASH® Insulin Management System User Guide. Personal Diabetes Manager imagery is for illustrative purposes only and should not be considered suggestions for user settings.

Refer to the Omnipod DASH® Insulin Management System User Guide for complete information on how to use the Omnipod DASH® System, and for all related warnings and cautions. The Omnipod DASH® Insulin

Management System User Guide is available online at omnipod.com or by calling Customer Care (24 hours/7 days), at 800-591-3455.

This Podder™ Quick Glance Guide is for Personal Diabetes Manager model PDM-USA1-D001-MG-USA1. The Personal Diabetes Manager model number is written on the back cover of each Personal Diabetes Manager.

© 2020 Insulet Corporation. Omnipod, the Omnipod logo, DASH, the DASH logo, and Podder are trademarks or registered trademarks of Insulet Corporation. All rights reserved. The Bluetooth® word mark and logos are registered trademarks owned by the Bluetooth SIG, Inc. and any use of such marks by Insulet Corporation is under license. Ascensia, the Ascensia Diabetes Care logo, and Contour are trademarks and/or registered trademarks of Ascensia Diabetes Care Holdings AG.

INS-ODS-04-2020-00078 V2.0

Insulet Corporation

100 Nagog Park, Acton, MA 01720

800-591-3455 • omnipod.com

Documents / Resources

	<p>Omnipod DASH Podder Insulin Management System [pdf] User Guide Omnipod DASH, Podder, Insulin, Management, System</p>
--	---