

## OMNIBAR

OMNIBAR  
PBK10KD  
10000mAh  
Magfast Power  
Bank XL



# OMNIBAR PBK10KD 10000mAh Magfast Power Bank XL User Guide

[Home](#) » [OMNIBAR](#) » OMNIBAR PBK10KD 10000mAh Magfast Power Bank XL User Guide 

### Contents

- [1 OMNIBAR PBK10KD 10000mAh Magfast Power Bank XL](#)
- [2 IMPORTANT SAFETY INSTRUCTIONS](#)
- [3 TECHNICAL SPECIFICATIONS](#)
- [4 PRODUCT OVERVIEW](#)
- [5 OPERATION INSTRUCTIONS](#)
- [6 FCC Compliance Statement](#)
- [7 WARRANTY](#)
- [8 Documents / Resources](#)
  - [8.1 References](#)
- [9 Related Posts](#)

# OMNIBAR

OMNIBAR PBK10KD 10000mAh Magfast Power Bank XL



## IMPORTANT SAFETY INSTRUCTIONS

Before using this power bank, thoroughly read all warnings and instructions. To avoid risks like explosions, fires, electric shocks, or personal injury, adhere strictly to IEEE guidelines and those from the manufacturers of any equipment you use with the power bank. Omnibar may update this information without prior notice. For the latest updates and the most recent User Manual, visit [www.omnibar.com](http://www.omnibar.com)

## WARNINGS

### INSTRUCTIONS TO RISK OF ELECTRIC SHOCK, OR PERSONAL INJURY.

With great power comes great responsibility!

When using this power bank, basic safety precautions should always be followed. Please read all the instructions before using the product:

**AWAY FROM CHILDREN:** Don't allow children to operate or play with the power bank.

- **KEEP AWAY FROM CHILDREN:** Don't allow children to operate or play with the power bank.
- **ALWAYS KEEP DRY:** Protect the power bank from rain, snow, and any form of liquid. Do not charge or use the power bank if it's exposed to liquid. If internal components get wet, your power bank MUST be disposed of, Isolate it in a fire safe location before disposal. Failure to comply with these guidelines could cause serious damage, injury, or worse. Contact your local fire department if you see any sparks or smell burning.
- **FLAME-FREE ZONE:** Keep smoking, sparks, and flames away from the power bank.
- **AVOID STATIC:** Do not expose the device to strong electrostatic or electromagnetic interference.
- **HANDLE GENTLY:** Avoid dropping or severe impacts to ensure the power bank works properly.
- **NOT TAMPERING:** Do not attempt to open the power bank casing. Never allow foreign objects to enter into inputs, outputs or ventilation holes.
- **NO BATTERY REPLACEMENT:** Do not try to replace or alter the power bank battery. It is rechargeable but not replaceable.

- **PROFESSIONAL SERVICING ONLY:** Only a qualified repair person should service the device using the correct parts to ensure continued safety.

## TECHNICAL SPECIFICATIONS

- **MODEL:** PBKIOKD
- **CAPACITY:** 10,000mAh (3.7V 37Wh)
- **RATED CAPACITY:** 5800mAh (5V—2.4A)
- **USB-C INPUT:** 5V=3A 9V=2A Max)
- **USB-C OUTPUT:** 5V=2.4A 9V=2.22A 12V=1.67A (20W Flax)
- **WIRELESS CHARGING:** sW / 7.5W / IOW / 15W
- **TOTAL OUTPUT:** 5V—2.4A
- **MATERIALS:** Fireproof PC+ABS Plastic
- **SIZE:** 104.6\*68.9\*20mm
- **WEIGHT:** 198g

## IN THE BOX

- Power Bank X 1
- 2ft USB-C to USB-C Charging Cable X 1
- Instruction Manual X 1

## PRODUCT OVERVIEW

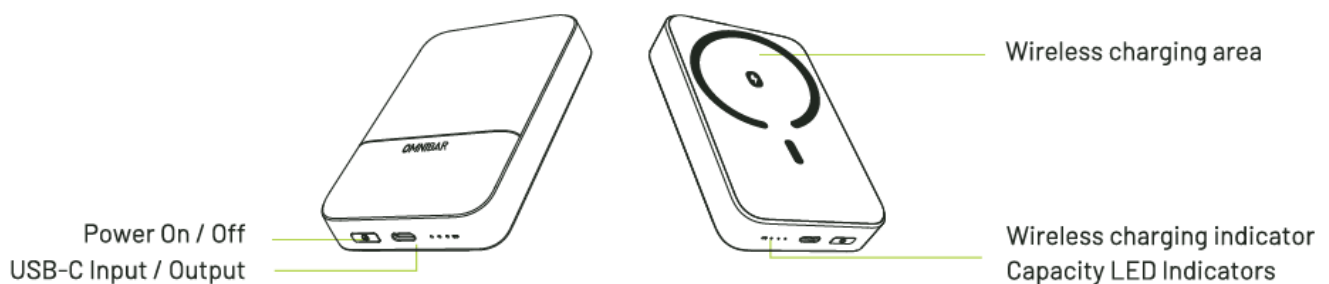

- Recharging Power Bank

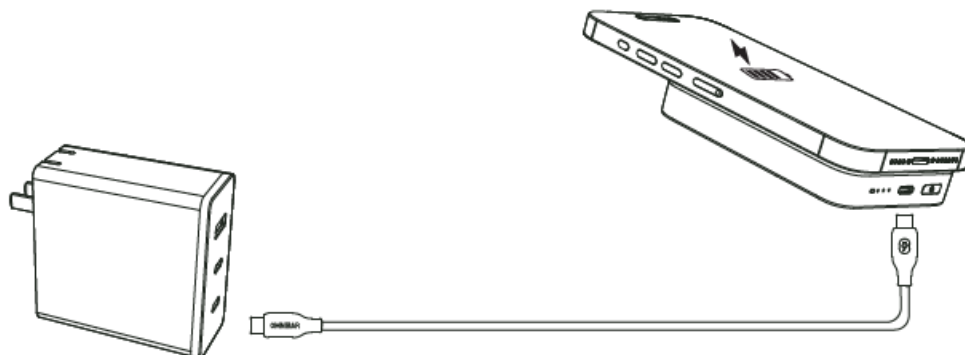

- Charging Your Phone or Tablet Using Charging Cables

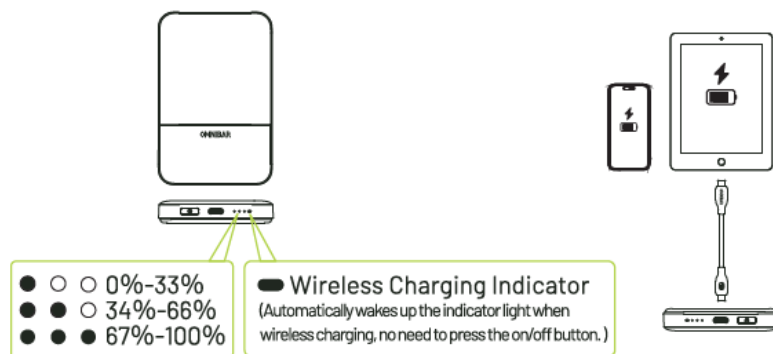

## Charging Other Devices

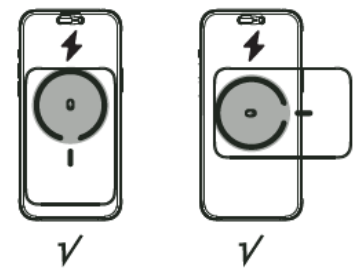

- Charging an iPhone and Other Devices Wirelessly

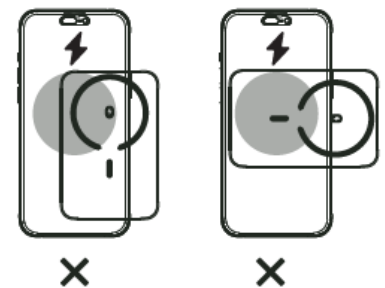
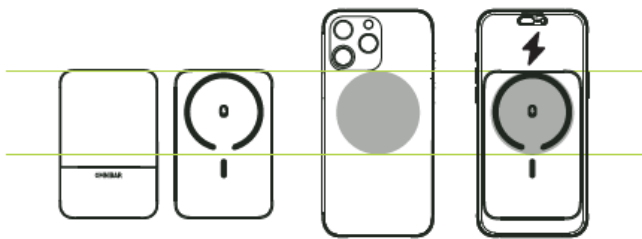

## OPERATING GUIDELINES

- **AVOID WATER:** When traveling, take care to keep it dry; avoid rain, snow and any water. It's also best to keep it cool and shaded from direct sunlight.
- **KEEP IT COOL:** Give your power bank some breathing room. Don't stack things on it or block its ventilation while in use or in storage.
- **COOL DOWN BEFORE CHARGING:** After a full discharge, let your power bank chill for 1-2 hours before recharging. It's like letting it take a nap and prolongs the life of your battery!
- **RECHARGE REGULARLY:** To preserve the battery, use and recharge the power bank at least once every 3 months.
- **ONE PORT, ONE DEVICE:** Don't overload it! Only power one device per port or socket on the power bank. Never connect a multi-outlet power strip, surge protector or extension cord.
- **USE CERTIFIED ACCESSORIES ONLY:** Ensure all accessories, attachments and appliances used with the power bank are safety certified to avoid potential hazards.
- **PULL THE PLUG:** When disconnecting, pull the plug-not the cord. It is less likely to break into an accidental tug-of-war damaging your cables or power bank.
- **INSPECT CORDS:** Ensure that cords, plugs, and cables are not damaged before using with the power station.
- **CHECK FOR DAMAGE:** If you spot any cracks or damage, stop using the power bank immediately. Avoid contact with any leaked liquid. The battery acid can be irritating or worse. If it touches skin or eyes, flush with water and seek medical attention.
- **AVOID USING DAMAGED UNITS:** Do not operate the power bank or any connected devices if they are damaged or altered.

## OPERATION INSTRUCTIONS

- **To check battery status:** Press the button once to check the battery status (remaining power). The indicator will light up about 30s before it automatically turns off.
- **When charging using a cable:** The power bank will automatically starts to output when you connect a charging cable to it. However, due to compatibility issues, for some phones you need to press the power button once to start charging. The output mode will stay for 30s after you press the button, during which if there' s no device connected, the mode will automatically shut down.
- **When charging wirelessly:** This product has an auto-wake function for wireless charging, just place your phone onto it, and it will automatically start charging. But for some phones, due to compatibility issues, the wireless charging function needs to be activated by pressing the button. Press it once, the battery indicator will light up and the wireless charging is turned on, and you can place your device on. If there' s no load connected for the wireless charging in 30s, the product will automatically shut off the wireless charging function.

### WIRELESS CHARGING TIPS

Place your phone onto the wireless charging area (as it shows in the picture) for wireless charging. The distance between the charging phone and the power bank must be within 8mm for wireless charging to work, if not it will stop charging, and you need to adjust the phone' s position.

### FCC Compliance Statement

This device complies with Part 15 of the FCC Rules. Operation is subject to the following two conditions:

1. This device may not cause harmful interference, and
2. This device must accept any interference received, including interference that may cause undesired operation.

**WARNING:** Changes or modifications not expressly approved by the party responsible for compliance could void the user's authority to operate the equipment.

**NOTE:** This equipment has been tested and found to comply with the limits for a Class B digital device, pursuant to Part 15 of the FCC Rules. These limits are designed to provide reasonable protection against harmful interference in a residential installation. This equipment generates, uses, and can radiate radio frequency energy and, if not installed and used in accordance with the instructions, may cause harmful interference to radio communications. However, there is no guarantee that interference will not occur in a particular installation. If this equipment does cause harmful interference to radio or television reception, which can be determined by turning the equipment off and on, the user is encouraged to try to correct the interference by one or more of the following measures:

1. Reorient or relocate the receiving antenna .
2. Increase the separation between the equipment and receiver.
3. Connect the equipment into an outlet on a circuit different from that to which the receiver is connected.
4. Consult the dealer or an experienced radio/ TV technician for help.

Omnibar is a trademark of Omnibar LLC. All the images and text in this user guide are the copyright of Omnibar. The photos and illustrations in this guide may differ from the actual product.

The device has been evaluated to meet general RF exposure requirement. The device can be used in portable exposure condition without restriction.

### WEEE INFORMATION

Disposal and recycling information. This product and battery should not be used as household garbage or thrown

into the fire. When you decide to dispose of the product and battery, please handle the battery according to the local environment all laws to avoid explosion.

**WARNING:** Do not disassemble, crush, or expose to fire or high temperatures. If significant swelling occurs, discontinue use immediately. Never use after submersion in water.

Only suitable for safe use in non-tropical climates

Made in China

## LIST OF TOXIC AND HAZARDOUS SUBSTANCES IN ELECTRONIC PRODUCTS

Part Name	Poisonous Or Harmful Substance Or Element					
	(Pb)	(Hg)	(Cd)	(Cr(VI))	(PBB)	(PBDE)
Internal Components	X	O	O	O	O	O
Shell	X	O	O	O	O	O
Other	X	O	O	O	O	O

This form is prepared in accordance with SJ/T 11364

- O: indicates that the content of the hazardous substance in all homogeneous materials of the component is below the limit requirements stipulated in GB/T 26572.
- X: indicates that the content of the hazardous substance in at least one homogeneous material of the component exceeds the limit requirements stipulated in GB/T 26572.

For the parts marked “X” in the table, the replacement of hazardous substances cannot be realized due to the limitation of global technological development level.

The product you purchase may not contain all of the above components.



The number in this label indicates that the product has an environmental protection service life of 10 years under normal use condition. Some parts may also have an environmental service life label, and the number in the label shall prevail.

## WARRANTY

This device has a 1-year warranty, covering 12 months from the date of purchase (the “warranty period”). During the warranty period, if a device failure occurs under normal use due to a manufacturing defect, Omnibar will repair or replace the device. The company reserves the right to verify that proper use and maintenance guidelines were followed.

## CONDITIONS THAT VOID THIS WARRANTY:

1. Unauthorized repair, disassembly, or alteration of any kind.
2. Evidence of abnormal usage or misuse.
3. Damage from dropping, abuse, or negligence.
4. Damages caused by failure to follow the operating instructions.
5. Tampering with the product's original serial number label and other similar markings.
6. Fake products, including those indicated by a missing product serial number or nonconformity between the product model and serial number.
7. Improper storage, such as long-term exposure to humidity or temperatures outside the parameters specified in the technical specifications of this user's guide.
8. Expiration of the product warranty.

**FORCE MAJEURE:** Omnibar shall not be liable for any failure or delay in performing any of its obligations under this warranty if such failure or delay is caused by or results from events beyond its reasonable control, including, but not limited to:

- Natural disasters (e.g., earthquakes, floods, hurricanes, wildfires)
- Acts of God
- War, invasion, or acts of terrorism
- Civil unrest, riots, or strikes
- Government actions, regulations, or restrictions
- Epidemics, pandemics, or quarantines
- Power outages or electrical failures
- Supply chain disruptions

Dear user, this warranty card is your future warranty application voucher, please cooperate with the seller to fill in and properly Keep it for later!

<b>User information</b>			
<b>User name</b>		<b>E-mail</b>	
<b>Contact Number</b>		<b>Zip code</b>	
<b>Address of correspondence</b>			
<b>Product Information</b>			
<b>Product name</b>		<b>Model number</b>	
<b>Product barcode/number/batch number</b>			
<b>Seller information</b>			
<b>Name</b>			
<b>Address</b>			
<b>Contact Number</b>		<b>Zip code</b>	
<b>Date of sale</b>		<b>Invoice number</b>	
<b>Remarks</b>			

The above information shall be filled in by the buyer

- (O +1 [208-252-5229](tel:208-252-5229))
- [www.omnibar.com](http://www.omnibar.com)

## Documents / Resources

	<a href="#">OMNIBAR PBK10KD 10000mAh Magfast Power Bank XL</a> [pdf] User Guide PBK10KD, 2BM7E-PBK10KD, 2BM7EPBK10KD, PBK10KD 10000mAh Magfast Power Bank X L, PBK10KD, 10000mAh Magfast Power Bank XL, Magfast Power Bank XL, Power Bank XL
---	--

## References

- [User Manual](#)

[Manuals+](#), [Privacy Policy](#)

This website is an independent publication and is neither affiliated with nor endorsed by any of the trademark owners. The "Bluetooth®" word mark and logos are registered trademarks owned by Bluetooth SIG, Inc. The "Wi-Fi®" word mark and logos are registered trademarks owned by the Wi-Fi Alliance. Any use of these marks on this website does not imply any affiliation with or endorsement.