



OMEGA FTB300 Series Flow Verification Sensor User Guide

[Home](#) » [Omega](#) » OMEGA FTB300 Series Flow Verification Sensor User Guide 



Contents

- 1 Introduction
- 2 Features
- 3 Specifications
 - 3.1 Temperature and Pressure limits
 - 3.2 Dimensions
 - 3.3 Replacement Parts
- 4 Installation
 - 4.1 Wiring Connections
 - 4.2 Circuit Board Connections
 - 4.3 Flow Verification Output Signal
 - 4.4 Panel or wall mounting
- 5 Operation
 - 5.1 Theory of operation
 - 5.2 Control Panel
 - 5.3 Flow stream requirements
 - 5.4 Run mode display
 - 5.5 Run mode operation
 - 5.6 Viewing the K-factor (pulses per unit)
 - 5.7 Useful formulas
- 6 Programming
 - 6.1 Field Calibration
 - 6.2 Programming for body size/ranges Although S6 –
 - 6.3 Field calibration size/range setting SO
- 7 WARRANTY/DISCLAIMER
- 8 RETURN REQUESTS/INQUIRIES
- 9 Documents / Resources
- 10 Related Posts

Introduction

This flowmeter is designed to display flow rate and flow total on a six-digit LCD display. The meter can measure bi-directional flows in either vertical or horizontal mounting orientation. Six flow ranges and four optional pipe and tubing connections are available. Pre-programmed calibration K-factors can be selected for the corresponding flow range or a custom field calibration can be performed for higher accuracy at a specific flow rate. The meter is factory programmed for the correct K-factor of the body size included with the meter.

Features

- Four connection options available: 1/8" F /NPT, 1/4" F /NPT, 1/4" OD x .170 ID Tubing & 3/8" OD x 1/4" ID Tubing sizes.
- Six body size/flow range options available:
30 to 300 ml/min, 100 to 1000 ml/min, 200 to 2000 ml/min,
300 to 3000 ml/min, 500 to 5000 ml/min, 700 to 7000 ml/min.
- 3 model display variations:
FS = Sensor mounted display
FP = Panel mounted display (includes 6' cable)
FV = No display. Sensor only. 5vdc current-sinking output
- 6 digit LCD, up to 4 decimal positions.
- Displays both rates of flow and total accumulated flow.
- Open collector alarm setpoint.

- User-selectable or custom programmable K-factor.
Flow units: Gallons, Liters, Ounces, milliliters
Time units: Minutes, Hours, Days
- Volumetric field calibration programming system.
- Non-volatile programming and accumulated flow memory.
- The total reset function can be disabled.
- Opaque PV DF chemical resistant lens.
- Weather-resistant Valox PBT enclosure. NEMA 4X

Specifications

Max. Working Pressure: 150 psig (10 bar)@ 70°F (21°C)
 PVDF lens Max. Fluid Temperature: 200°F (93°C)@ 0 PSI
 Full-scale accuracy
 Input Power requirement: +/-6%
 The sensor only output cable: 3-wire shielded cable, 6ft
 Pulse output signal: Digital square wave (2-wire) 25ft max.
 Voltage high = 5V de,
 Voltage low < .25V de
 50% duty cycle
 Output frequency range: 4 to 500Hz
 Alarm output signal:
 NPN Open collector. Active low above
 the programmable rate set point.
 30V de maximum, 50mA max load.
 Active low < .25V de
 2K ohm pull-up resistor required.
 Enclosure: NEMA type 4X, (IP56)
 Approximate shipping wt: 1 lb. (.45 kg)

Temperature and Pressure limits

Maximum Temperature vs. Pressure

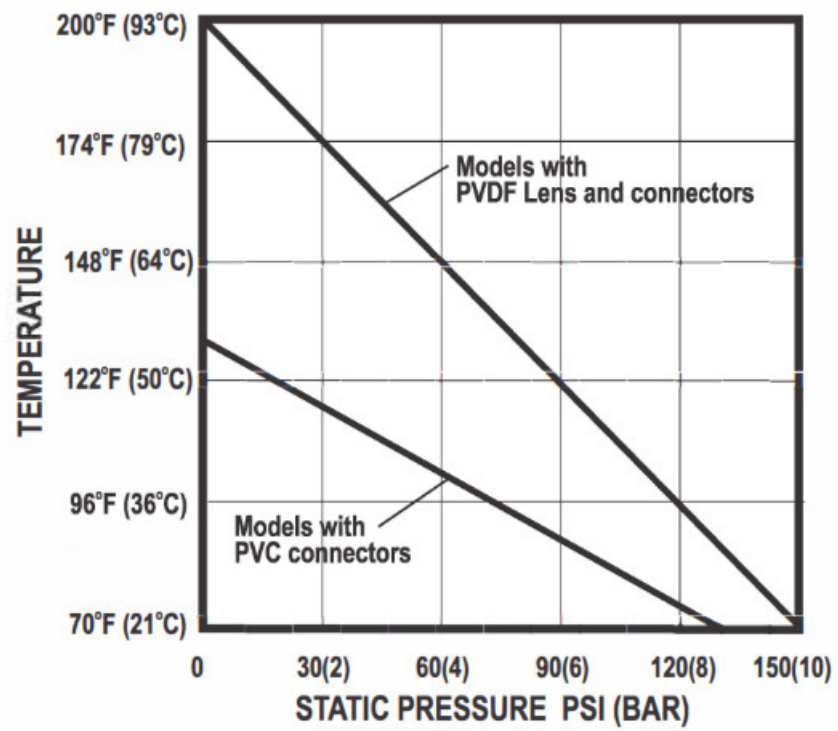

Dimensions

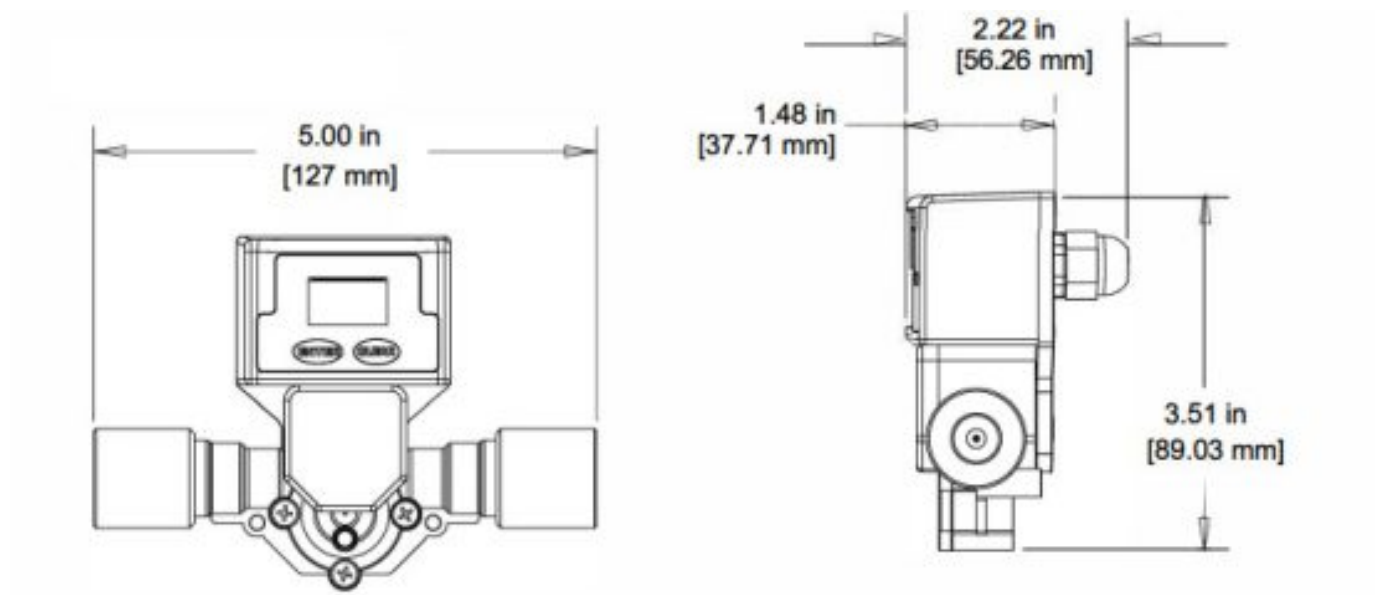

Replacement Parts

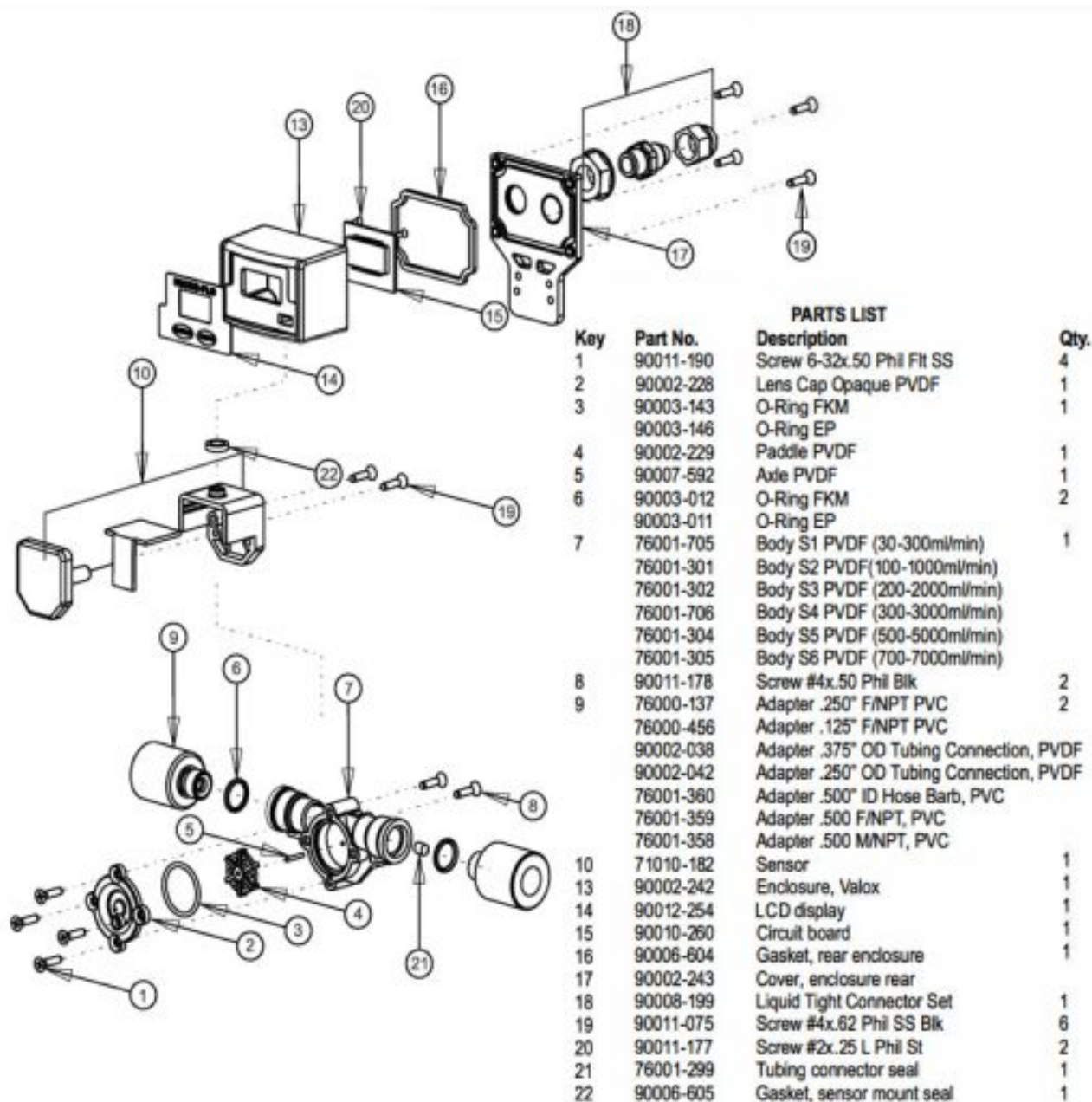

Installation

Wiring Connections

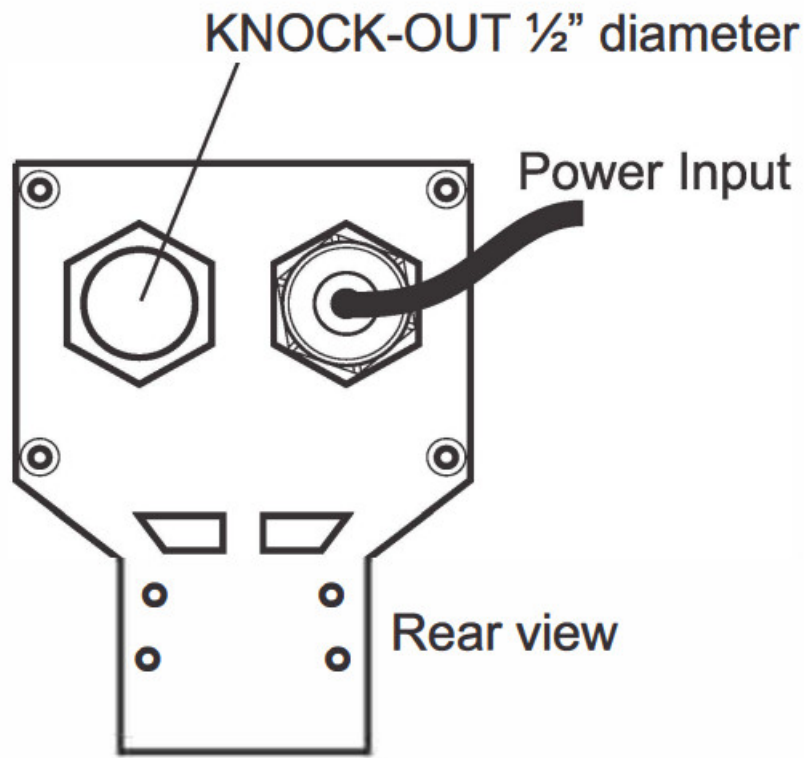

On sensor-mounted units, the output signal wires must be installed through the back panel using a second liquid-tite connector (included). To install the connector, remove the circular knock-out. Trim the edge if required. Install the extra liquid-tite connector.

On panel or wall-mounted units, wiring may be installed through the enclosure bottom or through the back panel. See below.

Circuit Board Connections

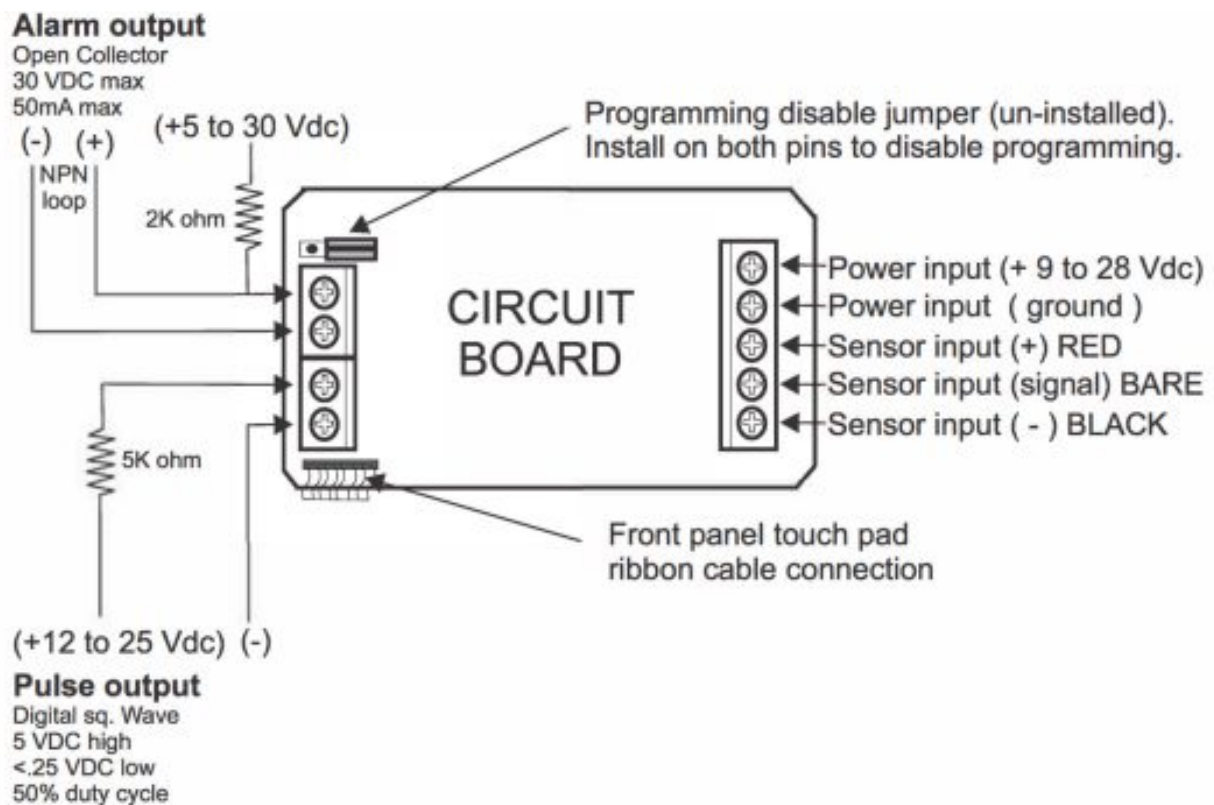

NOTE: To reset the circuit board: 1) Disconnect power 2) Apply power while pressing the two front panel buttons.

Flow Verification Output Signal

When connected to external equipment such as a PLC, data logger, or metering pump, the pulse output signal can be used as a flow verification signal. When used with metering pumps, connect the positive (+) terminal on the circuit board to the pump's yellow signal input wire and the negative (-) terminal to the black input wire.

Panel or wall mounting

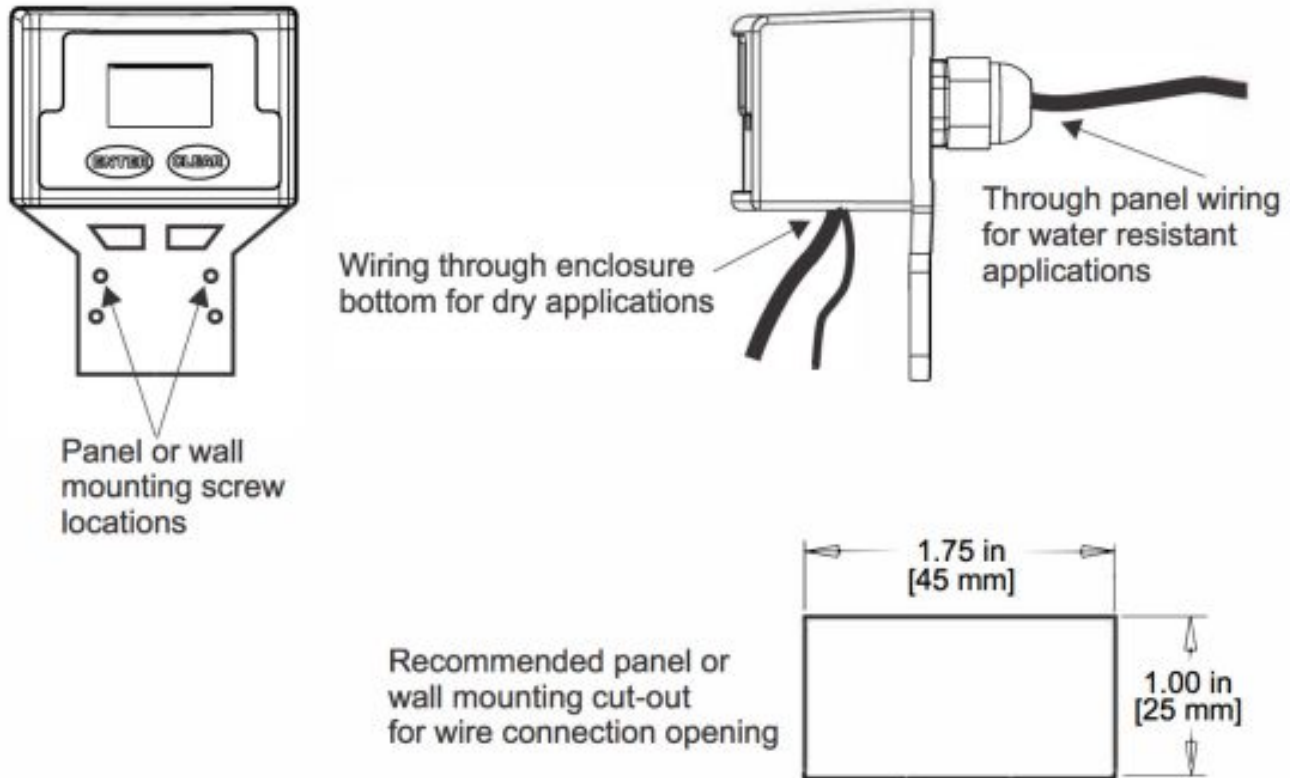

Operation

Theory of operation

The flowmeter is designed to measure the flow rate and accumulate the total volume of a fluid. The unit contains a paddle wheel that has six (6) through holes to allow infrared light to pass through, a light-detecting circuit, and an LCD-display electronic circuit.

As fluid passes through the meter body, the paddlewheel spins. Each time the wheel rotates a DC square wave is output from the sensor. There are six (6) complete DC cycles induced for every revolution of the paddlewheel. The frequency of this signal is proportional to the velocity of the fluid in the conduit. The generated signal is then sent into the electronic circuit to be processed.

The meter is factory programmed for the correct K-factor of the body size included with the meter.

The flowmeter includes the following features:

- Displays either the flow rate or the accumulated total flow.
- Provides a pulse output signal that is proportional to the flow rate.
- Provides an open collector alarm output signal. Active low at flow rates above the user-programmed value.
- Provides user-selectable, factory preset calibration k-factors.
- Provides a field calibration procedure for more precise measurement.
- Front panel programming can be disabled by a circuit board jumper pin.

Control Panel



Enter Button (right arrow)

- **Press and release** – Toggle between Rate, Total, and Calibrate screens in the run mode. Select program screens in the program mode.
- **Press and hold 2 seconds** – Enter and exit program mode. (Automatic exit program mode after 30 seconds of no inputs).
Clear/Cal (up arrow)
- **Press and release** – Clear total in the run mode. Scroll through and select options in the program mode.

NOTE: To reset the circuit board: 1) Disconnect power 2) Apply power while pressing the two front panel buttons.

Flow stream requirements

- The flowmeter can measure fluid flow in either direction.
- The meter must be mounted so that the paddle axle is in a horizontal position – up to 10° off the horizontal is acceptable.
- The fluid must be capable of passing infra-red light.
- The fluid must be free of debris. A 150-micron filter is recommended especially when using the smallest body size (SI), which has a 0.031" through-hole.

Run mode display

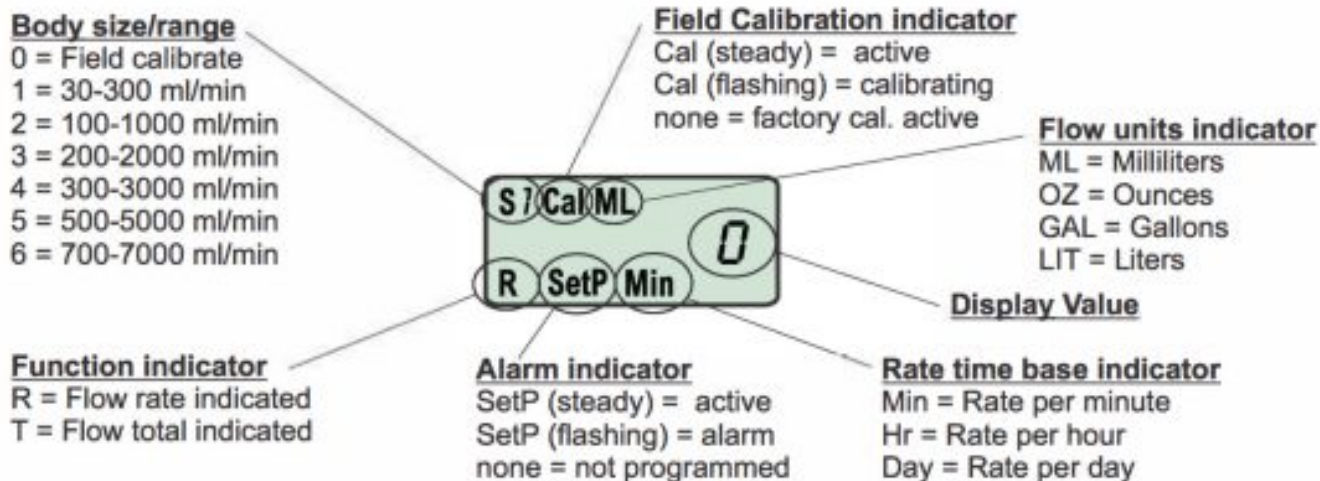

Run mode operation

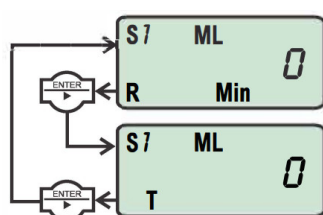

Viewing the K-factor (pulses per unit)

FLOW RATE DISPLAY – Indicates rate of flow, S1 = body size/range #1, ML = units displayed in milliliters, MIN = time units in minutes, R = flow rate displayed.

FLOW TOTAL DISPLAY – Indicates accumulated total flow, S1 = body size/range #1, ML = units displayed in milliliters, T = total accumulated flow displayed.



display the K-factor.

while in the run mode, Press and hold ENTER then press and hold CLEAR to

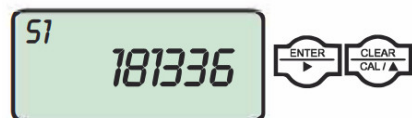

Release ENTER and CLEAR to return to run mode.

Body Size	Flow Range (ml/min)	Pulses per Gallon	Pulses per Liter
1	30-300	181,336	47,909
2	100-1000	81,509	21,535
3	200-2000	42,051	13,752
4	300-3000	25,153	6,646
5	500-5000	15,737	4,157
6	700-7000	9,375	2,477

Useful formulas

60 / K = rate scale factor

rate scale factor x Hz = flow rate in volume per minute

1 / K = total scale factor total scale factor x n pulses = total volume

Programming

The flowmeter uses a K-factor to calculate the flow rate and total. The K-factor is defined as the number of pulses generated by the paddle per volume of fluid flow. Each of the six different body sizes have different operating flow ranges and different K-factors. The meter is factory programmed for the correct K-factor of the body size included with the meter.

The meter's rate and total displays can be independently programmed to display units in milliliters (ML), ounces (OZ), gallons (gal), or liters (LIT). Rate and total can be displayed in different units of measure. The factory programming is in milliliters (ML).

The meter's rate display can be independently programmed to display timebase units in minutes (Min), Hours (Hr), or Days (Day). The factory programming is in minutes (Min).

For greater accuracy at a specific flow rate, the meter can be field calibrated. This procedure will automatically override the factory K-factor with the number of pulses accumulated during the calibration procedure. The factory default settings can be re-selected at any time.

Field Calibration

Anybody size/range can be field calibrated. Calibration will take into account your specific application's fluid properties, such as viscosity and flow rate, and increase the accuracy of the meter in your application. The Body Size/Range must be set for "SO" to enable the calibration mode. Follow the programming instructions on pages 10 & 11 to reset the Body Size/Range and perform the calibration procedure.

Programming for body size/ranges Although S6 –

Press and Hold ENTER to initiate the programming mode.

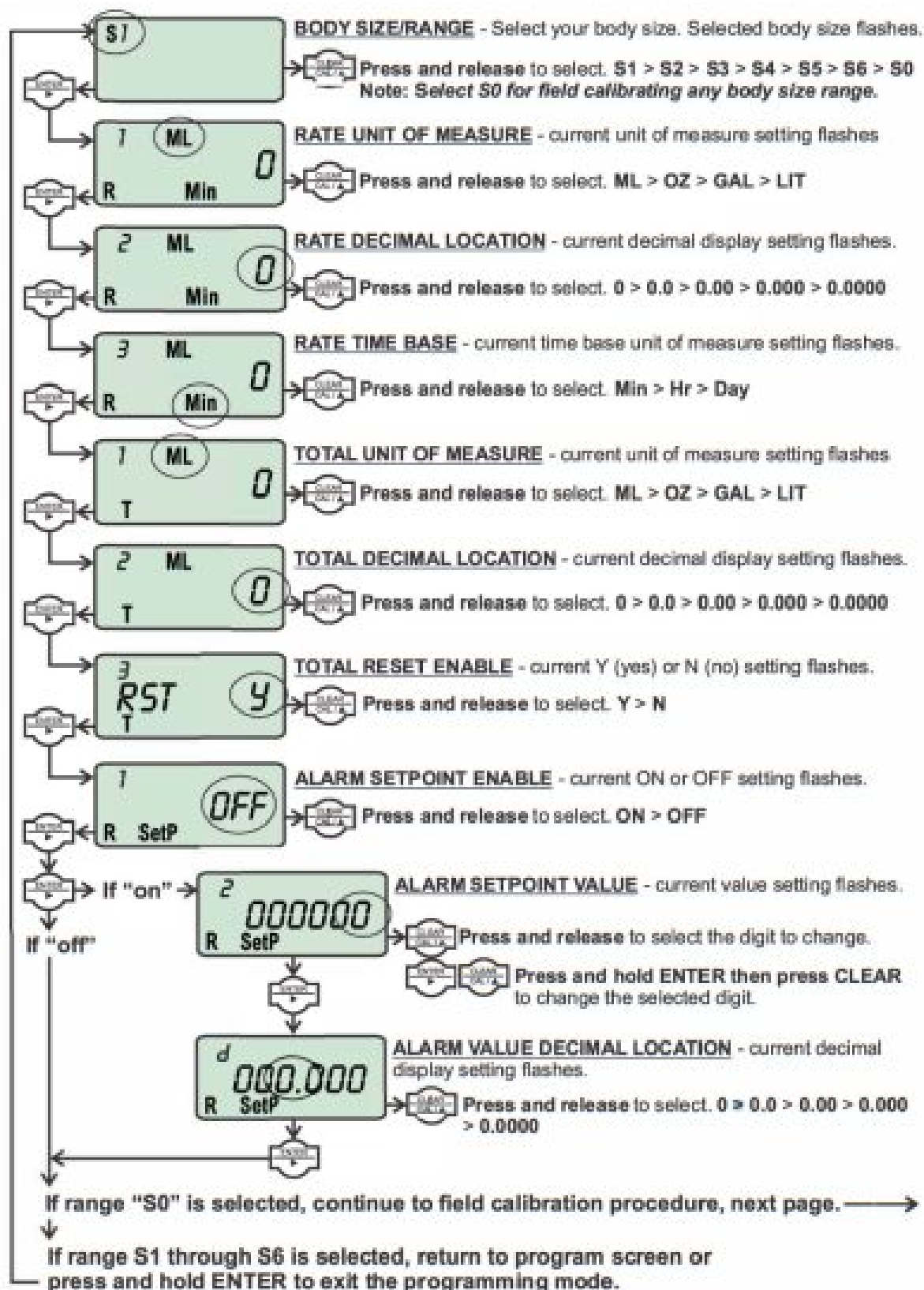

Field calibration size/range setting S0

– Continuation of programming sequence when range "S0" is selected.

The meter should be installed as intended in the application.

The amount of fluid that flows through the meter during the calibration procedure must be measured at the end of the calibration procedure.

Allow the meter to operate normally, in the intended application, for a period of time. A testing time of at least one minute is recommended. Note – the maximum number of pulses possible is 52,000. Pulses will accumulate in the display. After the test time period, Stop the flow through the meter. The pulse counter will stop.

Determine the amount of fluid that passed through the meter using a graduated cylinder, scale, or another method. The measured amount must be entered in calibration screen #4 "MEASURED VALUE INPUT."

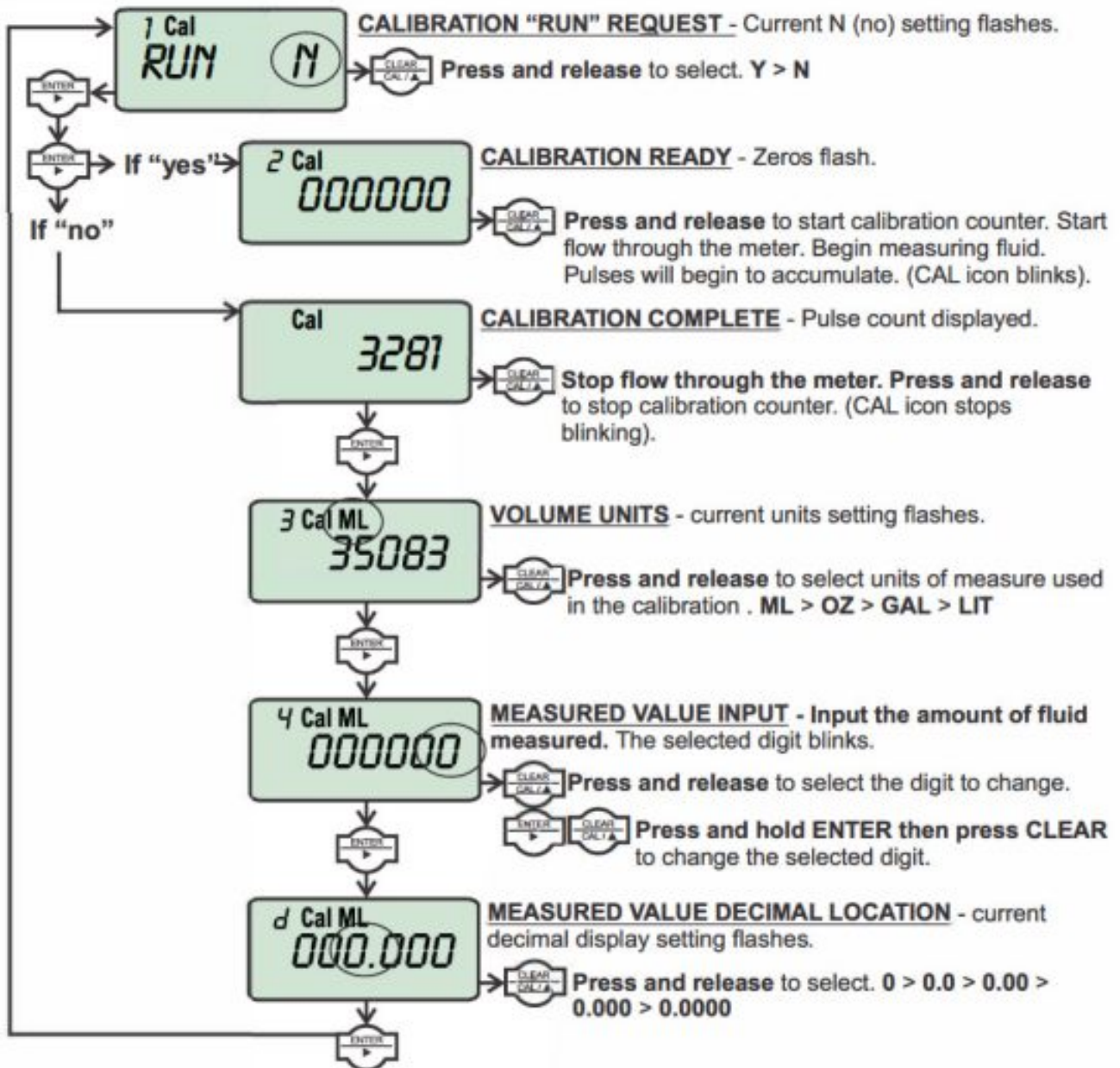

Notes:

WARRANTY/DISCLAIMER

OMEGA ENGINEERING, INC. warrants this unit to be free of defects in materials and workmanship for a period of 13 months from the date of purchase. OMEGA's WARRANTY adds an additional one (1) month grace period to the normal one (1) year product warranty to cover handling and shipping time. This ensures that OMEGA's customers receive maximum coverage on each product.

If the unit malfunctions, it must be returned to the factory for evaluation. OMEGA's Customer Service Department will issue an Authorized Return (AR) number immediately upon phone or written request. Upon examination by OMEGA, if the unit is found to be defective, it will be repaired or replaced at no charge. OMEGA's WARRANTY does not apply to defects resulting from any action of the purchaser, including but not limited to mishandling, improper interfacing, operation outside of design limits, improper repair, or unauthorized modification. This WARRANTY is VOID if the unit shows evidence of having been tampered with or shows evidence of having been damaged as a result of excessive corrosion; or current, heat, moisture, or vibration; improper specification; misapplication; misuse, or other operating conditions outside of OMEGA's control. Components in which wear is not warranted, include but are not limited to contact points, fuses, and triacs.

OMEGA is pleased to offer suggestions on the use of its various products. However, OMEGA neither assumes responsibility for any omissions or errors nor assumes liability for any damages that result from the use of its products in accordance with the information provided by OMEGA, either verbal or written. OMEGA warrants only that the parts manufactured by the company will be as specified and free of defects. OMEGA MAKES NO OTHER WARRANTIES OR REPRESENTATIONS OF ANY KIND WHATSOEVER, EXPRESSED OR IMPLIED, EXCEPT

THAT OF TITLE, AND ALL IMPLIED WARRANTIES INCLUDING ANY WARRANTY OF MERCHANTABILITY AND FITNESS FOR A PARTICULAR PURPOSE ARE HEREBY DISCLAIMED. LIMITATION OF LIABILITY: The remedies of purchaser set forth herein are exclusive, and the total liability of OMEGA with respect to this order, whether based on contract, warranty, negligence, indemnification, strict liability, or otherwise, shall not exceed the purchase price of the component upon which liability is based. In no event shall OMEGA be liable for consequential, incidental, or special damages.

CONDITIONS: Equipment sold by OMEGA is not intended to be used, nor shall it be used: (1) as a "Basic Component" under 10 CFR 21 (NRC), used in or with any nuclear installation or activity; or (2) in medical applications or used on humans. Should any Product(s) be used in or with any nuclear installation or activity, medical application, used on humans, or misused in any way, OMEGA assumes no responsibility as set forth in our basic WARRANTY/DISCLAIMER language, and, additionally, the purchaser will indemnify OMEGA and hold OMEGA harmless from any liability or damage whatsoever arising out of the use of the Product(s) in such a manner.

RETURN REQUESTS/INQUIRIES

Direct all warranty and repair requests/inquiries to the OMEGA Customer Service Department. BEFORE RETURNING ANY PRODUCT(S) TO OMEGA, THE PURCHASER MUST OBTAIN AN AUTHORIZED RETURN (AR) NUMBER FROM OMEGA'S CUSTOMER SERVICE DEPARTMENT (IN ORDER TO AVOID PROCESSING DELAYS). The assigned AR number should then be marked on the outside of the return package and on any correspondence.

The purchaser is responsible for shipping charges, freight, insurance, and proper packaging to prevent breakage in transit.

FOR WARRANTY RETURNS, please have the following information available BEFORE contacting OMEGA:

1. Purchase Order number under which the product was PURCHASED,
2. Model and serial number of the product under warranty, and
3. Repair instructions and/or specific problems relative to the product.

FOR NON-WARRANTY REPAIRS, consult OMEGA for current repair charges. Have the following information available BEFORE contacting OMEGA:

1. Purchase Order number to cover the COST of the repair,
2. Model and a serial number of the product, and
3. Repair instructions and/or specific problems relative to the product.

OMEGA's policy is to make running changes, not model changes, whenever an improvement is possible. This affords our customers the latest in technology and engineering.

OMEGA is a registered trademark of OMEGA ENGINEERING, INC.



©Copyright 2016 OMEGA ENGINEERING, INC. All rights reserved. This document may not be copied, photocopied, reproduced, translated, or reduced to any electronic medium or machine-readable form, in whole or in part, without the prior written consent of OMEGA ENGINEERING, INC.

Where Do I Find Everything I Need for Process Measurement and Control?

OMEGA...Of Course!

Shop online at omega.com sm

TEMPERATURE

-  Thermocouple, RTD & Thermistor Probes, Connectors, Panels & Assemblies
-  Wire: Thermocouple, RTD & Thermistor
-  Calibrators & Ice Point References

- ☒ Recorders, Controllers & Process Monitors
- ☒ Infrared Pyrometers

PRESSURE, STRAIN, AND FORCE

- ☒ Transducers & Strain Gages
- ☒ Load Cells & Pressure Gages
- ☒ Displacement Transducers Instrumentation & Accessories

FLOW/LEVEL

- ☒ Rotameters, Gas Mass Flowmeters & Flow Computers
- ☒ Air Velocity Indicators
- ☒ Turbine/Paddlewheel Systems
- ☒ Totalizers & Batch Controllers

pH/CONDUCTIVITY

- ☒ pH Electrodes, Testers & Accessories
- ☒ Benchtop /Laboratory Meters
- ☒ Controllers, Calibrators, Simulators & Pumps
- ☒ Industrial pH & Conductivity Equipment

DATA ACQUISITION

- ☒ Communications-Based Acquisition Systems
- ☒ Data Logging Systems
- ☒ Wireless Sensors, Transmitters, & Receivers
- ☒ Signal Conditioners
- ☒ Data Acquisition Software

HEATERS

- ☒ Heating Cable
- ☒ Cartridge & Strip Heaters
- ☒ Immersion & Band Heaters
- ☒ Flexible Heaters
- ☒ Laboratory Heaters

ENVIRONMENTAL MONITORING AND CONTROL

- ☒ Metering & Control Instrumentation
- ☒ Refractometers
- ☒ Pumps & Tubing
- ☒ Air, Soil & Water Monitors
- ☒ Industrial Water & Wastewater Treatment
- ☒ pH, Conductivity & Dissolved Oxygen Instruments

Shop online at

omega. COffl
e-mail: info@omega.com
For latest product manuals:
www.omegamanual.info



otnega.com info@omega.com

Servicing North America:

The U.S.A. Headquarters:

Omega Engineering, Inc.

Toll-Free: 1-800-826-6342 (USA & Canada only)

Customer Service: 1-800-622-2378 (USA & Canada only)

Engineering Service: 1-800-872-9436 (USA & Canada only)

Tel: (203) 359-1660

Fax: (203) 359-7700

e-mail: info@omega.com

For Other Locations Visit omega.com/worldwide

Documents / Resources

 <p>FTB300 Series Flow Verification Sensor</p>	<p>OMEGA FTB300 Series Flow Verification Sensor [pdf] User Guide FTB300, Series Flow Verification Sensor</p>
---	--