

Olympus DP-201 Digital Voice Recorder



OLYMPUS DP-201 Digital Voice Recorder Instruction Manual

[Home](#) » [Olympus](#) » OLYMPUS DP-201 Digital Voice Recorder Instruction Manual 

Contents

- 1 OLYMPUS DP-201 Digital Voice Recorder
- 2 Getting started
- 3 Recording
- 4 Microphone sensitivity
- 5 Playback
- 6 Erase
- 7 Safe and proper usage
- 8 Troubleshooting
- 9 Specifications
- 10 Frequently Asked Questions
- 11 Device Report
- 12 References

OLYMPUS

OLYMPUS DP-201 Digital Voice Recorder



Thank you for purchasing an Olympus Digital Voice Recorder. Please read these instructions for information about using the product correctly and safely. Keep the instructions handy for future reference.

To ensure successful recordings, we recommend that you test the record function and volume before use.

Shinjuku Monolith, 3-1 Nishi-Shinjuku 2-chome, Shinjuku-ku, Tokyo 163-0914, Japan. Tel. +81 (0)3-3340-2111
<http://www.olympus.com>

For customers in North and South America

USA RFI:

This equipment has been tested and found to comply with the limits for Class B digital devices, under part 15 of the FCC rules. These limits are designed to provide reasonable protection against harmful interference in a residential installation. This equipment generates, uses, and can radiate radio frequency energy and, if not installed and used per the instructions, may cause harmful interference to radio communications. However, there is no guarantee that interference will not occur in a particular installation. If this equipment does cause harmful interference to radio or television reception, which can be determined by turning the equipment off and on, the user is encouraged to try to correct the interference by one or more of the following measures:

- Reorient or relocate the receiving antenna.
- Increase the separation between the equipment and the receiver.
- Connect the equipment to an outlet on a circuit different from that to which the receiver is connected.
- Consult the dealer or experienced radio/TV technician for help.

Canadian RFI:

This digital apparatus does not exceed the Class B limits for radio noise emissions from digital apparatus as set out in the Radio Interference Regulations of the Canadian Department of Communications.

Getting started

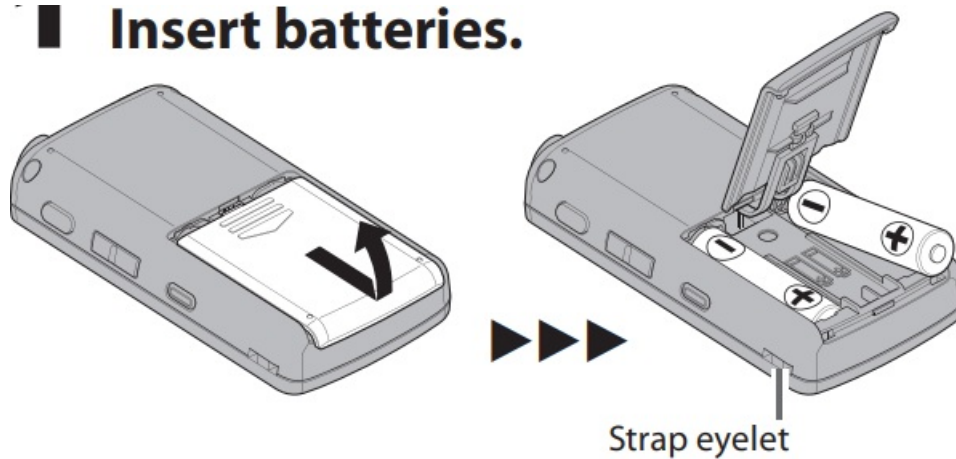

Insert batteries.

■ Insert batteries.



- A strap is not supplied with this product.

Battery indicator

If  is displayed on the screen, replace batteries as soon as possible. If the battery level becomes too low  and [Battery Low] are displayed then the recorder automatically turns off

Turn on the power

Slide the POWER switch to ON.

- Be sure to remove the protective film on the display before using this product.

To turn off the power

While the recorder is in the stop mode, slide the POWER switch to OFF/HOLD.

Power save mode

If no operations are performed for more than 10 minutes when the power is on, the display automatically turns off and the recorder enters the power save mode. To exit the power save mode, press any button.

HOLD

If sliding the POWER switch to OFF/HOLD while the recorder is in operation, all buttons and switches are disabled without interrupting the current operations.

Set the time and date. “Setting time and date” (Verso)

- The [Set Time & Date] screen appears when you use the recorder for the first time or when the recorder is turned on after more than 30 minutes without a power supply.
- If the time and date are not set, the time and date of the default settings are recorded to files.

Recording

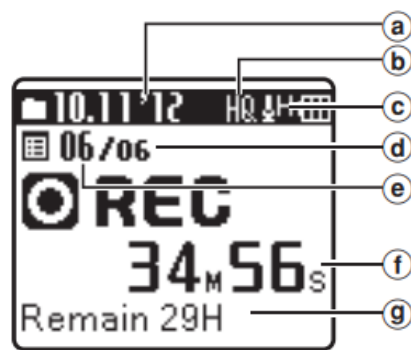
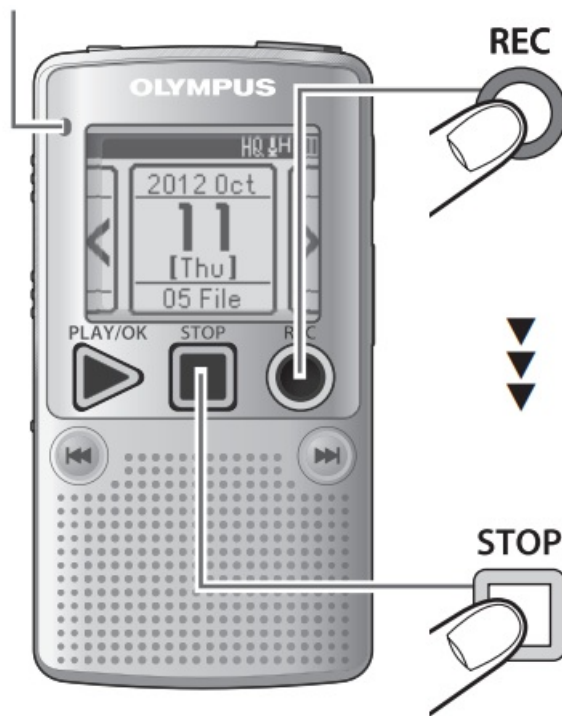

- Current date
- Recording mode indicator
- Microphone sensitivity indicator
- Total number of recorded files for the date
- Current file number
- Elapsed recording time
- Remaining recording time



Pause

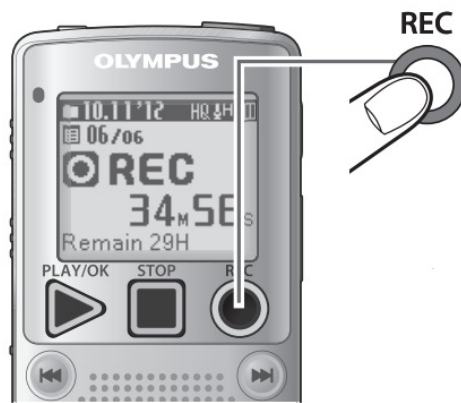

To pause recording, press the REC (O) button while recording. To resume the recording, press the REC (O) button again.

- Recording is automatically stopped if 60 minutes elapse after recording is paused.

Microphone sensitivity

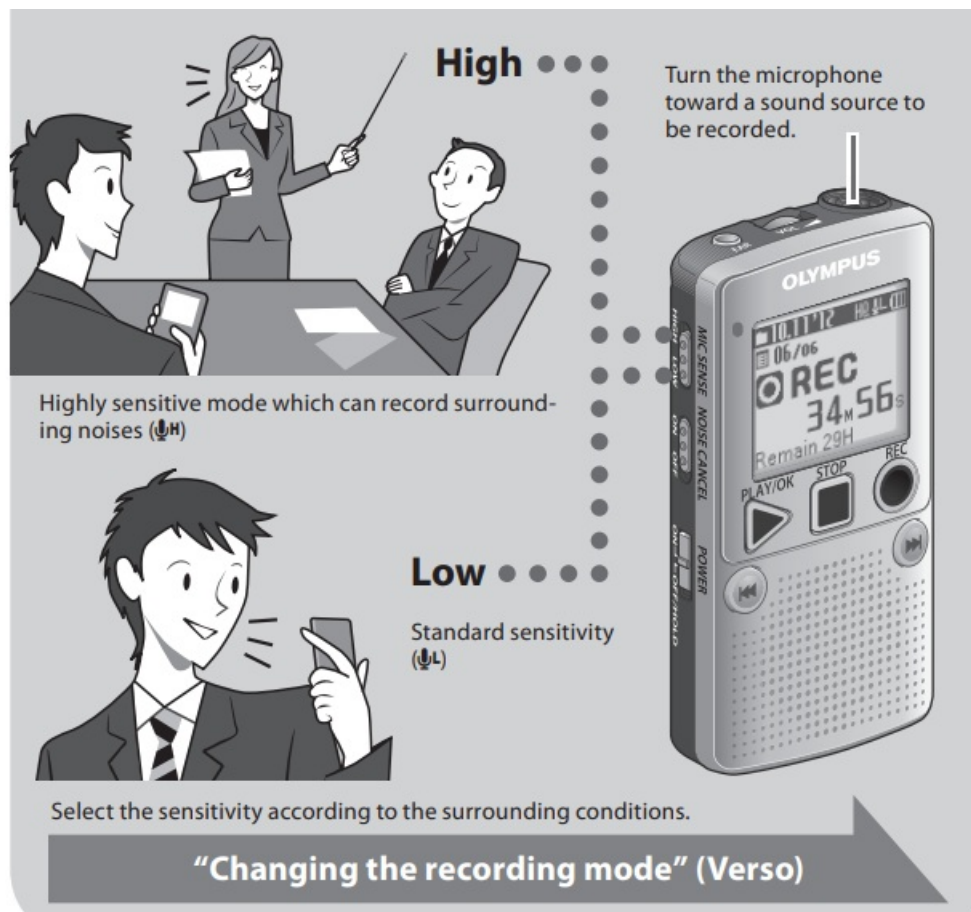

“Changing the recording mode” (Verso)

- To ensure successful recordings, we recommend you test recording with the selected functions and volume beforehand.
- To ensure recording from the beginning, start recording a sound source after the recording indicator lights.
- The recorder cannot record if [Memory Full] or [Maximum File Size is reached] is displayed. Delete unnecessary files to free up some space in memory.
- If the recorder is placed directly on a table, the vibrations of the table are likely to be recorded. To record sound clearly, place a notebook or handkerchief between the recorder and the table to prevent the vibrations from being recorded.
- When the available recording time becomes less than 60 seconds, the recording indicator starts flashing. The indicator flashes faster if the available time decreases to 30 seconds and to 10 seconds.

Playback

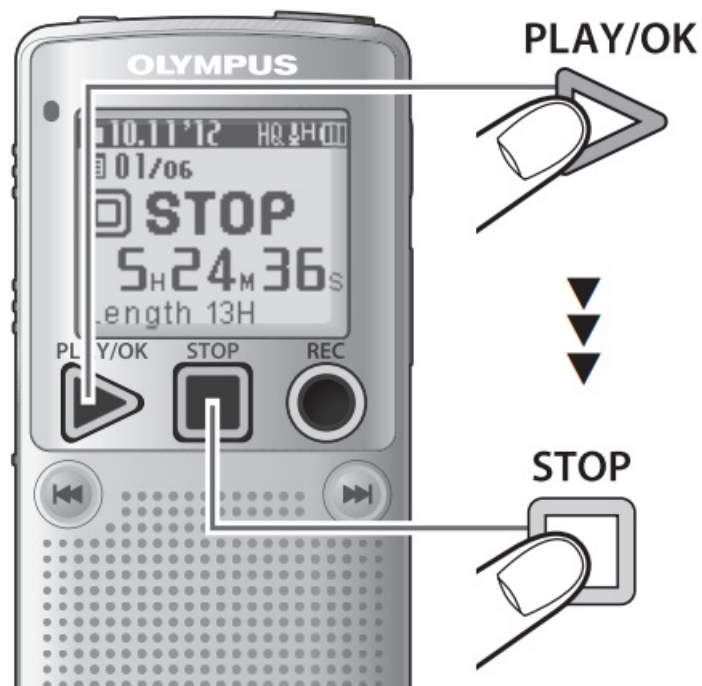

- Recording date
- Current file number
- Elapsed playback time
- Playback position bar indicator



e Approximate file length

Forwarding and Rewinding

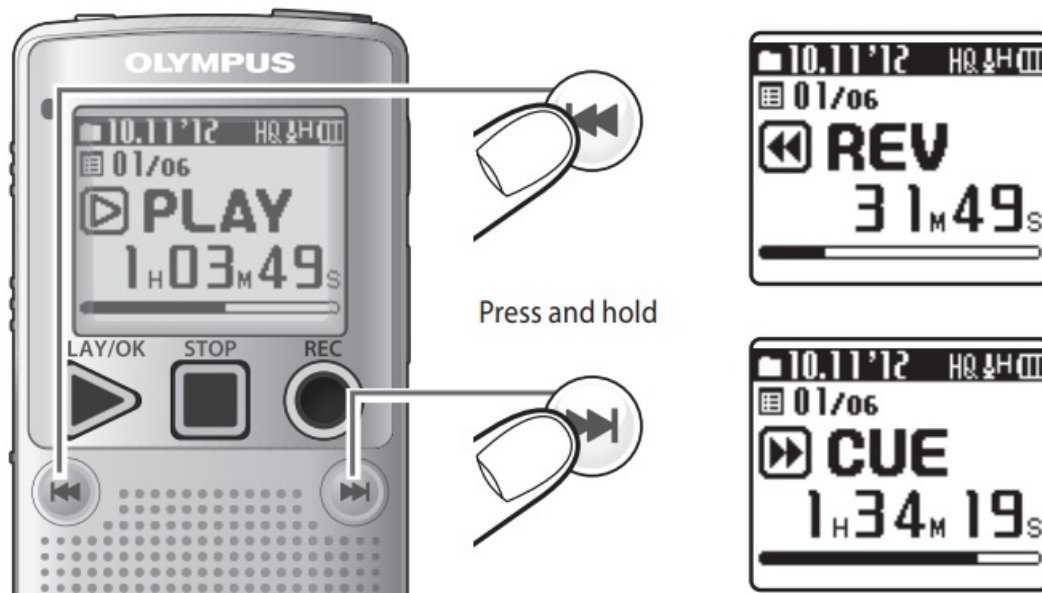

- To fast-forward or rewind a file, press and hold **⏮ or ⏭** button while playing back a file.
- To skip to the next file or previous file, press **⏮ or ⏭** button.
- Fast-forwarding or rewinding continues to the next file.

Changing the playback speed



Fast

Playback speed is changed between 0.5x, 0.75x, normal, 1.2x, 1.5x, and 2.0x by each press of the buttons.

Slow



Noise cancel

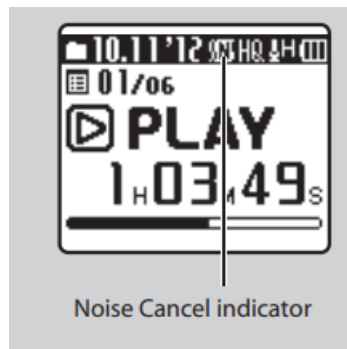

On

Noise is reduced when played back to achieve better sound quality.

Off

The file is played back as it was recorded.

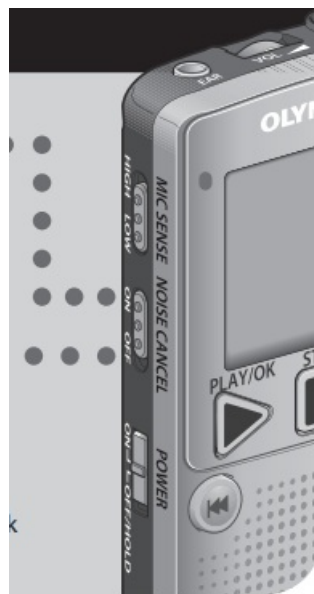

- When the NOISE CANCEL switch is set to ON, playback speed returns to normal.

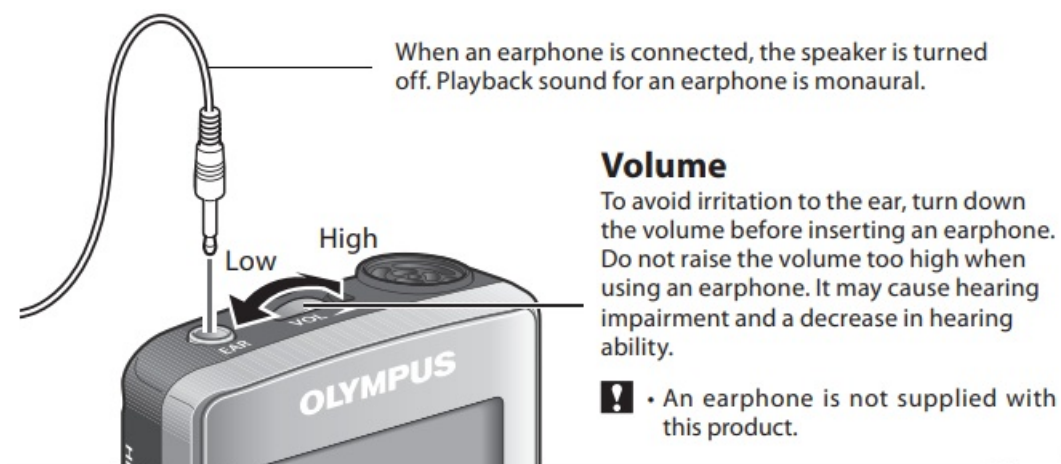

Volume

To avoid irritation to the ear, turn down the volume before inserting an earphone. Do not raise the volume too high when using an earphone. It may cause hearing impairment and a decrease in hearing ability.

File search

Search for files by the date they were recorded.



Recorder status indicator
 ▶ : During playback
 ▶F : During fast playback
 ▶S : During slow playback

● When searching for a file recorded on October 15.



The date display appears.



Select October 15.



The first file is played back.



If the file is skipped, the recorder plays back the next file.

STOP

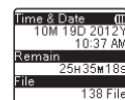

When the recorder is in stop mode, press and hold the **STOP** button to display the [Time & Date] and [Remain].

Erase

Select the file you want to delete and stop playback beforehand.

To delete all files recorded on a specific date, press the **SEARCH/MENU** button to switch to the date display.



PLAY/OK



PLAY/OK



Set

PLAY/OK



Select



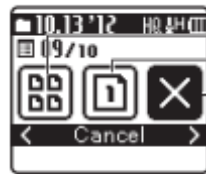

Erase in Date
File Erase
Cancel
If [Cancel] is selected and the **PLAY/OK** (▶) button is pressed, the recorder returns to the stop mode.

File Erase



Erase in Date



The number of files to be deleted flashes.



The date of all the files to be deleted flashes.

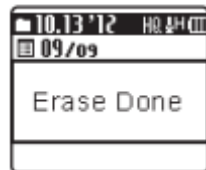

After deletion, files are renumbered consecutively, and the recorder stops at the beginning of the next file.

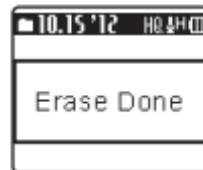

After deletion, the next date with recorded files available is displayed.



- If no operations are performed for 8 seconds, the recorder returns to the stop mode.

- It may take more than 10 seconds to complete the processing. Do not remove batteries while processing. The data may be corrupted. Check the battery level beforehand to ensure that the batteries do not run out while processing.

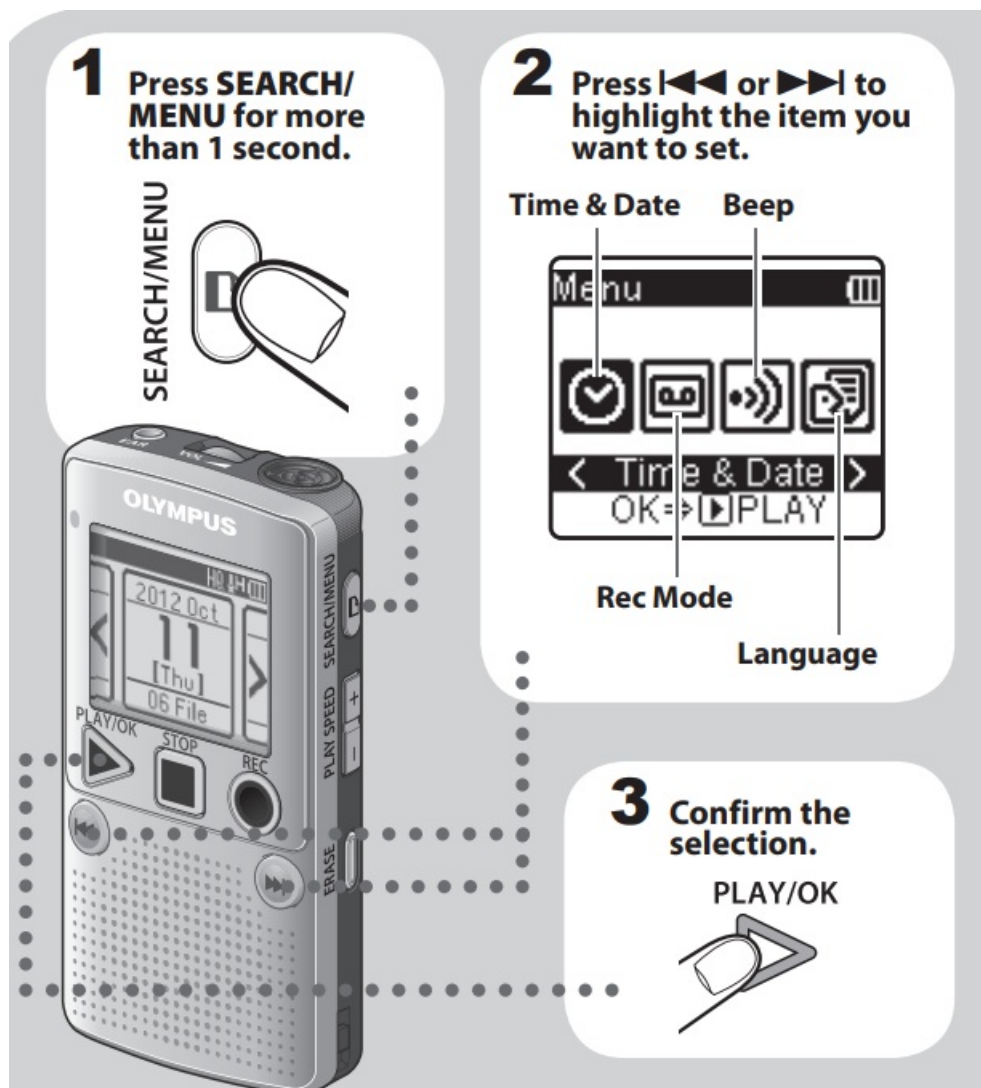

Setting time and date

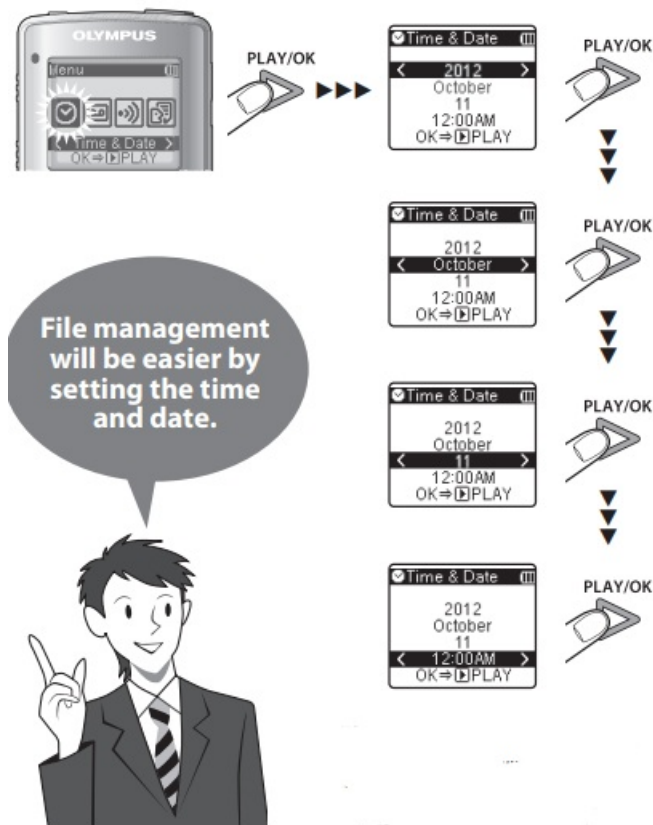

Press **⏮** or **⏭** to set a date.

- The clock will start from the set date and time. Press the PLAY/OK button according to the time signal.
- Check the time and date settings before using the product again if it is left unused for long periods of time.

Changing the recording mode





Use the **⏮** or **⏭** buttons to switch recording modes.

Turning the beep On/Off





Recommended settings by recording condition		
Recording condition	Recommended settings	
	Rec Mode	MIC SENSE
Dictation with a lot of background noise.	[HQ] (high quality sound recording)	[LOW]
Recordings for lessons and meetings.	[HQ] (high quality sound recording)	[HIGH]
Lengthy recordings.	[SP] (standard recording)	[HIGH]

Use the  or  buttons to turn the operating sound On/Off.

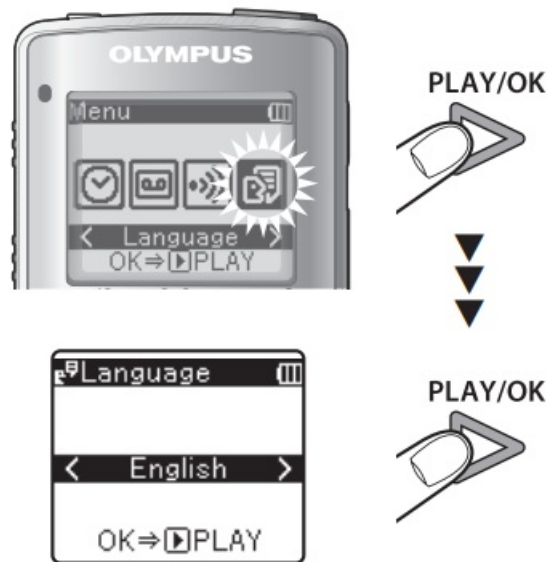
Changing the display language



Use the  or  buttons to select the display language.

Safe and proper usage

General Precautions

- Do not leave the recorder in hot, humid locations such as inside a closed automobile under direct sunlight or on the beach in the summer.
- Do not store the recorder in places exposed to excessive moisture or dust.
- Do not use organic solvents such as alcohol and lacquer thinner to clean the unit.
- Do not place the recorder on top of or near electric appliances such as TVs or refrigerators.
- Avoid recording or playing back near cellular phones or other wireless equipment, as they may cause interference and noise. If you experience noise, move to another place, or move the recorder further away from such equipment.
- Avoid sand or dirt. These can cause irreparable damage.
- Avoid strong vibrations or shocks.
- Do not disassemble, repair, or modify the unit yourself.
- Do not operate the unit while operating a vehicle (such as a bicycle, motorcycle, or go-cart).
- Keep the unit out of the reach of children.

<Warning regarding data loss>

- Recorded content in memory may be destroyed or erased by operating mistakes, unit malfunction, or during repair work.
- For important recorded content, we recommend you write it down somewhere.
- Any liability for passive damages or damage of any kind that occurred due to data loss incurred by a defect of the product, repair performed by a third party other than Olympus or an Olympus authorized service station, or any other reasons is excluded from Olympus's liability.

Batteries

Danger

- Batteries should never be exposed to flame, heat, short-circuited, or disassembled.
- Never store batteries where they will be exposed to direct sunlight, or subjected to high temperatures in a hot vehicle, near a heat source, etc.

Warning

- Do not solder lead wires or terminals directly onto a battery or modify it.
- Do not connect the = and – terminals. This may cause fire, overheating, or electric shock.
- When carrying or storing the batteries, be sure to put them in the provided case to protect their terminals. Do not carry or store the batteries with any metal objects (such as key rings).
- If this warning is not followed, fire, overheating, or electric shock may occur.
- Do not insert the batteries with their = and – terminals reversed.
- If any liquid from a battery gets into your eyes, promptly wash it off with clean water and consult your doctor at once.
- Do not attempt to recharge alkaline, lithium, or any other non-rechargeable batteries.
- Never use any batteries with a torn or cracked outer cover.
- Keep batteries out of the reach of children.
- If you notice anything unusual when using this product such as abnormal noise, heat, smoke, or a burning odor:
 - 1 remove the batteries immediately while being careful not to burn yourself, and;
 - 2 call your dealer or local Olympus representative for service.
- Do not expose the batteries to water. Do not allow water to contact the terminals.
- Do not remove or damage the battery insulating sheet.
- Do not use the batteries if you find something wrong with them such as leakage, color change or deformity.
- Unplug the charger if the charging is still incomplete after the specified time it should take.
- Should any battery liquid get on skin or clothing, promptly wash it off with clean water.
- Keep batteries away from fire.

Caution

- Do not subject batteries to strong shocks.
- When using rechargeable batteries that have not been used for a while, be sure to recharge them before use.
- Rechargeable batteries have a limited lifetime. When the operating time becomes shorter even if the rechargeable battery is fully charged under the specified condition, replace it with a new one.

Troubleshooting

The power cannot be turned on.

Batteries are exhausted. Batteries are inserted incorrectly. Check = and - before inserting new batteries.
Terminals are soiled. Terminals are soiled.

Nothing happens when a button is pressed.

The POWER switch is set to the OFF/HOLD position. Slide the POWER switch to the ON position.

No sound or quiet sound is heard from the speaker while playing back.

The earphone plug is plugged into the recorder. The volume is set to the low level

Recording is not possible.

By pressing the REC (?) button: Check if the display shows Memory Full. Check if the display shows Maximum File Size is reached. Delete unnecessary files before recording. A maximum of 99 files can be recorded in a day.

The playback speed is too fast (slow).

The recorder is set to fast (slow) Playback. Us the Pe LAY SPEED button to set to normal play-back.

Specifications

- **Recording medium:** Built-in flash memory (2GB)
- **Overall frequency:** HQ mode: 70 to 7,900 Hz
- **SP mode:** 70 to 4,700 Hz
- **Guide to recording times:** HQ mode: Approx.98h.
- **SP mode:** Approx. 202 h. Microphone: Electret Condenser Microphone (monaural)
- **Speaker:** Built-in ø 36 mm round dynamic speaker
- **Maximum power:** 180 mW
- **Earphone jack (monaural):** ø 3.5 mm diameter, impedance 8 Ω or more
- **Power supply:** Two AAA (LR03) batteries
- **Continuous battery:** Guide to alkaline battery life

Recording mode	HQ	SP
During recording mode	approx. 67 h.	approx. 80 h.
During playback mode (Built-in speakers)	approx. 21 h.	approx. 21 h.
During playback mode (Earphone)	approx. 45 h.	approx. 49 h.

- **Dimensions:** 95 (L)mmx50(W)mmx18.2 (T)mm (without protrusions)
- **Weight:** 78 g (including battery)
- **Operating temperature:** 0°C – 42°C

1. Battery life is measured by Olympus. It varies greatly according to the type of batteries used and the conditions of use.

2. Your recorded contents are for your personal use or pleasure only. It is prohibited to record copyrighted material without permission of the copyright holders according to copyright law.
3. Specifications and design are subject to change without notice for improvement of performance.

Frequently Asked Questions

What is the model number of the OLYMPUS DP-201 Digital Voice Recorder?

The model number of the OLYMPUS DP-201 Digital Voice Recorder is DP-201, and it is a product of the OLYMPUS brand.

How does the OLYMPUS DP-201 Digital Voice Recorder record audio?

The OLYMPUS DP-201 Digital Voice Recorder, model DP-201, records audio through its built-in microphone or an external microphone if connected.

Can I expand the storage capacity of the OLYMPUS DP-201 Digital Voice Recorder?

No, the OLYMPUS DP-201 Digital Voice Recorder (model DP-201) does not have expandable storage. It relies on its internal storage.

Is the OLYMPUS DP-201 Digital Voice Recorder compatible with Mac and Windows computers?

Yes, the OLYMPUS DP-201 Digital Voice Recorder (model DP-201) is compatible with both Mac and Windows operating systems.

What is the battery life of the OLYMPUS DP-201 Digital Voice Recorder?

The OLYMPUS DP-201 Digital Voice Recorder (model DP-201) offers a battery life.

Does the OLYMPUS DP-201 Digital Voice Recorder have a voice-activated recording feature?

Yes, the OLYMPUS DP-201 Digital Voice Recorder (model DP-201) has a voice-activated recording feature for convenience.

Can I transfer recordings from the OLYMPUS DP-201 Digital Voice Recorder to my computer?

Yes, you can transfer recordings from the OLYMPUS DP-201 Digital Voice Recorder (model DP-201) to your computer using the included USB cable.

Does the OLYMPUS DP-201 Digital Voice Recorder have a playback function?

Yes, the OLYMPUS DP-201 Digital Voice Recorder (model DP-201) has a playback function for reviewing recorded audio.

How can I set the date and time on the OLYMPUS DP-201 Digital Voice Recorder?

To set the date and time on the OLYMPUS DP-201 Digital Voice Recorder (model DP-201), refer to the user manual for step-by-step instructions.

Is the OLYMPUS DP-201 Digital Voice Recorder suitable for recording lectures?

Yes, the OLYMPUS DP-201 Digital Voice Recorder (model DP-201) is suitable for recording lectures and meetings.

Does the OLYMPUS DP-201 Digital Voice Recorder have a built-in speaker?

Yes, the OLYMPUS DP-201 Digital Voice Recorder (model DP-201) comes equipped with a built-in speaker for playback.

Download this PDF Manual [Olympus-DP-201-Digital-Voice-Recorder Instruction Manual](#)

Device Report

[OLYMPUS DP-201 Digital Voice Recorder Instruction Manual](#)

References

- [User Manual](#)